



Society for
Personality
Assessment

2024 SPA Convention



March 13 - 17, 2024 | San Diego, CA

personality.org

Welcome to San Diego, CA!

On behalf of the Convention Program Committee of the Society for Personality Assessment, we are pleased to welcome you to this year's conference. We are so happy to have you join us as we gather for another exceptional meeting of the Society for Personality Assessment. This year's program is full of a wide range of content delivered by the world's leading experts on personality assessment, an assortment of networking and social events, and educational opportunities offering over 100 CE credits over five exciting days. Whether you have a long history with SPA or this is your first time joining us, we look forward to spending the coming days with you, and we hope that you will stop and say "Hello!" if you see us. Solemnly, we have also dedicated time during this year's conference to honor and remember the lives and careers of those we lost over the past year. As an organization and as individuals, we are forever impacted by their lives and their work, and we offer our condolences to each of us touched by these losses.

We are honored to be bringing featured speakers from across the world to speak on strategies for increasing the accessibility, equity, and utility of assessment. We start things off on Thursday with Dr. Gregory Meyer's delivery of the Bruno Klopfer Lecture as he receives this year's Bruno Klopfer Award for Lifetime Achievement. You won't want to miss Friday's featured lecture on the place of psychology and assessment in support of Indigenous Health advancement delivered by Dr. Suzanne Pitama. On Saturday, Dr. Col Williams' will share gender affirming practices that are particularly pertinent to the field of psychological and personality assessment.

We're also excited to share that you'll have the opportunity to join SPA at the San Diego Zoo on Wednesday evening for food, drink, and socializing. And if that's not wild enough for you, this year we've partnered with the HiTOP consortium to host the 2024 HiTOP Conference where you can enjoy two thrilling days of research. But don't be overwhelmed! We strived to offer a balanced program, rich in learning opportunities, social events, and downtime to explore this fabulous city or connect with colleagues. Much of our programming will be recorded and made available through our website to make it even easier for all of you to experience as much of this year's convention as possible.

Welcome, and enjoy the conference!



Jennifer Laney
2024 Convention Program
Committee Co-Chair



Adam Natoli
2024 Convention Program
Committee Co-Chair

Sponsor

PAR[®]

Partners, & Exhibitors



American Psychology-Law Society

APA DIVISION 41



Pearson

**M
I
N
N
E
S
O
T
A**

Thurston Cradock
Test of Shame

www.testofshame.com



university
of minnesota
press

Leadership & Staff

President

2024 - 2025

Jan Kamphuis, PhD
Amsterdam, The Netherlands

President-Elect

2024 - 2025

Nicole Cain, PhD
Brooklyn, NY

Past President

2024 - 2025

A. Jill Clemence, PhD
Arlington, VT

Treasurer

2023 - 2024

Tayla T.C. Lee, PhD, HSPP
Muncie, IN

Secretary

2019 - 2024

Jaime Anderson, PhD
Huntsville, TX

Representatives at Large

Stephen Finn, PhD
Austin, TX

Katie Lewis, PhD
Stockbridge, MA

Abby Mulay, PhD
Charleston, SC

Leonard Simms, PhD
Buffalo, NY

Kate Thomas, PhD
Austin, TX

Matthew Yalch, PhD
Palo Alto, CA

Diversity & Social Justice Chair

Ksera Dyette, PsyD
Newton, MA

Strategic Liason to Board of Educational Affairs

Andrew Jordan Wright, PhD
New York, NY

Editor, Journal of Personality Assessment

Martin Sellbom, PhD
Otago, New Zealand

SPAGS President

2024 - 2025

Sarah Gottlieb, MA
William James College

Central Office

Nathan Victoria, MEd, CAE
Executive Director & CEO
nvictoria@personality.org

Monica Tune
Operations Director
mtune@personality.org

Cristina Gonzalez, CDMP
Marketing & Membership
Manager
cgonzalez@personality.org

2024 Convention Committee

Jennifer M. Laney, PsyD |
Private Practice

Adam P. Natoli, PhD | Sam
Houston State University

Anita L. Boss, PsyD, ABPP |
Clinical & Forensic Consulting

Christopher J. Hopwood, PhD |
University of Zurich

Katie Lewis, PhD | Austen
Riggs Center

Joye Anestis, PhD | Rutgers
University

JJ Boland, PhD | Sam Houston
State University

Daniela Escobedo, PhD |
Universidad Autónoma de
Nuevo Leon

Sarah Gottlieb, MA | William
James College

Abby L. Mulay, PhD | Medical
University of South Carolina

Jared Ruchensky, PhD | Sam
Houston State University

Pamela Schaber, PhD | Center
for Therapeutic Assessment

Matthew Yalch, PhD | Palo Alto
University

Table of Contents

- 2 Welcome Letter
- 3 Sponsors/Exhibitors/Partners
- 4 Leadership & Staff
- 6 Pricing
- 7 Hotel Map
- 9 Schedule at a Glance
- 10 Featured Lectures
- 14 Workshops
- Daily Presentations
 - 17 Thursday
 - 19 Friday
 - 23 Saturday
- Poster Presentations
 - 30 Thursday Posters
 - 34 Saturday Posters
- 39 Awards
- 45 Equity, Inclusion, and Social Justice Track
 - Sessions that have been indicated as an EISJ Track will be indicated with a ★.
- 45 General Information

Virtual sessions will be marked with the camera icon. 

Pricing

SPA views the workshops and the Convention as separate entities. There is a registration fee for each workshop; and there is a separate registration fee for the Convention (held Thursday through Saturday). One can attend any number of workshops and choose not to attend the convention, or attend the convention and not participate in any workshops.

The SPA Board of Trustees explored many options regarding registration rates for the Convention. The Board recognizes that institutional and personal funds are limited at this time, so the final prices for the convention balance the need to cover a portion of SPA's expenses while still creating an affordable yet well-produced convention that you have come to expect. These expenses include online conference software, development of software and apps, video editing, staff salaries, and contract staff to help produce this event. Cancellation Policy - Cancellations will be accepted for the Annual Convention and/or a workshop(s), less a \$75 administrative fee, until February 14, 2024. After that date no refunds will be granted.

*Member pricing is based on individual membership status at the time of the event. At this time, the SPA Annual Convention does not provide the option to join/renew and register in the same transaction. However, you will be given the option to join/renew prior to starting registration when you click the registration link. If you have never been a member and would like to register for the SPA Annual Convention at the member rate, please create a profile and join prior to registering.

In-Person Tickets

Member Type	Early Registration Rate* (Now - 1/23/24)	Regular Registration Rate* (1/24/24 - 2/28/24)	Late Registration Rate* (2/29/24 - 3/17/24)	One-Day Rate*
Student	\$99	\$124	\$164	\$74
Early-Career	\$209	\$249	\$299	\$149
Member/Fellow/Associate	\$339	\$389	\$459	\$249
Non-Member Student	\$149	\$174	\$214	\$124
Non-Member Early-Career	\$289	\$329	\$379	\$229
Non-Member	\$479	\$529	\$599	\$389

Virtual Tickets

Member Type	Early Registration Rate* (Now - 1/23/24)	Regular Registration Rate* (1/24/24 - 2/28/24)	Late Registration Rate* (2/29/24 - 3/17/24)
Student	\$79	\$104	\$144
Early-Career	\$179	\$219	\$269
Member/Fellow/Associate	\$289	\$339	\$409
Non-Member Student	\$129	\$154	\$194
Non-Member Early-Career	\$259	\$299	\$349
Non-Member	\$429	\$479	\$549

Half-Day Workshop Tickets

Member Type	Early Registration Rate* (Now - 1/23/24)	Regular Registration Rate* (1/24/24 - 2/28/24)	Late Registration Rate* (2/29/24 - 3/17/24)
Student	\$74	\$99	\$139
Early-Career	\$139	\$179	\$229
Member/Fellow/Associate	\$189	\$239	\$309
Non-Member Student	\$104	\$129	\$169
Non-Member Early-Career	\$194	\$234	\$284
Non-Member	\$259	\$309	\$379

Full-Day Workshop Tickets

Member Type	Early Registration Rate* (Now - 1/23/24)	Regular Registration Rate* (1/24/24 - 2/28/24)	Late Registration Rate* (2/29/24 - 3/17/24)
Student	\$139	\$164	\$204
Early-Career	\$199	\$239	\$289
Member/Fellow/Associate	\$249	\$299	\$369
Non-Member Student	\$169	\$194	\$234
Non-Member Early-Career	\$254	\$294	\$344
Non-Member	\$324	\$374	\$444

Hotel Map

Lobby Level

MEETING SPACE

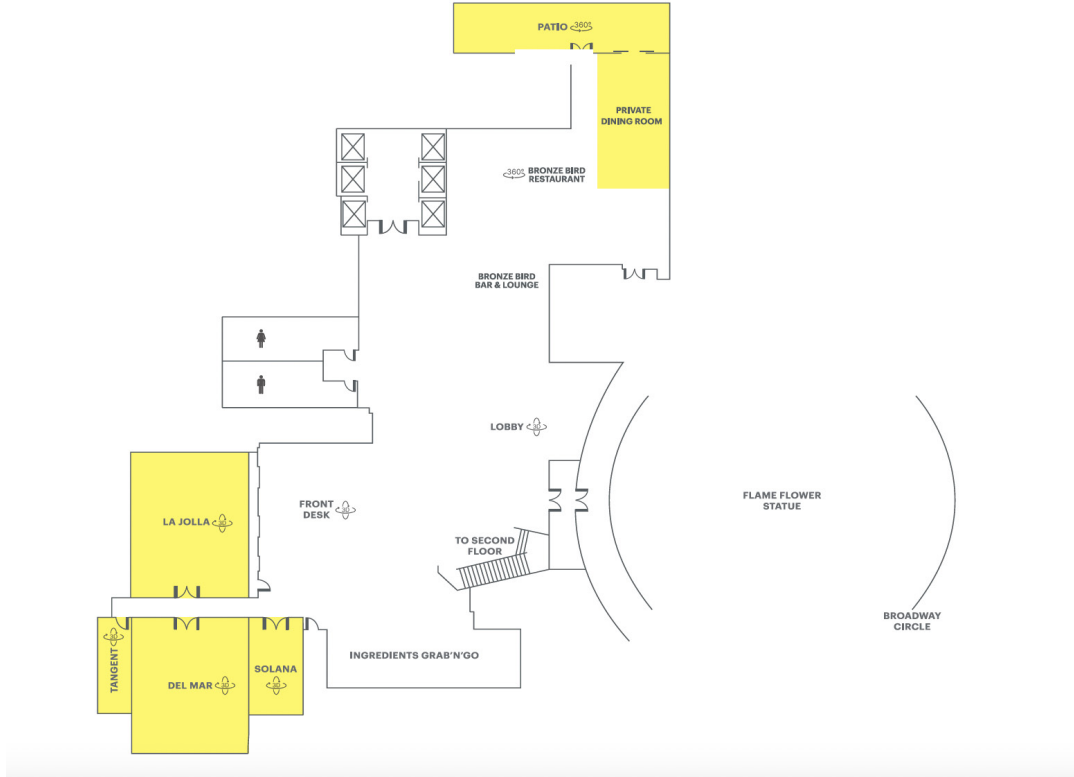

Second Floor

MEETING SPACE

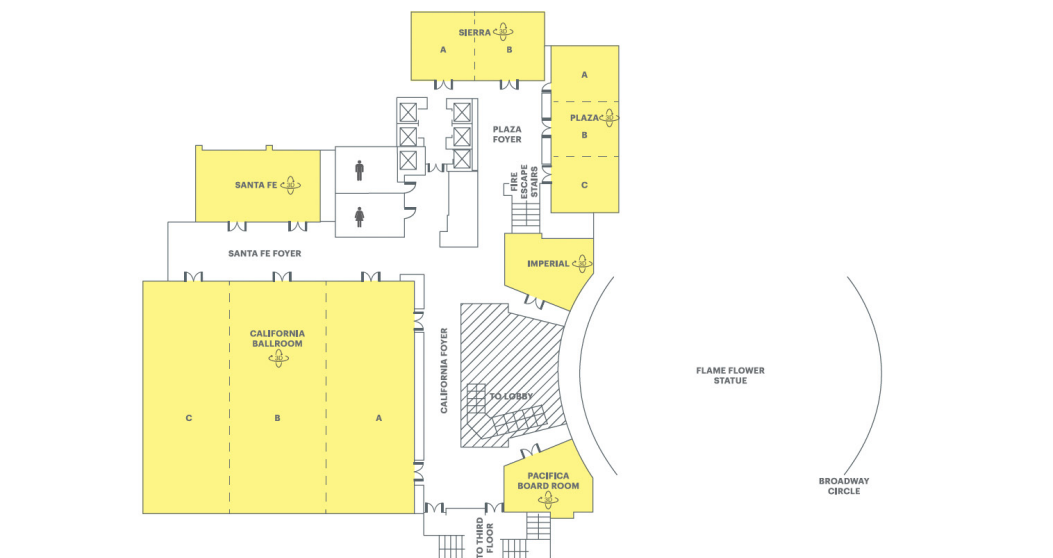

Third Floor

MEETING SPACE

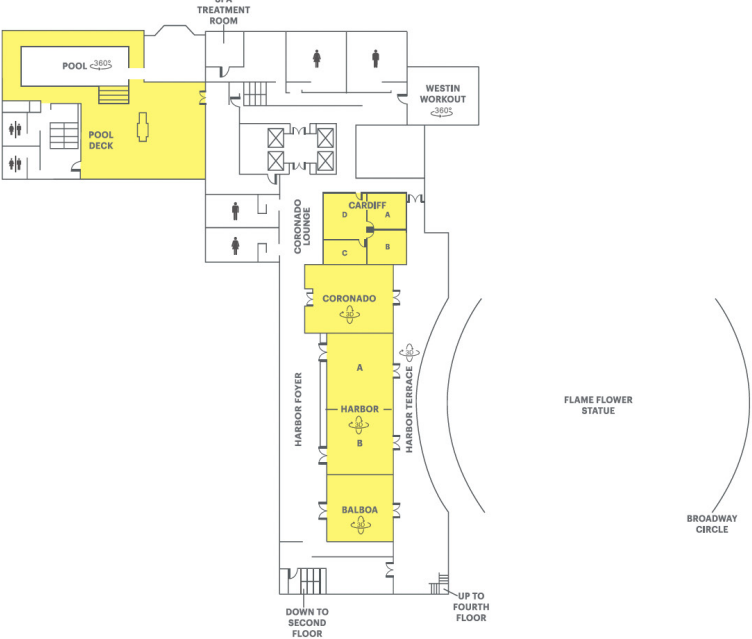

Fourth Floor

MEETING SPACE

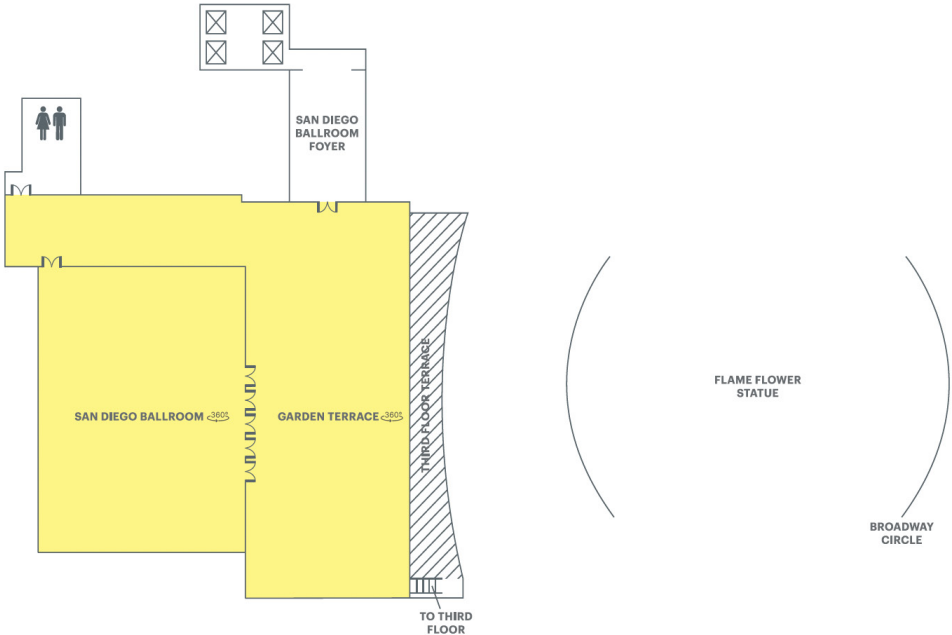

Schedule at a Glance

The SPA Convention will be held between March 13th - 17th, and workshops will be held on March 13th, 14th, 15th, and 16th in-person ONLY. Please note, the listed times below are in the Pacific Standard Time Zone and are subjective to change. View our online program for the most up to date information.

WEDNESDAY | MARCH 13TH

7:30 AM - 5:00 PM	Registration Desk Open
8:00 AM - 11:45 AM	Half-Day Workshops
8:00 AM - 4:45 PM	Full-Day Workshops
8:00 AM - 3:00 PM	Board of Trustees Meeting*
10:00 AM - 10:15 AM	Coffee Break**
11:45 AM - 1:00 PM	Lunch Break
1:00 PM - 4:45 PM	Half-Day Workshops
3:00 PM - 3:15 PM	Coffee Break**
3:00 PM - 9:00 PM	Wild Connections @ San Diego Zoo

THURSDAY | MARCH 14TH

7:30 AM - 5:30 AM	Registration Desk Open
8:00 AM - 11:30 AM	Board of Trustees Meeting*
8:00 AM - 11:45 AM	Half-Day Workshops
8:00 AM - 12:00 PM	Exhibitors Set-Up
10:15 AM - 10:30 AM	Coffee Break**
10:30 AM - 11:30 AM	First Time Attendee Orientation, Hosted by SPAGS
11:45 AM - 1:00 PM	Mentorship Lunch*
11:45 AM - 1:00 PM	Lunch Break
12:00 PM - 6:00 PM	Exhibitors Open
1:05 PM - 2:50 PM	Opening Plenary Session (President's Address & Plenary)
2:50 PM - 3:00 PM	Transition Break
3:00 PM - 4:30 PM	Concurrent Sessions
4:30 PM - 4:45 PM	Coffee Break
4:45 PM - 6:30 PM	SPA Awards & Bruno Klopfer Lecture
6:30 PM - 7:00 PM	Book Signing
6:30 PM - 7:30 PM	Poster Sessions I
6:30 PM - 8:00 PM	President's Welcome Reception

* This event is invite only.

** Coffee Break is only for individuals taking a workshop during this time.

FRIDAY | MARCH 15TH

7:30 AM - 5:30 PM	Registration Desk Open
8:00 AM - 9:30 AM	Concurrent Session 2
8:00 AM - 5:30 PM	Exhibitors Open
9:30 AM - 9:45 AM	Transition Break
9:45 AM - 10:45 AM	Hertz Memorial Lecture
10:45 AM - 11:15 AM	Exhibitor Coffee Break
11:00 AM - 12:15 PM	SPAGS Board Meeting*
11:15 AM - 12:15 PM	Interactive Interest Group Meeting
12:15 PM - 1:15 PM	FREE Headshots
12:15 PM - 2:00 PM	Lunch Break
12:30 PM - 1:30 PM	SPA Practitioners & Trainees of Color Lunch*
1:00 PM - 4:15 PM	Workshop Master Class*
2:00 PM - 3:30 PM	Concurrent Session 3
3:30 PM - 4:30 PM	Coffee Break and Networking
3:40 PM - 4:20 PM	Inside Perspectives to the Mentee/ Mentor Relationship
4:30 PM - 5:30 PM	Dr. Suz Pitama
5:30 PM - 6:15 PM	SPA Business Meeting
6:15 PM - 7:15 PM	International/ Diversity & Social Justice Social
7:15 PM - 7:30 PM	Lady Bluegrass Performance
7:30 PM - 8:30 PM	Society for Personality Assessment Graduate Students Social

SATURDAY | MARCH 16TH

7:30 AM - 5:30 PM	Registration Desk Open
7:45 AM - 8:45 AM	JPA Editorial Board Breakfast*
8:00 AM - 9:00 AM	Wellness Activity
8:30 AM - 2:00 PM	Exhibits Open
9:00 AM - 10:30 AM	Concurrent 4
10:30 AM - 11:00 AM	Exhibitor Coffee Break
11:00 AM - 12:00 PM	Dr. Col Williams
12:00 PM - 1:00 PM	FREE Headshots
12:00 PM - 1:30 PM	Lunch Break
12:15 PM - 1:15 PM	LGBTQ+ Practitioners & Trainees Lunch*
1:30 PM - 3:00 PM	Concurrent Session 5
2:00 PM - 5:30 PM	Exhibitor Breakdown
3:00 PM - 4:00 PM	Coffee Break and Networking
4:00 PM - 5:30 PM	Concurrent Session 6
5:30 PM - 7:00 PM	Poster Session II
5:30 PM - 7:00 PM	Joint SPA & HiTOP Reception, Sponsored by JPA

SUNDAY | MARCH 17TH

7:30 AM - 5:30 PM	Registration Desk Open
8:30 AM - 12:15 PM	Half-Day Workshops
10:30 AM - 10:45 AM	Coffee Break**

Featured Lectures

Thursday, March 14th | 1:50 - 2:50 PM 

A Celebration of the Career of John R. Graham: A Distinguished Scholar and Mentor

Location: California Ballroom

Tayla Lee, Carlo Veltri, and Martin Sellbom



In this talk, we honor the contributions to personality assessment made by Dr. John R. (Jack) Graham (1940 – 2022). Dr. Graham's empirical work focused primarily on the Minnesota Multiphasic Personality Inventory (MMPI) family of instruments. He was a member of the team responsible for the first revision of the test, which led to the MMPI-2 and the MMPI-A. Dr. Graham was the author of a book about the MMPI family of instruments, now in its 6th edition, that has been used to train generations of assessment psychologists. As a professor at Kent State University, Dr. Graham regularly taught courses on personality assessment and he mentored over 40 doctoral students. His teaching extended outside of the classroom, as Dr. Graham also regularly conducted professional workshops on the MMPI instruments and personality assessment. Dr.

Graham was a fellow of the Society for Personality Assessment and was awarded the Bruno Klopfer award for his achievements in 2015. While Dr. Graham had many significant achievements in his career, he considered his most significant contributions to the field to be the psychologists he helped train and whose careers he helped launch. To commemorate Dr. Graham's legacy of mentorship, it is our pleasure to announce a new Society for Personality Assessment Award, the John R. Graham Award for Distinguished Mentorship in Personality Assessment.

Goals & Objectives

- ▶ Identify contributions to personality assessment made by John R. Graham.
- ▶ Discuss how John R. Graham helped shape use of the MMPI instruments.
- ▶ Understand the importance of mentorship in the careers of students and junior colleagues.

Bruno Klopfer Award Lecture- Opportunities and Challenges with Rorschach Research
[1 CE]

Location: California Ballroom

Gregory J. Meyer

In this talk, I begin with a review of some of the fortuitous opportunities and choices that, in hindsight, importantly shaped my research agenda and career, including with the Society for Personality Assessment. I follow this with a discussion of the aims and strategies that guided my role as an accidental test developer, describing the psychometric principles and strategies that my co-authors and I implemented with the goal of enhancing applied Rorschach practice and research. Given this opportunity to talk both to people interested and already using the Rorschach as well as people who may not be interested and may even consider the Rorschach to be an inherently suspect assessment measure, I describe what the Rorschach task is and is not. In this, I describe a Bayesian predictive coding model of how minds work, which provides a seamless fit for what Hermann Rorschach (and I) thought the task provided information about to assessors. Time permitting, I also anticipate presenting a brief video vignette of its use in practice and then more explicitly illustrate how it is used in the context of the Rorschach Performance Assessment System (R-PAS). I then describe some of the challenges of using the Rorschach in research, including the costs of time and skeptical reviewers, and address some of the current critiques focused on R-PAS or its foundational research. I end with some aspirations for the future uses of the Rorschach in practice and research, including in the second edition of R-PAS.

Goals & Objectives

- ▶ Identify how the Society for Personality Assessment provided the author with pivotal support to thoroughly review the research literature on the validity of assessment measures for predicting treatment and outcome.
- ▶ Describe the role that John Exner played in the development of the Rorschach Performance Assessment System (R-PAS).
- ▶ List two of the seven concrete outcomes that the R-PAS authors implemented based on their guiding theme of getting the psychometrics right to enhance the accuracy of its use in clinical practice.
- ▶ Describe how the model of Bayesian predictive processing meshes with Herman Rorschach's view of the information provided by the inkblot task.
- ▶ List at least two of the challenges of engaging in Rorschach research.



Gregory J. Meyer, Ph.D., is a Professor of Psychology at the University of Toledo. His research focuses on psychological assessment, with an emphasis on the integration of personality assessment methods and using the Rorschach as a measure of psychological processes grounded in behavioral performance. He has more than 95 peer-reviewed publications and an h-index of 52. He has received Distinguished Contribution Awards for specific articles and general contributions to assessment and he served as the Editor of the Journal of Personality Assessment for 11 years. He is a Fellow of the American Psychological Association (Division 5) and of the Society for Personality Assessment. In addition to co-authoring the manual for the Rorschach Performance Assessment System, he co-edited a casebook entitled Using the Rorschach Performance Assessment System (R-PAS).

Friday, March 15th | 4:30 - 5:30 PM ★ 📺

Decolonising Psychological Practice: An Indigenous Aotearoa New Zealand Perspective [1 CE]

Location: California Ballroom

Suzanne Pitama

The application of psychological paradigms and perspectives, when working alongside Indigenous peoples in 2024, require review and decolonialisation to ensure they promote cultural competence of the clinician to enable cultural safety for the Indigenous patient/client. This presentation will present and discuss the application of an Indigenous Health Model in Aotearoa New Zealand within psychological practice and training, including; lessons learnt, measuring appropriate outcomes, and the place of psychology in support of Indigenous Health advancement.

Goals & Objectives

- ▶ Discuss the role of Indigenous Health Models as tools of decolonisation.
- ▶ Describe the key components of The Meihana Model.
- ▶ Identify the impact of cultural competency on Indigenous health outcomes.



Suzanne is a registered psychologist and a member of the New Zealand Psychological Society. She is the Dean and the Head of Campus of the University of Otago, Christchurch. Suz has been involved in Māori health research and health professional education for over 20 years. Her work has included the development of an Indigenous Health model of health, which supports Indigenous and non-Indigenous health professionals signpost cultural competency and safety within their practice. Suzanne has received a number of awards including the Prime Minister's Supreme Award for tertiary teaching excellence and the Indigenous Leadership Award from the Leaders in Indigenous Medical Education (LIME). Suzanne was awarded the Joan Metge Medal for her research in Indigenous medical education.

★  Saturday, March 16th | 11:00 AM - 12:00 PM

Bridging the GAP: Bringing Assessment & Gender Affirming Practices Together [1 CE]

Location: California Ballroom

Col Williams

Transgender and gender diverse (TGD) people are more visible in our society than ever before and are seeking psychological care across specialties. For general psychologists in the field of assessment, this likely means that they are seeing an increasing number of TGD individuals. This talk intends to highlight gender affirming practices that are particularly pertinent to the field of psychological and personality assessment so that attendees feel better equipped to provide competent, sensitive, and affirming assessment to the TGD community.

Goals & Objectives

- ▶ Describe the core tenants of the gender affirming model of care.
- ▶ List at least two (2) gender affirming practices that can be incorporated into one's assessment practice.
- ▶ Describe best practices for utilization of gender norms for scoring on assessments.



Dr. Col Williams is an attending-level, clinical psychologist in the Gender Multispecialty Service, GeMS, at Boston Children's Hospital and holds an Instructor of Psychology appointment at Harvard Medical School. Dr. Williams' expertise is centered on working with transgender and gender diverse individuals across the lifespan. This is founded upon Dr. Williams having completed two post-doctoral fellowships – the first fellowship focused on providing interdisciplinary care to LGBTQ+ veterans at the Bedford VA and the second fellowship focused on working with transgender youth and their families, youth with intersex conditions, and youth with urological health concerns at Boston Children's Hospital. Dr. Williams' current clinical, research, and scholarship is focused on the transgender and gender diverse community, and they have a niche specialty in working with trans and gender diverse athletes.

All Workshops

Wednesday, March 13th

- 8:00 am - 11:45 am ★ A6 | Using the Adult Attachment Projective Picture System (AAP) as a Therapeutic Tool [3.5 CEs]
Location: Plaza A
Stephen Finn, Carol George, Caroline Lee, and Melissa Lehmann
Skill Level: Introductory
- A7 | Using the Rorschach with Individuals from Diverse Cultural Backgrounds [3.5 CEs]
Location: Plaza C
Luciano Giromini, Nancy Kaser-Boyd, and Madeleine Starin
Skill Level: All levels of familiarity with Rorschach assessments
- 8:00 am - 4:45 pm ★ A4 | Introduction to the Rorschach Comprehensive System - Revised (CS-R) [7 CEs]
Location: Santa Fe
Patrick Fontan
Skill Level: Basic training with the Rorschach CS
- ★ A5 | MCMI-IV and MACI-II: Operationalizing and Contextualizing the Millon Inventories [7 CEs]
Location: Del Mar
Robert Tringone and Seth Grossman
Skill Level: Adequately versed in objective personality assessment and common psychometric concepts; exposure to Millon theory and instrumentation is helpful but not required
- 1:00 pm - 4:45 pm A3 | Interpreting and Integrating Symptom Validity Tests: Use of the PAI and MMPI-2-RF/3 [3.5 CEs]
Location: Coronado
Nicole Morris, Megan Keen, and Paul Ingram
Skill Level: Basic familiarity with the PAI and/or MMPI-2-RF
- A8 | Using the Thurston Cradock Test of Shame (TCTS) to Uncover Hidden Dynamics in Personality Assessment [3.5 CEs]
Location: Plaza A
Julie Cradock O'Leary
Skill Level: All levels - Including graduate students

Thursday, March 14th

8:00 am -
11:45 am

B2 | Clinical Use of the Personality Inventory for DSM-5 (PID-5) and the DSM-5 Alternative Model for Personality Disorders (AMPD) [3.5 CEs]

Location: Plaza A

Bob Krueger and Tanya Freedland

Skill Level: Basic familiarity with clinical personality assessment

B3 | Embrace the Complexity: Integrating Assessment Results into Client-Centered Feedback Sessions [3.5 CEs]

Location: Del Mar

Pamela Schaber and Hilde De Daeger

Skill Level: Graduate Students and Clinicians with some knowledge of assessment and interpretation of test materials

B5 | Integrating and Combining Different Test Results to Distinguish Authentic/Credible from Feigned/Non-Credible Clinical and Forensic Presentations [3.5 CEs]

Location: Balboa

Luciano Giromini

Skill Level: Basic knowledge of major personality assessment instruments (e.g., MMPI, PAI)

★ B6 | Intelligence, Personality Assessment, and Race: Topics at the Intersection [3.5 CEs]

Location: Coronado

Linda McGhee

Skill Level: Familiarity with intelligence and personality tests

B1 | Introductory Applications and Ethics of Artificial Intelligence for Personality Assessment Practice and Research [3.5 CEs]

Location: La Jolla

Adam Natoli and ABM Rezbaul Islam

Skill Level: Introductory

B7 | The Use of Narratives in Clinical Practice and Research: Scoring Emotional, Self, and Interpersonal Processes using the SCORS-G [3.5 CEs]

Location: Santa Fe

Michelle Stein and Jennelle Slavin-Mulford

Skill Level: All levels - Including graduate students

B8 | Thought Disorder and the Rorschach [3.5 CEs]

Location: Plaza C

Martin Leichtman

Skill Level: All levels - Including graduate students

Friday, March 15th

1:00 pm - 4:15 pm C1 | Ethical Forensic Practice: (Some of) What You Need to Know Before Your First Referral [3 CEs]
Location: Harbor
Amanda Fanniff
Skill Level: Intermediate

Sunday, March 17th

8:30 am - 12:30 pm D3 | The SPECTRA: Indices of Psychopathology- Introduction, Clinical Application, & Recent Developments [3.5 CEs]
Location: Plaza C
Mark Blais
Skill Level: Introductory

Daily Presentations

Thursday, March 14th

3:00 pm -
4:30 pm

Emerging Research on Content-Bases Invalid Responding on the MMPI-3 and PAI [1.5 CEs]

Location: Coronado

Chair: Paul Ingram

Detecting Simulated Underreporting on the MMPI-3 in Veterans with a History of Suicidality

Megan Keen, Taylor Rodriguez, Joye Anestis, Paul Ingram, and Lauren Khazem

Evaluating the Personality Assessment Inventory (PAI) Cognitive Bias Scale (CBS): Considering Alternative Scoring Methods

Keegan Diehl, Patrick Armistead-Jehle, and Paul Ingram

A Meta-Analysis of the Personality Assessment Inventory (PAI)

Overreporting Scales: An Update

Tristan Herring, Arianna Albertorio, Hunter Gideon, and Paul Ingram

 Fostering Therapeutic Change through the Early Memory Procedure: An Attachment Perspective [1.5 CEs]

Location: Harbor

Chair: Serena Messina

Discussant: Raja David

Why Have I Always Wanted to be Dead?

Dianne Santas

Why Do I Feel So Confused About My Relationship with my Husband? Is it Just My Brain Fog?

Pamela Schaber

  Impact of Interpersonal Trauma on Social Relating and Death Awareness in Diverse Populations of Children and Adult Survivors [1.5 CEs]

Location: Del Mar

Chair: Kate Szymanski

Impact of Childhood Physical Abuse and Insecure Attachments on Reflective Functioning in Indian Immigrant Mothers

Pavithra Viswanath and Kate Szymanski

Intergenerational Trauma - Father's Traumatization and Child's Wellbeing

Chrystal Marte, Kate Szymanski, Carolyn Springer, Shira Spiel

Relationship Between Executive Functioning and Implicit Assessment of Aggression in an Inpatient Sample of Children and Adolescents with Trauma History

Mackenzie Wild, Kate Szymanski, and Carolyn Springer

Is Individual Trauma History a Risk Factor for COVID-19 Death Anxiety?

Micah Zylstra and Kate Szymanski

Neurodiversity Affirmative Shifts in Conceptualization, Language, and Interpretation with the Wartegg: Preliminary Research & Case Application [1.5 CEs]

Location: Plaza C

Chair: Jacob Palm

Shifting from Pathology-Centered to Affirming Approaches in Assessment with Neurodivergent Populations

Kristin Gremban

Preliminary Research and Trends of CWS Indices in Neurodivergent Affirming Assessments

Angela Marx

Case Presentation & Specific Trends: Application of the CWS through a Neurodiversity Affirmative Lens in a High Masking Autistic Adult

Ori Elis

Case Presentation & Specific Trends: Application of the CWS through a Neurodiversity Affirmative Lens in a Neurodivergent Emerging Adult in the Long-Term Care System

Hannah Johnson

 Open the Pod Bay Door, HAL: The Example of the Social Cognitions and Object Relations Scales for Developing AI-Based Applications for Complex Assessment Procedures [1.5 CEs]

Location: La Jolla

Chair: Barry Dauphin

Discussant: Jennelle Slavin-Mulford

Just What Do You Think You're Doing, Dave?

Barry Dauphin and Caleb Siefert

Two Intelligences are Better Than One: Comparison of Human and AI Ratings for the SCORS-G

Caleb Siefert and Barry Dauphin

Artificial Intelligence (AI) and the Psychological Assessment Process: Benefits and Caveats in Applying AI to Clinical Narratives Using the SCORS-G

Michelle Stein, Shangyun Zhou, and Phyu Pannu Khin

It Takes a Village to Raise an AI: A Systematic, Multi-Disciplinary Research Agenda for Developing a Narrative Rating Application

Caleb Siefert, Barry Dauphin, Areen Alsaied, and Abdallah Chehade

 Shaping the Future of Personality Assessment [1.5 CEs]

Location: California Ballroom

Coordinators: Scott Schwartz and Adam Natoli

Andrew Wright, Abby Mulay, Jen Ying Zhen Ang, and Jan Kamphuis

Transdiagnostic Instruments Integrated Paper Session

Location: Plaza A

Deriving Transdiagnostic Scales from the Joint PAI and SPECTRA Factor Structure: A Demonstration

Mark Blais

Trans-model Assessment of Personality Dysfunction Using the Self and Interpersonal Functioning Scale- Expanded Version

Alexandre Cote, Phillippe Leclerc, Claudia Savard, and Dominick Gamache

The DSM-5 Cross-Cutting Symptom Measure as a Transdiagnostic Outcomes Monitoring Tool

Sara Lowmaster, Daniel Antonius, Jeffrey Anker, Annemarie Mikowski, Alex Cogswell, Sevie Kandefer, Beth Smith, and Stephen Dubovsky

 Use of the R-PAS in Forensic Assessments in Murder Cases [1.5 CEs]

Location: Santa Fe

Chair: Reneau Kennedy

Use of the R-PAS in Forensic Assessments in Murder Cases

Kenedy Ramos

Forensic Assessment Applications of R-PAS in Murder Cases

Abraham Loebenstein, Madeleine Starin, Kenedy Ramos

Use of the R-PAS in Forensic Assessments in Murder Cases

Madeleine Starin

Friday, March 15th

8:00 am -
9:30 am

 Annual Update on Experimental and Neurophysiological Rorschach Research [1.5 CEs]

Location: Balboa

Chair: Luciano Giromini

Time Course of Eye-Tracking Indices Across the Rorschach Cards

Alicia Villanueva Van Den Hurk, Selena Fadhil, Mindee Juve, Mellisa Boyle, Ellen Day, Barry Dauphin, and Harold Greene

Temporal Consistency for Eye-Tracking Measures during Rorschach

Administration: A Cross-Cultural Investigation

Shichie Kuribayashi, Sean Yang, Bennett Addy, Sally Yuju Chou, Barry Dauphin, and Harold Greene

Discriminating Feigned from Authentic Depressive Symptoms using R-PAS Variables and Speech Analysis

Angelica Ferraris, Francesca Ales, Marzia Di Girolamo, Luciano Giromini, and Agata Ando

Study of the Relationship Between Color Responses and Affective Functions in the Rorschach Test Using Transcranial Magnetic Stimulation (TMS)

Martina Camelio, Chiara Conti, Paolo Capotosto, Roberta Lanzara, and Peiro Porcelli

 Assessment in Diverse Populations

 Location: Del Mar

Hostile Masculinity: A Unique Predictor of Sexual Violence Perpetration in LGBTQ+ Individuals Beyond PID-5 Domains

Alexa Callahan, Tiffany Russell, and Jared Ruchensky

Is Attachment Theory a Western Invention? Assessing Attachment from a Culturally Sensitive Lens

Serena Messina

Personality Pathology and Experiences of Marginalization Amongst Sexual Minority Undergraduates

Sarah Hernandez and Jared Ruchensky

The Structure and Correlates of the Narcissistic Admiration and Rivalry Questionnaire Among U.S. Racial/Ethnic Groups

Edward Chou, Linh Nguyen, Dulce Wilkinson Westberg, and Moin Syed

★ [1.5 CEs] **Barriers to Ethical and Effective Mental Health Care in Criminal Justice Settings: Anticipating and Managing Issues in the Practice of Assessment**

Location: California Ballroom

Coordinator: Jacy Murdock

Ksera Dyette, Emily Gottfried, Sierra Iwanicki, Abby Mulay, and Adam Natoli

MMPI-3 in Practice

Location: Coronado

MMPI-3 Assessment of Externalizing Psychopathology in a Targeted Community Sample

Martin Sellbom

Treatment Engagement and Therapy Outcomes: Use of the MMPI-3 in a telehealth Training Clinic

Brian Cole and Paul Ingram

Deriving and Validating Models of Externalizing Psychopathology Using the MMPI-3

Searching for a General Psychopathology Factor with the MMPI-3

Megan Whitman, Martin Sellbom, Dustin Wygant, and Yossef Ben-Porath
Jacob Brown, Martin Sellbom, and Yossef Ben-Porath

■ **Novel Applications and Developments of the Social Cognition and Object Relations Scale-Global Rating Method (SCORS-G) [1.5 CEs]**

Location: Harbor

Chair: Michelle Stein

Every Story has Two Sides: Characterizing Interpersonal Memories Across Attachment Status Using the SCORS-G and Self-Other Narrative Evaluation Scales

Caleb Siefert, Allie Dolby, and Joshua Slater

Differences in SCORS-G Factor Structure and Nomological Networks Across TAT Cards

Comparing the SCORS-G and LIWC-22 Measures as Applied to TAT Narratives for Patients in a Residential Treatment Setting

Jeremy Ridenour, Evan Good, Katie Lewis, and Kyle Minor

Defensive Functioning and the SCORS-G as Predictors of Hierarchical Levels of Personality Functioning and Psychopathology

Laura Richardson, John Porcerelli, Michelle Stein, Jennelle Slavin-Mulford, Christina Massey, Brynn Huguener, Shangyun Zhou, Kelsey Hobbs-Matteson, Phyu Pannu Khin, and Mark Blais

★ **Spinning Straw into Gold: What Transforms Teaching Psychological Assessment from the Ordinary to the Extraordinary [1.5 CEs]**

Location: Santa Fe

Coordinator: Sarah Hedlund

Helen DeVinney, Katherine Marshall Woods, Han Yu, Hannah Goldstein, and Harsh Taneja

□ **Truth be Told: How Feedback Using the AAP Resonates with Client's Lived Experiences [1.5 CEs]**

Location: La Jolla

Chair: Carol George

Discussant: Melissa Lehmann

Using AAP Stories as a Tool for Feedback in a 20-year Old College Student with OCD

Mariam King

Using the Adult Attachment Projective with Couples: How Shared Understandings of Attachment Status Helps Couples Build Connection

Stephen Seger

Repairing Abuse: Reclaiming the Lost Self

Edward Jenny

2:00 pm -
3:30 pm

★ **Assessing Negative Response Bias Using Self-Report Measures: Current Trends and Future Directions [1.5 CEs]**

Location: Del Mar

Chair: Luciano Giromini

Generalizability of Response Styles Across the MMPI-3 and Concurrently Administered Tests in a Sample of Disability Claimants

Kaci Holmes, Megan Whitman, Roger Gervais, and Yossef Ben-Porath

Symptom Exaggeration Versus Fabrication: NSI/mBIAS, SIMS, and PCL-5

Robert Shura

The Inventory of Problems - 29 (IOP-29) and its Additional (Optional) Memory Module (IOP-M): A Research Update

Donald Viglione and Luciano Giromini

Evaluating the Pro-Rated MMPI-3 Over-Reporting Scales in Active-Duty Personnel

Paul Ingram, Patrick Armistead-Jehle, William Menton, and Yossef Ben-Porath

□ **Hierarchical Perspectives**

Location: La Jolla



Structural Validity of the HiTOP Self-Report Measure in Community, Patient, and Student Samples

Leonard Simms

Manifestations of Psychopathology Across Different Hierarchical Levels and Dimensions in Daily Life

Julianne Wu and Michael Roche

Mapping the MMPI-A-RF onto the Hierarchical Taxonomy of Psychopathology in a Sample of Justice Involved Youth

Tayla Lee, Colette Delawalla, Megan Keen, Mattea Parker, Molly Armstrong, and Janay B. Sander

On the Matter of Severity: Self-Report and Performance Measures on Psychopathology [1.5 CEs]

Location: Coronado

Using the Rorschach to Assess Severe Psychopathology: Investigating New Weights for the Disordered Thinking Variable

Ruam Pimentel, Giselle Pianowski, Gregory Meyer, and Joni Mihura

Data on the Validity of the Rorschach SC-Comp to Identify Suicide Risk

Giselle Pianowski, Ruam Pimentel, and Gregory Meyer

Development of the Full and Short Versions of the Suicide Indicator for the Dimensional Clinical Personality Inventory 2

Lucas de Francisco Carvalho, Ricardo Primi, Gisele Magaroto Machado, and Walter L. Leite

PAS and PAS-O: Psychometric Properties of the Brazilian Versions and an Investigation of the Moderating Effect of the Observers' Sex and Relationship with the Examinee

Gisele Magaroto Machado, Lucas de Francisco Carvalho, and Gisele Pianowski

Personality Assessment in Health and Sports

Location: Plaza A

Affective Changes Related to Binge Eating and Borderline Personality Traits

Katherine Hein, Shakur Dennis, Logan Folger, Isaac Ewers, Emily Files, Angelique Robinson, and Stephanie Mullins-Sweatt

Using the Millon Behavioral Medicine Diagnostic (MBMD) in Supporting Treatment Planning for NeuroGI Patients

Leila Wu, Lorna Chiu, and Robert Riddell

The Personality Profile of Elite Athletes Including Big Wave Surfers and Major League Baseball Players Using the Five Factor Inventory

Ronald Stolberg, Christian Glasgow, and R. Casey Aguinaldo

Patient Psychopathology and Physicians' Emotional Reactions to Primary Care Patients Predict Doctor-Patient Relationship

Khrystyna Melnyk, John Porcerelli, and Barry Dauphin

Perspectives on Psychopathology

Location: Plaza C

Expression of Maladaptive Emotional Endophenotypes and Psychopathological Risk: A New Experimental Framework

Enrico Vitolo, Agata Ando, and Alessandro Zennaro

Environmental Sensitivity, Emotional Systems, and Seasonality: An Experimental Study from an Evolutionary Perspective

Agata Ando, Francesca Ales, Enrico Pontefice, Claudia Pignolo, and Alessandro Zennaro

C.W.S. (Crisi Wartegg System) and Early Psychosis

Alessandro Crisi

★ Therapeutic Assessment in the Wild: (Trying To) Put Theory Into Practice [1.5 CEs]

Location: California Ballroom

Sara Boilen, Ori Elis, Caroline Lee, Anna Sapozhnikova, Sarvenaz Sepehri, Katherine Thomas, Elizabeth Winston

 What Do You Consider When Planning a Test Battery? An Investigation of Factors Impacting Test Completion Time [1.5 CEs]

Location: Santa Fe

Chair: Adam Natoli

Discussant: Sierra Iwanicki

Variations in Test Completion of the Personality Assessment Inventory (PAI) as a Factor of Psychopathology and Other Individual Differences

Adam Natoli

Using the HITOP Framework to Evaluate Relationships between Psychological Symptoms and Variability in Self-Report Test Completion Time

Sarah Birkenholz

Clarifying Relationships between Defense Mechanisms and Variability in Self-Report Test Completion Time

Tyler Barnes

Self-Report Completion Time Variance: Contributions of Individuals' Knowledge of and Attitudes Toward Mental Illness and Mental Health Services

Shelby Farmer

Saturday, March 16th

9:00 am -
10:30 am

 An Exploration of Informant Characteristics Associated with Bias on Informant-Report Measures of Personality [1.5 CEs]

Location: Harbor

Discussant: Adam Natoli

Role of Informants' Subjective Well-Being in Evaluative Bias: Effects on Informant-Report Measures of Personality

Lauren Allen

Associations between Perceiver Bias on Informant-Report Personality Measures and the Informant's Knowledge of and Personal Attributes Toward Mental Illness

Paige MacQueen

The Contribution of Personality Functioning Impairment to Evaluative Bias on Informant-Report Measures of Personality

John Cromb

Personality Traits' Influences on Informants' Ratings of Personality: Comparisons of Evaluative Bias between Normal and Maladaptive Traits

Saniyya Rahman

 Assessing Stress and Trauma with the MMPI-3 Integrated Papers

Location: Del Mar

Assessment of Trauma Symptoms with the MMPI-3 in a Sample of Post-9/11 Veterans

Jaime Anderson and Dustin Wygant



Assessing Post-Traumatic Stress Symptoms with the Minnesota Multiphasic Personality Assessment Inventory-3 Amongst Sexual and Gender Minority: Importance of Minority Stress Factors

Cole Morris and Paul Ingram



The MMPI-3 Score Patterns of Sex-Trafficked Women

Edleen De Jesus-Sanchez and Radhika Krishnamurthy

Assessment in Forensic Settings

Location: Coronado

A Comparison of Defensiveness in MMPI-2-RF Profiles of Male Sex Offenders and Child Custody Litigants

Kyla Jones and Radhika Krishnamurthy

An Empirical Evaluation of Within-Normal-Limits MMPI-2-RF Profiles of Sex Offenders

Ilona Likhtman and Radhika Krishnamurthy

Applying the SPECTRA: Indices of Psychopathology in Parental Fitness Evaluations: Acceptability and Utility

Mariah Laster, David Brandwein, and Mark Blais



Failure Rates of Personality Assessment Inventory (PAI) and Inventory of Problems (IOP) Validity Scales in Various Clinical and Forensic Samples from Italy

Oliviero Dona, Marta Montaldo, Daniela De Luca, Sharon Carfora Lettieri, Silvana Lerda, Luciano Giromini



“How Do I Exist in This World? Do I have to Die?” Drawing from Client Belief Systems in the Assessment Intervention [1.5 CEs]

Location: Plaza C

Chair: Anna Sapozhnikova

How Do I Exist in this World? Do I have to Die? Drawing from Client Belief Systems in the Assessment Intervention

Ori Elis

Experimental and Neurophysiological Research Part 2 [1.5 CEs]

Location: Plaza A

Chair: Gregory Meyer

The Association of R-PAS V-Comp Scores to Eye-Tracking and Electrodermal Indexes of Vigilance: An Archival Study

Luciano Giromini

R-PAS and Self-Report Indicators of Perception and Thinking Problems are Associated with Different Aspects of Attention: An Eye-Tracking Study

Barry Dauphin, Harold Greene, Mindee Juve, Mellisa Boyle, and Ellen Day

Examining the Influence of Feigning and Malingering on Rorschach Responses: A Meta-Analysis

Ruam Pimentel and Gregory Meyer

The Contributions of R-PAS to Assessing Adolescents with Suicidal Ideation and Behaviors

Marzia Di Girolamo, Roberta Invernizzi, Marika Orlandi, Alessandro Lorenzoni, Martina Mensi

Instrument Selection in Clinical Personality Assessment [1.5 CEs]

Location: California Ballroom

Chair: Alina Kopetzki

Discussant: Christopher Hopwood

Approach 1

Mark Blais

Approach 2

Hilde De Saeger

Approach 3
Stephen Finn
Approach 4
Katie Lewis

 **SPAGS Presents: The Empowered Path- Shaping the Future of Psychology Careers [1.5 CEs]**

Location: La Jolla

Coordinators: A. Esin Asan and Kelci Davis
Hilary DeShong, Nicole Cain, Ksera Dyette, Sierra Iwanicki, Abby Mulay,
Sharon Nelson

 **The Real-World Value of Psychological Assessment for Predicting Treatment Engagement and Outcomes [1.5 CEs]**

Location: Sante Fe

Discussant: Paul Arbisi
Prediction of Engagement in Combined Trauma-Focused and Dialectical Behavior Therapy Using the MMPI-2-RF
Craig Marquardt
MMPI-3 Predictors of Treatment Dropout and Clinician Rated Therapy Outcome
William Menton
Associations Between Personality Psychopathology-Five (PSY-5) Trait Dimensions and Pain Outcomes Among Primary Care Patients
Hannah Asis

1:30 pm -
3:00 pm

Alternative Model of Personality Disorders Papers

Location: Plaza A

Personality Disorder Types from the Alternative Model for DSM-5 Personality Disorders: Documenting Prevalence and Correlates in Private Practice Clients
Dominick Gamache, Phillippe Leclerc, Alexandre Cote, Mèlissa Deschenes, Annie Leroux, and Claudia Savard
Examining the Alternative Model for Personality Disorders with Suicide Attempts, Psychiatric Admissions, ER Visits, and Diagnoses in an Inpatient Psychiatric Sample
Courtney Mason, Darren Garcia, and Albert Poje
Multimethod Assessment of Personality Functioning: Predicting Clinical Constructs
Kelsey Hobbs, Michelle Stein, and Mark Blais

 **Epistemic Trust in Therapeutic Assessment: Walking a Tightrope with Our Clients [1.5 CEs]**

Location: Sante Fe

Discussant: Jan Kamphuis
Evolution of ET in TA with an Adolescent: A Balance in Between Five Persons
Inge Van Laer
Epistemic Trust and Performance Based in Tests in TA: How Transparency Helps the Client Integrate Test Findings
Maartje Hermans

Initial Explorations of the Psychophysiological Processes Engaged by Individuals During Multimethod Assessment [1.5 CEs]

Location: La Jolla

Chair: Adam Natoli

Multimethod Assessment's Activation of the Cardiovascular System:
Variability within and Between Different Methods of Measurement

Lauren Allen

Multimethod Assessment's Activation of the Respiratory System: Variability
within and Between Different Methods of Measurement

Brooklyn Lesure

Multimethod Assessment's Activation of the Sympathetic Nervous System:
Variability within and Between Different Methods of Measurement

Payton Scalf

Interpersonal Cycles of Borderline Personality Disorder in Daily Life [1.5 CEs]

Location: Harbor

Chair: Kevin Meehan

Discussant: Aaron Pincus

Affective-Interpersonal Signatures in Borderline Personality Disorder

Kevin Meehan

Personality Organization as a Moderator of Daily Interpersonal Behavior

Nicole Cain

Interpersonal Behaviors in the Daily Life of a Patient with BPD

Audrey Stephenson

PAI-A Papers

Location: Plaza C

Anger Rumination is a Unique Factor in Links Between Emotion
Regulation, Borderline Traits, and Aggression Among At-Risk Adolescents

Chloe O'Dell, Cameron Robins, Marley Mixon, Nora Charles, and Chris Barry

Characterizing Adolescent Gang Members: PAI-A Scores and Backgrounds of
Gang-Involved vs. Unaffiliated Youth in Juvenile Detention

Nora Charles, Cassidy Tennity, and Paula Floyd

Psychometric Properties of the Personality Assessment Inventory-
Adolescent in a Sample of Court-Involved African American Youth

Gizelle Car

Psychopathology Papers

Location: Coronado

Navigating a World of Enemies: The Impact of Personality Pathology
Functioning in Paranoid Presentations

Erika Fanti, Marco Di Sarno, and Rossella Di Pierro

Personality Disorders, Attachment, and Social Cognition

Niharika Parashar, Ana Kellermann, Randolph Arnau, and Bradley Green

Do the MMPI-3 Interpersonal Functioning Scales Increment the PSY-5
Scales in the Prediction of Personality Disorder Dimensions?

Keefe Maccarone and Yossef Ben-Porath

 **The Broken Glass Syndrome and its Recovery: Preliminary Findings from the Rorschach and Self Reports [1.5 CEs]**

Location: Del Mar

Chair: Patrick Fontan

CS-R Indicators of Identity, Self-Image and the Broken Glass Syndrome in an Adolescent Inpatient Samples

David Pogge, and Patrick Fontan

The Broken Glass Syndrome as a Response to Trauma in a Non-Binary Individual Raised in a Religious Cult

Kari Carstairs

The Search for the Re-Composition of a Destroyed Face

Maria Gazale

Healing the Brokenness: A Two Years Therapeutic Process

Noriko Nakamura

4:00 pm -
5:30 pm

 **Culture in Assessment from a Client's Perspective: Understanding Client Experiences with the Wright-Constantine Structured Cultural Interview (WCSCI) [1.5 CEs]**

 **Location: Del Mar**

Chair: Andrew Wright

Discussant: Hadas Pade

Understanding Client Experiences with the Wright-Constantine Structured Cultural Interview (WCSCI)

Jen Ying Zhen Ang

Understanding Client Experiences with the Wright-Constantine Structure Cultural Interview (WCSCI)

Aakriti Prasai

Using the WCSCI in Clinical Practice: Reflections from a Client Interaction

Brittany Matthews

Culture in Assessment from a Client's Perspective: Understanding Client Experiences with the Wright-Constantine Structured Cultural Interview

Aakriti Prasai

 **MMPI-A Papers**
Location: Harbor

Utility of the MMPI-A-RF in Assessing Risk of Violent Behavior in Adolescents

Ashley Kane

Psychological and Behavioral Characterization of Adolescents with Suicidal Ideation or Behaviors Investigated Using Minnesota Multiphasic Personality Inventory - Adolescent

Marika Orlandi, Anna Caushi, Marzia Di Girolamo, Roberta Invernizzi, and Martina Mensi

An Investigation of the MMPI-A-RF Validity Scales

Molly Armstrong, Mattea Parker, Danielle Burchett, Janay Sander, and Tayla Lee

Psychoanalytic Papers

Location: Coronado

Pregnant Mothers' Object Relations Predict Toddler Attachment and Behavior Problems

Kathryn Forche, John Porcerelli, Carrie Nantais, and Alissa Huth-Bocks

The Role of Object Relations in the Physician-Patient Relationships in Primary Care

John Porcerelli, Laura Richardson, and Steven Huprich

Assessing Defense Mechanisms of TAT Stories from the Harvard Grant Study

Laura Richardson



Psychological Assessment in the Psychiatric Inpatient Setting [1.5 CEs]



Location: La Jolla

Coordinator: Connor Adams

Connor Adams, Alex Smith, Zeynep Sen, Flora Ma, and Kelley Bloomer

Socially Desirable Responding Integrated Papers

Location: Plaza C

Detecting Positive Response Bias with the PAI: A Comparison of Proctored Remote and In-Person Administrations

Claudia Pignolo, Alessandro Lorenzoni, Marzia Di Girolamo, Alessandro Zennaro, and Luciano Giromini

Empathy Scores in Dark Personalities: The Effect of Positive Response Style

Marzia Di Girolamo, Alessandro Lorenzoni, Andrea Corgiat Loia, Enrico Vitolo, and Alessandro Zennaro

An Integrated Machine Learning Model Considering T-Scores, Response Time, Kinematic Indicators, and Eye Movements in Identifying Socially Desirable Responding

Cristina Mazza, Irene Ceccato, Loreta Cannito, Merylin Monaro, Eleonora Ricci, Emanuela Bartolini, Marco Colasanti, Silvia Biondi, Francesca Bosco, Adolfo Di Crosta, Matteo Cardaioli, Alessandra Cardinale, Pasquale La Malva, Rocco Palumbo, Luciano Giromini, Riccardo Palumbo, Alberto Di Domenico, and Paolo Roma

Socially Desirable Responding: New Insights for Psychological Assessment

Eleonora Ricci, Francesca Bosco, Marco Colasanti, Silvia Biondi, Cristina Mazza, and Paolo Roma

The Use of "Adult Attachment Projective Picture System (AAP)" in Clinical Encounter with Parents of Children and Adolescents [1.5 CEs]

Location: Plaza A

Discussant: Carol George

Parenting and Attachment

Adriana Lis

Adult Attachment Projective Picture System is the Main Tool for Attachment Assessment

Daniela Di Riso, Irene Severi, and Elisa Delvecchio

Why Use the AAP to Assess Parents' Attachment Patterns of a Boy Referred for Obesity and ADHD?

Maria Mirandi, Livia Buratta, and Claudia Mazzeschi

Utilizing the Adult Attachment Projective to Facilitate Family Change in High-Conflict Families
Carlo Vetere

 Using the Consensus Rorschach in Ultra-Brief Therapeutic Assessment with Couples [1.5 CEs]

Location: Santa Fe

Chair: Stephen Finn



Warriors Fighting Against Their Ally
Noriko Nakamura

Using the Consensus Rorschach to Increase Awareness in a Couple
Filippo Aschieri

Monsters and Fish: Using the Consensus Rorschach to Interrupt a Rational/Emotional Split in a Couple
Stephen Finn

SPA IS PARTNERING WITH THE
UNIVERSITY OF MINNESOTA
PRESS TO BRING YOU THE

MMPI WORKSHOPS & SYMPOSIUM

WWW.PERSONALITY.ORG

JUNE 12 - 15
TEMPE, AZ

Poster Presentations

Thursday, March 14th

6:30 pm -
7:30 pm

Location: San Diego Ballroom

“Did You Hear My Covert Narcissism I Disguise as Altruism?”: An AMPD Interrater Reliability Study Using Taylor Swift’s Song Lyrics
Savannah Diggett, Sophie Daly, Saffron Jones, Bella Draganov, Emily Gottfried, Nicole Cain, Alyssa Medenblik, Adam Natoli, Sharon Nelson, Mark Waugh, and Abby Mulay



A Comparison of Online Versus In-Person Thematic Apperception Test (TAT) Administration Method on Narrative Length and Story Richness as Measured by the Social Cognition and Object Relations Scale-Global Rating Method (SCORS-G)
Jenelle Slavin-Mulford and Elyse Vincent

A Study of Predictive Utility Between the PCL-YV and PCL-R
Darlene Ngo



A Training Model in Anti-Racist Psychological Assessment: A Collaborative and Therapeutic Assessment Approach
Tomoko Miwa

Adulthood Defensive Functioning and Adverse Childhood Experiences of Maltreatment and Household Dysfunction
Olivia Nelson, Kenneth Montemayor, Trisha Zimmerman Tanis, Theresa Wyatt, Khrystyna Melnyk, and John Porcerelli

An Investigation of the Link Between Childhood Risk Factors of Borderline Personality Disorder and Thought Control Strategies
Yasmine Griffin and Hilary DeShong

Applying Continuous Assessment of Interpersonal Dynamics to Clinical Training
Alexandra Halberstadt, A. Esin Asan, and Aaron Pincus

Assessing Psychopathology Overreporting in Adolescents Using the MMPI-A-RF
Jazmin Morales, Megan Keen, Tina Greene, Ashlinn Peters, Victoria Dennis, Derek Morgan, Adam Schmidt, Christy Rogers, and Paul Ingram

Associations Between Post Traumatic Growth and Psychopathology
Kelsey Priebe, Nicole Shumaker, Dustin Wygant, and Jaime Anderson



Associations Between Psychopathology and Personality Disorders in a Latinx Population
Julie Anne Miller, Andy Torres, Alfonso Mercado, and Jaime Anderson

Basic Personality Traits in College Students Before and After the COVID-19 Lockdown

Nadia DiNatale, Tia Nicolas, Annalise Jear, and John Kurtz

Beyond Clutter: Exploring the Evolutionary Roots of Dispositional and Motivational Structures in Hoarding Disorder

Lorenzo Brienza, Alessandro Zennaro, Enrico Vitolo, and Agata Ando

Differences in Personality Pathology Among Non-Suicidal Self-Injury and Suicidal Behavior Patterns: A Latent Class Analysis

Rachel Chavin and Sara Lowmaster

Evaluating the Applicability of the PAI's Level of Care Index (LOCI) for the Personality Assessment Inventory-Adolescent (PAI-A)

Lauren Kennedy, Nora Charles, Corey Leidenfrost, Daniel Antonius, and Sara Lowmaster



Examining Indicators of Cultural Mistrust on the MMPI-A-RF in a Residential Treatment Sample

Mattea Parker, Molly Armstrong, Janay Sander, and Tayla Lee



Examining the Construct Validity and Reliability of the Five Factor Form as a Measure of General Personality Structure within a Forensic Setting

Shelby Vaughn-Somervell

Examining Validity and PSY-5 Scales of the Minnesota Multiphasic Inventory-2 Restructured Form (MMPI-2-RF) in a Sample Feigning Substance Use Issues in Veterans

Michael Pinover, Ronald Stolberg, Thaddeus Camlin, Bailey Smith, Laura Gabbard, and Aida Javaheri

Exploring Individual Differences in Personality and Sleep-Related Practices

Ryan Krieger, Elizabeth Pantesco, and Irene Kan

Exploring Novel Approaches for Detecting Invalid Responding on the MMPI-A-RF Across Adolescent Feigning and Justice-Involved Youth Samples

Megan Keen, Jazmin Morales, Keegan Diehl, Tine Greene, Ashlinn Peters, Victoria Dennis, Derek Morgan, Adam Schmidt, Christy Rogers, and Paul Ingram

Exploring the Impact of Setting on Assessment Rationale and Collaborative/Therapeutic Assessment Adoption

Sharon Greene, Linda Baum, and Catherine Hanigan

Exploring the Overlapping Forms of Rumination, Thought Control Strategies, and Impulsivity Traits Across Psychopathology

Johntavia Toliver, Ashley Magnus, and Hilary DeShong

Hierarchical Structure of Posttraumatic Cognitions and Complex PTSD Symptoms in Survivors of Intimate Partner Violence

Alana Gallagher and Matthew Yalch

Identifying PTSD with the MMPI-2-RF Substantive Scales with Active-Duty (AD) Personnel

Luke Childers and Paul Ingram

Impact of Level of Personality Functioning on Patient-Doctor Relationships in Patients Undergoing Cancer Treatment

Shichie Kuribayashi, SriLasya Reddy, and John Porcerelli

Impulsivity and Changes in Positive and Negative Affect: Assessing the Utility of an in-Lab Mood Induction Rumination Task

William Foster, Robert Jones, Bennett Porter, and Hilary DeShong

Influence of Betrayal Trauma on Schizoid Personality Pathology

Sydney Stone, Kaliegh Newcomb, Margaret Froehlich, and Matthew Yalch

Interpersonal Projection of Right-Wing Authoritarianism

Christine Hujing and Matthew Yalch



Invariance of the Barret Impulsiveness Scale 11 (BIS-11) When Predicting Alcohol and Drug Use in Female and Male College Students

Shelby Farmer, Lauren Allen, Brooklyn Lesure, and Adam Natoli

Investigating the Relationship Between Social Adjustment and the Psychodynamic Diagnostic Manual-2

Julia Dobre and Nicole Cain

Investing the Between- and Within-Person Variance of the Joy of Missing Out (JOMO) Using Ecological Momentary Assessment (EMA)

Mackenzie Murphy, Alex Anderson, and Chris Barry

Juror Perception of the Use of Personality Assessment Data in Expert Psychological Testimony

Amanda Palardy, Mariah Laster, Blanca Garcia, and David Brandwein



Measurements Invariance of Two Alternative Model of Personality Disorders Measures Across Levels of Neighborhood Socioeconomic Status During Childhood

Chloe Rodriguez and Adam Natoli

Meaning Making and Interpersonal Decentering Predicting Non-Acceptance of Romantic Breakups

Prynce Fant

MMPI-2-RF Overreporting Scale Performance in the Detection of Feigned PTSD, mTBI, and Comorbid PTSD + mTBI in a Simulation Study

Efrain Ramirez, Tristan Herring, Cole Morris, Danielle Burchett, and Paul Ingram

My COVID Experience

Tia Nicolas, Hanna Campbell, Natalee Torre, and John Kurtz

Perfectionism and Health Behaviors

Morgan Maples, Claire Clifton, Sara Lowmaster, and Jean Caraway

Personality Assessment Inventory and Therapeutic Alliance Subscales Early In Treatment

Bianca Cersosimo, Mark Hilsenroth, Robert Bornstein, Jerold Gold, and Mark Blais

Pre-Performance Evaluations with Division 1 Student-Athletes: Examining Gender and Team Type Differences on the MMPI-3

Sarah Hirsch, Casandra Orourke, Kaci Holmes, Caleb Wilborn, Paul Ingram, and Tyler Bradstreet

The Association Between Personality and Firearm Access Screening Practices Among Mental Healthcare Providers

Taylor Rodriguez, Mike Anestis, and Joye Anestis

The Effect of Sad Affect Induction on Self-Rated Personality and DSM-5 Section III Personality Pathology

Shakur Dennis, Fredrick Moore, Angelique Robinson, Sara Kopp, Cora Warntjes, and Stephanie Mullins-Sweatt

The Evolutionary Roots of Feigning: The Cheater Strategy and Its Relationship with Deception

Claudia Pignolo, Lorenzo Brienza, Agata Ando, Chiara Rinaldi, Luciano Giromini, and Alessandro Zennaro

Theory of Mind: Performance Tests Predicted by Self-Report

Jabeen Shamji, Jacqueline Miller, and Sharon Rae Jenkins

The Relationship Between Negative Emotional States and Impulsivity Using the DASS-21 and BIS-11

Shayon Tayebi and Craig Henderson

The Relationship Between Suicidal Thoughts and Behaviors and Attachment Style

Anita Batuuure, May Stern, and Nicole Cain



The Role of Personality Pathology on Interpretations of Microaggressions Against Lesbian and Gay Individuals

Monica Paez, Daniella Cash, and Jared Ruchensky

The Role of Social Comparison Orientation on Perfectionistic Concerns and Related Outcomes

Estella Fox, Clare Krzykala, and Jason Rose

Trends in Training Assessment at the Department of Veteran Affairs Internship Sites

Alison Sapp, Hunter Gideon, and Paul Ingram

Understanding the Association Between Normal and Maladaptive Personality Traits: Replication and Extension of Morey et al

Chloe Evans, Leah Emery, Julia Dimitrova, Courtney O'Keefe, and Leonard Simms

Utilizing Infographics to Combat Sleep Myths: Unveiling the Role of Personality

Victoria Martin, Elizabeth Pantesco, and Irene Kan

Validation of an Interview Form of the Comprehensive Assessment of Traits Relevant to Personality Disorder (CAT-PD Interview)

Tyra Jones and Leonard Smith

Validity of the DSM-5 Criterion B Specifiers for the Differential Diagnosis of Borderline and Antisocial Personality Disorders

Derick DeCamp, Emily Pintarelli, Audrey Movsesian, and Julia Kearney

Saturday, March 16th

5:30 pm -
6:30 pm

Location: California Ballroom

A Comparative Analysis on the Personality Assessment Inventory (PAI) Scores of Child Sexual Abuse Survivors and Child Physical Abuse Survivors

Ronald Stolberg, Jordyn Skaggs, Robert Geffner, Bailey Smith, Laura Gabbard, and Brooke Schuman

An Investigation of the Relationship Between Female Rape Myths, Child Sexual Abuse Myths, and Personality Disorders

Anne Nickell, Frederick Coolidge, and Andrew Lac

Clarifying the Moderating Role of Self-Concealment in Self-Other Personality Ratings: Variations Across Different Types of Personality Traits

Brooklyn Lesure, Adam Natoli, and Jared Ruchensky



Clinical Applications of the PID-5 Faceted Brief Form in Sexual Minorities

Hadley McCartin, Tiffany Russell, and Jared Ruchensky



Comparing the Interpersonal Profiles of Different Forms of Impression Management Using the Interpersonal Circumplex

Julianne Wu, Adam Natoli, Jared Ruchensky, and Michael Roche

Connecting the Multidimensional Model of Boldness with the Risky, Impulsive & Self-Destructive Behavior Questionnaire

Daniel Zamora and Jared Ruchensky

Contrasting Patterns of Dependency and Detachment in Community Adults with Schizoid Versus Avoidant Traits

Shannon Thomson and Robert Bornstein

Convergence of the Expanded Levenson Self-Report Psychopathy Scales and the Boldness Inventory

Jacy Murdock, Modica Jimenez, and Jared Ruchensky

Cosmo, the New Collaborative Scoring Method that Redefines the Picture Frustration Study: A Single Case Study Highlighting Therapeutic Potential

Carlo Vetere

Developing the CAT-PD-BF: A Brief DSM-5 and ICD-11 Compatible Measure of Broad Pathological Personality Domains

Leah Emery, Whitney Ringwald, Shereen Khoo, Lee Anna Clark, Yuliya KotenInikova, Matthew Scalco, David Watson, Aidan Wright, and Leonard Simms

Development of a Local MMPI-3 Norm Group from College Students' Learning Disability Assessments

Reuben Philip, David Brandwein, Alison McCann, and Grace del Pino

Disrespect Sensitivity in the Context of Right-Wing Authoritarianism, Maladaptive Personality, and Violence

Hannah Benemann and Tiffany Russell

Does Coaching Improve Feigning? A Comparison Between Symptom- and Test- Coaching

Claudia Pignolo, Angelica Ferraris, Enrico Vitolo, Agata Ando, and Luciano Giromini

Emotional Dysregulation Moderates the Relationship Between Everyday Sadism and Coercive Control in Intimate Relationships

Taylor Johnson and Tiffany Russell

Examining Scoring Strategies for the Level of Personality Functioning Scale Self-Report of Criterion A

Brooke Tompkins, Kendall Fischer, and Michael Roche

Examining the Types of Interpersonal Problems Associated with Personality and Mental Functioning on the PDM-2

Che Harris and Nicole Cain

Examining Validity and Specific Problem Scales of the Minnesota Multiphasic Personality Inventory-2 Restructured Form (MMPI-2-RF) in a Sample Feigning Chronic Pain

Ronald Stolberg, Phillip Johnson, Kimberly Lauro, Andrew Stolberg, Bailey Smith, Aida Javaheri, and Katherine Schneider

Exploring Personality Characteristics and Risk for Recidivism Among Adult Male Sexual Offenders

Kadie Lombardo, Todd Pizitz, Ronald Stolberg, and Nadine Nakamura

How Narcissistic Perfectionism Moderates the Relationship Between Subjective Failure, Grit, and Self-Handicapping

Alvin Nicholas and Steven Huprich

How Trauma Might Affect Responding on Self-Report Measures of Empathy: Examining the Empathy Facet of Two Personality Functioning Impairment Measures

Paige MacQueen, Tyler Stokes-Kujawa, Caroline Carmody, and Adam Natoli

Improving Preemployment Psychological Evaluations for Law Enforcement Officers: Accounting for Context-Specific Variability in Stress and Lethal Force Decision-Making

Jacy Murdock and Adam Natoli

Influence of Personality Traits and Yoga on Anxiety

Emily Barbera, Desheane Newman, and Matthew Yalch

Maladaptive Traits and Opioid Misuse Among Healthcare Providers

Rebekah Nerenberg, Kayleigh Watters, and Matthew Yalch



Narcissism and Prosociality: A Meta-Analysis

Xi Xu and Kristian Markon

Narcissism, the UPPS-P Impulsivity, and Risky Sex: Do Certain Impulsivity Facets Explain the Relationship Between Narcissism and Risky Sex?

Laughlin Aschenbrenner and Hilary DeShong

Patience is a Virtue, But I Don't Have Time: Using AI to Create and Score Narrative Data with the SCORS-G with the Human Touch

Alicia Villanueva van den Hurk, Savanna Coleman, Havilah Ravula, Caleb Seifert, and Barry Dauphin

Perceived Invalidation Predicts Coercive Control Beyond Antagonistic Personality Traits

Taylor Johnson and Tiffany Russell

Predictive Relationship Between Overall Defensive Functioning and Coping Strategies

Kenneth Montemayor, Olivia Nelson, Trisha Zimmerman Tanis, Theresa Wyatt, Khrystyna Melnyk, and John Porcerelli



Psychological Functioning of Adolescents Referred for Gender Dysphoria: An MMPI-A and R-PAS Study

Sharon Carfora Lettieri, Agata Ando, Chiara Baietto, Daniela Bechis, Giulia Di Fini, Di Girolamo Marzia, Sarah Finzi, Luciano Giromini, Luca Guglielmi, Mariateresa Molo, Matteo Tasca, Fabio Veglia, and Benedetto Vitiello



Review of the MMPI-3 Cultural Mistrust Critical Items in Bilingual Spanish/English Speakers

Danna Ramirez, Nicole Shumaker, Andy Torres, Alfonso Mercado, and Jaime Anderson

Self-Other Knowledge Asymmetry for Personality Functions Versus Personality Traits

Emily Pintarelli, Annie Berkowitz, Eli Nuzzo-Dozier, and John Kurtz



Test-Retest Reliability of the Difficulties in Emotion Regulation Scale (Modified) in Student and Intellectual Developmental Disorder Populations

Caroline Carmody, Sarah Birkenholz, Lauren Allen, Stephen Sutter, and Adam Natoli



Test-Retest Reliability of the Modified Personality Inventory for the DSM-5 Brief Form Plus (PID5BF+M) in Student and Intellectual Developmental Disorder Populations

Sarah Birkenholz, Monica Paez, Chloe Rodriguez, Stephen Sutter, and Adam Natoli

The Experience of Resilience and Stress as Related to Personality Traits in College Students During the COVID-19 Pandemic Using the Five Factor Inventory

Meghan Fruth, Ronald Stolberg, Barbod Salimi, Andrew Stolberg, Katherine Schneider, and Brooke Schuman



The Gender Euphoria Scale: Developing a Measure of Transgender and Gender Diverse Euphoria

Kelci Davis, Will Beischel, and Jaime Anderson



The Inventory of Problems-29 is a Cross-Culturally Valid Symptom Validity Test: Initial Validation in a Turkish Community Sample

Ali Akca, Mehmed Tepedelen, Burcu Ulusoy, and Laszlo Erdodi

The Japanese Version of Self-Concept and Identity Measure (SCIM): From the Survey on the Relationship with Identity Dimensions and Sense of Identity of Japanese University Students

Kojun Shibata

The Potential Role of Personality Functioning Impairment in Multimethod Inter-Test Score Relationships

John Cromb and Adam Natoli

The Relationship between the MMPI-2 Validity Scales and the Validity Scales of Parent-Child Relationship Inventory and Parenting Stress Index Among Child Custody Litigants

Stephanie Judy, Ronald Stolberg, Robert Geffner, Aida Javaheri, and Laura Gabbard

The Relationship Between TriPM and Self-Report and Interview-Rated Measures of Section III Antisocial Personality Disorder Traits

Peggah Khalili-Tari, Jaime Anderson, and Jared Ruchensky

To What Extent Does the Alternative Model for Personality Disorders Capture Romantic Attachment?

Claudia Savard, Mélissa Deschênes, Charlotte Bouchard-Asselin, and Dominik Gamache

Typologies of Aggression and Anger and its Association with Trauma

Meghri Sarkissian and Matthew Yalch

Using the PDM-2 as a Measurement of Treatment Outcomes in a Sample of Patients Diagnosed with Borderline Personality Disorder

Julia Solomon and Nicole Cain

Variability in Response Scale Interpretation and its Impact on Personality
Test Validity

Vanessa Crofford, Saniyya Rahman, Julianne Wu, and Adam Natoli



2025 SPA Convention Denver, CO

March 26 - 30, 2025

Sheraton Denver Downtown Hotel

More information coming soon!

Awards

The Society is dedicated to the development of methods of personality assessment, the advancement of research on their effectiveness, and the exchange of ideas about the theory and practice of assessment.

Bruno Klopfer and a group of his students founded the Society for Personality Assessment (SPA) in Essex County, New Jersey. The Society is a collegial organization dedicated to the advancement of professional personality assessment, to the development of procedures and concepts for personality assessment and to the ethical and responsible use of these techniques.

Initially incorporated as the Rorschach Institute, Inc., in 1938, the organization was renamed the Society for Personality Assessment in 1971 to reflect the Society's interest in the entire spectrum of issues present in contemporary personality assessment and to focus the Society as a special interest group, concerned with promoting the exchange of ideas and information about personality assessment in research and practice.

The Society organizes and conducts an Annual Convention as partial fulfillment of the incorporator's objective "to provide an annual assembly of sharing research findings and clinical experiences". In addition, the Society publishes the Journal of Personality Assessment and a newsletter, the SPA Exchange. The following awards are presented by the Society:

The **BRUNO KLOPFER MEMORIAL AWARD** is given for outstanding, long-term professional contribution to the field of personality assessment. The recipient gives an acceptance presentation.

The **JOHN E. EXNER SCHOLAR AWARD** honors the memory of John E. Exner, Ph.D., a pioneer in personality assessment, by supporting the research of a young personality assessor. Dr. Exner was committed to advancing the science of personality assessment by empirical research in the development and application of assessment instruments. This award honors that commitment by recognizing and supporting a young investigator examining any method of personality assessment.

The **JOHN R. GRAHAM AWARD FOR DISTINGUISHED MENTORSHIP IN PERSONALITY ASSESSMENT** is given to individuals who have fostered excellence in the field of personality assessment by their mentorship of students and junior colleagues. Excellence in mentorship is reflected in the quantity of their mentees, its direct impact on their careers, including the quality of their accomplishments in personality assessment. The mentor's influence on the next generation may be evident through training programs, research supervision, and/or clinical training.

The **SAMUEL J. and ANNE G. BECK AWARD** is given for outstanding early career research in the field of personality assessment. The award is presented in conjunction with the University of Chicago. The recipient gives an acceptance presentation.

The **SPA MID-CAREER SCHOLAR AWARD** is bestowed annually for outstanding mid-career impact and scholarship in the field of personality assessment. The award honors scholars who are 15-25 years beyond their graduate degree and whose work has contributed substantially to the body of knowledge to the field of personality assessment and psychological test development.

The **WALTER G. KLOPFER AWARD** is bestowed annually by the Society for Personality Assessment for distinguished contribution to the literature in personality assessment. Eligible contributions focus on statistically based research projects. The Journal for Personality Assessment Editor invites

all Consulting Editors to nominate outstanding articles from the previous year, each of which is then rated by the Editor and Associate Editors. In the event of a tie, two awards may be given.

The **MARTIN MAYMAN AWARD** is bestowed annually by the Society for Personality Assessment for a distinguished contribution to the literature in personality assessment. Eligible contributions may consist of an outstanding case study, qualitative research project, or theoretical development. The JPA Editor invites all Consulting Editors to nominate outstanding articles from the previous year, each of which is then rated by the Editor and Associate Editors. In the event of a tie, two awards may be given.

The **MARGUERITE R. HERTZ MEMORIAL** is a tribute to Dr. Hertz for her long-term professional contributions to personality assessment. The memorial is presented by a distinguished member of the Society in honor of a deceased eminence from the field of personality assessment. At times, the presenter also invites other members to join in relating anecdotes of their personal contact with the honoree.

The **MARY S. CERNEY STUDENT AWARD** is awarded to the best personality assessment research paper submitted by a student. This award carries a small stipend to help defray the cost of attending the Annual Convention.

The **DISTINGUISHED SERVICE AND CONTRIBUTION TO PERSONALITY ASSESSMENT AWARD** honors individuals promoting personality assessment through excellence in teaching, outreach, advocacy, or practice. Recipients are those whose work has made a meaningful contribution to the practice of personality assessment by way of direct service, policy development and implementation, innovation, teaching, training, professional publications, leadership, or advocacy for the profession.

Bruno Klopfer Memorial Award



Dr. Gregory J. Meyer

Gregory J. Meyer, Ph.D., is a Professor of Psychology at the University of Toledo. His research focuses on psychological assessment, with an emphasis on the integration of personality assessment methods and using the Rorschach as a measure of psychological processes grounded in behavioral performance. He has more than 95 peer-reviewed publications and an h-index of 52. He has received Distinguished Contribution Awards for specific articles and general contributions to assessment and he served as the Editor of the Journal of Personality Assessment for 11 years. He is a Fellow of the American Psychological Association (Division 5) and of the Society for Personality Assessment. In addition to co-authoring the manual for the Rorschach Performance Assessment System, he co-edited a casebook entitled Using the Rorschach Performance Assessment System (R-PAS).

John E. Exner Award



Dr. Adam Natoli

Adam P. Natoli, PhD, is a Ronald E. McNair Scholar and an Assistant Professor in the Department of Psychology and Philosophy at Sam Houston State University. Dr. Natoli is the director of the Multimethod Assessment & Personality Lab (MAPL), where he investigates all aspects of how we measure the things we measure. His program of research focuses on developing, evaluating, and applying advanced measurement and statistical methodologies to the empirical study of human behavior with a concentration on instrument psychometrics, applications of Artificial Intelligence in psychology, personality, psychodynamic principles, and forensic psychology. He is a Licensed Psychologist, teaches numerous courses related to assessment, statistics, and clinical theory and practice. Before moving to Texas to join the faculty at Sam Houston State University, Dr. Natoli coached college ice hockey for close to a decade with the New Jersey Institute of Technology and served as a scout and trainer for the USA Hockey District Development Program. Dr. Natoli still loves ice hockey and enjoys spending time outdoors.

John R. Graham Award for Distinguished Mentorship in Personality Assessment



Dr. Paul Arbisi

Paul A. Arbisi, Ph.D., ABAP, ABPP, L.P. retired in 2023 after 33 years as a staff clinical psychologist at the Minneapolis VA Health Care Center and is currently a Professor in the Departments of Psychiatry and Psychology at the University of Minnesota. Dr. Arbisi has published extensively on the use of the MMPI-2/MMPI-2 RF/MMPI-3 in psychiatric and medical settings as well as in the assessment of trauma related conditions including PTSD. He has co-authored and developed several scales contained on the MMPI instruments including several scales designed to identify non-credible reporting of symptoms. His program of research is broadly focused on exploring the utility of psychological assessment in applied clinical settings including whether integration of trait level personality information into treatment planning can promote treatment engagement and lead to improved clinical outcomes. Further, as an investigator in a series of longitudinal studies of risk and resilience factors in deployed national guard soldiers, his research was focused toward better understanding the contribution of dimensional models of personality and psychopathology in identifying soldiers most likely to weather the challenges of deployment without developing stressor-related psychiatric conditions.

Dr. Arbisi currently maintains an active medico-legal practice specializing in evaluating consequential psychological injuries and trauma related conditions.

Samuel J. and Anne G. Beck Early Career Award



Dr. Katie Lewis

Katie C. Lewis, PhD, serves as the Director of Research at the Austen Riggs Center. Her research examines interpersonal behaviors, personality processes, and suicidal ideation in adult psychiatric patients using experience sampling methodology. Dr. Lewis received a doctorate in clinical psychology from the Brooklyn campus of Long Island University. In the past, she has served as the graduate student representative on the Ethics Board of APA's Division 39 and as an Associate Editor for the Journal of the American Psychoanalytic Association. Her research has been supported by the Robert Wallerstein Fellowship in Psychoanalytic Research, the American Foundation for Suicide Prevention, the National

Institute of Mental Health (NIMH), and the Division 39 Marsha McCary Fund for Psychoanalysis. She has published and presented on a wide range of topics, including suicide and self-harming behaviors, personality psychopathology and assessment, loneliness and social disconnection, and the ethics of confidentiality in clinical writing. She currently serves as a Representative-at-Large and Co-Chair of the CE Committee for the Society for Personality Assessment, and as a Consulting Editor and Section Editor for the Journal of Personality Assessment.

SPA Mid-Career Scholar Award



Dr. Martin Sellbom

Martin Sellbom is a Professor in Clinical Psychology at the University of Otago in Dunedin, New Zealand. He received his Ph.D. in Clinical Psychology in 2007 from Kent State University. His research focuses on psychopathy and other personality disorders, the integration of personality and psychopathology, and personality assessment with the MMPI instruments. Professor Sellbom's work has been featured in over 300 publications with three books, including *Introducing the MMPI-3* (co-authored with Yossef Ben-Porath). He has won several awards, including the American Psychological Foundation's Theodore Millon mid-career award for advancing personality science, American Psychology-Law

Society's Saleem Shah Award and Society for Personality Assessment's Samuel and Anne Beck Award for early career achievement. Professor Sellbom serves as the Editor-in-Chief for the Journal of Personality Assessment. For his clinical practice, he specializes in forensic psychological evaluations.

Walter G. Klopfer Award - Focusing Narrowly on Model Fit in Factor Analysis Can Mask Construct Heterogeneity and Model Misspecification: Applied Demonstrations Across Sample and Assessment Types



Kasey Stanton

Dr. Kasey Stanton is an assistant professor in the Department of Psychology at the University of Wyoming. Dr. Stanton completed his associates degree at Miles Community College and his bachelors degree at Montana State University Billings. Following that, he completed his masters degree and PhD in clinical psychology at the University of Notre Dame. Dr. Stanton's research focuses on measure development, clinical assessment, and personality assessment. He is interested in transdiagnostic, dimensional models of classification and assessment, with an emphasis on externalizing psychopathology, mood, and bipolar spectrum disorder symptoms.



Ashley Watts

Dr. Ashley Watts is an assistant professor at Vanderbilt University in the Department of Psychological Sciences. Dr. Watts received her masters and PhD in Psychology from Emory University. Following that, Dr. Watts completed a postdoctoral fellowship at the University of Missouri, where she was awarded a K99/R00 Pathway to Independence Award from the National Institute on Alcohol Abuse and Alcoholism. Her research focuses on understanding the causes and consequences of psychopathology, with a focus on addiction and quantitative modeling.



Holly Levin-Aspenson

Dr. Holly F. Levin-Aspenson is an assistant professor in the Department of Psychology at the University of North Texas. She completed her PhD in Clinical Psychology at the University of Notre Dame and her postdoctoral fellowship at the Alpert Medical School of Brown University. Dr. Levin-Aspenson's research focuses on clinical assessment and quantitative, dimensional models of psychopathology such as the Hierarchical Taxonomy of Psychopathology. This includes a focus on developing psychometrically-sound and clinically-useful measures for use in different settings. .



Ryan Carpenter

Dr. Ryan Carpenter is an assistant professor in the Department of Psychological Sciences at the University of Missouri-St. Louis. He received his PhD in Clinical Psychology at the University of Missouri-Columbia, which included earning a minor in Psychological Methods and Statistics. Dr. Carpenter then proceeded to complete a postdoctoral fellowship at the Center for Alcohol and Addiction Studies at Brown University. Dr. Carpenter's research uses advanced statistical techniques to better understand behavior, mood, and substance use in everyday life, including using momentary assessment methods such as ecological momentary assessment.



Noah Emery

Dr. Noah N. Emery is an assistant professor in the Department of Psychology at Colorado State University. Dr. Emery completed his PhD at the University of South Dakota in 2018 and proceeded to complete a postdoctoral fellowship at the Center for Alcohol and Addiction Studies at Brown University. His research focuses on identifying mechanisms of behavior change underlying substance use and leveraging this information to improve intervention efforts. Dr. Emery uses advanced quantitative modeling and methods such as ecological momentary assessment to better understand dynamic processes at the momentary level.



Mark Zimmerman

Dr. Mark Zimmerman is the director of South County Psychiatry (North Kingstown, Rhode Island). Dr. Zimmerman completed his undergraduate degree at Columbia University and proceeded to complete his medical degree at the Chicago Medical School. He then completed postgraduate training at the Medical College of Pennsylvania. He is board certified in psychiatry, and he is a professor of psychiatry and human behavior at the Alpert Medical School of Brown University, in addition to his role as South County Psychiatry's director. He has published over 500 articles and book chapters on a wide range of topics, including psychiatric diagnosis and personality disorders, among others. This includes overseeing research for the Rhode Island Methods to Improve Diagnostic Assessment and Services (MIDAS) Project, a clinical research study focused on improving routine clinical care that has been ongoing for more than 25 years.

Mary S. Cerney Student Paper Award - Interpersonal Complementarity and Affect in Daily Life



Alexandra Halberstadt

Alexandra Halberstadt is a fifth year doctoral candidate working with Dr. Aaron Pincus at the Pennsylvania State University. She is interested at connecting personality at multiple timescales, including moment-to-moment, interaction-level, and traits.

Equity, Inclusion, and Social Justice Track

The Society for Personality Assessment is responding to the call for action from our membership to foster equity, inclusion, and social justice in our work as assessment psychologists. Our goal is to encourage work that applies to groups who are not typically represented in assessment research, presentations, and dialogues. This special track will be a home base and a launchpad for infusing the entire conference with energy and momentum towards these goals. Please be prepared to present and/or attend with a curious, positive and non-shaming attitude. All are welcome to participate.

Programs requested will be proposals that include systematically oppressed groups in their study, that extend the application of a test to other populations such as through translation to another language or establishment of new/updated norms, theoretical programs based on assessment with non-dominant groups or proposals that foster discussion of equity, inclusion, and social justice values and issues as they apply to assessment psychology.

Equity means that everyone gets what they need to succeed (Project READY, 2021). Inclusion is reflected in “organizational strategies and practices that promote meaningful social and academic interactions among persons and groups who differ in their experiences, their views, and their traits” (Tienda, 2013, p. 467). Social justice “is the virtue which guides us in creating those organized human interactions we call institutions. In turn, social institutions, when justly organized, provide us with access to what is good for the person, both individually and in our associations with others. Social justice also imposes on each of us a personal responsibility to collaborate with others...[and] to design and continually perfect our institutions as tools for personal and social development” (Center for Economic and Social Justice, 2021).

Sessions that have been indicated as an EISJ Track will be indicated with a ★.

General Information

SPA Interest Groups

Interest Groups provide SPA members an opportunity to interact with other members who are engaged in personality assessment in similar venues. Interest Groups support the mission of SPA by fostering membership around similar interest and facilitate member’s networking and mutual support. The following interest groups are available at this time:

Interactive Interest Group Meeting
Friday, March 15, 2024 | 11:15 am - 12:15 pm
California Ballroom

Education & Training

Co-Chairs: Adam Natoli & Scott Schwartz

The mission of this interest group is to improve the quality of assessment training and supervision in the field of psychology, through improving and disseminating resources, promoting best practices, and advocating for rigor. Members of this interest group include academic and field-based trainers, supervisors, students, and clinicians. Topics addressed include bridging the gap between what is being taught in graduate programs and expectations for internship, licensure, and future practice; how to best assess competency during training; and how to best support those teaching and supervising assessment given the similarities and differences of graduate programs. Finally, the group will also make an effort to increase exposure to personality assessment throughout the psychology education lifespan, from undergraduate through postgraduate settings.

Psychoanalytic Assessment

Co-Chairs: Anthony D. Bram & Christina Biedermann

The mission of the Psychoanalytic Interest Group is to provide SPA members with a focused opportunity to discuss their interests in psychoanalytic approaches to personality assessment and to create a network of professionals to support each other's education, writing, and research. The group supports the mission of the SPA Board of Trustees by fostering membership interest in these topics, and by providing resources to support direct clinical service, supervision, teaching, and research. Recent initiatives have included collating a biannual summary of members' interests and initiatives and developing a list of significant publications that one might consult to learn and teach about this approach to assessment. We have also been piloting a mentorship program matching students and early-career clinicians with more senior assessors. The group also encourages scientific presentations, posters, continuing education workshops, and publications that integrate psychoanalytic theory with personality assessment. We welcome all colleagues to join us, particularly graduate students and early career psychologists seeking support in integrating their psychoanalytic and assessment interests.

Collaborative/Therapeutic Assessment

Co-Chairs: Krista Brittain & Raja David

The Collaborative/Therapeutic Assessment (CTA) interest group offers the opportunity to meet with assessors thinking about, working to develop, and practicing this approach to psychological assessment and intervention. Developments, training and learning opportunities, ideas, research efforts and findings, and marketing issues involving CTA, as well as the successes and challenges our members experience, are central topics of discussion. This interest group offers support to those on the cutting edge as well as those just learning CTA and it fosters a collaborative community of assessors, promoting connections and friendships. Everyone is welcome! Students and assessors new to CTA are especially valued.

Forensic Psychology

Co-Chairs: Corine de Rooter & Madeleine Starin

The mission of the FIG is developing interest and momentum for the implementation of forensic psychology and personality assessment within the scope of SPA's overall mission and to disseminate findings to the membership and SPA Board: to develop membership and Board interests and resources, support forensically-relevant publications in JPA, forensic psychology presentations at Annual Conventions, and continuing education workshops. Starting in 2016, a presentation of topical interest to participants will be presented every year.

GUIDELINES TO DEVELOP A NEW INTEREST GROUP

1. Any SPA member, fellow or student affiliate interested and willing to start a new interest group should bring the proposal to the Board of Trustees, including a mission for the group and proposed plan to attract members.
2. Interest groups shall change leadership every three years with the option of reelection.
3. Once the Board approves a new Interest Group, the Board will provide the following:
 - a. A meeting place will be assigned to meet during Convention,
 - b. A description in the website and Convention program
 - c. Assistance to recruit members and maintain connections outside Convention meetings.
 - d. Assistance to the group in achieving the goals they set for their group.

NOTE: NOT ALL SCHOLARSHIP WINNERS ARE LISTED BELOW. ONLY SCHOLARSHIPS WINNERS THAT HAVE GIVEN PERMISSION TO DISPLAY THEIR INFORMATION ARE INCLUDED.

Diversity Scholarship

As part of its overall commitment to diversity, SPA is now offering diversity scholarships of up to \$1100.00 to support diverse professionals or students involved in personality assessment who seek to attend the 2024 SPA Convention and Workshops. This scholarship award includes a complimentary member early-bird rate registration, one night hotel, and up to \$500 for reimbursable expenses (travel, additional registration fees, additional hotel, food). Additional funds for expenses may be given if registering at a lower rate.

Winners

A. ESIN ASAN
CAROLINE CARMODY
ABM REZBAUL ISLAM
EDLEEN DE JESUS-SANCHEZ
PEGGAH KHALILI-TARI
KENNETH MONTEMAYOR
TIA NICOLAS
DANNA RAMIREZ
ZEYNEP SEN
KRYSTAL SMITH
ZIQI WU

Early Career Scholarship

In an effort to encourage and support the training and education of early career psychologists in personality assessment, which are defined as individuals within 5 years of receiving their terminal degree, SPA has created scholarship opportunities to attend the 2024 SPA Convention and Workshops. This \$650.00 scholarship award includes a complimentary member early-bird rate registration, one night hotel, and \$150 for reimbursable expenses (travel, additional registration fees, additional hotel, food). International applicants may be awarded an additional stipend of up to \$800 depending on the stated need and the number of applications received.

Winners

CONNOR ADAMS
JJ BOLAND
DALLAS BOYCE
HANNAH HOLMES
RITA PASION
CAITLYN RAMBERG

Student Scholarship

In an effort to encourage training of students and promote student participation in research and scholarly presentation in the area of personality assessment, SPA has created scholarships opportunities to attend the 2024 SPA Convention and Workshops. This \$430.00 scholarship award includes a complimentary member early-bird rate registration and one night hotel. International applicants may be awarded an additional travel stipend of up to \$400 depending on the stated need and the number of applications received.

Winners

MOLLY ARMSTRONG
HANNAH ASIS
MARTINA CAMELIO
JOHN CROMB
WILLIAM FOSTER
LAUREN KENNEDY
ANNE NICKELL
MATTEA PARKER

These are the volunteers names at the time the Program was published. There may be others who signed up to volunteer after publishing. Please know that we appreciate your time and willingness to volunteer. We could not succeed without the help of our volunteers. Thank you!

CONNOR ADAMS
MOLLY ARMSTRONG
NICOLE BALDWIN
SHAMIRON BALES
EMILY BARBERA
JANICE BLACKHAM
KELLEY BLOOMER
JACK BURKE
EDWARD CHOU
VANESSA CROFFORD
SARAH GOTTLIEB
YASMINE GRIFFIN
CHRISTINE HUJING
ALICIA W. VILLANUEVA VAN DEN HURK
SHANNON KELLEY
ALESSANDRO LORENZONI
REBEKAH NERENBERG
ELIZABETH PAPAGNI
MATTEA PARKER
CAITLYN RAMBERG
TAYLOR RODRIGUEZ
SARVENAZ SEPEHRI
AUDREY STEPHENSON

Notes

Thank you for attending our 2024 SPA Convention!

If you're interested in presenting a webinar this upcoming year, please contact our office.



Society for
Personality
Assessment

Society for Personality Assessment
703.534.4772

www.personality.org
info@personality.org
[@SPA1938](https://twitter.com/SPA1938)