

# STRUCTURAL BUILDING **COMPONENTS**<sup>TM</sup>

THE FUTURE OF FRAMING

Sept/Oct 2010

[www.sbcmag.info](http://www.sbcmag.info)

Design Competition Leads to  
Advanced Framing & Energy Efficiency



**PLUS...**

**2010 BCMC Show Guide  
...and more!**

CHANGE SERVICE REQUESTED

*Framing the*  
**AMERICAN  
DREAM**<sup>®</sup>

PRRST STD  
U.S. Postage  
**PAID**  
Madison, WI  
Permit No. 2223

SBC Magazine • 6300 Enterprise Lane • Suite 200 • Madison, WI 53719



# MiTek®

## SOFTWARE SUITE

### COMPONENT DESIGN

MiTek® Engineering  
OnLine Plus Engineering

### STRUCTURAL FRAMING

SAPPHIRE™ Structure  
SAPPHIRE™ Viewer  
MiTek® eFrame Panel™  
OnLine Plus Layout

### BUSINESS MANAGEMENT

MiTek® Job Summary  
MiTek® WorkFlow™  
MiTek® MBA™  
SAPPHIRE™ Management  
SAPPHIRE™ Materials  
SAPPHIRE™ Portal  
InfoStar Database

### PRODUCTION MANAGEMENT

MiTek® CyberSort™  
MiTek® JigSet™  
MiTek® MVP™  
MiTek® ShopNet™  
SAPPHIRE™ Production  
OnLine Plus Job Manager



# TECHNOLOGY BUILT FOR TODAY'S COMPONENT MANUFACTURERS



Our industry is challenged today more than ever — and your customers demand more value, greater efficiency and better communication. Your business demands lower costs, faster turnaround and a stronger competitive position. MiTek's **Software Suite** offers you tools to run your business effectively and to consistently improve your performance and productivity.

MiTek's **SAPPHIRE™** Suite was built from the ground up to meet your demands. It is technology built to meet your business needs in a demanding business environment. **SAPPHIRE** is built on a platform of true three-dimensional objects, fully connected and operating as the heart of the suite. You can share three-dimensional files with **SAPPHIRE™ Viewer** — improving communication between you and your customer. **SAPPHIRE** unifies your database of materials and reporting that drives your business processes, eliminating file sharing and delivering accuracy, speed and workflow optimization.

The MiTek Software Suite offers you tools to run your business effectively and consistently improve your performance and productivity. **MVP™** provides a bird's-eye view and metrics of all the production activities going on in your plant. As a Plant Manager, not only can you see all of the jobs, but you can schedule and manage the process for all of them right from your desk. The hub of the MiTek Software suite is **MBA™**. It provides the richest feature set of any centralized business management tool available to the industry. With **ShopNet™** you can streamline the entire wall panel production process and improve communications throughout your operation.

From production software to equipment, MiTek is dedicated to helping our customers succeed. MiTek continues to offer affordable solutions to boost your production efficiencies. Schedule an equipment automation demonstration at the **BCMC show in Charlotte** by visiting our website at [www.mii.com/scheduledemo.com](http://www.mii.com/scheduledemo.com). And be sure to review the schedule of educational seminars we will be conducting in our booth, and schedule time to attend these sessions at the show.

For reader service, go to [www.sbcmag.info/mitek.htm](http://www.sbcmag.info/mitek.htm)

# Our Valued Supporters...

These companies provide significant sponsorship of the structural building components industry.



**Many thanks for their ongoing support!**

For more information about our 2010 Program Advertisers or advertising in general, visit the SBC website at [www.sbcmag.info](http://www.sbcmag.info) or call 608/310-6706.



## Gold Advertisers

BCMC\* (p. 22-29)  
 Clark Industries\* (p. 30)  
 Eagle Metal Products\* (p. 30)  
 Eide (p. 6)  
 Intelligent Building Systems -  
 ITW Building Components Group\* (p. 15)  
 ITW Building Components Group\* (p. 32)  
 Lakeside Trailer Manufacturing\* (p. 13)  
 Masengill Machinery Co. (p. 11)  
 MiTek Industries, Inc.\* (p. 2-3, 9)  
 Panels Plus\* (p. 12)  
 Qualtim, Inc.\* (p. 20)  
 SBCA\* (p. 31)  
 Simpson Strong-Tie Co.\* (p. 11)  
 Southern Pine Council\* (p. 17)  
 Viking - Wall Panel Systems\* (p. 21)  
 Wood Truss Systems, Inc.\* (p. 30)

## Silver Advertisers

Finnforest USA\* (p. 21)  
 Pennsylvania Lumbermens  
 Mutual Insurance Co. (p. 19)

## Bronze Advertisers

Stiles Machinery, Inc.  
 Wasserman & Associates, Inc. (p. 13)

\*Indicates Charter Advertiser Status Listing based on contracts received as of 8/18/10.

# STRUCTURAL BUILDING COMPONENTS™

THE FUTURE OF FRAMING

Sept/Oct 2010

[www.sbcmag.info](http://www.sbcmag.info)

## contents

Page 14



by Libby Maurer

**Design Competition Leads to Advanced Framing & Energy Efficiency**

on the cover: Apex Technology's Mike Kozlowski and a material vendor inspect a raised wood floor built in Jacksonville.

Page 18



**Down Under Company Scoops Up Equipment Deals**

by Libby Maurer

Page 22



**BUILDING COMMUNITY MAKING CONNECTIONS**

BCMC 2010 Show Guide

Sept 29 - Oct 1  
 Charlotte, NC

Editor's Message	7
Technical Q&A	10
Parting Shots	30

**Publisher**  
 Truss Publications, Inc.  
 6300 Enterprise Lane • Suite 200  
 Madison, WI 53719  
 Phone: 608/310-6706 • Fax: 608/271-7006  
[trusspubs@sbcmag.info](mailto:trusspubs@sbcmag.info) • [www.sbcmag.info](http://www.sbcmag.info)

**Editor**  
 Steven Spradlin  
 Capital Structures Inc. • [sspradlin@sbcmag.info](mailto:sspradlin@sbcmag.info)

**Art Director**  
 Melinda Caldwell  
 608/310-6729 • [mcaldwell@sbcmag.info](mailto:mcaldwell@sbcmag.info)

**Managing Editor & Circulation Director**  
 Libby Maurer  
 608/310-6724 • [lmaurer@sbcmag.info](mailto:lmaurer@sbcmag.info)

**Editorial Review**  
 Kirk Grundahl  
 608/274-2345 • [kgrundahl@sbcmag.info](mailto:kgrundahl@sbcmag.info)

Suzi Grundahl  
 608/310-6710 • [sgrundahl@sbcmag.info](mailto:sgrundahl@sbcmag.info)

**Advertising Sales & Marketing**  
 Peggy Pichette  
 608/310-6723 • [ppichette@sbcmag.info](mailto:ppichette@sbcmag.info)  
 Emmy Thorson-Hanson  
 608/310-6702 • [ethorson-hanson@sbcmag.info](mailto:ethorson-hanson@sbcmag.info)

**Staff Writers for September/October**  
 Jim Vogt, PE.

**Accountant**  
 Mike Younglove  
 608/310-6714 • [myounglove@sbcmag.info](mailto:myounglove@sbcmag.info)

**Computer Systems Administrator**  
 Rick Saindon  
 608/310-6717 • [rsaindon@sbcmag.info](mailto:rsaindon@sbcmag.info)

Send all ad materials, insertion orders, contracts & payments to:  
 Truss Publications, Inc.  
 6300 Enterprise Lane • Suite 200  
 Madison, WI 53719  
 Phone: 608/310-6706 • Fax: 608/271-7006  
[trusspubs@sbcmag.info](mailto:trusspubs@sbcmag.info) • [www.sbcmag.info](http://www.sbcmag.info)

The mission of Structural Building Components Magazine (SBC) is to increase the knowledge of and to promote the common interests of those engaged in manufacturing and distributing structural building components. Further, SBC strives to ensure growth, continuity and increased professionalism in our industry, and to be the information conduit by staying abreast of leading-edge issues. SBC's editorial focus is geared toward the entire structural building component industry, which includes the membership of the Structural Building Components Association (SBCA). The opinions expressed in SBC are those of the authors and those quoted, and are not necessarily the opinions of Truss Publications or SBCA.

Copyright ©2010 by Truss Publications, Inc. All rights reserved.



# “We purchased our first WizardPDS® drop-in Channels™ System in 2008. And a second system in 2009.”

“Faced with a dwindling housing industry and shrinking margins in tough economic times, Richco Structures needed to look for ways to reduce costs. This led us on a search for the best way to streamline our set up process. After carefully considering our options we purchased our first WizardPDS drop-in Channels system in 2008. And a second system in 2009.

Because of the attention to detail by the Wizard Team prior to installation, the retrofit went in exceptionally well. And using the drop-in channel meant we could save money by using existing tables in lieu of purchasing an entirely new table layout.

The Wizard systems have lived up to their billing when it comes to reliability and accuracy. Ask our maintenance team and they’ll tell you they aren’t bothered with routine maintenance or calibration. An occasional lubrication and walk by sighting on chord planes tells them all they need to know; spot on pin placement every time.

The Wizard systems integrated seamlessly with our design software and line operators quickly learned to appreciate the ease of use and accuracy. Probably most valued by the assembly crews is the elimination of 10–20 minutes per setup spent on the tables placing jig hardware.

We have changed our scheduling philosophy to shift most of the production, especially the set-up intensive jobs, to the WizardPDS lines to save on labor costs. This caused a remarkable increase in productivity.”

*Rich Pearce  
Plant Manager  
Richco Structures – Haven, WI  
Division of Richardson Industries*



## Editor's Message

### BCMC Build Brings Excitement

by Steven Spradlin

What a year it's been! We've all faced ups and downs as the economy begins to slowly emerge from the slump. Housing starts seem to be up one month and down the next. We've seen the new homebuyer tax credit be extended and expanded. Lumber and steel prices have spiked and then crashed. Yet there are still questions no one can answer: Will we see the economy double dip? Where will interest rates go? What will Mark Vitner say in his Economic Forecast at BCMC 2010? I'm optimistic that a year from now we'll be back to a robust, sustainable level of business.

I'd like to thank a couple specific people for making my year as president seamless. I've had the opportunity to work with group of talented peers who serve on the Executive Committee and the Marketing, Management, Membership, Legislative, Engineering & Technology and QC Committees. I couldn't have done it without their input and direction. I'd also like to thank the companies who maintained their membership with SBCA. Our organization is only as strong and diverse as the individuals who are willing to give their time, talent and treasure. Thank you to the very capable Qualtim, Inc. staff under the direction of Kirk and Suzi Grundahl for keeping me on the right path to help our industry.

**BCMC Build 2010 demonstrates this theme of community. We should all take pride that we're coming together as a community to give this gift of housing to a deserving Charlotte family.**

One of the things I love about our industry is we always seem so willing to put our trials behind us and help people who need it more than we do. BCMC Build 2010 demonstrates this theme of community. We should all take pride that we're coming together as a community to give this gift of housing to a very deserving Charlotte family. It's been many years since the industry came together for this type of project. The *Framing the American Dream*® project took place in 1996. And though we aren't competing against stick framing this time, we will be showing the community and Habitat that our products offer without a doubt the best available framing solution.

My company has committed to send several managers to help run the build on site. I can only hope it isn't as hot during BCMC Build as it was when we did *Extreme Makeover: Home Edition* in July 2005. (It was a steamy 95 degrees!) If you are not yet involved in this exciting new BCMC event, I encourage you to do so in the next several weeks. We still need donations and volunteers! Check out the attendee promo on page 22 for more details.

Finally, best wishes to incoming President Joe Hikel of Shelter Systems Limited. We are in very capable hands! Thank you for the opportunity to serve as your president over the past year. I wish everyone in our industry a prosperous and productive year. **SBC**

*SBC Magazine encourages the participation of its readers in developing content for future issues. Do you have an article idea for a future issue or a topic that you would like to see covered? Email your thoughts and ideas to [editor@sbcmag.info](mailto:editor@sbcmag.info).*

Continued on page 8

Thank you for a great year!

#### at a glance

- Thank you for your SBCA membership!
- Our industry is unique in that we are willing to help people who need it more than we do.
- BCMC Build 2010 will take place September 27-28 in Charlotte.

Visit the  
**EIS Booth**  
BCMC 2010

**WizardPDS® drop-in Channels™**  
Your table, Automated.



Think green.  
Retro fit.  
Save green.

**WizardPDS®**  
Automated Perimeter Definition System

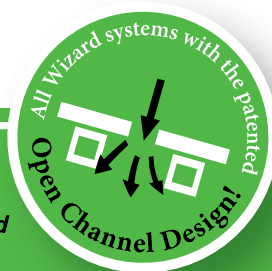

We bring the best together!

Toll free 800-344-3433 Ph. 612-521-9193 Fax 612-521-9307 [www.eideintegratedsystems.com](http://www.eideintegratedsystems.com)  
Eide Integrated Systems, LLC PO Box 11397 / 3219 North Second Street Minneapolis, MN 55411-0397

For reader service, go to [www.sbcmag.info/eide.htm](http://www.sbcmag.info/eide.htm)



# SBCRI Testing IRC Wall Panel Provisions

Revolutionary braced wall testing is happening at SBCRI! Determining the true performance of braced wall products used as braced wall panels is a critical step in understanding building design and performance. In the last several months, SBCRI has begun examining how braced wall panels perform in braced wall lines in an actual building. The results thus far indicate our industry will be able to influence more efficient value engineering in these designs.

SBCRI is testing braced walls within a standard comparative equivalency test structure (see pictures below): a 12'x30' single story code complying building. This structure is built consistently, allowing staff to accurately compare load path and assembly resistance. The structure can be built to any building code specification and up to two stories high!

In the coming weeks and months, SBCRI will provide all the baseline analysis we collected from our more than \$300,000 of testing and analysis. We will compare our test results to the analysis methods used in the RISA/WoodWorks partnership, which is promoted as providing a full range of wood design features.

SBCRI's proprietary partners' goal is to complete full value engineered shear wall design for residential/commercial structures using a proprietary "testing calibrated" version of RISA software as the engineered design foundation. We will be providing summaries of the braced wall line testing and test results that support our RISA engineering calibrations as results are vetted and finalized.

Keep checking the website: [www.sbcricri.info/techIRCnotes](http://www.sbcricri.info/techIRCnotes) for the latest test report and findings from SBCRI. **SBC**



Views of the 12'x30' IRC-compliant structure in SBCRI. Braced wall panels are placed in various locations along the structure, loads are applied, and the products' performance is measured.

[www.sbcmag.info](http://www.sbcmag.info)



## TECHNOLOGY BUILT FOR TODAY'S COMPONENT MANUFACTURERS

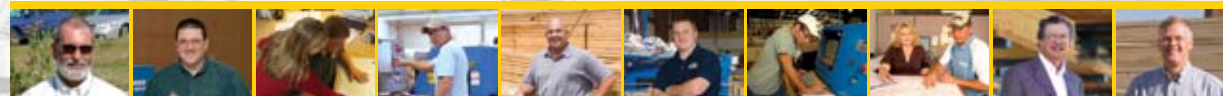

Our industry is challenged today more than ever — and your customers demand more value, greater efficiency and better communication. Your business demands lower costs, faster turnaround and a stronger competitive position. MiTek's component manufacturing equipment was built from the ground up to meet your demands. It is technology built to meet your business needs in a demanding business environment.

With MiTek's **MatchPoint™ PLANX** automated jigging system, you can improve accuracy and productivity by over 50% with the same crew, in the same space and, with same size tables system. **The Virtek® TrussLine** laser projection system makes manufacturing so easy that you can increase throughput by 25%, reduce set up time by 70% and make inexperienced workers productive in just a few hours. When purchasing used equipment, proper calibration and installation is key to achieving maximum productivity. The experienced technicians at MiTek are your best resource for proper installation and performance of MiTek equipment. MiTek's **Machinery Assurance Program™** can connect you with MiTek technicians, factory replacement parts and performance calibration.

From production equipment to software, MiTek is dedicated to helping our customers succeed. MiTek continues to offer affordable solutions to boost your production efficiencies. Schedule an equipment automation demonstration at the **BCMC show in Charlotte** by visiting our website at [www.mii.com/scheduledemo.com](http://www.mii.com/scheduledemo.com). And be sure to review the schedule of educational seminars we will be conducting in our booth, and schedule time to attend these sessions at the show.

For reader service, go to [www.sbcmag.info/mitek.htm](http://www.sbcmag.info/mitek.htm)

Questions? Contact us today: **800.325.8075** • [www.mii.com](http://www.mii.com)

©2010 MiTek. All rights reserved.

SOFTWARE • EQUIPMENT • CONNECTOR & BRACING PRODUCTS • ENGINEERING SERVICES



## When is Preservative-Treated Wood Required?

How much is too much when it comes to treated wood?

by Jim Vogt, P.E.

**P**reservative-treated wood should be used when conditions are favorable for attack by decay causing organisms and/or wood eating insects. The building codes identify several conditions when this might occur and provide minimum construction practices to prevent such attacks. Component manufacturers should be aware of the code requirements pertaining to the use of preservative-treated wood so they can assist their customers in using these materials in the appropriate applications.

### Question

We are a wall panel manufacturer and recently reviewed construction documents for two different multi-story projects in which preservative-treated wood sill plates are specified for the exterior walls at each floor level. For both projects, the typical exterior wall assembly consists of masonry veneer, an air space, weather-resistant sheathing (e.g., Tyvek®), OSB sheathing, 2x\_ wood studs, fiberglass batt insulation, a 6 MIL poly vapor retarder and 5/8" gypsum board. The typical floor/ceiling assembly



consists of 3/4" light-weight concrete topping, 3/4" tongue and groove plywood, parallel chord wood trusses, resilient furring channel, sound attenuation batt insulation, and a 5/8" gypsum board ceiling. The exterior wall-to-floor details for the upper floors appear to be fairly standard and show the bottom plate of the wall bearing directly on the plywood floor sheathing, which in turn is supported by the ends of the floor trusses. A slight gap is shown between the top of the plywood floor sheathing and the bottom edge of the gypsum wall board and is to be filled with a flexible sealant. The 3/4" gypsum floor topping is flush with the face of the gypsum wall board and sits directly on top of the plywood floor sheathing. The floor-to-wall detail at the first level is similar except the first floor consists of a precast concrete hollow core slab. The bottom wall plate at this level bears directly on the concrete.

These two projects are located in different states and were designed by different building designers. No other treated lumber is specified in the exterior wall and floor assemblies. I can certainly understand the use of a preservative-treated wood sill plate at the first floor level, but the requirement for the treated plates at the upper floors seems to be a bit much. Has there been a change in the building code that now requires this?

### Answer

"Naturally durable wood" or preservative-treated wood is typically required for applications where deterioration of the wood by decay causing organisms and/or wood eating insects (e.g., termites) is likely. This includes applications where the wood will be:

- in direct contact with the ground or fresh water,
- used above the ground and exposed to the weather,
- used above the ground within a specified distance of exposed earth,
- used above the ground and in contact with moisture permeable materials (such as concrete or masonry) that are in direct contact with the ground or exposed to the weather, or
- in areas with inadequate ventilation.

Section 2304.11 of the International Building Code® (IBC®) identifies the conditions where protection from decay and termites is required. (See page 12 for specific language.) Except for some minor revisions, these provisions have remained relatively unchanged from the 2003 to 2009 editions of the IBC.

Note that Section 2304.11.2.2 requires the use of naturally durable wood or preservative-treated wood when wood framing members bear on exterior foundation walls and are within eight inches of exposed earth. Note also Section 2304.11.2.4 requires that sill plates be naturally durable or preservative-treated if they bear on a concrete or masonry slab that is in direct contact with the earth. Depending on the site conditions for your two projects, both of these provisions could explain the use of the preservative-treated sill plate at the first floor level. However, neither these, nor any of the other provisions in Section 2304.11 explain the requirement for using preservative-treated sill plates on the upper floors, especially since no other durable or treated wood has been specified for the floor and wall assemblies.

Keep in mind that building codes establish minimum requirements and the building designer can certainly specify more stringent requirements. You will want to contact both building designers to verify that a preservative-treated wood plate is actually required for the exterior walls of the upper floors.

Continued on page 12



**One-sided fastening  
— it's a cinch.**

The Strong-Drive® SDW structural wood screw fastens multi-ply truss assemblies and engineered-wood applications without gapping or flipping heavy girders. The thread design firmly cinches together 2, 3 and 4-ply trusses or 1 3/4" engineered lumber from one side. Unlike typical hex-style screws, the SDW features a large, flush head which makes installing drywall and connectors much simpler since the head doesn't protrude from the girder. The deep head recess also reduces spinout and makes driving faster and easier.

To learn more about the benefits of the Simpson Strong-Tie® SDW screw, visit [www.strongtie.com](http://www.strongtie.com) or call (800) 999-5099.

**Come visit us  
at our booth at BCMA  
Sept. 29–Oct. 1**

For reader service, go to [www.sbcmag.info/simpson.htm](http://www.sbcmag.info/simpson.htm)

**SIMPSON**  
**Strong-Tie**

**MASENGILL MACHINERY CO.**  
Production Machinery Specialists Since 1963

**New • Used • Refurbished • Reconditioned**

**Reconditioned machines available with warranty:**

Spida Saw

ASI/Monet FWA 500 Web Saw

Koskovich Auto-OMNI

Haulin'/ASI Stretch Trailer

Klaisler Rol-Splice Machine

**Visit our booth at BCMA 2010!**

**www.masengills.com**

1002 Buffalo Trail • Morristown, TN 37814  
Office: (888)USE-WOOD (873-9663)  
Fax: (423)586-0483 •  
info@masengills.com

For reader service, go to [www.sbcmag.info/masengill.htm](http://www.sbcmag.info/masengill.htm)



Wall Framing Made Simple...

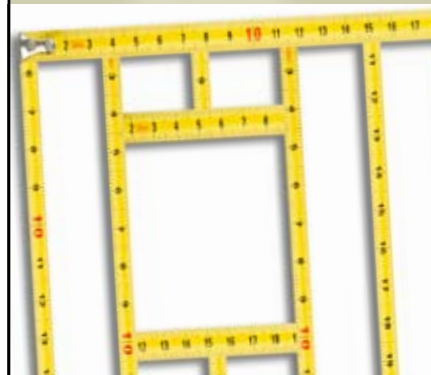

PLUS  
PANELS

Success is measured only one way — by the components you build

With our reputation for building machinery "that works" and our master design capabilities you can be assured Panels Plus equipment will increase your production.

- Low budget multi function single table (requires little shop floor space)
- Custom length tables for long walls. Interior/exterior fastening options (nails, staples, screws)
- Custom built bridge over your existing table
- Tilt table with both side access (near vertical positioning)
- Floor section tables (adjusts from 6' to 16', up to any length)
- Steel stud tables (inquire)
- Sub component nailer (builds 8 different wall sub components)
- Mount any brand of nailer, stapler, screw gun (on most any machine)
- Material Handling carts (extra heavy duty)

For Information call Tim Kaasa  
866.726.7587 or [www.panplus.com](http://www.panplus.com)

For reader service, go to [www.sbcmag.info/panelsplus.htm](http://www.sbcmag.info/panelsplus.htm)

## Technical Q&A • Continued from page 11

Wood that has been treated with waterborne preservatives usually has higher moisture content, which can result in additional shrinkage in the walls unless the treated lumber has been kiln dried after treatment (KDAT) or allowed to air dry after treatment (ADAT). Unless already provided in the construction documents, the building designer will also need to clarify the required Use Category (UC), preservative system, and corrosion potential of the preservative system, so that you can use fasteners in your wall panels with the proper corrosion resistance. Finally providing guidance on the additional cost of preservative-treated wood and several alternatives to the building designer and your customer will make you a more valuable supplier to them. **SBC**

To pose a question for this column, email [technicalqa@sbcmag.info](mailto:technicalqa@sbcmag.info) or call 608/274-4849.

### Section 2304.11 from the 2009 IBC

#### 2304.11 Protection against decay and termites.

**2304.11.1 General.** Where required by this section, protection from decay and termites shall be provided by the use of naturally durable or *preservative-treated* wood.

**2304.11.2 Wood used above ground.** Wood used above ground in the locations specified in Sections 2304.11.2.1 through 2304.11.2.7, 2304.11.3 and 2304.11.5 shall be naturally durable wood or *preservative-treated* wood using water-borne preservatives, in accordance with AWPA U1 (Commodity Specifications A or F) for above-ground use.

**2304.11.2.1 Joists, girders and subfloor.** Where wood joists or the bottom of a wood structural floor without joists are closer than 18 inches (457 mm), or wood girders are closer than 12 inches (305 mm) to the exposed ground in crawl spaces or unexcavated areas located within the perimeter of the building foundation, the floor construction (including posts, girders, joists and subfloor) shall be of naturally durable or *preservative-treated* wood.

**2304.11.2.2 Wood supported by exterior foundation walls.** Wood framing members, including wood sheathing, that rest on exterior foundation walls and are less than 8 inches (203 mm) from exposed earth shall be of naturally durable or *preservative-treated* wood.

**2304.11.2.3 Exterior walls below grade.** Wood framing members and furring strips attached directly to the interior of exterior masonry or concrete walls below grade shall be of approved naturally durable or *preservative-treated* wood.

**2304.11.2.4 Sleepers and sills.** Sleepers and sills on a concrete or masonry slab that is in direct contact with earth shall be of naturally durable or *preservative-treated* wood.

**2304.11.2.5 Girder ends.** The ends of wood girders entering exterior masonry or concrete walls shall be provided with a 1/2-inch (12.7 mm) air space on top, sides and end, unless naturally durable or *preservative-treated* wood is used.

**2304.11.2.6 Wood siding.** Clearance between wood siding and earth on the exterior of a building shall not be less than 6 inches (152 mm) or less than 2 inches (51 mm) vertical from concrete steps, porch slabs, patio slabs and similar horizontal surfaces exposed to the weather except where siding, sheathing and wall framing are of naturally durable or *preservative-treated* wood.

**2304.11.2.7 Posts or columns.** Posts or columns supporting permanent structures and supported by a concrete or masonry slab or footing that is in direct contact with the earth shall be of naturally durable or *preservative-treated* wood.

#### Exceptions:

1. Posts or columns that are either exposed to the weather or located in basements or cellars, supported by concrete piers or metal pedestals projected at least 1 inch (25 mm) above the slab or deck and 6 inches (152 mm) above exposed earth, and are separated there from by an impervious moisture barrier.
2. Posts or columns in enclosed crawl spaces or unexcavated areas located within the periphery of the building, supported by a concrete pier or metal pedestal at a height

greater than 8 inches (203 mm) from exposed ground, and are separated there from by an impervious moisture barrier.

**2304.11.3 Laminated timbers.** The portions of glued-laminated timbers that form the structural supports of a building or other structure and are exposed to weather and not fully protected from moisture by a roof, eave or similar covering shall be pressure treated with preservative or be manufactured from naturally durable or *preservative-treated* wood.

**2304.11.4 Wood in contact with the ground or freshwater.** Wood used in contact with the ground (exposed earth) in the locations specified in Sections 2304.11.4.1 and 2304.11.4.2 shall be naturally durable (species for both decay and termite resistance) or preservative treated using water-borne preservatives in accordance with AWPA U1 (Commodity Specifications A or F) for soil or fresh water use.

**Exception:** Untreated wood is permitted where such wood is continuously and entirely below the groundwater level or submerged in fresh water.

**2304.11.4.1 Posts or columns.** Posts and columns supporting permanent structures that are embedded in concrete that is in direct contact with the earth, embedded in concrete that is exposed to the weather or in direct contact with the earth shall be of *preservative-treated* wood.

**2304.11.4.2 Wood structural members.** Wood structural members that support moisture-permeable floors or roofs that are exposed to the weather, such as concrete or masonry slabs, shall be of naturally durable or *preservative-treated* wood unless separated from such floors or roofs by an impervious moisture barrier.

**2304.11.5 Supporting member for permanent appurtenances.** Naturally durable or *preservative-treated* wood shall be utilized for those portions of wood members that form the structural supports of buildings, balconies, porches or similar permanent building appurtenances where such members are exposed to the weather without adequate protection from a roof, eave, overhang or other covering to prevent moisture or water accumulation on the surface or at joints between members.

**Exception:** When a building is located in a geographical region where experience has demonstrated that climatic conditions preclude the need to use durable materials where the structure is exposed to the weather.

**2304.11.6 Termite protection.** In geographical areas where hazard of termite damage is known to be very heavy, wood floor framing shall be of naturally durable species (termite resistant) or preservative treated in accordance with AWPA U1 for the species, product preservative and end use or provided with *approved* methods of termite protection.

**2304.11.7 Wood used in retaining walls and cribs.** Wood installed in retaining or crib walls shall be preservative treated in accordance with AWPA U1 (Commodity Specifications A or F) for soil and fresh water use.

**2304.11.8 Attic ventilation.** For *attic* ventilation, see Section 1203.2.

**2304.11.9 Under-floor ventilation (crawl space).** For under-floor ventilation (crawl space), see Section 1203.3

## New SBCA Members

### REGULAR MEMBERS

**Mayfield Truss LLC**  
18409 SD Highway 25  
Willow Lake, SD 57278-5403  
605-625-3314  
Mr. Kent E. Namken

**The Truss Company**  
4520 N St Louis St  
Batesville, AR 72501-8233  
870-793-5134  
Mr. Vance Jarrett

### ASSOCIATE MEMBERS

**Carolina Construction Services**  
162 Crimson Orchard Dr  
 Mooresville, NC 28115  
704-663-5880  
Mr. Chris Yaede

**Component Runner, LLC**  
440 Spring St  
Marshfield, MA 02050-5858  
314-374-7400  
Mr. J. Chip Dean  
Sponsor: Mr. Norm McKenna

### J-Gable

PO Box 1445  
Watertown, SD 57201  
877-765-3915  
Mr. James A. Hill  
Sponsor: Mr. Luke Kraft

**James R McDonagh**  
165 Western Ave N #501  
St Paul, MN 55102  
651-353-8139  
Mr. James R. McDonagh  
Listing as of 8/18/10.

## Serving the Truss Industry Since 1987

New & Used Models in Stock



For over 20 years, Lakeside Trailer has led the way in the component trailer industry with innovative ideas to assure your delivery operations remain efficient in today's competitive market. With more than 1700 truss trailers to our credit, Lakeside has perfected ways to reduce or eliminate your transportation concerns.

**LAKESIDE**  
TRAILER MANUFACTURING, INC.

573/736-2966 • 573/736-5515 fax  
[www.rollerbed.com](http://www.rollerbed.com) • [lee@rollerbed.com](mailto:lee@rollerbed.com)

For reader service, go to [www.sbcmag.info/lakeside.htm](http://www.sbcmag.info/lakeside.htm).

## Used Truss, Wall Panel & Door Equipment

- **Roller Gantry Systems** (starting at \$14,900)
- **Laser Projection Systems** (starting at \$4,900 per head)
- **Floor Truss Machines** (starting at \$4,900)
- **Automated Component Saws** (starting at \$17,500)
- **Wall Panel Lines** (starting at \$11,750)
- **Pre-Hung Door Machines** (starting at \$12,000)

**WASSERMAN & ASSOCIATES, INC.**  
800/382-0329 phone • 402/438-2524 fax  
[www.wasserman-associates.com](http://www.wasserman-associates.com)

## Not Comfortable with Used Equipment?

Please consider the following:

- Satisfaction Guaranteed— if it's not right, we'll buy it back!
- Installation Services Available
- Leasing Available
- Shipping Coordination Is Included

Please contact us to sell your excess equipment!

For reader service, go to [www.sbcmag.info/wasserman.htm](http://www.sbcmag.info/wasserman.htm).





# Design Competition Leads to Advanced Framing & Energy Efficiency

by Libby Maurer

**H**ow did a design competition for an in-fill lot in Jacksonville turn into a high performance single family home?

When Bob Esposito, principle designer with True Design Studios, entered the Raised Floor Living Design Challenge, he treated the competition like any other project. "I kind of laughed when we were named winner," he said, thinking back to the November 2009 award ceremony. "As far as I was concerned, I approached it with the same enthusiasm as I would any other project. I studied the design program and applied the fundamentals of architectural design."

Nearly nine months later, Bob's winning design is a model for modern framing techniques geared toward reducing energy consumption. The 1293 sq. ft. single family home features three bedrooms, two baths, a raised structural building component floor system, and several other advanced framing techniques.

The Challenge, issued jointly by the APA and Southern Pine Council, was launched to promote raised floor construction over the traditional concrete slab within the design community. "The goal was to stimulate discussion between builders and designers to use wood products in ways they haven't before," said CW Macomber, project manager for the Raised Floor Living project.

In addition to soliciting innovative raised floor designs, the group also planned to use them to build an actual home in a preselected in-fill lot in Jacksonville. They chose local builder MasterCraft Builder Group to construct it. Aside from the raised floor foundation, other criteria for the contest were set:

- All exterior walls had to be wood frame and fully sheathed with wood structural panels.
- The total conditioned space had to fall within 1200 sq. ft. and 1300 sq. ft.
- 3 bedrooms and 2 full baths
- Unconditioned space:
  - A carport ranging from 200 to 250 sq. ft.
  - A storage room adjacent to carport ranging from 50 to 100 sq. ft.
  - A covered front porch ranging from 50 to 75 sq. ft.
  - A rear deck ranging from 75 to 125 sq. ft.

The criteria further called for an emphasis on affordability and consistency with the "traditional cottage style" look of the existing homes in the neighborhood. Raised Floor Living approached the Northeast Florida Builders Association (NEFBA) to help promote the Challenge. NEFBA President Andy Chambers also happens to be the President of MasterCraft.

Esposito received a \$11,000 prize for winning the competition, and a portion of it was used to cover the cost of securing the permit drawings. True Design Studios then partnered with Jacksonville's Apex Technology, with whom they have a collaborative relationship, to complete the engineering. Apex structural engineer Mike Kozlowski leveraged his position as president of the newly formed Wood Council within NEFBA to engineer some cutting edge design elements. Kozlowski says with the Council's goal to help promote wood frame construction, the team soon broadened its focus to showcase

advanced wood framing techniques that would improve energy performance.

Chambers originally planned to use the house as a model home for his company. But when the Wood Council became involved, Chambers decided to sell the completed home and give the proceeds to NEFBA. "I thought we could use it to showcase some of members' new products and then educate suppliers and the end user about them," he said. Chambers named it the NEFBA 2010 President's Project and began planning a series of on-site events for the building and design community to observe the construction. For Kozlowski, Chambers' new plan was extra incentive to cut costs. "In order to sell, it needed to be affordable. We turned it upside down to make it as cost effective as possible," Kozlowski says.

## Advanced Framing Cuts Costs & Energy

In addition to increasing awareness of raised wood foundations, the challenge highlighted ways to reduce energy consumption using advanced framing techniques in the wall and roof components.

**Wall Framing.** The walls, spaced at 24-inch on center to take advantage of in-line framing, were built with 2x6s so extra insulation could be installed. Headers located below gables or small truss spans were either eliminated or built with a plank orientated 2x\_ header. Headers above window and door openings in non-load bearing walls were also eliminated and the space filled with insulation.



**Wall Sheathing.** Instead of horizontal wall sheathing, 11' vertical sheathing panels run continuously from the top plate to the bottom plate. This technique minimizes energy loss that occurs in the horizontal seams. "The longer panel lengths allow a single sheet to be installed from the roof trusses to the support beam in the floor system. It removed the cost of the typical wall uplift connectors and various blocking requirements," Kozlowski said.

Continued on page 16

How a design competition in Florida became a study in using advanced framing techniques from floor to roof.

**"[This project] allowed us to show the marketplace that advanced construction techniques, enhanced energy efficiency, and high quality design can all come together in a budget conscious home."**

—Bob Esposito, True Design Studios

# Plans to Production

## ITWBCG has the tools to get the job done!

See the complete solution at BCMC 2010 in Charlotte!



project by: Millard Lumber Inc. Your Turnkey Building Solution Source

### Start with IntelliBuild wall panel software Finish with equipment from IBS, PFS & Alpine!

- Roof & Floor Truss Equipment • Fasteners for Component Applications
- Panel & Truss Cutting Systems • Full Line of Wall Panel Equipment



ITWBCG Equipment • 2820 N. Great Southwest Parkway • Grand Prairie, TX 75050 • 800-755-6005

For reader service, go to www.sbcmag.info/ibs.htm



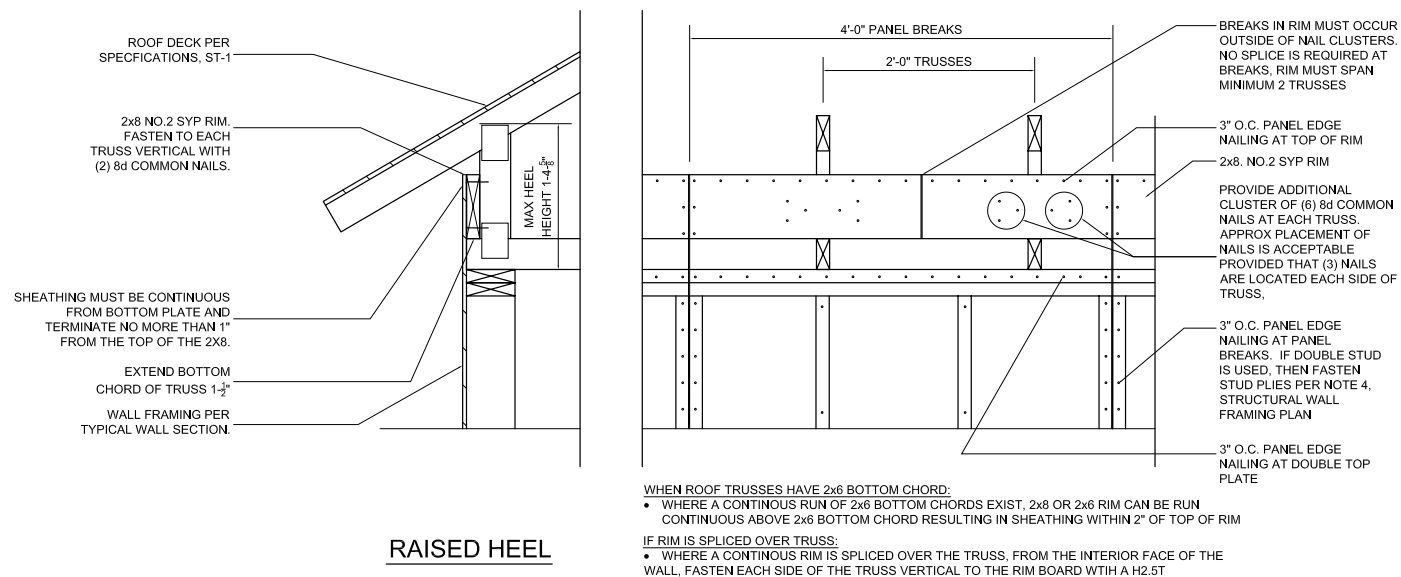

**RAISED HEEL**



**Roof Framing.** Raised heel trusses at height were installed to add a thick layer of insulation in the roof cavity. Kozlowski said the heel configuration was modified by holding back the end vertical 1-1/2" to allow for continuous 2x\_ rimboard (see detail above). The rimboard bears directly on the bottom chord and nails into the end vertical of the truss. The vertical wall sheathing extends to the top of this rimboard and braces the trusses while transferring the shear into the wall sheathing. Finally, the nailing of

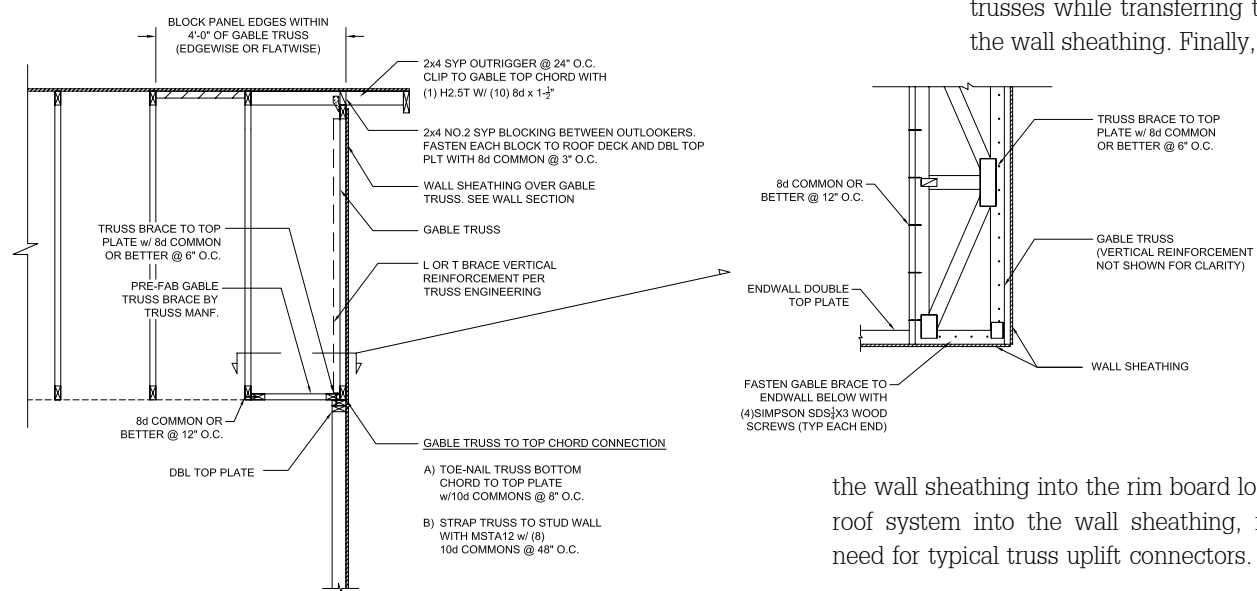

**C1 PRE-FAB TRUSS GABLE BRACING DETAIL**

- 1) GABLE TRUSS VERTICALS SHOULD BE SPACED @ 24" O.C. MAX.
- 2) MAX. TRUSS SPACING = 24" O.C.
- 3) OUTLOOKERS, BLOCKING & CUPS MAY BE OMITTED FROM OVERHANG PORTION OF DETAIL FOR NON-DROPPED GABLE TRUSSES W/ 12" OR LESS OVERHANGS.

the wall sheathing into the rim board locks the entire roof system into the wall sheathing, removing the need for typical truss uplift connectors.

Also in the roof, Kozlowski designed a gable brace truss to resist the out of plane wind loads. The truss installs flat between the first two truss bays and runs from wall to wall. This method reduced material and labor cost significantly. "We've been talking about it with framers for a while now, and we ended up wondering why we couldn't just lay a truss flat there," he said.

As an example of how little waste was produced

during framing, it was tough to scare up any loose framing lumber on site. "We had the rough-in trades looking for 2x4s... they couldn't find any!" Chambers recalled.

### Raised Floors Contribute to Energy Efficiency

Slab on grade foundations are prevalent in Florida, primarily because they are thought to cost less than raised floor foundations. "It's viewed as cheaper and less complicated," Esposito said.

He says the public should be aware that the advantages of foundations sitting on raised wood foundations range from aesthetic to structural. Esposito says raised floors add an element of sophistication and dimension to homes that slab on grade doesn't. Macomber points out that plumbing, water lines and other mechanical elements are often routed through the concrete, making it difficult or even impossible to reach for repairs or an addition. With this type of raised foundation, however, you can easily access and reroute plumbing.

Raised wood foundations elevate the lower portion of exterior walls above grade. This fact alone significantly reduces the effects of water on the lower portion of the wall. "Especially in humid climates like Florida, when moisture gets trapped in the foundation and has nowhere to go, it can easily climb up into the walls by way of capillary action," said Esposito. And though it wasn't done in this house, raised floors offer a space to house HVAC units and ducting. "Most homeowners have them in their attics, which have tremendous heat. Moving them to a cooler space like under the house makes them much more efficient," Macomber commented.

### 50% Reduction By 2019

Beyond cutting utility costs, Floridians have cause to adopt energy-conserving building techniques. In 2007, Governor Charlie Crist issued an Executive Order outlining a 50 percent cut in the energy consumption of new residential construction by 2019 (compared to the energy provisions of the 2007 Florida Building Code). The mandate is already in the works; between now and 2019, incremental efficiency goals ranging from five to ten percent have been defined for all new homes.

Macomber believes one of the reasons builders have been reluctant to incorporate advanced framing elements is because the homeowner tends to react to the extra up-front cost, but doesn't necessarily see the downstream savings. "I think the way builders should think about it is if energy costs are lower, homeowners can buy more house." It's important for homeowners to understand that energy efficiency isn't accomplished with one specific change, "it's several small changes that add two percent savings here, maybe five percent there," he said.

After seeing the ways components can be optimized to save material and improve efficiency, Chambers says he intends to use the techniques in future Master Craft homes. "I see now that we can do a lot of these things without adding cost but benefitting the end user tremendously," he said.

### A Classroom in the Field

Everyone from architects and engineers to building inspectors came by to see the home during its various phases of construction. APA organized and promoted four on-site events throughout the project. The first was held just after the piers and foundation were set. The second was to show off the wall framing (unsheathed) and the third event displayed the wall sheathing and installed ductwork. The final event was an open house to celebrate its completion. Macomber said on average, 65 to 85 designers, builders and building officials attended the events. "I think it really helped to stimulate their thoughts on different ways to use wood frame construction in efficient ways," Macomber said. Chambers says the house will be listed between \$150,000 and \$175,000.

Aside from the notoriety and recognition following its win, True Design Studios sees the project as a benefit from a marketing standpoint. "It's allowed us to show the marketplace that advanced construction techniques, enhanced energy efficiency, and high quality design can all come together in a budget conscious home," said Esposito.

Kozlowski believes what was accomplished on this project demonstrates what will someday be commonplace in homebuilding. "The advanced framing techniques we used are necessary when you're trying to take wood out and add insulation at the same time," he said. "Our [building] codes don't yet marry structural and energy requirements." And when they do, we'll have the NEFBA President's Project to learn from. **SBC**

[www.southernpine.com](http://www.southernpine.com) • [info@southernpine.com](mailto:info@southernpine.com)

For reader service, go to [www.sbcmag.info/spc.htm](http://www.sbcmag.info/spc.htm)





## Down Under Company Scoops Up Equipment Deals

by Libby Maurer

**Why an Australian manufacturer shipped two used machines from the U.S.**

**Y**ou've just invested in a piece of used equipment for your shop...in Australia. How will you get it? How long will it take? Getting component manufacturing equipment from point A to B requires coordination, expertise, time and care. The healthy offering of used equipment available in the marketplace means machines are being relocated to new places all over the U.S. and Canada, and sometimes even overseas! The U.S. housing downturn and recession means this equipment is not only readily available to manufacturers overseas, but the costs involved in the process have come down significantly.

Wonthaggi, Australia is a coastal town less than two hours' drive from Melbourne on the southeastern tip of the continent. It is home to Capeview Building Products, a manufacturer of roof and floor trusses and wall frames. The company recently bought two pieces of used equipment from 84 Components in Tampa, Florida and Knoxville, Tennessee. Wood Truss Systems, Inc., facilitated by Jay Halteman, brokered the deal.



Mark Warren, General Manager of Capeview, located the equipment on Halteman's website and saw exactly what he wanted. Warren said a combination of a growing market and fierce regional competition spurred an overhaul of the company's production operation. "This equipment is the next step in terms of automation for us. We needed something to increase our per-man production output," he said.

### Trifecta of Conditions Increases Buying Power of American Goods

Rock bottom machine prices, affordable overseas freight and favorable exchange rates have made transporting used equipment to Australia, New Zealand and even South Africa more feasible. "It's a substantial savings when you consider all three things," Halteman said. In addition to more than 100 U.S.-Canada transactions, Wood Truss Systems has executed 14 overseas transactions to Eastern Europe, parts of Asia, South America, South Africa and Australia.

"Unfortunately there's a lot of late model used equipment available for sometimes as low as 50 cents on the [U.S.] dollar," Halteman said. Simply put, shop closures attributed to the downturn/recession starting in 2008 have flooded the used equipment market, driving down the value of machines that were once selling for nearly twice what they are now.

Second, the U.S. dollar is not as strong as it once was against international currency. Because of this, manufacturers overseas are enjoying more buying power with their currency. As of this writing, the Australian dollar is worth .91 American dollars. That means an Australian company buying a \$1 million used machine today pays just \$1,100,000, whereas the same transaction would have cost 10-25 percent more several years ago. Companies in New Zealand, South Africa and Canada face a similar currency advantage.

When shipping goods overseas, freight charges often amount to a substantial portion of transaction's cost. Substantial enough, according to Halteman, to be a deal breaker for some companies. But the decline in international trade has made shipping far more affordable recently. "Fewer shipments around the world have brought the cost of freight down quite a bit," said Halteman, estimating shipping fees have dropped 20-30 percent from a year ago.

Warren said unlike the current state of the U.S. market, Australia's homebuilding industry has remained very strong. "We've had no downturn to speak of. We've had continued growth each year," he said, noting his company has about six solid weeks of work on the books.

"We've definitely taken advantage of selling overseas. There are some very viable companies who have opportunities for new business that we don't have in the U.S.," said Frank Kelcha, division controller for 84 Components. "The sale of this equipment benefits us by getting some cash flow back into our company." Kelcha says 84 has also sold equipment from closed facilities to operations in South Africa and Chile.

### Off to Sea

Curious about what happens when an exchange of goods goes international? Halteman says the multitude of arrangements and paperwork are required to meet international shipping regulations are quite extensive. However, the process



PENNSYLVANIA LUMBERMENS MUTUAL  
INSURANCE COMPANY

For over 100 years  
we've been protecting  
businesses just  
like yours.

Tomorrow  
we'll do  
the same.

wood is all we do.

At PLM, we understand that you need an insurance company with property and casualty insurance products and services that you can trust.

For over 100 years, our experts have been providing quality claims and risk management services to the lumber, woodworking and building material industries. Remember, "you get what you pay for." We understand wood. We know your business... because it's our business too.

If you're looking for quality and value from your insurance provider, give us a call.

Yesterday, Today, Tomorrow... grow knowing you're covered.

For more information, please contact the PLM Marketing Department at 800.752.1895 or log on to [www.plmins.com](http://www.plmins.com).

Pennsylvania Lumbermens Mutual Insurance Company  
One Commerce Square  
2005 Market Street, Suite 1200  
Philadelphia, PA 19103

*John Smith*

John K. Smith, CPCU  
President and Chief Executive Officer

For reader service, go to [www.sbcmag.info/plmins.htm](http://www.sbcmag.info/plmins.htm)

happens remarkably efficiently.

In March, Halteman and Warren struck a deal, agreeing to a "door to door rate:" the selling price plus the total cost of loading and freight from the equipment's origination point to delivery at Capeview's facility. "Door to door is the most common way of writing a deal because the buyer doesn't have to worry about transporting the equipment at all," said Halteman. Capeview purchased a trackless gantry system being stored disassembled at an 84 location in Atlanta. (The system originated from an 84 shop in Gibsonton, Florida.) The machine was packed into five shipping crates. The company also bought a trackless floor truss machine from a closed 84 plant in Knoxville, which needed to be broken down and was

Continued on page 20



# Essential BUSINESS PACKAGE

Logo Design: four logo designs to choose from!

Business Card Design:

- Four single-sided designs OR
- Two double-sided designs

Brochures Design:

One 8.5" x 11" tri- or bi-fold, full color flyer

Website Design:

- 45 minute initial consultation
- Three custom concepts to choose from: custom colors, menus and graphics
- Five pages
- Five email addresses

**Get started today!**

**GREAT PACKAGE RATE!**  
Call for details.

**Call today!**



**608/310-6723**  
**www.qualtim.com**

For reader service, go to [www.sbcmag.info/qualtim.htm](http://www.sbcmag.info/qualtim.htm)

## Down Under Company...Equipment Deals

Continued from page 19

packed into just one crate.

While domestic machines can be moved via truck or rail, overseas shipments have very strict packaging, loading and transport regulations. It is often wise or even necessary to contract with a shipping logistics company to ensure that the proper protocol is followed. The need for an export license, a government-issued license required to send certain items to foreign countries, is another good reason to use an exporter. Excluding shipments from the U.S. to Canada or Mexico (thanks to NAFTA), most overseas equipment shipments require an export license. In this case, Halteman brokered with an exporting company called CEVA Logistics to coordinate the overseas freight. CEVA helped Halteman coordinate ship dates, prepare paperwork, and provided the appropriate shipping containers. "A company shipping on their own will have to do a lot of legwork. I wouldn't want to risk getting fined for not following protocol," Halteman explained.

CEVA sent trucks with shipping containers to Atlanta and Knoxville. The seller is usually responsible for packing the machines in them. "A company like 84 will take a look at the dimensions of the machine and weight limitation of each crate. It takes quite a bit of coordination to do that," he says. The typical container size for this kind of equipment is 40'; 20' containers are occasionally used for overflow materials. As soon as the crates are sealed, the truck leaves for port.

## Post-911 Precautions

In a post-911 era, more restrictions on containers have been enforced. For instance, when a container arrives at the originating location, it must be filled within a two-hour window. A representative of the shipping company monitors the process.

"That container can't sit overnight. The idea is it's more secure to have a time limit. The longer it sits, the greater potential for someone to put something bad in it," says Halteman. He says containers don't sit idle at port either. "They're on the move the whole time."

Before the ship leaves port, several pieces of documentation must be in order: a certificate of origin (certifying that the machine(s) are of U.S. origin); a commercial invoice outlining the items purchased, their sale prices and documentation of freight insurance; and a packing list detailing all items, their weights, and counts for each container. A critical part of this process is assigning a harmonized tariff number (HTN) to the goods. The Harmonized Commodity Description and Coding System is a method for classifying internationally traded products. Tariffs are assessed on a product's

HTN. Every product traded in the world is given an HTN. CEVA helped Halteman organize this paperwork, and then he turned it over to them for processing.

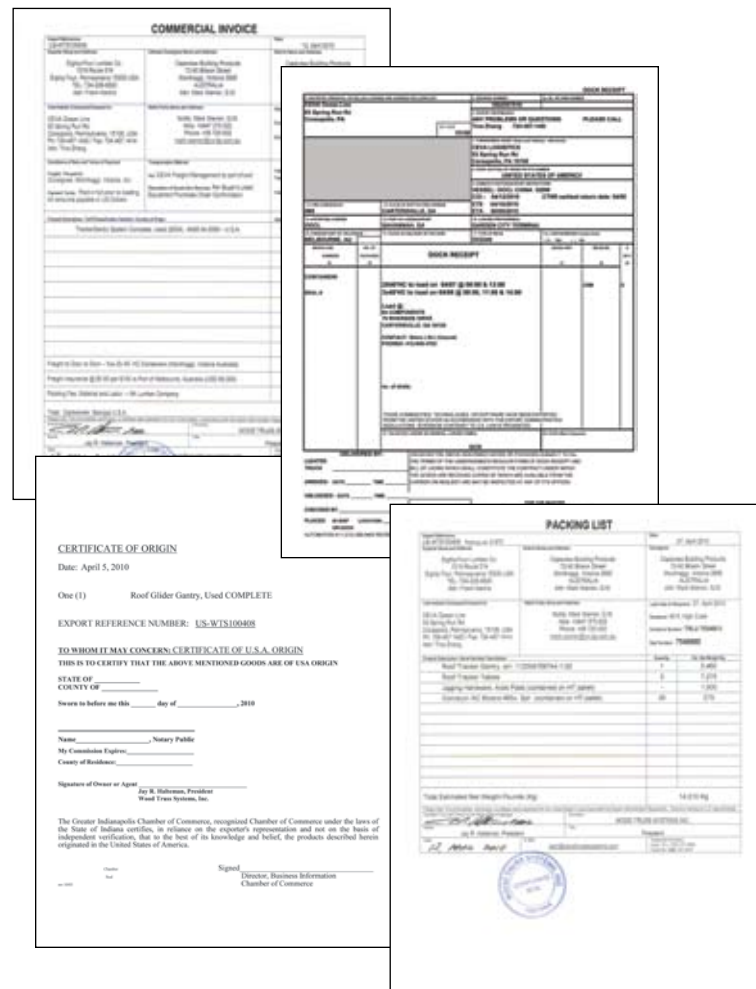

Halteman received notification when the ships left the U.S. port. Ocean transport to Australia takes roughly six weeks. On the other end, Capeview received notification when the ship was about a week from reaching port.

Warren said when the containers arrived in Melbourne, customs agents inspected each of the six containers, which meant unloading the contents of each one. They were then inspected for pests and contraband. Capeview was charged for unpacking and repacking the containers. "But other than that, getting it here was very simple. Nothing was damaged in shipping," said Warren. Finally, Capeview was assessed a tax for the incoming goods using the HTN.

In terms of installing its new machines, Capeview relied on instructions from the original equipment manufacturer. 84 went out of their way to accommodate Capeview, generously providing them with extra manuals and jiggling hardware. "These machines have completely transformed our operation. They allow us to increase through-put by two-thirds.

## Small Industry, Big Economic Impact

Interesting as it is to follow the path of such specialized equipment moving from one side of the world to the other, perhaps even more interesting is that the weak U.S. housing market has made it possible for an Australian company to make upgrades. "This is an example of how the changing U.S. economy affected even our small industry around the world," Halteman said.

Even though shutting down an operation and liquidating its assets is an unpleasant part of doing business, 84 made the best of it. "They have squared their shoulders and been extremely conscientious," Halteman commented. Kelcha said, "We all wish the industry was stronger right now." But, he added, "We're fortunate that there are livelier markets out there to buy this equipment." And although they've not met in person, Warren says the same about Wood Truss Systems. "I can't speak highly enough of them," he said. "I never saw the equipment...even though it came from the other side of the world." **SBC**

# The VIKING Combo-16

Framing & Sheathing on ONE Platform

Modular:  
16' long or  
60' long: we can  
build the length  
you need!

- Manual Stops
- Stud Locators 16" and 24" o/c
- Manual Frame Nailing
- Quick Disconnect Air Fittings for Hand Tools
- Automated Sheathing Nailing
  - Simple to Use Controls
  - Tilt Nailing
  - High Load Coil Capacity
  - Infinite o/c spacing
- Quick Change Tool Mounts
- 2x4, 2x6, and 2x8 capable
- Programmable for Under and Overhung Sheathing

Wall Panel Solutions That Fit Your Business Needs



**Viking Wall Panel Systems**  
800.328.3402  
[www.vikingeng.com](http://www.vikingeng.com)  
[info@vikingeng.com](mailto:info@vikingeng.com)

For reader service, go to [www.sbcmag.info/viking.htm](http://www.sbcmag.info/viking.htm)

**High strength for long spans and fewer girder plies**

**AN EXCELLENT VALUE**

**Master Chord™ LVL** may be used for plate connected trusses which require high-strength tension members—such as attic trusses, agricultural truss applications, girder trusses and long-span trusses.

- **Strength** = less jobsite damage & waste saving costs
- **Spruce** = requires less pressure for plate installation
- **Available** = in all standard I-joist depths
- **Values** = are included in major truss plate software for ease of design, engineering verification

**Strong • Lightweight • Stable • Call today!**

**Finnforest USA Natural Excellence.**  
[www.finnforestus.com](http://www.finnforestus.com)  
**[800] 622 5850**

**IN STOCK**

**finnforest**

For reader service, go to [www.sbcmag.info/finnforest.htm](http://www.sbcmag.info/finnforest.htm)



## FULL SCHEDULE

(Subject to Change)

### TUESDAY, SEPTEMBER 28

12p-6p Registration  
8a-4p Golf Outing  
2p-5p Your Business Lifeline  
6p-7:30p Business Solutions Group Summit

### WEDNESDAY, SEPTEMBER 29

7a-6p Registration  
7a-8a Continental Breakfast  
8a Welcome from BCMC Chair  
8a-9a Kick-off Presentation:  
Roger Crawford  
9a-6p Spouse/Guest Hospitality Room  
9:15a-10:30a Educational Sessions  
10a Spouse/Guest Orientation  
by Visit Charlotte  
10:30a-10:45a Coffee Break  
10:45a-12p Educational Sessions  
12:15p Ribbon Cutting Ceremony  
**12:15p-6p Exhibit Hall Open**  
5p-6p Welcome Reception  
5p BCMC Bowl Drawing

### THURSDAY, SEPTEMBER 30

7a-5p Registration  
7:30a-8a Sit-down Breakfast  
8a-9a SBCA Annual Meeting  
8a-5p Spouse/Guest Hospitality Room  
9:15a-10:30a Educational Sessions  
9:30a Spouse/Guest Tour  
**10:30a-5p Exhibit Hall Open**  
1p & 3:30p BCMC Bowl Drawings  
4p-5:15p Component Manufacturer  
Roundtables:  
Industry Issues

### FRIDAY, OCTOBER 1

8a-10a Registration  
7:30a-8a Continental Breakfast  
8a-9:30a Economic Forecast  
**9:30a-12:30p Exhibit Hall Open**  
8a-12:30p Spouse/Guest Hospitality  
Room  
11:30a BCMC Bowl Drawing  
12:30p Official Adjournment  
12:30p Plant Tour  
6:30p SBCA Top Chord Club &  
Board Dinner. All Are  
Welcome!

#### EXHIBIT INFORMATION:

Go to [bcmcshow.com](http://bcmcshow.com) to request additional information from an exhibitor.



**BUILDING  
COMMUNITY  
MAKING  
CONNECTIONS**



Visit [www.bcmcshow.com](http://www.bcmcshow.com) for exciting details about the 2010 show!

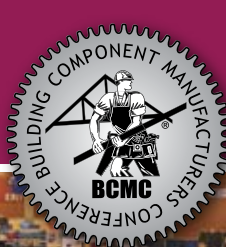

**COME FOR COMMUNITY, LEAVE WITH CONNECTIONS!**

### BCMC BUILD 2010

As part of our Building Community, Making Connections initiative, we are embarking on a meaningful and exciting project! BCMC has volunteered to partner with Habitat for Humanity to fund and build a single-family home in the Charlotte area during the week of BCMC. Visit [bcmcshow.com/bcmcbuild.php](http://bcmcshow.com/bcmcbuild.php) to find out ways you can participate.



### LEARNING & CONNECTING

New this year, BCMC is launching a program where you can take advantage of educational or focus group sessions provided by exhibitors on the show floor. The goal is to provide attendees additional opportunities to exchange ideas and learn with experts in the industry.

### KICK-OFF PRESENTATION: Roger Crawford Wednesday, September 29 • 8:00 a.m.

Roger is a living example that all of us have the capacity to achieve great success, despite the obstacles. Although physically challenged, he was an award winning NCAA Division One college athlete and has been inducted into three different halls of fame. Roger has appeared on Larry King Live, Good Morning America and CNBC. He has also been featured in publications such as *USA Today*, *Sports Illustrated* and *Tennis magazine* along with the book, *Chicken Soup for the Soul*. We are so excited to have Roger kick off the show!



*Take the cost of going to BCMC and multiply by 10.  
That's the value I get out of BCMC every year!*

—Jason Blenker, Blenker Building Systems

**Community • BCMC Build • Friends • Preventative Maintenance • Networking • Lean Six Sigma  
Fun • Used Equipment • Economic Forecast • Connections • New Software • Innovate • Golf  
Technology • Ideas • Design Tips • Business Solutions Group • Profit Mastery**

### GOLF OUTING

**Tuesday, September 28 • 8:00 a.m.**

Olde Sycamore Golf Plantation is a golfing pleasure nestled among a mature forest of hardwoods. This semi-private course was recognized as the "Best New Course" and "Best Eastside Course" in the Queen City by Charlotte's Best Magazine. All skill levels and ages can enjoy the beauty of Olde Sycamore located minutes from Uptown Charlotte. Go to [bcmcshow.com](http://bcmcshow.com) to register online or to download the golf registration form.

### ECONOMIC FORECAST: Mark Vitner Friday, October 1 • 8:00 a.m.

Mark Vitner is a managing director and senior economist at Wells Fargo, responsible for tracking U.S. and regional economic trends. He provides regular updates on the housing markets, commercial real estate, regional economies, and inflation.



Mark's commentary has been featured in the *New York Times*, *Wall Street Journal*, *BusinessWeek*, and many other publications.

*The BCMC show is great way to get the very latest market knowledge, make informed decisions about your business, and accomplish several supplier or business meetings in just a few days, to save hundreds of dollars in travel expenses. It makes good business sense.*

—Gregg Renner, MiTek

FOLLOW US ON facebook



## EXHIBITOR PROFILES

Current as of 8/17/10

### AbitibiBowater\*

AbitibiBowater is one of the leading North American lumber producers with a capacity exceeding 2.0 billion board feet. From 2 x 3, 2 x 10 and #2 grades and better, to high MSR grades and premium grades, we have what you need. Come and see us!

### Aegis Metal Framing

Aegis Metal Framing, a division of MiTek is a leading supplier of products, software, and engineering to the pre-fabricated steel components industry. Our Ultra-Span® truss system, TradeReady® floor joists, and WallSolutions™ panels offer component manufacturers a full line of cost-effective structural solutions. All products are supported with advanced software and comprehensive engineering services.

### Alpine Engineered Products - ITW Building Components Group

Alpine software offers manufacturers more ways to streamline component design and business management tasks. Alpine's powerful software handles "whole house" design, from the first floor to walls all the way to the roof. See it for yourself—one integrated system for trusses, hardware, wall panels, engineered wood products and conventional framing!

### Alpine Equipment - ITW Building Components Group

Let Alpine Equipment (a division of ITW BCG Equipment) show you how we can help improve your bottom line. See the latest in cutting technology with the Linear Express Saw! Our staff is the most skilled in the industry we assist with financing, plant layout, installation, parts, service and maintenance plans—whatever it takes!

### Alpine Systems Corporation - ITW Building Components Group

Alpine Systems is a full service supplier of metal connector plates and truss hangers to wood truss manufacturers across Canada. Alpine's full line of products and services includes complete engineering service; proprietary software, support and training; and a complete line of cutting, assembly and material handling equipment for truss and wall panel manufacturers.

### AmeriCAD - VisionRez - ITW Building Components Group

VisionREZ by Ameri-CAD bridges the gap between architectural and manufacturing with purpose-built residential Building Information Model (BIM) data.

### Automatic Stamping, LLC

Automatic Stamping, LLC is a manufacturer of metal truss plates. Come visit our booth to see the new "AS20" truss plate and the new "AS-18-HS" truss plate where dependability and customer service is our number one priority.

### Beadles Lumber Company

#1 wane graded and stamped MSR. Quality MSR and visually graded Southern Yellow Pine lumber. Stock generated from Longleaf and Slash timber with an average age of 45 years. Grown

in the heart of the Coastal Plain; dense, straight grain, off the chart strength values.

### Blackpoint Builder Services

Blackpoint Builder Services is an integrated, 3D Lean-Design solution for Builders to transform 2D plans into Blackpoint-Enabled 3D BIMs, and a web-based collaboration portal to manage all product information between stakeholders. Blackpoint's Drafting Service team works with your existing designs to Blackpoint-Enable your plans using Autodesk ACA.

### Canadian Wood Products Montreal Inc.

CWP focuses its efforts on certain specialty products in order to offer a service of high quality. Our traders are in touch with forest products suppliers around the world and they can help you find what you need. The following products constitute our specialties: Certified Lumber, Commodities, Export, MSR lumber, Premium Lumber, and Tropical Wood.

### Cargotec USA Inc.

Cargotec USA Inc. is the nation wide material handling distributor of HIAB truck mounted cranes and Moffett truck mounted forklifts. We provide--Total Care--a service equipment program. For additional product information, please contact (800) 852-2331 for a Sales Representative near you.

### Carolina Strapping and Buckles Company

Carolina Strapping and Buckles Company is a leading manufacturer of woven, composite and bonded strapping/lashing products based in Gastonia, NC. Our GatorSTRAP, MakoSTRAP, ZippSTRAP and GatorLASH are used extensively throughout the building component industry. These products deliver safety, savings and convenience compared to traditional steel banding and ratchet straps.

### Clark Industries, Inc.

See ad on page 30

CII's standard equipment line includes roof & floor truss presses, jack presses, column & post laminators, vertical & horizontal truss stackers, conveyors, etc. We enjoy assisting companies with unique or special equipment requirements and stress quality, reliability, and continued support. Please visit our booth to learn how CII can help you.

Contact: Mr. Jared Schulz • 417-235-7182 • 417-235-8262  
jared@clark-ind.com • www.clark-ind.com

### Cold-Formed Steel Council

SBCA established the Cold-Formed Steel Council (CFSC) to focus on issues that affect manufacturers of steel structural building components. The goal of CFSC is to protect and educate component manufacturers through risk management and training material. Stop by our booth to see all of CFSC's new products and services.

### Component Runner, LLC

Component Runner, LLC is a design outsourcing firm exclusively for MiTek Software Suite customers. They provide building modeling and truss design services for both estimating and production. Component Runner uses a design team approach delivering high quality at affordable prices. Come visit us inside the MiTek booth.

### Cordstrap USA

Cordstrap® is the world leading manufacturer of corded polyester strapping and one-way load securing systems. AAR certified Cordstrap® provides customers with a safe and cost-efficient alternative to steel banding and other conventional transport packaging materials. Since 1965, Cordstrap's mission is to solve strapping, transport and load securing complexities for customers worldwide.

### Custom-Arch

Arches by Custom-Arch are pre-fabricated to the exact specifications of our homebuilder customers. Our wooden arches are pre-mitered to slip into your panels with ease and nail in place quickly with your standard nail guns. Perfect curvature, strong, durable, and economical...If you want to add value to your wall panels by installing arches, you owe it to yourself to consider Custom-Arch.

### DANSCO ENGINEERING, LLC

Dansco can provide your company with wood and steel truss seals, sealed repairs, permanent bracing plans and layouts in 29 states currently. Dansco prides itself in providing faster turnaround times at a lower cost than many of our competitors as well as achieving and maintaining 100% customer satisfaction time after time.

### Deacom, Inc.

The DEACOM Enterprise Resource Planning (ERP) Software System is designed for lumber dealers and building component manufacturers. DEACOM simply manages all areas of your company—from engineering software links and inventory control, to order entry and accounting—giving you a comprehensive view of your entire operation from one system.

### Eagle Metal Products

See ad on page 30

Serving the component industry for more than 20 years with connector plates, design software, engineering services and manufacturing equipment, Eagle Metal is committed to providing exceptional products and customer service. Manufacturers across the country are discovering the advantages. Visit our booth to learn more. Eagle Metal...Engineered. Tested. True.®

Contact: Mr. Carl Schoening • 800-521-3245 • 972-888-9966  
carl@eaglemetal.com • www.eaglemetal.com

### Eide

See ad on page 6

WizardPDS® is the world's leading automated truss jig system and the first to virtually eliminate ALL setup time and manual jigging at the assembly table. WizardPDS® technology will retrofit with virtually any new or existing truss manufacturing system. Powerful WizardPDS® Gold software offers Truss Projection & Laser Integration features.

Contact: Mr. G. Mitchell Eide • 612-521-9193 • 612-521-9307  
mitch@eidemachinery.com • www.eideintegratedsystems.com

### Engineered Wood Council

SBCA's Engineered Wood Council represents the interests of SBCA members who distribute engineered wood products. Projects include publications and educational programs.

KEY: Gold SBC Advertiser • Silver SBC Advertiser • Bronze SBC Advertiser • Asterisk (\*) indicates a new exhibitor

### Essetre - Timber Tools\*

Essetre has been a leading manufacturer of CNC machinery for over 30 years. Timber Tools introduces Techno-Turn - a CNC system that processes dimensional lumber, I-joist and timber trusses, which allows flexibility in all of your business opportunities. Other products are, Techno PF/PM Joinery systems; Techno Wall: SIP and solid wood.

### FastenMaster

FastenMaster is a brand of task specific contractor quality fasteners engineered to enable a PRO to complete a project Faster, Easier, Stronger.

### Finnforest US

See ad on page 21

Finnforest USA, engineered Wood Division is a manufacturer and importer of Master Plank LVL, Master Q-LVL, Finland Birch Plywood for the residential and light commercial building industry, mobile/modular industry, scaffold rental/erection business, along with a variety of industrial applications.

Contact: Mr. Robert Loew • 800-622-5850 • 586-296-8773  
robert.loew@finnforest.com • www.finnforestus.com

### Georgia-Pacific Wood Products LLC

Georgia-Pacific Wood Products operates fourteen Southern Pine lumber mills located in North Carolina, South Carolina, Georgia, Alabama, Mississippi, Arkansas and Texas. Primary production is 2x4's in 6'-20' lengths, including 7'. Grades include DSS, SS, #1, #2 and #3.

### GerryRigs LLC

"Self-Storing" Truss-to-Truss and Truss-to-Bearing Connectors. Deliver your trusses "Installation Ready" with GR-1 and GR-3, the only Truss Framing Connectors designed to be Pre-Installed at the point of fabrication. Eliminate supply and handling of bracing materials on-site, reduce labor, increase safety.

### GILMAN BUILDING PRODUCTS, LLC

Gilman Building Products Company is a quality Southern Yellow Pine manufacturer servicing the truss industry since 1972. Gilman's annual production of SYP lumber exceeds 600 million board feet per year with 75% of production going directly to the truss and component manufacturing industry. We invite our current customers and friends to stop by and visit, as well as prospective customers in the truss industry that are not currently doing business with us.

### Hardy Frames

Hardy Frames, Inc. manufactures and markets the revolutionary Hardy Frame® shear wall system and have been the leader in the pre-fabricated shear wall industry for over a decade. The Hardy Frame® system allows Building Design Professionals to economically and safely minimize wall space and maximize wall openings while resisting high wind and earthquake loads.

### HOLTEC USA Corporation

We are the worldwide leader in package crosscut systems. Our Transcut® II Portable Crosscut Saw is affordably priced at \$7900 for cutting whole bunks of lumber of length and our Precision Crosscut Systems are in use by over 7,000 customers worldwide to PET in less than one minute per cut.



### hsbCAD - ITW Building Components Group

Take AutoCAD or AutoCAD Architecture to a whole new dimension. If you are manufacturing Timber Frame, Steel Frame, Sips' or Log Homes; hsbCAD is the solution you require.

### Hundegger USA, L.C.

Hundegger has manufactured the building industry's leading CNC machinery for over 30 years, and is known for quality and versatility. Products include: the #1 selling Joinery saw; Gantry-style SIPS saws; 4-sided Planers; a component, I-Joist, and Timber Framing saw; and a new linear SIP Saw.

### Integrated Stealth Technology

Integrated Stealth Technology will be showing a new product that we have come out with this year at the 2010 BCMC Show. This automated system will cut your setup time drastically. We also have rebuilt machines. Stop by and let us see what we can do for you.

### Intelligent Building Systems - ITW Building Components Group

See ad on page 15

Intelligent Building Systems (IBS) offers a COMPLETE WALL PANEL SYSTEM; from fully integrated design software, to industry leading semi automated & automated wall panel equipment that includes a "production reporting system" for the plant. IBS was solely created and developed by wall panel experts for the wall panel industry and continues today to provide the industry with leading edge technology.

Contact: Mr. Jack VanCleave • 800-755-6005  
jvancleave@itwbcg.com • www.intelbuildsys.com

### International Beams

International Beams Engineered Wood Products are recognized as an innovative solution to the industry's floor and roof framing requirements; The Green Building Solution. We have a full EWP product line of the highest quality that is known for strength, visual appearance, and cost effectiveness. International Beams is a 100% independently owned company.

### ITW Building Components Group

See ad on back cover

ITW Building Components Group is the leading supplier of innovative products and services for the building component industry. We offer engineering services, design & management software, cutting and manufacturing equipment for truss and wall components, floor truss metal webs, metal truss connector plates, cold-formed steel chords/webs/fasteners, and construction hardware.

Contact: Mr. Ken Kuehn • 800-521-9790  
kkuehn@itwbcg.com • www.itwbcg.com

### ITW BCG Hardware - ITW Building Components Group

ITW Building Components Group is proud to introduce a complete line of construction hardware and software solutions based on our extensive engineering expertise—all designed to create more value for you! Quality buildings start with smart design software and connections from ITW BCG Hardware.

### Keymark Enterprises, LLC

Whole House Design, Single Building Model Technology, Building Information Modeling—Keymark is your one stop shop for integrated floor, wall & roof design software, as well as truss plate supply, engineering services, machinery interfaces, and pre-cut expertise. Visit Keymark's booth at this year's BCMC.

### Lakeside Trailer Mfg., Inc.

See ad on page 13

Stop by the Lakeside Trailer booth to get all the newest & latest improvements in delivery of components. Unbelievably reduced show prices on all models. We have made over 1,700 truss trailers since 1987.

Contact: Mr. Lee J. Kinsman • 573-736-2966 • 573-736-5515  
lee@rollerbed.com • www.rollerbed.com

### Lamco Forest Products

We manufacture product design optimization in floor, wall (tall studs), header, truss, perimeter and roof systems. Strong Design Values (1.5E, 1.6E, 1.8E and 2.0E); Customization: exact widths 2 1/2" to 16", exact lengths up to 32', in increments of 1/16". Lamco advantages: 100% useable, wane free edges, <14% moisture, dimensional stability, less twisting, flexibility in height restricted projects, less glue, long spans, no special tools needed to drill/nail, reduces waste, good for fire rated assembly & no need to cut big trees anymore!

### MangoTech USA LLC

"Providing Fresh Automated Solutions Globally" MangoTech provides fresh automated solutions to the building components industry. Beginning with the cutting process, the APOLLO and ACE LINEAR SAW offer fresh automation. The M.A.L. JIGGING SYSTEM offers an onsite retrofit. The WALL EXTRUDER is redefining the way walls are built.

### Masengill Machinery Company, Inc.\*

See ad on page 11

Masengill Machinery is one of the southeast's largest reconditioners of used woodworking machinery. In addition to stock on-hand and the computerized inventory of the UWME (United Woodworking Machinery Exchange), Masengill offers a locating service for reworked machinery to local, regional, national and international customers. We also offer exclusive and open lines in new machinery as well.

Contact: Mr. Wayne Masengill • 888-873-9663 • 423-586-0483  
waynem@masengills.com • www.masengills.com

### Metriguard

The world's leading provider of precision equipment for Machine Lumber Grading (MSR & MEL), Veneer Testing (LVL), Bending & Tension Testing (Quality Control) and Structural Panels (OSB & Plywood).

### Metwood Building Solutions

Metwood structural products are extremely adaptable to all building systems. TUFFBEAM and TUFFJOIST are two examples of structural products that create flexibility in design and increased structural integrity. NUJOIST Distributor. If you need structural components for girders, headers, decks, trusses and more then stop by our booth.

### MiTek

See ads on pages 2-3 & 9

At MiTek we continue to invest in your future through software, machinery, technical support and builders' products. The goal? Bottom-line benefits to your business in any market. Our Focus is on your business—performance, improved productivity and greater accuracy when you need it the most.

Contact: Mr. Michael Klein • 314-434-1200 • 314-434-5343  
MKlein@mii.com • www.mii.com/unitedstates

### Monet DeSaw Inc.

Monet DeSaw Inc. is a company where Engineering and Service collide, bringing you the most sought after cutting and material handling equipment available today. Our linear saw has proven to be the most cost effective saw and our floor web and DeSawyer 2000 fully automated saws are the most reliable.

### MSR Lumber Producers Council

Emphasizing its higher quality, longer spans, and better lifetime performance, we will let you know how you can benefit directly from using MSR lumber at your component manufacturing operation. We welcome your feedback on what you would like to see next from your MSR producers, too!

### Nordic Engineered Wood

Nordic produces competitively priced wood I-joists and glulam building products. The company is ISO 14001 certified, manages over 2 million acres of forests and is FSC certified. Nordic Lam™ beams, headers, columns and tall wall studs feature an exclusive EnviroLam™ technology—a process that minimizes waste and optimizes fiber use.

### Palfinger North America

PALFINGER, a world leading manufacturer of knuckle-boom cranes, offers over 40 different models of cranes that provide a wide range of lifting capacities and reach. We offer 6 models of truck-mounted forklifts with lifting capacities ranging up to 6500 lbs. to help you deliver building materials to the worksite.

### Panel Fastening Systems - ITW Building Components Group

ITW Panel Fastening Systems (a division of ITW BCG Equipment) is a supplier of pneumatic and Cordless nailing, stapling tools and fasteners for the wood panel industry. We offer Paslode, Duo-Fast and ToolMatic brand tools and fasteners. Our tools are compatible with all U.S. and European automated panel equipment.

### PANELS PLUS

See ad on page 12

Panels Plus has different options for wall panel lines. From the space saving expandable Combo Table line to our Multi Table lines, we offer a fully customizable package to meet your needs. The

newest offering from Panels Plus is the Tilt Table. This table can be used for blocking, window and door installation and more. We have added options to our CN100 Component Nailer to include a pusher and component stacking options as well. From 1' to 76' walls, Panels Plus offers a safe, robust, easy to operate and maintain, line of equipment.

Contact: Mr. Tim Kaasa • 866-726-7587 • 507-369-0524  
tkaasa@panplus.com • www.panplus.com

### Pennsylvania Lumbermens Mutual Insurance Co.

See ad on page 19

PLM specializes in Property and Casualty insurance for the lumber, woodworking and building material industries. We offer competitive rates, loss control programs and prompt claims handling. We carry an A.M. Best rating of A (Excellent). For more information call 800-752-1895 or visit our booth to learn more about our services.

Contact: Ms. Charlotte Friend • 800-752-1895 • 215-625-9097  
cfriend@plmins.com • www.plmins.com

### Princeton Delivery Systems

Princeton Delivery Systems is the leading U.S. truck mounted forklift manufacturer. We offer 4 PiggyBack® Delivery System models designed for building material applications. The 4-Way is designed to carry long loads through narrow openings. PB80 will handle prefabricated wall panels. PB50 is unequalled in rough terrain performance. PB45 is ideal for medium loads on single axle trucks.

### Qualtim, Inc.

See ad on page 20

Qualtim is a technical marketing group offering a range of creative and technical services, from advertising and website development to online training and truss testing. Qualtim has the right solution to fit your unique business needs and interests. Our strength lies in the individual expertise of our team members.

Contact: Ms. Peggy S. Meskan • 608-271-1176 • 608-271-7006  
pmeskan@qualtim.com • www.qualtim.com

### RAND Manufacturing, Inc.

### Rayonier Wood Products

Rayonier Wood Products manufactures high quality Southern Yellow Pine lumber. Rayonier is a quality-driven, service focused company. Our production facilities give us the flexibility to offer customers the highest quality products for use in construction, remodeling and decorative applications. We have been producing top-grade lumber products since 1926.

### Robbins Lumber Company

Robbins Lumber offers distribution centers throughout the Midwest specializing in MSR Pine and MSR spruce lumber. We have office locations in Florida, Michigan and Chicago, IL. Stop by our booth and let us show you our commitment to customer satisfaction.

### SBC Research Institute

The SBC Research Institute (SBCRI) offers an extensive list of testing options under a variety of application, attachment and loading conditions, all of which will lead to more accurate and efficient design and improved installation/use of products. SBCRI has ISO/IEC 17025 ACLASS accreditation.

I attended the BCMC preview presentation that Jim Thomas did for the last SBCA Annual Workshop session and it was without a doubt the best one ever. The BCMC presentation on Thursday on Lean Six Sigma Gives Trussway "New Eyes" will be a great take home event and one not to be missed. This session alone is reason to get yourself and your management team to this year's show.

—Stan Sias, Simpson Strong-Tie



### Senco Brands, Inc.

For almost 60 years Senco has been the worldwide leader in fastening systems, providing a wide range of products to meet the needs of the building industry. With manufacturing in the USA, Latin America, Asia and Europe, Senco is a leader in pneumatic, battery, gas and electric-operated stapling, nailing, collated fasteners and screw systems.

### Simpson Strong-Tie

See ad on page 11

Simpson Strong-Tie Company is the world's largest manufacturer of steel connectors for wood construction. The product line totals 7,000 items, with more than 1,700 different joist hangers alone. Strong-Tie® connectors for solid timber, composite wood products & plated trusses are the most specified of any brand.

Contact: Ms. Frankie Emerson • 925-560-9000 • 925-847-1603  
femerson@strongtie.com • www.strongtie.com

### SL-Laser Systems

Founded in 1988, SL Laser has been a pioneering force in the development of precision single and multiple head laser projection systems for truss, floor deck and wall panel systems. Our patented hardware and state-of-the-art software feature many user-friendly features designed to enhance functionality, while prompting the easy-to-use fundamentals that make our systems the industry benchmark. Seamless integration between TrussPilot™ software and hardware results in reduction of production costs and an increase in accuracy and profitability. Our Laser Systems can be found projecting increased productivity in some of the finest building components manufacturing companies in the world.

### SpaceJoist TE - ITW Building Components Group

Capture a growing market with SpaceJoist, the industry standard and lightest open-web floor joist available. This truly unique truss system combines the best features of a wood I-joist and an open metal web floor truss to deliver a quality product for maximum efficiency. SpaceJoist is the premier floor system for both commercial and residential applications. Stop by our booth to see how this INNOVATIVE product can benefit your company.

### Spotnails

Spotnails has been one of the leading manufacturers of pneumatically driven fasteners for nearly 70 years. The Company manufactures a wide range of industrial fastening products including nails, staples, pins, brads and tools for use in packaging, furniture/woodworking, construction, factory-built housing and many other industries. With manufacturing facilities in the United States, Mexico and Korea, Spotnails is keeping pace with the demand for quality tools and fasteners.

### Structural Building Components Association

See ad on page 31

Representing component manufacturers, builders, material suppliers and industry professionals, SBCA provides the tools to protect and grow your business. Whether it's educational resources, risk management strategies, building code watch, financial/wage surveys, legislative alerts, in-plant safety and quality control, transportation issues, technical training or marketing plans, SBCA provides tangible benefits to members.

Contact: Ms. Anna L. Stamm • 608-274-4849 • 608-274-3329  
astamm@sbcindustry.com • www.sbcindustry.com

### Structural Building Components Magazine

Your Industry...Your Ideas...Your Magazine! Structural Building Components (SBC) Magazine is the component industry's primary resource for leading-edge information about current issues, trends and products that affect the future of framing. SBC staff welcomes your feedback and article ideas at editor@sbcimag.info.

### Taiga Building Products\*

Taiga Building Products is the premiere supplier to the building products industry in Canada. The exclusive distributor of Louisiana Pacific's Engineered Wood Products and the Master Licensee and partner of Keymark software, Taiga brings together product expertise, quality products and industry leading distribution services.

### Timber Products Inspection, Inc.

TP provides superior quality assurance programs and services to the forest products industry. This is accomplished by providing timely, cost effective services, thorough and accurate inspections, and exemplary customer service. These duties are performed by an energetic, highly trained, and experienced staff.

### Truss Plate Council

SBCA's Truss Plate Council acts as a forum and a resource for the companies that supply truss plates and component design software.

### Truss Plate Institute

The Truss Plate Institute (TPI) and its members are connecting the truss industry. Stop by our booth to learn about our nationally recognized 3rd Party Quality Assurance Inspection program, to learn about the ANSI/TPI 1 -2007 standard, and to review and ask questions about other guidelines and technical publications such as BCSI!

### Trussoft, llc

Trussoft, llc is developing a totally new, plate independent, software suite for analyzing roof trusses and frames. Though still in the development stages, TrusserPE is already proving itself more than capable of analyzing even the most demanding designs.

### TrusSteel - ITW Building Components Group

TrusSteel is the culmination of over fifty years combined experience in truss and Cold-Formed Steel building products. The product line is built upon the extensive truss engineering and software knowledge inherent in all our products, an experienced staff of CFS design engineers, and many years of designing and building efficient trusses.

### Truswal Systems -

### ITW Building Components Group

Truswal Systems offers programs for component design, engineering, building layout and truss plant management. Intellibuild whole house design software utilizes the power of parametrics, which allows all design modifications to instantly flow through the entire structure.

### USP Structural Connectors

USP Structural Connectors serves the residential and commercial building industries throughout the U.S. and Canada. Our product line encompasses over 3000 parts, including a line of connectors for the Engineered Lumber and Plated Truss industries and is backed by an in-house engineering staff, technical assistance team and customer service.

### Vekta Automation\*

The Razer linear saw is proudly presented by Vekta Automation. Stop by our booth to find out how the Razer V5 saw can provide a cost effective solution to your cutting needs.

### Virtek

Virtek is the leading developer of precision laser-based solutions enabling component manufacturers to produce products faster, better and at lower costs. The Virtek TrussLine Laser Projection System, with new green lasers that provides improved visibility with new software that features improved usability, real-time production status, and reporting functionality.

### Wall Panel Council

SBCA's Wall Panel Council provides information and resources for the manufacturers of wood wall panels and their suppliers, and it will assist them as they act to expand the market for their products.

### Wasserman & Associates, Inc.

See ad on page 13

Wasserman & Associates is a representative for new truss, wall panel, stair, door and finger-jointing equipment. We also offer the option of used or reconditioned equipment. As a partner in your equipment selection process, we promote the equipment that best suits your individual requirements, not the equipment that optimizes our commission.

Contact: Mr. Rod Wasserman • 402-438-2161 • 402-438-2524  
rodwass@aol.com • www.wasserman-associates.com

### West Fraser

West Fraser is a leading manufacturer of softwood lumber and engineered wood products including MSR, MEL, MDF, LVL and Plywood. The Company has been in business for over 55 years and has more than 30 plants throughout North America. Please come by and visit our booth.

### Wood Truss Council

The Wood Truss Council (WTCA) is SBCA's largest council. Representing the wood structural building components industry in the U.S., Canada and internationally, WTCA provides a comprehensive supply of tools and resources for wood truss manufacturers.

### Wood Truss Sytems, Inc.

See ad on page 30

USED/NEW EQUIPMENT—Fully independent, we search from top suppliers and our large listing of used equipment to develop the right solution for you. WTS offers you the ability to custom design your own used systems for: Truss and Wall Panel Equipment, Saws, Material Handling, and much more.

Contact: Mr. Jay R. Halteman • 888-288-9874 • 888-751-9914  
jayh@woodtrussystems.com • www.woodtrussystems.com

## BCMC BOWL & MEGA DRAWING

Many exciting drawings and giveaways will be featured at the show! We will keep you posted about the newest prospects at [bcmcshow.com](http://bcmcshow.com). Keep your ear to the ground and WIN!



For more in-depth information on **BCMC** and the following topics please go to [bcmcshow.com](http://bcmcshow.com)

- Online registration information
- Housing information
- Transportation information
- How to win a free registration
- Loyalty rewards program

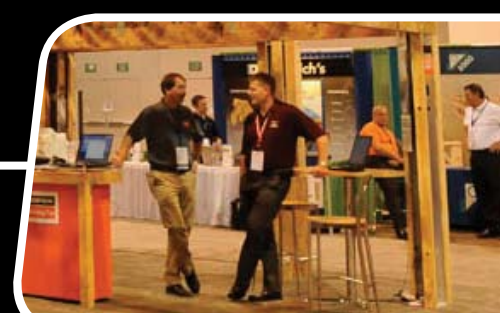



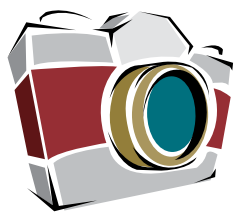

## Parting Shots

Share your stories and photos with us! Send submissions to [partingshots@sbcimag.info](mailto:partingshots@sbcimag.info).



Neither rain, nor heat, nor a poor golf game kept some SBCA Chapter members from attending meetings this summer. Several chapters held meetings in July, and a couple even remembered their cameras!

Taking a break from their usual summer outing to an Orioles game, Capital Area Chapter members (above left) played a rousing game of golf at Mattaponi Springs in Ruther Glen, VA. Ever the professionals, they held a meeting over lunch in the clubhouse. Pictured at the table from left to right are: Rusty Airington, Shawn Kelly, Kevin Friday, Teri Miller, John Beamer, Chris Johnson, John Green, Mike Wolfe and Rick Dyson.



Beginning a new series of plant tours at members' locations, the Northeast Chapter (above right) was welcomed for a meeting, lunch and tour at FastenMaster in Agawam, MA. Pictured from left to right are: Brice Hereford, Gunner Isaacson, Steve Archer, Brad Ferris, Josh Bartlett, Steve Noon, John Jacksics, Joe Kannappell and John Underwood. Just drop a note to [chapters@sbcindustry.com](mailto:chapters@sbcindustry.com) if you'd like to receive an invite to the next tour! **SBC**

Do you have a Parting Shot you would like to share with the industry? Email [editor@sbcimag.info](mailto:editor@sbcimag.info) with your photos and story.

# REACH FOR EXCELLENCE

## Take Your Plant to New Heights with SCORE



"In order to succeed, our customers need to know they can count on us to provide what's needed. Working with SBCA and becoming SCORE certified proves we are committed to excellence."

- Steve Kennedy, Engineer/Training Manager, Lumber Specialties

Set your company apart with SCORE's certification program that incorporates all of SBCA's education and training programs - helping you implement cost-effective industry best practices. Learn more about options and how to get started at [www.sbcindustry.com/score.php](http://www.sbcindustry.com/score.php).



**Wood Truss Systems inc.**  
MANUFACTURERS' REPRESENTATIVES

Truss and wood component machinery experts for over 30 years. We can help you enter the component industry or refine your existing facility with custom equipment solutions featuring:

**New & Used**

- ▲ Truss Production Equipment
- ▲ Wall Panel Framing Equipment
- ▲ Automatic & Manual Cutting Equipment: Component, Radial Arm, Linear Single Blade Saws
- ▲ Plant Layouts / Production Consultants
- ▲ Automated Jigging Systems
- ▲ Automated Mesuring Devices
- ▲ Replacement Production Surfaces

*Count on effective, economical and timely solutions.*

[www.WoodTrussSystems.com](http://www.WoodTrussSystems.com)

888.288.WTSI (9874)

For reader service, go to [www.sbcimag.info/wts.htm](http://www.sbcimag.info/wts.htm).

**EAGLE METAL**

**True.**

As a family owned, full-service plate supplier, Eagle Metal serves independent truss manufacturers. For more than 20 years, we have provided component manufacturers with quality connector products, structural component software and dependable, customer-first support.

**Partner with us today.**

Connector Products • Structural Component Software • Customer-First Support

[eaglemetal.com](http://eaglemetal.com) • 1-800-521-3245

For reader service, go to [www.sbcimag.info/eagle.htm](http://www.sbcimag.info/eagle.htm)

**Clark Industries, Inc.**  
Since 1967 - Menard, Missouri

Considering equipment? Consider Clark.

- Roof & Floor Truss Presses
- Multi-Head Truss Presses
- Modular Truss Presses
- Shuttle Presses
- Jack Presses
- H.D. Chord Splicers
- Floor Truss Machines
- Electric Horizontal Stackers
- Electric Peak-up Stackers
- Post & Column Machines
- Conveyor Systems
- Custom Machinery

**800.743.9727**

[www.clark-ind.com](http://www.clark-ind.com)

For reader service, go to [www.sbcimag.info/clark.htm](http://www.sbcimag.info/clark.htm)

### SCORE Elite

#### ProBuild Manufacturing

[www.probuild.com](http://www.probuild.com)

Anchorage, AK	Norcross, GA	Clackamas, OR
Big Lake, AK	Pooler, GA	Morrisville, PA
Chugiak, AK	Hawarden, IA	Mitchell, SD
Kenai, AK	New Hampton, IA	Buda, TX
Phoenix, AZ	Indianapolis, IN	Carrollton, TX
National City, CA	Valley Center, KS	Mercedes, TX
Visalia, CA	Dry Ridge, KY	West Point, VA
Dolores, CO	Wadena, MN	Auburn, WA
Longmont, CO	Albemarle, NC	Walla Walla, WA
Lady Lake, FL	Albuquerque, NM	West Richland WA
Milton, FL	Berlin, NJ	Spokane, WA
Plant City, FL	Delaware, OH	De Pere, WI

#### Shelter Systems Limited

[www.sheltersystems.com](http://www.sheltersystems.com) • Westminster, MD

#### Sun State Components of Nevada, Inc.

[www.sunstatenv.com](http://www.sunstatenv.com) • North Las Vegas, NV

### SCORE Leaders

#### Capital Structures

[www.capstructures.com](http://www.capstructures.com)  
Fort Smith, AR

#### Dakota Craft Truss

[www.dakotacraft.com](http://www.dakotacraft.com)  
Rapid City, SD

#### Lumber Specialties

[www.lbrspec.com](http://www.lbrspec.com)  
Dyersville, IA • Story City, IA

#### Plum Building Systems, LLC

[www.plumbuildingsystemsinc.com](http://www.plumbuildingsystemsinc.com)  
West Des Moines, IA

#### True House, Inc.

[www.truehouse.com](http://www.truehouse.com)  
Jacksonville, FL

#### Truss Craft

[www.trusscraft.com](http://www.trusscraft.com)  
Cheyenne, WY

### SCORE Achievers

#### Latco Structural Components

[www.latcoinc.com](http://www.latcoinc.com)  
Lincoln, AR

#### Tri-County Truss, Inc.

[www.tricountytruss.com](http://www.tricountytruss.com)  
Burlington, WA

#### Truss Systems, Inc.

[www.trussystemsinc.com](http://www.trussystemsinc.com)  
Oxford, GA



# **ITW** Building Components Group is proud to introduce our new line of Construction Hardware

It is time to get more out of the efforts you put into the design and build process. It is time to shake things up, to look at construction hardware in a whole new light. Our new line of more than 3,500 construction hardware items and powerful new software draw on our extensive engineering expertise. They are all geared to help you create more value for your customer!



Designing structural connections is the lifeblood of our business. Building professionals have consistently called on the component industry to supply the critical structural information they need to specify hardware - in fact, we have been calling out loads to specify custom and stock hangers for more than 40 years. So, while this is just the start of our brand of hardware, you can rest easy knowing our experts have experience and expertise to help you get the job done.

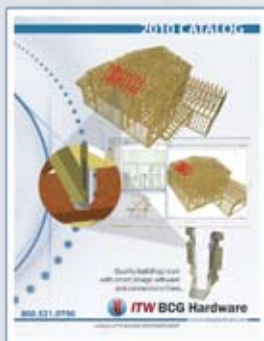

**Download your free  
product catalog  
right now!**

And that is just the start! The addition of construction hardware gives us a unique opportunity to be involved in every major part of the building industry. We now have the reach to deliver on the complete promise of whole house design - by realigning existing business systems and creating the missing links to tie together all the parts and all the players.

Our connections to Cullen hardware, Paslode, Duofast and other strategic partners have allowed us to fast-track a full line of "code accepted" products and we have no intention of slowing down. For nearly 100 years ITW has been providing game changing business to business solutions.

**Call us to see how you can connect all the dots and start building!**

*Quality buildings start with smart design software  
and connections from...*

**ITW BCG Hardware**  
a division of ITW Building Components Group

[www.itwbcghardware.com](http://www.itwbcghardware.com)

**Call Today!**  
**800.521.9790**

For reader service, go to [www.sbcmag.info/itw.htm](http://www.sbcmag.info/itw.htm)