

Quick Start
Guide

SBCATM

DIGITAL QC

Download

Go to <https://digqc.sbcacomponents.com/>

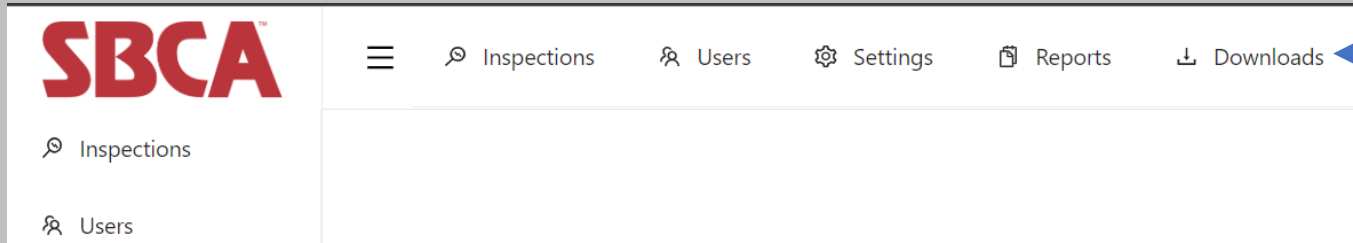

Select Downloads

Windows

The screenshot shows the 'Downloads' page. It features a table with columns for Version, Release Date, Size, and Download. Below the table are 'Mobile and Tablet Downloads' for Google Play and the App Store. A green arrow labeled 'Android' points to the Google Play button, and a red arrow labeled 'Apple' points to the App Store button. A blue arrow labeled 'Windows' points to the 'Download' button in the table for version 2.0.8. The table also includes a 'Release Notes' link and pagination controls showing 'Records 1 - 2 from 2'.

Version	Release Date	Size	Download
2.0.8	01/15/2023	105 MB	Download
2.0.7	10/23/2022	105 MB	Download

Mobile and Tablet Downloads

[GET IT ON Google Play](#) [Download on the App Store](#)

Android Version iOS Version

[Digital QC Resources](#)

Android

Apple

If there are multiple versions, please download the most recent one.



DIGITAL QC

Signing In

User Login

Connection Status

The device needs to be **connected** to the Internet to log in and upload inspections.

Software Version

Please make sure you are always running the most recent version.

New Version

When this box appears, that means a new version is available on the website. Clicking this box will open a browser to it directly.

Server Settings

Server URL, Local Storage Path, and Connectivity Check Frequency

Main Menu

1 Location Selection

2 Current Location

3 Inspection

4 Reports

5 Plate Inventory

6 Bug Report

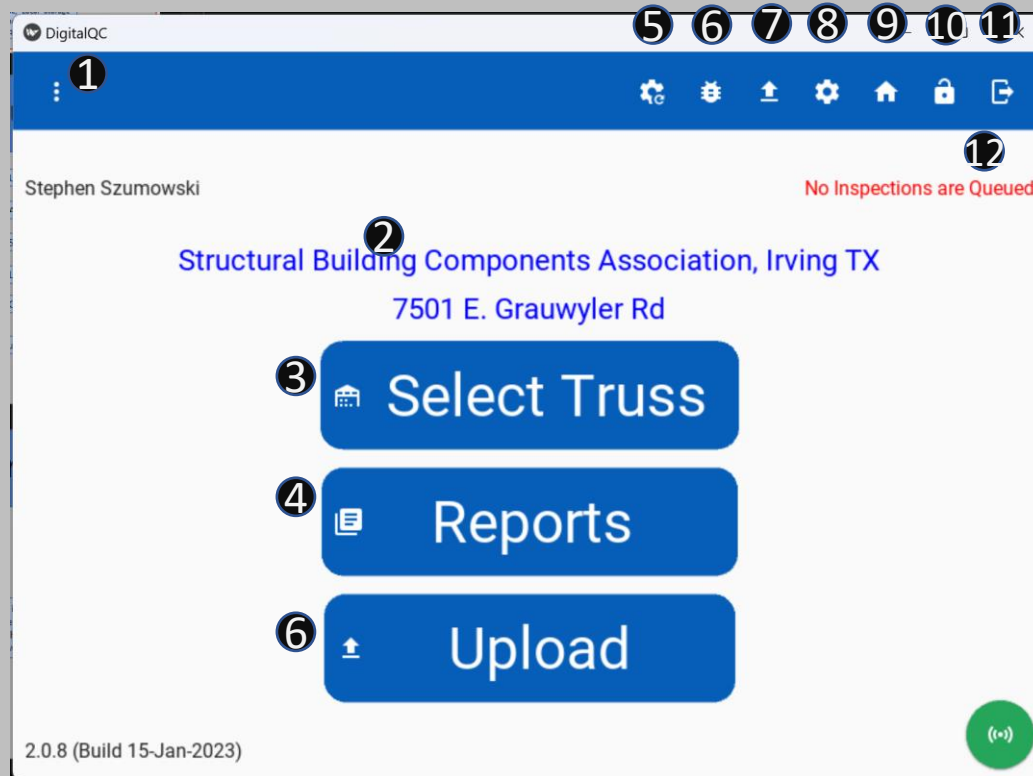

Software Version

Connection Status

7 Upload Inspections Queued

8 Application Settings

9 Server Homepage

10 Reset Password

11 Logout

12 Inspection Queue

Server Settings

DigitalQC

Settings

Server URL
https://digqc.sbcindustry.com

Use the new API

Local Storage Path
C:\Program Files (x86)\Digital QC\data

Connectivity Check Frequency(Seconds)
60

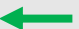
Generate PDF Reports 
ON

Save

When an inspection is finalized, a PDF is created of the report. Should the device have issues, changing **Generate PDF Reports** to **OFF** will resolve this.

Application Settings

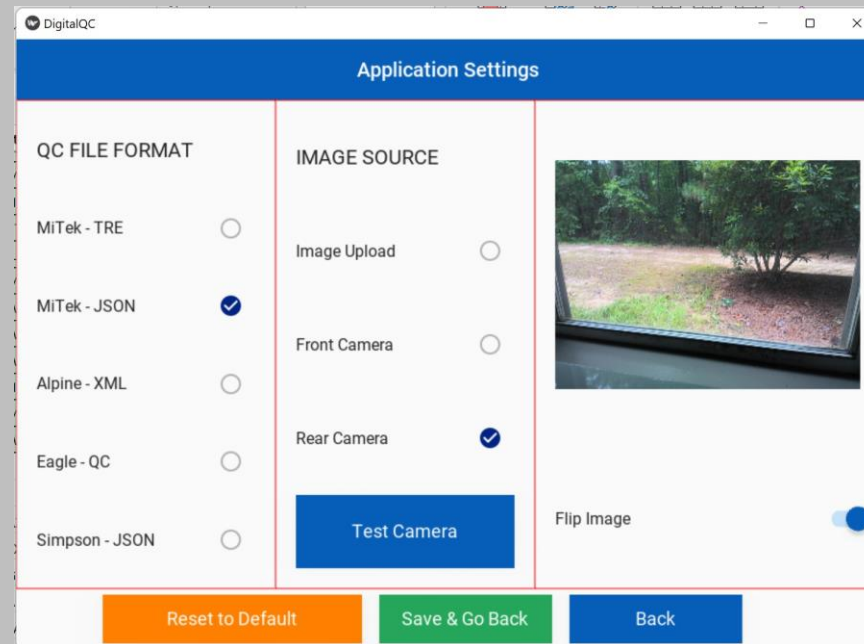
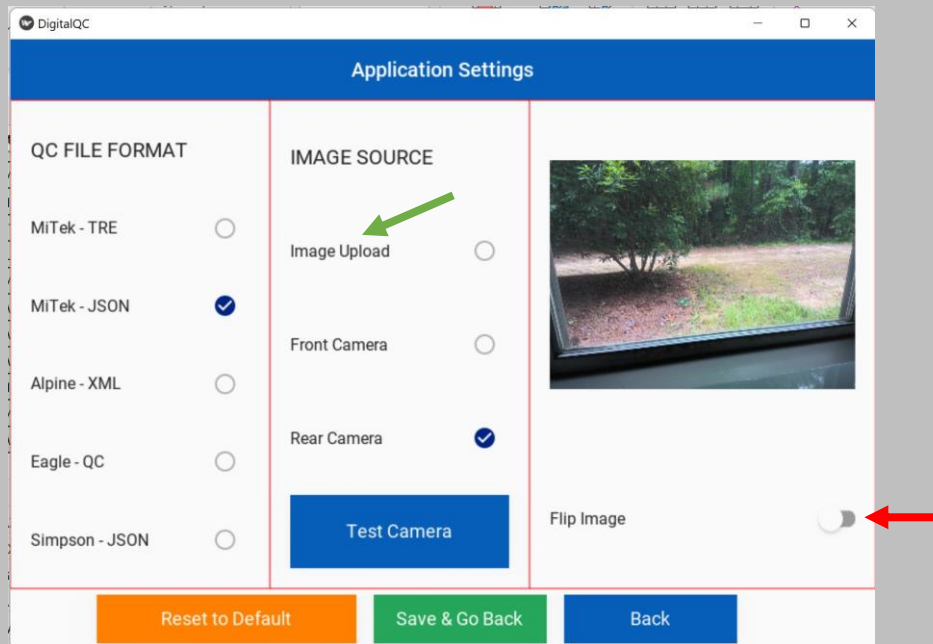
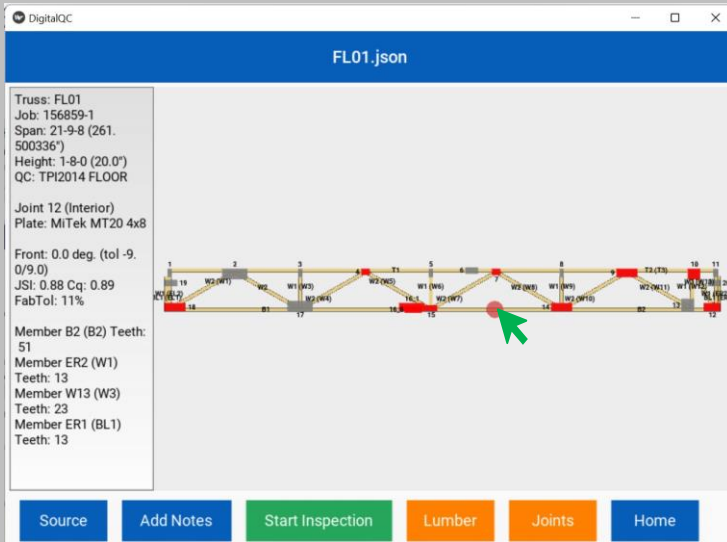

Image Upload is used when the device cannot take pictures directly and are transferred from another device. When the critical inspection is being performed, a dialog box will appear to select a photo.

The **Flip Image** toggle will mirror the camera, so what was on the left side will now be on the right, and vice versa.

Navigation (Mouse)



By **Right Clicking** on an object, you can create one point of contact similar to that of a touchscreen device.

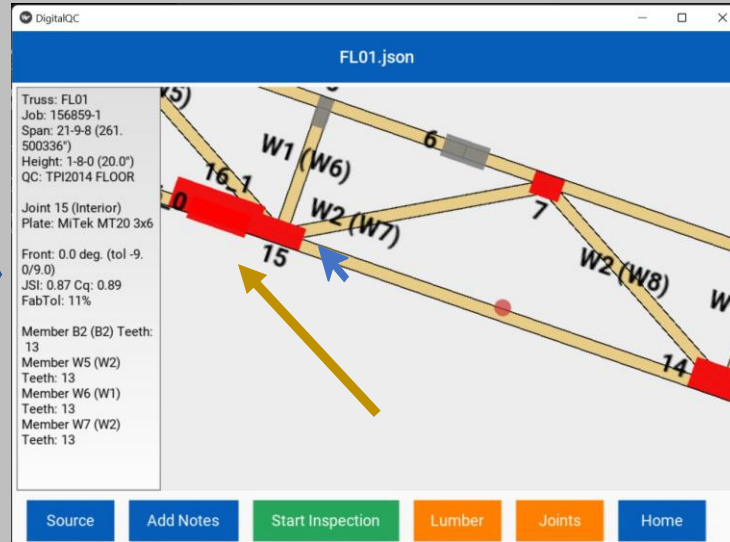

Left Clicking and **dragging** anywhere else on the photo will be the other point of contact, allowing you to rotate and zoom in.

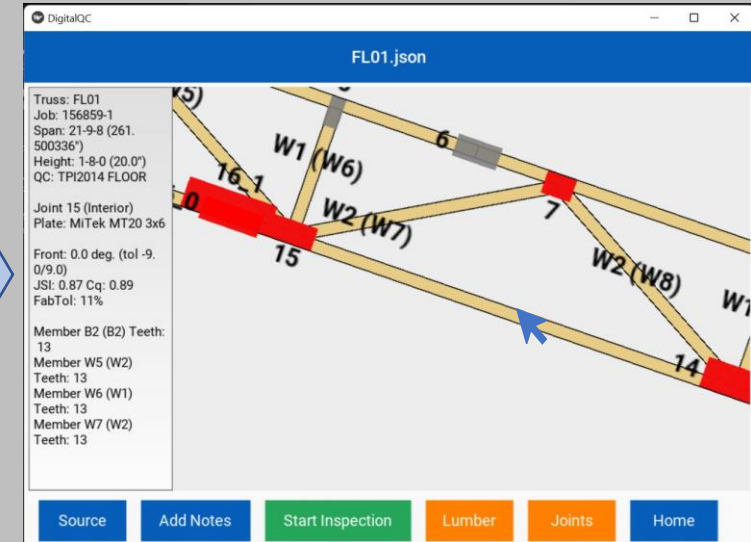

You can remove the **Red Circle** by **Left Clicking** on it.

Navigation (Touch)

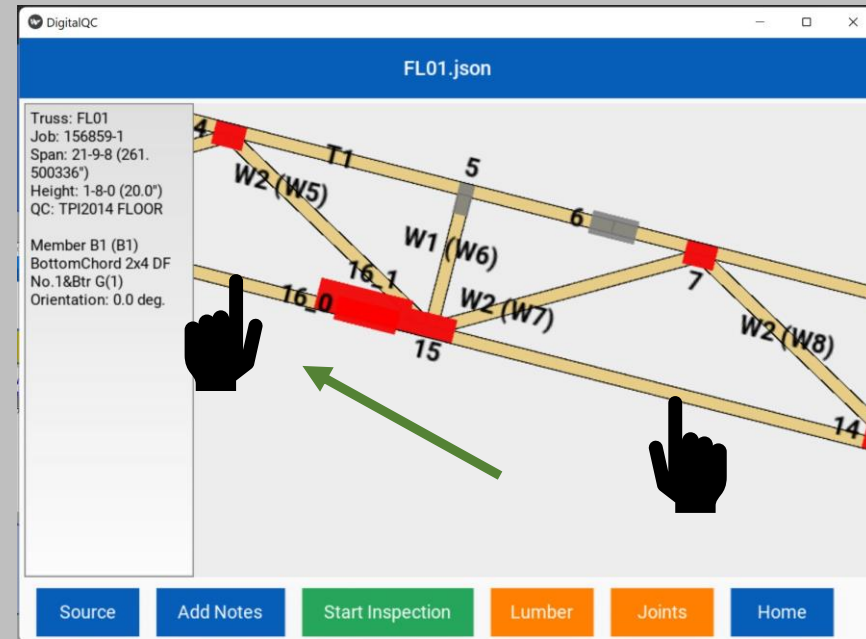
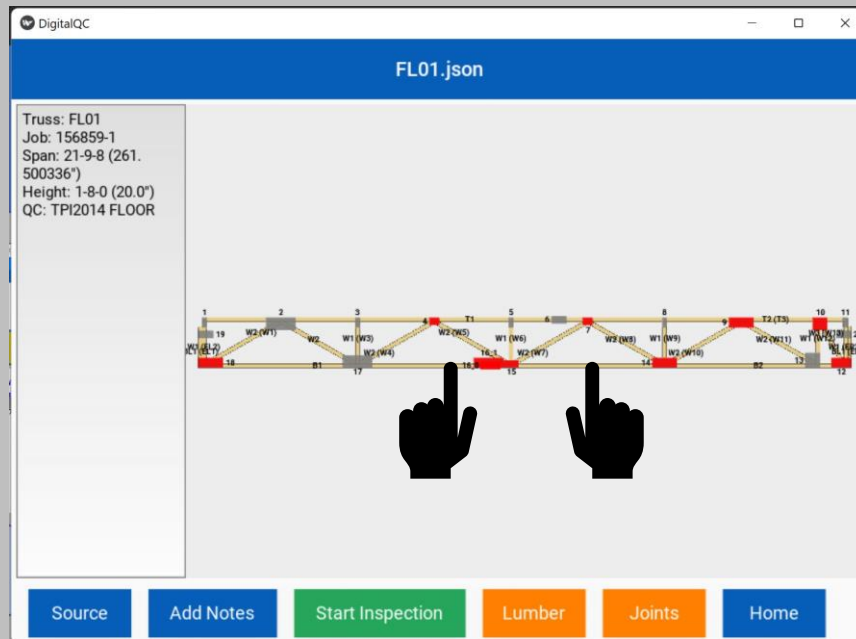

By touching two points on the object, you can rotate and zoom the picture by **dragging** your fingers across the screen. Referred to as Pinch Zoom, moving your fingers further away enlarges the object, and bringing them closer together shrinks it.

Inspection

Source

Choose how to submit photos.

Add Notes

Comments will only appear on the local PDF and not on the reports uploaded to the website.

Start the Inspection

Enter job and inspection details such as shift/crew, inspector, and span/height.

The screenshot shows the DigitalQC application window titled "FL01.json". On the left, a text box contains the following information: "Truss: FL01", "Job: 156859-1", "Span: 21-9-8 (261.500336")", "Height: 1-8-0 (20.0")", and "QC: TPI2014 FLOOR". The main area displays a technical diagram of a truss structure with various components labeled, including joints (T1, T2, T3), members (W1-W11), and supports (B1, B2). At the bottom, there is a navigation bar with six buttons: "Source" (blue), "Add Notes" (blue), "Start Inspection" (green), "Lumber" (orange), "Joints" (orange), and "Home" (blue).

Lumber

Verify Lumber Specifications

Joints

Inspect the individual joints.

Home

Takes you back to the main screen. It will prompt to either Save or Delete the job.

Inspection (Joints)

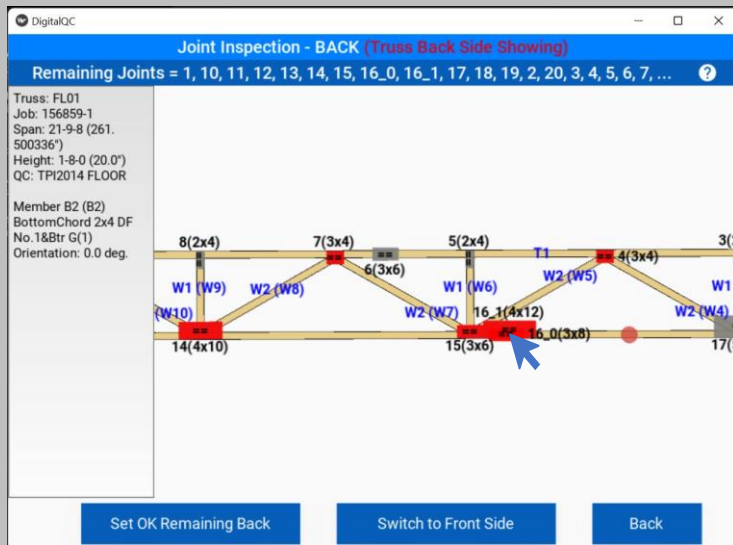

By **Double Left Clicking** on a joint, you will bring up the joint inspection.

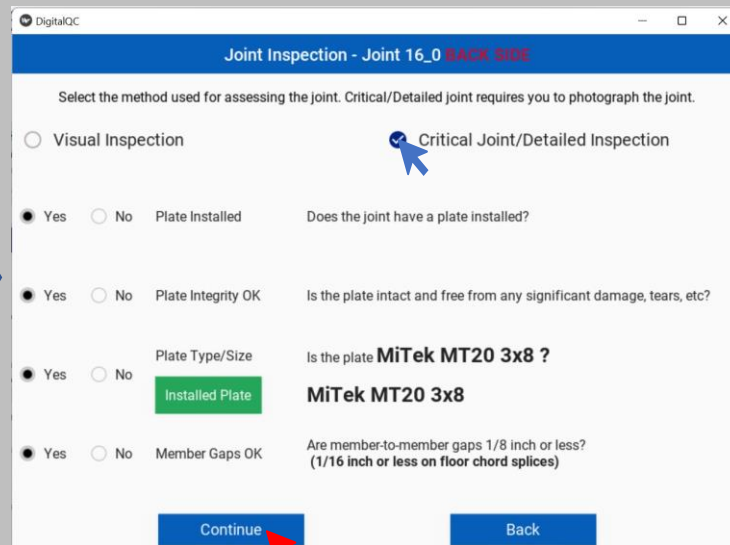

At the top, there are two tabs:
Visual Inspection
Critical Joint/Detailed Inspection

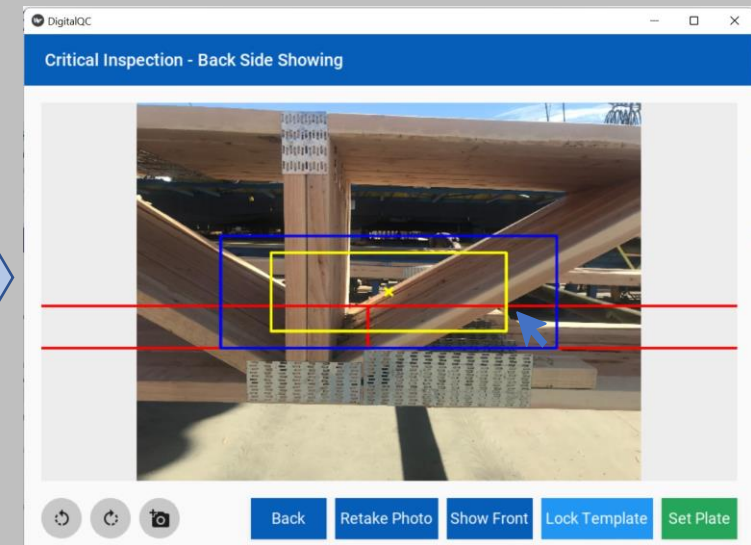

When you click **Continue** on a Critical Joint Inspection, you will be prompted to either take a photo or select one from your file directory.

You will need to use the information from the Navigation page to resize and angle the photo to ensure the plate is between the **Yellow** and **Blue** rectangles.



DIGITAL QC

Additional Resources

For more assistance, please check out [Digital QC Resources](#)

For any questions, comments, or errors, please email qc@sbcacomponents.com

Reporting Errors: When an error occurs, the application will prompt an option to report the error. Enter comments and select a location to save the file. Once the file is created, please upload it to the form.