

## A Place to Escape: Lower-Level Retreat

---



### PROJECT SCOPE

This project transformed an unfinished basement into a vibrant, multifunctional lower-level family space.

#### The scope included:

- A fully equipped bar with integrated appliances
- A luxurious bathroom featuring a spacious walk-in shower and custom vanity
- A large family room anchored by a custom fireplace and built-in storage
- A guest bedroom with a large closet.
- Redesigned stairs and storage solutions for improved function and flow
- Conversion of a former wine room into an arcade room, adding playful energy to the space

---

2025 NARI ROTY AWARDS, BASEMENT OVER \$250,000

Like many basement remodels, this project came with its share of unique considerations.

---



- **Blank Slate with Structural Elements:**  
The unfinished basement provided freedom in design but required careful planning around structural posts and existing utilities.
- **Multi-Functional Requirements:**  
Balancing the homeowners' desire for open flow while still creating distinctive spaces—family room, bar, and bathroom—required precise space planning.
- **Material Coordination:** Matching large-format tiles with plumbing fixtures and incorporating repurposed appliances into a fresh bar design required creative problem-solving.
- **“Unbasement” Goal:** Basements often get a reputation for being dark and dingy. The homeowners wanted this space to break that mold—bright, welcoming, and nothing like a typical basement.

---

## CHALLENGES

Nº. 2 of 13

Space planning carves out meaningful spaces.

## BEFORE

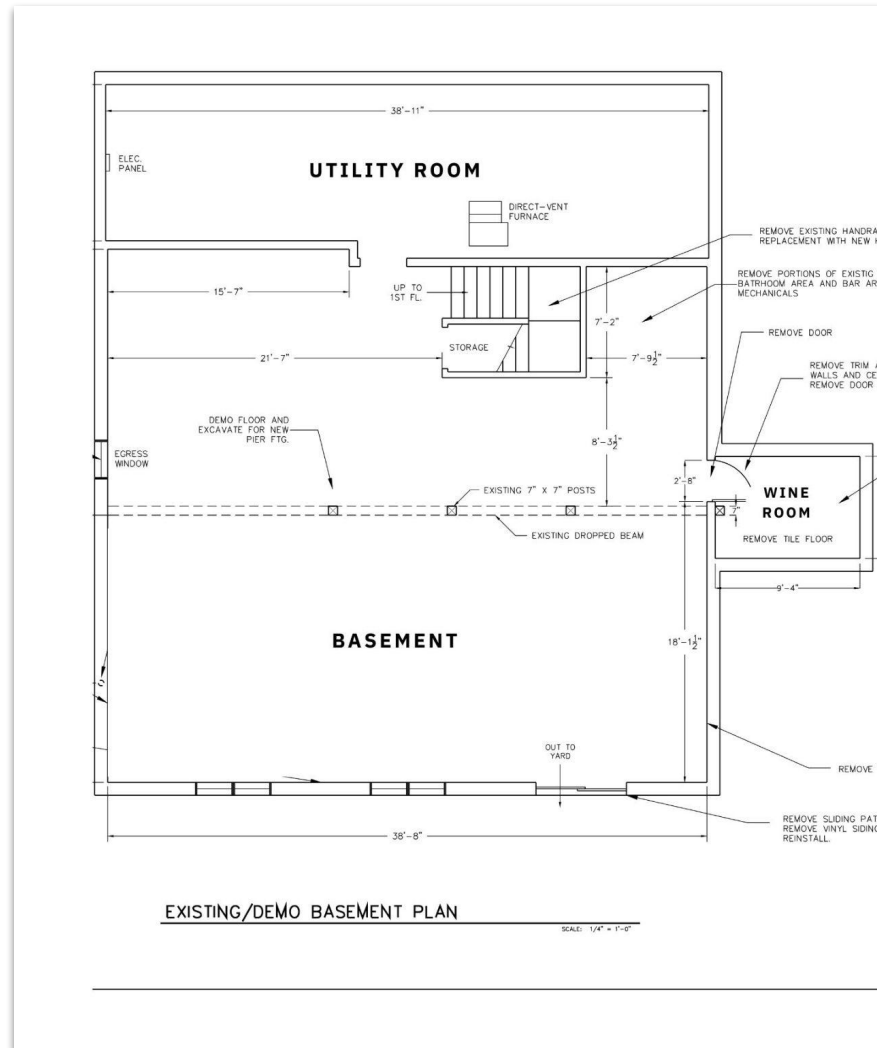

## AFTER

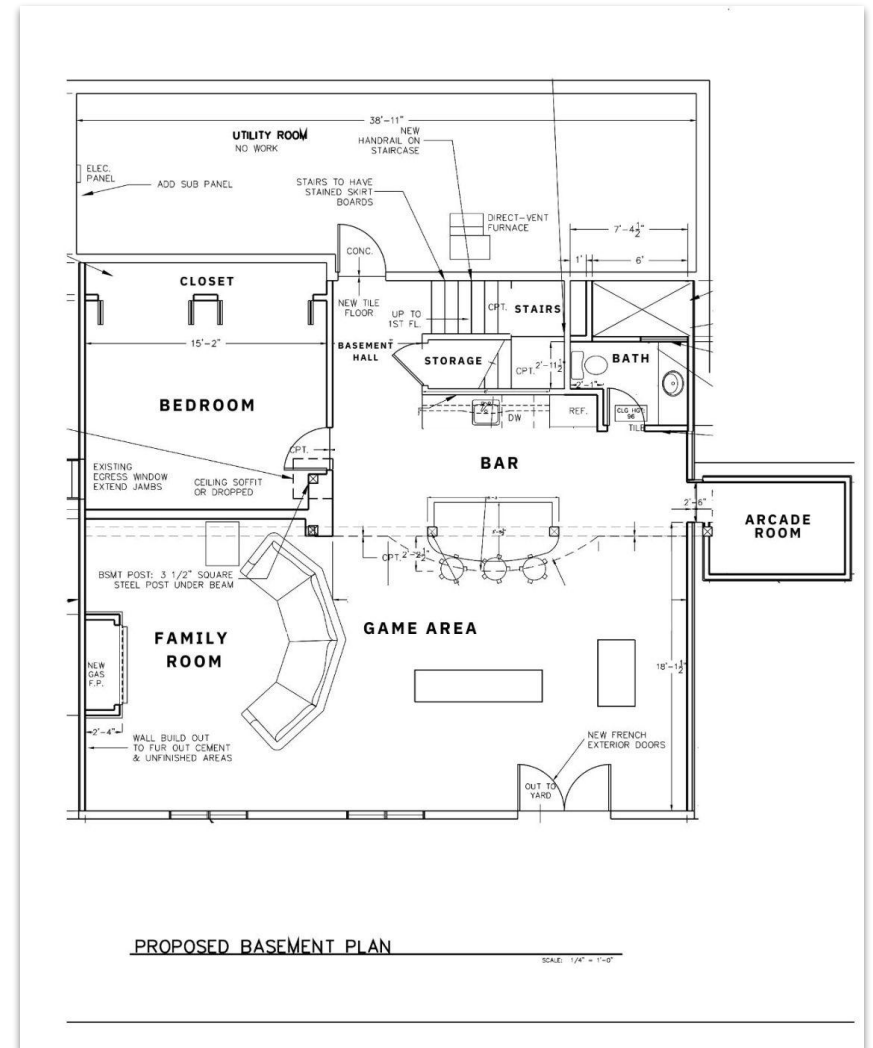

## FLOOR PLANS

Nº. 3 of 13



## Transforming a blank slate to valuable living space.

---



The homeowners envisioned a retreat that could serve as both a casual gathering place for their family and an entertainment hub for friends.



Positioned for both safety and style, the TV and fireplace complement each other beautifully.



**Custom-Built Fireplace:** framed by beautiful herringbone tile that adds texture and interest. On either side, we incorporated built-in shelving and storage, ideal for keeping clutter at bay.

**Shelving & Cabinetry:** Built-in shelving, shaker cabinetry, and a wall-to-wall vanity showcase attention to proportion, detail, and durability.

---

AESTHETICS & CRAFTSMANSHIP

---

## FAMILY ROOM

Nº 4 of 13

A family room designed for gathering.

---



**Design Palette:** Lovely greens and blues create a soothing palette, tying the room together. Durable luxury vinyl plank flooring flows throughout, ensuring the space will stand up to everyday life.

---

**AESTHETICS**

**Durable Finishes:** Luxury vinyl plank flooring was selected for its slip resistance and resilience against moisture—a crucial consideration in a lower level.

---

**SAFETY**

---

## FAMILY ROOM

Nº. 5 of 13





**Bar Counter Design:** Instead of seeing structural posts as limitations, we integrated them into the bar design—enhancing both form and function. The island fits neatly between the posts, naturally delineating the bar from the living area.

———— INNOVATION



The curved soffit above the bar area visually sets it apart from the rest of the living space, making it feel like its own destination. The bar itself features granite countertops with a smooth curve mimicking above. On the back wall, glass subway tile backdrops display shelves.

---

AESTHETICS & CRAFTSMANSHIP

## An Airy, Open Bar with Repurposed Appliances

---



Painted shaker cabinets pair with a new granite countertop for a timeless foundation, while open wood shelving against a glass subway tile backsplash creates a fresh, airy backdrop. The mix of textures balances function with style, giving the bar both warmth and polish.

---

### AESTHETICS

We were also able to repurpose their old refrigerator and dishwasher from the main floor and give them another life in a new space!

---

### INNOVATION



## Designing a Luxurious Bathroom

---



Although this corner was once perfect for hockey shots, it now serves as a bathroom with a large walk-in shower and striking large-format tiles spanning the walls.



A glass partition separates the space without a shower door, requiring the entire area outside the shower to be waterproofed. For safety, the pony wall is anchored with metal angle supports.

---

**SAFETY**

---

## BATHROOM

Nº 9 of 13

## Bathroom vanity and mirror

---

A full-wall mirror, custom cut around outlets and vanity lighting, expands the space and adds sophistication—without the stark ‘hotel mirror’ feel.

---

### INNOVATION

Custom mirror cutouts ensure outlets and lighting are safely integrated without sacrificing design.

---

### SAFETY



---

## BATHROOM

Nº. 10 of 13

## Maximizing storage without compromising style

---



**Precision Tilework:** Large-format shower tiles were meticulously aligned and color-matched with plumbing fixtures for a seamless, high-end look.

---

CRAFTSMANSHIP

---

## SHOWER

Nº 11 of 13



## Converting wine room into an arcade room.

---



Mom and Dad wanted a space their son could still enjoy—just without the hockey stick.



A curved doorway begins to take shape, adding character even at the framing stage.



Now, an arcade room— the ultimate hangout spot for games, sports, and good times.

## A Basement Reimagined

---

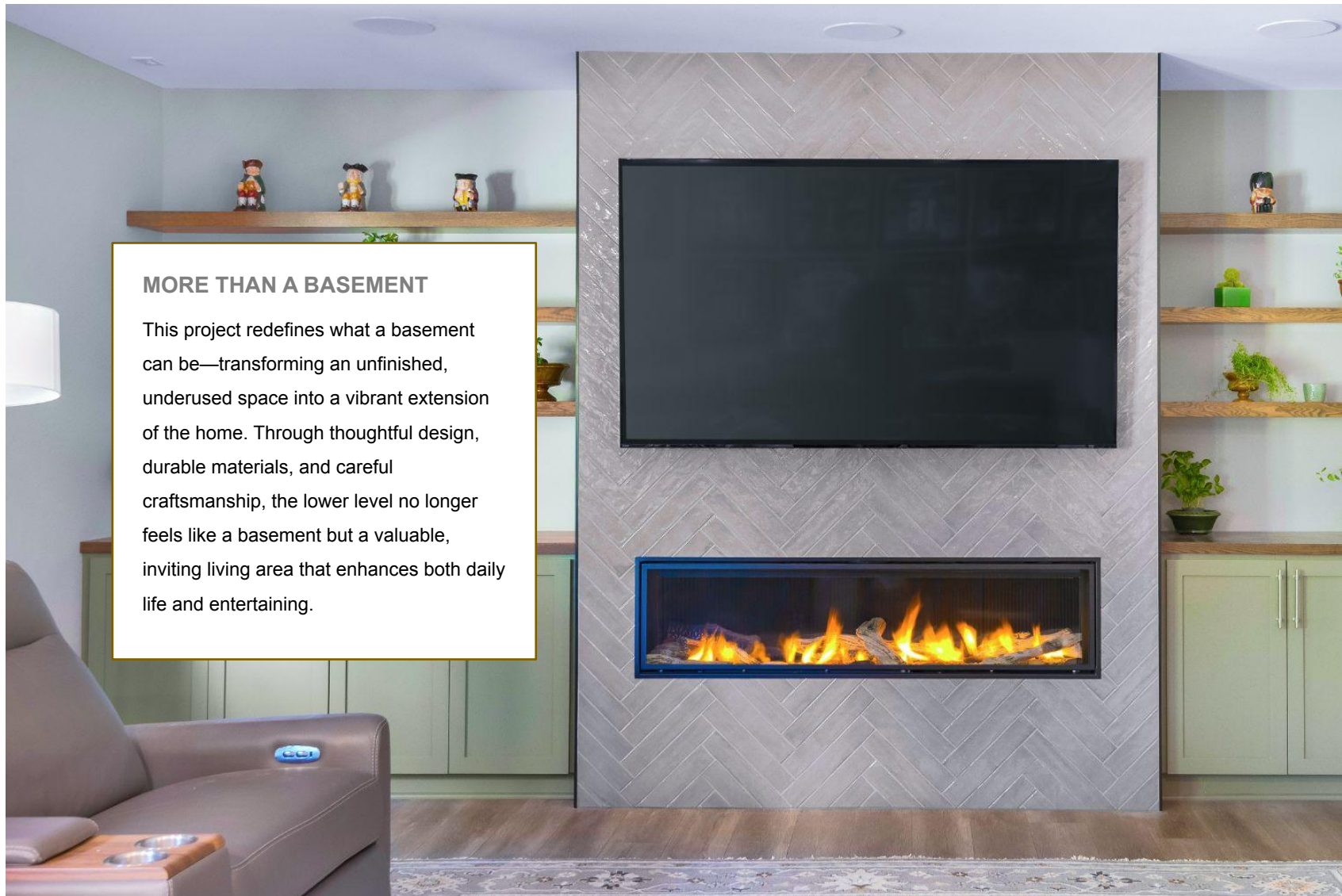

---

## CONCLUSION

Nº. 13 of 13