



**ENERGY AND ENVIRONMENT CABINET  
DEPARTMENT FOR ENVIRONMENTAL PROTECTION**

300 SOWER BOULEVARD  
FRANKFORT, KENTUCKY 40601

**KENTUCKY DIVISION OF WATER  
WELLHEAD PROTECTION PLAN  
5-YEAR UPDATE FORM**

**Update Requirements:**

This form should be used for the 5-year update submittal requirements of the Kentucky Wellhead Protection Program (WHPP) in compliance with 401 KAR 4:220 and SDWA Section 1428. Once the form is complete, please sign and send to:

Kentucky Division of Water  
Watershed Management Branch  
Attention: Allan Shingleton  
300 Sower Boulevard, 3<sup>rd</sup> Floor  
Frankfort, Kentucky 40601 or [allan.shingleton@ky.gov](mailto:allan.shingleton@ky.gov)

For assistance contact Allan Shingleton at (502) 782-6907 or [allan.shingleton@ky.gov](mailto:allan.shingleton@ky.gov)

**System Information:**

PWS Name: **Fulton Municipal Water System**

PWS ID Number: 380149

AI Number: Click here to enter text.

Contact Person/Title: **Billy A. Nelms, Jr.**

Mailing Address: **PO Box 1350 600 Fourth Street Fulton, KY 42041**

Telephone: (270) 472-2434 Email: [fultonpwdirector@outlook.com](mailto:fultonpwdirector@outlook.com)

System Type\*: **Community; Non-Transient**

\*Community; Non-Transient/Non-Community; Transient/Non-Community

Source\*: **Wells** \*Well(s) or Spring(s) and total number of each

County: **Fulton**

ADD: **Purchase ADD**

WWD Permit #: Click here to enter text. Permitted Amount (mgd): Click here to enter text.

Population Served: **4600**

Overall Susceptibility Rating\*: **Medium** \*High, Medium or Low

WHPP Changes Summary: **No changes**

### **Update Form Instructions:**

Please complete each section that applies to any system or WHPP updates and submit the supporting documentation. Please indicate if a section is not applicable to this update. **Sections 4, and 6 through 11 are required for every 5-year update.**

Please sign certification on the last page upon completion.

### **Section Updates:**

#### **Section 1: Treatment Plant**

If the treatment plant location has changed then provide a new location map below. This can be a county road map or a GIS-produced map. Please use the area below to provide relevant details, or to indicate that no change has occurred.

There has been no change to the water treatment plant since the previous submittal. A map with the marked location of the plant has been attached.

#### **Section 2: Water Withdrawal and Water Quality**

If there have been changes in water withdrawal rates or water quality since the last submittal, provide a discussion of the relevant details in the space below (include new Water Withdrawal Permit Number if applicable). Include supporting documentation as an attachment.

There have been no changes to Fulton's water withdrawal or water quality since the previous submittal.

#### **Section 3: Change or Modification to Groundwater Source**

If the system has changed or modified the wells or springs being used, provide the following: 1) a description of changes/modifications; 2) copies of the relevant form(s) (Kentucky Water Well Record, Well Maintenance & Plugging Record, Well Inspection Form or Spring Inventory Record); and 3) any other information relating to well construction (i.e., installation logs, driller's logs, lithologic or geophysical logs), below.

There have been no changes to Fulton's water supply wells since the previous submittal.

**Section 4 (REQUIRED): Planning Team**

Effective water supply protection requires community involvement and public awareness. Identify the planning team consisting of a leader and at least two team members, with their respective titles, below.

**Leader:**

**Billy A. Nelms, Jr.**

**Team Members:**

**C.J. Bonds**

**Leann Frizzell**

**Section 5: WHPA Delineation**

If the system is revising a Wellhead Protection Area (WHPA) delineation, or if a new groundwater source has been added since the last submittal, provide a site-specific description of the local geology and aquifer. Include references for published literature. Provide a summary of any aquifer tests (i.e. pumping tests, slug tests, tracer tests), including data gathering and evaluation methods. Show calculations and supporting data for each WHPA delineated or revised. Include the detailed hydrogeologic report as an attachment.

There is no modification to the existing WHPA delineation. A copy of a WHPA map is attached.

**Section 6 (REQUIRED): WHPA Map**

Provide a WHPA map that shows each groundwater source labeled with the appropriate AKGWA #, all protection zones identified and the Contaminant Source Inventory (CSI) point locations. If no changes have occurred since the last submittal, then a copy of the most recent WHPA/CSI map can be resubmitted. Please contact program staff for assistance.

A copy of the CSI map is attached.

**Section 7 (REQUIRED): Contaminant Source Inventor**

Provide an updated CSI in table format. This can be created using the spreadsheet template provided, and copied into the space below. If no changes occurred since the last update, the table can be pulled from previous WHPP documents. Each contaminant source listed should have a Contaminant Souce ID # that corresponds to the WHPA map in Section 6. The CSI table must show the susceptibility determination ranking for each contaminant source. Include a brief discussion of the overall system susceptibility. Please contact program staff for assistance.

The Turner Dairy located on the previous CSI is no longer in business and removed from the CSI. A CSI table is attached.

**Section 8 (REQUIRED): Management Strategies**

Provide a discussion of the previous and newly proposed management strategies. This discussion must include the previous management strategies that were implemented as well as the goals that were met. Next, include any NEWLY proposed management strategies, associated goals, implementation plans and the party responsible for implementation.

**Previous Management Strategy Update:**

Previous management strategies for Fulton were a combination of regulatory compliance and public education. The annual consumer confidence report has been utilized as a public education initiative along with area wellhead protection road signs.

**Newly Proposed Management Strategies:**

Fulton will continue to use a combination of public education and regulatory compliance to manage the wellhead protection area. The annual consumer confidence report will be used to spread awareness. A supplied flyer describing the Wellhead Protection Area is available to the public at both Public Works and City Hall.

**Section 9 (REQUIRED): Contingency and WHP Planning**

Provide a description of Contingency and WHP Planning. Complete the Emergency Response Phone List, Procedures for Public Notification, identification of Potential Future Problems and the procedures to establish Alternative Water Supplies. This section must also address how often the WHPP will be reviewed and updated.

**Emergency Response Phone List**

Fill in all Blanks and Phone Numbers with appropriate information.

<b>Local Emergency Response</b>	<b>Phone Number</b>
Plant Operator	(270) 627-3718
City of Fulton Fire Department	(270) 472-3141
Fulton Police Department	(270) 472-3141

COUNTY	PHONE NUMBER
Local Emergency Dispatch Fulton County Office of Emergency Management	(270) 236-3480

State and Federal Assistance	Phone Number
Kentucky DOW (Frankfort)	(502) 564-3410
Kentucky DOW Associated Field Office Paducah Regional Office	(270) 898-8468
Kentucky Environmental Response Team 24 hour response line	(502) 564-2380 (800) 928-2380
Kentucky State Fire Marshall	(502) 573-0382

Any Other Pertinent Contacts	Any Other Pertinent Numbers
Fulton City Hall	(270) 472-1320
Click here to enter text.	PHONE NUMBER
Click here to enter text.	

**Procedures for Public Notification:**

In the event of contamination, Fulton Municipal Water System will notify all residents via TV and radio broadcasts, the City's website (www.fulton-ky.com), mobile alerts, and issue a boil water advisory.

Newspaper, Television, and Radio Stations	Phone Numbers
The Current Newspaper	(270) 472-1121
WPSD – Paducah, KY	(270) 415-1900

**Potential Future Problems:**

Describe the *most likely* scenarios that could threaten the water supply.

The most likely scenario for contamination of Fulton’s groundwater supply is from the rail yard or from Highway 307. Ways to combat these issues are public awareness of their place in the Wellhead Protection Area from the brochure and wellhead signage.

**Alternative Water Supply (Short and Long Term):**

Describe the short term and long term water supply alternatives that address each of the potential future problems identified above. List all current interconnections with other water systems. Discuss the capacity of each potential alternative water supply to sustain normal operations.

In the event contamination does occur, depending on the nature and extent of the contaminant, long and short term contingency plans should be in place. Short term contingency planning would include boil water advisory to customers and supplying bottled water. Long term contingency planning would include interconnecting with the city of South Fulton, TN.

**Schedule for Update and Review:**

The Wellhead Protection Plan will be reviewed regularly and updated every five years as required by regulation.

**Section 10 (REQUIRED): Copies of Public Notices and Education Materials**

Provide copies of wellhead protection public notices and education materials distributed.

Click here to enter text.

**Section 11 (REQUIRED): Public Meeting Documentation\*\*\***

Provide the record of WHPP public meeting attendance, minutes and comments.

Click here to enter text.

\*\*\*Non-Community Water Systems are not required to have public meetings for 5 year updates, but must post a public notice in a conspicuous place. A public notice template is provided as a separate document. However, public input and associated documentation are encouraged. Please contact program staff if you have any questions.

**Certification Signature (TO BE COMPLETED BY PLANNING REPRESENTATIVE):**

"I certify that this document and all attachments were prepared under my direction or supervision. The information submitted is, to the best of my knowledge and belief, true, accurate, and complete."

Signature: Billy A. Nelson 1-31-22 Date: Click here to enter text.

Printed Name/Title: Click here to enter text.

**Assistance:**

For any assistance please contact Wellhead Protection Staff:



Rob Blair  
(502) 782-6893  
[Robert.Blair@ky.gov](mailto:Robert.Blair@ky.gov)

Allan Shingleton  
(502) 782-6907  
[Allan.Shingleton@ky.gov](mailto:Allan.Shingleton@ky.gov)

**Please sign and return completed form to:**

Kentucky Division of Water  
Watershed Management Branch  
Attention: Allan Shingleton  
300 Sower Boulevard, 3<sup>rd</sup> Floor  
Frankfort, Kentucky 40601  
or [allan.shingleton@ky.gov](mailto:allan.shingleton@ky.gov)

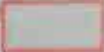
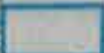
# Wellhead Protection Areas

-  Zone 1: 180 Day time of travel for potential contaminant
  -  Zone 2: 5 year time of travel
  -  Zone 3: Hydrologic Boundary
  -  Well
- 0.03125 0.15 0.225 0.3  
Miles

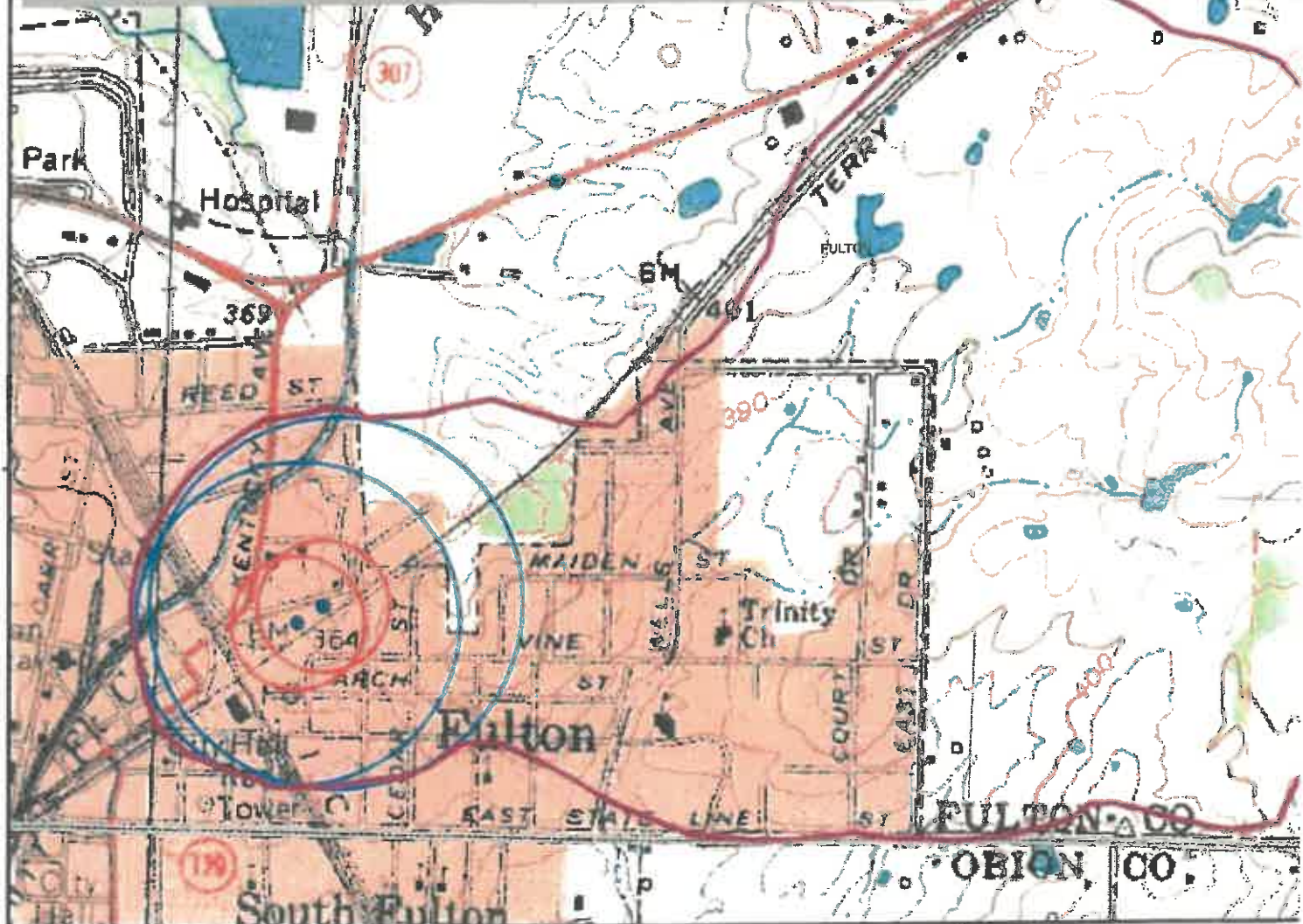

88°52'30"W

88°52'0"W

88°51'30"W



# Contaminant Source Inventory and Susceptibility Analysis for Fulton Municipal Water System

Contaminant Source ID #	Contaminant Source/Land Use	Address	Lat	Lon	Quantity	WHPA	Proximity	Contaminant Value	Hydrologic Sensitivity	Numeric Rating	Susceptibility Ranking
1	Railroad Line		36.50538	-88.87368	1	1	3	3	2	17	High
2	West Boy's Automotive	100 East 4th Street	36.50522	-88.87408	1	2	2	2	2	12	Med
3	Electric System Maintenance	Walnut Street	36.50374	-88.87177	1	2	2	2	2	12	Med
4	KY DOT HWY 307		36.50679	-88.87228	1	1	3	3	2	17	High
5	KY DOT HWY 45		36.50699	-88.87148	1	3	1	3	2	13	Med
6	Agriculture: Row Crops		36.50884	-88.87078	1	2	2	3	2	15	Med
7	Agriculture: Row Crops		36.50897	-88.8513	1	3	1	3	2	13	Med
<b>Totals:</b>									<b>High</b>	<b>Med</b>	<b>Low</b>
									2	5	0

Use the table above to list and rank potential contaminants identified during the contaminant source inventory, include addresses when possible. Multiple, similar sources that are clustered can be listed once with the **Quantity** identified (e.g. 50 Domestic Septic Systems in one neighborhood). Enter the **WHPA** in which the contaminant occurs. The **Proximity Ranking** is based on the WHPA in which the contaminant is located (WHPA 1=3; WHPA 2=2; WHPA 3=1). **Contaminant Value** is on a 1-3 scale, based upon its potential threat; consult the Contaminant Risk Values Guide on Sheet 2. **Hydrologic Sensitivity** is on a 1-5 scale, determined by local geology (consult the map on Sheet 2). The spreadsheet will use the values entered to calculate the **Numeric Rating** for each contaminant source. This will determine the **Susceptibility Ranking: Numeric Rating** less than 10 = Low; 10-15 = Medium; greater than 15 = High. Please contact SWP/WHPP staff if you have any questions.



**Fulton Municipal  
Water District:  
Contaminant  
Source  
Inventory**

**DOW Wellhead Protection Areas**

**WHPA Active**

- Zone 1: 180 day time of travel for potential contamination
- Zone 2: 5 year time of travel
- Zone 3: Hydrologic boundary

- Contaminant Source
- DOW Water Wells (PWS)
- Water Treatment Plants