

**2017**

**Sunbelt,  
Beijing**

XXXVII International  
Network for Social  
Network Analysis  
Conference

社会网络分析国际研讨会  
及第十三届中国社会学会社会网  
与社会资本研究专业委员会年会

Beijing International Convention Center

May 30 to June 4

# Conference Sponsors



中国社会网研究



清華大學社會網絡研究中心

CENTER FOR SOCIAL NETWORK RESEARCH, TSINGHUA UNIVERSITY



西安交通大学



实证社会科学研究所  
Institute for Empirical Social Science Research

# The Team

## Special Thanks

Chinese Network for Social Network Studies  
Center for Social Network Research at Tsinghua University  
School of Social Sciences, Tsinghua University  
Institute for Empirical Social Science Research at Xi'an Jiaotong University

## Event Team

Jar-Der Luo, Tsinghua University  
Yanjie Bian, Xi'an Jiaotong University  
Frank Zhang, University of Colorado Colorado Springs  
Taoxiong Liu, Tsinghua University

## Students/Assistants

Yu Sun  
Xihua Liu  
Kunhao Yang  
Xiaoyue Liang

## Supporters

	Danqing Ruan	Ray-May Hsung	Steve Borgatti
Ronald Burt	Nan Lin	John Skvoretz	Barry Wellman
	Shun Zhang	Xiaoxian Guo	Haifeng Du
	Zhengping Fu	Pengfei Diao	Wenhong Zhang
	Jun Liu	Jianxun Chu	Xijin Tang

## Directory

Participant Information .....	5
Meeting Space.....	6
Keynote Speaker .....	7
Workshops .....	8
Oral Presentation .....	10
Parallel Sessions .....	12
Posters .....	34
Author Index.....	36
Chinese Sessions (中文论坛议程).....	45
Chinese Network for Social Network Studies .....	53
Center for Social Network Research at Tsinghua University.....	54
Institute for Empirical Social Science Research at Xi'an Jiaotong University .....	55
School of Social Sciences Tsinghua University .....	56
Beijing City Map .....	57
Beijing Subway Map .....	58
Nearby Restaurants.....	59
Nearby attractions.....	60
International Sunbelt Social Network Conference History .....	61

## Participant Information

Dear Colleague,

Welcome to 2017 Sunbelt XXXVII International Social Network Conference in Beijing, China!

Your registration package consists of this printed program, a name tag, a USB disk, and tickets for the banquet and/or workshops if you registered for them.

Full abstracts are available in the USB.

There are some “Sunbelt” traditions that we would like to highlight:

- We strongly recommend that you buy travel insurance to cover your time in China.
- Each Oral presentation is 20 minutes, and to start and stop at the stated program times, as attendees often move between sessions to catch papers of interest.
- The named session chairs are asked to keep the session presenters on time.
- If you are presenting a talk, please load your presentation slides on the dedicated laptop connected to the projector 10 minutes before the session start. If you need to see your own laptop this will cut into your 20-minute presentation time. If you use an Apple computer, please transfer your slides into a Windows system compatible format.
- Lunch breaks are over 1 hour to give you enough time to enjoy Beijing food.
- There is a hospitality suite Friday through Saturday evening, from 6pm to 9:30pm, in the BICC room 303. We ask that you cooperate with our student assistants who will close the suite at 9:30pm.
- Please always bring your name tag with you, as some sessions, such as the keynote speech and Freeman Award speech, require participants to show their name tags.
- If you failed to pay registration fee by Paypal or an alternative payment method, you may pay the registration fee on site. Please show your record of invoice or proof of registration, then the local organizer will charge you with the fee according to your registration time, i.e. early-bird fee before March 10<sup>th</sup> and regular fee during Mar. 10<sup>th</sup> and May 28<sup>th</sup>, Visa and Master Card are accepted.
- The final program has been put on 2017 Sunbelt website. Please review this program as it contains some last-minute changes. Any further changes will be posted as necessary at the registration desk.

If you have any questions about the conference, please look out for the organizers or student assistants. We are happy to help.

Thank you for your attendance and contribution to this conference. We hope that you have an intellectually valuable, and very enjoyable week in Beijing!

The Organizers

Jarder Luo

Yanjie Bian

Frank Zhang

Taoxiong Liu

# Meeting Space

BICC 一层平面图  
PLAN OF BICC LEVEL 1

技术说明/TECHNICAL SPECIFICATIONS  
 地面承重/FLOOR LOADING:  
 层高/CEILING HEIGHT: 3.4m  
 特装限高/BOOTH CONSTRUCTION LIMITED: 3m  
 通道/FREIGHT ENTEANCE: 3.9m(W)\*2.4m(H)

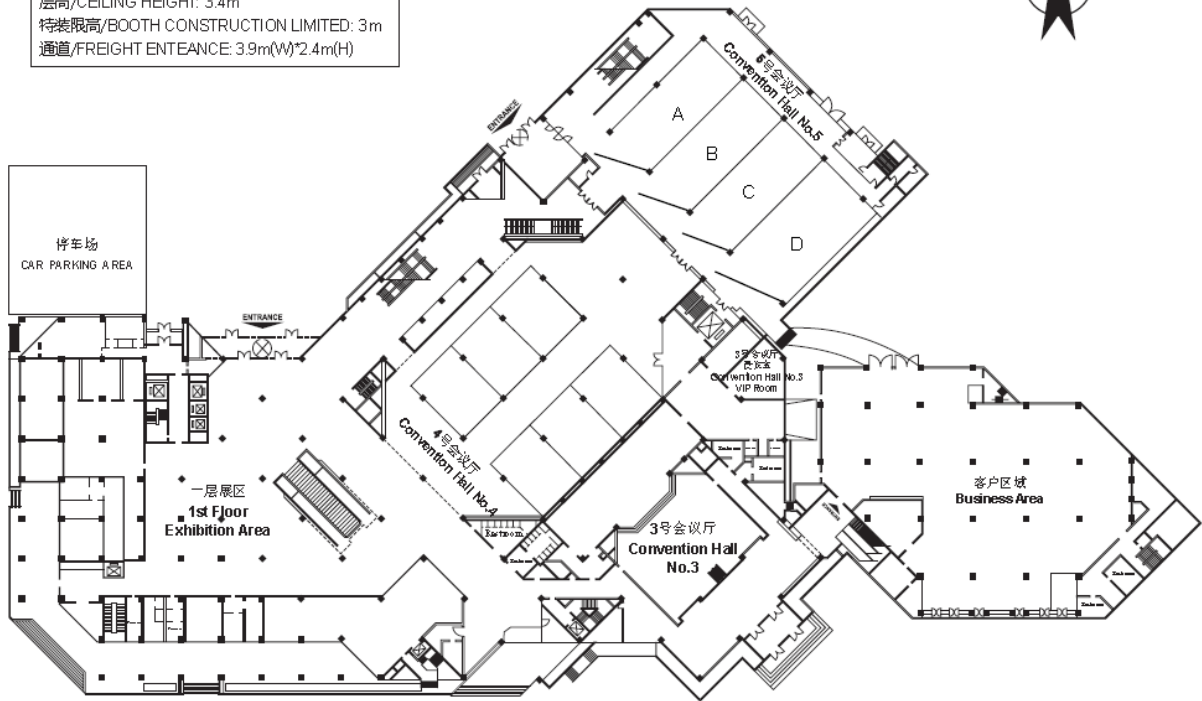

BICC 三层平面图  
PLAN OF BICC LEVEL 3

技术说明/TECHNICAL SPECIFICATIONS  
 地面承重/FLOOR LOADING:  
 层高/CEILING HEIGHT:  
 特装限高/BOOTH CONSTRUCTION LIMITED: 2.5m  
 通道/FREIGHT ENTEANCE:

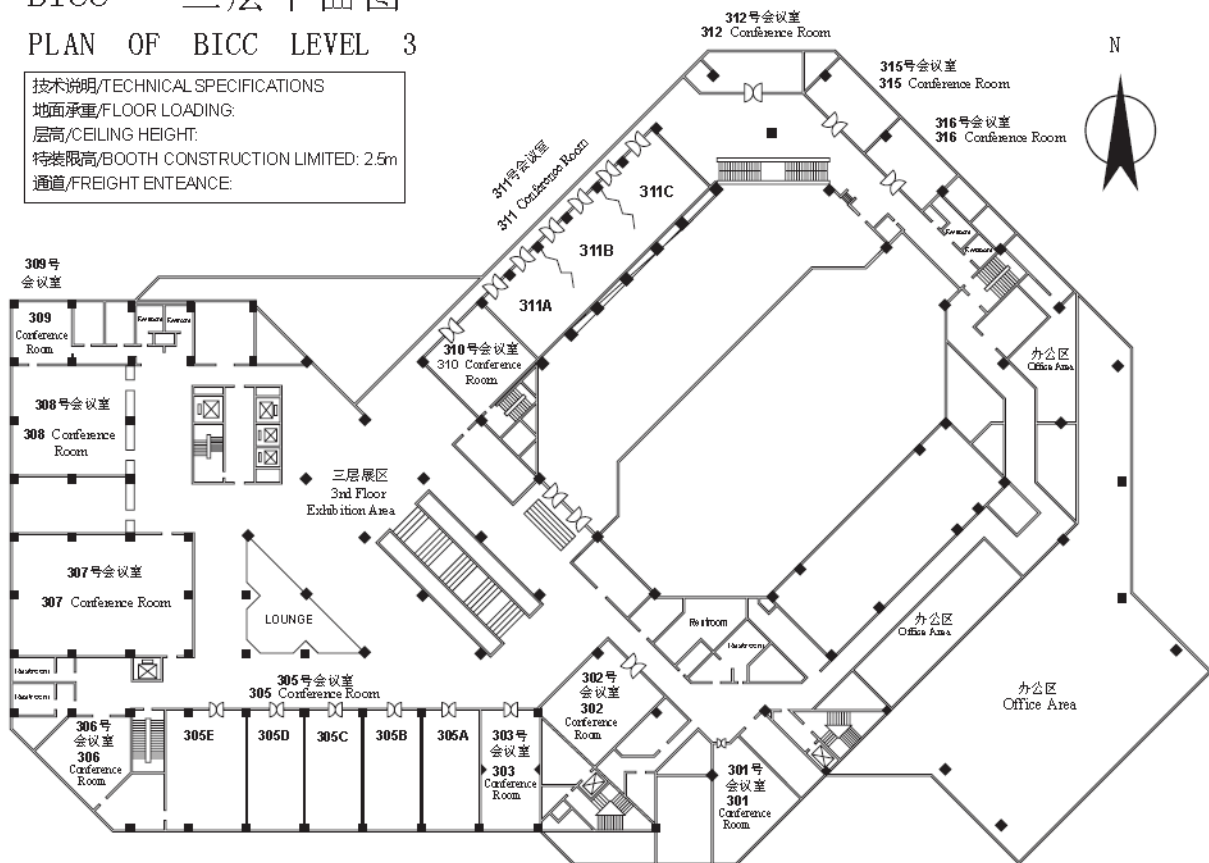

---

**Keynote Speaker****Chinese Entrepreneurs, Social Networks, and Guanxi**

Thurs 16:30-18:00 BICC Room 305

**Ronald Burt**

Hobart W. Williams

Professor of Sociology and Strategy

Booth School of Business

University of Chicago

Professor Burt's work describes social networks creating advantage. Applications focus on personal networks and the network structure of markets. In addition to computer software and articles in research journals, Professor Burt's last three books are the one that proposed the concept of structural holes, *Structural Holes: The Social Structure of Competition* (1992, Harvard University Press), a broad review of links between network structure and performance, *Brokerage and Closure: An Introduction to Social Capital* (2005, Oxford University Press), and argument and evidence on the substantial extent to which network advantage depends on the person at the center of the network, *Neighbor Networks: Competitive Advantage Local and Personal* (2010, Oxford University Press, which received the 2011 Academy of Management George R. Terry Book Award for the work that most advanced management knowledge in the last two years). Research and teaching materials can be downloaded at <http://faculty.chicagobooth.edu/ronald.burt>.

Professor Burt's college work at Johns Hopkins University included pre-medical training, physiological psychology, and behavioral science. He graduated from the University of Chicago with a Ph.D. in sociology, then was on the faculty at the University of California Berkeley, SUNY Albany, and Columbia University before returning to join the University of Chicago faculty in 1993. In 1999, he began a leave of absence to learn more about European business as the Shell Professor of Human Resources at INSEAD. In 2000, he began a leave of absence to learn more about practical implementation as the Vice President of Strategic Learning in Raytheon Company. He continues today at the University of Chicago.

## Workshops

Tuesday May 30				
Room	8:00-12:00	12:00-12:55	12:55-14:55	15:00-18:00
BICC 310	<b>#1.</b> Introduction to Social Network Analysis Using Stata, by Thomas Grund		<b>#1.</b> Introduction to Social Network Analysis Using Stata, by Thomas Grund	<b>#10.</b> Advanced RSIENA and advanced actor-oriented network modelling workshop, by Per Block, Zsofia Boda, Timon Elmer, Andras Vörös
BICC 311A	<b>#13.</b> A Hands-on Introduction to Analyzing Social Networks with UCINET & Netdraw, by James Coutinho, Meredith Woehler, and Steve Borgatti		<b>#13.</b> A Hands-on Introduction to Analyzing Social Networks with UCINET & Netdraw, by James Coutinho, Meredith Woehler, and Steve Borgatti	<b>#14.</b> Advanced Social Network Analysis Using UCINET and Netdraw, by Steve Borgatti and Martin Everett
BICC 311B	<b>#8.</b> Social Network Analysis using NetMiner, by Ghi-Hoon, Woosik Choi, and Youngjin Ko	Lunch Time	<b>#8.</b> Social Network Analysis using NetMiner, by Ghi-Hoon, Woosik Choi, and Youngjin Ko	<b>#5.</b> Analysis of temporal networks, by Vladimir Batagelj
BICC 311C	<b>#17.</b> Dynamic Network Analysis (DNA) and *ORA, by Kathleen M. Carley and L. Richard Carley		<b>#17.</b> Dynamic Network Analysis (DNA) and *ORA, by Kathleen M. Carley and L. Richard Carley	
BICC 305A	<b>#9.</b> The Analysis of Longitudinal Social Network Data using RSIENA, by Per Block, Zsofia Boda, Timon Elmer, Andras Vörös		<b>#9.</b> The Analysis of Longitudinal Social Network Data using RSIENA, by Per Block, Zsofia Boda, Timon Elmer, Andras Vörös	<b>#11.</b> Research questions, competing explanations, and network configurations: A practical guide to theorizing about network processes, by András Vörös



## Workshops

Wednesday May 31	
Room	8:00-11:00
BICC 310	<b>#6.</b> Algebraic analysis and visualization of multiple, signed, and two-mode networks with 'multiplex' & 'multigraph', by Antonio Rivero Ostoic
BICC 311A	<b>#14.</b> Advanced Social Network Analysis Using UCINET and Netdraw, by Steve Borgatti and Martin Everett
BICC 311B	<b>#7.</b> Using Polinode: A Browser-Based Application for Collecting, Analyzing and Visualizing Network Data, by Andrew Pitts
BICC 301	<b>#15.</b> Fundamentals of Biased Net Models, by John Skvoretz
BICC 302	<b>#18</b> Guanxi Networks, by Yanjie Bian

## Oral Presentation

Day	Time	BICC 310	BICC 311A	BICC 311B	BICC 311C
<b>5/31</b> <b>Wed.</b>	13:30-15:30	Networks and Organizations. (1)	Session: Historical Network Research. (1)	Session: Business and Corporate Networks. (1)	Session: Advances in Network Methods and Modeling. (1)
	15:50-17:50	Networks and Organizations. (2)	Session: Historical Network Research. (2)	Session: Business and Corporate Networks. (2)	Session: Advances in Network Methods and Modeling. (2)
<b>6/1</b> <b>Thur.</b>	08:00-10:00	Networks and Organizations. (3)	Session: Networks in Global Health. (2)	Session: Academic and Scientific Networks. (3)	Session: Government and Political Networks. (2)
	10:20-12:20	Session: Internet, Social Media, and Social Networks. (1)	Session: Networked Innovation. (2)	Session: Networks and Labor Markets. (1)	Session: Personal Networks and Vulnerability in the Life Course.
	13:30-14:30	Session: Networks in Global Health. (3)	Session: Networked Innovation. (3)	Session: Networks and Labor Markets. (2)	Networks and Organizations. (4)
	14:50-16:10	Session: Network Approaches to Language, Meaning, and Sociocultural Contexts. (1)	Session: Internet, Social Media, and Social Networks. (2)	Session: Business and Corporate Networks. (3)	Session: Advances in Network Methods and Modeling. (3)
	16:30-18:00	Keynote Speech: Ronald Burt(in Room 305 B C D E), Topic: Chinese Entrepreneurs, Social Networks, and Guanxi			
	18:30--21:00	Banquet (Hotel Banquet Room, Lijiang Restaurant, in Beijing Continental Grand Hotel)			
<b>6/2</b> <b>Fri.</b>	08:00-10:00	Session: Recent Advances in Statistical Analysis and Mathematical Modeling of Social Networks (1)	Session: Social Capital in Social Networks. (1)	Session: Network Approaches to Language, Meaning, and Sociocultural Contexts. (2)	Session: SNA in Russia: Progress and Prospects. (1)
	10:20-12:20	Session: Recent Advances in Statistical Analysis and Mathematical Modeling of Social Networks (2)	Session: Social Capital in Social Networks. (2)	Session: Community Social Capital and Community Revitalization.	Session: SNA in Russia: Progress and Prospects. (2)
	13:30-15:30	Session: Sex Networks and Health.	Session: Networks and Experiments.	Session: Online Social Networks.	Session: Networks and Organizations. (5)
	15:50-17:50	Session: Social Networks and Health Inequalities.	Session: Statistical Analysis of Networks (1).	Session: Elite Networks.	Session: Networks and Education.
	18:00--21:30	hospitality suite (BICC 303)			
<b>6/3</b> <b>Sat.</b>	08:00-09:20	Session: Qualitative Social Network Research	Session: Adolescent Friendship Networks.	Session: Guanxi Networks.	Session: Networks and Economics.
	09:20-10:00				Session: Negative and Signed Ties.(9:30-10:10)
	10:20-11:40	Session: Networks and Market Norms.	Session: Guanxi Circle and Organizational Behavior.	Session: Networks in International Trade and Investment.	Session: Entrepreneurial Networks.
	11:40-12:30	INSNA Business Meeting (BICC 307)			
	13:30-15:30	Session: Guanxi Circle and Chinese Venture Capital Network.	Session: Unique Network Structures in Social Media.	Session: Social Capital.	Session: Social Networks and Subjective Wellbeing.
	15:50-16:50	Session: Network Boundary and Network Dynamics.	Session: Network Centrality: Theoretical Advances and Applications.	Session: Network for Learning.	Session: Network Interventions using Network Structure.
	17:00-18:00	Session: Social Media and Mobilization.	Session: Social Media Networks.	Other Social Network Topics	Session: Statistical Analysis of Networks(2).
18:00-21:30	hospitality suite (BICC 303)				

Day	Time	BICC 305A	BICC 305B	BICC 305C	BICC 305D
5/31 Wed.	13:30-15:30	Session: Academic and Scientific Networks. (1)	Session: Networks in Global Health. (1)	Session: Social Capital and Health. (1)	Session: Network Approaches for Environmental Governance.)13:30-15:50)
	15:50-17:50	Session: Academic and Scientific Networks. (2)	Session: Networked Innovation. (1)	Session: Social Capital and Health. (2)	Session: Government and Political Networks. (16:10-17:50)
6/1 Thur.	BICC 305BCDE				
	14:30-16:10	40th Anniversary of INSNA: From Toronto to Beijing: Barry Wellman and Nan Lin			
	16:30-18:00	Keynote Speech: Ronald Burt, Topic: Chinese Entrepreneurs, Social Networks, and Guanxi			
	18:30-21:00	Banquet (Hotel Banquet Room, Lijiang hall, in Beijing Continental Grand Hotel )			
6/2 Fri.		BIC 303	BICC 305ABC		
	08:00-10:00	Session: Networked Innovation. (4)			
	10:20-11:20	Session: Multilevel Network Perspectives in and around Organizations (10:20-11:20)			
	11:20-12:20	Board Meeting (11:30-13:00)			
	13:30-15:30		Keynote Speech Discussion Panel, Ron Burt, Barry Wellman, Nan Lin and Yanjie Bian14: 30-16: 10		
	15:50-17: 50		Freeman Award Address 16: 30-18: 00		
	18: 00--21: 30	hospitality suite(BICC 303)			
6/3 Sat.		BICC307			
	08:00-09:20	Session: Networked Individualism -- East and West.			
	09:30-10:10	Special speech:Networked Individualism -- Barry Wellman (9: 40--10:20)			
	10:20-11:40	Session: Social Networks and Climate Change.			
	11:40-12:30	INSNA Business Meeting (BICC 307)			
		BICC301			
	13:30-15:30	Session: Ethnic Networks			
	15:50-16:50	Session: Business and Corporate Networks.			
	17:00-18:00	Session: Networks and Entrepreneurship in the Digital Age.			
	18: 00-21: 30	hospitality suite(BICC 303)			

## Parallel Sessions

### 5/31 Wednesday-PM1

	BICC 310	BICC 311A	BICC 311B	BICC 311C
PM1	Session: Networks and Organizations. (1)	Session: Historical Network Research. (1)	Session: Business and Corporate Networks. (1)	Session: Advances in Network Methods and Modeling. (1)
Chair	Adil Rodionov	Delfi I. Nieto-Isabel & David Zbiral	Chi-Nien Chung	Kathleen M. Carley
13:30	Positive attribute and negative structural homophily among civic organizations in Kazakhstan, Presented by: Adil Rodionov, Paper ID: 157	Communities of Dissent: A Social Network Approach to the Study of Late Medieval Heresies, Presented by: Delfi I. Nieto-Isabel, Paper ID: 69	Why do Family Business Groups Form Marriage Ties? Evidence from an Emerging Economy, Presented by: Chi-Nien Chung, Paper ID: 25	Socio-Cultural Cognitive Mapping: A new approach for network inference, Presented by: Kathleen M. Carley, Paper ID: 426
13:50	Cutting ties? Interprofessional networks and surgical team performance., Presented by: John M. Hollingsworth, Paper ID: 160	The Role of Women and Men in the Structures of Dissident Christianity in Medieval Languedoc from the Perspective of Social Network Analysis, Presented by: David Zbiral, Paper ID: 68	Social Network Analysis of Banks and their Investment by Segment, Presented by: Shabana Kamal, Paper ID: 27	Excavating Structural Holes: Dyadic Mechanisms Buried in Triadic Theory, Presented by: Amir Sasson, Paper ID: 19
14:10	Findings from the 2015 New Mexico Nonprofit Survey: Inter-organizational Collaboration and Challenges,, Presented by: Kun Huang, Paper ID: 161	Topologies of medieval local power: the prosopographical networks of the Norman nobility in the kingdom of Sicily, Presented by: Hervin Fernández-Aceves, Paper ID: 71	A semantic network analysis of customer perception of Samsung Galaxy Note7 explosion issue, Presented by: Jaewon Lim, Paper ID: 28	Creating context for social influence processes in multiplex networks, Presented by: Antonio Rivero Ostoic, Paper ID: 20
14:30	Deficient management control and role ambiguity as antecedents for employees' embeddedness in intra-organizational information exchange networks, Presented by: Natalie David, Paper ID: 163	Slaves, Freedmen, Indians and Pardos. The Early Modern Social Networks of the Population of Color in the Atlantic Portuguese Empire, Presented by: Agata Bloch, Paper ID: 67	THE ROLE OF INSTITUTIONAL LOGICS IN BOARD INTERLOCK FORMATION: COMPARING U.S. AND CHINESE DIRECTORATE NETWORKS, Presented by: Ji Youn (Rose) Kim, Paper ID: 29	Computing Structural Balance in Signed Networks with Network Motifs, Presented by: KAIQI ZHANG, Paper ID: 22
14:50	Organizational uncertainty and the hierarchical orientation of advisory ties, Presented by: Rick Aalbers, Paper ID: 164	Hypergraph Representations: A Study of Caribe Attacks on Colonial Forces, 1509-1700, Presented by: Termeh Shafie, Paper ID: 73	The Duality of Connections: A Political Control Model of Corporate Strategy, Presented by: Jianhua Ge, Paper ID: 30	Generating random networks with a given blockmodel structure, Presented by: Marjan Cugmas, Paper ID: 23
15:10		Networks of Judges, Accused and Accusers in the 'Mongol' Trials (yarghu) of the Mongolian Empire, Presented by: Florence Hodous, Paper ID: 70	Trust or opportunity? Managing corporate lending networks if institutions are weak, Presented by: Katarzyna Burzynska, Paper ID: 31	Structural Signatures of Group Discussion Networks in Cooperative Online Games using Weighted ERGM, Presented by: Qi Hao, Paper ID: 24
15:30	Tea Break, Outside the room 310			

## 5/31 Wednesday-PM1 cont.

	BICC 305A	BICC 305B	BICC 305C	BICC 305D
PM1	Session: Academic and Scientific Networks. (1)	Session: Networks in Global Health. (1)	Session: Social Capital and Health. (1)	Session: Network Approaches for Environmental Governance. (1)
Chair	Ye Ryung, Kim-Chung	Goylette F. Chami	Lijun Song	Michele L Barnes
13:30	Coordinated Access and Sharing of Expertise Through Social Network During Diaster, Presented by: Ye Ryung, Kim-Chung, Paper ID: 1	Social network fragmentation, Presented by: Goylette F. Chami, Paper ID: 176	Mobility, Social Networks, and Self-Reported Health of Older People Living with HIV/AIDS in Washington, DC, Presented by: Debarchana Ghosh, Paper ID: 17	Polarization and Clustering in Scientific Debate and Problem Framing: Network Analysis of the Science-Policy Interface on Grassland Management in China, Presented by: Aitong Li, Paper ID: 86
13:50	Triple-Helix Network Analysis in Korea-China using Publication and Patent Data, Presented by: Han Woo PARK, Paper ID: 2	Mapping the Tobacco Control Network in China Based on Social Network Analysis, Presented by: Jingjing Du, Paper ID: 177	Social Capital and Self-reported Health Status in Nursing Homes: An Empirical Study, Presented by: Anđelija Arandelovic, Paper ID: 247	Linking Social and Ecological Networks for Environmental Problem Solving, Presented by: Michele L. Barnes, Paper ID: 88
14:10	Management Studies and Human Interests, Presented by: HAN, Yi, Paper ID: 3	Quicker antiretroviral therapy initiation through organizational network strengthening, Presented by: James C. Thomas, Paper ID: 392	Personal networks, cognitive health and survival in late adulthood: Findings from the Longitudinal Aging Study Amsterdam, Presented by: Lea Ellwardt, Paper ID: 249	Private Lands, NGOs, and Landscape Conservation: Assessing Opportunities through Social Network Analysis in the Texas Hill Country, Presented by: Clare Zutz, Paper ID: 345
14:30	Perception upon Virtual Reality on the Press and Twitter: A Semantic Network Analysis, Presented by: Jin Tao Huang, Paper ID: 4	Social Networks and Direct Caregiving in Rural Senegal, Presented by: John Sandberg, Paper ID: 393	Network Effects in Cardiac Rehab -- Empirics and Neural Networks, Presented by: Maksim Tsvetovat, Paper ID: 250	Multilevel scale mismatches in estuary restoration: challenges and opportunities, Presented by: Jesse S. Sayles, Paper ID: 347
14:50	metaknowledge: Open Source Software for Networks Research on Science, Presented by: John McLevey, Paper ID: 5	Influence of a patient transfer network of US inpatient facilities on the incidence of nosocomial infections, Presented by: Juan Fernández-Gracia, Paper ID: 394	Dynamic Evolution of Patients-to-Patients Network in Online Health Community: an Empirical Study based on Stochastic Actor-oriented, Presented by: Jiang Wu, Paper ID: 435	Networks of Policy Change and Continuance: Mapping the Post-Fukushima Energy and Environmental Policy Networks in Germany, Presented by: Manuela Hartwig, Paper ID: 348
15:10			Who get the advice on weight loss from physicians? Network effects on receiving advice on weight loss., Presented by: Keunbok Lee, Paper ID: 436	Key players in conservation diffusion: Using social network analysis to identify critical injection points, Presented by: Emmanuel K. Mbaru, Paper ID: 605
15:30				Social Impact Assessment of Dam Project Using Network Analysis Method, Presented by: Hannaneh Mohamadi Kangarani, Paper ID: 611
15:30	Tea Break, Outside the room 305			

## 5/31 Wednesday-PM2

	BICC 310	BICC 311A	BICC 311B	BICC 311C
PM2	Networks and Organizations. (2)	Session: Historical Network Research. (2)	Session: Business and Corporate Network. (2)	Session: Advances in Network Methods and Modeling. (2)
Chair	Shu Zhang	Delfi I. Nieto-Isabel & David Zbiral	Oliver Rossmannek	Roger S. Chen
15:50	Networks and Professional Deviance in the Prescription Drug Abuse Epidemic, Presented by: Shu Zhang, Paper ID: 166	Social Networks and Meritocracy in Elite Recruitment: The Chinese Civil Service Examinations, 1400–1580, Presented by: Enying Zheng, Paper ID: 519	Institutional development and the contingent value of signals in the alliance formation process, Presented by: Oliver Rossmannek, Paper ID: 34	Incorporating Text Mining into Social Network Analysis for Urban Resilience Governance, Presented by: Roger S. Chen, Paper ID: 90
16:10	Measuring Electronic Communication Networks in Virtual Healthcare Teams Using Electronic Health Records Access-Log Data, Presented by: Xi Zhu, Paper ID: 170	The Jiusan Study Group: A Chinese Academic Network Under Early Communist Rule (1944–1956), Presented by: Henrike Rudolph, Paper ID: 334	Does Interlock Network Still Matter for Corporate Actions: A Retest of Social Influence Theory on Corporate Social Responsibility in the U.S., Presented by: Yi Zhao, Paper ID: 35	Social Influence Network Model of Performance Expectations, Presented by: Jingwen Zhong, Paper ID: 193
16:30	Reducing the cost of knowledge exchange: Extending the relational view of information seeking to multiple knowledge-exchange relationships, Presented by: Yuval Kalish, Paper ID: 171	Session: Mixed Methods Studies in SNA. Questioning closeness: helpful tie as a new dimension in social capital research, Presented by: Amritorupa Sen, Paper ID: 82	The Impact of Distribution Channel on Trial-Version Provision with Positive Network Effect, Presented by: Zelong Yi, Paper ID: 36	Anonymizing Social Network Data for the Research Community, Presented by: John Skvoretz, Paper ID: 194
16:50	Social network in terrorist organization: Detection of terrorist activities by a two-step strategy, Presented by: Ze Li, Paper ID: 172	Session: Networks and Culture. Reputation and Success in Art, Presented by: Samuel Fraiberger, Paper ID: 128	Corporate Financial Distress and CEO Networks, Presented by: Ahmed H. Eissa, Paper ID: 312	Attribute-based Network Measurements: Working with Overlapping Group Memberships, Presented by: Martin Everett, Paper ID: 230
17:10	Session: Networks and Institutions. Business-government ties targeting to improve firm innovation during the institutional transition of China: A multilevel analysis, Presented by: Yang Chun, Paper ID: 144		Evaluating the Effectiveness of Crisis Response Strategies on Public Response based on Semantic Network Analysis and Topic Modeling: A Case of Samsung Galaxy Note 7 Explosion, Presented by: Han Woo Park, Paper ID: 313	Optimization of small-world property based on Memetic Algorithm, Presented by: JINGJING WANG, Paper ID: 307
17:30				Inference versus estimation in exponential random graph models, Presented by: Alex Stivala, Paper ID: 18

## 5/31 Wednesday-PM2 cont.

	BICC 305A	BICC 305B	BICC 305C	BICC 305D
PM2	Session: Academic and Scientific Networks. (2)	Session: Networked Innovation. (1)	Session: Social Capital and Health. (2)	Session: Government and Political Networks. (1)
Chair	Victor Tishchenko,	Dean Lusher	Lijun Song	Zachary Neal
15:50	Unfolding of scientific communities in virtual networks, Presented by: Victor Tishchenko, Paper ID: 7	Testing Effects of Group Intellectual Diversity on Group Members, Presented by: Alexander Victor Graham, Paper ID: 114	Gendered associations between network size and self-rated health (SRH): a multilevel analysis of primary survey data on Lao adults, Presented by: Harris Hyun-soo Kim, Paper ID: 516	
16:10	Network Analysis of Literature on Network Clustering from WoS, Presented by: Vladimir Batagelj, Paper ID: 8	Communicate or Perish. Predicting innovative behaviors via Email Communication Analysis., Presented by: Andrea Fronzetti Colladon, Paper ID: 115	Session: Spatial Networks. Spatial Networks and Urban Inequality, Presented by: Joseph Galaskiewicz, Paper ID: 276	Structural Balance and Polarization in the U.S. Congress, 1973-2016, Presented by: Zachary Neal, Paper ID: 63
16:30	Building relationships in science, Presented by: Luka Kronegger, Paper ID: 229	Knowledge Sharing Behaviour in Three Open Innovation Cases, Presented by: Andrew Terhorst, Paper ID: 116	Session: Spatial Networks. Geographic and Social Proximity as Antecedents of Managerial Collaboration, Presented by: Olaf Rank, Paper ID: 277	Social Capital and Political Upward Mobility in Reforming China: Evidence from Chinese Provincial Leaders from 1990 to 2013, Presented by: Rongrong Lin, Paper ID: 330
16:50	Acknowledgement patterns and networks: the case of accounting scholarship, Presented by: Andreas Andrikopoulos, Paper ID: 301	Towards successful innovation of public research: Transitioning from business models to industry engagement models, Presented by: Bopha Roden, Paper ID: 117		A Social Network Analysis on the Mechanism of Community Policing, Presented by: Xiaozhan Wang, Paper ID: 331
17:10	Session: Social Network Analysis of Mobile Phone Datasets. Locations of social network as part of daily activity space, Presented by: Anniki Puura, Paper ID: 264	How experiential learning diffuses in organizations, Presented by: Colin Gallagher, Paper ID: 118		Extensions of the Network Change Model to Political Realms, Presented by: David Krackhardt, Paper ID: 504
17:30	Session: Social Network Analysis of Mobile Phone Datasets. Over-Time Social Network Analysis on Cellular Phone Network Data, Presented by: L. Richard Carley, Paper ID: 454	Structural differences between data collected from primary and secondary sources, Presented by: Julien Brailly, Paper ID: 119		

## 6/1 Thursday-AM1

	BICC 310	BICC 311A	BICC 311B	BICC 311C
AM1	Networks and Organizations. (3)	Session: Networks in Global Health. (2)	Session: Academic and Scientific Networks. (3)	Session: Government and Political Networks. (2)
Chair	Gopakumar	Leanne Dougherty	Jesse Fagan	Anatoliy Gruzd
08:00	Formation of Hierarchically Structured Teams, Presented by: Gopakumar, Paper ID: 384	The Influence of Social Networks on Infant and Young Child Feeding Behaviors in Burkina Faso, West Africa, Presented by: Leanne Dougherty, Paper ID: 395	Linguistic Signatures of Cross-Boundary Research, Presented by: Jesse Fagan, Paper ID: 302	What Binds Us Online: Friendship vs. Communication Ties?, Presented by: Anatoliy Gruzd, Paper ID: 53
08:20	Hyperlink Connectivity: An Analysis of Western Australia's Tourism Industry, Presented by: Hossein Raisi, Paper ID: 385	Structural network position and performance of popular opinion health leaders within an HIV prevention trial in Dar es Salaam, Tanzania, Presented by: Marta Mulawa, Paper ID: 396	Knowledge flow and innovation networks of genetically modified (GM) crops, Presented by: Jianxun Chu, Paper ID: 303	Facing the Giants: A Network Analysis of Transnational Advocacy Campaign at Intergovernmental Organizations, Presented by: Bi Zhao, Paper ID: 54
08:40	Complexity of Organisational Interdependencies, Presented by: Justyna Tasic, Paper ID: 386	The Social Network of Volunteers Working on Tobacco Control in Beijing, Presented by: Wen-Juan Wang, Paper ID: 397	Evaluating NIH Translational Science Program in Scientific Collaboration Networks, Presented by: Meng-Hao Li, Paper ID: 304	Look Who's Talking: Bipartite Networks as Representations of a Topic Model of New Zealand Parliamentary Speeches, Presented by: Demival Vasques Filho, Paper ID: 57
09:00	Network embeddedness, knowledge diversity and performance in teams: The case of robotic surgery, Presented by: Marco Tonellato, Paper ID: 387	Why online cancer information goes viral? Role of personal influence, homophily, and network structure, Presented by: Xiaohui Wang, Paper ID: 398	Identifying researcher complementarity in a scientific network, Presented by: Vinton Cheng, Paper ID: 306	Inter-Agency Collaboration in Local Government: Evidence from Water Governance in Dongguan, China, Presented by: Hongtao Yi, Paper ID: 59
09:20	Structures within and between individuals: Combining psychological and social networks, Presented by: Srebrenka Letina, Paper ID: 389	Whom to Talk to about Diabetes? Exploring the Formation of Online Network of #DSMA, Presented by: Ye Sun, Paper ID: 399		Cross-level coordination for electronic public services: A social network analysis of Guangzhou's online business hall, Presented by: Huiping Zhang, Paper ID: 60
09:40	Breaking the Glass Ceiling: The Social Capital of Senior Female Executives, Presented by: Heather McGregor, Paper ID: 501			Lobbying beyond interests in the EU Climate Change and Energy Policy-Making Process: An Explanation of Coalitions' Formation through Multilevel Network Dynamics., Presented by: Valentina Baiamonte, Paper ID: 62
10:00	Tea Break, Outside the room 310			



## 6/1 Thursday-AM2

	BICC 310	BICC 311A	BICC 311B	BICC 311C
AM2	Session: Internet, Social Media, and Social Networks. (1)	Session: Networked Innovation. (2)	Session: Networks and Labor Markets. (1)	Session: Personal Networks and Vulnerability in the Life Course.
Chair	Aimei Yang	Dean Lusher	Elena Obukhova	Marlène Sapin & Eric Widmer
10:20	Humanitarian Advocacy in the International Refugee Crisis: NGOs' Network Agenda Building and Setting, Presented by: Aimei Yang, Paper ID: 74	Bipartite innovation networks and collaboration between patent owners, Presented by: Demival Vasques Filho, Paper ID: 120	Who do referrers work for? Marketization and network use in the Chinese labor market, Presented by: Elena Obukhova, Paper ID: 145	Patterns of positive and negative relationships in family networks and mental health: Exploration of relational resources and strains in a general population sample, Presented by: Marlène Sapin, Paper ID: 203
10:40	From Online Strangers to Offline Friends: In-depth Interviews of Video Game Players in Hong Kong, Presented by: Gina Lai, Paper ID: 75	Endogenous Legal Innovation in the Global Trade Governance Complex, Presented by: James Hollway, Paper ID: 121	Use of Social Ties for Job Search by College Students in China, Presented by: Gina Lai, Paper ID: 147	Potential role of personal social network analysis as a therapeutic tool in work with young people experiencing mental health challenges, Presented by: Jeffrey Grierson, Paper ID: 204
11:00	Perceptions on Electric Vehicles and Their User Interface: A Case of Tesla S, Presented by: JangHyun Kim, Paper ID: 76	Networks of Innovation: Models from Japanese Advertising, Presented by: John McCreery, Paper ID: 122	Space, Social Capital and Labor Market Performance, Presented by: Ke-Wei Lu, Paper ID: 148	Conflict structures in family networks of older adults and their relation with health related quality of life, Presented by: Widmer, Paper ID: 205
11:20	Leveraging Neural Network Algorithms to Explore Teachers' Social Networks and Knowledge Diffusion, Presented by: Kaitlin T. Torphy, Paper ID: 77	Wise innovation? Using a personal network perspective for identifying innovation and nurse champions of innovation, Presented by: Shirly Luz, Paper ID: 123	Social Capital and Getting a Job for Young Adults in Taiwan, Presented by: Ray-May Hsung, Paper ID: 149	The impact of personal networks on conjugal and psychological vulnerability of heterosexual couples in a long-term relationship: a longitudinal perspective Presented by: Rita Gouveia Paper ID:417
11:40	Team Formation in Collaborative Crowdsourcing, Presented by: Ruqin Ren, Paper ID: 78	The Value of Instrumental Brokerage in Preserving Ideation Activity, Presented by: Rick Aalbers, Paper ID: 124	Trajectories analysis of Chinese hosts' flow across different TV stations, Presented by: Jinmiao Wang, Paper ID: 377	Is having enemies an important feature in adolescents' networks? Presented by: Stéphanie Baggio Paper ID:418
12:00	Exploration and Exploitation of Team Assembly Strategies in a MOBA, Presented by: Xiaozhe Arcadia Zhang, Paper ID: 80	Teaming up for challenges: a two-mode network analysis of collaborative crowdsourcing, Presented by: Rong Wang, Paper ID: 125		

## 6/1 Thursday-PM1

	BICC 310	BICC 311A	BICC 311B	BICC 311C	BICC 305 B,C,D,E
PM1	Session: Networks in Global Health. (3)	Session: Networked Innovation. (3)	Session: Networks and Labor Markets. (2)	Networks and Organizations. (4)	
Chair	Feng Lin	Dean Lusher	Jongyoun Baek	Zhanfeng Li	
13:30	Exploratory ICF Core Sets for Stroke with Network Analysis, Presented by: Feng Lin, Paper ID: 404	Analysis of the influence of social networks on the innovation capacity of individuals, Presented by: DESI RAULIN, Paper ID: 511	High-Status Affiliations and Task Performance: The Analysis of Categorical Alignment as a Moderator, Presented by: Jongyoun Baek, Paper ID: 378	Social network based exploration on global terrorism evolutionary: the Matthew Effect, Presented by: Zhanfeng Li, Paper ID: 173"	
13:50	Perturbations, behaviour, and disease: network insights into woylie response to fire and range expansion, Presented by: Krista Jones, Paper ID: 408	Social processes of regional industrial symbiosis networks for SMEs, Presented by: Sarah King, Paper ID: 610	Diversity Initiatives and Network Advantage: Examining the effects of the NFL's Rooney Rule on Minority Hiring, Presented by: Wyatt S. Taylor, Paper ID: 379	Development of a Psycho-structural Approach to the Study of Groups and Teams, Presented by: André Escórcio Soares, Paper ID: 381"	
14:10	Risk communication networks in families affected by Alzheimer's disease, Presented by: Laura M. Koehly, Paper ID: 409	When the Governance Structure Choice Overshadows Competitive Advantage, Presented by: Tao Wang, Paper ID: 367	Gender salary gap and job network, Presented by: Youngjoon Bae, Paper ID: 380	The Structure of Organizational Ecosystems: A Holistic Approach to Niche Space and Market Dynamics, Presented by: Brian Aronson, Paper ID: 382"	

## 6/1 Thursday-PM2

	BICC 310	BICC 311A	BICC 311B	BICC 311C	BICC 305 B,C,D,E
PM2	Session: Network Approaches to Language, Meaning, and Sociocultural Contexts. (1)	Session: Internet, Social Media, and Social Networks. (2)	Session: Business and Corporate Networks. (3)	Session: Advances in Network Methods and Modeling. (3)	
Chair	David L. Elliott	Yunya Song	Jiao Jinhan	Xiaochen He	
14:50	The Global Structure of Communication Studies: A Social and Semantic Network Analysis of International Communication Association, Presented by: Ke Jiang, Paper ID: 95"	Comparing Online Discussion Networks in Elite-initiated versus Grassroots-initiated Genetically Modified Food Controversies: The Case of China's Social-Media Space, Presented by: Yunya Song, Paper ID: 81	The theoretical model research on SMEs' open innovation commercialization performance of symmetric alliance: based on the perspective of social network, Presented by: Jiao Jinhan, Paper ID: 314	Optimization of small-world property based on multiobjective evolutionary algorithm with decomposition, Presented by: Xiaochen He, Paper ID: 309	40th Anniversary of INSNA: From Toronto to Beijing: Barry Wellman and Nan Lin (14: 30--16: 10)
15:10	A network visualisation method of cognitive dissonance in discourses: discovery, validity, application and extensions, Presented by: Marc Idelson, Paper ID: 96"	A Taste of Discrimination: Intergroup Bias Communicated through Yelp Reviews, Presented by: Chao Yu, Paper ID: 337	Why Take The Risk?: Firm Choices in Network Forms of Organization, Presented by: Meredith Woehler, Paper ID: 315	Friendship Formation: Testing Heterogeneity using an Agent-based Model, Presented by: Xiaomeng Li, Paper ID: 311	
15:30	Evolution of Chinese Function Words in Co-occurrence Networks, Presented by: Xinying CHEN, Paper ID: 101"	Emergence of scale-free networks and small-world properties in psychosocial feelings expressed on Twitter, Presented by: Thejan Rajapakshe, Paper ID: 339	Institutional Legacy and Similarity of Political Behavior Among Business Groups in Taiwan, Presented by: Shi-Rong Lee, Paper ID: 316	Modelling Online Social Network Users by Attitude to Key Events, Presented by: Karpov Ilia, Paper ID: 425	
15:50	A Network Approach to Understanding Aphasics: Insights from Word Co-Occurrence Networks and Functional Brain Graph Modeling, Presented by: Zhongli JIANG, Paper ID: 102"	From Virtual Space to Public Space: Online Activism and Political Mobilization during the Arab Spring, Presented by: Harris Hyun-soo Kim, Paper ID: 507	Association Analysis between Customers' Review and Purchasing Behavior on B2C Platforms, Presented by: Shixiong Wang, Paper ID: 317	Session: Dynamics of Multilevel Networks. The social embeddedness of adolescents' media use. A multilevel network approach, Presented by: Matthias Bixler, Paper ID: 324	
16:10—16:30	Tea Break, Outside the room 310				
16: 30--18: 00	Keynote Speech: Ronald Burt(in Room 305 B C D E)				
18: 30--21: 00	Banquet (Hotel Banquet Room, Lijiang Restaurant, in Beijing Continental Grand Hotel )				

## 6/2 Friday-AM1

	BICC 310	BICC 311A	BICC 311B	BICC 311C	BICC 303
AM1	Session: Recent Advances in Statistical Analysis and Mathematical Modeling of Social Networks (1)	Session: Social Capital in Social Networks. (1)	Session: Network Approaches to Language, Meaning, and Sociocultural Contexts. (2)	Session: SNA in Russia: Progress and Prospects. (1)	Session: Networked Innovation. (4)
Chair	Frederick Kin Hing Phoa	Song Yang & Wenhong Zhang	David L. Elliott	Valentina Kuskova	Dean Lusher
08:00	Dynamic Latent Factor Network Modeling of the United Nations Voting Behaviors, Presented by: Xiaoyue Niu, Paper ID: 200	Networks in the Mind: Awakening Dormant Ties, Presented by: Bálint Diószegi, Paper ID: 251	Investigating the Stance and Rhetorical Structure of Longer Spans of Written Academic Discourse, Presented by: David L Elliott, Paper ID: 349	Solving the problem of ineffective subsidiary: the impact of intraorganizational networks, Presented by: Antonina Milekhina, Paper ID: 237	Social networks and individual innovative behavior ----- A Case Study of H Hospital in Beijing, Presented by: Cai Yuanqing, Paper ID: 360
08:20	Network autocorrelation modeling: Bayesian approaches for estimating and testing multiple network autocorrelations, Presented by: Dino Dittrich, Paper ID: 212	Does peers affect individual performance beyond work? A social network perspective., Presented by: Nobin Thomas, Paper ID: 253	Are there Core Frames in Framenet? An Exploratory Network Analysis on Frame-to-frame Relations of Framenet, Presented by: Joseph Wai-ip, Lam, Paper ID: 350	Mapping the Community of Network Researchers in RUSSIA: Structure and Thematic Agenda, Presented by: Daria Maltseva, Paper ID: 238	A Proposed Temporal Model of Networked Conflict Among Wikipedia Page Editors and Conflict's Impact on Article Quality Scores, Presented by: Chris Robbins, Paper ID: 361
08:40	Community Detection under Exponential Random Graph Model: A Metaheuristic Approach, Presented by: Frederick Kin Hing Phoa, Paper ID: 213	A Changing Landscape? An Intersectional Analysis of Race and Gender in Access to Social Capitals, Presented by: Song Yang, Paper ID: 254	Uncovering Relational Meaning through Discussion Networks, Presented by: Neha Gondal, Paper ID: 352	Modelling the Impact of Mass Protests of 2010s on Political Change (by using Data Envelopment and Social Network Analysis), Presented by: Dmitry Zaytsev, Paper ID: 239	The Role of Hierarchy for Tacit and Codified Knowledge Transfer in Advanced Manufacturing Settings, Presented by: Dean Lusher, Paper ID: 363
09:00	Applying Bayesian inference for ERGM to a large multilevel criminal network, Presented by: johan koskinen, Paper ID: 214	Social networks and its potential in creating social capital - a German case study, Presented by: Texier-Ast, Verena, Paper ID: 255	The relation between anger and crime: analysis of discourse structure of violent crimes in Korea, Presented by: Sunhyoung Lee, Paper ID: 353	Regional migration in Russia from a network perspective: identifying key migration flows between regions, Presented by: Elena Artyukhova, Paper ID: 241	The relational dimensions of ideas development: A case study of an innovation contest in car manufacturing., Presented by: Marco Tonellato, Paper ID: 365
09:20	Efficient MCMC Estimation for Exponential Random Graph Models, Presented by: Maksym Byshkin, Paper ID: 216	Brain Connectivity and Social Network Embeddedness of Older Adults in South Korea, Presented by: Yoosik Youm, Paper ID: 256	"Relation between social influence and discourse similarity in workgroups through time, Presented by: Johanne Saint-Charles, Paper ID: 509"	Intra-organizational networks in project-based organizations: communication networks as a key to success, Presented by: Ivan Kuznetsov, Paper ID: 243	Social Marginalization of Overweight/Obese Middle Adolescents in Taiwan, Presented by: Duan-Rung Chen, Paper ID: 14
10:00	Tea Break, Outside the room 310				

## 6/2 Friday-AM2

	<b>BICC 310</b>	<b>BICC 311A</b>	<b>BICC 311B</b>	<b>BICC 311C</b>	<b>BIC 303</b>
AM2	Session: Recent Advances in Statistical Analysis and Mathematical Modeling of Social Networks (2)	Session: Social Capital in Social Networks. (2)	Session: Community Social Capital and Community Revitalization.	Session: SNA in Russia: Progress and Prospects. (2)	Session: Multilevel Network Perspectives in and around Organizations.
Chair	Frederick Kin Hing Phoa	Song Yang & Wenhong Zhang	Man Shuai	Valentina Kuskova	Yu Xu
10:20	Duality of Social Selection and Social Influence - ERGMs for network dynamics, Presented by: Peng Wang, Paper ID: 219	Do we really discuss important things with unimportant others? On the tie strength of discussion networks and important tie networks, Presented by: Beate Volker, Paper ID: 438	Longitudinal Analysis of Collaboration Graphs of Forked Open Source Software Development Projects, Presented by: Emerson Amirhosein Azarbakht, Paper ID: 37"	Scientific Community of Russian Sociologists: Network Analysis of Biographical Interviews, Presented by: Stanislav Moiseev, Paper ID: 244	The interplay between expertise, follower-follower relations, and commenting behaviors in crowdsourcing: A multidimensional network perspective, Presented by: Yu Xu, Paper ID: 85
10:40	Sensitivity analysis for biases in network observations, Presented by: Ran Xu, Paper ID: 220	Social Network Structure and Social Capital, Presented by: Joseph F. Cabrera, Paper ID: 440	Patterns, factors, and effects of partnership: Exploring community-based organizations involved in social services at a historical Taipei area, Presented by: Yi-Yi Chen, Paper ID: 39"	Spread of information in Political Discourse Networks, Presented by: Tamara Shcheglova, Paper ID: 245	Competition and collaboration in multilevel organized criminal networks, Presented by: James Coutinho, Paper ID: 192
11:00	Combining decision by sampling and Schelling model: The effect of within – group network on segregation generation, Presented by: YE Han-zhang, Paper ID: 221	The Association of Leisure Activities and Cognitive Functioning in Old Age: The Role of Social Capital, Presented by: Julia Sauter, Paper ID: 441	Why is Trust in the Federal Government Higher than Local Governments in Rural China? --An Social Capital Approach to Study Distributive Injustice, Presented by: Shuai Man, Paper ID: 322	PERSONALITY TRAITS BEHIND THE MUTUAL FORMATION OF POLITICAL ATTITUDES AND SOCIAL RELATIONSHIPS, Presented by: Yana Maria Priestley, Paper ID: 246	A Social Network Analysis of the Relationship between NGOs and Foundations in China, Presented by: Qingyan WANG, Paper ID: 508
11:20	A New and Efficient Tool on the Measurement of Network Spread, Presented by: Yuan-Lung Lin, Paper ID: 222	Personality and Creation of Social Capital, Presented by: Marina Tulin, Paper ID: 443	Bottom-up Consent: Social Capital, Government Arrangement, and Post-Disaster Recovery, Presented by: Zhonghao Wang, Paper ID: 323	Network Structure of Russian Sociological Journals, Presented by: Aleksandr Semenov, Paper ID: 433	
11:40	Beyond Profiling: Modelling Affiliation Behavior with Criminal Organizations Using Blau Status Analysis, Presented by: Michael Genkin, Paper ID: 410	Exploring Female Felons' Access to Resources with Egocentric Networks, Presented by: Marva V. Goodson, Paper ID: 444	Influences of Social Capital on Political Participation in Rural Areas in China, Presented by: Fanmu Zeng, Paper ID: 424	Weighting Relationship Strength in Online Social Networks Based on Text Clustering, Presented by: Karpov Iliia, Paper ID: 434	

## 6/2 Friday-PM1

	BICC 310	BICC 311A	BICC 311B
PM1	Session: Sex Networks and Health.	Session: Networks and Experiments.	Session: Online Social Networks.
Chair	Carol Strong	Eric Gladstone	Shu-Fen Tseng
13:30	Network-Related Risk Factors for the Detection of Anogenital Human Papillomavirus in a Community Cohort of Adult Men Who Have Sex with Men in Taiwan, Presented by: Carol Strong, Paper ID: 231	Connecting newcomers to a social network with the right alters: Designing a randomized field experiment to test network interventions, Presented by: Florian Schلودerer, Paper ID: 140	The Echo Chamber Effects: Measuring Network Homophily in Social Media, Presented by: Shu-Fen Tseng, Paper ID: 188
13:50	Statistical adjustment of network degree in respondent-driven sampling by individual-venue attendance information, Presented by: Ming Cao, Paper ID: 235	Strategic Players for Identifying Optimal Social Network Intervention Subjects, with Application to an Undergraduate Social Network, Presented by: Miles Ott, Paper ID: 141	Longitudinal Change of Core Discussion Network in terms of Size and Discourse in Online Public Forums, Presented by: Sujin Choi, Paper ID: 189
14:10	Network cognition and online dating; Presented by: Bernie Hogan, Paper ID: 429	Gender differences in trust game: the influences of Social capital, Presented by: Yang, Tien-Tun, Paper ID: 142	Understanding Public Mindset on Weight Loss From Consumer-generated Online Data, Presented by: Bo Liang, Paper ID: 400
14:30	Drivers of network structure in sexual contact networks: implications for disease modeling, Presented by: Nicole Bohme Carnegie, Paper ID: 430	The effects of social value orientation, punishment on bypassing immediate leadership, Presented by: Jun Liu, Paper ID: 375	Why Are You Quoted by Others Within A Thread? An Exploration of Reference Ties Among Posters In Online Health Communities, Presented by: Bo Liang, Paper ID: 401
14:50		Social Network Characteristics that Influence Seller's Decision to Join a Sharing Economy Platform, Presented by: Kristina Maiksteniene, Paper ID: 376	Knowledge Contribution in Open Source Communities: The Saliency of Reciprocity, Presented by: Jyun-Cheng Wang, Paper ID: 514
15:10			
15:30	Tea Break, Outside the room 310		

## 6/2 Friday-PM1 cont.

BICC 311C		BICC 305ABC
PM1	Session: Networks and Organizations. (5)	
Chair	Zhiya Guo	
13:30	The Impact of Open and Closed Informal Boundary Spanning Ties on Leadership Emergence in the Field of Large Collaborative Science, Presented by: Zhiya Guo, Paper ID: 390	
13:50	Intraorganizational Communication Networks and Climate for Implementation, Presented by: Alicia Bunger, Paper ID: 403	
14:10	Team Dynamics in Spaceflight Analogs: Shared Mental Models, Informal Social Roles, and Team Viability and Conflict in the Human Exploration Research Analog (HERA), Presented by: Jeffrey C Johnson, Paper ID: 405	
14:30	Social Intelligence and Social Networks Explain Collective Intelligence in Teams, Presented by: Kayla de la Haye, Paper ID: 407	
14:50	Capability, Role, or Relation: Collaboration in Dota 2 Combat Teams, Presented by: Yun Huang, Paper ID: 412	Keynote Speech Discussion Panel, Ron Burt, Barry Wellman, Nan Lin and Yanjie Bian 14: 30-16: 10
15:10	Energy Networks and Individual Performance in Organizations, Presented by: Tiziana Casciaro, Paper ID: 606"	
15:30	Tea Break, Outside the room 310	

6/2 Friday-PM2

	BICC 310	BICC 311A	BICC 311B
PM2	Session: Social Networks and Health Inequalities.	Session: Statistical Analysis of Networks. (1)	Session: Elite Networks.
Chair	Lijun Song	Qinyun Lin	Franziska Barbara Keller
15: 50	Network Members' Occupational Status, Tie Strength, and Depression in Two Societies, Presented by: Lijun Song, Paper ID: 270	Different Treatments of Weights to Generate Null Models in Significance Tests in Community Detection Algorithms for Weighted Network Data, Presented by: Qinyun Lin, Paper ID: 278	Elite Social Capital Reproduction in Urban China under Mao, Presented by: Danching Ruan, Paper ID: 41
16:10	Contagion of Suicidal Thoughts among Korean Older Adults: Network-Structure Contingency of Contagion, Presented by: Seungwon Lee, Paper ID: 271	Accounting for Heterogeneity in the Network Formation Behaviors: With an Application to Vietnamese SMEs, Presented by: Daichi Shimamoto, Paper ID: 279	Public appearances of political elites in opaque regimes - the cases of China and the Soviet Union, Presented by: Franziska Barbara Keller, Paper ID: 44
16:30	A Social Network Analysis of Venues Serving Young Latino MSM in Miami, Presented by: Mariano Kanamori, Paper ID: 457	Predictors of community cohesion in two communities of wild eastern chimpanzees ( <i>Pan troglodytes schweinfurthii</i> ), Presented by: Joseph T. Feldblum, Paper ID: 406	Difference or Similarity? Understanding corporate elites' networking behavior in constructing friendship and advice ties, Presented by: Pyung Nahm, Paper ID: 45
16:50	Session: Sex Networks and Health. Group-level isolation, depression, and ADMA (Asymmetric Dimethylarginine) among older adult population of a Korean rural village, Presented by: Yoosik Youm, Paper ID: 431	The relative importance of similarity, contact opportunity, and balance in friendship transitivity, Presented by: András Voros, Paper ID: 463	ESG (Brazilian War School): the use of the Gephi program to analyze the social political network, Presented by: Gilberto de Souza Vianna, Paper ID: 327
17:10	Session: Urban Social Networks. Understanding Urban Mobility from Public Transportation Perspective Using Smart-Card Data: The Case of Shanghai, Presented by: Xu Wang, Paper ID: 471	Session: Personal Networks in Comparative Perspective. A comparison of personal networks between Chongqing, Toulouse and San Francisco, Presented by: JIN HUANG, Paper ID: 206	Session: Networks and Education. Known Devils or Unknown Angels: Which peers matter when? A network approach to understand group formation in a higher-education setting, Presented by: Rihana Shaik, Paper ID: 411
17:30		Session: Personal Networks in Comparative Perspective. Resource generator in comparative perspective, Presented by: Dominique Joye, Paper ID: 207	Do Mayors' Social Networks Increase Local Governments' Performance?: Network Analyses of 300 Local Governments in the Philippines, Presented by: Jun Kobayashi, Paper ID: 329
18: 00-21: 30	hospitality suite (BICC 303)		



## Friday-PM2 cont.

	BICC 311C	BICC 305ABC
PM2	Session: Networks and Education.	Keynote Speech Discussion Panel, Ron Burt, Barry Wellman, Nan Lin and Yanjie Bian
Chair	Anatoliy Gruzd	
15:50	Networked Learning and Analytics in Online Education, Presented by: Anatoliy Gruzd, Paper ID: 133	
16:10	Social networks and favourite subjects: can friends explain gender differences in STEM preferences?, Presented by: Isabel J. Raabe, Paper ID: 135	Tea Break, Outside the room 310
16:30	Linking structure and content: college-related support networks of Peruvian disadvantaged students, Presented by: Martin Santos, Paper ID: 370	Freeman Award Address
16:50	Investigating the Relationship Between Teacher Professional Networks, Self-Efficacy, and Capacity for Diffusion of Computer Science Standards in an Urban District, Presented by: Rebecca Mazur, Paper ID: 371	
17:10	Informal instructional resource acquisition and diffusion within Pinterest: A study of early career teachers' physical and virtual social networks, Presented by: Zixi Chen, Paper ID: 373	
17:30		
18: 00-21: 30		hospitality suite (BICC 303)

## 6/3 Saturday-AM1

	BICC 310	BICC 311A	BICC 311B
AM1	Session: Qualitative Social Network Research.	Session: Adolescent Friendship Networks.	Session: Guanxi Networks.
Chair	Diana M. Kingsbury	Ching-chieh Huang	Wang Xiao
08:00	The Role of Social Networks in Providing Social Support to Resettled Female Refugees During Pregnancy in the United States, Presented by: Diana M. Kingsbury, Paper ID: 209	The structure and social support of the friendship networks among urban and rural schoolchildren in Taiwan, Presented by: Ching-chieh Huang, Paper ID: 10	Digitalized renqing flowing in a Chinese journalists' network: how the space for guanxi capital is diminishing in the digital era, Presented by: Wang Xiao, Paper ID: 66
08:20	A Study on the Strike Strategy of MLN Organization Based on Multiplex Nature, Presented by: duo-yong sun, Paper ID: 210	Exploring Male High School Students' Friendship Networks Change in Korea, Presented by: Chongmin Kim, Paper ID: 11	Guanxi Violates Justice? Marketization and Public Attitudes towards Guanxi Practice, Presented by: Felicia F. Tian, Paper ID: 332
08:40	Leveraging Social Network to Legitimize the Sharing Economy, Presented by: Yong Lin, Paper ID: 211	Status Struggles: Position, Peer and Practice in Classroom, Presented by: Chyi-in Wu, Paper ID: 12	Emergence and causality: the role of ties in the process of job hunting, Presented by: Jun Liu, Paper ID: 333
09:00	Weak Ties Lacking Strength: A Case Study of Self-Employed African Businessmen in Guangzhou, China, Presented by: Di Shao, Paper ID: 225	Deconstructing the World of Student Friendships: An Ego-network Analysis, Presented by: Thomas Odell, Paper ID: 16	Session: East Asian Social Networks. Social Network, Relative Deprivation, and Protest Propensity in Urban China: A Structural-Cognitive Approach, Presented by: yongjun zhang, Paper ID: 40
09:20	The Strategic Pursuit of Black Homophily, Presented by: Tamara Gilkes, Paper ID: 421		Session: East Asian Social Networks. Assessment of Adolescent Body Mass Index (BMI) and Sedentary Activities within Their Social Networks in Kunming, China, Presented by: Jenna Hua, Paper ID: 326
09:40	A Plea For Interdisciplinarity: The Benefits for the Structural Analysis of Social Networks, Presented by: Verena Knerich, Paper ID: 422		
10:00	Tea Break, Outside the room 310		

## 6/3 Saturday-AM1 cont.

	BICC 311C	BICC 307
AM1	Session: Networks and Economics.	Session: Networked Individualism -- East and West.
Chair	Taoxiong Liu	Barry Wellman
08:00	Assets Diversification, Portfolios Homogenization and Systemic Risk, Presented by: Taoxiong Liu, Paper ID: 129	Connected and Networked Seniors, Presented by: Barry Wellman, Paper ID: 113
08:20	The Role Played by Social Network on the Risk of Informal Finance: A Study based on Theoretical and Empirical Analyses of Social Network Structure, Presented by: Yaorong L Lowan, Paper ID: 131	Towards a Theory of Open Entrepreneurship, Presented by: Zeynep Yetis-Larsson, Paper ID: 520
08:40	Varieties of Intergovernmental Organization Memberships and Structural Effects in the World Trade Network, Presented by: Zhengqi Pan, Paper ID: 132	Online gay communities as communities : A space for Gay Rights Movements in India, Presented by: Somrita Ganchoudhuri, Paper ID: 359
09:00	Supply Chain Disruptions and Trade Credit, Presented by: Lianming Zhu, Paper ID: 369	Can there be too many trees? The relationship between green spaces and social capital, Presented by: Vincent Chua, Paper ID: 199
09:20	Session: Negative and Signed Ties(9: 30-10:10). Nicholas Harrigan	Special speech: Networked Individualism -- Barry Wellman (9: 30--10:10)
	The Cost of Ties: Explaining balance and status in signed tie formation., Presented by: Nicholas Harrigan, Paper ID: 197	
09:40	Analysing Balance in Social, Biological, and Political Signed Networks using the Frustration Index, Presented by: Samin Aref, Paper ID: 343	
10:00	Tea Break, Outside the room 310	

## 6/3 Saturday-AM2

	BICC 310	BICC 311A	BICC 311B
AM2	Session: Networks and Market Norms.	Session: Guanxi Circle and Organizational Behavior.	Session: Networks in International Trade and Investment.
Chair	Guillaume Favre	Xiao-Yun Cao	Jiangtao Fu
10:20	Ties that bind, ties that structure : The case of French Socially Responsible Investment, Presented by: Elise Penalva-Icher, Paper ID: 151	The Measurement of Guanxi Circles—Using Qualitative Study to Modify Quantitative Measurement, Presented by: Luo, Jar-Der, Paper ID: 601	Propagation of Financial Constraints in the Global Production Network: Evidence from Firm-level Data for Asian Economies, Presented by: Jiangtao Fu, Paper ID: 181
10:40	The micro-relational structure of the EU interbank money market. The effect of market uncertainty on transactions sequences, Presented by: Federica Bianchi, Paper ID: 154	Guanxi Circle and Performance: Do Structural Holes Matter in China?, Presented by: Yang, Kun Hao, Paper ID: 602	A Network Analysis of International Trade in Plastic Waste, Presented by: Yikang Bai, Paper ID: 183
11:00	The persistence of face to face interactions in a digitalized economy: the effects of an electronic matching platform on 'real' relationships in two trade fairs., Presented by: Guillaume Favre, Paper ID: 155	Organizational Justice in Chinese Guanxi Circles, Presented by: Cao, Xiao-Yun, Paper ID: 603	Propagation of Shocks due to Natural Disasters through Global Supply Chains, Presented by: Yuzuka Kashiwagi, Paper ID: 184
11:20	Social networks in the collaborative economy: the making of a sector and its norms, Presented by: Paola Tubaro, Paper ID: 156	Admire from Heart in the view of power distance: Examining the relationship between Guanxi circle, emotion labor and job satisfaction, Presented by: Zhang, Ya-Juan, Paper ID: 604	Economic Crises within Global Value Chains: Examining the Complex Dynamics of the World Trade Network, Presented by: Zhengqi Pan, Paper ID: 185
11: 40-12: 30	INSNA Business Meeting (BICC 307)		

## 6/3 Saturday-AM2 cont.

AM2	BICC 311C	BICC 307
	Session: Entrepreneurial Networks.	Session: Social Networks and Climate Change. Change(10:30-11:40).
Chair	Christian Kelly Scott	Rebecca Cunningham
10:20	The Role of Emerging Farmers' Personal Networks In Market Access And Start-Up Farm Success, Presented by: Christian Kelly Scott, Paper ID: 47	#ClimateChange   exploring networks of social change and political will, Presented by: Rebecca Cunningham, Paper ID: 266
10:40	Unpacking the Black Box: Firm-Bank Relations, The Competitive Context, and Internal Ratings of Entrepreneurial Firms in an Emerging Economy, Presented by: Yanlong Zhang, Paper ID: 48	A comparative study of environmental policy actor networks in Japan and Germany, Presented by: Junku Lee, Paper ID: 455
11:00	The Social Network Approach and Leadership Research: Common Pathways?, Presented by: Markku Jokisaari, Paper ID: 196	Before the Trump: Emotional Responses to Climate Change in YouTube, Presented by: Xanat Vargas Meza, Paper ID: 456
11:20	Social Networks of Women and Business in China, Presented by: Jing Song, Paper ID: 503	
11: 40-12: 30	INSNA Business Meeting (BICC 307)	

## 6/3 Saturday-PM1

	BICC 310	BICC 311A	BICC 311B
PM1	Session: Guanxi Circle and Chinese Venture Capital Network.	Session: Unique Network Structures in Social Media.	Session: Social Capital.
Chair	Jar-Der Luo	Yang-chih Fu	Eric Gladstone
13:30	International Syndication through Social Embeddedness: A Comparison of Foreign and State-Owned Venture Capital (VC) Firms in China, Presented by: Rong Ke, Paper ID: 608	The Structure of Sequences: Mining and Interpreting Networks from Event Log Data, Presented by: Brian Keegan, Paper ID: 282	Solving the brokerage paradox: Trait homophily in triads, and the broker-in-between hypothesis, Presented by: Eric Gladstone, Paper ID: 257
13:50	Identifying the leaders of Chinese venture capital industry — network analysis vs ground truth Presented by: Jianlin Zhou, Paper ID: 65	Peer Influence, Personality Traits, and Future Aspirations among Recent College Graduates: Evidence from Facebook and survey data, Presented by: Yen-hsin Alice Cheng, Paper ID: 283	Social Capital, Institutional Constraints, and Employment Inequality: Evidence from Well-Educated Urban Migrants in China, Presented by: Du Shengchen, Paper ID: 447
14:10	Analysis on the Dynamic Evolution Model of Joint Investment Network Presented by: Weiwei Gu, Paper ID: 612	The Life Cycle of One Triad: An Alternative Perspective from Weibo, Presented by: Xiaoming Fu, Paper ID: 469	Towards an understanding of the dark side of social capital in developmental networks: Effects on compulsory citizenship behaviour and relational inertia, Presented by: Jiafeng Jin, Paper ID: 448
14:30	Why Do Chinese Venture Capitals Invest Jointly?—A Proposed Analytical Method by Using Big Data, Presented by: Jie Ren, Paper ID: 607	Network Structures and Subsequent Contact Size on Social Media, Presented by: Yang-chih Fu, Paper ID: 470	Social Capital and Sharing Practices of Social Media Users in Poland: A Quantitative Study, Presented by: Kamil Filipek, Paper ID: 449
14:50	Why and How Venture Capital Syndication Influences Their Successful Exits: Empirical Evidence from GVC and FVC, Presented by: Li Zhu, Paper ID: 64	Session: Social Networks and Migration. The form and function of global migration network, Presented by: Idan Porat, Paper ID: 272	Bring Guanxi Ties Back in: Causal Effects of Guanxi-based Corporate Social Capital on Business Performance of Chinese Small- and Medium-sized Enterprises, Presented by: Lei Zhang, Paper ID: 450
15:10	Clustering analysis for venture capital companies based on social networks and extra data, Presented by: Hu Yang, Paper ID: 609	Session: Social Networks and Migration. Online and Offline Social Networks of Migrant Workers, Presented by: Jennifer Ihm, Paper ID: 273	
15:30	Tea Break, Outside the room 310		

## 6/3 Saturday-PM1 cont.

PM1	BICC 311C	BICC 301
	Chair	Baek Ji Won
	Session: Social Networks and Subjective Wellbeing.	Session: Ethnic Networks.
13:30	Social network with children and neighbors as predictors of life satisfaction among Korean older adults in traditional rural communities, Presented by: Baek Ji Won, Paper ID: 274	Local Conflicts, but transnational foci? Ethnic organizations in Sweden and the conflict "back home", Presented by: Sofiya Voytiv, Paper ID: 50
13:50	Social interaction and pain: An arctic expedition, Presented by: Per Block, Paper ID: 275	Network density and medical mistrust among breast cancer patients: Do relationships vary by ethnicity?, Presented by: Yamile Molina, Paper ID: 52
14:10	How Does Your Friends' Socio-Economic Status Affect Your Subjective Well-Being? A Social Network Analysis on Chinese Undergraduates, Presented by: Ji-Dong Wang, Paper ID: 458	Ethnic Homophily in Multicultural and Hegemonic Mixed Israeli Schools, Presented by: Uri Shwed, Paper ID: 328
14:30	Multiplexity of personal networks and well-being, Presented by: Keunbok Lee, Paper ID: 460	
14:50	How do depressive symptoms shape face-to-face interaction networks?, Presented by: Timon Elmer, Paper ID: 461	
15:10		
15:30	Tea Break, Outside the room 310	

**POSTER**

6/3 Saturday-PM2

	BICC 310	BICC 311A	BICC 311B
PM2	Session: Network Boundary and Network Dynamics.	Session: Network Centrality: Theoretical Advances and Applications.	Session: Network for Learning.
Chair	Chang Z. Lin	Andrés Chiriboga-Tejada	Alexander Fliaster
15:50	Theorizing Dormancy, Presented by: Chang Z. Lin, Paper ID: 104	Power, social networks and economic action in the Ecuadorian Securities Market, Presented by: Andrés Chiriboga-Tejada, Paper ID: 105	Knowledge acquisition and learning for innovation: An explorative study of top managers' ego networks in the watch and jewelry industry, Presented by: Alexander Fliaster, Paper ID: 107
16:10	Pragmatics of e-Language: Irony in online networked communication, Presented by: Joyce Lee, Paper ID: 355	Using Complex Numbers in Social Network Analysis: A Proposal of a Centrality Score for Digraphs, Presented by: Keita Sugihara, Paper ID: 228	Intergenerational learning through advice seeking relationships in school teams, Presented by: Kendra Geeraerts, Paper ID: 357
16:30		Knowledge externalities and production in networks: game equilibria, types of nodes, network formation, Presented by: Vladimir Matveenko, Paper ID: 510	
	Session: Social Media and Mobilization.	Session: Social Media Networks.	Other Social Network Topics
Chair	Jason Thornberry	William D. Li	Gerald Mollenhorst
17:00	Polarization in the Fracking Network: Applying Ideology Ecology Theory to Understand the Network Structure of Opposing Social Movements, Presented by: Aimei Yang, Paper ID: 259	Online Social Support Network: a Preliminary Report on the Social Support of International Brides in Taiwan, Presented by: William D. Li, Paper ID: 263	Session: Networks and Social Class. Discussion topics and social cleavages: is there social segregation in what we discuss with whom?, Presented by: Gerald Mollenhorst, Paper ID: 391
17:20	Brokerage Roles and Strategic Locations within Twitter Networks of the Egyptian Revolution, Presented by: Deena Abul Fottouh, Paper ID: 260	Person-organization Fit : A Conceptual Framework for Social Commerce Design Based on Social Relations Management, Presented by: Xiao Llu, Paper ID: 452	Session: Social Media and Political Campaigns. Exploring networks generated by #repealthe8th, Presented by: Rajalakshmi Kanagavel, Paper ID: 262
17:40	Towards an ecology of ties: How weak ties challenge activist sustainment, Presented by: Hjalmar Bang Carlsen, Paper ID: 451	Networks of (Dis)information and the Ukrainian Crisis: Exploring the Role of State and Non-state Actors in the Struggle over MH17, Presented by: Yevgeniy Golovchenko, Paper ID: 453	
18:00-21:30	hospitality suite (BICC 303)		



## 6/3 Saturday-PM2 cont.

	BICC 311C	BICC 302	
PM2	Session: Network Interventions using Network Structure.	Session: Business and Corporate Networks.	
Chair	Eric Gladstone	Yun Huang	
15:50	Crafting Contagion in an Organization: A Field Experiment, Presented by: Eric Gladstone, Paper ID: 110	Higher Visibility, Better Participation: Peer Pressure Enabled by Enterprise Social Media, Presented by: Yun Huang, Paper ID: 318	
16:10	Making the world smaller: A network intervention to improve public school educators' access to and use of research evidence, Presented by: Jennifer Watling Neal, Paper ID: 111	Networks and Leaders: Link between one's Network and Leader Preference, Presented by: Zeynep Aksehirli, Paper ID: 319	
16:30	How trust relationship decay in an open innovation context: based on network signaling mechanism, Presented by: Jinhan Jiao, Paper ID: 112		
	Session: Statistical Analysis of Networks. (2)	Networks and Entrepreneurship in the Digital Age.	
Chair	Dongah Kim	Wenhong Chen	
17:00	Inferring Bivariate Association for Respondent Driven Sampling, Presented by: Dongah Kim, Paper ID: 465	The World of Twitter: Understanding the Global Diffusion of Knowledge and Ideas among Entrepreneurs and Innovators using Big Data Analysis, Presented by: Borkert, Maren, Paper ID: 137	
7:20 <sup>1</sup>	Patterns and Variation in Homophily by Seeds and Waves in Two Men Who Have Sex with Men Samples Recruited through Respondent-Driven Sampling Method in Southwest China, Presented by: Chunmei Duan, Paper ID: 466	Private entrepreneurs' initial socioeconomic status, political tie and new venture performance: evidence from transitional economy of China, Presented by: Li Xu, Paper ID: 138	
17:40	The serendipity of friendship, Presented by: Zsófia Boda, Paper ID: 468	Got Funding: Glocalized Networks and Mobile Media Entrepreneurship, Presented by: wenhong chen, Paper ID: 139	
18: 00-21: 30	hospitality suite(BICC 303)		

**POSTER**

## Posters 6/3 Saturday 13 : 30—17: 30

No.	Title cont.	Authors cont.
268	Social network influences on health service utilization among adults living in marginalized housing	Andrea A. Jones , Louie Dinh, Sara A. Mostafavi, William G. Honer
190	Polinode: A Web Application for the Collection and Analysis of Network Data	Andrew Pitts
464	Scalable ERGM Inference for organizational interaction and behavioral simulation data	Fan Yin, Carter T. Butts
158	Exploring interdisciplinary collaboration networks: the effects of formal and informal network structures	Chengyu Fang, Ly Dinh
439	Effects of Social Capital Development Behavior, Resource Exchange and Combination on Task performance	Chitin HON, Siyu SUN
108	Exploring Elementary Students ' Help Networks Formation and Influence of their Help Networks on Achievement Goal Using Stochastic Actor-Oriented Models	Hyunjung Lim, Chongmin Kim
134	Exploring Peer Networks and Social Capital of Korean Elementary School Students in Multicultural Classrooms	Hyun Hee Choi, Chongmin Kim
191	A randomized controlled trial of egocentric social network-based intervention to promote HIV testing behaviors among men who have sex with men in Guangzhou, China	Xiongzhi Fan, Weibin Cheng, Huifang Xu, Zhongqi Liu, Jing Gu, Yuantao Hao, Chun Hao
092	Event and Character Networks	Dingding Chao
013	The associations between sexuality and friendship networks among adolescents in Taiwan	Yen-Ping Liu, Duan-Rung Chen, Yu-Wen Chen
042	Segmentation and Clustering in professional network among surgeons in Taiwan	Duan-Rung Chen, Chang-Hsien Yeh
146	Do women network differently than men? Gender and contact mobilization in the search for managerial work	Elena Obukhova, Adam M. Kleinbaum
058	Networks of Influence: Exploring Criminal Justice Campaign Finance in a Pennsylvania County	Glenn Sterner
402	Multilevel Collaboration between Software Developers and the Impact of Proximity	Dawn Foster, Guido Conaldi, Riccardo De Vita
612	Financial and Information Interactions in the Area of Nanotechnology of Iran; Application of Network Analysis for Identification of the Agent Network	Kioomars Ashtarian, Hannaneh Mohamadi Kangarani, Ali Khaje Naieni
613	Research on Distribution of Power within the Forest Policy Networks in Iran through Network Analysis	Hannaneh Mohamadi Kangarani
093	The Language of Moral Panics: Contextualizing the Framing of the Refugee Crisis in Croatian Mass Media with Discursive Network Analysis	Pasko Bilic, Ivo Furman, Savas Yildirim
187	How Do Communication Networks Among Volunteers Motivate More Volunteering?	Jennifer Ihm
021	How to Build Your Network? A Structural Analysis	Anastasia Moskvina, Jiamou Liu
103	The dynamics of marketer-customer interaction in online social commerce communities	Joyce Yi-Hui Lee, Liang-Chih Yu, Chang-Yen Huang

## Posters 6/3 Saturday 13: 30—17: 30

No.	Title cont.	Authors cont.
087	Mapping Social Landscapes Using WRI Data for Building an Inclusive Global Restoration Movement and Beyond	Kathleen Buckingham, Nitin Pandit, Sabin Ray
234	Multiplex referral and affiliation networks in relation to uptake of Pre-exposure prophylaxis among HIV-negative young men who have sex with men	Kayo Fujimoto, Peng Wang, Lisa Kuhns, John Schneider
143	Complex Networks: Continuity of Care research in Rural China	Li Boyang, Zhang Liang
032	The Two Sides of Social Capital: The differences between board and ownership interlocks on cost of capital in emerging markets	Luciano Rossoni, Alex Gonçalves, Cezar Aranha, Wesley Mendes-da-Silva
427	Network Canvas: Designing a digital tool for egocentric network capture	Michelle Birkett, Joshua Melville, Patrick Janulis, Bernie Hogan, Michael Bass, Noshir Contractor, Gregory Phillips II
305	Social scientists on semi-periphery: The difference in co-authorship egonets between the best and the “rest”	Nikola Petrovi? , Srebrenka Letina, Stjepan Mateljan, Maja Joki?
079	Personality, Homophily and Embeddedness	Samuel Fraiberger, Carlos Herrera, Antonio Prada, Arun Sundararajan
198	Resilience in animal social networks: insights from an individual-based model of primates social behaviour	Ivan Puga-Gonzalez, Sebastian Sosa, Zhang Peng, Cedric Sueur
136	The influence of schoolchildren's friendship networks on their practice of walking to school in Taiwan	Huang, S., Hung, W. , Huang, C., Wu, C.
167	"Leadership of many": configurations, reciprocity and teams' outcomes	Smadar Porat, Amalya Oliver, Micha Popper
445	The social consequences of networked individualization	Snorre Ralund
513	When it rains, it pours: A triple-pathway model of collective turnover based on causal mapping analysis	Song Wang, Bowen Dong
467	Discussing Missing Data Issues for Two-Mode Network Analysis based on Influence Model	Tingqiao Chen, Kenneth A. Frank
051	Mapping Roma university students' personal network composition in relation to ethnic identity types	Tünde Szabó, Beáta Dávid, Ágnes Lukács
518	Understanding Online Survey Data as a Bipartite Network: A Case Study on pol.is	Tzu-Chi Yen
446	Blockchain technology: a new stage in social network analysis	Svetlana Chernozub, Victor Tishchenko
432	Simulating Sexual Contact Networks with ERGMs: an Investigation of the Parameter Space	Yue Yu, Carter T. Butts
195	Each one has a role to play: Age influence on affiliative interaction patterns and social roles in rhesus macaque	LIAO Zhijie, Zhangpeng

## Author Index

A. Gruzd	Fri15:50	Andrew Edward	Wed13:30
A. Iamnitchi	Wed16:30	Andrew Terhorst	Wed16:30
Adam J. Saffer	Thur10:20	Andrew Wright	Fri09:00
Adil Rodionov	Wed13:30	Andrew Wright	Fri10:40
Agata Bloch	Wed14:30	Andrew Yu	Fri13:30
Ahmed H. Eissa	Wed16:50	Anna Zajicek	Fri08:40
Aimei Yang	Thur10:20	Anne E. Pusey	Fri16:30
Aimei Yang	Sat17:00	Anniki Puura	Wed17:10
Aitong Li	Wed13:30	Antonietta Mira	Fri09:20
Ajay Mehra	Thur15:10	Antonina Milekhina	Fri08:00
Albert-Laszlo Barabasi	Wed16:50	Antonio Rivero Ostoic	Wed14:10
Alberto Monti	Wed17:10	Anuška Ferligoj	Wed14:50
Aleksandr Semenov	Fri11:20	Anuška Ferligoj	Wed16:30
Aleš Žiberna	Wed14:50	Arashk Holisaz	Wed15:30
Alessandro Lomi	Wed17:10	Ashley Lovell	Wed14:10
Alessandro Lomi	Thur09:00	Baek Ji Won	Sat13:30
Alessandro Lomi	Fri09:20	Balazs Vedres	Thur09:20
Alessandro Lomi	Sat10:40	Bálint Diószegi	Fri08:00
Alex Stivala	Wed17:30	Barry Wellman	Sat08:00
Alex Stivala	Fri09:20	Bart Bossink	Wed17:10
Alexa Beavers	Sat15:50	Beate Volker	Fri10:20
Alexander Fliaster	Sat15:50	Beate Volker	Sat17:00
Alexander Victor Graham	Wed15:50	Beate Volker	Fri11:20
Alexei Korolev	Sat16:30	Bei Yan	Thur11:40
Ali Khaje Naieni	Sat14:10	Ben Curran	Thur08:40
Alicia Bungler	Fri13:50	Bernard Agala	Wed14:10
Allard van Riel	Sat16:30	Bernard Léca	Sat10:20
Amalya Oliver	Wed16:30	Bernie Hogan	Fri14:10
Amir Sasson	Wed13:50	Bi Zhao	Thur08:20
Amritorupa Sen	Wed16:30	Bludova Oksana	Fri08:00
Anabel Quan-Haase	Sat08:00	Bo Liang	Fri14:10
Anatoliy Gruzd	Thur08:00	Bo Liang	Fri14:30
Anatoliy Gruzd	Thur14:50	Bo Xu	Fri14:50
Andelija Arandelovic	Wed13:50	Bomin Kim	Fri08:00
András Voros	Fri16:50	Bopha Roden	Wed16:50
András Voros	Sat17:40	Borkert Maren	Sat17:00
André Escórcio Soares	Thur13:50	Bram Lancee	Fri11:20
Andrea Fronzetti Colladon	Wed16:10	Brandon Jackson	Fri08:40
Andreas Andrikopoulos	Wed16:50	Brazilian Army	Fri16:50
Andreas Ihle	Fri11:00	Brian Aronson	Thur14:10
Andrés Chiriboga-Tejada	Sat15:50	Brian Keegan	Thur12:00
Andrew A. Hill	Thur13:50	Brian Keegan	Sat13:30
		Brian Mustanski	Fri14:10
		Brian Rubineau	Thur10:20

Brian Rubineau	Sat13:30	Daniele Mascia	Wed13:50
Brian Rubineau	Sat15:50	Daniele Mascia	Thur09:00
Bryan Stephens	Sat17:40	Daniella Laureiro-Martínez	Fri08:00
Burt, Ronald	Sat10:20	Daria Maltseva	Fri08:20
C. C. Chuang	Sat17:00	Daria Maltseva	Fri10:20
C. Gandy	Wed16:30	Darkhan Medeuov	Wed13:30
C. Rafferty	Thur13:50	David Bright	Fri10:40
Cai Yuanqing	Fri08:00	David Broudy	Wed14:10
Cao, Xiao-Yun	Sat10:40	David Hunter	Fri08:00
Cao, Xiao-Yun	Sat11:00	David Krackhardt	Wed17:10
Cao, Xiao-Yun	Sat11:20	David L Elliott	Fri08:00
Carol Strong	Fri13:30	David Schoch	Wed14:50
Catherine Ludwig	Thur11:00	David Thompson	Sat15:50
Chang Z. Lin	Sat15:50	David Thompson	Sat13:30
Chang-Yen Huang	Sat16:10	David Zbiral	Wed13:50
Chao Yu	Thur15:10	Dean Lusher	Wed16:30
Chen Huang	Thur09:00	Dean Lusher	Wed16:50
Cheng Ding	Thur08:00	Dean Lusher	Wed17:30
Cheng, Meng-Yu	Sat10:20	Dean Lusher	Thur13:50
CHIANG Yen-sheng	Fri11:00	Dean Lusher	Fri08:40
Chien-Lung Chan	Sat16:10	Dean Lusser	Fri10:20
Ching-chieh Huang	Sat08:00	Debarchana Ghosh	Wed13:30
Chi-Nien Chung	Wed13:30	Debra Scammon	Fri14:30
Chongmin Kim	Sat08:20	Deena Abul Fottouh	Sat17:20
Chou, Cao-Wen	Sat10:20	Delfi I. Nieto-Isabel	Wed13:30
Chris Robbins	Fri08:20	Demival Vasques Filho	Thur08:40
Christian Böhm	Sat09:40	Demival Vasques Filho	Thur10:20
Christian Kelly Scott	Sat10:20	DESI RAULIN	Thur13:30
Christof Wolf	Fri17:30	Di Shao	Sat09:00
Christoph Riedl	Wed16:50	Diana M. Kingsbury	Sat08:00
Christoph Stadtfeld	Sat17:40	Dianne Bolton	Wed16:30
Christoph Stadtfeld	Fri16:50	Dickon Bevington	Thur10:40
Christoph Stadtfeld	Fri16:10	Dimitris Christopoulos	Thur09:40
Christoph Stadtfeld	Sat14:50	Dino Dittrich	Fri08:20
Chun Feng	Thur13:30	Dion O'Neale	Thur10:20
Chyi-in Wu	Sat08:00	Dirk Deichmann	Fri09:00
Chyi-in Wu	Sat08:40	Dmitri Tsyganova	Thur08:00
Claire Gubbins	Sat14:30	Dmitry Zaytsev	Fri08:40
Clare Zutz	Wed14:10	Dominique Joye	Fri17:30
Claudia Plant	Sat09:40	Dongah Kim	Sat17:00
Corinne Hofman	Wed14:50	Drach - Zahavy Anat	Thur11:20
D. Tay	Fri15:50	Drew Margolin	Thur15:10
Daichi Shimamoto	Fri16:10	Du Shengchen	Sat14:10
Dan Sewell	Wed16:10	Duan-Rung Chen	Fri09:20
Danching Ruan	Fri15:50	Duoyong Sun	Thur13:30
Danching Ruan	Sat11:20	Duo-yong Sun	Wed16:50

## 2017 Sunbelt Conference

Duo-yong Sun	Sat08:20	Gerald Mollenhorst	Sat17:00
Edmund Seto	Sat09:20	Gianfranco Damiani	Wed13:50
Edridah M. Tukahebwa	Wed13:30	Gilberto de Souza Vianna	Fri16:50
Elena Artyukhova	Fri09:00	Gina Lai	Thur10:40
Elena Obukhova	Thur10:20	Gina Lai	Thur10:40
Elise Penalva-Icher	Sat10:20	Gopakumar Gopalakrishnan	Thur08:00
Elisenda Ortiz	Thur08:40	Goylette F. Chami	Wed13:30
Emerson Amirhosein Azarbakht	Fri10:20	Gradoselskaya Galina	Fri11:40
Emily Stammer	Thur08:00	Graham Schaffer	Fri08:40
Emmanuel K. Mbaru	Wed15:10	Greg Simpso	Wed17:30
Emmanuel Lazega	Sat11:00	Greg Simpson	Thur13:50
Enying Zheng	Wed15:50	Guillaume Favre	Sat11:00
Eric D. Widmer	Thur11:00	Guofu Yang	Thur09:20
Eric Gladstone	Sat15:50	H Colin Gallagher	Wed17:10
Eric Gladstone	Sat13:30	HAIFENG DU	Wed17:10
Eric Widmer	Fri11:00	Haifeng Du	Thur14:50
Erin Arcario	Sat15:50	Hai-Ming Lee	Wed13:50
Fabio Rojas	Thur15:50	Han Woo PARK	Wed13:50
Fan Xia	Thur08:00	Han Woo Park	Wed17:10
FanMu Zeng	Fri11:40	Han, Yi	Wed14:10
Federica Bianchi	Sat10:40	Hannaneh Mohamadi Kangarani	Wed15:30
Federica Giordani	Thur15:10	Hannaneh Mohamadi Kangarani	Sat14:10
Felicia F. Tian	Sat08:20	Harjeet S. Bhabra	Wed16:50
Feng Lin	Thur13:30	Harris H Kim	Thur15:50
Feng Lin	Thur15:50	Harris Hyun-soo Kim	Wed15:50
Florence Hodous	Wed15:10	Heather McGregor	Thur09:40
Florian Schloderer	Fri13:30	Heidi Reynolds	Wed14:10
Franc Mali	Wed16:30	Heidi Weiss	Thur08:00
Francesca Grippa	Wed16:10	Henrike Rudolph	Wed16:10
Franziska Barbara Keller	Fri16:10	Hervin Fernández-Aceves	Wed14:10
Frederick Kin Hing Phoa	Fri08:40	Hiroko Osaki	Fri17:30
Frederick Kin Hing Phoa	Fri11:20	Hjalmar Bang Carlsen	Sat17:40
Frederick L. Altice	Wed13:30	Hong Huang	Fri17:10
Frédérique Déjean	Sat10:20	Hong Huang	Sat14:10
Galina Gradoselskaya	Fri09:00	Hongjin Zhu	Wed13:30
Galina Gradoselskaya	Fri10:40	Hongtao Yi	Thur09:00
Ganga Vijayasiri	Sat13:50	Hongyun Fu	Sat17:20
Gar	Sat13:50	Honorio Guarino	Sat17:00
Garry Robins	Wed17:30	Hossein Raisi	Thur08:20
Garry Robins	Wed17:10	Hsin-Hui Lu	Fri09:20
Garry Robins	Fri09:20	Hsung, Ray-May	Fri14:10
Garry Robins	Fri10:20	Hu Yang	Sat14:50
Geoff Morgan	Wed13:30	Hu Yang	Sat15:10
George A. Barnett	Thur08:20	Hua Wang	Sat08:00
George A. Barnett	Thur14:50	Huachun Zou	Fri13:30
George Beknazar-Yuzbashev	Fri11:00	Huang, Hong	Sat10:20

Hui Li	Sat15:50	Jia Chen	Sat10:40
Huiping Zhang	Thur09:20	Jiafeng Jin	Sat14:30
Ian C. Gilby	Fri16:30	Jianghong Li	Sat17:20
Ian Eslum	Wed16:30	Jiangtao Fu	Sat10:20
Idan Porat	Sat14:50	Jianhua Ge	Wed14:50
Ilya Karpov	Fri10:40	Jianlin Zhou	Sat13:50
Isabel J. Raabe	Fri16:10	Jianxun Chu	Thur08:20
Ivan Kuznetsov	Fri09:20	Jiao Jinhan	Thur14:50
J. Arroyo Flores	Wed16:30	Jiaojiao Ji	Thur08:20
J. Skvoretz	Wed16:30	Ji-Dong Wang	Sat14:10
Jae Won Lim	Wed14:10	Jie Ren	Sat14:30
Jake Fisher	Sat13:50	JiFan Liu	Fri11:40
James C. Thomas	Wed14:10	Jiliang Tang	Thur11:20
James Coutinho	Fri09:00	Jimmy Mans	Wed14:50
James Coutinho	Fri10:40	JIN HUANG	Fri17:10
James Hollway	Thur10:40	Jin Tao Huang	Wed14:30
James Moody	Sat13:50	Jinchuan Shi	Sat08:20
Jan Vanhoof	Sat16:10	Jing GAO	Thur15:50
Jang Hyun Kim	Wed14:10	Jing Luo	Sat08:40
Jang Hyun Kim	Wed14:30	Jing Nie	Sat08:40
JangHyun Kim	Thur11:00	Jing Song	Sat11:20
Janice Yap	Sat09:20	Jingjing Du	Wed13:50
Janine Bosak	Sat14:30	JINGJING WANG	Wed17:10
Jar-Der Luo	Fri11:40	Jingwen Zhong	Wed16:10
Jar-Der Luo	Sat10:20	Jingxuan Cai	Wed14:50
Jar-Der Luo	Sat10:40	Jingyuan Shi	Thur09:00
Jar-Der Luo	Sat13:30	Jinhan Jiao	Sat16:30
Jar-Der Luo	Sat13:50	Jinmiao Wang	Thur12:00
Jar-Der Luo	Sat14:30	Joel Levine	Wed13:30
Jason Owen-Smith	Wed13:50	Johan Koskinen	Fri09:00
Jean-Frederic Morin	Thur10:40	Johan Koskinen	Fri10:20
Jeanyung Chey	Fri09:20	Johan Koskinen	Fri10:40
Jeffrey C Johnson	Fri14:10	Johanne Saint-Charles	Fri09:20
Jeffrey Grierson	Thur10:40	John Chandler Johnson	Wed13:50
Jenna Hua	Sat09:20	John Hopkins	Thur13:50
Jennifer A. Lawlor	Sat16:10	John Light	Fri13:50
Jennifer Cleary	Thur14:10	John M. Hollingsworth	Wed13:50
Jennifer Dolly	Thur08:00	John McCreery	Thur11:00
Jennifer Ihm	Sat15:10	John McLevey	Wed14:50
Jennifer Labrecque	Fri14:30	John R. Hollenbeck	Fri13:30
Jennifer Watling Neal	Sat16:10	John Sandberg	Wed14:30
Jens Rydgren	Sat17:00	John Schneider	Fri13:50
Jesse Fagan	Thur08:00	Jongyoun Baek	Thur13:30
Jesse S. Sayles	Wed14:30	Joomi Lee	Wed15:10
Ji Won Baek	Fri16:50	Joost Pauwelyn	Thur10:40
Ji Youn (Rose) Kim	Wed14:30	Joris Mulder	Fri08:20

## 2017 Sunbelt Conference

Joseph F. Cabrera	Fri10:40	Ke Jiang	Thur08:20
Joseph Galaskiewicz	Wed16:10	Ke Jiang	Thur14:50
Joseph T. Feldblum	Fri16:30	Ke Rong	Sat08:40
Joseph Wai-ip, Lam	Fri08:20	Keita Sugihara	Sat16:10
Joshua Melville	Fri14:10	Kendra Geeraerts	Sat16:10
Joyce Lee	Sat16:10	Kendra Thompson-Dyck	Wed16:10
Juan Fernández-Gracia	Wed14:50	Kenichi Nishimura	Fri17:30
Jukka-Pekka Onnela	Wed14:50	Kenneth A. Frank	Thur11:20
Julia Brennecke	Wed17:30	Kenneth A. Frank	Fri15:50
Julia Brennecke	Fri08:40	Keunbok Lee	Wed15:10
Julia Neidhardt	Fri14:50	Keunbok Lee	Sat14:30
Julia Sauter	Fri11:00	Kevin Langergraber	Fri16:30
Julien Brailly	Sat11:00	Ke-Wei Lu	Thur11:00
Jun Kobayashi	Fri17:30	Ke-Wei Lu	Thur11:20
Jun Liu	Fri14:30	Kinga Andras	Thur09:20
Jun Liu	Sat08:40	Kioomars Ashtarian	Sat14:10
Jungwon Yoon	Wed13:50	Konstantinos Kostaris	Wed16:50
Junku Lee	Wed14:50	Kratzer Jan	Sat17:00
Justin Levens	Thur08:00	Krista J. Gile	Sat17:00
Justyna Tasic	Thur08:40	Kristen J. Mills	Sat16:10
Jyun-Cheng Wang	Fri14:50	Kristina Maiksteniene	Fri14:50
K.L. Jones	Thur13:50	Ksenia Tsyganova	Thur08:00
K.S. Chung	Wed13:30	Kuan-Hao Yang	Fri11:00
Kai Xu	Wed14:30	Kuan-Hao Yang	Sat14:30
KAIQI ZHANG	Wed14:30	Kun Huang	Wed14:10
Kaitlin T. Torphy	Thur11:20	Kun Huang	Fri13:50
Kaitlin Torphy	Fri17:30	Kuskova Valentina	Fri08:00
Kamal Badar	Wed13:50	Kyle Higham	Thur08:40
Kamil Filipek	Sat14:50	L. Richard Carley	Wed17:30
Kang Nyeon Lee	Wed14:30	Laetitia Douillot	Wed14:30
Kang-Nyeon Lee	Thur11:00	Laura M. Koehly	Thur14:10
Karpov Ilia	Thur15:30	Lauren C Heathcote	Sat13:50
Karpov Ilia	Fri11:40	Laurie A. Schintler	Thur08:40
Katarzyna Burzynska	Wed15:10	Lea Ellwardt	Wed14:10
Katerina Guba	Fri11:20	Leanne Dougherty	Thur08:00
Katherine Eddens	Thur08:00	Lebedev Innokentii	Thur15:30
Katherine Ma	Thur10:40	Lei Zhang	Sat15:10
Kathleen M. Carley	Wed13:30	Leslie DeChurch	Fri14:10
Kathleen M. Carley	Wed17:30	Leslie Tkach-Kawasaki	Wed14:50
Kathryn Freeman Anderson	Wed16:10	Li Shi	Wed14:50
Kathryn McAlindon	Sat16:10	Li Xu	Sat17:20
Kaushalya Premachandra	Thur15:30	Li Zhu	Sat14:50
Kayi Fung	Thur10:40	Li Zhu	Sat15:10
Kayla de la Haye	Fri14:30	Li Zou	Sat13:50
Kayo Fujimoto	Fri13:50	Lian Jian	Thur11:40
Kayo Fujimoto	Fri16:30	Liang Chen	Thur09:00



## 2017 Sunbelt Conference

Lianming Zhu	Sat09:00	Meredith Woehler	Thur15:10
Liaquat Hossain	Wed13:30	Michael Genkin	Fri11:40
Lihua Huang	Sat15:50	Michael Gilding	Wed16:50
Lijun Song	Fri15:50	Michael Gilding	Wed17:30
Lindsey Hall	Wed16:10	Michael Gilding	Fri08:40
Ling Yang	Sat10:40	Michael L. Barnett	Wed14:50
Lisa Johnston	Sat17:20	Michael Withers	Wed14:30
Lu Zheng	Sat14:10	Michael Zurek	Fri14:10
Lu, Ke-Wei	Fri14:10	Michal Bojanowski	Wed14:30
Lucien Benguigui	Sat14:50	MICHEL GROSSETTI	Fri17:10
Luka Kronegger	Wed16:30	Michele L. Barnes	Wed13:50
Lusajo Kajula	Thur08:20	Michele L. Barnes	Wed15:10
Lusha Zhou	Wed14:50	Michelle Birkett	Fri14:10
Lynda Jiwen Song	Sat14:50	Miguel Lobo	Fri13:30
M. Durier-Copp	Fri15:50	Miguel Pereira Lopes	Thur13:50
M. Fitzgerald	Fri15:50	Mike Howe	Fri13:30
Maksim Tsvetovat	Wed14:30	Miles Ott	Fri13:50
Maksym Byshkin	Wed17:30	Min Fu	Thur08:40
Maksym Byshkin	Fri09:20	Ming Cao	Fri13:50
Manuela Hartwig	Wed14:50	Ming-Jing Chiang	Fri14:50
Marc Idelson	Thur15:10	Mingjiu Zheng	Fri14:30
Marco Tonellato	Thur09:00	Mingxia Liu	Sat17:20
Marco Tonellato	Fri09:00	Ming-Yi Chang	Sat14:30
Marcus Green	Thur09:00	Minjoo Yoo	Wed14:10
Mareike Hartmann	Sat17:40	Mo Guang Ying	Sat08:00
Margarita Erofeeva	Fri08:40	Myriam Girardin	Thur11:00
Mariano Kanamori	Fri16:30	Nancy Barnett	Fri13:50
Marina Tulin	Fri11:20	Narcis B. Kabatereine	Wed13:30
Marissa King	Wed15:50	Natalie David	Wed14:30
Marjan Cugmas	Wed14:50	Nathan Vanderford	Thur08:00
Mark Pachucki	Sat09:20	Neha Gondal	Fri08:40
Mark Williams	Fri16:30	Nicholas A. Christakis	Wed14:50
Markku Jokisaari W	Sat11:00	Nicholas Harrigan	Sat09:20
Marlène Sapin	Thur10:20	Nicole Bohme Carnegie	Fri14:30
Marlène Sapin	Fri17:30	Nobin Thomas	Fri08:20
Marta Mulawa	Thur08:20	Noshir Contractor	Fri14:10
Martin Everett	Wed16:50	Noshir Contractor	Fri14:50
Martin Santos	Fri16:30	Noshir Contractor	Sat15:50
Marva V. Goodson	Fri11:40	Odalía Wong	Thur10:40
Masaru Yarime	Wed13:30	Olaf N. Rank	Wed15:50
Matthias Bixler	Thur15:50	Olaf Rank	Wed16:30
Matthias Kliegel	Fri11:00	Olaf Rank	Wed14:30
May Wang	Sat09:20	Oliver Rossmannek	Wed15:50
Melissa A. Clark	Fri13:50	Paola Tubaro	Sat11:20
Meng-Hao Li	Thur08:40	Patrick Bixler	Wed14:10
Mercouris John	Sat17:00		

## 2017 Sunbelt Conference

Patrick Flood	Sat14:30	Rong Ke	Sat13:30
Patrick Janulis	Fri14:10	Rong Wang	Thur12:00
Pedro Mateu-Gelabert	Sat17:00	Rongrong Lin	Wed16:30
Pen Wang	Wed16:30	Rongzhu Ke	Wed15:50
Peng Wang	Wed17:30	Ruqin Ren	Thur11:40
Peng Wang	Fri10:20	Russell J. Funk	Wed13:50
Peng Xiaobao	Thur14:50	S. Comber	Fri15:50
Per Block	Sat13:50	S. Godfrey	Thur13:50
Peter Fuggle	Thur10:40	S. Viswanathan	Wed16:30
Peter Gloor	Wed16:10	Samuel Fraiberger	Wed16:50
Peter Peverelli	Wed17:10	Sander Smit	Wed14:50
Petr Matours	Sat10:20	Santosh Kumar Tiwari	Fri17:10
Petros Ieromonachou	Sat08:40	Sara O'Sullivan	Sat17:20
Pierre Mongeau	Fri09:20	Sarah King	Thur13:50
Piet Van den Bossche	Sat16:10	Sato Ashida	Thur14:10
Pi-hu Feng	Sat08:20	Saul Hillman	Thur10:40
Po-Chun Lee	Sat14:30	Sebastian E. Ahnert	Wed13:30
Prochko Alexey	Wed15:50	Sejung Park	Wed17:10
Pyung Nahm	Fri16:30	Sergey Sanovich	Fri16:10
Qi Hao	Wed15:10	Seungwon Lee	Fri16:10
Qing Guo	Sat13:50	Seyul Kwak	Fri09:20
Qingyan WANG	Fri11:00	Shabana Kamal	Wed13:50
Qinyun Lin	Fri15:50	Shadmi Efrat	Thur11:20
R.C.A. Thompson	Thur13:50	Shanshan Li	Wed14:50
Rajalakshmi Kanagavel	Sat17:20	Shauna Killen	Thur09:40
Ralph A. Heidl	Fri13:30	Sheu-jen Huang	Sat08:00
Ran Xu	Fri10:40	Shichang Ding	Fri17:10
Ranjeet Numbudiri	Fri17:10	Shin-Ping Tu	Wed16:10
Ray-May Hsung	Thur11:20	Shirly Luz	Thur11:20
Rebecca Adler-Nissen	Sat17:40	Shi-Rong Lee	Thur15:30
Rebecca Cunningham	Sat10:20	Shixiong Wang	Thur15:50
Rebecca Lengnick-Hall	Fri13:50	Shu Zhang	Wed15:50
Rebecca Mazur	Fri16:50	Shuai Man	Fri11:00
Rebecca Woodland	Fri16:50	Shuai, Man	Sat11:00
Reid Mclroy-Young	Wed14:50	Shu-Fen Tseng	Fri13:30
Rein Ahas	Wed17:10	Sihua Hu	Thur11:20
Renwen Alice Zhang	Sat08:00	Sihua Hu	Fri17:30
Richard Warnecke	Sat13:50	Siiri Silm	Wed17:10
Rick Aalbers	Wed14:50	Simona Bignami	Wed14:30
Rick Aalbers	Thur11:40	Snorre Johan Ralund	Sat17:40
Ri-Han Wu	Thur08:40	Snorre Ralund	Sat10:40
Rihana Shaik	Fri17:10	Sofiya Voytiv	Sat13:30
Roberta Sinatra	Wed16:50	Somrita Ganchoudhuri	Sat08:40
Roger Leenders	Fri08:20	Song Yang	Fri08:40
Roger S. Chen	Wed15:50	Song, Ji-Wen	Sat11:20
Rong Guo	Sat14:30	Sonja Opper	Wed15:10

## 2017 Sunbelt Conference

Sonja Sperber	Sat15:50	Valentina Baiamonte	Thur09:40
Srebrenka Letina	Thur09:20	Valentina Iacopino	Thur09:00
Stanislav Moiseev	Fri10:20	Valerie Delaunay	Wed14:30
Stefano Brusoni	Fri08:00	Verena Knerich	Sat09:40
Stella Zounta	Wed16:50	Víctor M. Eguíluz	Wed14:50
Stephanie Burnett Heyes	Sat13:50	Victor Tishchenko	Wed15:50
Stephen P. Juza	Thur13:50	Victor Tishchenko	Sat11:00
Steve Borgatti	Wed16:50	Victoria Breeze	Thur15:10
Steven L. Rytina	Wed14:30	Vimal Mishra	Wed16:10
Sujin Choi	Fri13:50	Vincent Chua	Sat09:00
Sun Hyun Park	Fri16:30	Vinton Cheng	Thur09:00
Sungyae Shin	Fri16:50	Vladimir Batagelj	Wed16:10
Sunhyoung Lee	Fri09:00	Vladimir Glazachev	Fri11:20
Suzanne Maman	Thur08:20	Vladimir Matveenko	Sat16:30
Svetlana Chernozub	Sat11:00	Volkova Irina	Fri08:00
Swati Ghulyani	Fri17:10	Wang Xiao	Sat08:00
Tadao Hoshino	Fri16:10	Wang Youqiang	Fri08:00
Tai-Chi Wang	Fri08:40	Wei Hong	Wed15:50
Tai-quan Peng	Thur09:00	Wei Zhao	Wed14:50
Tamara Gilkes	Sat09:20	Weihua XIANG	Thur15:50
Tamara Shcheglova	Fri10:40	Weining Qian	Thur08:00
Tan Bing Yang	Sat09:20	WEIRAN WANG	Wed17:10
Tan Yu Xun	Sat09:20	Wen-chi Hung	Sat08:00
Tao Chen	Thur09:00	Wenhong Chen	Sat17:40
Tao Wang	Thur14:10	Wenjuan Wang	Wed16:50
Taoxiaong Liu	Fri17:10	Wen-Juan Wang	Thur08:40
Taoxiong Liu	Sat08:00	Wen-Juan Wang	Sat14:10
Termeh Shafie	Wed14:50	William D. Li	Sat17:00
Texier-Ast, Verena	Fri09:00	Won-tak Joo	Fri09:20
Thejan Rajapakshe	Thur15:30	Wubin Xie	Wed14:30
Thespina Yamanis	Thur08:20	Wyatt S. Taylor	Thur13:50
Thomas Gillier	Fri09:00	Wyatt Taylor	Thur15:10
Thomas Malone	Fri14:30	Wyatt Taylor	Sat13:30
Thomas N. Friemel	Thur15:50	Xi Zhu	Wed16:10
Thomas Odell	Sat09:00	Xiao He	Sat15:50
Tien-dun Yang	Thur11:20	Xiao Liu	Sat17:20
Till Klein	Wed17:30	Xiao, Han	Sat10:20
Timon Elmer	Sat14:50	Xiaochen He	Thur14:50
Timon Elmer	Sat17:40	Xiaohui Wang	Thur09:00
Ting W Lowan	Sat08:20	Xiaomeng Li	Thur15:10
Tiziana Casciaro	Fri15:10	Xiaoming Fu	Thur15:50
Tobias Nolte	Thur10:40	Xiaoming Fu	Fri17:10
Tom Spurling	Wed16:50	Xiaoming Fu	Sat14:10
Tyson Brown	Sat13:50	Xiaoyue Niu	Fri08:00
Ulrik Brandes	Wed14:50	Xiaozhan Wang	Wed16:50
Uri Shwed	Sat14:10	Xiaozhe Arcadia Zhang	Thur12:00

## 2017 Sunbelt Conference

Xinying CHEN	Thur15:30	You-Shuan Li	Fri14:50
Xinyu Dai	Thur14:50	Yu Xu	Fri10:20
Xiushi Yang	Sat17:20	Yuan-Lung Lin	Fri11:20
Xu Zhang	Fri17:10	Yun Geng	Wed16:50
Xujian Yang	Sat08:20	Yun Huang	Fri14:50
Xun Cao	Fri08:00	Yun Huang	Sat15:50
Yacine Boujja	Wed14:30	Yunjie Xu	Sat15:50
Yajing Huang	Sat08:00	Yunya Song	Thur14:50
Ya-Lun Liang	Fri13:30	Yuqing Liu	Fri17:30
Yamile Molina	Sat13:50	Yuval Kalish	Wed16:30
Yan Li	Sat09:20	Yuval Kalish	Sat14:10
Yana Maria Priestley	Fri11:00	Yuzuka Kashiwagi	Sat11:00
Yang Chun	Wed17:10	Zachary Neal	Wed16:10
Yang, Kuan Hao	Sat10:40	Zachary P. Neal	Sat16:10
Yang, Tien-Tun	Fri14:10	Ze Li	Wed16:50
Yang-chih Fu	Sat14:30	Ze Li	Sat08:20
Yanlong Zhang	Sat10:40	Zelong Yi	Wed16:30
Yaorong L Lowan	Sat08:20	Zeynep Aksehirli	Sat16:10
Yasheng Huang	Wed15:50	Zeynep Yetis-Larsson	Sat08:20
Yasuyuki Todo	Fri16:10	Zhanfeng Li	Thur13:30
Yasuyuki Todo	Sat09:00	Zhang, Ya-Juan	Sat11:20
Yasuyuki Todo	Sat10:20	Zhengqi Pan	Sat08:40
Yasuyuki Todo	Sat11:00	Zhengqi Pan	Sat11:20
YE Han-zhang	Fri11:00	Zhiya Guo	Fri13:30
Ye Ryung, Kim-Chung	Wed13:30	Zhonghao Wang	Fri11:20
Ye Sun	Thur09:20	Zixi Chen	Fri17:30
Yen-hsin Alice Cheng	Sat13:50	Zong-Rong Lee	Wed13:30
Yevgeniy Golovchenko	Sat17:40	Zong-Rong Lee	Thur15:30
Yi Lu	Sat09:00	Zong-Rong Lee	Fri13:30
Yi Zhao	Wed16:10	Zsófia Boda	Fri16:50
Yi-Fang Yu	Fri13:30	Zsófia Boda	Fri16:10
Yikang Bai	Sat10:40	Zsófia Boda	Sat17:40
Ying Fan	Sat13:50	Zuzana Sasovova	Sat16:30
Ying Fan	Sat15:10		
Yi-Yi Chen	Fri10:40		
Yizhen Lan	Thur15:50		
Yong Lin	Sat08:40		
Yongjun Zhang	Sat09:00		
Yoosik Youm	Fri09:20		
Yoosik Youm	Fri16:10		
Yoosik Youm	Fri16:50		
Yoshiaki Ogura	Sat09:00		
Yossi Shavit	Sat14:10		
Young Ji Kim	Fri14:30		
Youngjoon Bae	Thur14:10		

## Chinese Sessions (中文论坛议程)

BICC 第三会议厅						
中文开幕式						
6/1	09:20-10:15	学会代表李培林书面致词	5 分钟			
		清华大学社会科学学院代表刘涛雄致词	5 分钟			
		西安交通大学人文社会科学院代表边燕杰致词	5 分钟			
		嘉宾演讲：林南；讲题：社会与经济	40 分钟			
	10:15-10:30	茶 歇				
10:30-11:50	清华大学社会网络研究中心的未来研究：罗家德 题目：大数据社会网分析 1.0 版 2.0 版 3.0 版	40 分钟				
	西安交通大学实证社会科学研究所的未来研究：边燕杰 题目：关系社会学	40 分钟				
6/2	BICC 301					
	08:00-10:00	分论坛：劳动力市场的社会网络（1） （主持人：林聚任）				
	10:20-12:20	分论坛：勇敢的大妈们——广场舞的社会网分析 （主持人：郭毅）				
	13:30-15:30	分论坛：社会网络与身心健康 （主持人：张顺）				
	15:50-17:50	分论坛：在线社会网络（1） （主持人：褚建勋）				
18:20-20:00 中文会议晚宴（限报名中文会议者参加）地点：五洲大酒店二层宴会厅						
6/3	BICC 302		BICC 303		BICC 301	
	08:00-10:00	分论坛： 复杂网方法 （主持人：吴钢）	分论坛： 其他社会网络研究（1） （主持人：张杰）	分论坛： 劳动力市场的社会网络（2） （主持人：梁玉成）		
	10:20-12:20	分论坛： 社会大数据和舆情分析 （主持人：唐锡晋）	分论坛： 本土企业管理 （主持人：周小虎）	分论坛： 在线社会网络（2） （主持人：褚建勋）		
	BICC 302					
	13:30-15:30	分论坛：社会网络与战略管理 （主持人：任兵）				
15:50-17:10	分论坛：社会网方法论 （主持人：刘军）					
6/4	BICC 311A		BICC 311B		BICC 311C	
	08:00-10:00	分论坛： 关系社会学的理论与研究（1） （主持人：沈毅）	分论坛： 社会支持 （主持人：刁鹏飞）	分论坛： 社会网络与计算传播学（1） （主持人：许小可）		
	10:20-12:20	分论坛： 关系社会学的理论与研究（2） （主持人：沈毅）	分论坛： 其他社会网络研究（2） （主持人：赵延东）	分论坛： 社会网络与计算传播学（2） （主持人：许小可）		

## 中文论坛详细列表

6月1日

BICC 第三会议厅		
中文开幕式		
09:20-10:15	学会代表李培林书面致词	5 分钟
	清华大学社会科学学院代表刘涛雄致词	5 分钟
	西安交通大学人文社会科学院代表边燕杰致词	5 分钟
	嘉宾演讲：林南；讲题：社会与经济	40 分钟
10:15-10:30	茶 歇	
10:30-11:50	清华大学社会网络研究中心的未来研究：罗家德 题目：大数据社会网分析 1.0 版 2.0 版 3.0 版"	40 分钟
	西安交通大学实证社会科学研究所的未来研究：边燕杰 题目：关系社会学	40 分钟

6月2日

BICC 301		
分论坛：劳动力市场的社会网络（1） 主持人：林聚任		
08:00	职业地位获得机制的体制内外差异分析 098	林聚任 向维
08:20	社会网研究中的求职群体内生异质性 099	张洪、梁玉成
08:40	人力资本、社会网络与劳动力市场搜寻成本 100	张顺、李韵秋
09:00	找关系：关系搜寻方式对劳动力市场回报的影响研究 101	杨张博、程诚、边燕杰
09:20	谁从关系中获益？——关系资源差异性回报研究 102	郭小弦、陈奇、张顺
09:40	职业地位获得过程中社会资本的累积效应 103	孙宇
10:00	茶 歇	
分论坛：勇敢的大妈们——广场舞的社会网分析 主持人：郭毅		
10:20	勇敢的大妈们-如何撩动大妈心 045	杨君

10:40	勇敢的大妈们-广场舞：大妈们自嗨，由何而来，由何提升？ 蒋韦磊、顾倩 067
11:00	勇敢的大妈们-大妈们的自我觉醒之路 郭毅、杨君 068
11:20	广场舞：大妈们的情感表达和主体性建构仪式 孔佳南 120
<b>分论坛：社会网络与身心健康 主持人：张顺</b>	
13:30	吸烟行为与社会网络资源 李煜 109
13:50	社会资本的阶层特性及其对关系认同的影响 王文彬 110
14:10	社会网络精英关联度对主观阶层地位认同的影响 梁芳、张顺 111
14:30	社会网络与城市居民的主观幸福感 ——基于社会支持和参照群体的双重视角 王建、郭小弦 112
14:50	社会支持、社会比较与青少年的心理健康 姚远、张顺 113
15:10	"城市居民社会网络对身心健康的影响 ——基于“虚拟情境锚定法”的分析 高继波 114
15:30	茶 歇
<b>分论坛：在线社会网络（1） 主持人：褚建勋</b>	
15:50	从结构到行动：社会地位、社会资本如何影响互联网使用 孙悦 014
16:10	我国府际关系网络的结构特征及其原因分析——基于 284 个政务微博关注数据的实证研究 张阿城 053
16:30	基于社会网络分析的国内医养结合研究热点分析 陈舒盈、黄晓光 056
16:50	“互联网+政务”的科技信息采纳意愿影响因素分析——以转基因信息为例 张敏、杨吕乐 060
17:10	Interaction under Computer-mediated Circumstances and the Communication Effects of Tacit Knowledge: An Explorative Study Based on the Case of Zhihu.com Danyang Zhang, Junbin Su* (苏俊斌) 084
17:30	基于大数据分析在线社会网络的信息传播模式 褚建勋、陈健 071
18:20-20:00	中文会议晚宴（限报名中文会议者参加）地点： 五洲大酒店二层宴会厅

## 6月3日上午

	BICC 302	BIC 303	BICC 301
	分论坛： 复杂网方法 主持人：吴钢	分论坛： 其他社会网络研究（1） 主持人：张杰	分论坛： 劳动力市场的社会网络（2） 主持人：梁玉成
08:00	“一带一路”沿线国家在中国对外贸易中的排名超越关系研究 蒲岳、姚星、吴钢 023	风险感知下的城市居民志愿活动参与 杜欣、缪晓雷 115	社会网络的作用及其边界：基于人职匹配视角的研究 郝明松、边燕杰 104
08:20	中国产品出口增长的多元边界分解新框架——基于“产品-市场”动态二模网络 梅琳、吴钢、姚星 024	人们为什么不选择法律：纠纷解决偏好的影响因素研究 杨舸 116	社会网络对人职匹配的影响——基于关系强度的视角 肖阳 105
08:40	国际贸易网络微结构的形成机理及其稳态分析——以中国贸易伙伴关系网为例 吴钢、张永忠 025	市场化改革、关系资本动员与收入分配公平感 李黎明、李晓光 117	“有原则的特殊主义”的嬗变：国有单位内部的庇护性流动，1949-2014 雷鸣 106
09:00	共享经济用户交互对销量的影响研究：从二模网络分析的视角 陈远、刘福珍、吴江 031	校园共享单车困境及其治理研究 --基于行为主体间博弈的视角 闫慧丽 027	社会流动与社会资本建构 芦强 107
09:20	企业专利合作网络模式及对创新绩效的影响——以制药产业科技型上市中小企业为例 王黎莹、王佳敏、李建成、虞微佳 070	中国城市外交关系组织构建行为的跟随与差异： 基于友好城市二模网络 陈焯、刘夏明、王珏 029	社区社会资本与创业 苏洋 108
09:40		留职者的社会网络联结强度对追随离职意愿的影响：人际信任与风险规避视角 陈琳、袁庆宏、牛琬婕、谢宗晓 043	居民间社会关系网络对社区意识和社区参与影响之研究：不同营造经验社区的比较 王光旭、黄怡臻 011
10:00	茶 歇		



	分论坛： 社会大数据和舆情分析 主持人：唐锡晋	分论坛： 在线社会网络（2） 主持人：褚建勋	分论坛： 本土企业管理 主持人：周小虎
10:20	问诊类移动医疗 APP 的用户持续使用意愿分析——基于患者特征、医护特性与系统质量的多维视角 张敏、刘盈、聂瑞、张艳 062	亚文化青年趣缘群体的网络互动研究-以 COSER 群体为例 连昕萌、褚建勋 072	基于 QCA 方法的企业资源整合能力提升路径研究 邱玉霞、武同 021
10:40	探讨土地覆盖和对感知减重的影响 洪心、叶信岳 095	基于语义网络分析的学科研究主题演化研究 申帆、褚建勋 073	二元社会网络与海归企业创新绩效：基于模糊集的定性比较分析 赵文、李文霞、孙国强 033
11:00	探索在线群体对社会风险事件的关注点 贾玉改、唐锡晋 003	在线游戏社区中的默会知识传播 游仪 091	补偿机制模型：领导自我监控与认知灵活性的交互作用对意见网络中心性和团队绩效的影响 董雅楠、胡赛全 039
11:20	基于百度新闻的城市社会风险感知 苑鹏佳、唐锡晋 019	海归创业企业成长中双重网络嵌入的动态演化：一个纵向多案例研究 彭伟、朱晴雯、符正平 94	同事关系对工作繁荣的作用机制：基于工作关系的中介作用 李敏、李佳萍 042
11:40	探讨公众对“亚洲飞人”刘翔伦敦赛后的定位——体育明星还是娱乐明星？ 许诺、唐锡晋 020	社会资本与组织创新效率：一个多元治理视角 石军伟 118	“拉帮结派”有利于企业创新吗？——来自中国高端装备制造产业的证据 郑向杰 049
12:00	在线辩论网络分析——以天涯论坛辩论热帖为例 王灿、唐锡晋 028		

## 6月3日下午

BIC 302	
分论坛：社会网络与战略管理 主持人：任兵	
13:30	校企合作网络的生成影响因素研究 孙俊华 001
13:50	基金网络对投资效率的信息效应研究 徐金金、齐鲁骏 006
14:10	关系冗余、组织合法性与新创企业绩效关系研究 裴梦丹、张宝建、孙国强 037
14:30	社会资本与组织绩效的关系—基于元分析的文献综述 张慧 046
14:50	高威胁环境下企业间网络的角色和作用机制：对资源依赖理论的拓展 任兵、王励翔 004
15:10	
15:30	茶 歇
分论坛：社会网方法论 主持人：刘军	
15:50	制度变迁视角下社会网络对于水权交易行为影响的探索性研究 唐佳路 017
16:10	Optimization of small-world property based on Memetic Algorithm 杜海峰、王晶晶、王薇然 059
16:30	关系中的幸福：对幸福研究的批判与反思 刘军 119
16:50	网络分析视角下的地方政府危机治理与政府回应研究 刘淑华、魏以宁、唐心怡 097

## 6月4日上午

	BICC 311A	BICC 311B	BIC 311C
	分论坛： 关系社会学的理论与研究（1） 主持人：沈毅	分论坛： 社会支持 主持人：刁鹏飞	分论坛： 社会网络与计算传播学（1） 主持人：许小可
08:00	二维差序格局——转型中国社会关系结构变迁的再认识 董帅鹏 015	农民工集群行为的资源动员——基于核心-边缘结构的分析 何晓晨、杜海峰 009	基于迭代超中心度的 MOOC 论坛用户知识互动超网络研究 吴江、贺超城、马磐昊、周露莎 032
08:20	组织社会资本演化的多案例研究 冯文娜 057	结构洞位置对应急救援团队成员情境意识的影响 陈樊骏、姜卉、王振雄、王玉婷 035	中国近十年网络传播领域研究的知识图谱——基于共词方法的分析 晏齐宏 047
08:40	论中国人的关系信任：一种社会学的思考 陈云龙 008	自我归类和研究生校园幸福感的关系：社会网络和社会支持的中介作用 余卓霖 041	中国流动儿童研究图谱：基于CSSCI（1999-2016）科学计量学分析 周帅 052
09:00	儒家天人关系的社会学研究 卢崑翎 085	同伴关系与幸福感：基于社会网络的纵向研究 张镇 058	社交媒体环境下用户健康信息转发意愿影响研究 张敏、赵雅兰、罗梅芬、张艳 061
09:20	社会资本能否维持中国政治信任的有效存续 后梦婷 086	社会网络对信任的影响分析：资源机制与交往机制 邹宇春、赵延东 007	基于用户阅读和转发行为的微博信息扩散预测模型 罗春海、刘红丽、胡海波 013
09:40	从“自己人”到合伙人？——关系退化机制的本土研究 张杰 087	村改居社区治理能力建设-基于居民社会支持网的视角 刁鹏飞、孙悦 089	加权网络中权重边的有监督预测 傅晨波 075
10:00	茶 歇		
	BICC 311A	BICC 311B	BIC 311C

2017 Sunbelt Conference

	分论坛： 关系社会学的理论与研究（2） 主持人：沈毅	分论坛： 其他社会网络研究（2） 主持人：赵延东	分论坛： 社会网络与计算传播学（2） 主持人：许小可
10:20	单条微博传播的定量化测量与影响因素分析 许小可 083	复杂网络结构范型下的社会治理协同创新 范如国 096	复杂网络中的社会性同步 宣琦 076
10:40	Computational Social Science in Big Scholarly Data Feng Xia (夏锋) 005	边疆景观文化网络的空间分析 曾宇怀 054	网络多路径传播效率测量 闫小勇 077
11:00	儒法传统与“关系信任”的指向 沈毅 088	常规还是多元？西方组织理论开发与探索的“组织文化”——基于 AMR1976-2015 年文献数据的实证研究 曹祖毅、贾慧英 065	基于节点结构重要性的多层网络传播特性分析 苗清影 078
11:20	与谁交往更幸福？——社会网对主观幸福感的影响机制研究 尉建文、赵延东、韩杨 090	区域孵化网络效率与影响因素研究——基于中国大陆 29 个省级数据的实证分析 张玲 012	在线音乐社区的文化结构分析 韩筱璞 079
11:40	社会资本何以影响集体行动——基于 CGSS2012 数据的实证研究 贺寨平、王艺憧 092	企业联盟形成机制研究：基于角色地位的视角 王曦、符正平、罗超亮 044	基于准派系的符号网络聚类方法 亓兴勤 081
12:00		组群层次下风险投资多边联盟的形成研究 罗超亮 051	

## Chinese Network for Social Network Studies

### 中国社会学会社会网与社会资本研究专业委员会

Chinese Network for Social Network Studies (in brief, CNSNS) is a voluntary organization of Chinese network theorists. Its purposes aim at promoting Network Theories and Social Network Analysis in China and developing network theories suited for Chinese society. The preparatory office has been set up for organizing a series of activities at Jan. 17th 2007. It has held four "Social Network Studies and Relationship Management Conference(s)" separately in Shanghai, Harbin, Nanjing and GuangChou. In addition, the association also helped editing several special issues of social network studies for Chinese journals, and organized five training programs of social network analysis.

Chinese always describe themselves as a "Ren-Qing society", that is, roughly saying, a society built upon social ties (guanxi) and favor exchanges. Guanxi, guanxi network, favor exchange, guanxi circle and self-organization are the most important concepts to analyze Chinese society. Social network theories and network analysis exactly provide the best tools for these analyses. Therefore, many young scholars and graduate students tried to learn the relevant theories and methods. A group of network theorists in China has worked hard to promote the studies in this area, and CNSNS becomes the platform for these programs. In addition, a series of academic activities were organized for developing network theories specially suited for China. Since Chinese society provides abundant data for networking behaviors, we wish these efforts will enrich social network theories.

社会网理论(Network Theory)自 Harrison White 建立此一研究观点及方法后, 历经第二代弟子如 Mark Granovetter, Scott Boorman 以及 R.L.Breiger 等人五十多年经营, 至本世纪初已被美国社会学界誉为与新制度论、理性选择学派鼎足而三的显学。社会网理论视社会结构为一群人或组织的社会网连结, 不同于过去社会学多视社会为不同族群的组合, 此一新分析观点配合上网络分析、统计方法以及随机模型等相关数学的发展, 其实证的方法论基础在社会学中尤显扎实, 故能在日渐讲求科学实证的社会学内成为一代显学, 也必将引领未来社会学的走向。

网络理论及分析方法的应用层面很广, 早期的研究有新产品的传播、传染病的扩散、社会支持、情感支持、心理咨商、婚姻配对以及劳力市场中找职过程等等, 后来的研究则增加了很多经济现象, 如消费行为、网络式组织、经济制度、组织行为的研究等。八零年代以后, 网络研究由社会学而进入商学领域, 遂蔚为一时之盛, 成为各主要研究大学商学院的新领域, 尤其以芝加哥大学之 R. Burt 为然。

近年社会网研究在国内社会学界及管理学界也渐渐蔚为风气, 并与复杂网、动态网及大数据结合, 发展到传媒学、计算机学与物理学者之中, 研究同仁日渐增多, 写出相当多精彩论文, 面对此蓬勃发展的气象, 可惜国内尚缺一学会有计划地收集同仁们的论文以及网络分析数据的数据库, 使相关学者、学生可以便捷地取得社会网研究之资源, 并收到相互讨论切磋之效。

有鉴于此, 中国社会学会社会网与社会资本研究专业委员会遂成立, 以收整合资源且促进研究同仁交流之功效。本委员会是由清华大学、南京大学、中山大学、上海大学、哈尔滨工业大学、南京理工大学、华东理工大学、华南理工大学等诸多社会网学人发起的全国性的专业学术研究组织。2006 年委员会开始筹备, 2009 年 7 月于上海正式成立。

委员会秉承自组织、自治理的志愿者精神, 以社会网及社会资本学术研究为纲, 团结了社会学、管理学、传播学、复杂网络、计算机研究等多类学科的学者, 到 2017 年共举办了十二次中国社会学年会社会网与社会资本研究的分论坛, 独立举办十三届社会网与关系管理研究年会, 在中国本土社会学研究、管理学研究中产生重大影响。

## Center for Social Network Research at Tsinghua University

### 清华大学社会网络研究中心

The Tsinghua Center for Social Network Research was founded on Jan. 1st 2013. As a Tsinghua University research center, its purpose is to develop a platform for cooperation among physicists, computer scientists, and social, behavioral and epidemiology researchers, so that they can explore a set of interdisciplinary methodological approaches for studying complex social networks in big data.

Big data brings a lot of opportunities and challenges for interdisciplinary research: Various domains of knowledge have developed and accumulated a large body of hypotheses, models and empirical findings on the structure, dynamic processes, and consequences of social networks.

In order to arrive at a consensus we first need to create a methodological framework that takes data mining as its starting point. The object of research is online big data, which has the untapped potential to yield findings about new social phenomena. The next step is interpreting these findings through various qualitative and survey studies, which will further help us reveal grounded truth to verify theoretical hypotheses. The final step is building a model that encompasses the co-evolution of human actions and network structure based on the operative theories. With a model built on this solid foundation, researchers trained with interdisciplinary methods have the required information to predict new facts from their results.

Running in parallel to our research are real-world surveys that often generate new facts that conflict with our interpretation of the results of data mining. In this kind of scenario, we must return to our data and begin an iterative process of data mining, theory development and dynamic model building; until we can reconcile the two sets of results.

清华大学社会网络研究中心（CSNR）成立于 2013 年 1 月 1 日。作为清华大学的研究中心，其目的是建立平台推进物理学、计算机科学和社会科学研究者之间的合作，以利彼此探索跨学科方法。

为了有效整合数据挖掘、理论建构与动态复杂系统的预测，中心创建一个以数据挖掘为出发点的方法论框架，以在线大数据为挖掘对象，发现新社会现象，通过各种定性和调查研究，解释这些发现，进而揭示社会实际情况，并验证理论假说。在被验证的理论基础上建立包括人类行动和网络结构的共同演化模型。通过跨学科的方式建立动态网络模型，从而预测社会系统非线性演化的轨迹，并对非线性发展的社会系统中涌现的新生社会现象有所解释与预测。

CSNR 的目标是推进一系列项目，用以培养不同研究背景的学生，让他们不同的专业领域在方法上和实质上交流、整合并相互印证发明。依靠这样的跨学科培训学生以及联合研究的方法，做出大数据领域的新发现以及社会网络研究方面的大进展。

Institute for Empirical Social Science Research at Xi'an Jiaotong University

## 西安交通大学实证社会科学研究所

Established in October 2009, the Institute for Empirical Social Science Research (IESSR) at Xi'an Jiaotong University has been aimed to promote theoretically-informed and empirically-based social science research, with a focus on social network analysis and the sociology of guanxi through which to observe and explain the changing social realities of contemporary Chinese society. Since its founding, the IESSR has organized summer schools on social science research methods, a Wednesday seminar series, created and maintained a public data archive on topical social surveys, and built a research platform for Chinese and international researchers. In July 2013, IESSR successfully held the INSNA International Conference, which attracted about 500 scholars and students from 23 countries and regions to attend.

IESSR now has one University Leading Professor (Yanjie Bian, IESSR founding director), three Changjiang-Scholar Distinguished Professors (Shenyang Guo, Yaojun Li, Zai Liang), one Young Talent Scholar (Jun Liu), and 40 research fellows on its research faculty, who actively work with 40 graduate research assistants and consult with 20 domestic and international advisors on board. In recent years, IESSR research fellows have received four major project grants and a dozen individual grants from China's national social science foundation, one major project grant from Shaanxi Provincial Social Science Foundation, and a few internationally collaborative grants. One of the current efforts of the IESSR is to study the positive and negative impacts of social networks on career outcomes through the Job-Search Network Project, known as JSNET project.

西安交通大学实证社会科学研究所（实证所）成立于 2009 年 10 月，其宗旨是推动理论导向的实证社会科学研究，主攻学术研究方向为社会网络分析和关系社会学研究，由此把握中国社会现实及其变动。建立至今，实证所每年举办社会科学研究方法暑期学校，举办周三午间工作坊，组织大型专题社会调查并建立公共数据库，并致力于打造国际知名、全国一流的社会科学研究平台。实证所于 2013 年 7 月在西安成功举办了“社会网络分析世界大会”，来自 23 个国家和地区的约 500 学者和学生前来参加。

实证所目前拥有西安交大领军学者 1 人（边燕杰，创所所长）、长江学者 3 人（郭申阳、李姚军、梁在）、青拔拔尖学者 1 人（刘军），以及研究员 40 人、硕博研究生研究助理 40 人、中外学术顾问 20 人。实证所研究员近年获得国家社科重大和重点项目 4 项、陕西省社科重大项目 1 项、国家和教育部社科一般项目 10 余项、国际合作项目若干。目前，实证所正在开展求职网络的追踪调查（JSNET），研讨社会网络对于职业生涯的正负因果效应。

## School of Social Sciences Tsinghua University

# 清華大學社會科學學院

1911年清华学堂（1912年改称清华学校）建立之初，便开设多门政治学、经济学课程。1925年清华学校设立大学部。1926年成立的17个学系就包括社会学系、政治学系、经济学系和教育心理学系。1928年清华学校改名国立清华大学，设文、理、法三个学院共15个学系，其中社会学系、心理学系分别归入文学院和理学院，政治学系和经济学系隶属法学院。

清华大学社会科学的发展秉承“中西融会、文理会通”的学术传统，倡导运用现代科学的思想 and 研究方法探讨政治、经济和社会现象，坚持学习借鉴国际社会科学的先进经验和国际学术标准，注重研究中国现实问题，以“民族在学术上之独立发展，而完成建设新中国之使命为宗旨”，在治学和人才培养方面取得了世所公认的杰出成就。

一大批学术造诣深厚、社会影响广泛的杰出学者和社会活动家曾在清华社会科学各学系执教或学习，如费孝通、陈岱孙、张奚若、潘光旦、钱端升、萧公权、王铁崖、王亚南、陈达、朱君毅、伍启元、赵元任、戴世光、萧蓬、吴景超、李景汉、陈体强、唐钺等。以他们为代表的清华社会科学师生不但引领科学研究风气之先，而且学以致用，成为中国现代政治、经济和社会建设的一代英才。

1952年全国高等教育院系调整，清华大学成为多科性工业大学。社会科学相关学系和师生并入其他院校或学术机构。20世纪80年代之后，清华大学逐步向综合性大学方向发展，相继复建社会科学学科。1984年清华大学成立社会科学系，1993年成立人文社会科学学院，下设哲学与社会学系、中国语言文学系、历史系、思想文化研究所、科学技术与社会研究所、经济学研究所、教育研究所和艺术教育中心。1997年人文社会科学学院成立国际关系学系。2000年复建社会学系和政治学系。2008年复建心理学系。2012年，在清华新百年的起始之年，清华大学在原人文社会科学学院基础上，分别成立人文学院和社会科学学院。社会科学学院下设政治学系、国际关系学系、社会学系、心理学系、经济学研究所、科学技术与社会研究所，旨在瞄准国际学术前沿和国家战略需求，再创清华大学社会科学新的辉煌。

社会科学学院的主干学科是：政治学、社会学、经济学、心理学，目前有5个博士学位授予权的一级学科：政治学、社会学、理论经济学、体育学、哲学。4个本科专业：社会科学实验班（含国际政治学、社会学、经济学专业方向）、心理学专业；4个博士后流动站：政治学、社会学、理论经济学、哲学；3个北京市重点学科：国际关系、社会学、科学技术与社会。《国际关系分析》、《马克思主义政治经济学原理》、《邓小平理论与“三个代表”重要思想概论》课程被评为国家级本科精品课。

学院现有教职工83人，其中教授45人，副教授25人，讲师11人，职员2人，在站博士后67人。目前在读学生总数862人，其中本科生358人，硕士研究生281人，博士研究生223人（含留学生151人、港澳台学生13人）。

学院下设4系（政治学系、国际关系学系、社会学系、心理学系）2所（经济学研究所、科学技术与社会研究所），还设有近20个跨学科非实体研究机构。



# Beijing City Map

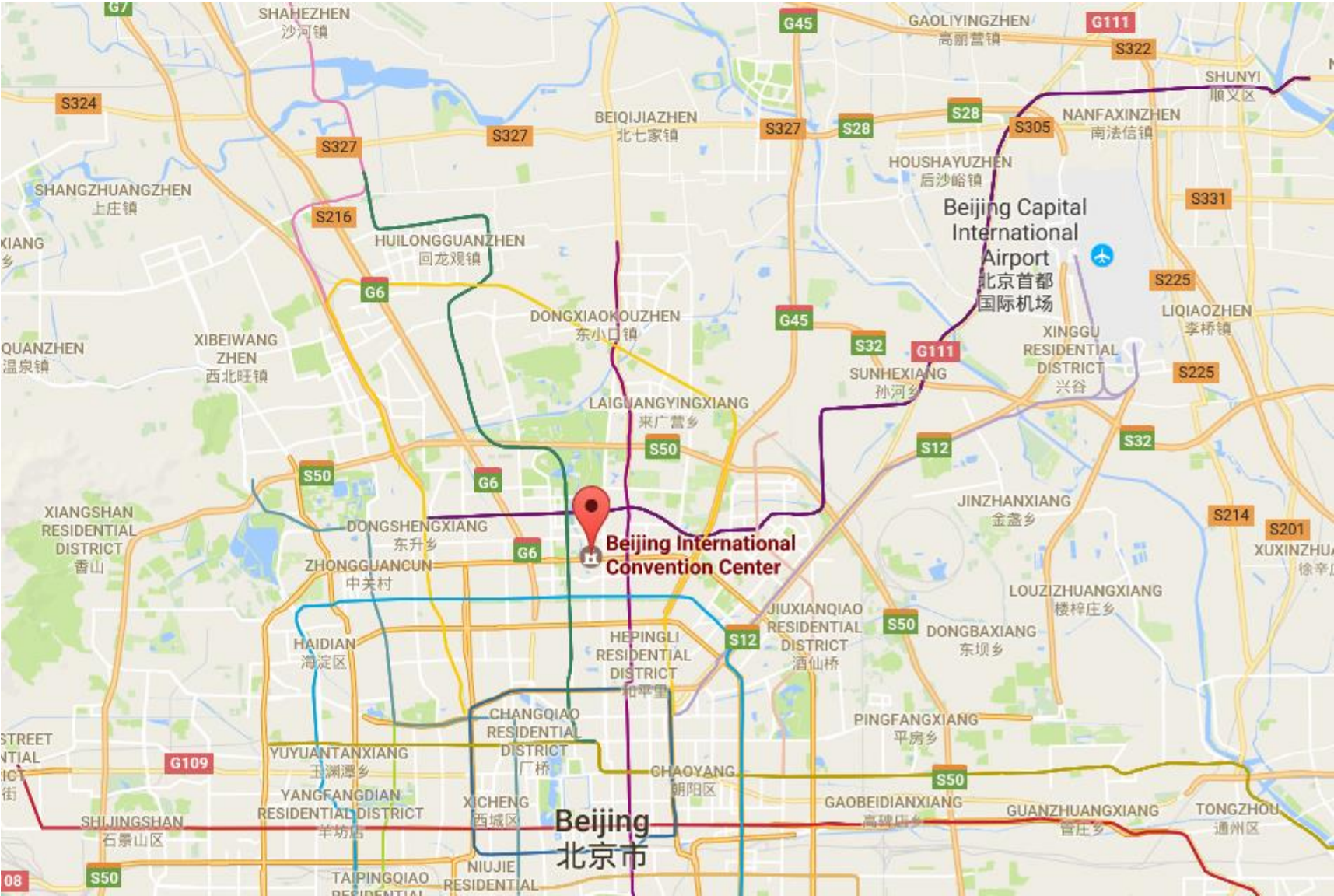

# Beijing Subway Map



Legend

- Line 1 BAOJING Line
- Line 4 DAXING Line
- Line 6
- Line 8
- Line 10
- Line 14
- Line 16
- FANGSHAN Line
- CHANGPING Line
- Line 2
- Line 5
- Line 7
- Line 9
- Line 13
- Line 15
- YIZHANG Line
- Airport Express

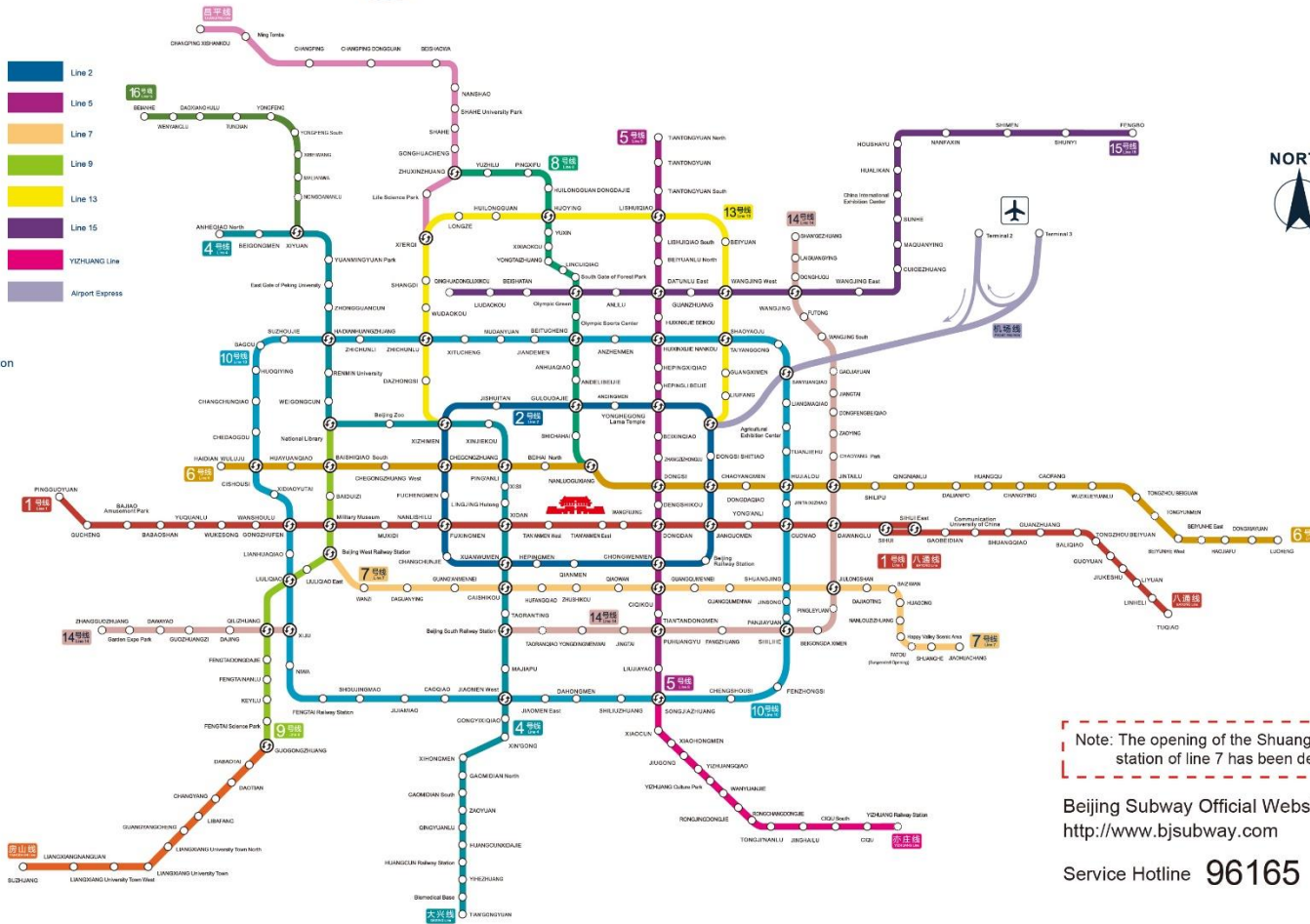

## Nearby Restaurants



indicates restaurants or food court

## Nearby attractions

·To Bird Nest: 600m, within walking distance

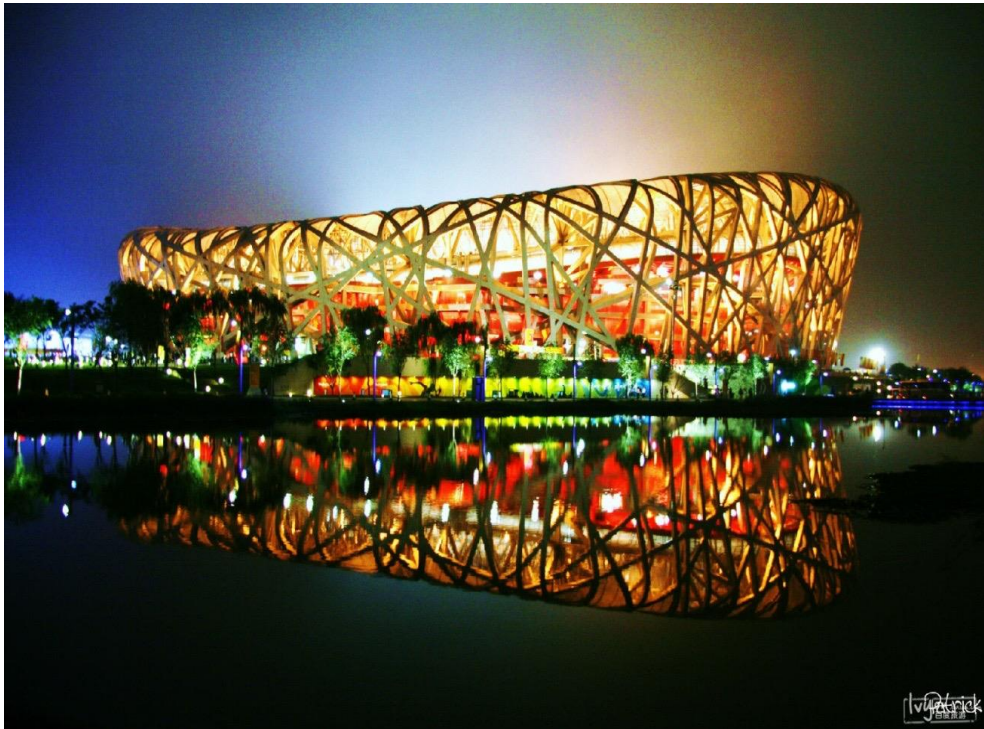

·To Water Cube: 600m, within walking distance



## International Sunbelt Social Network Conference History

No	Year	Location	Keynote Speaker	Organizers
I	1981	Tampa	None	H. Russell Bernard & Alvin Wolfe
II	1982	Tampa	John Barnes	H. Russell Bernard & Alvin Wolfe
III	1983	San Diego	James Coleman	Douglas White
IV	1984	Phoenix	Harrison White	Brian Foster
V	1985	Palm Beach	Linton Freeman	H. Russell Bernard & Alvin Wolfe
VI	1986	Santa Barbara	J. Clyde Mitchell	Eugene Johnsen & John Sonquist
VII	1987	Clearwater	Everett M. Rogers	H. Russell Bernard & Alvin Wolfe
VIII	1988	San Diego	Charles Kadushin	John Sonquist, Eugene Johnsen, Sue Freeman & Linton Freeman
IX	1989	Tampa	Frank Harary	Jeffery Johnson
X	1990	San Diego	Mark Granovetter	Everett M. Rogers
XI	1991	Tampa	James Davis	Katie Faust, Jeffery Johnson, John Skvoretz & Alvin Wolfe
XII	1992	San Diego	Peter Blau	Phillip Bonacich & Sue Freeman
XIII	1993	Tampa	A. Kimball Romney	H. Russell Bernard & Alvin Wolfe
XIV	1994	New Orleans	Barry Wellman	Scott Feld & Jill Sutor
XV	1995	London	Patrick Doreian	Martin Everett & Keith Rennolls
XVI	1996	Charleston	Bonnie Erickson	Katie Faust & John Skvoretz
XVII	1997	San Diego	H. Russell Bernard & Peter Killworth	Pat Doreian & Sue Freeman
XVIII	1998	Sitges	Rolf Zeigler	Jose Luis Molina, Josep Rodriguez, Nuria Avila, Frans Stokman, Tom Snijders, Evelien Zeggelink, Stephen Borgatti, Alain Degenne & Thomas Schweizer
XIX	1999	Charleston	Nan Lin	John Skvoretz & Katie Faust
XX	2000	Vancouver	Linton Freeman	Bill Richards & Andrew Seary
XXI	2001	Budapest	Martin Everett	Endre Sik
XXII	2002	New Orleans	Philippa Pattison	Ruth Aguilera, Noshir Contractor, Scott Fled, Caroline Haythornthwaite, Shin-Kap Han, Ravi Madhavan & Stan Wasserman
XXIII	2003	Cancun	Alvin Wolfe	Jorge Gil-Mendieta, Narda Alcantra, Silvia Casasola Vargas, Jorge Castro Cuellar, Alejandro Ruiz Leon, Jose Luis Molina, Samuel Schmidt & Enrique Perez Garcia
XXIV	2004	Portoroz	Frans Stokman	Anuska Ferligoj, Vladimir Batagelj, Andrej Mrvar, Hajdeja Iglic, Andrej Rus, Gregor Petric, Tina Kogovsek, Matjaz Zaversnik, Natasa Kejzar & Darinka Kovacic
No	Year	Location	Keynote Speaker	Organizers
XXV	2005	Redondo Beach	Ronald Breiger	Carter Butts, Rebecca Davis, Katherine

2017 Sunbelt Conference

				Faust & Tom Valente
XXVI	2006	Vancouver	Ed Laumann	Bill Richards
XXVII	2007	Corfu	Vlado Batagelj & Anuska Ferligoj	Moses Bourdoudis & Losif Botetzagias
XXVIII	2008	St. Pete Beach	Stephen Borgatti	John Skvortz, H. Russell Bernard, Christopher McCarty & Mark House
XXIX	2009	San Diego	Phillip Bonacich	Rebecca Davis, Laura Koehly & Tom Valente
XXX	2010	Riva del Garda	Tom A. B. Snijders	Mario Diani, Ferenc Jordan, Francesca Odella, Elena Pavan, Massimo Riccaboni, Alberto Sanna, Marco Zamarian, Francesca Menna
XXXI	2011	St. Pete Beach	Kathleen Carley	John Skvoretz, H. Russell Bernard, Christopher McCarty & Mark House
XXXII	2012	Redondo Beach	David Krackhardt	Laura Koehly, Rebecca Davis & Tom Valente
XXXIII	2013	Hamburg	John Padgett	Betina Hollstein, Sonja Drobnic & Michael Snegg
XXXIV	2014	St. Pete Beach	Jeff Johnson	H. Russell Bernard, Christopher McCarty & John Skvoretz
XXXV	2015	Brighton	Tom Valente	Elisa Bellotti, Bruce Cronin & Martin Everett
XXXVI	2016	Newport Beach	Garry Robins	Kayla de Haye, Rebecca Davis, Tom Valente, Hank Green & Kate Coronges
XXXVII	2017	Beijing	Ronald Burt	Jarder Luo, Yanjie Bian, Frank Zhang & Taoxiong Liu