

***Welcome!***  
**The Dairy Practices Council®**  
**52<sup>nd</sup> Annual Conference**

November 3 - 5, 2021

Pittsburgh, PA



# Zoom Webinar Tips

- Participants should be on Mute with Cameras Turned Off during this session.
- Participants will be able to type in comments/motions in the Chat
- Chat will be used during breaks
- Be sure to  your screen if it locks up
- This session will be recorded

# Gold Conference Sponsors



*Experience the difference*

MUELLER



# Silver Conference Sponsors



# Keynote Speaker Sponsorship



Dairy Farmers of America



# Bus Sponsors

Always good.  
**Always**



Dairy Farmers of America



# Morning Coffee Sponsors



*Experience the difference*



Eastern Crown<sup>INC</sup>  
DISTRIBUTOR OF DAIRY SUPPLIES



# Dairy Practices Council® New Member Orientation

---



# Objectives of DPC

- Develop & distribute educational guidelines
- Guidelines are designed to improve sanitation & production practices in the production of milk & dairy products
- DPC cooperates with other organizations that have similar educational goals



# DPC Annual Conference

- The 3-day conference takes place each Fall. Usually starts the day after election day in November
- Task Forces meet concurrently and provide a forum where topics of common interest can be shared with the members & other attendees



# DPC Financing

- Financed by Membership Dues:
  - Sustaining
  - Educational / Cooperative Extension
  - Regulatory State Agriculture & Health
  - Regulatory Federal FDA & USDA
  - Individual Members
- Supports the distribution of DPC Guidelines to the Dairy Industry in the US & throughout the world.



# DPC Organization

Governing body is the Executive Board.

- **State Departments of Health & Ag**
- **Federal Departments of Health & Ag**
- **Dairy Industry:** Representatives from Production, Processing, & Service areas of the industry
- **Education:** Representatives from Production, Processing, & Engineering areas of academia
- **Task Force Directors**



# Guideline Development

- Developed in Task Forces by people who have an interest in the guideline topic.
- There are approximately 100 Guidelines currently online and more in the development process.
- Guidelines are periodically updated & revised, depending on changes in technology or procedures.



# Guideline Development Peer Review

- Each Guideline goes through several levels of peer review.
- Peer Review ensures that Guidelines represent the state of knowledge at the time they are written.

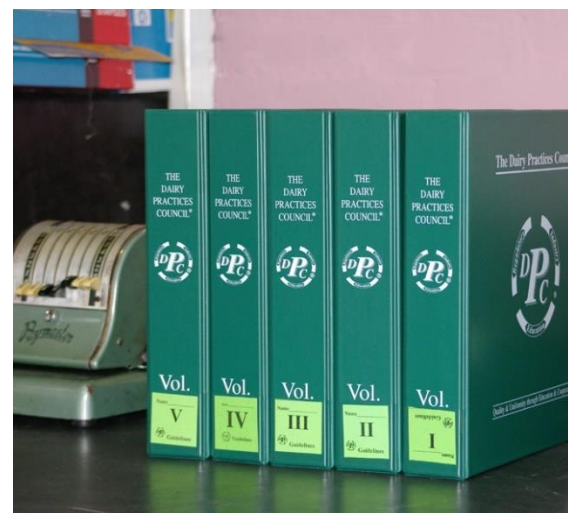

# Guideline Development

Three step development process:

1. **White cover** - a Guideline developed by the task force and is in draft form and open to revision.
2. **Yellow cover** - a Guideline completed & ready for final review by “*Key Sanitarians*” in each state who can insert footnotes and recommend changes if their state standards & regulations differ.
3. **Green cover** - a Guideline in final copy & ready for distribution



# Guideline Sets & Sales

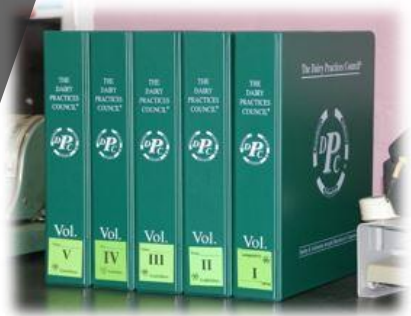

Pre-1990



2006 - 2014



2014 - 2020



# Guidelines - Sales 2021...

Join or Log-In

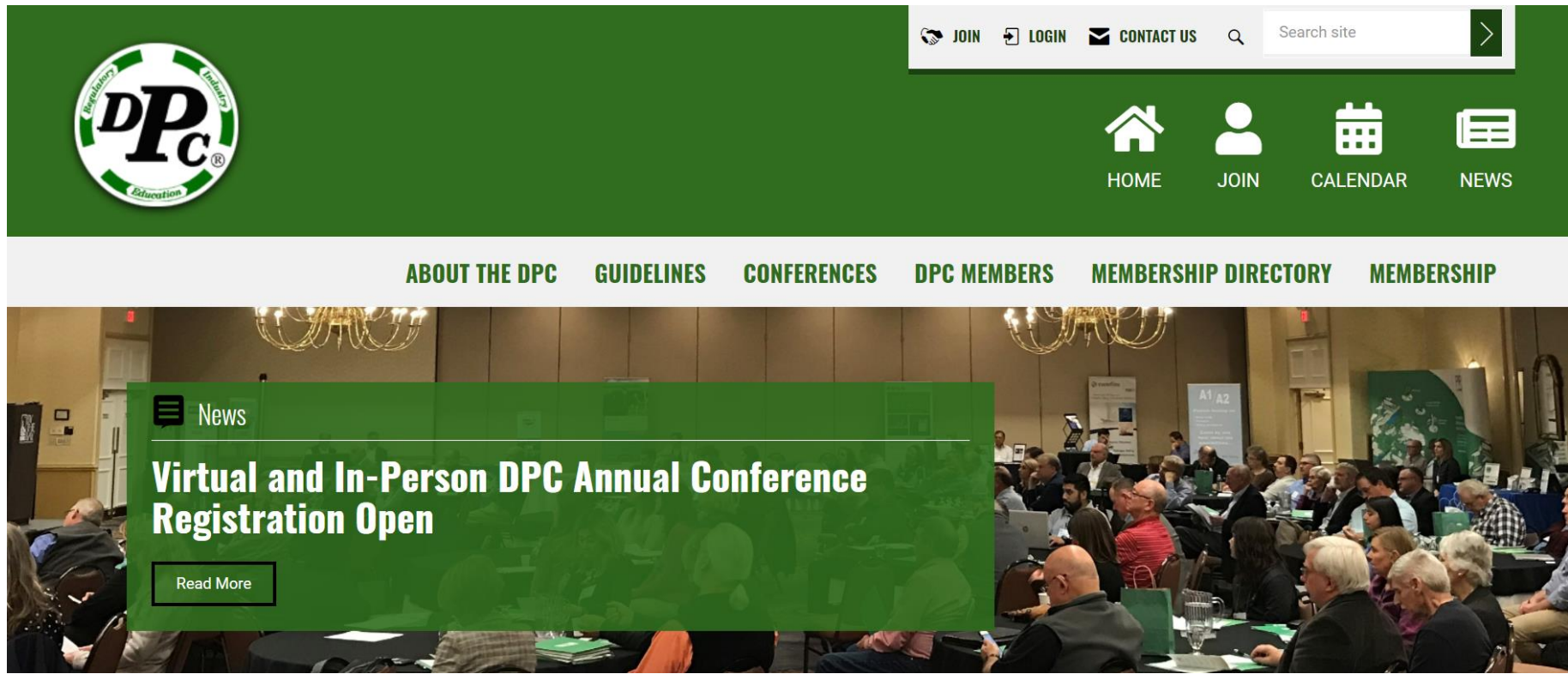

Contact [evp@dairypc.org](mailto:evp@dairypc.org) if you need a password reset

# Guidelines - Sustaining/HLM Member Access 2021...

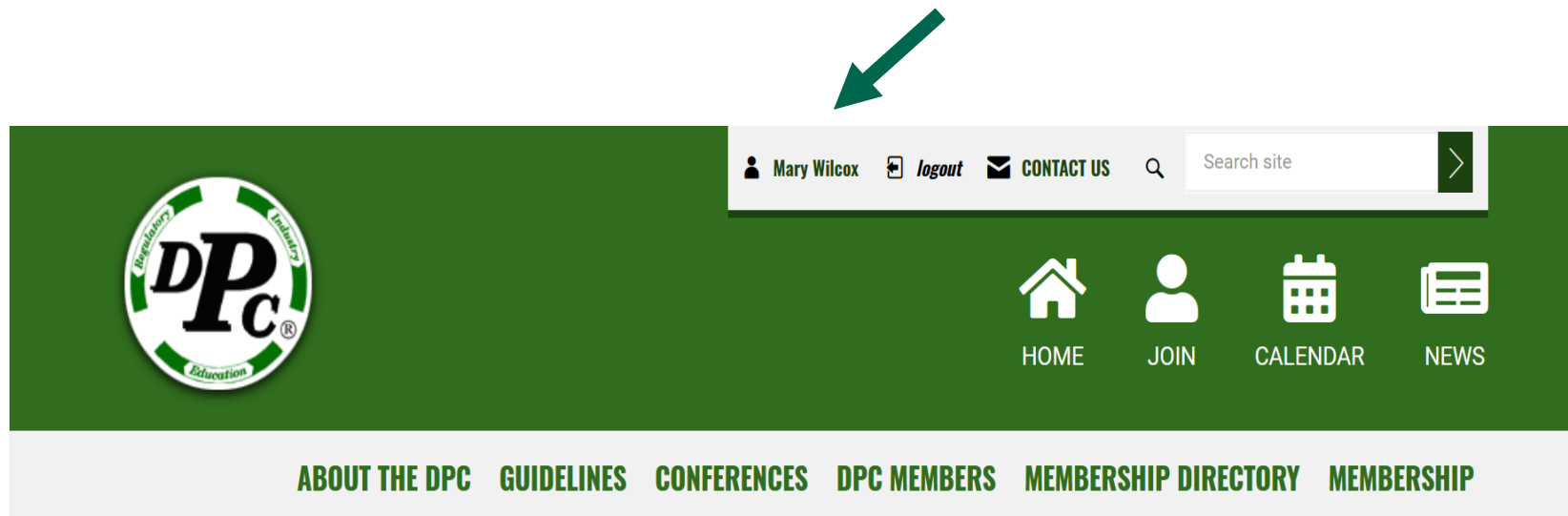

**Click on your name to enter Member Compass**

# Guidelines - Sustaining/HLM Member Access 2021...

**Click on Guideline Directory and Click on GL to Access**

## Welcome to your Member Compass™

This is an area tailored to your membership and member engagement. You can access the following:

**View, Print & Pay Invoices**

**Update Your Profile**

**Manage Events**

**Guideline Directory**

**News, Job Postings & Updates**

**Meeting Archives**

## Guideline Directory

---

*Member-only Access*

---

Guideline Working List

### **TASK FORCE I - Farm Buildings & Equipment:**

DPC001\_Planning Dairy Stall Barns

DPC006\_Natural Ventilation for Dairy Tie Stall Barns - NRAES

DPC015\_Milking Center Wastewater

DPC027\_Dairy Manure Management from Barn to Storage

DPC037\_Planning Dairy Freestall Barns

DPC041\_Milkrooms and Bulk Tank Installations

DPC042\_Stray Voltage on Dairy Farms

# International DPC

Argentina  
Australia  
Barbados  
Brazil  
Canada  
Chile  
Czech Rep.  
Denmark  
Finland  
France

Germany  
Great Britain  
Greece  
Ireland  
Israel  
Italy  
Japan  
Malaysia  
Mexico  
New Zealand

Norway  
Pakistan  
Puerto Rico  
Portugal  
Romania  
Russia  
Spain  
Sweden  
Thailand  
Turkey  
Venezuela

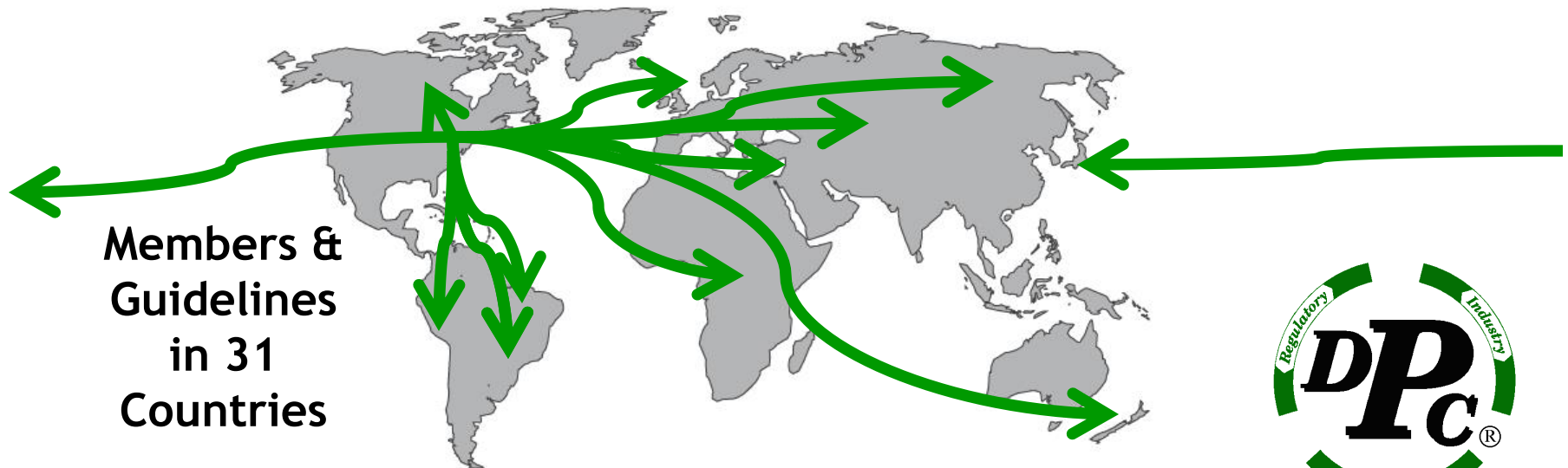

Members &  
Guidelines  
in 31  
Countries



# DPC Executive Board

## DPC OFFICERS



**Christopher Hylkema**

*Dairy Products Specialist II -  
Dairy Equipment*

NY Dept. of Agriculture &  
Markets



**DPC President**



**Keith Hay**

Pennsylvania Milk Marketing  
Board



**DPC Vice President**



**Mary Wilcox**



**DPC Executive Vice President**

## MEMBERS REPRESENTING REGULATORY



**Patrick Clark**

USDA



**FDA**



**Michelle Steinmetz**

Registered Sanitarian  
*Dairy Technical Specialist*  
Wisconsin Dept. of Agric.  
Trade & CP



**State Regulatory**



**Nicole Neeser**

MN Department of Agriculture



**State Regulatory**



## MEMBERS REPRESENTING INDUSTRY



**Wendy Landry**

HP Hood LLC



**Processing**



**Robin Breeding**

Dairy Farmers of America



**Production**



**Sharon Wilson**

Nelson-Jameson, Inc



**Suppliers/Services**

## MEMBERS REPRESENTING EDUCATION



**Charles Boeneke**

Louisiana State University



**Processing**



**Rick Watters**

Quality Milk Production  
Services



**Production**

## BOARD MEMBER-AT-LARGE



**Amanda Rife**

Land O'Lakes, Inc.



**Member at Large**



# DPC Task Forces

- DPC Guidelines are started, developed, and completed in a Task Force.
- DPC Members may belong to any or all six of the following Task Forces:





**Joseph Zulovich**

University of Missouri



**TASK FORCE I FARM BUILDINGS &  
EQUIPMENT**

Activities & Guidelines of  
this Task Force involve  
buildings & equipment for  
dairy operations.

Systems include designs for  
handling cows, feed, milk,  
ventilation, & manure.





**Carli Peskar**

USDA-FMMA Cleveland



**TASK FORCE II PLANT EQUIPMENT  
& PROCEDURES**

To develop meaningful  
guidelines for procedures  
and equipment involved in  
dairy plant operations.

To promote uniformity  
between the states.





**Jessica Smith**

USDA-FMMA Cleveland



**TASK FORCE III LAB & QUALITY  
CONTROL PROCEDURES**

To cover topics related to  
laboratory, quality control,  
product evaluation &  
trouble shooting  
procedures.

To cover methods of  
assuring quality  
through good production &  
manufacturing procedures.





**Melinda Davis**

HP Hood LLC



**TASK FORCE IV REGULATORY  
ISSUES & HACCP**

To foster communications  
& uniformity between the  
states.

This TF has been assigned  
guidelines concerning  
inspections as well as  
those relating to HACCP  
and FSMA.





**Neil Bendixen**

Dairy Farmers of America



**TASK FORCE V MILKING SYSTEMS  
& PROCEDURES**

To address guidelines  
relating to milking  
system design,  
equipment and facility  
function and cleaning.





## **TASK FORCE VI SMALL RUMINANTS**

To develop guidelines  
pertaining to all  
aspects of production  
and processing for  
dairy goat, sheep and  
other small ruminant  
operations.



# General & Task Force Sessions

## Meeting Rooms

- Opening & all General Sessions will be in the Pittsburgh/Philadelphia Ballroom
- Task Force Sessions -
  - TF I Alleghany
  - TF II Monongahela (Joint with TF IV)
  - TF III Keystone Suite
  - TF IV Monongahela (Joint with TF IV)
  - TF V Ohio
  - TF VI Scranton



# Meeting Rooms

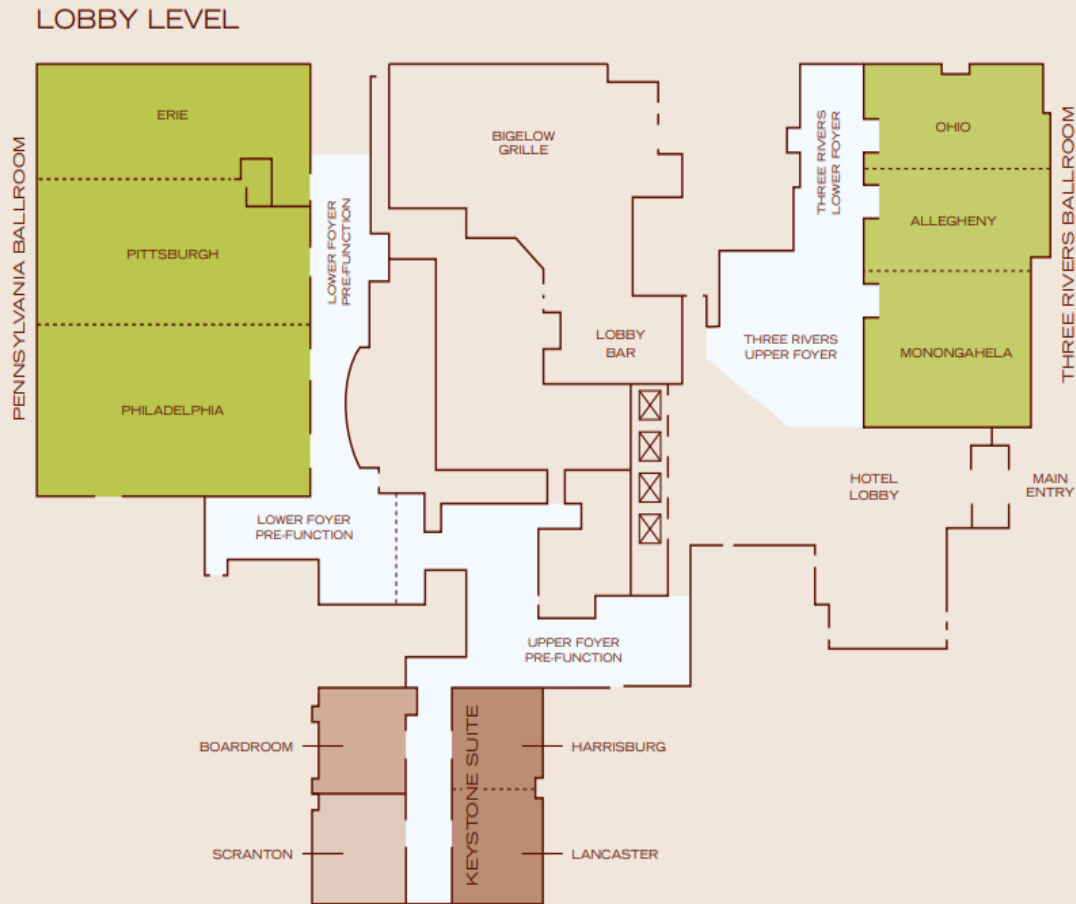

DOUBLETREE BY HILTON HOTEL & SUITES PITTSBURGH DOWNTOWN

One Bigelow Square 412-281-5800

PITDT\_DS@Hilton.com | [www.PittsburghDowntownDoubleTree.com](http://www.PittsburghDowntownDoubleTree.com)

# WHAT DAIRY LOOKS LIKE IN PENNSYLVANIA



- 5,430 Family-Owned Dairy Farms ranging in herd size from 15 cows to 3,500 cows. Total of 482,000 Dairy Cows.
- More than 50 Major Dairy Processing Companies, manufacturing a variety of dairy products. Currently about 32 percent of the milk produced in Pennsylvania is sold as bottled milk, while the remaining goes into other products.
- More than 60 Farm-Based Artisan Cheese Companies Marketing Cheese Up and Down the East Coast.
- A Host of Farm-Based Creameries Selling Milk, Ice Cream and Other Types of Dairy Products.

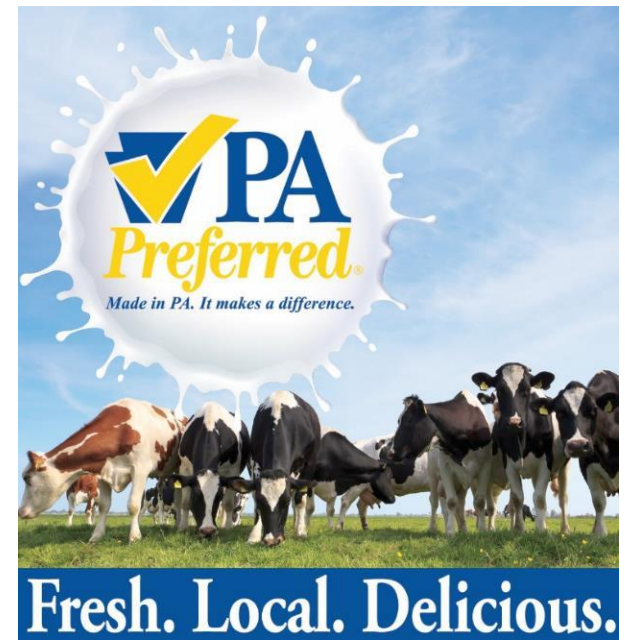

## PENNSYLVANIA NATIONAL LEADER IN DAIRY

- Second Largest Number of Dairy Farms
- Seventh Largest Industry in Total Milk Production
- Leader In:
  - Butter
  - Ice Cream
  - Swiss Cheese





# WHAT DAIRY'S WORTH TO PENNSYLVANIA

*\* From 2017 PA Dairy Study.*



**10.3 Billion Pounds  
of Milk Annually**



**52,000 Jobs  
Supported by  
Industry**

**\$12.6 Billion  
in Annual Economic  
Revenue Generation**



## **Pittsburgh – “City of Bridges”**

There are 446 bridges in Pittsburgh, which is more than any other city in the world.





The Polio vaccine was  
created by Dr. Jonas Salk in  
Pittsburgh in 1950

Pittsburgh has more days  
of rain and snow than  
Seattle, Washington





T  
W

**GO BILLS!**

ogo  
l



Networking Reception 5:30 - 7:30  
First Time Attendees Meet-Up 5:00

---



# Gold Conference Sponsors



*Experience the difference*

**MUELLER**



# Silver Conference Sponsors



# Keynote Speaker Sponsorship



Dairy Farmers of America



# Keynote Speaker

Matt Gould

Dairy & Food Market Analyst, *Inc*



# Please Enjoy the Conference

- We hope you enjoyed today's session and our Keynote Speaker
- First Time Attendee Recognition
- Participate in Task Force Sessions
- Enjoy The Dairy Bar
- Network during breaks
- Visit our Sponsor's Tables
- If you're virtual - please visit our sponsors websites as well



# Thank You!

Products for this

## Dairy Bar

Were graciously donated by  
the following companies:

Turner Dairy

Titusville Dairy

Galliker Dairy

Fairview Swiss Cheese

The Hershey Company

*Please Enjoy!*

