

ASHHE *Association
for the Study
of Higher
Education*

2008
33rd Annual Conference
Jacksonville, Florida



Research and Practice:
Embracing Connections

Pre-Conference November 5-6
General Conference November 6-8

Table of Contents

Welcome	3	Keynote Addresses	33
2008 Program Committee	3	Concurrent Session H	34
Highlights		Keynote Addresses	36
Preconferences	4	Concurrent Session I	37
Receptions	4	Concurrent Session J	39
Meetings	5	Concurrent Session K	43
Presidential Sessions	6	Concurrent Session L	45
Major Addresses	6	ASHE Community Meeting	45
Graduate Student Public Policy Seminar	7	2008 ASHE/Lumina Foundation for Education Dissertation Fellows	47
Graduate Student Events	7	Bobby Wright Dissertation of the Year Award	48
Council for the Advancement for Higher Education Programs	8	ASHE Award Winners	50
Council for International Higher Education	10	Council on Ethics Participation Awards	50
Public Policy Forum	11	2008 Board of Directors	52
Annual Conference		Conference Program Chairs	51
Newcomers Orientation	12	Past Presidents	53
Concurrent Session A	13	Proposal Reviewers	54
Concurrent Session B	17	Index of Participants	56
Presidential Address	20	Book Donors and Exhibitors	62
ASHE Welcome Reception	20	Hyatt Regency Floor Plan	63
Concurrent Session C	21	Sponsor Recognition	Back Cover
Concurrent Session D	23		
Awards Luncheon	26		
Concurrent Session E (Posters)	26		
Concurrent Session F	28		
Concurrent Session G	31		

Executive Office Staff

Executive Director
Patricia L. Farrell

Administrative Assistant
Patti Lillie

Graduate Student Assistants
Jesse S. Watson, ASHE
Matt Van Alstine, Lumina

Association for the Study of Higher Education

Michigan State University
424 Erickson Hall
East Lansing, MI 48824

Voice: 517-432-8805
Fax: 517-432-8806
Email: ashemsu@msu.edu
Website: www.ashe.ws

Dear Colleagues:

We are pleased to invite you to join us in Jacksonville, Florida, November 5-8, 2008, for the 33rd annual meeting of ASHE – the Association for the Study of Higher Education. ASHE is a scholarly society made up of professors, policy makers, administrators, and others who examine higher education as a field of study.

This year, our theme is Research and Practice: Embracing Connections. This focus extends our association's recent examination of ways in which higher education scholars talk with and learn from colleagues who carry out the daily work of colleges and universities in this country and beyond.

To further these discussions, we have organized a series of panels and discussions to explore connections between theory and practice. One featured session will foster a discussion among three college presidents, two of whom have been professors of higher education. Mildred Garcia, Colleen Hester, and Bernard Harleston will talk with Caroline Turner and Jay Dee about ways in which higher education research informs their campus work.

As institutions develop and search for new leadership, executive search firms provide an important service and a unique perspective on changes in academic leadership. Sharon McDade, of George Washington University and director of the Fellows Program of the American Council on Education, will moderate a discussion among senior colleagues in several academic search firms.

Other featured sessions explore the research and practice connection via discussions with policy makers, researchers, and other practitioners. In addition, we will offer dozens of symposia, panels, and research presentations from colleagues performing cutting-edge work in our field.

The main conference occurs November 6-8, but we also invite you to consider pre-conference gatherings with the Council on Public Policy in Higher Education, Council for International Higher Education, the Graduate Student Public Policy Seminar, and the Council for the Advancement of Higher Education Programs. For more information, for housing accommodations, or to register for the conference, please see www.ashe.ws. We look forward to seeing you in Jacksonville.

Linda Eisenmann, ASHE President, John Carroll University
Jay R. Dee, Program Chair, University of Massachusetts, Boston

2008 Program Committee

International Forum

Fatma Nevra Seggie, Bogazici University

Public Policy Forum

Colleen O'Brien
Patricia Yaeger, University of Illinois

Organization, Administration, and Leadership

Jason Lane, University at Albany, SUNY
Vicente Lechuga, Texas A & M University

Teaching, Learning, and Assessment

Karen Kurotsuchi Inkelas, University of Maryland
Tara Parker, University of Massachusetts, Boston

Context, Foundations, and Methods

Jana Nidiffer, University of Michigan
Steven Hubbard, New York University

Policy, Finance, and Economics

John Cheslock, The University of Arizona
Glenda Musoba, Florida International University

Faculty

Cheryl Daly, Western Carolina University
Luis Ponjuan, University of Florida

Students

Robert Reason, The Pennsylvania State University
Debra Bragg, University of Illinois

Receptions

Wednesday, November 5

**International and Public Policy Forums,
CAHEP, and Graduate Student Policy
Seminar Joint Reception**

6:30 pm – 8:30 pm
River Terrace 1/Deck

Sponsored by:

**Institute for Higher Education,
University of Georgia
and Lumina Foundation for Education**

Thursday, November 6

ASHE Welcome Reception

6:30 pm – 7:30 pm
River Terrace 1/Deck

North Carolina State University Reception

7:00 pm – 8:00 pm
City Terrace 9

**University of Massachusetts, Boston
Reception**

7:30 pm – 9:00 pm
River Terrace 2

University at Albany - SUNY Reception

7:30 pm – 9:30 pm
Clearwater

**Council on Ethnic Participation
Dessert Reception**

9:30 pm – 11:30 pm
St. Johns

**University of Minnesota Reception
(By Invitation Only)**

7:00 pm – 9:00 pm
River Terrace 3

Friday, November 7

Michigan State University Reception

7:00 pm – 8:30 pm
Daytona

**University of Michigan - Center for the Study
of Higher and Postsecondary Education
(CSHPE) Reception**

7:00 pm – 8:30 pm
City Terrace 7

**Vanderbilt University's Peabody College
Higher Education Leadership & Policy
Program Reception**

7:00 pm – 9:00 pm
City Terrace 9

**The University of Tennessee, Knoxville
Reception**

7:30 pm – 9:00 pm
City Terrace 12

University of Pennsylvania Reception

8:00 pm – 9:30 pm
St. Johns

**Council for the Study of Community Colleges
(CSCC) Dessert Reception**

8:30 pm – 10:00 pm
River Terrace 1

Iowa State University Reception

8:00 pm – 10:30 p.m.
River Terrace 3

**Claremont Graduate University, School of
Educational Studies Dinner
(By Invitation Only)**

7:00 p.m.
City Terrace 4

Pre-Conferences

Council on International Higher Education

Thursday, 8:00 am - Noon
City Terrace 9

7:30 am - 8:00 am Continental Breakfast

Council on Public Policy in Higher Education

Wednesday, 8:30 am - 6:30 pm
River Terrace 2

8:00 am - 8:45 am - Continental Breakfast

Thursday, 8:15 am - 12:15 pm

River Terrace 2

8:15 am - 9:00 am - Continental Breakfast

Graduate Student Public Policy Seminar

(By invitation only)

Wednesday, 12:30 pm - 9:00 pm
St. Johns

Dinner

7:30 pm - 9:30 pm

Orlando

Thursday, 8:00 am - Noon

City Terrace 7

Unless indicated, all Receptions are open to all conference attendees.

Pre-Conferences continued

Council for the Advancement of Higher Education Programs / Early Career Faculty Teaching Workshop

Wednesday 1:00 pm - 6:30 pm

City Terrace 6

CAHEP Evening Program

7:30 pm - 9:15 pm

River Terrace 1

Thursday, 7:30 am - Noon

City Terrace 4

ASHE/Lumina Foundation for Education Fellowship Program

(By Invitation Only)

Wednesday, 1:00 pm - 5:00 pm

City Terrace 4

Wednesday, 6:30 pm - Close

River Terrace 3

Thursday, 8:00 am - Noon

Orlando

Meetings

Wednesday, November 5

The George Washington Project – CAP Project (By Invitation Only)

1:00 – 5:00 pm

City Terrace 8

Thursday, November 6

Board of Directors

8:00 am – 11:30 am

City Terrace 5

ASHE Institute on Equity Research Methods and Critical Policy Analysis

8:00 am – Noon

City Terrace 11

Newcomers' Orientation

(All Welcome)

11:45 am – 12:45 pm

River Terrace 1

ASHE Reader Series Meeting

Noon – 2:00 pm

Suite 4104

Council on Ethnic Participation

8:00 pm – 9:30 pm

Orlando

Friday, November 7

Publications Committee Meeting

7:00 am – 8:30 am

Board Room 2

Journal of Higher Education Advisory Meeting

7:00 am - 8:15 am

Board Room 1

Council for the Study of Community Colleges (CSCC) Board Meeting

8:30 am – Noon

Board Room 3

AERA Emerging Scholars Pre-Conference Workshop Planning Committee

8:00 am – 9:45 am

Board Room 4

Higher Education Colloquium (All Welcome)

1:00 pm – 3:15 pm

Board Room 1

CEP Mentee/Protégé

4:00 pm – 5:00 pm

Board Room 1

Saturday, November 8

2009 Program Committee

8:00 am – 10:30 am

Board Room 1

The Review of Higher Education Editorial Board Meeting

7:30 am – 9:00 am

Board Room 3

ACE Meeting

7:00 am – 10:00 am

Board Room 2

ASHE Higher Education Report Advisory Board Meeting

11:00 am – 1:00 pm

Board Room 3

Organization of ASHE Seniors (Luncheon)

11:30 am – 1:30 pm

Board Room 1

ASHE Community Meeting (All Welcome)

6:30 pm – 7:30 pm

River Terrace 2

Sunday, November 9

Board of Directors

8:00 am – Noon

City Terrace 12

Thursday, November 6

A • Higher Education as an Engaged Field of Study: ASHE Board Dialogue on its Connections to Policy and Practice

Grand 3

1:00 pm - 2:30 pm

B • Strategies to Achieve Equity Without Affirmative Action

Grand 2

2:45 pm - 4:15 pm

Friday, November 7

D • Theory to Practice, or Practicing Theory?: Uncovering the Explicit and Implicit Ways that College Leaders Really Use Theory

Orlando

9:45 am - 11:15 am

F • Is it Double Dipping or Not?: The Ethics of Presenting and Publishing in Higher Education

Orlando 2:00 pm - 3:15 pm

G • Writing Research that Connects to Practice

City Terrace 4

3:30 pm - 4:15 pm

Saturday, November 8

I • The Research World beyond Higher Education Programs

City Terrace 7

11:30 am - 1:00 pm

J • Who's In? Who's Out? A Conversation About Inclusion in ASHE

Orlando 1:15:00 PM-2:45:00 PM

K • Navigating the Publications Process: A Conversation with Journal Editors

City Terrace 5

3:00-4:15 p.m.

Major Addresses

PRESIDENTIAL ADDRESS

Thursday, November 6, 4:30 pm -6:00 pm

Terrace Pavilion 2

Practicing What I Teach: Does a Career as a Higher Education Professor Inform My Work as a Dean?

Linda Eisenmann, John Carroll University

Keynote

Friday, 5:00 pm -6:30 pm

Terrace Pavilion 2

Preparing Leaders for Colleges and Universities: the View from Search Firms

Moderator: Sharon McDade, American Council on Education

Jean Dowdall, Vice President, Witt/Kieffer

Ted Marchese, Academic Search, Inc.

Narcisa A. Polonio, AACT – Education, Research and Board Leadership Services

Keynote

Saturday, 9:45 am -11:15 am

Terrace Pavilion 2

College Presidents and Higher Education Research: Do Our Studies Matter to Practice?

Introduction: Jay R. Dee, University of Massachusetts, Boston

Moderator: Caroline Sotello Viernes Turner, Arizona State University

Mildred Garcia, President, California State University, Dominguez Hills

Colleen Hester, President, MacMurray College

Bernard Harleston, Former President, City College of New York

The Graduate Student Policy Seminar is only for invited students. If you were not selected to attend this Seminar you are welcome to take part in the Public Policy Pre-Conference Forum. If you have any questions regarding the seminar, please contact Marvin Titus at mtitus@umd.edu

Wednesday, November 5 St. Johns

12:30 pm - 1:00 pm Registration

1:00 pm - 1:30 pm Welcome and Introductions
Marvin Titus, University of Maryland – College Park
Jennifer Ann Delaney, University of Wisconsin – Madison
David Weerts, University of Minnesota – Twin Cities

1:30 pm - 2:00 pm Local Innovations in Student Aid: The Case of Kalamazoo Promise
Steve DesJardins, University of Michigan

2:00 pm - 2:30 pm State Student Financial Aid
William R. Doyle, Vanderbilt University

2:30 pm – 2:45 pm Break

2:45 pm – 3:45 pm How States Develop a Public Agenda for Higher Education
Karen Paulson, National Center for Higher Education Management Systems (NCHEMS)

3:45 pm- 4:45 pm Participant Project Discussions

4:45 pm - 6:30 pm Joint Roundtables with ASHE Public Policy and Lumina Fellows (Please see page 11 for the list of roundtable topics.)

6:30 pm - 7:30 pm Joint Reception with ASHE Public Policy, CAHEP and International Pre-Conference Forums
River Terrace 1

7:30 pm - 9:00 pm Dinner Keynote:
Orlando
Why We Write
Michael Olivas, University of Houston

Thursday, November 6 City Terrace 7

8:00 am - 8:30 am Continental Breakfast

8:30 am – 9:00 am Debrief of Roundtables and Dinner Conversations

9:00 am - am 10:00 State Data Systems and Policy Analysis
David Tandberg, Pennsylvania Department of Education
Jennifer Ann Delaney, University of Wisconsin

10:00 am - 10:15 am Break

10:15 am - 11:30 am State and Federal Support of Higher Education
Marvin Titus, University of Maryland
David Weerts, University of Minnesota

11:30 am – 11:45 am Wrap Up and Evaluation

Graduate Student Events

Thursday, November 6 Newcomers Orientation

(All Newcomers are invited)

Hosted by ASHE Membership Committee
Clearwater

11:45 am - 12:45 pm

A * The Pressure to Publish: Demystifying the Publications Process From the Research Project to the Final Article

Clearwater

1:00 pm - 2:30 pm

Chair: Kelly Risbey, University of Minnesota

Discussant: Judy Marquez Kiyama, University of Rochester

Sylvia Hurtado, University of California, Los Angeles

Jenny Lee, University of Arizona

Liang Zhang, Vanderbilt University

Friday, November 7

C * Frustration of Success: Examining the Importance of Graduate Student Socialization in Higher Education

City Terrace 5

8:00 am - 9:30 am

Chair: Judy Marquez Kiyama/University of Rochester

Discussant: Kelly Risbey/University of Minnesota

Ann Austin, Michigan State University

Carol Colbeck, University of Massachusetts, Boston

Christine Golde, Carnegie Foundation for the Advancement of Teaching

Saturday, November 8

I * Establishing Yourself as a Professional Within the Field of Higher Education

Graduate Student Luncheon

City Terrace 4

11:30 am - 1:00 pm

Consuella Lewis, University of Pittsburgh

Vicki J. Rosser, University of Nevada, Las Vegas

Barbara Townsend, University of Missouri-Columbia

Education Programs (CAHEP)

Early Career Faculty Teaching Workshop

Wednesday, November 5

1:00 pm – 1:15 pm

Welcome, Introductions, and Overview

City Terrace 6

Joshua Powers/Chair, CAHEP

1:15 pm – 3:40 pm

Moderator: Les Goodchild/Program Co-Chair, CAHEP

Introductory Remarks – Faculty Academic Vocation

Jennifer Haworth/Loyola University Chicago & 1998 ASHE Promising Scholar/Early Career Award Winner

Teaching Topic Roundtables

- Teaching History of Higher Education - Marybeth Gasman/University of Pennsylvania
- Teaching Gender and Diversity - Lisa Wolf-Wendel/University of Kansas
- Teaching Organizational Theory and Administration – Jerlando F. L. Jackson/University of Wisconsin
- Teaching Curriculum - Dwight Giles/University of Massachusetts, Boston
- Teaching Faculty Issues – Marty Finkelstein/Seton Hall University

3:40 pm – 4:00 pm

Break

4:00 pm – 6:30 pm

Introductory Remarks – Context for Dissertation Advisement/Supervision

Adrienne Hyle/Vice-Chair, CAHEP

Les Goodchild/Program Co-Chair, CAHEP

Dissertation Advising Strategies for High Quality Dissertations

- Anna Neuman, Columbia University & Advisor to 2006 ASHE Dissertation of the Year Award Winner
- Lisa Wolf-Wendel, University of Kansas & Advisor to 2004 ASHE Dissertation of the Year Award Winner
- Les Goodchild, Santa Clara University & Advisor to 2003 ASHE Dissertation of the Year Award Winner
- Edward St. John, University of Michigan, & Advisor to 2002 ASHE Dissertation of the Year Cited for Excellence Award Winner

Dissertation Advising Roundtables (Participants engage topics raised in smaller groups with panelists as facilitators)

6:30 pm- 7:30 pm

Joint Reception with Other Pre-Conferences

River Terrace 1

7:30 pm – 9:15 pm

CAHEP Evening Program

Dessert and refreshments served; event is open to all and is free

City Terrace 7

New Faculty Teaching Workshop Participant Introduction/Recognition with Certificates of Completion Distribution

Moderators: Les Goodchild & Ashley Sieman/Program Co-Chairs, CAHEP

State of the Programs Roundtable

Moderator: Joshua Powers/Chair, CAHEP

CAHEP Officer Elections and Business Meeting

Thursday, November 6

City Terrace 4

Council for the Advancement of Higher Education Programs – Pre-Conference Program Improvement & Promising Practices Forum (Open and free to program coordinators and other interested persons)

7:30 am – 8:00 am

Breakfast

8:00 am – 8:10 am

Welcome

Joshua Powers/Chair, CAHEP

Linda Eisenmann/President, ASHE

8:15 am – 9:30 am

Paper Session I

City Terrace 4

Chair/Discussion Facilitator: Ashley Sieman/Marymount University

Integrating Inclusive Excellence: The Case of Higher Education Program at the University of Denver

Rahul Choudaha/University of Denver

Bridgette Coble/University of Denver

Niki Latino/University of Denver

Benchmarking Higher Education Doctoral Programs

Peggy Sindelar/University of North Texas

Randy Byers/University of North Texas

Marc Cutright/University of North Texas

Research Versus Practice: Testing the Predictive Ability of GRE Scores in Relation to Faculty Ratings of Graduate Students' Performance

Terrell Strayhorn/University of Tennessee, Knoxville

Norma Mertz/University of Tennessee, Knoxville

Roundtable Sessions

City Terrace 6

Roundtable Hosts:

Dana Christman/New Mexico State University

Rhonda McClellan/Texas Woman's University

Multiculturally Competent Student Affairs Graduate Students?

Hermen Diaz/Buffalo State University

Kim Kline/Buffalo State University

Higher Education Programs and Emerging Technology: What's the Connection?

Megan Palmer/Indiana University Purdue University Indianapolis

Leila Gonzalez-Sullivan/North Carolina State University

Genevieve Shaker/Indiana University Purdue University Indianapolis

9:40 am – 10:55 am

Paper Session II

City Terrace 4

Chair/Discussion Facilitator: Adrienne Hyle/University of Texas, Arlington

The Role of Self-Reliance in the Graduate Student Experience of Women Faculty in Higher Education Administration

Karen Haley/Northern Illinois University

Launching International Doctoral Cohorts: Bridging Theory and Lessons Learned on Three Continents

Stephen Wanger/Oklahoma State University

Higher Education as a Field of Study at Historically Black Colleges and Universities

Nicole Barnett/Indiana Wesleyan University

Symposium Session

City Terrace 6

Chair/Discussion Facilitator: Karen Card/University of South Dakota

Higher Education Leadership Program Standards: Can We Afford Not to Have Them?

Dianne Wright/Florida Atlantic University

Patricia Carretta/George Mason University

11:00 am – 12:00 pm

Joint ASHE/CAHEP Featured Speaker Presentation

Rethinking the Doctorate: Responding to Emerging Conditions

City Terrace 4

Chair/Discussion Facilitator: Les Goodchild/Santa Clara University

Chris Golde/former senior scholar at the Carnegie Foundation for the Advancement of Teaching and currently Associate Vice Provost for Graduate Education at Stanford University

The Formation of Scholars: Rethinking Doctoral Education for the 21st Century (San Francisco: Jossey-Bass and Carnegie Foundation for the Advancement of Teaching, 2008)

Organization of ASHE Seniors

Saturday

11:30 am - 1:30 pm

Board Room 1

Jonathon Feinstein

John G. Searle Professor of Economics and Management at Yale University

Changes in Modes of Creativity in Senior Scholars

Council for International Higher Education (CIHE) Forum

Thursday November 6, 2008

City Terrace 9

This year's International Forum takes a new shape, which will enable more ASHE delegates to participate. The Forum opens on Thursday morning, November 6, 2008 with a session from 8 am until 11:30 am.

Our International program this year addresses a range of higher education issues related to the overall theme of Research and Practice: Embracing Connections examined in a global and international context. Sessions will be held on Thursday morning and will also be woven throughout the remainder of the conference, thus integrating the work of the International Forum into the fabric of the main conference. We look forward to a stimulating occasion.

8:00 am - 8:15 am Welcome and Introductions

8:15 am – 9:30 am Parallel Session

Globalization of the Anglo-Saxon Model of Higher Education: The Impact on Research and Practice

Alan France/University of Westminster
Zarrina Azizova/Oklahoma State University
Meng Wang/Oklahoma State University
Stephen P. Wanger/Oklahoma State University

9:30 am – 10:00 am Coffee break

**10:00 am - 11:30 am Plenary Speaker
Dr. Mary-Louise Kearney
UNESCO Forum on Higher Education, Research and Knowledge
Topic: *Challenges for Research Systems in the Knowledge Society***

Dr. Kearney is a Senior Research Fellow in Higher Education at Oxford University, a Vice-President of the Society for Research into Higher Education, and has published considerably on higher education.

11:30 am– Noon CIHE Business Meeting

**Special Invitation:
Wednesday, November 5
6:30 – 8:30 p.m.
River Terrace 1/Deck**

Wednesday evening CIHE members are invited to join colleagues from the Public Policy Forum, Graduate Student Policy Seminar, ASHE/Lumina Fellows, and the Council for the Advancement of Higher Education Programs to a joint reception.

Public Policy Forum

Wednesday November 5, 2008

River Terrace 2

8:00 – 8:45 am
Continental Breakfast

8:50 – 9:00 am
Welcome and Introductions

9:00 – 10:30 am
Undocumented Immigrants and College Access: The Origin and Consequences of In-State Tuition Policy

Kevin Dougherty/Teachers College, Columbia University
Elizabeth Feranchak/University of Texas at Arlington
Stella Flores/Vanderbilt University
H. Kenny Nienhusser/Teachers College, Columbia University
Michael Olivas/University of Houston
Blanca Vega/Teachers College, Columbia University

10:30 – 10:45 am
Break

10:45 am – 12:00 pm
Debating the Value of a College Degree
Moderator: William Doyle, Vanderbilt University

The Value of a College Degree: Miracle or Myth?
Steve Boilard/California Legislative Analysts Office

The Fiscal Impacts of College Attainment
Phillip Trostel/University of Maine

12:00 – 1:30 pm
Lunch Break

1:30 – 2:15 pm
Paradoxes in State Constitutional Autonomy and Deregulation of Public Higher Education
Moderator: Judith Gill/University of Massachusetts, Boston

Robert Berdahl/University of Maryland
Neal Hutchens/Barry University

2:15 – 3:00 pm
Adult Students and State Financial Aid
Moderator: Kimberly Rogers/Jobs for the Future
Erin Walsh/University of Pennsylvania

3:00 – 3:15
Break

3:15 – 4:45 pm

Data-Driven Accountability: The Access to Success Initiative

Mark Rosenberg/State University System of Florida
Dorothy Minear/Strategic Initiatives, Florida Board
of Governors

Margarita Benitez/The Education Trust
Jennifer Engle/The Education Trust

4:45 – 5:00 pm

Break

5:00 pm – 6:30 pm

Round Table Discussion

Joint Sessions with Graduate Student Public Policy
Seminar and ASHE/Lumina Fellows

Moderators: Robert K. Poch/University of
Minnesota

Fritz Vandover/University of Minnesota
Topic: *Changes in the Role of Governors in State
Higher Education: Structural Changes Alone or
Something More?*

Moderator: Michelle Asha Cooper/Institute for
Higher Education Policy
Topic: *Update on the Reauthorization of Higher
Education Act and Other Federal Policy
Developments*

Moderator: Barbara Townsend/University of
Missouri-Columbia
Topic: *Baccalaureates Awarded by Associate
Degree-Granting Institutions*

Moderator: Jeff Milem/University of Arizona
Topic: *Considering Diversity Policy: Mapping an
Agenda for the Future Equity*

Moderator: Kathleen Shaw/Pennsylvania
Department of Education
Topic: *Building Longitudinal Postsecondary
Databases*

Moderator: Patricia Marin/University of California,
Santa Barbara
Topic: *Social Science and the Media:
Communicating Your Research Beyond the Academy*

Moderator: Karen Paulson/NCHEMS
Topic: *Accountability: Reporting the Data*

Moderator: Christopher Morpew/University of
Georgia
Topic: *Research on Statewide Coordination/
Governance*

Moderator: James T. Minor/Michigan State
University
Topic: *State Higher Education Funding Formulas
and Institutional Capacity*

Moderator: Scott Thomas/Claremont Graduate
University

Topic: *A Discussion of Policy Issues in an
International Context*

Moderator: Marybeth Gasman/University of
Pennsylvania

Topic: *Minority-Serving Institutions*

Moderator: Consuella Lewis/University of Pittsburgh
Topic: *Revisiting State Financial Support for Higher
Education in the Current Financial Climate*

Moderator: Jennifer A. Delaney/University of
Wisconsin

Topic: *State Merit-Based Aid*

Moderator: David J. Weertz/University of Minnesota
Topic: *The Role of Legislators in Setting Higher
Education Policy*

Moderator: Heather Eggins/Staffordshire University
Topic: *Access from a Global Perspective*

Moderator: Kimberly R. Rogers/Jobs for the Future
Topic: *Doing and Using Policy Research in the Non-
Profit Sector*

Moderator: ASHE Linkages Task Force
Topic: *ASHE Connections to Policy and Practice*

Moderator: Deborah Santiago/Excelencia in
Education
Topic: *Crystal Ball or Snow Globe? Public Policy and
the Future of Latinos in Higher Education*

Thursday November 6

River Terrace 2

8:15 – 9:00 am

Continental Breakfast

9:00 – 10:30 am

Bakke at 30: The Legal and Policy Implications

Karen Miksch/University of Minnesota
Stella Flores/Vanderbilt University
Donald Heller/The Pennsylvania State University
Patricia Marin/Harvard University

10:30 – 11:15 am

What's in a Number: The Impact of the New Federal Guidelines on Collecting and Reporting Racial and Ethnic Data

Moderator: Alisa Cunningham/Institute for Higher
Education Policy

Eugene Anderson/American Dental Education
Association

Bryan Cook/ American Council on Education

11:15am – 12:15 pm

Business Meeting

Newcomers' Orientation

11:45 am - 12:45 pm
Clearwater

Host: ASHE Membership Committee

All Newcomers are Invited to Attend

The NEA congratulates these ASHE members whose work appears in our higher education publications, *The 2008 NEA Higher Education Almanac* and *Thought & Action*, the NEA higher education journal:

Valerie Martin Conley, Ohio University

Chad Hason, Casper College

Christine Maitland, National Education Association

Jana Nidiffer, University of Michigan

Gary Rhoades, University of Arizona

Vicki J. Rosser, University of Nevada-Las Vegas

Harold Wechsler, New York University

William Zumeta, University of Washington

Please visit the NEA literature table for a complimentary copy of the publications and join us for Saturday's Presidential Session, "The Research World beyond Higher Education Programs," at 11:30 a.m. where *NEA Almanac* contributors John B. Lee of JBL Associates and Mark Smith, NEA Higher Education coordinator, will participate.



1:00 pm - 2:30 pm

A1 * Presidential Session

Grand 3

Higher Education as an Engaged Field of Study: ASHE Board Dialogue on its Connections to Policy and Practice

Adrianna J. Kezar/University of Southern California

Heather Eggins/Staffordshire University

Consuella Lewis/University of Pittsburgh

Joshua B. Powers/Indiana State University

Barbara K. Townsend/University of

Missouri-Columbia

Patricia Farrell/ASHE

Patricia M. Yaeger/University of Illinois at

Urbana-Champaign

A2 * Graduate Session

Clearwater

The Pressure to Publish: Demystifying the Publications Process From the Research Project to the Final Article

Discussant: Judy Marquez Kiyama/University of Rochester

Chair: Kelly R. Risbey/University of Minnesota

Liang Zhang/Vanderbilt University

Jenny Lee/The University of Arizona

Sylvia Hurtado/University of California, Los Angeles

A3 * Research and/or Scholarly Paper

City Terrace 6

Three Perspectives on Institutional Quality: Faculty, Students, and External Rankings

Discussant: Nadezhda V. Kulikova/University of Utah

Chair: Tatiana Suspitsyna/The Ohio State University

Do We Belong Here: An Exploration of Foreign-Born Faculty's Organizational Attachment at a U.S. Research University

Na Wei/Michigan State University

The Ranking of Rankings Benchmarking Higher Education Ranking Systems in Europe

Ingo Stolz/University of Minnesota

Darwin Hendel/University of Minnesota

Aaron Horn/University of Minnesota

Learning Environment - Relevant or Not to Students Decision to Leave University?

Elisabeth Hovdhaugen/Norwegian Institute for Studies in Innovation, Research & Education

A4 * Research and/or Scholarly Paper

City Terrace 12

An Analysis of Private Financial Aid Programs: Kalamazoo and Gates

Discussant: Robert Toutkoushian/Indiana University

Chair: Roger G. Gonzalez/Florida International University

The Kalamazoo Promise: A Study of Philanthropy's Increasing Role in the American Economy and Education

Shelley R. Strickland/University of Michigan

Investigating the Impact of the Kalamazoo Promise Program on the College Choice Decisions of Prospective Students

Stephen DesJardins/University of Michigan

Rodney Andrews/Harvard University

Vimal Ranchhod/University of Cape Town

Financial Aid Packages and Minority Attainment: Evidence From the Gates Millennium Scholarship Program

Tatiana Melguizo/University of Southern California

Anna Chung/Indiana University

Does Financial Aid Impact Collegiate Success?: The Effects of the Gates Millennium Scholars Program on Academic Performance and Behaviors

Angela Boatman/Harvard University

Bridget Terry Long/Harvard University

A5 * Research and/or Scholarly Paper

City Terrace 9

Student Experiences in the Community College Classroom

Discussant: Debra D. Bragg/University of Illinois

Chair: Eboni Zamani-Gallaher/Eastern Michigan University

Teaching Academically Underprepared Students at Community Colleges

Negar Farakish/Teachers College - Columbia University

Effects of Exposure to Part-Time Faculty on Community College Transfer

Audrey J. Jaeger/North Carolina State University

Kevin Eagan/University of California, Los Angeles

What Really Matters: A Hermeneutic Inquiry Exploring ELL Student Experiences in the College Classroom

JoAnn Mulready-Shick/University of Massachusetts, Boston

Tara Parker/University of Massachusetts, Boston

A6 * Research and/or Scholarly Paper
City Terrace 7

Role of Gender in Fostering Effective Leadership

Discussant: Judith Glazer-Raymo/Teachers College -
Columbia University
Chair: Theresa Survillion/Texas A&M University

Women Community College Presidents: Tenets of Effective Leadership

Monoka Venters/Florida State University
Beverly L. Bower/University of North Texas

Exploring Gender Disparities in Senior-Level Position Attainment in Higher Education: Is There a Glass Ceiling?

Elizabeth M. O'Callaghan/University of Wisconsin
Jerlando F. L. Jackson/University of Wisconsin

The Views of Deans Regarding Climate and Leadership Opportunities for Women: Insights From Academic Medicine with Application to the Larger Enterprise of Higher Education

Sharon McDade/American Council on Education
Sharon Dannels/The George Washington University

A7 * Research and/or Scholarly Paper
City Terrace 11

Exploring Fund-Raising and Friend-Raising: Alumni, Endowments, and Development

Discussant: Sheila Slaughter/University of Georgia
Chair: Ryan Beard/Texas A&M University

Endowment Reports to the Senate Committee on Finance As Reflections of Institutional Norms

David Soo/University of Pennsylvania

Exploring the Characteristics of Young Alumni Donors

Jerold Laguilles/University of Massachusetts, Amherst

Construct Validity for Measures of Alumni Support: A Confirmatory Factor Analysis

David John Weerts/University of Minnesota
Alberto F. Cabrera/University of Maryland

"More Bang For the Buck": Examining Influencers of Fundraising Efficiency and Total Dollars Raised

Eve Proper/Vanderbilt University
Timothy Caboni/Vanderbilt University
Harold V. Hartley, III/Council of Independent Colleges
Wesley Willmer/Biola University

A8 * Research and/or Scholarly Paper
City Terrace 5

Graduate Student Performance and Persistence

Discussant: Shaun R. Harper/University of Pennsylvania
Chair: Ryan Davis/University of Maryland

Understanding Persistence Through the Voices of African American Men in Doctoral Programs at Predominantly White Institutions

Ted N. Ingram/Bronx Community College

Are You Ready?: Academic Preparation and Performance in Law School

Meera Deo/University of California, Los Angeles
Maria Luisa Woodruff/University of California, Los Angeles
Walter R. Allen/University of California, Los Angeles

Doing It For Themselves: Examination of an Underrepresented Minority Graduate Student Research Team

Susan D. Johnson/Indiana University
Rachelle Winkle-Wagner/University of Nebraska
Carla Morelon-Quainoo/Dillard University
Lilia Santiago/Florida International University

A9 * Research and/or Scholarly Paper
City Terrace 8

Intersections of Identity for Latino and Latina Students

Discussant: Linda Serra Hagedorn/Iowa State University
Chair: Michelle M. Espino/The University of Arizona

Making Meaning of Mexican American Women's Activism with Self-Authorship

Ebelia Hernandez/Miami University of Ohio

Understanding Issues of College Persistence for Undocumented Mexican Immigrant Women From the New Latino Diaspora: A Case Study

Susana Maria Munoz/Iowa State University

The Connections Between Latino Ethnic Identity and Adult Experiences

Vasti Torres/Indiana University
Sylvia Martinez/Indiana University
Ebelia Hernandez/Miami University of Ohio
Christianne I. Medrano/Indiana University
Andrea Robledo/Indiana University
Lisa Wallace/Indiana University

1:00 pm - 2:30 pm

A10 * Research and/or Scholarly Paper
City Terrace 10

Environmental Facilitators of Persistence in STEM

Discussant: William T. Trent/University of Illinois at Urbana-Champaign

Chair: Noah D. Drezner/University of Maryland

The Role of Living-Learning Programs in Predicting Students: Decisions About Leaving STEM Majors

Matthew Soldner/University of Maryland
Heather Rowan-Kenyon/University of Virginia
Katalin Szelenyi/University of Massachusetts, Boston
Karen Kurotsuchi Inkelas/University of Maryland

The Role of Living-Learning Programs in Women's Plans to Attend Graduate School in STEM Fields

Katalin Szelenyi/University of Massachusetts, Boston
Karen Kurotsuchi Inkelas/University of Maryland

Facilitating Change in Undergraduate Science Instruction: Synthesis of Change Strategies Across Disciplines

Andrea Beach/Western Michigan University
Charles Henderson/Western Michigan University
R. Sam Larson/Applied Research
Noah Finkelstein/University of Colorado

A11 * Symposia
Grand 2

Higher Education and Meanings of Access: The Challenges of Definition

Philo A. Hutcheson/Georgia State University
Ralph Kidder/Marymount University
Jana Nidiffer/University of Michigan
Christine A. Ogren/University of Iowa

A12 * Symposia
City Terrace 4

Inspirational Mentorship: Toward the Development of Scholars of Color

Caroline Turner/Arizona State University
Juan Carlos Gonzalez/University of Missouri-Kansas City
Jonathan Wood/Arizona State University
Kristi Ryujin/University of Missouri-Kansas City

1:00 pm - 1:40 pm

Roundtables A1-1
St. Johns

A1

Resistance to Racial/Ethnic Dialogue: Implications for Enhancing Multicultural Competence in Graduate Preparation Programs

Joy Gaston Gayles/North Carolina State University
Bridget Turner Kelly/Seattle University

A2

Faculty Work in Multiple Places: A Case Study of Daily Practices in Material Environments

Aaron M. Kuntz/University of Alabama

A3

Paradigmatic Rationality and Higher Education Rhetoric: Toward a New Narrative

Jason Johnson/University of Wisconsin

A4

A Slice of Perception: Impact of Missouri's A+ Schools Program Goal Achievement on Higher Education Attainment

Elizabeth Ann Tankersley-Bankhead/University of Missouri-Columbia

A5

Market-Based Reform to Higher Education: An Imperative For a New Approach to College Choice Research

Julie Morgan/Boston College

A6

Searching For Astin in Afghanistan?

John Howe/Indiana University

Roundtables A1-1

Daytona

A7

How Employment Affects the Collegiate Experience: Evidence from Tobit and Simultaneous Equation Models

Fred Wanjera/Indiana University
John P. Bean/Indiana University

Concurrent Session A1-1

1:00 pm - 1:40 pm

Roundtables continued

Daytona

A8

Race, Class, and the Millennial College Student: Perspectives From Faculty of Color

Fred A. Bonner, II/Texas A&M University
Vince Lechuga/Texas A&M University

A9

Multiple Situational Cohorts to Support Dissertation Completion

Michelle Maher/University of South Carolina
Katherine E. Chaddock/University of South Carolina
Amber C. Stegelin/University of South Carolina

A10

Changing the Future: Historically Black Colleges and Universities Development of Black Ph.D.s in Science, Technology, Engineering and Mathematics

Shannon Gary/Drexel University

A11

A Case Study of Institutional Culture and the Impact of the Community College Baccalaureate Program on a Rural Community College

Jennifer Behnke/Florida State University

A12

Entrepreneurship: Theoretical Rigor or Practical Convenience?

Cecilia Rios-Aguilar/The University of Arizona
Matthew M. Mars/The University of Arizona
Shanna Autry/Florida State University

Concurrent Session A2-1

1:45 pm - 2:30 pm

Roundtables A2-1

St. Johns

A13

Funding of Biomedical Research and Faculty Careers

Georgeanna Robinson/University of Pittsburgh

Concurrent Session A2-1

16

1:45 pm - 2:30 pm

A14

A Matter of Campus Safety in Higher Education: Students Packing Books and Guns in Their Book Bags

Lonnie Booker, Jr./Texas A&M University

A15

Exploring the Campus Climate For Religious and Ideological Pluralism and Related Student Outcomes: Best Practices For a New Line of Research

Alyssa N. Bryant/North Carolina State University

A16

World Higher Education Rankings: Unintended Consequences of Higher Education Systems in Developing Countries

Lisa Garcia/University of Southern California
Douglas A. Burleson/University of Southern California

Roundtables A2-1

Daytona

A17

Mules of the Earth: The Educational Profile of Young African American Women

Crystal R. Gafford Muhammad/East Carolina University
Adrienne Dixon/The Ohio State University

A18

Connecting the High School Experience to College Success: A Call For Collaboration

Rick Jakeman/The George Washington University

A19

Higher Education Reform Policies and Their Effects on Perceptions on Academic Professionalism at Two Universities in Argentina

Gabriela Judith Silvestre/University of Pittsburgh

1:45 pm - 2:30 pm

A20

Perceptions of Inter-Campus Relations by Branch Campus and Main Campus Student Affairs Administrators in Multicampus Public Universities in Florida

Marion Merzer/Florida Atlantic University
Deborah L. Floyd/Florida Atlantic University

A21

The Definition and Measurement of Work Engagement and Job Satisfaction in a Higher Education Context

Jill Hermsen/University of Missouri-Columbia

A11

Working in a Data Mine: Exploring Doctoral Degree Completion Using Data Mining Analysis

Gayle McLaughlin/Florida State University
Robert A. Schwartz/Florida State University

Coffee Break
2:30 pm - 2:45 pm



Stop by and visit the Pearson Custom Publishing table to view and purchase the latest ASHE Reader Series.

2:45 pm - 4:15 pm

B1 * Presidential Session

Grand 2

Strategies to Achieve Equity Without Affirmative Action

Estela Bensimon/University of Southern California
Sylvia Hurtado/University of California, Los Angeles
Gregory M. Anderson/The Ford Foundation
Peter Schmidt/The Chronicle of Higher Education
& www.colorandmoney.com

B2 * Scholarly Paper

City Terrace 4

Improving Access to Higher Education Around the World

Discussant: Na Wei/Michigan State University
Chair: Laura Oliveira/University of Massachusetts, Boston
National Education Systems and College Access in Five Countries: Australia, France, Germany, United Kingdom and United States
Lijing Yang/University of Michigan

Higher Education Gender Inequity in Post-Socialist Countries: The Case of Mongolia

John C. Weidman/University of Pittsburgh
Enkhjargal Adiya/University of Pittsburgh

Creating High-Quality Educational Opportunities For High-Potential Youth: A Multinational Approach to Providing Opportunities

Catherine Millett/Educational Testing Service
Heather Corcoran/Educational Testing Service
Michael Nettles/Educational Testing Service

Different Pathways to Brazilian Universities: Comparing the Experiences of Students From Different Socioeconomic and Racial Backgrounds

Angela Jeanette Slocum/University of California, Los Angeles

B3 * Research and/or Scholarly Paper

City Terrace 6

Research: Commercialization, Expenditures, and Faculty

Discussant: Amy Scott Metcalfe/University of British Columbia
Chair: Michelle J. Nilson/Simon Fraser University

Academic Capitalism at Smaller Universities: A Study of Emergent Technology Commercialization

Joshua B. Powers/Indiana State University

Curiosity and Commercialization: Faculty Perspectives on Sponsored Research and Academic Science

Thomas E. Perorazio/University of Michigan

2:45 pm - 4:15 pm continued

B3 continued

Does Technology Commercialization in Higher Education Speed or Slow the Pace of Research Diffusion? An Investigation of a Key Tenet of the Bayh-Dole Act

Joshua B. Powers/Indiana State University
Eric Campbell/Harvard University

Faculty Employment and R&D Expenditures at Research Universities

Liang Zhang/Vanderbilt University
Ronald G. Ehrenberg/Cornell University

B4 * Scholarly Paper

City Terrace 5

Postmodern Ideas in Higher Education Research

Discussant: Mary Ziskin/University of Indiana
Chair: Gabriela Judith Silvestre/University of Pittsburgh

Neoliberalism, Hegemony, and Changes in College Students

Daniel Saunders/University of Massachusetts, Amherst

Imagining Resistance: Master Narrative and Mexican American Counter-Narrative Construction in Higher Education

Michelle M. Espino/The University of Arizona

Decolonizing Indigenous Research in Education

Stephanie Waterman/University of Rochester
Heather J. Shotton/Oklahoma City University

B5 * Research and/or Scholarly Paper

City Terrace 10

Seeking Educational Opportunity for Students of Color

Discussant: Marybeth Gasman/University of Pennsylvania
Chair: Dorothy E. Finnegan/The College of William and Mary

Unlikely Pioneers: An Analysis of the Experiences of the Earliest White Students at Historically Black Colleges and Universities

Katherine E. Chaddock/University of South Carolina
Amber C. Stegelin/University of South Carolina

Habitus, Academic Domain Identification and the Origins of College Predisposition

Julie Posselt/University of Michigan
Johanna Masse/University of Michigan
Rosemary Perez/University of Michigan

Education Is Our Only Weapon! : The Mexican American Movement in California Higher Education, 1934-1950

Christopher Tudico/University of Pennsylvania

B6 * Research and/or Scholarly Paper

City Terrace 11

Innovative Leadership Strategies

Discussant: Margaret Healy/University of North Dakota
Chair: Valerie L. Johnson/University of North Dakota

Faculty and Staff Grassroots Leaders Beliefs About Power: Do Their Beliefs Affect Their Strategies and Effectiveness?

Adrianna J. Kezar/University of Southern California

Rural Community College Leadership Development and the AACC Competencies

Pamela Eddy/The College of William and Mary
Eron Drake/Davenport University

Creating Institutional Pathways for Transformation and Change: Educating for Leadership and Social Innovation

Melissa R. Peet/University of Michigan

The Constant Gardener: The Powerful Role of Agency in Institutionalization

Tricia Bertram Gallant/University of California, San Diego

B7 * Research and/or Scholarly Paper

City Terrace 12

Student Development in an Online Environment

Discussant: John Dirks/Michigan State University
Chair: Jenny LeBeau/Washington State University

The Fronts Students Use: Facebook and the Standardization of Self-Presentations

Matt Birnbaum/The University of Arizona

Online Social Networking, College Student Identity, and Campus Culture

Ana M. Martinez-Aleman/Boston College
Katherine L. Wartman/Boston College

Interpersonal Development of Adult Online Learners Who Have Had No Face-To-Face Contact With Peers or Faculty

Natalie Lupton/Central Washington University
Richard Hoover/University of Nebraska

2:45 pm - 4:15 pm

B8 * Research and/or Scholarly Paper
City Terrace 8

Liberal Arts and Cognitive Outcomes

Discussant: Mark Engberg/Loyola University Chicago
Chair: JoNes R. VanHecke/Central College

Liberal Arts Colleges and Good Practices in Undergraduate Education: Additional Evidence

Tricia A. Seifert/University of Iowa
Ernest T. Pascarella/University of Iowa
Kathleen Goodman/University of Iowa
Mark H. Salisbury/University of Iowa
Charles Blaich/Wabash College

Enhancing Perpetual Learning: The Nexus Between a Liberal Arts Education and the Disposition Toward Lifelong Learning

Nathan K. Lindsay/University of North Carolina
Wilmington

The Impact of College Student Socialization and Socioeconomic Factors on Cognitive Outcomes

Ryan Padgett/University of Iowa
Kathleen Goodman/University of Iowa
Megan P. Johnson/University of Iowa
Kem Saichaie/University of Iowa
Paul Umbach/North Carolina State University

B9 * Research Paper

City Terrace 9

Opportunities and Challenges at International Institutions for Students

Discussant: Mohamed Nur-Awaleh, Illinois State University

Chair: Lisette Montoto, University of Georgia

Transnational Muslim College Students: Constructed by the Margins

Xyanthe Neider, Washington State University

Headscarf Ban Policy in Turkish Higher Education: Opportunities and Challenges of Part-Time Unveilers as a Result of Unveiling

Fatma Nevra Seggie, Bogazici University, Turkey

Effect of the Turkish Headscarf Ban on Turkish Covered Female Students

Fatma Nevra Seggie, Bogazici University, Turkey

B10 * Symposia

Grand 3

Advancing a Higher Education Agenda in the Midst of Competing Education Agendas and Shrinking Resources

David Tandberg/Pennsylvania Department of Education
Kathleen M. Shaw/Pennsylvania Department of Education
Michael McLendon/Vanderbilt University
Donald E. Heller/The Pennsylvania State University
Erik C. Ness/University of Pittsburgh
Karen Paulson/NCHEMS

B11 * Symposia

Clearwater

White Researchers Conducting Critical White Research

Jesse S. Watson/Michigan State University
Jennifer Loftin/Louisiana State University
Melanie J. Stivers/Southern Illinois University
David McIntosh/Texas A & M University
Robert Reason/The Pennsylvania State University
Rebecca Ropers-Huilman/University of Minnesota

B12 * Symposia

City Terrace 7

The Vanishing African American and Latino Male in Higher Education: A Critical Dialogue at a Critical Time

Victor Saenz/The University of Texas at Austin
Luis Ponjuan/University of Florida
Julian Vasquez-Hellig/The University of Texas at Austin
Richard J. Reddick/University of Texas at Austin
Sharon Fries-Britt/University of Maryland
Mark A. Lopez/University of Maryland
Wendell Diedrik Hall/University of Maryland
Ana L. Romero/Northern Arizona University
Michael Cuyjet/University of Louisville

Presidential Address

Practicing What I Teach: Does a Career as a Higher Education Professor Inform My Work as a Dean?

Linda Eisenmann, John Carroll University

4:30 pm -6:00 pm

Terrace Pavilion 2

Special Event

ASHE Welcome Reception

6:30 pm - 7:30 pm

River Terrace 1/Deck

All conference attendees are invited to attend



Coffee Breaks

Thursday: 2:30 pm

Friday: 9:30 am & 3:15 pm

Saturday: 9:30 am & 2:45 pm

8:00 am - 9:30 am

C1 * Graduate Session

City Terrace 5

Frustration or Success: Examining the Importance of Graduate Student Socialization in Higher Education

Discussant: Kelly R. Risbey/University of Minnesota
Chair: Judy Marquez Kiyama/University of Rochester

Ann E. Austin/Michigan State University
Christine M. Golde/Carnegie Foundation for the Advancement of Teaching
Carol Colbeck/University of Massachusetts, Boston

C2 * Research and/or Scholarly Paper

City Terrace 6

Intercultural Issues in Higher Education

Discussant: Darwin Hendel/University of Minnesota
Chair: Nasrin Fatima/University of New Orleans

Benefits From Interacting with International Students on Campus: Do Domestic Students Become Interculturally Competent? A Study in South Korea

Jae-Eun Jon/University of Minnesota

The Impact of Study Abroad on Senior Year Engagement

Robert Gonyea/Indiana University

International Connections in a Mexican Lengua Inglesa Program: Imagination and Academic Culture as Fuel for Agency

Blanca Minerva Torres-Olave/The University of Arizona

C3 * Research and/or Scholarly Paper

City Terrace 8

Matching State Governance Structure and Context

Discussant: Michael McLendon/Vanderbilt University
Chair: Erik C. Ness/University of Pittsburgh

Assessing the Effectiveness of Legislative Action on Academic Change: A Case Study of the North Dakota Higher Education Roundtable

Jason E. Lane/University at Albany, SUNY
Valerie L. Johnson/University of North Dakota
Steven LeMire/University of North Dakota

Understanding the Impact of Exogenous Factors on State Higher Education Governance and Coordination Structures

Christopher Morpew/University of Georgia

Theoretical Insights into State Higher Education Governance Policy

Daryl Monear/University of Washington

C4 * Research and/or Scholarly Paper

River Terrace 3

Issues in Choice, Recruitment, and Retention

Discussant: Vasti Torres/Indiana University
Chair: Frank Harris III/San Diego State University

More Than Increasing the Numbers: Latina/o Recruitment and Retention at an Emerging HSI

Erica Yamamura/Texas State University, San Marcos

For-Profit Colleges and the Students Who Choose Them: Identifying Paradoxes, Pathways, and Possibilities

Anna Chung/Indiana University
Regina J. Deil-Amen/The University of Arizona

The Relation of College Choice Factors to Satisfaction with College Among Low-Income Students of Color: A Sequential Mixed Methods Study

Terrell Strayhorn/University of Tennessee

C5 * Research and/or Scholarly Paper

City Terrace 10

Comparing Three Modes of Historical Analysis: Archival, Philosophical, and Novel

Discussant: Christian K. Anderson/University of South Carolina

Chair: Katherine E. Chaddock/University of South Carolina

The More Men Movements at Boston University and Northwestern University 1910-1915

Laura Oliveira/University of Massachusetts, Boston

Towards a Theoretical Framework for Conceptualizing the Philosophical Foundations of General Education and Liberal Education: A Historical Analysis

Nathan M. Sorber/The Pennsylvania State University

A Schema For Assessing An American College Novel as a Form of Higher Education Research

Kathryn M. Rybka/University of Illinois at Urbana-Champaign

8:00 am - 9:30 am

C6 * Research and/or Scholarly Paper
City Terrace 4

Part-Time and Contingent Faculty in Higher Education

Discussant: Roger G. Baldwin/Michigan State University
Chair: Tonya N. Saddler/Northwestern University

Off Track: The Experience of Being Full-Time Nontenure-Track in English

Genevieve Shaker/Indiana University Purdue University Indianapolis

The Effects of Part-Time Faculty Appointments on Instructional Techniques and Commitment to Teaching

Paul Umbach/North Carolina State University

Adjunct Faculty Institutional Sense of Belonging

Constance L. Merriman/Old Dominion University

Examining the Relationship Between Exposure to Part-Time Faculty and Associate's Degree Completion

Kevin Eagan/University of California, Los Angeles

C7 * Scholarly Paper
City Terrace 11

Assessing Workplace Satisfaction in the Academy

Discussant: Valerie Martin Conley/Ohio University
Chair: Lonnie Booker, Jr./Texas A&M University

An Examination of the Factors That Explain Work Engagement and Job Satisfaction of Higher Education Staff Members

Jill Hermsen/University of Missouri-Columbia
Vicki J. Rosser/University of Nevada, Las Vegas

Sustaining and Improving Program-Level Assessment Plans: An Evaluation of Commitments and Resources Utilized to Support Assessment and Factors that Effect Faculty Satisfaction with Assessment

Christopher Allen McCullough/DePaul University
Elizabeth A. Jones/West Virginia University

Organizational Politics and Faculty Governance Priorities

Janet Lawrence/University of Michigan
Molly Ott/University of Michigan

Unionization and Faculty Satisfaction: A New Look with the 2004 National Study of Postsecondary Faculty

Carrie B. Myers/Montana State University

C8 * Research and/or Scholarly Paper
City Terrace 12

The Academic Presidency: Entry, Exit, and Emergencies

Discussant: J. Fredericks Volkwein/The Pennsylvania State University
Chair: Dean C. Lefor/University of North Dakota

The Organizational Entry of a New College President: Twenty-Four Months of Socialization and Sensemaking

MaryPat Lohse/Boston College

The First Lady or the First Gent: The Power Behind the University Presidency?

Juanita Gamez Vargas/Texas A&M University

Universities in Crisis: Strategic Responses of University Presidents in Canada, the United Kingdom and the United States

Keith Walker/University of Saskatchewan

No-Confidence Votes and the Academic Presidency

Sean McKinniss/The Ohio State University

C9 * Research and/or Scholarly Paper
City Terrace 9

Perspectives on Student Outcomes

Discussant: Gary Pike/Indiana University Purdue University Indianapolis
Chair: JoAnn Mulready-Shick/University of Massachusetts, Boston

Differential Patterns of Change and Stability in Student Learning Outcomes in Holland's Academic Environments: The Role of Environmental Consistency

John Smart/University of Memphis

Institutional Departure Verses System Departure: Is There a Difference?

Matthew Stimpson/Virginia Polytechnic Institute and State University

New Evidence on the Link Between Alcohol Use and College Outcomes

Kathleen Goodman/University of Iowa
Ernest T. Pascarella/University of Iowa
Georgianna L. Martin/University of Iowa
Angela Reams/University of Iowa

8:00 am - 9:30 am

C10 * Symposia

City Terrace 7

Between Elite and Non-Elite: The Growing Semi-Elite Category in Private Higher Education

Daniel C. Levy/University at Albany, SUNY
 Joanna Demurat/University at Albany, SUNY
 Prachayani Praphamontripong/University at Albany, SUNY
 Juan Carlos Silas/Universidad de Monterrey
 William Zumeta/University of Washington

C11 * Symposia

Orlando

Regulation, De-Regulation, and the Future of Higher Education

Brian Pusser/University of Virginia
 Michael A. Olivas/University of Houston
 Sheila Slaughter/University of Georgia
 Kathleen M. Shaw/Pennsylvania Department of Education
 Kevin Kinser/University at Albany, SUNY

C12 * Symposia

Daytona

When Does (and Doesn't) 2+2 Equal Four? Examining Variations in the New Math of Transfer Access From Community Colleges to the Baccalaureate

Alicia Dowd/University of Southern California
 Debra D. Bragg/University of Illinois
 Rose Martinez/University of Texas
 Estela Bensimon/University of Southern California
 Tara Watford/University of Southern California
 Lindsey Malcom/University of California, Riverside

C13 * Symposia

St. Johns

Gender Differences in the College Experiences of African American Students

Crystal R. Gafford Muhammad/East Carolina University
 Allan Okech/East Carolina University
 Lori D. Patton/Iowa State University
 Symone Simmons/Iowa State University
 Shaun R. Harper/University of Pennsylvania
 Marybeth Gasman/University of Pennsylvania
 Rachelle Winkle-Wagner/University of Nebraska
 Nicole R. Lewis/Duke University
 Henry T. Frierson/University of North Carolina

9:45 am - 11:15 am

D1 * Presidential Session

Orlando

Theory to Practice, or Practicing Theory?: Uncovering the Explicit and Implicit Ways that College Leaders Really Use Theory

Chair: Jay R. Dee/University of Massachusetts, Boston

Caroline Turner/Arizona State University
 Judy Jackson/University of Kentucky
 Carol Colbeck/University of Massachusetts, Boston
 Vicki J. Rosser/University of Nevada, Las Vegas
 Marilyn J. Amey/Michigan State University

D2 * Research and/or Scholarly Paper

City Terrace 11

Internationalization of Higher Education

Discussant: Xyanthe Neider/Washington State University

Chair: Luciana Dar/University of California, Riverside

At the Sign Post: Mapping International Efforts in U.S. Research Universities

Adam Thomas McLean Wyatt/University of Georgia

Internationalizing Higher Education: Policy and Practice in the South African Context

Nadine Dolby/Purdue University

The International Sole of Finnish Higher Education

David M. Hoffman/University of Jyvsyk
 Jussi Valimaa/University of Jyvsyk
 Taina Saarinen/University of Jyvsyk
 Minna Sderqvist/Helsinki University of Technology

D3 * Research and/or Scholarly Paper

River Terrace 3

Challenges in Quantitative Analysis

Discussant: Paul Umbach/North Carolina State University

Chair: Vincent Novack/California State University, Long Beach

Assessing Longitudinal Change: Adjustment For Regression to the Mean Effects

Louis Rocconi/University of Memphis
 Corinna A. Ethington/University of Memphis

The Predictive Validity of a Measure of Deep Approaches to Learning

Thomas Nelson Laird/Indiana University
 Amy Garver/Indiana University
 Amanda Suniti Niskode-Dossett/Indiana University
 Julianna Banks/Indiana University

9:45 am - 11:15 am

The Problems and Opportunities Created by Hierarchical Data

John Cheslock/The University of Arizona
Cecilia Rios-Aguilar/The University of Arizona

How Sampling Matters: A Methodological Explanation for the Mixed Findings in the Area of Student Persistence

Rong Chen/Seton Hall University
Mandi Yu/University of Michigan
Scott L. Thomas/University of Georgia

D4 * Research and/or Scholarly Paper City Terrace 6

Learning From a Single-campus Study

Discussant: Philo A. Hutcheson/Georgia State University
Chair: Amy Wells/University of Mississippi

Hitting the Books, Hitting the Beach: Southern California Goes to College, 1919-1941.

William C. Purdy/University of California, Los Angeles

Unionization in Higher Education: The University of Illinois, 1919-1923

Timothy Reese Cain/University of Illinois at Urbana-Champaign

Sherman's Administration: A Historic Examination of a Northern Military Officer's Attempts at the Creation and Maintenance of a Southern University

Eric Platt/Louisiana State University

D5 * Research and/or Scholarly Paper City Terrace 10

Faculty Collaborations and Involvements on Campus

Discussant: Imanol Ordorika/Universidad de Nacional Autonoma de Mexico
Chair: James L. Bess/James L. Bess & Associates

Academic and Student Affairs Integration Through Leadership, Culture and Sensemaking: A Case Study

James Woodell/The Pennsylvania State University
India McHale/The Pennsylvania State University
Peter Moran/The Pennsylvania State University
Nathan M. Sorber/ The Pennsylvania State University

The Influence of Rank in Predicting Faculty Involvement in Service-Learning at Select Research Institutions

Leslie Parkins/University of North Carolina
Audrey J. Jaeger/North Carolina State University

Studying the Professional Lives and Work of Faculty Involved in Community Engagement

Lorilee Sandmann/University of Georgia
John Saltmarsh/University of Massachusetts, Boston
Dwight E. Giles, Jr./University of Massachusetts, Boston

Motivators and Barriers for Faculty in Academic-Student Affairs Partnership Programs

Melanie J. Guentzel/St. Cloud State University

D6 * Research and/or Scholarly Paper City Terrace 8

Intersections in the Doctoral Education Experience

Discussant: Linda DeAngelo/University of California, Los Angeles

Chair: Karen Zentner Bacig/University of Minnesota

Doctoral Advisors and Their Protoges: Does Mentoring Matter?

Laura Gail Lunsford/North Carolina State University

Where Exactly is the Intersection? The Challenge of an Interdisciplinary Doctoral Curriculum

Karri Holley/University of Alabama

Developmental Networks and Learning: An Interdisciplinary Perspective on Faculty Identity Development During Doctoral Study

Vicki L. Sweitzer/Albion College
Lisa R. Lattuca/The Pennsylvania State University

D7 * Research and/or Scholarly Paper City Terrace 12

Social Networks and Diverse Interactions

Discussant: Kimberly A. Griffin/The Pennsylvania State University

Chair: Jim Sirianni/Stanford University

The Role of Institutional Agents in the Socialization of Minority Students: Implications for Research and Practice

Samuel D. Museus/University of Massachusetts, Boston
Kathleen Neville/University of Massachusetts, Boston

Generating Ethnic Minority Success: Campus Cultures and Minority Student Access to Social Networks

Samuel D. Museus/University of Massachusetts, Boston

Contextualizing Quality and Avenues for Diverse Interactions and Friendship Groups Over Time

Fanny Yeung/University of California, Los Angeles
Casandra Elena Harper/University of Missouri-Columbia

9:45 am - 11:15 am

Black People Aren't Going to Want to Come: Student Perspectives on Black Student Participation in a Multiethnic Student Subculture

Julie Park/University of California, Los Angeles

D8 * Research and/or Scholarly Paper

City Terrace 5

Experiences and Impacts of HBCUs and Minority Serving Institutions

Discussant: V. Barbara Bush/University of North Texas

Chair: Shannon Gary/Drexel University

American Higher Education Without Public Historically Black Colleges and Universities: The Impact on Student Access

John Michael Lee, Jr./The College Board

A Structural Equation Modeling Approach to Examining the Interaction Between College Processes and Student Subgroups

Meechai Orsuwan/Central Michigan University

The Impact of Family Support For African American Males at a Historically Black University: Affirming the Revision of Tinto's Theory

Robert Terry Palmer/Morgan State University
Ryan Davis/University of Maryland

D9 * Research and/or Scholarly Paper

City Terrace 9

Epistemological and Cognitive Development

Discussant: Susan Jones/University of Maryland
Chair: Ebelia Hernandez/Miami University of Ohio

Student Development, Student Learning: Examining the Relation Between Epistemological Development and Learning

Jane Pizzolato/University of California, Los Angeles
Sherrell Tamia Hicklen/University of Pittsburgh
Elizabeth Brown/University of Pittsburgh
Prema Chaudhari/University of Pittsburgh

Cultural Selfways and Epistemological Development: The Case of Asian Students

Jane Pizzolato/University of California, Los Angeles
Prema Chaudhari/University of Pittsburgh

Does Context Matter? Exploring Epistemological Understanding of Law Students.

Rican Vue/University of California, Los Angeles
Walter R. Allen/University of California, Los Angeles

D10 * Symposia

City Terrace 7

The Governance and Management of Higher Education in "Emerging" Higher Educational Systems

William Cummings/The George Washington University
Monica Marquina/Universidad Nacional de General Sarmiento

Elizabeth Balbachevsky/Universidade di Sao Paulo
Hong Shen/Huazhong University of Science & Technology
Gerard Postiglione/University of Hong Kong
Jesus F. Galaz-Fontes/Universidad Autonoma de Baja California

Manuel Graca/Fundacao das Universidades Portuguesas
Norberto Fernandez Lamarra/Universidad Nacional de Tres de Febrero

Norzairi Azman/National Higher Education Research Institute

Li-fang Zhang/University of Hong Kong

D11 * Symposia

City Terrace 4

An Antidote to Blue Yondering: Using State Databases to Connect Research to Policy

Jan M. Ignash/University of South Florida
Debra D. Bragg/University of Illinois
Lynne Curry/Illinois State University
Hans L'Orange/State Higher Education Executive Officers

D12 * Symposia

St. Johns

Prisms on Women's Leadership: Research Providing Perspectives on the Past, Present, and Future For Women in Higher Education

Beverly L. Bower/University of North Texas
Allison H. Crume/Florida State University
Angela Hernquist/University of Nevada, Las Vegas
Mimi Wolverton/Retired
Deborah L. Floyd/Florida Atlantic University

D13 * Symposia

Daytona

From College Choice to the Doctoral Experience: Implications and Considerations For Navigating the Latina/o Educational Pipeline

Julie Lopez Figueroa/California State University, Sacramento

Patricia Perez/California State University, Fullerton
Miguel Ceja/California State University, Northridge
Michelle M. Espino/The University of Arizona
Robert T. Teranishi/New York University

Awards Luncheon

11:30 am - 1:00 pm
Grand Ballrooms 5-8

This Awards Luncheon has been made possible with the generous support of:
National Survey Student Engagement at the Center for Postsecondary Research, Indiana University
Center for the Study of Higher Education, The Pennsylvania State University

Concurrent Session E-Posters

1:00 pm - 2:00 pm

Ballroom Foyer 5-8

1 - Major Challenges that Chinese Graduate Students Have Encountered in the Process of Their Academic and Social Integration into U.S. Universities

Xiaolan Li/University of California, Los Angeles

2 - An Analysis of the Return to Higher Education in Korea: Which is the Most Important Factor Among Year of Schooling, College Quality, and Major?

Heesook Lee/Florida State University
Jaeyoung Chung/Korean Ministry of Education, Science and Technology

3 - Factors That Predict International Doctorates' Intention to Stay in U.S.

Dongbin Kim/National Association of Independent Colleges

Charles A.S. Bankart/University of Kansas
Laura Burrows/University of Kansas

4- The Creation of External Quality Assurance Systems in Japanese Higher Education: Policy Borrowing From the UK and the US

Hirosuke Honda/University at Albany, SUNY

5 - An International Examination of the Student Affairs Profession

Jennifer Behnke/Florida State University

6 - Diversification or Homogenization in Higher Education: A Global Allomorphism Perspective

Qiang Zha/York University

7 - Letting the Agenda For Change: State Merit Aid and Public Policy Agenda Setting in Public Higher Education

John R. Standard/University of Massachusetts, Boston

8 - Basic Conditions in the Market for Higher Education and the Tuition-Setting Process: A Principal-Agent Perspective

Jacob T. Fowles/University of Kentucky

9 - State Adoption of Undocumented Student Tuition Policy: An Event History Analysis

Brian Sponsler/The George Washington University

10 - Revisiting Breneman & Haarlow: The Cost of Developmental Education in Texas

Joshua Pretlow/University of Virginia
Brian Pusser/University of Virginia

11 - The Role of Hispanic Serving Institutions in Closing the Gaps of Latino Doctoral Attainment

Emily Calderon Galdeano/University of Texas - Pan American

12 - Reauthorizing the Higher Education Act: How For-Profit Higher Education Influences Federal Policy

Brittney McCarthy/University of Minnesota

13 - College Novels in the Twenty-First Century

Christian K. Anderson/University of South Carolina
Kyle Mallinak/University of South Carolina

14 - A Conceptual Model of Campus Influences on Community College Student Engagement

Pam Schuetz/Northwestern University

15 - Awash in Tragedy: Hurricane Katrina and Its Impact on American Higher Education

Robert Detwiler/University of Toledo

16 - No African American Male Left Behind

John Hamilton/California State University, Long Beach

17 - Mutual Benefits: Examining Who Benefits From the Mentoring Relationships Between Faculty Members and Doctoral Students

Tonya N. Saddler/Northwestern University

18 - Using Research to Support An Institutional Gender Equity Initiative

Jill Hermsen/University of Missouri-Columbia
Jeni L. Hart/University of Missouri-Columbia

19- Faculty Transitioning Into Retirement

Seth Fishman/The Ohio State University

1:00 pm - 2:00 pm

20 - A Policy Approach to Reducing the Dependence on Part-Time Faculty in Institutions of Higher Education

Rubini Pasupathy/Texas Tech University

21 - Dual-Career Couples' Lifestyle Influences on Academic Career Development

Karen Baker/Morehead State

22- Testing the Factorial Invariance of the Black Racial Identity Scale Across Gender

Joe Lott, II/University of Washington

23 - Identifying Connections Within the Literature on STEM Instructional Change Using an Historiographic Approach

Andrea Beach/Western Michigan University

Charles Henderson/Western Michigan University

24 - Exploring Respondent Issues in the Collection of Ethnic/Race Demographics in Survey Assessment

Lawrence J. Mrozek/Wright State University

25 - Motivational Influences in Distance Education: The Role of Computer Self-Efficacy

Chih-Yuan Sun/University of Southern California

26 - A Rubric for Assessing and Stimulating Quality in Effective Online Threaded Discussions

Jessica Hale/Washtenaw Community College

27 - What's on the Faculty Senate Agenda? Why?

Christian K. Anderson/University of South Carolina

Amber C. Stegelin/University of South Carolina

28 - Dr. Jekyll and Mr. Hyde in the Academy: A Case Study of Hybrid Organizational Identity Interactions in a Division I Intercollegiate Athletic Department

Troy Buer/University of Virginia

29 - High Achieving Academic Women: Navigating Multiple Environments

Monica Marcelis-Fochtman/Michigan State University

30 - Emergency Operations Strategies: Structure and Process of Campus Crisis Response in Higher Education

Ryan Akers/Mississippi State University

31 - Can't Get No Satisfaction: Contingent Faculty in Higher Education

Maura J Murphy/North Carolina State University

32 - Assessing the Condition of Community College Student Learning Outcomes Using the Bellwether College Survey Instrument

Dale Campbell/University of Florida

Syraj Syed/University of Florida

Phillip Morris/University of Florida

33 - Women Who Shaped Tougaloo College From 1869 to 1979 and Influenced Leaders in Education

Edwina Harris Hamby/Jackson State University

Walter Brown/Jackson State University

34 - Peering Through the Kaleidoscope: An Examination of Tufts University's Innovative Approach to Undergraduate Admissions and Affirmative Action (A Work in Progress)

Julie Vultaggio/University of Pennsylvania

35 - Underrepresented Racial Minority Students and PhD Aspirations: How the Undergraduate Institution a Student Attends Matters

Linda DeAngelo/University of California, Los Angeles

36- An Uphill Climb: Student Perspectives on Careers and Career Pathways in the Computational Sciences

Amy Wells/University of Mississippi

Deborah L. Worley/University of Mississippi

37 - Antecedents of Developmental/Remedial Mathematics Course Taking in Minnesota Public Post-Secondary Institutions

Geoffrey Maruyama/University of Minnesota

Craig Schoenecker/Minnesota State Colleges and Universities

Mark Davison/University of Minnesota

Mayuko Kanada/University of Minnesota

John Kellogg/University of Minnesota

Leslie Mercer/Minnesota State Colleges and Universities

38 - Is It Really a "Man's World"? Reconsidering African American Men in Science, Technology, Engineering, and Mathematics at HBCUs

Valerie Lundy-Wagner/University of Pennsylvania

39 - The Effects of Friendship Group Diversity and Heterophily on Student Outcomes

Jim Sirianni/Stanford University

40 - Measuring Student Satisfaction and Persistence in a Community College Learning Community

Jason L. Taylor/University of Illinois at Urbana-Champaign

1:00 pm - 2:00 pm

41 - Commuter Student Self-Efficacy for Leadership: A Within-Group Analysis

John P. Dugan/Loyola University Chicago
Anna Gasiorski/Ohio Learning Network

42 - Assessing the U.S. News and World Report College Rankings Using a Structural Equation Modeling Approach: Do the Measures Used in the Ranking Predict College Outcomes?

Jessica Sharkness/University of California, Los Angeles

43 - Senior Women's Perspectives on an Undergraduate Computer Science Major: A Comparative Case Study

Amanda O'Connor/University of Washington

44 - Graduate Student Orientation Needs Assessment

Mary Hall/University of Virginia

45 - The Transfer Student Experience by Gender, Race, and Participation in a Transfer Assistance Program

Cassandra Elena Harper/University of Missouri-Columbia
Jennifer Keup/University of South Carolina

46 - The Effects of Gender on Moral Development in the First Year of College

Ashley Asel/University of Iowa
Sherri I. Edvalson/University of Iowa

47 - What's the Point? Exploring How Students Conceptualize and Operationalize Motivation in a Pass/Fail, One-Credit, Transition-Focused First-Year Seminar

Jody E. Jessup-Anger/Michigan State University

48 - In Their Own Voices: How Curricular Diversity Affects First-Generation Latina/o Students Engagement in College

Anne-Marie Nunez/University of Texas at San Antonio

49 - Pathways to the Baccalaureate Degree for Non-Traditional Students in Philadelphia

Erin J. Walsh/University of Pennsylvania
Patricia Williams/University of Pennsylvania

50 - Preparing Underrepresented Students of Color for Doctoral Success: The Role of Undergraduate Institutions

Valerie Lundy-Wagner/University of Pennsylvania
Julie Vultaggio/University of Pennsylvania
Marybeth Gasman/University of Pennsylvania

51 - In Reflection: The Lived Experiences of Black Gay Men with an Undergraduate Degree from a Historically Black College or University

Obie Ford III/Columbus State Community College

52 - Discerning Differences in Pre-College Information, Student Perception and Interactions with UT Austin: A Comparison of Survey Responses from UT Freshmen & Admitted, Non-Enrolled Students

Gregory Vincent/The University of Texas at Austin
Rose Martinez/University of Texas at Austin
Sarah Kiersten Ferguson/The University of Texas at Austin

53 - Examining and Transferring Promising Practices in California Community Colleges

John Levin/University of California, Riverside
Elizabeth Cox/University of California, Riverside
Christine Cerven/University of California, Riverside
Yueh-ching Chang/University of California, Riverside

Concurrent Session F

2:00 pm - 3:15 pm

F1 * Presidential Session

Orlando

Is it Double Dipping or Not?: The Ethics of Presenting and Publishing in Higher Education

Marybeth Gasman/University of Pennsylvania
Jeffrey F. Milem/The University of Arizona
Kristen Renn/Michigan State University

F2 * Research and/or Scholarly Paper
City Terrace 11

Issues in Asian Higher Education

Discussant: Marc Cutright/University of North Texas
Chair: Nadezhda V. Kulikova/University of Utah

Brain Gain? U.S. Doctoral Recipients Returning to South Korea

Jenny Lee/The University of Arizona
Dongbin Kim/National Association of Independent Colleges

Higher Education Reform in Japan: Changing the Kouza-System and Its Effects on the Preparation of the Professoriate

Luise McCarty/Indiana University

Fiscal Constraint and the Incorporation of National Universities in Japan: Some Lessons Learned Before the End of the First Management Term 2004-09

Kensuke Mizuta/Center for National University Finance and Management
Takeshi Yanagiura/Tennessee Higher Education Comm.

2:00 pm - 3:15 pm

F3 * Research and/or Scholarly Paper
St. Johns

State Appropriations: Fluctuations, Inequities, and Outcomes

Discussant: John Cheslock/The University of Arizona
Chair: Donald E. Heller/The Pennsylvania State University

The Effectiveness of State Appropriations and Financial Aid on Improving Access to Higher Education

Robert Toutkoushian/Indiana University
Nicholas Hillman/Indiana University

Politics, Identities, and Inequities in State Support for Higher Education in New England States

David John Weerts/University of Minnesota

A Balance Wheel For State Budgets: Higher Education

Jennifer A. Delaney/University of Wisconsin - Madison
William Doyle/Vanderbilt University

F4 * Research and/or Scholarly Paper
City Terrace 6

Can We Talk Here?: Presidential Discourse, Political Polarization, and the Media

Discussant: Karen Paulson/NCHEMS
Chair: Ontario Sherrod Wooden/Albany State University

Presidential Discourses on Higher Education and the Struggle for Equal Opportunity, 1964-1984

Julie Posselt/University of Michigan

The Political Dynamics of Higher Education Spending Decisions: Ideology and Political Polarization in the State of California

Luciana Dar/University of California, Riverside

A Critical Race Content Analysis of Responses to Proposition 209 and the Abolishment of Affirmative Action via the UCLA Daily Bruin

Natasha Croom/Iowa State University
Corey Rumann/Iowa State University

F5 * Research and/or Scholarly Paper
City Terrace 7

Methodological Challenges in Higher Education Research

Discussant: Brian Pusser/University of Virginia
Chair: Penny Pasque/University of Oklahoma

Response Rates in Higher Education Research: Why Does It Feel Like Pulling Teeth?

Matthew A. Holsapple/University of Michigan
Eric Dey/University of Michigan
Cassie L. Barnhardt/University of Michigan
Mary Edna Antonaros/University of Michigan
Karen Moronski/University of Michigan
Veronica Vergoth/University of Michigan

Qualitative Data Analysis: Comparing Results From Constant Comparative and Computer Software Methods

Jim Vander Putten/University of Arkansas at Little Rock
Amanda Nolen/University of Arkansas at Little Rock

Framing and Decoding Race-Conscious Affirmative Action Policy in Higher Education

Maria Ledesma/University of California, Berkeley

F6 * Research and/or Scholarly Paper
City Terrace 4

Faculty Scholarship: Prestige and Rewards

Discussant: Dorothy E. Finnegan/The College of William and Mary
Chair: Jaime Lester/George Mason University

The Extent of Community College Faculty Scholarship in 1993 and 2004

Barbara K. Townsend/University of Missouri-Columbia
Vicki J. Rosser/University of Nevada, Las Vegas

An Analysis of Faculty Reward Policies For Engaged Scholarship at Carnegie-Classified Community Engaged Institutions

Dwight E. Giles, Jr./University of Massachusetts, Boston
John Saltmarsh/University of Massachusetts, Boston

Higher Education Journal Prestige

Nathaniel J. Bray/University of Alabama
Claire Major/University of Alabama

F7 * Research and/or Scholarly Paper
City Terrace 8

Faculty Members Mentoring Students

Discussant: Jay R. Dee/University of Massachusetts, Boston
Chair: Marquerite McLellan/Salem State College

The Influences of Faculty on Undergraduate Student Participation in Research Activities

Shouping Hu/Florida State University
Kathyrine Scheuch/Florida Department of Education
Joy Gaston Gayles/North Carolina State University

2:00 pm - 3:15 pm

F7 * Research continued

A Closer Look: The Dynamics of the Doctoral Student-Faculty Advising Relationship

Ellen Bara Stolzenberg/University of California, Los Angeles

Learning to Mentor: A Mixed Methods Study of the Nature and Influence of Black Professors Training to Fulfill Their Role as Mentors and Advisors

Kimberly A. Griffin/The Pennsylvania State University

F8 * Research and/or Scholarly Paper City Terrace 5

Assessing Student Learning & Development Outcomes

Discussant: Karen Kurotsuchi Inkelas/University of Maryland

Chair: Heather Rowan-Kenyon/University of Virginia

Validation of the NSSE Benchmarks Against Liberal Arts Outcomes

Ernest T. Pascarella/University of Iowa

Tricia A. Seifert/University of Iowa

Charles Blaich/Wabash College

Constructing Connections: A Qualitative Study of Integration of Learning Among First-Year College Students

James P. Barber/University of Michigan

Can First-Year College Students Provide Accurate Self-Reports About Their Learning and Development?

Nick Bowman/University of Notre Dame

F9 * Research and/or Scholarly Paper City Terrace 12

Pedagogical Practices and Student Learning

Discussant: Leonard Baird/The Ohio State University

Chair: Steven Hubbard/New York University

The Impact of Faculty Teaching Practices on the Development of Students' Critical Thinking Skills

Woo-jeong Shim/University of Michigan

Kelley K. Walczak/University of Michigan

Developmental Education: Linking Student Learning and Faculty Instruction

Robin Capt/West Texas A&M University

The Engaged Learning Index: Implications for Faculty Development

Laurie A. Schreiner/Azusa Pacific University

Michelle Louis/Azusa Pacific University

F10 * Research and/or Scholarly Paper

City Terrace 9

Executive Leaders and Strategic Change

Discussant: Christopher Morphew/University of Georgia

Chair: Joanna Demurat/University at Albany, SUNY

The Effects of Monopsony on Strategic Planning in Colleges

Michael S. Cooke/George Brown College

Boards of Trustees in the Face of Institutional Mission Change in Public Higher Education: Cheerleaders or Something Beyond?

Cai Lun Jia/University of Utah

Amy Aldous Bergerson/University of Utah

College and University Executive Leadership: The Impact of Demography on the Propensity for Strategic Change

Mark Fincher/University of Arkansas at Little Rock

F11 * Research and/or Scholarly Paper

City Terrace 10

Sexual Diversity in Gendered Environments

Discussant: Patrick Dilley/Southern Illinois University

Chair: Faye Lesht/University of Illinois at Urbana-Champaign

The Experiences of Gay Male Undergraduate Students at a Traditional Women's College

Christopher J. Holland/Brevard College

Karri Holley/University of Alabama

The Paradox of Homophobia and Male Bonding: A Qualitative Study of College Men and Masculinities

Frank Harris III/San Diego State University

Shaun R. Harper/University of Pennsylvania

2:00 pm - 3:15 pm

F12 * Research and/or Scholarly Paper
Daytona

Underrepresented Students and STEM

Discussant: Deborah Carter/University of Michigan
Chair: Robert Terry Palmer/Morgan State University

Examining the Academic Success and Educational Satisfaction of Female and Male Minority Students in STEM Majors

Darnell Cole/University of Southern California
Araceli Espinoza/University of Southern California

Factors Affecting the Success of African American Male Graduate Students in STEM and Education: A Sequential Mixed Methods Approach

Terrell Strayhorn/University of Tennessee
Michael Cuyjet/University of Louisville

Underrepresented Students Entering STEM Fields

Gregory Kienzl/University of Illinois at Urbana-Champaign
Casey E. George-Jackson/University of Illinois at Urbana-Champaign

William T. Trent/University of Illinois at Urbana-Champaign

Coffee Break

3:15 pm - 3:30 pm



Concurrent Session G

3:30 pm - 4:15 pm

G1 * Presidential Session

City Terrace 4

Writing Research that Connects to Practice

Chair: Vince Lechuga/Texas A&M University

Alicia Dowd/University of Southern California
Kathleen M. Shaw/Pennsylvania Department of Education
Roger G. Baldwin/Michigan State University
Vasti Torres/Indiana University

G2 * Research and/or Scholarly Paper
City Terrace 9

Modeling Time in the Study of Enrollment and Attainment

Discussant: Stephen DesJardins/University of Michigan
Chair: Philip Trostel/University of Maine

Promoting or Perturbing Access: An Event History Analysis of the Effects of Financial Aid on Latino Students Educational Attainment

Jacob P.K. Gross/Indiana University

The Racial/Ethnic and SES Differences in the Timing of Postsecondary Education Enrollment: An Event History Analysis Approach

Pedro Villarreal III/The George Washington University

G3 * Research and/or Scholarly Paper
City Terrace 12

Research on Rules, Laws, and Regulations

Discussant: Crystal R. Gafford Muhammad/East Carolina University

Chair: David Tandberg/Pennsylvania Department of Education

Neoliberalism in the Spellings Report: A Language-In-Use Discourse Analysis

Willis Jones/Vanderbilt University

Higher Education as Commodity and Civic Learning: An Analysis of the U.S. Department of Education Discourse

Tatiana Suspitsyna/The Ohio State University

Ten Years After Managed Professionals: Who Owns Intellectual Property Now?

Michael Klein/New York University

G4 * Research and/or Scholarly Paper
City Terrace 11

Spirituality and Faculty Work

Discussant: Ann E. Austin/Michigan State University
Chair: Cheryl Daly/Western Carolina University

The Role of Spirituality Among Faculty of Color Teaching for Social Justice

Riyad Shahjahan/Iowa State University

The Engaged Intellectual as Defined Through an Ethic of Care

Cecilia Sam/University of Southern California

3:30 pm - 4:15 pm

Finding Congruence, Finding Meaning: The Intersection of Personal and Institutional Values Among Faculty and Staff at a Religious College

Alyssa N. Bryant/North Carolina State University
Christy D. Moran/Kansas State University

G5 * Research and/or Scholarly Paper
City Terrace 8

Fostering Change Through Institutional Policies and Practices

Discussant: Mari Luna De La Rosa/Azusa Pacific University
Chair: Rosie Banda/Texas A&M University

Institutional Priority and Minority Enrollment at Christian Institutions

Kristin Paredes Collins/Azusa Pacific University

Institutional Factors that Contribute to Student Persistence: Views from Three Campuses

Mary Ziskin/University of Indiana
John Moore/Indiana University
Don Hossler/Indiana University
Phoebe Wakhungu/Indiana University

Service Quality Performance and the Impact on Behavioral Intentions

James Bartlett/North Carolina State University
Michelle Bartlett/Clemson University
Marcia Kiessling/North Carolina State University

G6 * Research and/or Scholarly Paper
City Terrace 6

New Directions in Cognitive and Psychosocial Developmental Theories

Discussant: Nancy Evans/Iowa State University
Chair: Christianne I. Medrano/Indiana University

A Multi-Institutional Assessment of Moral Reasoning Development Among First-Year Students

Matt Mayhew/New York University
Tricia A. Seifert/University of Iowa

Undergraduate Students' Descriptions of Their Intercultural Maturity Development

Kelly Merrill/University of Hawaii at Manoa
Patricia M. King/University of Michigan

Negotiating Class Boundaries: Class Status and the Identity Development of College Students

Christian Steinmetz/University of Virginia

3:30 pm - 4:45 pm

G7 * Research and/or Scholarly Paper
City Terrace 7

Climates and Cultures of Community Colleges

Discussant: Debra D. Bragg/University of Illinois
Chair: Jody E. Jessup-Anger/Michigan State University

Making Sense of College Life: Examining the Relationship Between Organizational Culture, College Identity, and Student Accommodation at the Community College of Denver

Virginia Montero Hernandez/University of California, Riverside
John Levin/University of California, Riverside

Reasons Students Return to College After a Period of Nonenrollment: Reflections of Returnees at a Community College

C. Casey Ozaki/Michigan State University

The Effects of Racial Representation on Persistence Among Two-Year College Students: A Structural Model

Samuel D. Museus/University of Massachusetts, Boston
Thomas E. Robinson/University of Massachusetts, Boston
Uma Jayakumar/University of California, Los Angeles

G8 * Research and/or Scholarly Paper
City Terrace 5

Enduring Women's Experiences in Higher Education

Discussant: Rachelle Winkle-Wagner/University of Nebraska
Chair: Peggy Delmas/University of South Alabama

College Women's Female Friendships: A Longitudinal View

Ana M. Martinez-Aleman/Boston College

Women of Color Leaders: The Role of Race and Leadership in Community College Transfer Readiness

Dimpal Jain/University of California, Los Angeles

Experiences of Adult Women Students: Transformative Learning in Her Own Words

Deborah Faust/University of Denver
Danielle Ferioli Sulick/University of Denver
Lynn M. Gangone/University of Denver

3:30 pm - 4:45 pm

G9 * Research and/or Scholarly Paper
City Terrace 10

Socialization in Doctoral Education

Discussant: Pilar Mendoza/University of Florida
Chair: Melissa McDaniels/Michigan State University

Contrasting the Socialization Experiences of Doctoral Students in High- and Low-Completing Departments: A Qualitative Analysis of Disciplinary and Institutional Contexts

Susan K. Gardner/University of Maine

The Socialization Processes of Asian American Doctoral Students at a Research I Institution

Jessica K. Kim/University of Pennsylvania

Characteristics That Matter Most: Doctoral Students Perceptions of Positive and Negative Advisor Attributes

Benita J. Barnes/University of Massachusetts, Amherst
Elizabeth A. Williams/University of Massachusetts, Amherst
Shuli Arieh Archer/University of Massachusetts, Amherst

G10 * Symposia

St. Johns

Beyond Access to Space: Creating a Culturally Inclusive Place at Predominately White Institutions

William T. Trent/University of Illinois at Urbana-Champaign
Lorenzo Baber/University of Illinois at Urbana-Champaign
Stephen John Quaye/University of Maryland
Adele Lozano/University of Illinois at Urbana-Champaign
Erin Castro-Saia/University of Illinois at Urbana-Champaign

G11 * Symposia
Orlando

Perspectives on the State and Future of Engagement in Higher Education: A Critical and Committed View

Audrey J. Jaeger/North Carolina State University
KerryAnn O'Meara/University of Maryland
Penny Pasque/University of Oklahoma
Matthew Hartley/University of Pennsylvania
David John Weerts/University of Minnesota
Courtney Thornton/University of North Carolina
Leslie Parkins/University of North Carolina

G12 * Symposia
Daytona

If You Support Them, They Will Come (and Persist AND Graduate)

Carla Morelon-Quainoo/Dillard University
Lilia Santiago/Florida International University
Oiyen Poon/University of California, Los Angeles
Juan Carlos Gonzalez/University of Missouri-Kansas City
Franklin Tuitt/University of Denver
Mary Howard-Hamilton/Indiana State University

Keynote - November 7, 5:00 pm - 6:30 pm
Terrace Pavilion 2

*Preparing Leaders for Colleges and Universities:
the View from Search Firms*

Moderator: Sharon McDade, The George Washington University
Jean Dowdall, Vice President, Witt/Kieffer
Ted Marchese, Academic Search, Inc.
Narcisa A. Polonio, AACT – Education, Research and Board
Leadership Services

8:00 am - 9:45 am

H1 * Research and/or Scholarly Paper
City Terrace 11

When Do You Buy?: How Students Respond to Tuition and Loans

Discussant: Glenda Droogsma Musoba/Florida International University
Chair: Rong Chen/Seton Hall University

Student Price Response Under Changing Admission Policy: Analyzing Access for Low-Income and Minority Students to the University of California Pre- and Post-Proposition 209

Ray Franke/University of California, Los Angeles

Before the Dream Acts: In-District Resident Tuition Policies in the Dallas and Houston Community College Districts

Stella M. Flores/Vanderbilt University

Social Trust and Loan Aversion: Class-Based Perceptions of Risk in the Financing of a College Education

Shannon Calderone/University of California, Los Angeles
Patricia McDonough/University of California, Los Angeles

H2 * Research and/or Scholarly Paper
Clearwater

Multiple Approaches to Research in College Athletics

Discussant: Michael S. Harris/University of Alabama
Chair: Anne M. DeFelippo/Salem State College

Huddle-Up: A Qualitative Approach to Understanding the Impact of Intercollegiate Athletic Participation on the Academic Socialization of Male Revenue-Generating Student-Athletes

Dennis Kramer II/University of Georgia

Student Athlete Retention: Are Athletic Scholarships Enough?

Eric Archer/Oklahoma State University
Jesse Mendez/Oklahoma State University
Pilar Mendoza/University of Florida

Higher Education Research of Intercollegiate Athletics: A Missed Opportunity

Scott R. Hirko/Michigan State University

Extra, Extra, Read All About It!: The Influence of Football and the Media on Enrollment at Pennsylvania State College, 1890-1905

Jordan R. Humphrey/The Pennsylvania State University

H3 * Research and/or Scholarly Paper
City Terrace 6

Intercultural/Global Perspectives of Students

Discussant: Katalin Szelenyi/University of Massachusetts, Boston
Chair: Matthew Soldner/University of Maryland

Assessing Individuals Global Perspectives Using the Global Perspectives Inventory (GPI)

Kelly Merrill/University of Hawaii at Manoa
Larry A. Braskamp/Loyola University Chicago
David Braskamp/Chicago Public Schools

Self-Authorship As a Learning Outcome of Study Abroad: Towards a New Approach For Examining Learning and Learning Conditions

Fang Du/University of Minnesota Morris

Learning Through Cross-Cultural Interactions: A Developmental Perspective on U.S. and International Students

XinQuan Jiang/University of Michigan
Marie Kendall Brown/University of Michigan

H4 * Research and/or Scholarly Paper
City Terrace 7

Developing Inclusive Dialogues Around Diversity

Discussant: Erica Yamamura/Texas State University, San Marcos
Chair: Kathleen Neville/University of Massachusetts, Boston

Crossing Borders: Bringing Latina/o Students and Professors to the Same Side of the River

Amanda Norton/University of Denver

Understanding the Diversity Inclusivity of College Courses

Thomas Nelson Laird/Indiana University

Doing One's Own Work: The Role of Self in Facilitating Dialogues About Racial Realities

Stephen John Quaye/University of Maryland

Reflecting on Pedagogy, Privilege, and Perceptions of Self: White Faculty Facilitating Dialogues About Racial Realities

Stephen John Quaye/University of Maryland

8:00 am - 9:45 am

H5 * Research and/or Scholarly Paper City Terrace 5

Divergent Pathways to College

Discussant: MaryBeth Walpole/Rowan University
Chair: Shaila D. Mulholland/New York University

Post-High School Paths of Different Racial/Ethnic Youth: A Hierarchical Linear Approach

Leticia Oseguera/University of California, Irvine
Eduardo Mosqueda/University of California, Santa Cruz

Academic Achievement in the First Year of College: Evidence of the Pervasive Effects of the High School Context

Gregory C. Wolniak/University of Chicago
Mark Engberg/Loyola University Chicago

A Comparison of Levels of Academic Engagement of Native Freshmen vs. Transfer Students at the University of California

Greg Dubrow/University of California, Berkeley

The Real Story: Validity in Longitudinal Studies of College Access

Karen Arnold/Boston College
Katherine L. Wartman/Boston College
Benjamin Castleman/Harvard University
Percy Napier/Boston College
Shezwee Fleming/Big Picture Company
Mario DeAnda/Big Picture Company

H6 * Research and/or Scholarly Paper City Terrace 8

Access Issues in Graduate Education

Discussant: Karri Holley/University of Alabama
Chair: Amanda Suniti Niskode-Dossett/Indiana University

Embracing the Connection Between Signals and Strategies: Envisioning New Theory and Practice of Recruiting Graduate Students of Color

Franklin Tuitt/University of Denver
Rahul Choudaha/University of Denver
Stephanie L. Krusemark/University of Denver

Moving on Up: Examining First-Generation Doctoral Students Decision to Pursue the Doctorate

Carmen McCallum/University of Michigan

Time-Sensitive Access: Understanding the Aspirations and Experiences of Chicana Transfer Students Through the Graduate School Choice Process

Martha A. Rivas/University of California, Los Angeles

H7 * Research and/or Scholarly Paper City Terrace 10

Effects of Participation in Learning Communities

Discussant: Matthew Wawrzynski/Michigan State University
Chair: Bradley E. Cox/The Pennsylvania State University

Learning Communities: Who Benefits and Do Integrative Activities Matter?

Jillian L. Kinzie/Indiana University
Shimon Sarraf/Indiana University

Direct, Indirect, and Contingent Relationships Between Learning Community Participation and Educational Outcomes

Gary Pike/Indiana University Purdue University Indianapolis
George D. Kuh/Indiana University
Alexander McCormick/Indiana University

The Effect of Developmental Education Learning Communities on Academic Involvement at Two- and Four-Year Institutions: A Multilevel Model Approach

Rachel A. Smith/Syracuse University

H8 * Symposia City Terrace 12

The Governance and Management of Higher Education in Mature Higher Educational Systems

William Cummings/The George Washington University
Amy Scott Metcalfe/University of British Columbia
Donald Fisher/The University of British Columbia
Akira Arimoto/Hijiyama University
Futao Huang/Hiroshima University
J.C. Shin/Seoul National University
William David Locke/Open University
Martin J. Finkelstein/Seton Hall University

H9 * Symposia City Terrace 4

Expressions of Community Engagement: The Role of Institutional Type

Tami L. Moore/Washington State University
Kelly Ward/Washington State University
KerryAnn O'Meara/University of Maryland
Alan H. Bloomgarden/Mount Holyoke College
Matthew Hartley/University of Pennsylvania
Christian K. Wuthrich/Washington State University
Elizabeth Niehaus/University of Maryland

8:00 am - 9:45 am

H10 * Symposia
Orlando

Researching the Realities of Race on Campus: Constructing An Agenda to Explore Racialized Trends and Outcomes Among Students

Shaun R. Harper/University of Pennsylvania
Lori D. Patton/Iowa State University
Mitchell James Chang/University of California, Los Angeles
Frank Harris III/San Diego State University
Tara Parker/University of Massachusetts, Boston
Estela Bensimon/University of Southern California

H11 * Symposia
City Terrace 9

Higher Education Working Together to Advance Students Personal and Social Responsibility

Eric Dey/University of Michigan
Mary Edna Antonaros/University of Michigan
Cassie L. Barnhardt/University of Michigan
Matthew A. Holsapple/University of Michigan
Karen Moronski/University of Michigan
Veronica Vergoth/University of Michigan

Keynote - Saturday, 9:45 am - 11:15 am

Terrace Pavilion 2

*College Presidents and Higher Education Research:
Do Our Studies Matter to Practice?*

Introduction: Jay R. Dee, University of Massachusetts, Boston

Moderator: Caroline Sotello Viernes Turner,
Arizona State University

Mildred Garcia, President, California State University,
Dominguez Hills

Colleen Hester, President, MacMurray College

Bernard Harleston, Former President, City College of New York



sas | THE POWER TO KNOW.

SAS® Global Academic Program
SAS partners with universities and professors to develop the next generation of analytically skilled students.

SAS offers:

- Curriculum consulting and teaching materials.
- Academic discounts on training, software, and books.
- Specialized data mining training and mini grants for professors.
- Certificate programs.
- A variety of student programs.
- SAS® Global Certification Program.

For more information e-mail training@sas.com or visit support.sas.com/heconsulting

SAS and all other SAS Institute Inc. product or service names are registered trademarks or trademarks of SAS Institute Inc. in the USA and other countries. ® indicates USA registration. Other brand and product names are trademarks of their respective companies. Copyright © 2014, SAS Institute Inc. All rights reserved. SAS114324EN

11:30 am - 1:00 pm

I1 * Presidential Session

City Terrace 7

The Research World beyond Higher Education Programs

Chair: Karen Kurotsuchi Inkelas/University of Maryland

Mark Smith/National Education Association

Karen Paulson/NCHEMS

Kenneth Redd/National Association of College and University Business Officers

John B. Lee/JBL Associates

Jeanne Miller/University of Michigan

I2 * Graduate Session

City Terrace 4

Establishing Yourself as a Professional Within the Field of Higher Education

Discussant: Kelly R. Risbey/University of Minnesota

Chair: Judy Marquez Kiyama/University of Rochester

Barbara K. Townsend/University of Missouri-Columbia

Consuella Lewis/University of Pittsburgh

Vicki J. Rosser/University of Nevada, Las Vegas

I3 * Research and/or Scholarly Paper

City Terrace 10

Issues Related to Globalization in Higher Education

Discussant: Luciana Dar/University of California, Riverside

Chair: Xyanthe Neider/Washington State University

U.S. Based Business Needs For Technical/Occupational Employees with International Skills: Considerations For Community College and Sub-Baccalaureate Programs in the Tampa Bay Economic Zone

Ronald Olney/University of South Florida

International Engagement: A Critical Discussion

Lorilee Sandmann/University of Georgia

Tami L. Moore/Washington State University

Jocey Quinn/London Metropolitan University

Academic Roles and Strategies in Global Health: Comparing Canadian and U.S. Universities

Anatoly Oleksiyenko/University of Toronto

Creso Sa/University of Toronto

I4 * Research and/or Scholarly Paper

City Terrace 5

The Social Context of the Student Experience

Discussant: Robert T. Teranishi/New York University

Chair: T. Elon Dancy II/Louisiana State University

Negotiating Diversity in a Liberal Arts Context: Examining Students' Transformational Processes with Racial Diversity

Erica Yamamura/Texas State University, San Marcos

The Sociopolitical Vessel of Black Student Life: A Reexamination of How Context Influenced the Emergence of the Extracurriculum

Andre M. Perry/University of New Orleans

The Social Construction of Meritocracy Through Honors Programs: The Changing Landscape of Public Higher Education in the U.S.

Elena Galinova/The Pennsylvania State University

Producing Global Citizens for the Future: Space, Discourse, and Curricular Reform

Claudia Matus/Florida International University

Susan Talburt/Georgia State University

I5 * Research and/or Scholarly Paper

City Terrace 8

Balance of Faculty Careers and Family

Discussant: Diane Dean/Illinois State University

Chair: Luis Ponjuan/University of Florida

Gender Differences in the Understanding and Pursuit of Life Purpose Among University Faculty

Don Thompson/Pepperdine University

Cindy Miller-Perrin/Pepperdine University

I Want My Tenure: Life After Becoming the University Presidential Partner

Juanita Gamez Vargas/Texas A&M University

Can I, Should I, Will I? Faculty Sense of Agency in Decisions About Work and Family

KerryAnn O'Meara/University of Maryland

L. Corbin M. Campbell/University of Maryland

Narrating and Navigating the Academic Job Market

Mary Wright/University of Michigan

I6 * Research and/or Scholarly Paper

City Terrace 6

Leadership We Can Believe In: Opening the Pathway for Internal Leaders

Discussant: Marilyn J. Amey/Michigan State University

Chair: Vince Lechuga/Texas A & M University

11:30 am - 1:00 pm

I6 * Research continued

Department Chair Leadership: The Impact on Faculty Motivation and Productivity
Todd Pourciau/Louisiana State University

Everyday People Making a Difference on College Campuses: The Tempered Grassroots Leadership Strategies of Faculty and Staff
Tricia Bertram Gallant/University of California, San Diego
Adrianna J. Kezar/University of Southern California
Jaime Lester/George Mason University
Melissa Contreras-McGavin/University of Southern California

Three Perspectives of Administrative and Faculty Culture: Toward a Model of Cultural Complexity
Ryan Smerek/University of Michigan

Flying Under the Radar: Strategies of Grassroots Staff Activists
Jaime Lester/George Mason University

I7 * Research and/or Scholarly Paper City Terrace 11

Religious Identities Among College Students

Discussant: Dwight E. Giles, Jr./University of Massachusetts, Boston
Chair: Andrew Nichols/The Pennsylvania State University

Catholic Women's College Students Constructions of Identity: The Influence of Faculty and Staff on Students' Personal and Professional Self-Understanding
Rebecca Ropers-Huilman/University of Minnesota
Kathryn A. E. Enke/University of Minnesota
Claire Chien/University of Minnesota

A Phenomenological Analysis of College Students' Spiritual Struggles

Alyssa N. Bryant/North Carolina State University
Coretta Roseboro/North Carolina State University
Jordan Luzader/North Carolina State University

How Does Religiosity Differ for Students Who Attend Catholic Versus Non-Catholic Four-Year Colleges?

Dan Merson/University of Michigan

I8 * Symposia

City Terrace 12

Cross-Border Higher Education: Policies, Politics, and Practice

Kevin Kinser/University at Albany, SUNY
David Chapman/University of Minnesota
Lisette Montoto/University of Georgia
Jason E. Lane/University at Albany, SUNY
Robin Sakamoto/Rikkyo University

I9 * Symposia

Orlando

Pushing the Boundaries: Incorporating Neglected Aspects of Qualitative Research

William G Tierney/University of Southern California
Yvonna S. Lincoln/Texas A&M University
Julia Colyar/University at Buffalo, SUNY
Karri Holley/University of Alabama
Margaret Whitney Sallee/University of Tennessee
Ronald Hallett/University of Southern California
Ken Kempner/Southern Oregon University

I10 * Symposia

Clearwater

Researching the Black Researcher: Embracing the Struggle and Successes of Black Faculty at Predominantly White Institutions

Carol Wright/TERC
Franklin Tuitt/University of Denver
Kimberly A. Griffin/The Pennsylvania State University
Richard J. Reddick/University of Texas at Austin

I11 * Symposia

City Terrace 9

El Camino: The Latina/o Student Journey to Higher Education and Beyond

Philip Vasquez/Iowa State University
Jessica Ranero/
R. Evely Gildersleeve/Iowa State University
Jose A. Cabrales/Iowa State University
Laura Rendon/Iowa State University

1:15 pm - 2:45 pm

J1 * Presidential Session

Orlando

Who's In? Who's Out? A Conversation About Inclusion in ASHE

Jeffrey F. Milem/The University of Arizona
Marybeth Gasman/University of Pennsylvania
Judy Marquez Kiyama/University of Rochester
Heather Eggins/Staffordshire University
Consuella Lewis/University of Pittsburgh
Darnell Cole/University of Southern California

J2 * Research and/or Scholarly Paper

City Terrace 8

Marketization and Higher Education Responses

Discussant: Jenny Lee/The University of Arizona
Chair: Na Wei/Michigan State University

Cost Sharing and Student Activism at the University of Ouagadougou, Burkina Faso: Voices From Below

Touorouzou Some/University at Buffalo, SUNY

The Adaptation of Quality Assurance Mechanisms to External Environment in England, Japan and New York State

Keiko Yokoyama/The Pennsylvania State University

Decentralization, Privatization, Amalgamation and Expansion: National Reform Policies as Situated Practices at a Key Chinese University

Jingning Zhang/Arizona State University

J3 * Research and/or Scholarly Paper

City Terrace 6

Learning Across the Quad: Using Political Science Models to Study Higher Education

Discussant: William Doyle/Vanderbilt University
Chair: Jesse Mendez/Oklahoma State University

Median Voter Preferences and Merit Aid

Jennifer A. Delaney/University of Wisconsin - Madison

Performance Funding Through Theoretical Lenses: Examining the Applicability of the Advocacy Coalition Framework

Rebecca Natow/Teachers College - Columbia University
Kevin Dougherty/Teachers College - Columbia University

Higher Education Policy Punctuations: An Assessment of Media Attention and Congressional Oversight

Jason E. Lane/University at Albany, SUNY
Dean C. Lefor/University of North Dakota

J4 * Research and/or Scholarly Paper

City Terrace 10

Faculty Research Work in the Academy

Discussant: Martin J. Finkelstein/Seton Hall University

Chair: Valerie Martin Conley/Ohio University

Decomposing the Differences in Time Allocation, Research Productivity, and Satisfaction Between Latino and Non-Latino Faculty

Sylvia Martinez/Indiana University
Robert Toutkoushian/Indiana University
John Moore/Indiana University

Postsecondary Research Scholarship in a Context of the New Hire Career Cohort

Cindy Martin/University of Memphis

Intergenerational Research Collaborations at Research-Oriented Liberal Arts Colleges: An Ecological Approach to Faculty Development

Melissa McDaniels/Michigan State University

J5 * Research and/or Scholarly Paper

Clearwater

Co-Curricular Influences on Students' Experiences

Discussant: Dwight E. Giles, Jr./University of Massachusetts, Boston

Chair: William Wayne Young, Jr./Creighton University

"It's Like a Double-Edged Sword": Understanding College Student Perceptions of Their Required High School "Service-Learning" Experiences

Susan Jones/University of Maryland
Thomas Segar/University of Maryland
Anna Gasiorski/Ohio Learning Network

The Socially-Oriented Student Entrepreneur

Matthew M. Mars/The University of Arizona

Embracing the Student-Institution Relationship: Creating a Connection Conducive to Personal and Social Responsibility

Karen Boyd/University of Georgia
Diane Cooper/University of Georgia

From Disequilibrium to Literacy: Diverse Students and Service-Learning

Heidi L. Barajas/University of Minnesota
Amy Ronnkvist/University of Minnesota
Lisa Burton/University of Minnesota

1:15 pm - 2:45 pm

J6 * Research and/or Scholarly Paper
City Terrace 11

Mentoring at Two-Year and Four-Year Institutions

Discussant: Thomas Nelson Laird/Indiana University
Chair: Marco J Barker/Louisiana State University

Undergraduate Research Experiences with Faculty: Considering the Disciplinary Effects and Associated Gains

Jennifer Buckley/Indiana University
Ali Korkmaz/Indiana University
George D. Kuh/Indiana University

The Effect of Mentoring on Community College Student Persistence

Gloria Crisp/University of Texas at San Antonio

Students and Professors Aspirations of Mentoring and Undergraduate Research Experiences

Linda S. Behar-Horenstein/University of Florida
Alice Dix/University of Florida
Kellie Roberts/University of Florida

J7 * Research and/or Scholarly Paper
City Terrace 7

Bridges to Facilitate Academic Preparation and Transition

Discussant: Lisa Wolf-Wendel/University of Kansas
Chair: Shannon Calderone/University of California, Los Angeles

The Role of Financial Aid Awards in Student Engagement in College Activities: A Study of the Gates Millennium Scholarship Program

Shouping Hu/Florida State University

Struggle and Success: The Experiences of Urban High School Seniors Participating in a Dual Enrollment Program

Meghan Wilson/University of Pennsylvania

Summer Bridge Students Academic Success: A Longitudinal, Control Group Comparison

MaryBeth Walpole/Rowan University
Herbert Simmerman/Rowan University
John Mills/Rowan University

J8 * Symposia
City Terrace 9

Critical Qualitative Scholars Connecting Research and Practice in the Era of Conservative Modernization

Penny Pasque/University of Oklahoma
Aaron M. Kuntz/University of Alabama
Rozana Carducci/University of California, Los Angeles
R. Evelyn Gildersleeve/Iowa State University

J9 * Symposia
City Terrace 5

Separated at Birth? Examining Conceptualizations of Learning and Development

Ann E. Austin/Michigan State University
Marcia Baxter Magolda/Miami University of Ohio
Lisa R. Lattuca/The Pennsylvania State University
Anna Neumann/Teachers College - Columbia University
Robert Reason/The Pennsylvania State University
Kristen Renn/Michigan State University
Terry M. Wildman/Virginia Polytechnic Institute and State University

J10 * Symposia
City Terrace 4

Planning, Implementing, and Using Assessment Results: Examining Recent Trends and Progress

Trudy W. Banta/Indiana University Purdue University Indianapolis
Karen Black/Indiana University Purdue University Indianapolis
Elizabeth A. Jones/West Virginia University
Christopher Allen McCullough/DePaul University

J11 * Symposia
City Terrace 12

Enhancing Student Development Theory Using Critical, Constructivist, and Ecological Approaches

Nancy Evans/Iowa State University
Lori D. Patton/Iowa State University
Ellen Broido/Bowling Green State University
Jessica Ranero/Iowa State University

1:15 pm - 1:55 pm

Roundtables J1-1 Daytona

J1 Writing Book Reviews for the Review of Higher Education as a Professional Development Opportunity

Kevin Kinser/University at Albany, SUNY
John H. Schuh/Iowa State University
Crystal L. Rion/University at Albany, SUNY
Andy Ryder/Iowa State University
Layheng Ting/University at Albany, SUNY

J2 Affordability and College Choice: An Exploratory Analysis of Why Students Do Not Attend Their First Choice

Jose Luis Santos/University of California, Los Angeles
Lorelle L. Espinosa/University of California, Los Angeles
Hanna Song/University of California, Los Angeles

J3 If the Framework Doesn't Fit - Flip It: Alternative Approaches to College Student Development Theory

Fred A. Bonner, II/Texas A&M University
Kelli Peck-Parrott/Texas A&M University

J4 Beyond the Puente Project: The Next Steps For Improving Latino Student Retention

Sara Lacagnino/Seton Hall University
Enmanuel Mercedes/Seton Hall University

J5 Partnership Capital: A New Model For Partners, Leaders, and Policy Makers

Marilyn J. Amey/Michigan State University
Pamela Eddy/The College of William and Mary
Timothy Campbell/Michigan State University

J6 Free Technology, Stolen Content, Borrowed Solutions: The Assets of Institutional Policy

Frank Cuevas/Florida State University
Gordon Mills/Florida State University

Roundtables St. Johns J1-1

J7 The Impact of Using Reflection, Action Theories and Social Justice Issues in a Higher Education Graduate Course: Five Years Later

Kimberly Kline/Buffalo State College

J8 Assessment: More Than Fad, Less Than Promised?

Don Haviland/California State University, Long Beach

J9 Why We Know DuBois and Not Woodson: How the Research Platforms of Faculty of Color Can Impact Tenure Track Success

Robyn Clarke/Marquette University
John A. Kuykendall/Marquette University

J10 Creating a Seamless Pathway for Community College Transfer Students: Maintaining System-Wide Compliance in a Decentralized State University System

Angela M. Falconetti/The University of Texas at Austin
Joyce Jones/University of North Florida

J11 Women and Underrepresented Students of Color in Science, Technology, Engineering, and Mathematics: An Examination From K-20

Faye Jones/Florida State University
William Rew/Florida State University

J12 A Cross-Country Examination of Factors that Impact Higher Education Access and Completion in Developing Countries

Felly Chiteng Kot/University of Minnesota

2:00 pm - 2:45 pm

Roundtables J2-1 St. Johns

J13 Faculty Role and Perspective in Privatization

Rachel Boon/Drake University

J14 Peer Debriefing in Qualitative Research

James P. Barber/University of Michigan
Kelley K. Walczak/University of Michigan

J15 Unintended Impact: The End of Affirmative Action and its Effects on Outreach Programs in California

Erica Yamamura/Texas State University, San Marcos
Maria Ledesma/University of California, Berkeley
Dolores Calderon/University of Utah
Tracy Lachica Buenavista/University of California, Los Angeles

J16 Parents With or Without a College Education: The Nuances of College Choice Among Latino University Students

Regina J. Deil-Amen/The University of Arizona
Sandra Luca/The University of Arizona

Stop by the
Jossey-Bass exhibitor's table
to check out the latest ASHE
Higher Education Reports.

Roundtables J2-1 Daytona

J17 The Second Chance to College Access: How Summer Bridge Programs Structure College Opportunity For Under-Prepared Students

Ryan Davis/University of Maryland
Robert Terry Palmer/Morgan State University

J18 Psychological Well-Being and College Students: The Possible Influence of Spirituality and Religion For Diverse Populations

Julie Park/University of California, Los Angeles
Lisa Millora/University of California, Los Angeles

J19 Understanding Barriers to Pursuit of a Professional Doctoral Degree in Education: Navigating Challenges Through Social Support Structures

Ilda Jimenez y West/University of Southern California
Edlyn Vallejo Pena/University of Southern California
Gokce Gokalp/University of Southern California
Linda A. Fischer/University of Southern California

J20 College Access and Success for Rural Low SES Students

Sarah Beasley/Boston College

J21 Challenges of Policy Implementation in Higher Education From the Perspective of Leadership and Organization Theory

Ruth C. Slotnick/University of South Florida
Yenni Djajalaksana/University of South Florida
Maranatha Christian University, Indonesia

J22 Identifying Undergraduate Institutions that Produce Women and Minority Scientists

Steven Hubbard/New York University
Frances K. Stage/New York University

3:00 pm - 4:30 pm

K1 * Bobby Wright Dissertation of the Year

City Terrace 5

Chair: Christopher Morpew/University of Georgia

Announced at Awards Luncheon

K2 * Presidential Session

City Terrace 5

Navigating the Publications Process: A Conversation with Journal Editors

John Braxton/Journal of College Student Development

Amaury Nora/Review of Higher Education

James C. Palmer/Community College Review

John Smart/Research in Higher Education

K3 * Research and/or Scholarly Paper

Clearwater

The College Choice of Students: When and Where

Discussant: Michael Paulsen/University of Iowa

Chair: Sandra Luca/The University of Arizona

The Effect of Financial Aid Packages on Postsecondary Choice

Jiyun Kim/University of Michigan

Stephen DesJardins/University of Michigan

Brian P. McCall/University of Michigan

Who Goes Early?: A Multi-Level Analysis of Enrollment via Early Action and Early Decision Admissions

Julie Park/University of California, Los Angeles

Kevin Eagan/University of California, Los Angeles

Revealed Preferences: Which College Attributes Inform Initial College Choices?

Ty M. Cruce/Indiana University

Where You Go May Depend on Where You Start: Does Community College Locale Affect Transfer to a Four-Year Institution?

Afet Dadashova/Indiana University

Jacob P.K. Gross/Indiana University

Don Hossler/Indiana University

K4 * Research and/or Scholarly Paper

City Terrace 9

The Influence of Financial Aid on Post-Undergraduate Outcomes

Discussant: Bradley Curs/University of Missouri - Columbia

Chair: J. Nathaniel Southerland/University of Utah

Majors Matter: Estimates of the Effects of Major Field of Study on the Early-Career Earnings of Minorities Evidence From the Gates Millennium Scholarship (GMS) Program

Tatiana Melguizo/University of Southern California

Gregory C. Wolniak/University of Chicago

Where Did All the Leaders Go? Analyzing the Impact of California's Budget Crisis and Proposition 209 on Graduate Education

Ray Franke/University of California, Los Angeles

Jaime Rodriguez/University of California, Los Angeles

The Effect of Indebtedness on Graduate School Enrollment of Latino STEM Baccalaureates: A Propensity Score Matching Analysis

Lindsey Malcom/University of California, Riverside

Alicia Dowd/University of Southern California

K5 * Research and/or Scholarly Paper

City Terrace 8

Basing Decisions on Reality: The Need for Data in Institutional Decision Making

Discussant: Greg Dubrow/University of California, Berkeley

Chair: Nancy Ludwig/Northeastern University

Building a Culture of Evidence in Community Colleges: A Study of Data Use for Program Improvement

Monica Reid/Teachers College - Columbia University

Davis Jenkins/Teachers College - Columbia University

Online Education in the New World College: Perceptions of Change

Regina L. Garza Mitchell/Central Michigan University

Barriers to Effective Assessment: A Case Study Analysis

Marilee Bresciani/San Diego State University

Megan Moore Gardner/University Of Akron

Jessica Hickmott/San Diego State University

K6 * Scholarly Paper

City Terrace 10

Developments in Organizational Theory: Assessing the State of the Field

Discussant: Jason E. Lane/University at Albany, SUNY

Chair: Amanda Joy Kleinheksel/University of Florida

The Paradoxical Dilemmas of Organized Anarchy: An Overview

Joseph Berger/University of Massachusetts, Amherst

Daniel Saunders/University of Massachusetts, Amherst

3:00 pm - 4:30 pm

K6 continued

Incorporating Industry Analysis into Higher Education Strategy-Making

Mario C. Martinez/University of Nevada, Las Vegas
Mimi Wolverton/Retired

The Big 10 in Higher Education: An Empirical Analysis of Organizations Research in Field Journals, 1990-2006

Michael Bastedo/University of Michigan
Danielle Knabjian Molina/University of Michigan
Cassie L. Barnhardt/University of Michigan

K7 * Research and/or Scholarly Paper City Terrace 6

Pursuit of Prestige: The Role of Positioning and Rankings

Discussant: Robert Hendrickson/The Pennsylvania State University
Chair: Alonzo Flowers/Texas A & M University

Aspirational U.: Positioning For Prestige in American Higher Education

J. Douglas Toma/University of Georgia

Variables That Explain Changes in Institutional Rankings in U.S. News & World Report

Thomas Sanford/University of Minnesota
Giljae Lee/University of Minnesota

Can We Improve Our Reputation? The Variables That Relate to Change Over Time in U.S. News Peer Ratings

Kyle Sweitzer/Michigan State University
J. Fredericks Volkwein/The Pennsylvania State University

K8 * Research and/or Scholarly Paper City Terrace 11

Contemporary Issues in Fraternity and Sorority Life

Discussant: John Thelin/University of Kentucky
Chair: Jose A. Cabrales/Iowa State University

Reflections on Personal Responsibility: Sorority Members at Risk for Interpersonal Violence

Christian K. Wuthrich/Washington State University

Further Evidence of the Effects of Fraternity and Sorority Membership: It's More Complicated Than You Might Think

Georgianna L. Martin/University of Iowa
Michael Hevel/University of Iowa
Ashley Asel/University of Iowa

It's all Greek to Me: Exploring Why Latin@S Join Latino-Based Fraternities and Sororities

Lucy Arellano/University of California, Los Angeles

K9 * Research and/or Scholarly Paper City Terrace 7

Experiences of Asian and Asian American College Students

Discussant: Leticia Oseguera/University of California, Irvine
Chair: Meechai Orsuwan/Central Michigan University

A Theory of Major Choosing for the 21st Century Julie Traxler/Rutgers University

The Racialization of Asian Americans and Pacific Islanders in Selective College Admissions

Robert T. Teranishi/New York University
Tu-Lien Kim Nguyen/University of California, Los Angeles

Overcoming Invisibility: The Role of Ethnic Organizations for Hmong Students

Rican Vue/University of California, Los Angeles

Asian and Asian American Students: Differences in Engagement Patterns and Implications for Research

Wen Qi/Indiana University
James Cole/Indiana University

K10 * Symposia City Terrace 12

Establishing a Family-Friendly Campus: Best Practices

Jaime Lester/George Mason University
Jean M. McLaughlin/The George Washington University
Gloria Thomas/University of Michigan
Kate Quinn/University of Washington
Jeni L. Hart/University of Missouri-Columbia
Margaret Whitney Sallee/University of Tennessee
Sharon Dannels/The George Washington University
Sharon McDade/American Council on Education

K11 * Symposia City Terrace 4

Developing a More Complete Understanding of Work for Today's College Students

Laura Perna/University of Pennsylvania
Carol Kasworm/North Carolina State University
Marvin A. Titus/University of Maryland
Paul Umbach/North Carolina State University
Mary Ziskin/University of Indiana

4:45 pm - 6:15 pm

L1 * Research and/or Scholarly Paper
City Terrace 11

Change and Reform in African Higher Education

Discussant: Tatiana Suspitsyna/The Ohio State University
Chair: Mohamed Nur-Awaleh/Illinois State University

Internationalization of Higher Education in Sub-Saharan Africa: The Case of Private Universities

Janice R. Sandiford/Florida International University

International Development Through Research: Building Academic Capacities in Africa

Amy Scott Metcalfe/University of British Columbia
Samuel Esseh/Kwame Nkrumah University of Science and Technology

Exploring the Responsiveness of Faculty Deans After The Quiet Revolution at a Ugandan Public University

Ronald Bisaso/University of Tampere, Finland

L2 * Research and/or Scholarly Paper
City Terrace 12

College Finances for Single Mothers, Adult Students, and Students from Low-Income Families

Discussant: Regina J. Deil-Amen/The University of Arizona
Chair: Nathan Daun-Barnett/University of Michigan

If Not TANF, Then What? How Single Mothers Finance College Post-Welfare Reform

Kristin Bailey Wilson/University of Missouri-Columbia
Barbara K. Townsend/University of Missouri-Columbia

State Higher Education Finance Policy and Adult Student Enrollment: A Stochastic Frontier Analysis

Marvin A. Titus/University of Maryland
Brian Pusser/University of Virginia

College Affordability and Class-Based Meanings Around Money: A New Conceptual Approach

Shannon Calderone/University of California, Los Angeles

Loan Replacement Grants for Low Income Students: A Typology of Programs

Adam J.A. Lips/University of Pittsburgh

L3 * Research and/or Scholarly Paper
City Terrace 7

Faculty Diversity: Advocacy and Perceptions

Discussant: Alicia Dowd/University of Southern California
Chair: Michelle Bartlett/Clemson University

Latent Social Roles Revisited: The Effect of Academic Networks in the Loyalty to a Public Mexican Higher Education Institution

Manuel S. Gonzalez Canche/The University of Arizona

Tempered Radicals in Academe: Expressions of Diversity Advocacy in the Faculty Hiring Process

Marcela Muniz/Stanford University

Structurally Transformative Agency: Black Female Faculty and Critical Approaches at PWIs

Venice T. Sule/University of Michigan

From Another Perspective: Faculty Perceptions of the Racial Climate at Black Colleges

Barbara J. Johnson/Northern Illinois University
Timothy Johnson/Jackson State University
SaFiya D. Hoskins/Jackson State University

L4 * Research and/or Scholarly Paper
City Terrace 9

Curricular Considerations in the First-Year Experience

Discussant: John Braxton/Vanderbilt University
Chair: Stephen John Quaye/University of Maryland

Promoting the Development of Civic Responsibility: Infusing Service-Learning Practices in First-Year Success Courses

Matt Mayhew/New York University
Mark Engberg/Loyola University Chicago

Using Research to Shape First-Year Seminar Curriculum Development: The Impact of Strengths-Based Approaches on Students Perceived Academic Control

Michelle Louis/Azusa Pacific University
Laurie A. Schreiner/Azusa Pacific University

Promoting Encounters with Difference in First-Year Courses: A Multilevel Analysis of Faculty Practice

Robert Reason/The Pennsylvania State University
Brenda Lutovsky/The Pennsylvania State University
Bradley E. Cox/The Pennsylvania State University
Patrick Terenzini/The Pennsylvania State University

Special Event - November 8 - ASHE Community Meeting

6:30 pm - 7:30 pm in River Terrace 2

All ASHE Members and 2008 Conference Program Committee members are asked to attend this annual meeting

4:45 pm - 6:15 pm

L5 * Research and/or Scholarly Paper
City Terrace 8

Influences of Student Background Characteristics on Academic Preparation

Discussant: Eric Dey/University of Michigan
Chair: Robert Michael Haynes/University of North Texas

The Difference a Generation Makes: An Analysis of the Relationship Between Tertiary Education Plans and Parental Educational Attainment Levels

Dale Kirby/Memorial University of Newfoundland
Dennis Sharpe/Memorial University of Newfoundland

Reorienting the Concept of Intergenerational Closure: Student-Parent Communication About College Preparation

Scott M. Myers/Montana State University
Carrie B. Myers/Montana State University

Accuracy of Self-Reported SAT and ACT Test Scores: Implications for Research

James Cole/Indiana University
Robert Gonyea/Indiana University

L6 * Research and/or Scholarly Paper
City Terrace 10

Experiences of Non-Traditional College Students

Discussant: Tara Parker/University of Massachusetts, Boston
Chair: Judy Marquez Kiyama/University of Rochester

First-Generation Undergraduate Students and the Impacts of the First Year of College: Some Additional Evidence

Ryan Padgett/University of Iowa
Megan P. Johnson/University of Iowa

Predictors of Academic Success for Working Non-Traditional Students

Heather Rowan-Kenyon/University of Virginia
Bruce Gansneder/University of Virginia
Amy Swan/University of Virginia

Destination: College - Influences on the Successful Journey to College of Twenty Low-Income, First-Generation, African American and Latino Students

Gerard Rooney/St. John Fisher College

L7 * Research and/or Scholarly Paper
City Terrace 6

Racialized Perspectives on White Students

Discussant: Ellen Broido/Bowling Green State University
Chair: Jesse S. Watson/Michigan State University

International Social Justice Activism: An Exploration of White College Students and Post-College Millennials Who Are Activists For Africa

Caryn P. Grimstead/Indiana State University

Seeing Through White-Tinted Glasses: White, Male College Students on Race, Anger and Ambivalence

Nolan Cabrera/University of California, Los Angeles

Viewing the World From a Privileged Perspective: How Race Shapes the Experience of White College Students

Amy Aldous Bergerson/University of Utah

White Racial Identity Development: From Research to Practice

Anne M. Hornak/University of Toledo

L8 * Research and/or Scholarly Paper
Clearwater

Self-Authorship and Meaning-Making

Discussant: Elizabeth G. Creamer/Virginia Polytechnic Institute and State University
Chair: Jennifer Buckley/Indiana University

Integrating Developmental Dimensions: Promoting Self-Authorship in College

Marcia Baxter Magolda/Miami University of Ohio

The Curvilinear Relationship Between Intellectual Development and Academic Dishonesty: A New Connection in Making Meaning of Students Cheating Ways

Cody J. Arvidson/University of North Texas

Developmental Steps Withing External Meaning Making

Patricia M. King/University of Michigan
Marcia Baxter Magolda/Miami University of Ohio
Kelley K. Walczak/University of Michigan
Rosemary Perez/University of Michigan
Kari Taylor/Miami University of Ohio

L9 * Symposia

Orlando

Research as Resistance: "Anti"-Oppressive Research in Higher Education

Riyad Shahjahan/Iowa State University
Laura Rendon/Iowa State University
Benjamin Baez/Florida International University
Susan Talburt/Georgia State University

Dissertation Fellows

Allison Ambrose, Illinois State University

Student Characteristics of Merit Aid Recipients: Structural and Human Agency Determinants

Director: Diane Dean

Mentor: Frances Stage/New York University

DeAnna Burt, Western Michigan University

African American Student Persistence: A Study of the Effects of an Intrusive Advising Intervention at a Career College

Director: Andrea Beach

Mentor: Bridget Turner Kelly/Seattle University

Carol Brochin Ceballos, University of Texas, San Antonio

Becoming Maestras: A Case Study of How Latina Preservice Teachers Navigate Their Success in a Bilingual Teacher Preparation Program

Director: Maria Franquiz

Mentor: Lisa Lattuca/The Pennsylvania State University

Lara Couturier, Brown University

Accessing opportunity: A History of the Debates Over Access to College in the United States, 1945-2000

Director: Mari Jo Buhle

Mentor: Philo Hutcheson/Georgia State University

Matthew Foraker, University of Arizona

State Appropriations: Implications for Public Higher Education Pricing and Financial Aid Policies

Director: John Cheslock

Mentor: Stephen Porter/Iowa State University

Jacob Gross, Indiana University

Promoting or Perturbing Access: An Event History Analysis of the Effects of Financial Aid on Latino Students' Educational Attainment

Directors: Don Hossler

Mentor: Steve Desjardins/University of Michigan

Jarrett Gupton, University of Southern California

Pathways to Postsecondary Education for Homeless Youth

Director: William Tierney

Mentor: Octavio Villalpando/University of Utah

Shaila Mulholland, NYU

The Lessons of Fifty Years of Access and Equity Struggles in Indiana

Director: Richard Richardson

Mentor: Marybeth Gasman/University of Pennsylvania

Meghan Wilson, University of Pennsylvania

Struggle and Success: The Experiences of Urban High School Seniors Participating in a Dual Enrollment Program

Director: Laura Perna

Mentor: Linda Hagedorn/Iowa State University

Named in memory of Irvin Lee (Bobby) Wright, this award recognizes one or more dissertations that serve as exemplary models of the methodology employed. Criteria also include the significance of the dissertation topic.

2007-2008: Uma Madhure Jayakumar, UCLA
Diversity Capital: Conceptualizing How Higher Education Positions Individuals for Success (or Failure) in an Increasingly Global Marketplace

2007-2008: Katalin Szelenyi, UCLA (Cited for Excellence)
Doctoral Student Socialization in Science and Engineering: The Role of Commercialization, Entrepreneurialism, and the Research Laboratory

2006-2007: Melissa R. Peet
We Make it the Road By Walking it: Critical Consciousness, Structuration, and Social Change School

2005-2006: Aimee LaPointe Terosky
Taking Teaching Seriously: A Study of University Professors and Their Undergraduate Teaching

2004-2005: Liang Zhang
How College Affects Students: Toward the Reconciliation of Theory With Empirical Evidence

2003-2004: Toni E. Larson
Decentralization in U.S. Public Higher Education: A Comparative Study of New Jersey, Illinois, and Arkansas

2002-2003: Joni Mini Montez
Developing and Piloting the Higher Education Leadership Instrument (HELI)

2002-2003: Cited for Excellence: Christine Keller
Moving Forward or Standing Still: Progress in Achieving Wage Equality for Women Faculty in the 1990s

2001-2002: Michael K. McLendon
Setting the Agenda for State Decentralization of Higher Education: Analyzing the Explanatory Boundaries of Alternative Agenda Models

2001-2002: Cited for Excellence: Joshua B. Powers
Academic Entrepreneurship: Institutional Effects on Performance of University Technology Transfer

2000-2001: David Weerts
Understanding Differences in State Support for Higher Education: A Comparative Study of State Appropriations for Research Universities

2000-2001: Cited for Excellence: William Mallon
Abolishing or Instituting Tenure: Four Case Studies of Change in Faculty Employment Policies

1999-2000: Marvin Dewey
An Exploratory Study of the Relationship Between Cognitive Complexity of Administrative Teams in Private Liberal Arts Colleges and Organizational Health as One Dimension of Organizational Effectiveness

1999-2000: Cited for Excellence: Elizabeth A. Palmer
An Analysis of a Diversity Requirement: The Effect of Course Characteristics on Students' Racial Attitudes, Gender Attitudes, and Self-Perceived Learning

1998-99: Deborah Faye Carter
A Dream Deferred? Examining the Degree Aspirations of African American and White College Students

1998-99: Cited for Excellence: R. Sam Larson
Organizational Change from the 'Inside': A Study of University Outreach

1997-98: Joseph Berger (Co-winner)
Organizational Behavior at Colleges and Student Outcomes: Generating a Quantitatively Grounded Theory

1997-98: Cynthia Sabik (Co-winner)
(Re)Writing Metaphor and Form: Autoethnographic Enactments from the Postmodern Classroom

1996-97: Lisa Rose Lattuca
Envisioning Interdisciplinarity: Processes, Contexts, Outcomes

1996-97: Cited for Excellence: Rebecca Ropers-Huilman
Shaping an Island of Power and Change: Creating a Feminist Poststructural Teaching Discourse

1996-97: Cited for Excellence: Carol L. Colbeck
Organizational and Disciplinary Influences on Integration and Congruence of Faculty Work

1995-96: Teresa Isabelle Daza Campbell
Protecting the Public's Trust: A Search for Balance Among Benefits and Conflicts in University-Industry Relationships

1994-95: Robert A. Rhoads
Institutional Culture and Student Subculture: Student Identity and Socialization

1994-95: Cited for Excellence: Peter M. Magolda
A Quest for Community: An Ethnographic Study of a Residential College

1993-94: Rebecca R. Kline
The Social Practice of Literacy in a Program of Study Abroad

1993-94: Cited for Excellence: Dorothy Finnegan
Academic Career Lines: A Case Study of Faculty in Two Comprehensive Universities

1992-93: Martha Lillian Ann Stassen
White Faculty Members' Responses to Racial Diversity at Predominantly White Institutions

1991-92: Julie Neururer
Decency and Dollars Invested: Case Studies of South African Divestiture

- 1991-92: Cited for Excellence: Francoise Queval
The Evolution Toward Research Orientation and Capability
in Comprehensive Universities: A Case Study: The
California State University System
- 1990-91: Kenneth D. Crews, J.D.
Copyright Policies at American Research Universities:
Balancing Information Needs and Legal Limits
- 1989-90: Roger L. Williams
George W. Atherton and the Beginnings of Federal
Support for Higher Education
- 1988-89: Patricia Gumpert
The Social Construction of Knowledge: Individual and
Institutional Commitment to Feminist Scholarship
- 1987-88: Dolores L. Burke
Change in the Academic Marketplace: A Study of Faculty
Mobility in the 1980s
- 1986-87: Irvin Lee (Bobby) Wright
Piety, Politics and Profit: American Indian Missions in the
Colonial Colleges
- 1986-87: Cited for Excellence: Lester F. Goodchild
The Mission of the Catholic University in the Midwest,
1842-1980
- 1985-86: Janet Kerr-Tener
From Truman to Johnson: Ad Hoc Policy Formulation in
Higher Education
- 1985-86: Cited for Excellence: Amaury Nora
Determinants of Retention Among Chicano Students: A
Structural Model
- 1985-86: Cited for Excellence: Charlotte Hanna
Modest Expectations: Qualitative and Quantitative
Analysis of Faculty Affirmative Action
- 1984-85: Lois A. Fisher
State Legislatures and the Autonomy of Colleges and
Universities: A Comparative Study of Legislation in Four
States, 1900-79
- 1984-85: Runner-Up: Bernard Reams
Research Interactions Between Industry and Higher
Education
- 1984-85: Cited for Excellence: Marta Wagner
The American Scholar in the Early National Period: The
Changing Context of Colonial Education
- 1983-84: Jeffery Bartkovich
Designing an Empirically Derived Taxonomy of
Organization Structures in Higher Education
- 1983-84: Cited for Excellence: Constance Collins
Loose Coupling as a Framework for Understanding
Structural Change: Case Studies of Four American
Colleges and Universities
- 1983-84: Cited for Excellence: Edward Ottensmeyer II
Strategic Organizational Adaptation and the Regulatory
Environment: A Study of Universities During a Time of
Regulatory Change
- 1982-83: Catherine Marienau
Bridging Theory and Practice in Adult Development and
Planned Change
- 1982-83: Cited for Excellence: Jerry Wayne Askew
Toward a Theory on the Impact of Budget Retrenchment
in Educational Organizations
- 1982-83: Cited for Excellence: Ellen Metzner Ironside
Career Paths of Women Administrators in Higher
Education
- 1981-82: Ellen Chaffee
Decision Models in Budgeting
- 1981-82: Cited for Excellence: Ted I. K. Youn
The Career of Young Ph.D.s: Temporal Change and
Institutional Effects
- 1981-82: Cited for Excellence: Joyce Mushaben
The State Versus the University: Juridicalization and
the Politics of Higher Education at the Free University of
Berlin, 1969-79
- 1980-81: Paul Duby
An Investigation of the Mediating Role of Causal Attitudes
in School Learning
- 1980-81: Cited for Excellence: James Henson
Institutional Excellence and Student Achievement: A
Study of College Quality and its Impact on Education and
Career Development
- 1979-80: Kenneth Bradley Orr
The Impact of the Depression Years 1929-39 on Faculty in
American Colleges and Universities
- 1979-80: William Zumeta
The State and Doctoral Programs at the University of
California: Academic Planning for an Uncertain Future
- 1979-80: Cited for Excellence: Daniel Carl Levy
University Autonomy Versus Government Control: The
Mexican Case

HOWARD R. BOWEN DISTINGUISHED CAREER AWARD

Presented to an individual whose professional life has been devoted in substantial part to the study of higher education and whose career has significantly advanced the field through extraordinary scholarship, leadership and service. The award is usually presented at, or near, the time of the individual's retirement.

2007	Jack H. Schuster
2006	Martin Trow
2005	Robert Birnbaum
2004	Yvonna Lincoln
2003	Ernest T. Pascarella
2002	Marvin W. Peterson
2001	Helen S. Astin
2000	Arthur Chickering
1999	Joan S. Stark
1998	Arthur Cohen
1997	Burton Clark
1996	Alexander W. Astin
1995	William Toombs
1994	Robert Silverman
1993	Robert O. Berdahl
1992	K. Patricia Cross
1991	Cameron Fincher
1989	Mary Corcoran
1989	Robert Pace
1987	Lewis Mayhew
1987	Joseph Kauffman
1986	David Riesman
1985	Howard R. Bowen

SPECIAL MERIT AWARD

Presented to a person, group or organization in recognition of distinctive support for the purposes and goals of the Association for the Study of Higher Education. This award may be presented to an influential academic leader or a scholar outside the field of higher education who has offered a valuable perspective for studying and understanding colleges and universities.

2006	United Negro College Fund
2005	Samuel E. Kellams
2004	Jerry Davis/Lumina
2003	University of Michigan Affirmative Action Defense Team
2002	Walter R. Allen
2001	Clifford Adelman
2001	Deborah Wilds
2000	Michael A. Olivas
1995	Lavina Fielding Anderson
1993	Walter Hobbs
1992	Jossey-Bass Inc. Publishers
1990	Peggy Heim
1990	Robert Silverman

ASHE DISTINGUISHED SERVICE AWARD

Presented in recognition of exceptional commitment to the Association for the Study of Higher Education and significant contribution to its success.

2007	Estela Mara Bensimon
2006	Laura Rendón
2005	Carol Everly Floyd
2004	Wynetta Lee
2003	Ann E. Austin
2002	Barbara K. Townsend
2001	Robert O. Berdahl
2000	Mildred Garcia
1999	Philip G. Altbach
1998	Joan S. Stark
1996	Stan Carpenter
1996	Patricia Hyer
1995	Daryl Smith
1993	John C. Smart
1990	L. Jackson Newell
1987	Jonathan Fife

RESEARCH ACHIEVEMENT AWARD

Presented for outstanding contribution to research for an individual whose published research (theoretical, empirical or applied) advances understanding of higher education in a significant way. The Research Achievement Award may acknowledge a body of research or a single piece of meritorious research.

2007	Marcia B. Baxter-Magolda
2006	Frances Stage
2005	Arthur M. Cohen
2004	Judith Glazer-Raymo
2003	Michael T. Nettles
2002	David W. Leslie
2001	John C. Smart
2000	George Kuh
1999	Vincent Tinto
1998	Sheila Slaughter
1997	William G. Tierney
1996	Kenneth A. Feldman
1995	Larry L. Leslie
1994	Michael A. Olivas
1993	Yvonna S. Lincoln
1992	Joan Stark
1991	Ernest Pascarella
1991	Patrick Terenzini
1990	Robert Birnbaum
1989	Jack Schuster
1988	Robert Blackburn
1988	Howard Bowen
1987	Alexander W. Astin
1985	Burton Clark

EARLY CAREER AWARD

Given for a significant body of scholarship or a single extraordinary research achievement by a higher education scholar, and in recognition of potential for future research. This award may also call attention to significant work in progress that has won praise from senior colleagues and support from foundations or government agencies. The Early Career Award, called the Promising Scholar Award in 1989 and 1990, is reserved for individuals who are no more than six years beyond the receipt of their doctoral degree.

2007	Paul D. Umbach
2006	Marybeth Gasman
2005	Brian Pusser
2004	anthony I. antonio
2003	Laura W. Perna
2002	Donald E. Heller
2001	M. Christopher Brown, II
2000	Linda Serra Hagedorn
2000	Lisa Wolf-Wendel
1999	Linda J. Sax
1998	Jennifer Grant Haworth
1997	Rob Rhoads
1996	Eric Dey
1995	Sylvia Hurtado
1995	Elizabeth Whitt
1993	Alberto Cabrera
1993	Patricia Gumpert
1991	Amaury Nora
1990	Frances Stage
1989	Ann Austin

LEADERSHIP AWARD

Given for outstanding leadership in advancing the study of higher education. This award is intended to recognize individuals who bring visibility and support to the field of higher education by demonstrating the contributions of the study of higher education to policy formation, or in gaining substantial resources for research and training in higher education.

2007	Judith Glazer-Raymo
2006	Elaine El-Khawas
2005	Ann I. Morey
2004	Stanley Ikenberry
2003	Kathryn M. Moore
2002	Edward St. John
2001	William Bowen
2000	Ted Marchese
1999	Zelda Gamson
1996	Peter Ewell
1995	Derek Bok
1992	Ernest Boyer
1990	Kenneth P. Mortimer

Council On Ethnic Participation Awards

FOUNDERS' SERVICE AWARD

The purpose of the service award is to recognize two members of the CEP community who have served the CEP in different capacities over the years. Service is defined as activity which supports the CEP and/or fosters inclusiveness in the ASHE organization.

2007	Berta Vigil Laden (posthumously) and Bonita Butner
------	---

MILDRED GARCÍA AWARD FOR EXEMPLARY SCHOLARSHIP

This award is named in honor of Dr. Mildred García, an exemplary scholar whose contributions in the field of higher education continue to raise the bar for academicians and administrators alike. The purpose of this award is to recognize seminal scholarship that focuses on research and issues specifically related to underrepresented populations of color. The CEP award will recognize one junior scholar (non-tenured) and one senior scholar (tenured).

2007	Sylvia Hurtado and Joy Ann Williamson
------	---------------------------------------

Conference Program Chairs

2008	Jay R. Dee
2007	Vicki J. Rosser
2006	Brian Pusser
2005	Deborah Faye Carter
2004	Benjamin Baez
2003	Adrianna Kezar
2002	James Soto Antony
2001	Kate Shaw
2000	Linda Eisenmann
1999	Amaury Nora & Wynetta Lee
1998	Robert Rhoads
1997	Julie A. Caplow
1996	Barbara Townsend
1995	Marilyn J. Amey
1994	L. Jackson Newell
1993	Mildred Garcia
1992	Ann E. Austin
1991	Robert Silverman
1990	Judy Diane Grace
1989	Michael T. Nettles

President Linda Eisenmann
John Carroll University,
leisenmann@jcu.edu

President-Elect Jeffrey Milem
The University of Arizona,
jmilem@email.arizona.edu

Immediate Past President
Linda K. Johnsrud
University of Hawai'i,
johnsrud@hawaii.edu

At-Large Member
Deborah Faye Carter
University of Michigan,
dfcarter@umich.edu

At-Large Member
Marybeth Gasman
University of Pennsylvania,
mgasman@gse.upenn.edu

At-Large Member
Adrianna Kezar
University of Southern California,
kezar@usc.edu

At-Large Member
Kristen Renn
Michigan State University,
renn@msu.edu

Graduate Student Member
Judy Marquez Kiyama
University of Arizona,
jkiyama@email.arizona.edu

Graduate Student
Member Kelly Risbey
University of Minnesota,
risb0012@umn.edu

Legal Counsel
Karen Miksch
University of Minnesota
miksc001@umn.edu

Executive Director
Patricia L. Farrell
Michigan State University,
pfarrell@msu.edu

CPPHE - ex officio
Patricia Yaeger
University of Illinois
pyaeger@illinois.edu

CIHE - ex officio
Heather Eggins
Staffordshire University,
heggins@btinternet.com

CEP - ex officio
Consuella Lewis
University of Pittsburgh,
lewisc@pitt.edu

CAHEP - ex officio
Joshua Powers
Indiana State University,
jpowers3@isugw.indstate.edu

Publications Committee Chair - ex officio
Barbara Townsend
University of Missouri, Columbia
townsendb@missouri.edu

Budget - ex officio
Ralph Kidder
Marymount University
ralph.kidder@marymount.edu

2007-2008	Linda Eisenmann
2006-2007	Linda K. Johnsrud
2005-2006	Estela Mara Bensimon
2004-2005	Sylvia Hurtado
2003-2004	Gary Rhoades
2002-2003	John M. Braxton
2001-2000	William G. Tierney
2000-2001	Ann E. Austin
1999-2000	John Thelin
1998-1999	Laura Rendón
1997-1998	Yvonna Lincoln
1996-1997	George Kuh
1995-1996	Sheila Slaughter
1994-1995	Patrick Terenzini
1993-1994	Elaine El-Khawas
1992-1993	Michael T. Nettles
1991-1992	Shirley M. Clark
1990-1991	Judith Dozier Hackman
1989-1990	Ernest T. Pascarella
1988-1989	Ellen Earle Chaffee
1987-1988	Clifton Conrad
1986-1987	David W. Leslie
1985-1986	Robert Birnbaum
1984-1985	Joan S. Stark
1983-1984	Kathryn M. Moore
1982-1983	Marvin W. Peterson
1981-1982	Joseph F. Kauffman
1980-1981	Howard R. Bowen
1979-1980	Burton R. Clark
1978-1979	Robert O. Berdahl
1977-1978	Kenneth P. Mortimer
1976-1977	C. Robert Pace

2008 Dissertation of the Year Committee

Christopher Morpew, Chair/University of Georgia
Karen Card/University of South Dakota
Michael Harris/University of Alabama
Don Heller/Pennsylvania State University
Peter Magolda/Miami University
Shaun Harper/University of Pennsylvania
Amy Metcalfe/University of British Columbia
Crystal Muhammad/East Carolina University
Jerlando F.L. Jackson/ University of Wisconsin
Lisa Wolf-Wendel/University of Kansas
Lori Patton/Iowa State University
David Weerts/University of Minnesota

2008 Awards Committee

Ronald Opp, Chair/University of Toledo
Bonita Butner/University of Missouri - Kansas City
Frankie Santos Laanan/Iowa State University
Linda Saxe/University of California, Los Angeles
Kelly Risbey/University of Minnesota
Ben Baez/Florida International University
Sharon McDade/George Washington University

2008 Conference Evaluation Committee

Barbara J. Johnson/University of Northern Illinois
Brandon Daniels/Frederick D. Patterson Research
Institute

Adam, Bronwyn	Chen, Rong	Fatima, Nasrin	Hornak, Anne
Adiya, Enkhjargal	Childress, Lisa	Feldmann, Matthew	Howell, Cameron
Agans, Lyndsay	Choudaha, Rahul	Fester, Rachel	Huang, Sheila
Akers, Ryan	Chowdhry, Bhawani Shankar	Finkelstein, Martin	Hubbard, Steven
Aksoy, Hasan	Chung, Anna	Finnegan, Dorothy	Hutcheson, Philo
Alexander-Snow, Mia	Cintron, Rosa	Fishman, Seth	Hyle, Adrienne
Allen, Angela	Colley, Kay	Flora, Bethany	Ignash, Jan
Ambrose, Allison	Collins, Denise	Flores, Emma	Inman, Patricia
Anderson, Christian	Conley, Susanne	Flores, Stella	Jaeger, Audrey
Aper, Jeff	Conley, Valerie	Foubert, John	Janke, Emily
Archer-Banks, Diane	Cook, Jennifer	Frances, Carol	Jankowski, Natasha
Arellano, Eduardo	Cox, Bradley	Francis, Dr Bwambale	Janosik, Steven
Arvidson, Cody	Cox, Rebecca	Mulekya	Jessup-Anger, Jody
Austin, Ann	Coyner, Sandra	Gabauer, Colleen	Jiang, XinQuan
Awe, Clara	Creamer, Elizabeth	Gafford Muhammad, Crystal	Johnson, Barbara
Baber, Lorenzo	Crisp, Gloria	Gajda, Stanley	Johnson, Jason
Baez, Benjamin	Croom, Patricia	Gardner, Susan	Jones, Faye
Bain, Olga	Crume, Allison	Gasman, Marybeth	Joseph, Joretta
Barato, Ruben	Cunningham, Catrina	Gaston Gayles, Joy	Karp, Melinda
Barker, Marco	Curs, Bradley	George-Jackson, Casey	Kasch, David
Barnes, Benita	Cutright, Marc	Giles Jr., Dwight	Kater, Sue
Barnhardt, Cassie	Dancy II, T. Elon	Gill, Judith	Kellett, Pamela
Bartlett, James	Daniels, Brandon	Glazer-Raymo, Judith	Kempner, Ken
Bartlett, Michelle	Dar, Luciana	Goastellec, Gaele	Kennedy, Kirsten
Bartley, Ellen	Davis, Gailda	Gok, Fatma	Khoja, Shakeel
Bassett, Roberta Malee	Davis, R. Deborah	Gonyea, Robert	Kidder, Ralph
Beach, Andrea	Davis, Ryan	Gonzalez, Roger	Kile, Kimberly
Behringer, Laurie	De La Rosa, Mari	Goodchild, Lester	Kim, Dongbin
Bellucci, Debbie	De Sawal, Danielle	Goodman, Kathleen	Kim, Eun Kyung
Bergerson, Amy	Dean, Diane	Goss, III, John	Kim, Eunyong
Bertram Gallant, Tricia	DeAngelo, Linda	Gottlieb, Esther	Kim, Mikyong
Bess, James	Deil-Amen, Regina	Griffin, Kimberly	Kinser, Kevin
Bogue, E. Grady	Delaney, Jennifer	Grim, Jeffrey	Kinzie, Jillian
Boilard, Steve	Delgado, Jorge	Grimes, Mary	Kirby, Catherine
Bonner, II, Fred	Denoya, Laila	Grimstead, Caryn	Kolek, Ethan
Bonous-Hammarth, Marguerite	DesJardins, Stephen	Gross, Jacob	Koslowski, Fred
Boon, Rachel	Diamond, Nancy	Guardia, Juan	Kramer II, Dennis
Bourke, Brian	DiFrancesco, Paul	Gump, Steven	Kulikova, Nadezhda
Bowman, Nick	Dilley, Patrick	Guvercyn, Gokce	Kuntz, Aaron
Braxton, John	Dirkx, John	Haley, Karen	Kupo, V. Leilani
Bray, Nathaniel	Dokter, Christina	Harper, Casandra	Kuykendall, John
Bresciani, Dean	Domingo, Robert	Harper, Shaun	LaNasa, Steven
Brooks, Rachelle	Donahoo, Saran	Harris III, Frank	Lattuca, Lisa
Buckley, Jennifer	Dowd, Alicia	Hart, Jeni	Le, Tam
Buer, Troy	Doyle, Susan	Hayek, John	Lee-Thomas, Gwen
Buffone, Nancy	Doyle, William	Healy, Margaret	Lee, Jenny
Burns, Kimberly	Drezner, Noah	Hearn, James	Leon, Raul
Butner, Bonita	Dubrow, Greg	Heiselt, April	Lester, Jaime
Cabrales, Jose	Duffrin, Christopher	Heller, Donald	Lewis, Consuella
Cain, Timothy	Duggan, Michael	Hendel, Darwin	Ifcomma
Calderone, Shannon	Durand, Francesca	Hendrickson, Robert	Lindsay, Nathan
Cantwell, Brendan	Eagan, Kevin	Hernanowicz, Joseph	Liu, Amy
Cao, Yingxia	Eddy, Pamela	Hernandez, Ebelia	Liu, Sunny
Card, Karen	Edwards, Jennifer	Hernandez, Jeremy	Lohfink, Mandy
Cardona, Julio	Edwards, William	Hillman, Nicholas	Ludwig, Nancy
Carducci, Rozana	Eggleston, Latrice	Hilton, Adriel	Lundberg, Carol
Carter, Deborah	Engberg, Mark	Hirko, Scott	Lundy-Wagner, Valerie
Cawthon, Tony	Espino, Michelle	Hirt, Joan	Lutovsky, Brenda
Ceja, Miguel	Evans, Nancy	Hogendorp, Melanie	Luukkonen, John
Chaddock, Katherine	Everett, Dianne	Holland, Tina	Mabokela, Reitumetse
Chen, Liang	Ewing, Kris	Holley, Karri	Maldonado-Maldonado, Alma
	Fann, Amy	Holmes, Sharon	

Maloney, Patricia	Öztürk, Mehmet 'Dali'	Slocum, Angela	Wilson, Jeffery
Maltzan, Tammy	Page, Helen	Smith, Gilia	Wilson, Maureen
Manning, Kathleen	Palmer, Megan	Soldner, Matthew	Wilson, Meghan
Maramba, Dina	Palmer, Robert	Soo, David	Winkle-Wagner, Rachelle
Marginson, Simon	Parker, Tara	Southerland III, Wallace	Wolf-Wendel, Lisa
Marquez Kiyama, Judy	Pasque, Penny	Southerland, J. Nathaniel	Wolniak, Gregory
Mars, Matthew	Patton, Lori	Sponsler, Brian	Wolter, Bjørn
Martinez-Aleman, Ana	Paulsen, Michael	St. John, Edward	Wolter, Diane
Martinez, Mario	Paulson, Karen	Stage, Frances	Wood, Jonathan
Martinez, Rose	Payne, Jocelyn Lee	Stapel, Christopher	Wood, Melinda
Matveev, Alexei	Payne, Shaunna	Steinmetz, Christian	Wooden, Ontario
Mayhew, Matt	Perez, Rosemary	Stevens, Richard	Worley, Deborah
McClellan, Rhonda	Perna, Laura	Stewart, Dafina	Wright, Dianne
McCoy, Dorian	Pichon, Henrietta	Stimpson, Matthew	Wright, Mary
McDade, Sharon	Pike, Gary	Stinson, Barry	Wuthrich, Christian
McDonald, Lydia	Plazas Snyder, Blanca	Stolz, Katherine	Xu, Yonghong Jade
McDonough, Patricia	Poch, Robert	Stolzenberg, Ellen	Yaeger, Patricia
McKenzie, Crystal	Porter, Stephen	Stone, Jamie	Yakaboski, Tamara
McLendon, Michael	Pourciau, Todd	Summers, Jeff	Yamamura, Erica
McPherson, Ezella	Pusser, Brian	Sun, Jeffrey	Yao, Xiaohong
Medrano, Christianne	Quaye, Stephen	Suspitsyna, Tatiana	Zeligman, Dawn
Medwick, Allan	Rasmussen, Christopher	Szelenyi, Katalin	Zentner Bacig, Karen
Melguizo, Tatiana	Reddick, Richard	Talbur, Susan	Zhang, Liang
Mendez, Jesse	Ren, Jia	Tandberg, David	Zhang, Yanmei
Mendoza, Pilar	Rendon, Laura	Taylor, Catherine	Ziskin, Mary
Mesa, Vilma	Renn, Kristen	Taylor, Jason	Zusman, Ami
Metcalfe, Amy	Richardson, Susan	Teixeira, Pedro Nuno	
Meyer, Katrina	Rios-Aguilar, Cecilia	Teranishi, Robert	
Miles, Jennifer	Rizvi, Fazal	Thomas, Auden	
Miller, Daniel	Roberts, Elaine	Tiao, Ann	
Modica, Shizuka	Rosser, Vicki	Titus, Marvin	
Molasso, William	Rowan-Kenyon, Heather	Toma, J. Douglas	
Molina, Danielle	Rumyantseva, Nataliya	Toutkoushian, Robert	
Moore Gardner, Megan	Ruud, Collin	Tovar, Esau	
Moore, John	Ryan, Charles	Townsend, Barbara	
Morphew, Christopher	Rybka, Kathryn	Trautvetter, Lois	
Mulholland, Shaila	Sá, Creso	Trostel, Philip	
Murray, John	Saddler, Tonya	Tuitt, Franklin	
Myers, Scott	Saenz, Victor	Turner, Caroline	
Nagasawa, Makoto	Sallee, Margaret	Twombly, Susan	
Neider, Xyanthe	Sanders-McMurtry, Kijua	Unluhisarcikli, Ozlem	
Nelson Laird, Thomas	Sandmann, Lorilee	Valimaa, Jussi	
Ness, Erik	Sanford, Gretchen	Van Patten, James	
Neville, Kathleen	Sanford, Thomas	Vander Putten, Jim	
Nilson, Michelle	Santiago, Lilia	VanHecke, JoNes	
Nixon, Andrea	Santos, José Luis	Vann, Melinda	
Nora, Amaury	Saunders, Daniel	VanOverbeke, Marc	
Novack, Vincent	Schmertz, Barbara	Vazquez, Jose	
Nunez, William	Schonfeld, Natalie	Venegas, Kristan	
Nur-Awaleh, Mohamed	Schuh, John	Villarreal III, Pedro	
O'Brien, Jonathan	Schultheis, Luke	Walpole, MaryBeth	
O'Callaghan, Elizabeth	Schulz, Scott	Wang, Wei-ni	
Ogren, Christine	Schuster, Jack	Wang, Xueli	
OHalloran, Kim	Schwartz, Robert	Wanger, Stephen	
Okcabol, Ryfat	Seifert, Tricia	Ward, Kelly	
Olivas, Michael	Shakespeare, Christine	Wartman, Katherine	
Oliver, Diane	Shapiro, Beth	Washington, Latanya	
Oropeza, Maria Veronica	Shollen, S. Lynn	Watson, Jesse S.	
Orsuwan, Meechai	Siegel, David	Watson, Lemuel	
Ortiz, Anna	Silvestre, Gabriela	Weerts, David	
Oseguera, Leticia	Simon, Merrill	Wei, Na	
Osipian, Ararat	Sirianni, Jim	Wells, Amy	
Ousley, Melissa	Slantcheva-Durst, Snejana	Williams, Kristen	

A

Acker-Hocevar, Michele CAHEP
 Akers, Ryan E
 Allen, Walter R. A8, D9
 Amey, Marilyn J. D1, I6, J1-1
 Anderson, Christian K. C5, E, E
 Anderson, Eugene L. CPPHE
 Anderson, Gregory M. B1
 Andrews, Rodney A4
 Antonaros, Mary Edna F5, H11
 Archer, Eric H2
 Archer, Shuli Arieh G9
 Arellano, Lucy K8
 Arimoto, Akira H8
 Arnold, Karen H5
 Arvidson, Cody J. L8
 Asel, Ashley E, K8
 Austin, Ann E. C1, G4, J9
 Autry, Shanna A1-1
 Azizova, Zarrina CIHE
 Azman, Norzairi D10

B

Baber, Lorenzo G10
 Baez, Benjamin L9
 Baird, Leonard F9
 Baker, Karen E
 Balbachevsky, Elizabeth D10
 Baldwin, Roger G. C6, G1
 Banda, Rosie G5
 Bankart, Charles A.S. E
 Banks, Julianna D3
 Banta, Trudy W. J10
 Barajas, Heidi L. J5
 Barber, James P. F8, J2-1
 Barker, Marco J. J6
 Barnes, Benita J. G9
 Barnett, Nicole CAHEP
 Barnhardt, Cassie L. F5, H11, K6
 Bartlett, James G5
 Bartlett, Michelle Elizabeth G5, L3
 Bastedo, Michael K6
 Baxter Magolda, Marcia J9, L8, L8
 Beach, Andrea A10, E
 Bean, John P. A1-1
 Beard, Ryan A7
 Beasley, Sarah J2-1
 Behar-Horenstein, Linda S. J6
 Behnke, Jennifer A1-1, E
 Benitez, Margarita CPPHE
 Bensimon, Estela B1, C12, H10
 Berdahl, Robert CPPHE
 Berger, Joseph K6
 Bergerson, Amy Aldous F10, L7
 Bertram Gallant, Tricia B6, I6
 Bess, James L. D5
 Birnbaum, Matt B7
 Bisaso, Ronald L1
 Black, Karen J10
 Blaich, Charles B8, F8
 Bloomgarden, Alan H. H9
 Boatman, Angela A4
 Bolland, Steve CPPHE
 Bonner, II, Fred A. A1-1, J1-1
 Booker, Jr., Lonnie A2-1, C7
 Boon, Rachel J2-1
 Bower, Beverly L. A6, D12
 Bowman, Nick F8
 Boyd, Karen J5
 Bragg, Debra D. A5, C12, D11, G7
 Braskamp, David H3
 Braskamp, Larry A. H3
 Braxton, John K2, L4
 Bray, Nathaniel J. F6
 Bresciani, Marilee K5

Broido, Ellen J11, L7
 Brown, Elizabeth D9
 Brown, Walter E
 Bryant, Alyssa N. A2-1, G4, I7
 Buckley, Jennifer J6, L8
 Buenavista, Tracy Lachica J2-1
 Buer, Troy E
 Burleson, Douglas A. A2-1
 Burrows, Laura E
 Burton, Lisa J5
 Bush, V. Barbara D8
 Byers, Randy CAHEP

C

Caboni, Timothy A7
 Cabrales, Jose I11, K8
 Cabrera, Alberto F. A7
 Cabrera, Nolan L7
 Cain, Timothy Reese D4
 Calderon Galdeano, Emily E
 Calderon, Dolores J2-1
 Calderone, Shannon H1, J7, L2
 Campbell, Dale E
 Campbell, Eric B3
 Campbell, L. Corbin M. I5
 Campbell, Timothy J1-1
 Capt, Robin F9
 Card, Karen CAHEP
 Carducci, Rozana J8
 Carretta, Patricia CAHEP
 Carter, Deborah F12
 Castleman, Benjamin H5
 Castro-Saia, Erin G10
 Ceja, Miguel D12
 Cerven, Christine E
 Chaddock, Katherine E. A1-1, B5, C5
 Chang, Mitchell James H10
 Chang, Yueh-ching E
 Chapman, David I8
 Chaudhari, Prema D9, D9
 Chen, Rong D3, H1
 Cheslock, John D3, F3
 Chien, Claire I7
 Chiteng Kot, Felly J1-1
 Choudaha, Rahul CAHEP, H6
 Christman, Dana CAHEP
 Chung, Anna A4, C4
 Chung, Jaeyoung E
 Clarke, Robyn J1-1
 Coble, Bridgette CAHEP
 Colbeck, Carol C1, D1
 Cole, Darnell F12, J1
 Cole, James K9, L5
 Collins, Kristin Paredes G5
 Colyar, Julia I9
 Conley, Valerie Martin C7, J4
 Contreras-McGavin, Melissa I6
 Cook, Bryan J. CPPHE
 Cooke, Michael S. F10
 Cooper, Diane J5
 Cooper, Michelle Asha CPPHE
 Corcoran, Heather B2
 Cox, Bradley E. H7, L4
 Cox, Elizabeth E
 Creamer, Elizabeth G. L8
 Crisp, Gloria J6
 Croom, Natasha F4
 Cruce, Ty M. K3
 Crume, Allison H. D12
 Cuevas, Frank J1-1
 Cummings, William D10, H8
 Cunningham, Alisa CPPHE
 Curry, Lynne D11
 Curs, Bradley K4
 Cutright, Marc CAHEP, F2
 Cuyjet, Michael B12, F12

D

Dadashova, Afet K3
 Daly, Cheryl G4, K2
 Dancy II, T. Elon I4
 Dannels, Sharon A6, K10
 Dar, Luciana D2, F4, I3
 Daun-Barnett, Nathan L2
 Davis, Ryan A8, D8, J2-1
 Davison, Mark E
 De La Rosa, Mari Luna G5
 Dean, Diane I5
 DeAnda, Mario H5
 DeAngelo, Linda D6, E
 Dee, Jay R. D1, F7, Keynote
 DeFelippo, Anne M. H2
 Deil-Amen, Regina J. C4, J2-1, L2
 Delaney, Jennifer A. GSPPS, CPPHE, F3, J3
 Dellow, Donald A2-1
 Delmas, Peggy G8
 Demurat, Joanna C10, F10
 Deo, Meera A8
 DesJardins, Stephen GSPPS, A4, G2, K3
 Detwiler, Robert E
 Dey, Eric L. F5, H11, L5
 Diaz, Herman CAHEP
 Dilley, Patrick F11
 Dirkx, John B7
 Dix, Alice J6
 Dixon, Adrienne A2-1
 Djajalaksana, Yenni A2-1, J2-1
 Dolby, Nadine D2
 Dougherty, Kevin CPPHE, J3
 Dowd, Alicia C12, G2, K4, L3
 Dowdall, Jean Keynote
 Doyle, William GSPPS, CPPHE, F3, J3
 Drake, Eron B6
 Drezner, Noah D. A10
 Du, Fang H3
 Dubrow, Greg H5, K5
 Dugan, John P. E

E

Eagan, Kevin A5, C6, K3
 Eddy, Pamela B6, J1-1
 Edvalson, Sherri I. E
 Eggins, Heather CPPHE, A1, J1
 Ehrenberg, Ronald G. B3
 Eisenmann, Linda, Keynote
 Engberg, Mark B8, H5, L4
 Engle, Jennifer CPPHE
 Enke, Kathryn A. E. I7
 Espino, Michelle M. A9, B4, D13
 Espinosa, Lorelle L. J1-1
 Espinoza, Araceli F12
 Esseh, Samuel L1
 Ethington, Corinna A. D3
 Evans, Nancy G6, J11

F

Falconetti, Angela M. J1-1
 Farakish, Negar A5
 Farrell, Patricia L. A1
 Fatima, Nasrin C2
 Faust, Deborah G8
 Feinstein, Jonathon OAS
 Feranchak, Elizabeth CPPHE
 Ferguson, Sarah Kiersten E
 Figueroa, Julie López D13
 Fincher, Mark F10
 Finkelstein, Martin J. CAHEP, H8, J4
 Finkelstein, Noah A10

Finnegan, Dorothy B5, F6
 Fischer, Linda A. J2-1
 Fisher, Donald H8
 Fishman, Seth E
 Fleming, Shezwae H5
 Flores, Stella M. CPHHE, H1
 Flowers, Alonzo K7
 Floyd, Deborah L. A2-1, D12
 Ford III, Obie E
 Fowles, Jacob T. E
 France, Alan CIHE
 Franke, Ray H1, K4
 Frierson, Henry T. C13
 Fries-Britt, Sharon B12

G

Gafford Muhammad, Crystal R. A2-1, C13, G3
 Galaz-Fontes, Jesus F. D10
 Galinova, Elena I4
 Gamez Vargas, Juanita C8, I5
 Gangone, Lynn M. G8
 Gansneder, Bruce L6
 Garcia, Lisa A2-1
 Garcia, Mildred Keynote
 Gardner, Susan K. G9
 Garver, Amy D3
 Gary, Shannon A1-1
 Garza Mitchell, Regina L. K5
 Gasiorski, Anna E, J5
 Gasman, Marybeth CAHEP, B5, C13, E, F1, J1
 Gaston Gayles, Joy A1-1, F7
 George-Jackson, Casey E. F12
 Gildersleeve, R. Evelyn I11, J8
 Giles Jr., Dwight E. CAHEP, F6, I7, J5
 Glazer-Raymo, Judith A6
 Gokalp, Gokce J2-1
 Golde, Christine M. CAHEP, C1
 Gonyea, Robert C2, L5
 Gonzalez Canche, Manuel S. L3
 Gonzalez, Juan Carlos A12, G12
 Gonzalez, Roger G. A4
 Gonzalez-Sullivan, Leila CAHEP
 Goodchild, Lester CAHEP
 Goodman, Kathleen B8, B8, C9
 Graca, Manuel D10
 Griffin, Kimberly A. D7, F7, I10
 Grimstead, Caryn P. L7
 Gross, Jacob P.K. G2, K3
 Guentzel, Melanie J. D5

H

Hagedorn, Linda Serra A9
 Hale, Jessica E
 Haley, Karen CAHEP
 Hall, Mary E
 Hall, Wendell Diedrik B12
 Hallett, Ronald I9
 Hamilton, John E
 Harleston, Bernard Keynote
 Harper, Casandra Elena D7, E
 Harper, Shaun R. A8, C13, F11, H10
 Harris Hamby, Edwina E
 Harris III, Frank C4, F11, H10
 Harris, Michael S. H2
 Hart, Jeni L. E, K10
 Hartley III, Harold V A7
 Hartley, Matthew H9, G11
 Haviland, Don J1-1
 Haworth, Jennifer CAHEP
 Haynes, Robert Michael L5
 Healy, Margaret B6
 Heller, Donald CPPHE, B10, F3

Hendel, Darwin A3, C2
 Henderson, Charles A10, E
 Hendrickson, Robert K7
 Hermsen, Jill A2-1, C7, E
 Hernandez, Ebelia A9, A9, D9
 Hernquist, Angela D12
 Hester, Colleen Keynote
 Hevel, Michael K8
 Hicklen, Sherrell Tamia D9
 Hickmott, Jessica K5
 Hillman, Nicholas F3
 Hirko, Scott R. H2
 Hoffman, David M. D2
 Holland, Christopher J. F11
 Holley, Karri D6, F11, H6, I9
 Holsapple, Matthew A. F5, H11
 Honda, Hirosuke E
 Hoover, Richard B7
 Horn, Aaron A3
 Hornak, Anne M. L7
 Hoskins, SaFiya D. L3
 Hossler, Don G5, K3
 Hovdhaugen, Elisabeth A3
 Howard-Hamilton, Mary G12
 Howe, John A1-1
 Hu, Shouping F7, J7
 Huang, Futao H8
 Hubbard, Steven F9, J2-1
 Humphrey, Jordan R. H2
 Hurtado, Sylvia A2, B1
 Hutchens, Neal H. CPPHE
 Hutcheson, Philo A. A11, D4
 Hyle, Adrienne CAHEP

I

Ignash, Jan M. D4
 Ingram, Ted N. A8
 Inkelas, Karen Kurotsuchi A10, F8, I1

J

Jackson, Jerlando F. L. CAHEP, A6
 Jackson, Judy D1
 Jaeger, Audrey J. A5, D5. G11
 Jain, Dimpal G8
 Jakeman, Rick A2-1
 Jayakumar, Uma G7
 Jenkins, Davis K5
 Jessup-Anger, Jody E. E, G6
 Jia, Cai Lun F10
 Jiang, XinQuan H3
 Jimenez y West, Ilda J2-1
 Johnson, Barbara J. L3
 Johnson, Irene CAHEP
 Johnson, Jason A1-1
 Johnson, Megan P. B8, L6
 Johnson, Susan D. A8
 Johnson, Timothy L3
 Johnson, Valerie L. B6, C3
 Jon, Jae-Eun C2
 Jones, Elizabeth A. C7, J10
 Jones, Faye J1-1
 Jones, Joyce J1-1
 Jones, Susan D9, J5
 Jones, Willis G2

K

Kanada, Mayuko E
 Kasworm, Carol K11
 Kearney, Mary-Louise CIHE
 Kellogg, John E
 Kempner, Ken I9
 Kendall Brown, Marie H3

Keup, Jennifer E
 Kezar, Adrianna J. A1, B6, I6
 Kidder, Ralph A11
 Kienzl, Gregory F12
 Kiessling, Marcia G5
 Kim, Dongbin E, F2
 Kim, Jessica K. G9
 Kim, Jiyun K3
 King, Patricia M. G6, L8
 Kinser, Kevin C1, I8, J1-1
 Kinzie, Jillian L. H7
 Kirby, Dale L5
 Klein, Michael G2
 Kleinheksel, Amanda Joy K6
 Kline, Kimberly CAHEP, J1-1
 Korkmaz, Ali J6
 Kramer II, Dennis H2
 Krusemark, Stephanie L. H6
 Kuh, George D. H7, J6
 Kulikova, Nadezhda A3, F2
 Kuntz, Aaron M. A1-1, J8
 Kuykendall, John A. J1-1

L

Lacagnino, Sara J1-1
 Laguilles, Jerold A7
 Lamarra, Norberto Fernandez D10
 Lane, Jason E. C3, I8, J3, K6
 Larson, R. Sam A10
 Latino, Niki CAHEP
 Lattuca, Lisa R. D6, J9
 Lawrence, Janet C7
 LeBeau, Jenny B7
 Lechuga, Vince A1-1, G1, I6
 Ledesma, Maria F5, J2-1
 Lee, Giljae K7
 Lee, Heesook E
 Lee, Jenny A2, F2, J2
 Lee, John B. I1
 Lee, Jr., John Michael D8
 Lefor, Dean C. C8, J3
 LeMire, Steven C3
 Lesht, Faye F11
 Lester, Jaime F6, I6, I6, K10
 Levin, John E, G7
 Levy, Daniel C. C10
 Lewis, Consuella A1, CPPHE, I2, J1
 Lewis, Nicole R. C13
 Li, Xiaolan E
 Lincoln, Yvonna S. I9
 Lindsay, Nathan K. B8
 Lips, Adam J.A. L2
 Locke, William David H8
 Loftin, Jennifer B11
 Lohse, MaryPat C8
 Long, Bridget Terry A4
 Lopez, Mark A. B12
 L'Orange, Hans D11
 Lott, II, Joe E
 Louis, Michelle F9, L4
 Lozano, Adele G10
 Luca, Sandra J2-1, K3
 Ludwig, Nancy K5
 Lundy-Wagner, Valerie E, E
 Lunsford, Laura Gail D6
 Lupton, Natalie B7
 Lutovsky, Brenda L4
 Luzader, Jordan I7

M

Maher, Michelle A1-1
 Major, Claire F6
 Malcom, Lindsey C12, K4
 Mallinak, Kyle E

Marcelis-Fochtman, Monica E
 Marchese, Ted Keynote
 Marin, Patricia CPPHE
 Marquez Kiyama, Judy A2, C1, I2,
 J1, L6

Marquina, Monica D10
 Mars, Matthew M. A1-1, J5
 Martin, Cindy J4
 Martin, Georgianna L. C9, K8
 Martinez, Mario C. K6
 Martinez, Rose C12, E
 Martinez, Sylvia A9, J4
 Martinez-Aleman, Ana M. B7, G8
 Maruyama, Geoffrey E
 Masse, Johanna B5
 Matus, Claudia I4
 Mayhew, Matt G6, L4
 McCall, Brian P. K3
 McCallum, Carmen H6
 McCarthy, Brittany E
 McCarty, Luise F2
 McClellan, Rhonda CAHEP
 McCormick, Alexander H7
 McCullough, Christopher Allen C7, J10
 McDade, Sharon A6, K10, Keynote
 McDaniels, Melissa G9, J4
 McDonough, Patricia H1

McHale, India D5
 McIntosh, David B11
 McKinniss, Sean C8
 McLaughlin, Gayle A2-1
 McLaughlin, Jean M. K10
 McLellan, Marquerite F7
 McLendon, Michael B10, C3
 Medrano, Christianne I. A9, G6
 Melguizo, Tatiana A4, K4
 Mendez, Jesse H2, J3
 Mendoza, Pilar G9, H2
 Mercedes, Enmanuel J1-1
 Mercer, Leslie E
 Merrill, Kelly G6, H3
 Merriman, Constance L. C6
 Merson, Dan I7
 Mertz, Norma CAHEP
 Merzer, Marion A2-1
 Metcalfe, Amy Scott B3, H8, L1
 Miksch, Karen CPPHE
 Milem, Jeffrey F. CPPHE, F1, J1
 Miller, Jeanne I1
 Miller-Perrin, Cindy I5
 Millett, Catherine B2
 Millora, Lisa J2-1
 Mills, Gordon J1-1
 Mills, John J7

Miner, Dorothy CPPHE
 Minor, James CPPHE
 Mitchell, Alice CAHEP
 Mizuta, Kensuke F2
 Molina, Danielle Knabjian K6
 Monear, Daryl C3
 Montero Hernandez, Virginia G7
 Montoto, Lisette B9, I8
 Moore Gardner, Megan K5
 Moore, John G5, J4
 Moore, Tami L. G5, J4
 Moran, Christy D. G4
 Moran, Peter D5, G4
 Morelon-Quainoo, Carla A8, G12
 Morgan, Julie A1-1
 Moronski, Karen F5, H11
 Morphew, Christopher CPPHE, C3,
 F10, K1

Morris, Phillip E
 Mosqueda, Eduardo H5
 Mrozek, Lawrence J. E
 Mulholland, Shaila D. H5

Mulready-Shick, JoAnn A5, C9
 Muniz, Marcela L3
 Munoz, Susana Maria A9
 Murphy, Maura J. E
 Museus, Samuel D. D7, D7, G7
 Musoba, Glenda Droogsma H1
 Myers, Carrie B. C7, L5
 Myers, Scott M. L5

N

Napier, Percy H5
 Natow, Rebecca J3
 Neider, Xyanthe B9, D2, L3
 Nelson Laird, Thomas D3, H4, J6
 Ness, Erik C. B10, C3
 Nettles, Michael B2
 Neumann, Anna CAHEP, J9
 Neville, Kathleen D7, H4
 Nguyen, Tu-Lien Kim K9
 Nichols, Andrew I7
 Nidiffer, Jana A11
 Niehaus, Elizabeth H9
 Nienhuser, H. Kenny CPPHE
 Nilson, Michelle J. B3
 Niskode-Dossett, Amanda Suniti D3,
 H6

Nolen, Amanda F5
 Nora, Amaury K2
 Norton, Amanda H4
 Novack, Vincent D3
 Nunez, Anne-Marie E
 Nur-Awaleh, Mohamed B9, L1

O

O'Brien, Colleen CPPHE
 O'Callaghan, Elizabeth M. A6
 O'Connor, Amanda E
 Ogren, Christine A. A11
 Okech, Allan C13
 Oleksiyenko, Anatoly I3
 Olivas, Michael GSPPS, CPPHE, C11
 Oliveira, Laura B2, C5
 Olney, Ronald I3
 O'Meara, KerryAnn G11, H9, I5
 Ordorika, Imanol D5
 Orsuwan, Meechai D8, K9
 Oseguera, Leticia H5, K9
 Ott, Molly C7
 Ozaki, C. Casey G7

P

Padgett, Ryan B8, L6
 Palmer, James C. K2
 Palmer, Megan CAHEP
 Palmer, Robert Terry D8, F12, J2-1
 Park, Julie D7, J2-1, K3
 Parker, Tara A5, H10, L6
 Parkins, Leslie D5, G11
 Pascarella, Ernest T. B8, C9, F8
 Pasque, Penny F5, G11, J8
 Pasupathy, Rubini E
 Patton, Lori D. C13, H10, J11
 Paulsen, Michael K3
 Paulson, Karen GSPPS, CPPHE, B10,
 F4, I1
 Peck-Parrott, Kelli J1-1
 Peet, Melissa R. B6
 Pena, Edlyn Vallejo J2-1
 Pérez, Patricia D13
 Perez, Rosemary B5, L8
 Perna, Laura K11
 Perorazio, Thomas E. B3
 Perry, Andre M. I4

Pike, Gary C9, H7
 Pizzolato, Jane D9, D9
 Platt, Eric D4
 Poch, Robert CPPHE
 Polonio, Narcisa A. Keynote
 Ponjuan, Luis B12, I5
 Poon, Oiyann G12
 Posselt, Julie B5, F4
 Postiglione, Gerard D10
 Pourciau, Todd I6
 Powers, Joshua B. CAHEP, A1, B3, B3
 Praphamontripong, Prachayani C10
 Pretlow, Joshua E
 Proper, Eve A1
 Purdy, William C. D4
 Pusser, Brian C11, E, F5, L2

Q

Qi, Wen K9
 Quaye, Stephen John G10, H4, H4,
 L4
 Quinn, Jocey I3
 Quinn, Kate K10

R

Ranchhod, Vimal A4
 Ranero, Jessica I11, J11
 Reams, Angela C9
 Reason, Robert B11, J9, L4
 Redd, Kenneth I11
 Reddick, Richard J. B12
 Reid, Monica K5
 Rendon, Laura I11, L9
 Renn, Kristen F1, J9
 Rew, William J1-1
 Rion, Crystal L. J1-1
 Rios-Aguilar, Cecilia A1-1, D3
 Risbey, Kelly R. A2, C1, I2
 Rivas, Martha A. H6
 Roberts, Kellie J6
 Robinson, Georgeanna A2-1
 Robinson, Thomas E. G7
 Robledo, Andrea A9
 Rocconi, Louis D3
 Rodriguez, Jaime K4
 Rogers, Kimberly R. CPPHE
 Romero, Ana L. B12
 Ronnkvist, Amy B12
 Rooney, Gerard L6
 Ropers-Huilman, Rebecca B11, I7
 Roseboro, Coretta I7
 Rosenberg, Mark CPPHE
 Rosser, Vicki J. C7, D1, F6, I2
 Rowan-Kenyon, Heather A10, F8, L6
 Rumann, Corey F4
 Rybka, Kathryn M. C5
 Ryder, Andy J1-1
 Ryujin, Kristi A12

S

Sá, Creso I3
 Saarinen, Taina D2
 Saddler, Tonya N. C6, E
 Saenz, Victor B12
 Saichaie, Kem B8
 Sakamoto, Robin I8
 Salisbury, Mark H. B8
 Sallee, Margaret Whitney I9, K10
 Saltmarsh, John D5, F6
 Sam, Cecilia G4
 Sandiford, Janice R. L7
 Sandmann, Lorilee D5, I3
 Sanford, Thomas K7

Santiago, Deborah CPPHE
 Santiago, Lilia A8, G12
 Santos, José Luis J1-1
 Sarraf, Shimon H7
 Saunders, Daniel B4, K6
 Scheuch, Kathyrine F7
 Schmidt, Peter B1
 Schoenecker, Craig E
 Schreiner, Laurie A. F9, L4
 Schuetz, Pam E
 Schuh, John H. J1-1
 Schwartz, Robert A. A2-1
 Sderqvist, Minna D2
 Segar, Thomas J5
 Seggie, Fatma Nevra B9, B9
 Seifert, Tricia A. B8, F8, G6
 Shahjahan, Riyad G4, L9
 Shaker, Genevieve CAHEP, C6
 Sharkness, Jessica E
 Sharpe, Dennis L5
 Shaw, Kathleen M. CPPHE, B10, C10, G1
 Shen, Hong D10
 Shim, Woo-jeong F9
 Shin, J.C. H8
 Shotton, Heather J. B4
 Sieman, Ashley CAHEP
 Silas, Juan Carlos C10
 Silvestre, Gabriela Judith A2-1, B4
 Simmerman, Herbert J7
 Simmons, Symone C13
 Sindelar, Peggy CAHEP
 Sirianni, Jim D7, E
 Slaughter, Sheila A7, C11
 Slocum, Angela Jeanette B2
 Slotnick, Ruth C. J2-1
 Smart, John C9, K2
 Smerek, Ryan I6
 Smith, Mark I1
 Smith, Rachel A. H7
 Söderqvist, Minna D2
 Soldner, Matthew A10, H3
 Some, Touorouzou J2
 Song, Hanna J1-1
 Soo, David A7
 Sorber, Nathan M. C5, D5
 Southerland, J. Nathaniel K4
 Sponsler, Brian E
 St. John, Edward CAHEP
 Standard, John R. E
 Stegelin, Amber C. A1-1, B5, E
 Steinmetz, Christian G6
 Stimpson, Matthew C9
 Stivers, Melanie J. B11
 Stolz, Ingo A3
 Stolzenberg, Ellen Bara F7
 Strayhorn, Terrell CAHEP, C4, F12
 Strickland, Shelley R. A4
 Sule, Venice T. L3
 Sulick, Danielle Ferioli G8
 Sun, Chih-Yuan E
 Survillion, Theresa A6
 Suspitsyna, Tatiana A3, G2, L1
 Swan, Amy L6
 Sweitzer, Kyle K7
 Sweitzer, Vicki L. D6
 Syed, Syraj E
 Szelenyi, Katalin A10, H3

T

Talburt, Susan I4, L9
 Tandberg, David GSPPS, B10, G2
 Tankersley-Bankhead, Elizabeth Ann A1-1
 Taylor, Jason L. E

Taylor, Kari L8
 Teranishi, Robert T. D13, I4, K9
 Terenzini, Patrick L4
 Thelin, John K8
 Thomas, Gloria K10
 Thomas, Scott L. CPPHE, D3
 Thompson, Don I5
 Thornton, Courtney G11
 Tierney, William G. I9
 Ting, Layheng J1-1
 Titus, Marvin A. GSPPS, K11, L2
 Toma, J. Douglas K7
 Torres, Vasti A9, C4, G1
 Torres-Olave, Blanca Minerva C2
 Toutkoushian, Robert A4, F3, J4
 Townsend, Barbara K. CPPHE, A1, F6, I2, L2
 Traxler, Julie K9
 Trent, William T. F12, G10
 Trostel, Philip CPPHE, A10, G2
 Tudico, Christopher B5
 Tuitt, Franklin G12, H6, I10
 Turner Kelly, Bridget A1-1
 Turner, Caroline A12, D1, Keynote

U

Umbach, Paul B8, C5, D3, K11

V

Valimaa, Jussi D2
 Vander Putten, Jim CPPHE, F5
 Vandover, Fritz CPPHE
 VanHecke, JoNes R. B8
 Vasquez, Philip I11
 Vasquez-Heilig, Julian B12
 Vega, Blanca CPPHE
 Venters, Monoka A6
 Vergoth, Veronica F5, H11
 Villarreal III, Pedro G2
 Vincent, Gregory E
 Volkwein, J. Fredericks C8, K7
 Vue, Rican D9, K9
 Vultaggio, Julie E, E

W

Wakhungu, Phoebe G5
 Walczak, Kelley K. F9, J2-1, L8
 Walker, Keith C8
 Wallace, Lisa A9
 Walpole, MaryBeth H5, J7
 Walsh, Erin J. CPPHE, E
 Wang, Meng CIHE
 Wanger, Stephen P. CIHE, CAHEP
 Wanjera, Fred A1-1
 Ward, Kelly H9
 Wartman, Katherine L. B7, H5
 Waterman, Stephanie B4
 Watford, Tara C12
 Watson, Jesse S. B11, L7
 Wawrzynski, Matthew H7
 Weerts, David John A7, CPPHE, GSPPS, F3, G11
 Wei, Na A3, B1, J2
 Weidman, John C. B2
 Wells, Amy D4, E
 Wildman, Terry M. J9
 Williams, Elizabeth A. G9
 Williams, Patricia E
 Willmer, Wesley A7
 Wilson, Kristin Bailey L2
 Wilson, Meghan J7
 Winkle-Wagner, Rachelle C13, G8
 Wolf-Wendel, Lisa CAHEP, A8, J7

Wolniak, Gregory C. H5, K4
 Wolverton, Mimi D12, K6
 Wood, Jonathan A12
 Woodell, James D5
 Wooden, Ontario Sherrod F4
 Woodruff, Maria Luisa A8
 Worley, Deborah L. E
 Wright, Carol I10
 Wright, Dianne Avery CAHEP
 Wright, Mary I5
 Wuthrich, Christian K. H9, K8
 Wyatt, Adam Thomas McLean D2

Y

Yaeger, Patricia M. CPPHE, A1
 Yamamura, Erica C4, H4, I4, J2-1
 Yanagiura, Takeshi F2
 Yang, Lijing B2
 Yeung, Fanny D7
 Yokoyama, Keiko J2
 Young, Jr., William Wayne J5
 Yu, Mandi D3

Z

Zamani-Gallaher, Eboni A5
 Zentner Bacig, Karen D6
 Zha, Qiang E
 Zhang, Jingning J2
 Zhang, Liang A2, B3
 Zhang, Li-fang D10
 Ziskin, Mary B4, G5, K11
 Zumeta, William C10

- American Educational Research Association (AERA)
- Association for Institutional Research (AIR)
- Emerald Group Publishing Ltd.
- Harvard University Press
- Jossey-Bass
- Lumina Foundation for Education
- National Education Association (NEA)
- National Resource Center for the First-Year Experience and Students in Transition
- Open University Press (A McGraw-Hill Company)
- Pearson Learning Solutions
- Rossier School of Education, University of Southern California
- Routledge (A Taylor and Francis Group – an informa business)
- Sage Publications
- SAS Software
- Springer Publishing
- Stylus Publishing LLC
- The American Education Corporation
- The Center for Postsecondary Research at the Center for Postsecondary Research – Indiana University
- The John Hopkins University Press
- Open University Press (A McGraw-Hill Company)
- Sage Publications
- Routledge (A Taylor and Francis Group)
- American Educational Research Association (AERA)
- SAS Software
- Harvard University Press
- Association for Institutional Research (AIR)
- Stylus Publishing LLC



**ASSOCIATION FOR
INSTITUTIONAL RESEARCH**

**AIR IS YOUR SOURCE FOR INFORMATION,
NETWORKING AND PROFESSIONAL
GROWTH AT EVERY LEVEL OF YOUR CAREER
DEVELOPMENT.**

**THAT IS WHY AIR OFFERS INSTITUTES, WEBINARS,
WORKSHOPS, PUBLICATIONS AND IPEDS TRAINING
PROGRAMS EXCLUSIVELY FOR FACULTY, GRADUATE
STUDENTS AND IR PROFESSIONALS IN HIGHER EDUCATION.**

<http://airweb.org>



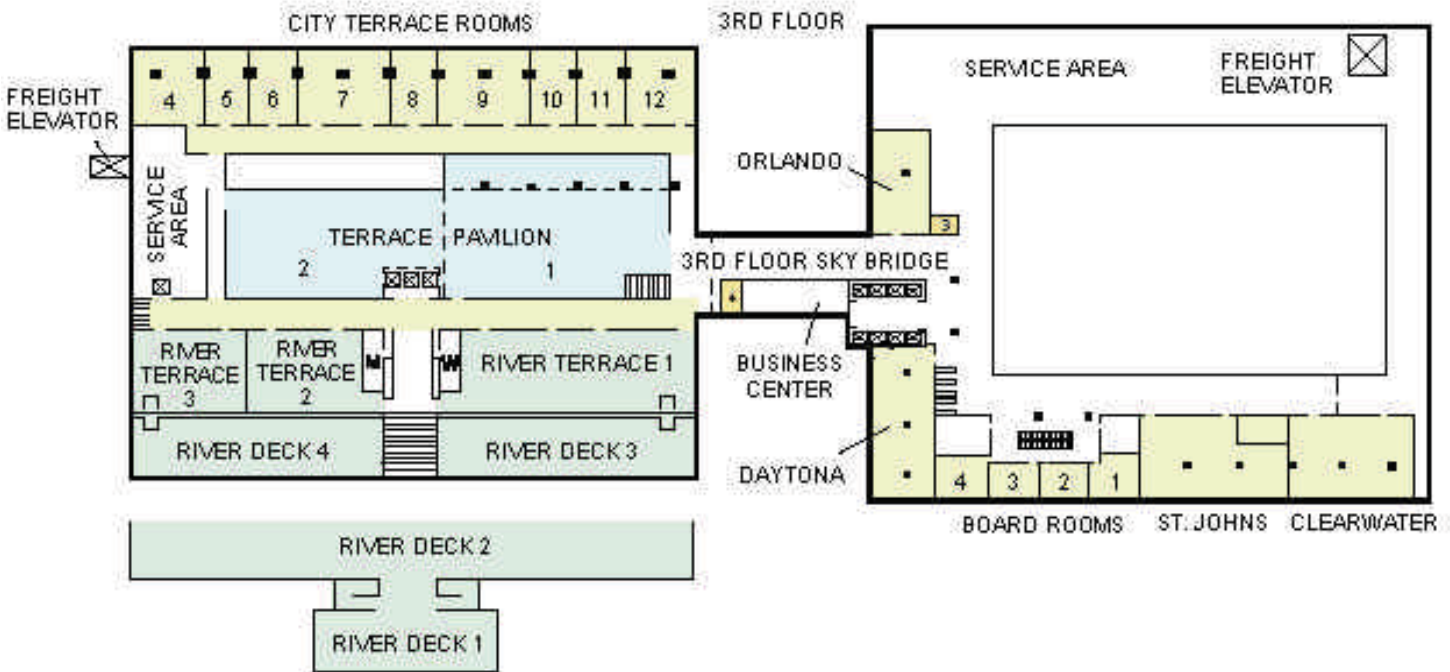
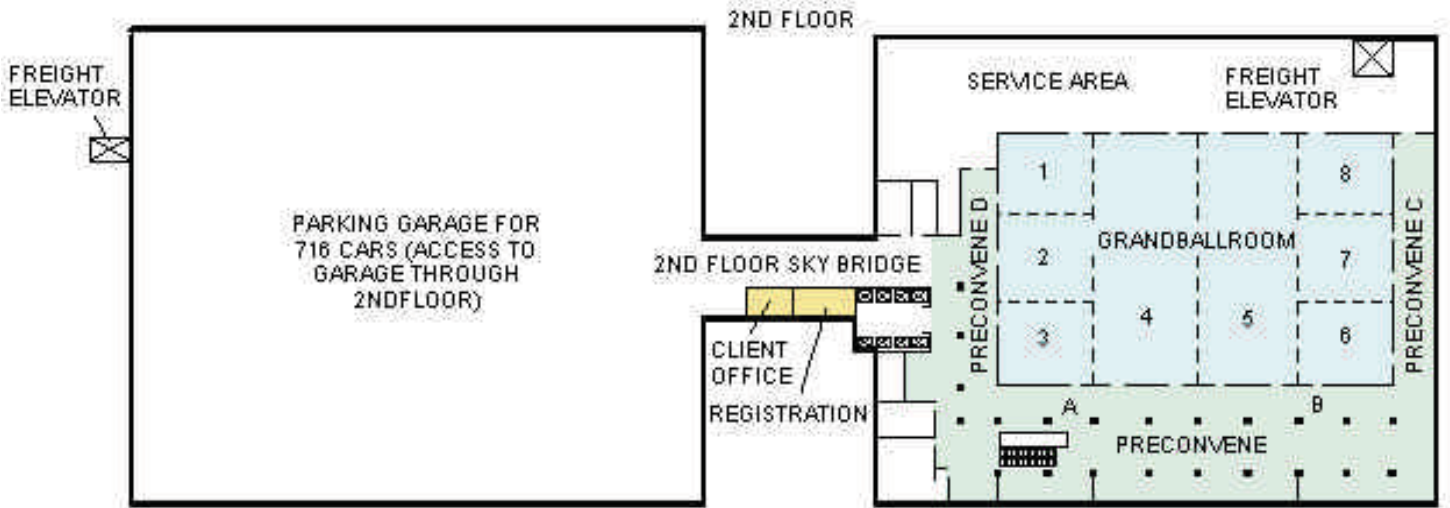

The Association for the Study of Higher Education would like to thank the 64
following Sponsors for their support of the annual conference.

Platinum (\$5,000 and up)



Silver (\$1,000 to \$2,499)

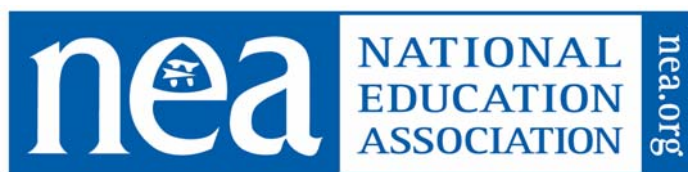

PENNSYLVANIA STATE UNIVERSITY



Center for the Study of Higher Education

Bronze (\$250-\$999)

