

ASHE  *Association
for the Study
of Higher
Education*

31st Annual Conference

Anaheim, California

**Borderlands
Borderlines**
in Higher Education

2006

Preconference Nov 1-2
Conference Nov 2-4

Welcome.....	3	2006 ASHE/Lumina Foundation for Education	
Highlights.....	4	Dissertation Fellows	39
Presidential Sessions	6	Bobby Wright Dissertation of the Year Award..	40
Foundation Support	6	ASHE Award Winners	42
Major Addresses.....	6	2006 Board of Directors	43
Graduate Student Public Policy Seminar	7	Past Presidents	43
International Forum	8	Proposal Reviewers	44
Public Policy Forum.....	11	Index of Participants	46
Annual Conference		Hyatt Regency OC Floor Plan	51
Newcomers Orientation.....	12		
Concurrent Session A.....	12		
Concurrent Session B	15		
Presidential Address.....	17		
ASHE Welcome Reception	17		
Concurrent Session C	18		
Concurrent Session D	20		
Awards Luncheon.....	22		
Concurrent Session E (Posters).....	22		
Concurrent Session F.....	24		
Concurrent Session G	26		
Keynote: Suarez-Orozco	27		
Concurrent Session H	28		
Keynote: Garcia.....	30		
Concurrent Session I.....	30		
Concurrent Session J.....	32		
Concurrent Session K	35		
Concurrent Session L.....	37		
ASHE Community Meeting.....	38		

Executive Office Staff

Executive Director
Dennis F. Brown

Director for Administration
Shannon M. Brandt Brecheisen

Graduate Student Assistants
Jesse S. Watson, ASHE
Matt Van Alstine, Lumina

Association for the Study
of Higher Education
Michigan State University
424 Erickson Hall
East Lansing, MI 48824

Voice: 517-432-8805
Fax: 517-432-8806
Email: ashemsu@msu.edu
Website: www.ashe.ws

Dear Colleagues,

We are very pleased to welcome you to the 31st Annual Meeting of the Association for the Study of Higher Education, the leading scholarly society dedicated to higher education as a field of study. Inspired by the demographic changes occurring across the United States, this year's conference theme is Borderlands/Lines in Higher Education. Our keynote speakers are Dr. Juliet Garcia and Dr. Marcelo Suarez-Orozco. Dr. Juliet Garcia is the President of the University of Texas at Brownsville and Texas Southmost College. Dr. Garcia is a leader whose vision and accomplishments embody the good that can come from the fusion of different cultures and identities. Professor Suarez-Orozco is the Courtney Sale Ross University Professor of Globalization and Education at The Steinhardt School of Education, New York University and is internationally recognized for his research on Asian, Afro-Caribbean, and Latino immigrant youth in American society. There are also several presidential sessions featuring prominent scholars on current issues impacting higher education, as well as sessions designed to address the graduate student experience in higher education.

We are very grateful to the Program Committee members and to Scott Lloyd for the time they dedicated to the review of over 800 proposals and for their assistance in the development of the program and taking care of small and not so small details.

Estela Mara Bensimon
ASHE President
University of Southern California

Brian Pusser
2006 Program Chair
University of Virginia

2006 Program Committee

Program Chair

Brian Pusser/University of Virginia

International Forum

Heather Eggins/Staffordshire University

Public Policy Forum

Kathleen M. Shaw/Pennsylvania
Department of Education

Organization and Administration

Alma Maldonado-Maldonado/The
University of Arizona
Crystal Gafford Muhammad/East
Carolina University
Joseph B. Berger/University of
Massachusetts

Teaching, Learning, and Curriculum

Alicia Dowd/University of Southern
California
Judy Ouimet/University of Nevada,
Reno

Faculty

Joanne Cooper/University of Hawaii
Ken Kempner/Southern Oregon
University

Contexts and Foundations

John Thelin/University of Kentucky
Kirsten Turner/University of Kentucky

Policy, Finance, and Economics

Marvin Titus/North Carolina State
University
William Ashby/University of Virginia
Frances Contreras/University of
Washington

Methodology and Assessment

Paul Umbach/University of Iowa
Vicki Rosser/University of Missouri,
Columbia
Kenneth Redd/Council of Graduate
Schools

Students

Leticia Oseguera/University of
California, Los Angeles
Shaun R. Harper/The Pennsylvania
State University
Heather Wathington/University of
Virginia
Robert Teranishi/New York University

"Open"

Imanol Ordorika/Universidad Nacional
Autónoma de México
Dudley Doane/University of Virginia

ASHE Graduate Student Representatives

Kimberly R. Rogers/University at Buffalo
Ashley Mouberry Sieman/North Carolina
State University

Conference Evaluation

Barbara Johnson/Jackson State
University
Marietta Del Favero/University of New
Orleans

Pre-Conferences

Council on International Higher Education

Wednesday, 9:30am - 5:35pm
Thursday, 8:00am - 12:05pm
Pacific

Council on Public Policy in Higher Education

Wednesday, 8:00am - 8:00pm
Garden 2/3
Thursday, 8:00am - noon
Garden 3

Graduate Student Public Policy Seminar

Wednesday, 12:30pm - 9:00pm
Thursday, 8:00am - Noon
Garden 1

Council for the Advancement of Higher Education Programs

Wednesday, 7:15pm - 9:15pm
Garden 4
Thursday, 8:30am - Noon
Garden 2

ASHE/Lumina Foundation for Education Fellowship Program

Wednesday, 1:00pm - 5:30pm
Imperial
Wednesday, 6:00pm - close
Regal/Royal Foyer
Thursday, 8:00am - noon
Imperial
(By Invitation Only)

Meetings

Thursday

Board of Directors

8:00am - Noon
Barcelona

Newcomers' Orientation

11:45am - 12:45pm
Harbor

Council on Ethnic Participation Business Meeting

7:30pm - 8:30pm
Salon 7/8

Friday

Publications Committee Meeting

7:00am start
Salon 7

Journal of Higher Education Advisory Meeting

7:00am - 8:15am
Salon 4

Council for the Study of Community Colleges (CSCC) Board Meeting

8:00am start
Salon 6

Review of Higher Education Editorial Board

1:00pm start
Salon 2

Higher Education Colloquium

1:00pm - 3:00pm
Terrace A-C

Saturday

2007 Program Committee

8:00am start
Salon 4

ASHE Reader Series Meeting

11:30am - 1:30pm
Salon 2

ASHE Monograph Series Advisor Board Meeting

11:00am - 1:00pm
Barcelona

ASHE Community Meeting

(Open to ALL)
6:30pm - 7:30pm
Terrace Plaza

Sunday

Board of Directors

8:00am - Noon
Barcelona

Graduate Student Meetings & Sessions

Thursday

Newcomers' Orientation

11:45am - 12:45pm

Harbor

The Job Search: Academic versus Non-Academic Positions (A10)

1:00pm - 2:30pm

Garden 3

Friday

Getting Published as a Graduate Student (G10)

3:30pm - 4:45pm

Pacific

Saturday

Graduate Student Luncheon/Establishing Yourself as a Professional within the Field of Higher Education (I10)

11:30am - 1:00pm

Garden 3

Receptions

Wednesday

International and Policy Reception, Institute of Higher Education, University of Georgia and Lumina Foundation for Education

Council on Public Policy in Higher Education

Graduate Student Public Policy Seminar

Council on International Higher Education

6:30pm - 8:30pm

North Tower Garden Terrace & Pool

Thursday

ASHE Welcome Reception

6:30pm - 7:30pm

North Tower Garden Terrace & Pool

Reception given by SUNY Albany's CIEPP and PROPHE and the University at Buffalo's ICEFAP

7:00pm - 9:00pm

Garden 4

Council on Ethnic Participation Reception

Co-Sponsored by Iowa State University, Educational Leadership & Policy Studies

8:30pm - 11:00pm

Garden 3

Friday

Rossier School of Education, University of Southern California

6:30pm - 8:30pm

Garden 3

Michigan State University

7:00pm - 8:30pm

Garden 1

Vanderbilt University

7:00pm - 9:00pm

Garden 4

New York University

8:00pm - 9:30pm

Garden 2

Council for the Study of Community Colleges (CSCC)

8:30pm - 10:00pm

Salon 5

NAFTA and Higher Education Markets: The Invisible Hand Revealed (A4)

November 2, 1:00pm - 2:30pm
Garden 4

Behind the Borders of Access and Equity: Educational Disparities Among College Men of Color (B10)

November 2, 2:45pm - 4:15pm
Garden 4

Promises to Keep: Financial Aid, College Access, and Democratic Participation (C11)

November 3, 8:00am - 9:30am
Garden 4

Admissions & Omissions: How "The Numbers" are used to Exclude Deserving Students (D9)

November 3, 9:45am - 11:15am
Garden 4

Darnell Hunt
University of California at Los Angeles

The Effects of Katrina on the Academic and Life Experiences of Students and Faculty (F5)

November 3, 2:00pm - 3:15pm
Garden 4

Higher Education Journals in the 21st Century (H4)

November 4, 8:00am - 9:30am
Grand Ballroom E

Emerging Perspectives on Student Success (J8)

November 4, 1:15pm - 2:45pm
Garden 4

Foundation Support

ASHE would like to recognize the following foundations for their contribution in support of the Annual Conference

Bill & Melinda Gates Foundation

the James Irvine foundation



LUMINA
FOUNDATION FOR EDUCATION



W.K. KELLOGG
FOUNDATION

Addresses ■ Grand Ballroom A

Presidential Address:

The Underestimated Significance of Practitioner Knowledge in the Scholarship on Student Success

Estela Mara Bensimon

Professor
University of Southern California
Director, Center for Urban Education
Thursday, November 2, 4:30pm - 6:00pm

Migration and Education in the Global Era

Marcelo Suarez-Orozco

Courtney Sale Ross University Professor of Globalization and Education,
New York University
Friday, November 3, 5:00pm - 6:30pm

Blurring the Borders

Juliet V. Garcia

President
University of Texas at Brownsville & Texas Southmost College
Saturday, November 4, 9:45am - 11:15am

Wednesday, November 1

Garden 1

12:30pm - 1:00pm

Registration

1:00pm - 1:30pm

Welcome and Introductions

Michael McLendon/Vanderbilt University
Estela Bensimon/University of Southern California

1:30pm - 2:45pm

Session I: State Policy Privatization in Higher Education

Michael McLendon/Vanderbilt University
Christopher Morpew/University of Georgia

2:45pm - 3:00pm

Break

3:00pm - 4:00pm

Session II: Access Challenges for Underrepresented Populations: What's the Problem? Where is the Solution?

Frances Contreras/University of Washington
Don Heller/The Pennsylvania State University

4:00pm - 4:10pm

Break

4:10pm - 5:00pm

Session III: Discussion of Participants' Higher Education Policy Projects

Michael McLendon/Vanderbilt University
Karen Paulson/National Center for Higher Education Management Systems (NCHEMS)

5:00pm - 6:30pm

Session IV: Joint Symposium with ASHE Public Policy PreConference: K-16 Policy Environments: Taking the Bitter with the Better

Patricia Maloney/Change & Sustainability in Higher Education
DeWayne Morgan/Education Equals Mentoring, Coaching & Cohorts
William Badders/Cleveland Mathematics Science Partnership
James Hamos/National Science Foundation
Nancy Shapiro/University System of Maryland
Donald Langenberg/University of Maryland

6:30pm - 7:30pm

North Tower Garden Terrace & Pool

International and Policy Reception

Graduate Student Public Policy Seminar
Council on Public Policy in Higher Education
Council on International Higher Education

Sponsored by the Institute of Higher Education, University of Georgia and Lumina Foundation for Education

7:30pm - 9:00pm

Session V: Dinner Presentations: Bridging the Worlds of Academic and Applied Policy Research: Conversations with Policy Scholars

Laura W. Perna/University of Pennsylvania
Nancy Shulock/California State University, Sacramento
M. Christopher Brown, II/American Association of Colleges for Teacher Education and The Pennsylvania State University

Thursday, November 2

Garden 1

8:00am - 8:30am

Continental Breakfast

8:30am - 10:00am

Session VI: How States Develop A Public Agenda for Higher Education

Karen Paulson/National Center for Higher Education Management Systems (NCHEMS)

10:00am - 10:15am

Break

10:15am - 11:30am

Session VII: New Experiments in State Postsecondary Governance & Finance

David Leslie/College of William and Mary
Matthew Gianneschi/Colorado Commission on Higher Education

11:30am - Noon

Wrap Up and Evaluation

Wednesday, November 1

Pacific

9:30am

Welcome

*Heather Eggins/Staffordshire University, United Kingdom
Program Chair*

9:45am – 11:00am

Plenary Symposium

Rethinking and Re-imagining Rankings: Multiple Models for World Class Universities

Gary Rhoades/The University of Arizona
Robert Birnbaum/University of Maryland
Simon Marginson/Monash University, Australia
Imanol Ordorika/Universidad Nacional Autonoma de Mexico

11:10am - 12:20pm

Keynote Speaker

Globalizations and Higher Education: Ethical and Political Tensions

Chair: Robert A. Rhoads/University of California, Los Angeles

Carlos Alberto Torres/University of California, Los Angeles

Torres is Professor of Social Sciences and Comparative Education at the Graduate School of Education and Information Studies. He is also the Founding Director of the Paulo Freire Institute in São Paulo, Brazil, the Paulo Freire Institute in Argentina, and the Paulo Freire Institute at UCLA. Research interests focus on education policies and practices in Latin America and the political sociology of education. Most recent research focuses on the context and impact of globalization policies in the lives of teachers in several countries.

12:20pm - 1:30pm

Lunch Break

1:30pm – 5:35pm

Posters

Harbor

1. *From Affirmative Action to Meritocracy in Malaysian Higher Education: The Process of Matrikulasi and enduring Issues of Equal Access*

Sherene Cheah/University at Buffalo, SUNY

2. *A College Choice Model for International Graduate Students: East Asian Students' Choice of Canadian Graduate Schools*

Liang-Hsuan Chen/University of Toronto, Scarborough

3. *The Intersection of the Government, Free Market, and the Third Sector in Chinese Educational Philanthropy*

Noah Drezner/University of Pennsylvania

4. *Internationalizing Campus: Institutional Policy and International Student Programs at the University of Dar es Salaam, Tanzania*

Amy Jamison/Michigan State University

5. *Quality Assurance in Irish Universities*

Jean McLaughlin/The George Washington University

6. *Academic Context, Performance and Productivity: An Analogy between American and Mexican Higher Education Institutions*

Rosalba Pinto/Universidad Autonoma de Baja California

Graciela Cordero-Arroyo/Universidad Autonoma de Baja California

Jesus Galaz-Fontes/Universidad Autonoma de Baja California

7. *Campus Religious Climate: Muslim International and Muslim American Students*

Gretchen Sanford/Michigan State University

Fatma Nevra Seggie/Michigan State University

8. *Affirmative Action in Brazilian Universities: A case Study of Admissions Quotas at the State University of Rio de Janeiro (UERJ)*

Jenee Slocum/University of California, Los Angeles

9. *Academic Integrity in Romanian Universities: A Survey of Student Opinions in Bucharest's State Universities*

Daniel Teodorescu/Emory University

Tudorel Andrei/Academy of Economic Studies, Bucharest, Romania

1:30pm - 2:45pm

Symposium: Cost-Sharing in Contemporary Africa: Variations on Tuition Fees and Financial Assistance in North Africa, East Africa, and Francophone West Africa (Burkina Faso)

Salon 7

Chair: Carol Frances/Seton Hall University and Claremont Graduate University

D. Bruce Johnstone/University at Buffalo, SUNY

Pamela N. Marcucci/University at Buffalo, SUNY

Mary Ngolovoi/University at Buffalo, SUNY

Ali Ait Si Mhamed/University at Buffalo, SUNY

Manar Sabry/University at Buffalo, SUNY

Touorouzou Some/University at Buffalo, SUNY

Paper Session A

Pacific

Chair: Alma Maldonado-Maldonado/The University of Arizona

How is Mexican Faculty been Trained? A National Perspective and a Case Study

Laura Padilla/Autonomous University of Aguascalientes

Learning Centers, Faculty Change, and Student-Centered Learning for the Learning College: A Case Study of a British Model

Christina Dokter/Michigan State University

Building The Case For The Efficacy Of Teaching As The Highest Priority Of Tenure And Promotion: Fulbright Study Analysis of African Higher Education Practices and its Influence upon HBCU Faculty

Artist Thornton/University of North Texas

Lenoar Foster/Washington State University

Paper Session B

Salon 8

Chair: Jussi Valimaa/University of Jyväskylä

Planning for the Internationalization of Higher Education in the U.S.: A Critical Assessment of Institutional Planning Documents for Internationalization

Lisa Childress/The George Washington University

Study Abroad and Ethnic Identity Development in an era of Globalization

Miloni Gandhi/University of California, Los Angeles

Broaching Borders: American Undergraduate Students Experience Venezuelan Culture through an Engineering Research Project.

Gwen Lee-Thomas/Old Dominion University

Stephanie Adams/National Science Foundation

2:55pm - 4:10pm

Symposium: Globalization and Crossborder Higher Education: Beyond the Monolithic and Inevitable Myth

Salon 7

Chair: Mary Ann Sagaria/University of Denver

Alma Maldonado-Maldonado/The University of Arizona
Xiaohong Yao/The University of Arizona
Simon Marginson/Monash University, Australia
Brendan Cantwell/The University of Arizona
Jenny Lee/The University of Arizona
Sandra Guillen/The University of Arizona
Roberta Malee Bassett/University of Southampton, CHEMPaS

Paper Session C

Pacific

Chair: Alexie Matveev/Norfolk State University

European Higher Education Reforms for the Public and Private Good: A Content Analysis of Public Policies
Karen Card/University of South Dakota

Public-Private Connections: A Comparative Analysis of Emerging Trends in Public Higher Education in Kenya and Uganda
Truphena Choti/University of Maryland, College Park

Tensions between Accountability and Autonomy in Chinese, Hong Kong and Singaporean Universities

Jan Currie/Murdoch University
Lesley Vidovich/University of Western Australia
Rui Yang/Monash University

Paper Session D

Salon 8

Chair: Judith Glazer-Raymo/Teachers College, Columbia University

Una Mirada a los Esfuerzos de Affirmative Action en el Mundo: A Review of "Affirmative Action" Efforts in the World
Christine Shakespeare/New York University
Anely Ramirez/New York University

Gender Stratification in Japanese Higher Education: The Private Role
Makoto Nagasawa/SUNY Albany

How Social Stratification Structures Higher Education Opportunities in the Transitioning Chinese Society
Lan Gao/University of Maryland, College Park

4:20pm – 5:35pm

Symposium: Global Capitalism, Neoliberalism, and the University: Case Studies from Around the World

Salon 7

Chair: Simon Marginson/Monash University, Australia

Shannon Calderone/University of California, Los Angeles
Robert Rhoads/University of California, Los Angeles
Katalin Szelenyi/University of California, Los Angeles
Jenee Slocum/University of California, Los Angeles

Paper Session E

Pacific

Chair: Susan Twombly/University of Kansas

Higher Education Internationalization in Taiwan: Policy Archaeology Analysis and Critical Reflections

Cheng-Cheng Yang/National Chung Cheng University

Higher Education Corruption: A Comparative Analysis of Kyrgyzstan and Ukraine

Joseph Stetar/Seton Hall University

Bin Cheng/Seton Hall University

The Changing Nature of Research Management at Universities in the Netherlands, South Africa, and the United Kingdom

Tembile Kulati/University of Twente

Liudvika Leišytė/University of Twente

Round Table Session A

Harbor

Table 1: *Soaring Beyond Boundaries: Gender and Education in a Global Context*

Reitumetse Obakeng Mabokela/Michigan State University

F. Nevra Seggie/Michigan State University

Na Wei/Michigan State University

Wei-ni Wang/National Chung Cheng University

Christina Dokter/Michigan State University

Fatma Abdulla/Sharjah Higher Colleges of Technology

Sharon Karkehabadi/College of William and Mary

Norseha Unin/Michigan State University

Table 2: *Intellectuals, Scholars, and University Leaders in Africa:*

Their Role in Building a Positive Image of the Continent

Margaret Asalele Mbilizi/Northern Illinois University

Cedrick Ngalande/University of Southern California

Table 3: *Low-profile / Demand-Absorbing Private Higher Education Institutions and Equity in Mexico*

Juan Carlos Silas Casillas/Universidad de Monterrey

Table 4: *Markets and Private Higher Education: Comparing Developments in Chile and China*

Anely Ramirez/New York University

Wanbing Shi/Northeastern, China

Richard Richardson/New York University

Table 5: *A Mighty Big Thing: Collaborative Course Development Between the University of South Africa and Thomas Edison State College*

Michael Klein/New York University

Table 6: *The Changing Status of the PhD Degree in Russia: An Academic Attribute in the Non-Academic Labor Market*

Anna Smolentseva/Moscow State University

6:30pm - 8:30pm

North Tower Garden Terrace & Pool

International and Policy Reception

Graduate Student Public Policy Seminar

Council on Public Policy in Higher Education

Council on International Higher Education

Sponsored by the Institute of Higher Education, University of Georgia and Lumina Foundation for Education

Thursday, November 2**7:30am - 8:00am****Continental Breakfast**

Harbor

8:00am – 9:15am**Symposium: Access, Equity and Educational Reform from International Perspectives**

Salon 7

Chair: Reitumetse Obakeng Mabokela/Michigan State University

Mohamed Nur-Awaleh/Illinois State University

Fatma M. Abdulla/Higher Colleges of Technology of United Arab Emirates

Tak Cheung Chan/Kennesaw State University

Lemuel Watson/Northern Illinois University

Margaret Asalele Mbilizi/Northern Illinois University

Tetyana S. Koshmanova /Western Michigan University

Paper Session F

Pacific

*Chair: Gary Rhoades/The University of Arizona**Public / Private Dynamics in Graduate Education: Examples from Latin America*

Pablo Landoni/Catholic University of Uruguay

Waiting for the Tide to Change? Strategies for Survival of Portuguese Private HEIs

Pedro Teixeira/CIPES and University of Porto

Political Economy of Massification of Higher Education in South Korea: Public Policy Choice on Elitism versus Accessibility and Private-Public Mix

Sunwoong Kim/University of Mary Washington

Paper Session G

Salon 8

*Chair: Dorothy Finnegan/The College of William and Mary**Navigating the Murky Waters of International Policy and Structures: A Case Study of a Transnational Tertiary Institution*

Jason Lane/University of North Dakota

Empirical Evidence for Distinct Dimensions of Internationalization in U.S. Research Universities

Aaron Horn/University of Minnesota, Twin Cities

Darwin Hendel/University of Minnesota

Gerald Fry/University of Minnesota

Fallen from Grace: With Global Competition Increasing, America Feels Pressure to Make a Move

Stephanie Raible/University of Pennsylvania

9:25am – 10:40am**Round Table Session B**

Harbor

Table 1: The Effect of the Introduction of the External Quality Mechanism on Governance, Management, and Leadership in Japan

Keiko Yokoyama/RIHE Hiroshima University

Table 2: Skewed Realities? Crossing Borders and Boundaries in Qualitative Research

Laura Portnoi/California State University, Long Beach

Table 3: Comparative Higher Education: A Focused Dialogue on its Pedagogy

Dorothy Finnegan/The College of William and Mary

Alma Maldonado-Maldonado/The University of Arizona

Lisa Heuvel/The College of William and Mary

Charles Rice/The University of Arizona

Roberta Malee Bassett/University of Southampton

Table 4: The Academic Profession in the Age of Globalization

Reitumetse Obakeng Mabokela/Michigan State University

Carol Colatrella/Georgia Institute of Technology

Elizabeth Balbachevsky/University of São Paulo

Anna Smolentseva/Moscow State University

Nelly P. Stromquist/University of Southern California

Paper Session H

Pacific

*Chair: Simon Marginson/Monash University, Australia**American Models and European Policies: The Career of the Short-Cycle Foundation Degree*

Gareth Parry/University of Sheffield

The Competitive Horizons of European Higher Education: Empirical Insights on the Globalization of Higher Education

Jussi Valimaa/University of Jyväskylä

David Hoffman/University of Jyväskylä

An International Perspective on Access and Equity in Higher Education: Policy and Performance in Selected National Systems

Gaele Goastellec/University of Lausanne, Switzerland

Patrick Clancy/University College Dublin, Ireland

Paper Session I

Salon 8

*Chair: Imanol Ordorika/Universidad Nacional Autonoma de Mexico**Globalization of Graduate Education: Comparing American and Chinese Perspectives*

Carol Frances/Seton Hall University and Claremont Graduate University

Liping Meng/University of International Business and Economics

The Impact of Postsecondary Privatization in Costa Rica

Lorelle Espinosa/University of California, Los Angeles

Jose Luis Santos/University of California, Los Angeles

The Converging Force of Performance-based Funding: The Case of South Korean Higher Education

Eunyoung Kim/University of Illinois at Urbana-Champaign

Eun Young Kim/University of Illinois at Urbana-Champaign

10:50am – 12:05pm**Closing Symposium: Higher Education and Social Cohesion: Cases from Europe, South Africa, Indonesia, and Former Soviet Republics**

Pacific

Chair: Heather Eggins/Staffordshire University, United Kingdom

Michael Bastedo/University of Michigan

Stephen Heyneman/Vanderbilt University

Richard Kraince/Ohio University

Nancy Lesko/Teachers College, Columbia University

D. Bruce Johnstone/University at Buffalo, SUNY

Wednesday, November 1
Garden 2/3

8:00am – Noon

Invited Session: Workshop: Legal Research as a Method and Tool to Advance Higher Education Policy

Coordinator: Karen Miksch/University of Minnesota

Philip T.K. Daniel/The Ohio State University
Kerry Brian Melear/University of Mississippi
John LaNear/University of Wisconsin, Milwaukee
Jeffrey C. Sun/University of North Dakota

The scope of legal issues in higher education is expanding and impacting administrative decision making and public policy. Yet many education researchers and policy makers are unfamiliar with legal research methods. This working session is designed to provide training with a variety of legal research techniques—no prior experience with legal research is necessary to participate. Participants will learn basic legal research approaches, as well as have the opportunity to work in small groups on a focused legal problem. The goal is for participants to leave the session with a specific set of steps and techniques to approach a legal issue.

Noon – 1:30pm
Lunch Break

1:30pm – 3:00pm

Symposium: Recession, Retrenchment, Recovery—State HE Funding & Financial Aid (Phase II)

Ross Hodel/Illinois State University
Christopher Mushrush/Illinois State University
Allison Ambrose/Illinois State University
Donald Heller/The Pennsylvania State University

3:15pm - 4:45pm

Symposium - The New Interest in Charter Universities and State Performance Contracts

Lara Couturier/Brown University
David Breneman/University of Virginia
William Chance/NORED
David Leslie/College of William and Mary
Robert Berdahl/University of Maryland

5:00pm - 6:30pm

Joint Symposium with ASHE Graduate Student Policy Seminar: K-16 Policy Environments: Taking the Bitter with the Better

Patricia Maloney/Change & Sustainability in Higher Education Project
DeWayne Morgan/Education Equals Mentoring, Coaching and Cohorts
William Badders/Cleveland Mathematics Science Partnership
James Hamos/National Science Foundation
Nancy Shapiro/University System of Maryland
Donald Langenberg/University of Maryland

6:30pm - 8:30pm

North Tower Garden Terrace & Pool

International and Policy Reception

Graduate Student Public Policy Seminar
Council on Public Policy in Higher Education
Council on International Higher Education

Sponsored by the Institute of Higher Education, University of Georgia and Lumina Foundation for Education

Thursday, November 2
Garden 3

8:00am - 8:30am

Continental Breakfast

8:30am - 9:45am

Paper Session: Research as a Policy Tool: Multiple Approaches

Competencies and Higher Education Policy Analysis
Eduardo Arellano/New Mexico State University
Mario Martinez/University of Nevada-Las Vegas

Buying the Right Thing: Policy Audit, Educational Finance and State Policy

Steve Boilard/California Legislative Analysts Office
Nancy Shulock/Institute for Higher Education Leadership and Policy, California State University, Sacramento

Infusion of Innovation: Catalyzing Policy Change Through Research

Nathan Daun-Barnett/University of Michigan
Thomas Perorazio/University of Michigan

10:00am - 11:15am

Invited Session: Rethinking Student Aid: Developing New Approaches to Equitable and Efficient Public Policy

Sandy Baum/The College Board

11:20 - noon

Business Meeting & Evaluation

Council on Public Policy in Higher Education

Newcomers' Orientation

11:45pm - 12:45pm
Harbor

Concurrent Session A • November 2 • 1:00pm - 2:30pm

A1 • Research/Scholarly Papers

Grand Ballroom B

Evolving Perceptions and Organizational Cultures

Chair: Aaron Kuntz/University of Massachusetts, Amherst
Discussant: Pilar Mendoza/Oklahoma State University

An Examination of the Job Satisfaction for Mid-Level Managers in Student Affairs Administration
Jessie Grant/Western Michigan University

What's Being Sold and To What End?: A Content Analysis of College Viewbooks
Christopher Morphey/Institute of Higher Education, University of Georgia
J. Matthew Hartley/University of Pennsylvania

Towards Organizational Culture Change in Higher Education: Introduction of a Model
Christopher Shults/University of Michigan

Institutional Culture and Citizenship at Research Universities: Collapsing the Border between Research and Practice
Courtney Thornton/North Carolina State University
Audrey Jaeger/North Carolina State University

A2 • Research/Scholarly Papers

Grand Ballroom C

Choice, Access, and Equity

Chair: James Barber/University of Michigan
Discussant: Vasti Torres/Indiana University

Post-Secondary Education on the Edge: Credentialing and College Aspirations in Appalachia
Jane Jensen/University of Kentucky

Building a College Going Schema: Thinking about College Preparation as a Cognitive Process
Amy Fann/University of California, Los Angeles

Inequitable Access to Curriculum, Uneven Social Capital, & the Plight of Latino Students in Washington
Frances Contreras/University of Washington

Texas' "Other" Top Seniors: An Analysis of the College Intentions, Choice, and Enrollment Behavior of Students Within the Top Third of Their Class
Leticia Oseguera/University of California, Irvine

A3 • Symposium

Grand Ballroom D

Borderlines and Borderlands at the Helm of Higher Education: Women in the Boardroom and Executive Office

Moderator: Yolanda Moses/University of California, Riverside

Diane Dean/Illinois State University
Helen Astin/University of California, Los Angeles
Rita Bornstein/Rollins College
Mildred Garcia/Berkeley College of New York and New Jersey
Judith Glazer-Raymo/Teachers College, Columbia University
Patricia Gumpert/Stanford University

A4 • Presidential Session

Garden 4

NAFTA and Higher Education Markets: The Invisible Hand Revealed

Imanol Ordorika/Universidad Nacional Autónoma de México
Sheila Slaughter/University of Georgia
Don Fisher/University of British Columbia
Amy Metcalfe/University of British Columbia
Jesus Fontes/The University of Arizona
Gary Rhoades/The University of Arizona
Jenny Lee/The University of Arizona
Alma Maldonado-Maldonado/The University of Arizona

A5 • Research/Scholarly Papers

Grand Ballroom E

Implications of Federal Policy and Politics

Chair: Kirsten Turner/University of Kentucky
Discussant: Amy Wells/University of Mississippi

Within Borders, Without Borders: A Critique of the Commission on the Future of Higher Education
Casey E. George/University of Illinois at Urbana-Champaign

Policy in Practice: How the GI Bill Renegotiated University-State-Federal Relations in Higher Education
Elizabeth Stransky/University of Wisconsin, Madison

Academic Freedom and the Courts: Balancing the Interests of Faculty, Students & Institutions
James Jorgensen/University of Iowa

Higher Education and Consent: The Political-Pedagogical Discourse of Editorials and Opinions in the US, 1980 - 2004
Gustavo Fischman/Arizona State University
Eric Haas/University of Connecticut

A6 • Research/Scholarly Papers

Grand Ballroom F

Information Choice and Entrepreneurship

Chair: MaryBeth Knight/University of Virginia

Discussant: Dra. María Herlinda Suárez Zozaya/Universidad Nacional Autónoma de México

Pell Grants and Student Choice in Puerto Rico: Subsidy Patterns and Postsecondary Transformations

Brian Pusser/University of Virginia

Waldemiro Vélez Cardona/University of Puerto Rico

Gloria Dávila Casasnovas/Puerto Rico Council on Higher Education

Borderlines Choice: College Application Behavior and the Information Gap

Charles Rice/The University of Arizona

The Second Academic Revolution: Interpretations of Academic Entrepreneurship

Peijun Zheng/University of Alabama

Michael Harris/University of Alabama

Conceptualizing the Entrepreneurial Cultures of Faculty within the Capitalist Academy

Matthew Mars/The University of Arizona

A7 • Symposium

Grand Ballroom G

Student-Faculty Interaction: Educational Outcomes for Students of Color

Discussant: Daniel Solorzano/University of California, Los Angeles

Marne Einarson/Cornell University

Linda DeAngelo/University of California, Los Angeles

Darnell Cole/University of Southern California

Miguel Ceja/California State University, Sacramento

Brent Cejda/University of Nebraska, Lincoln

A8 • Research/Scholarly Papers

Garden 1

Tenure, Time, and Ethics

Chair: Gabriela Sivestre/University of Pittsburg

Discussant: Lois Trautvetter/Northwestern University

Does Tenure Make You Happy?: Faculty Satisfaction in Institutions With and Without Tenure

Stephen Porter/Iowa State University

Tenured Times: Does Tenure Affect Productivity?

Daniel Fuerstman/Michigan State University

Can You See What I See?: Dissonant Perspectives between Faculty and Students as Roots of Ethical Dilemmas

Kelly Risbey/University of Minnesota

Brianne Keeney/University of Minnesota

Melissa S. Anderson/University of Minnesota

Karen Seashore Louis/University of Minnesota

Everyday Ethics in Academic Research: Aligning Authorship Principles with Practice in the Sciences

Janet M. Holdsworth/University of Minnesota

Karen Seashore Louis/University of Minnesota

Melissa S. Anderson/University of Minnesota

Eric G. Campbell/Harvard University

A9 • Symposium

Garden 2

Theory, Action & Measurable Results: Designing, Implementing and Evaluating College Preparation Programs

Discussant: Julia Colyar/Southern Illinois University, Carbondale

William Tierney/University of Southern California

Kristan Venegas/University of Nevada, Reno

Brianna Kennedy/University of Southern California

Paz Oliverez/University of Southern California

Margaret Sallee/University of Southern California

A10 • Graduate Student Session

Garden 3

The Job Search: Academic versus Non-Academic Positions

Chair: Kimberly R. Rogers/University at Buffalo

Jennifer Engle/The Pell Institute

Audrey Jaeger/North Carolina State University

Lisa R. Lattuca/The Pennsylvania State University

Stephen P. Wanger/Oklahoma State University

This session will provide graduate students with information on conducting a search for both academic and non-academic positions. Individuals working in policy, administration, and as faculty members will cover topics such as cover letters, curriculum vitae writing, networking, and references.

ART • Roundtables

Pacific and Harbor

Complete Listing on Next Page

ART • Roundtables

Pacific

1. Virtual Borderlands: Self-Presentation in On-line Student Communities
Matt Birbaum/The University of Arizona
2. Merging for Excellence
David Chapman/University of Minnesota
3. Incorporating Critical Race Theory into the Study of Latina/o Educational Pathways to the Doctorate
Michelle M. Espino/The University of Arizona
4. The Use of Diversity as a Factor in the Award of University Financial Aid
Thomas Graca/University of Texas at Arlington
5. Homeless Youth and College Access
Jarrett Gupton/University of Southern California
6. Exploring P-16 Education Policy: An Ecological Perspective of College Choice
Willie Heggins/Washington State University
Paul Pitre/Washington State University
7. What's Good for The Goose is Good for the Gander: Measuring Administrator Productivity in Higher Education
Joan Hirt/Virginia Tech University
8. From Challenge to Triumph: Examining Retention Strategies for African American men in Doctoral Programs
Ted Ingram/Indiana University
9. Evangelical Christian Students in the Secular Academy: Communities, Diversity, Identity, and Values
Jonathan Lew/Claremont Graduate University
Alyssa N. Bryant/North Carolina State University

Harbor

10. Higher Education Field Research in the Digital Age: Implications for the Research Questions we ask, and the Data we Collect, Analyze and Disseminate
Melissa McDaniels/Michigan State University
11. The Other Side of High Stakes Testing
Carlton R. McHargh/University of Alabama
12. A New Method of Teaching Higher Education Finance
Sandra Nadelson/University of Nevada, Las Vegas
13. How American Higher Education Affects Muslim Students: An Exploratory Study
Xyanthe Neider/Washington State University
14. Faculty of Color: Increasing Job Satisfaction
Mohamed Nur-Awaleh/Illinois State University
15. Facilitating Conversations on Race and Racism through Critical Race Pedagogy
Stephen John Quaye/The Pennsylvania State University
16. Please Don't Scare the White People: American Indian Students in the Borderlands
Michael Simpson/The University of Arizona
17. "Why should I do this?" A Study of Faculty Engagement and Gain in a Large-scale STEM Learning Intervention
Bernhard Streitwieser/Northwestern University
Erik Kjeldgaard/Northwestern University
18. Academic Novels, Corporatization, and Remasculinization
Susan Talburt/Georgia State University

Breaks • November 2-4

Coffee Break

Thursday: 2:30pm
Friday: 9:30am and 3:15pm
Saturday: 9:30am and 2:45pm



The breaks have been made possible with the generous support of:



B1 • Research/Scholarly Papers

Grand Ballroom B

Spanning Organizational Borders

Chair: Kate Douglas/Holyoke Community College
Discussant: Shederick McClendon/University of Massachusetts, Amherst

Building a Two-way Street: Toward a Theory of Knowledge Flow in University-Community Partnerships
 David Weerts/Florida Atlantic University
 Lorilee Sandmann/University of Georgia

Organizational Collaboration for Diversity: The Case of LEAD
 David Siegel/East Carolina University

State-level Virtual Universities: a Comparative Case Study
 Haixia Xu/University of Georgia
 Libby Morris/University of Georgia

Who Goes First: Assessment and Boundary-Spanning Collaboration at Buckingham University
 Barrett Taylor/University of Alabama
 Kristi Wheeler-Griffin/University of Alabama

B2 • Symposium

Grand Ballroom C

Power, Politics, and University Reform from a Global Perspective

Discussant: Humberto Muñoz/Universidad Nacional Autónoma de México

Sheila Slaughter/University of Georgia
 Simon Marginson/University of Melbourne
 Robert A. Rhoads/University of California, Los Angeles
 Brian Pusser/University of Virginia
 Imanol Ordorika/Universidad Nacional Autónoma de México

B3 • Symposium

Grand Ballroom D

Theoretical Frameworks for Understanding on Doctoral Student Learning and Development: Implications for Research and Practice

Chair: Christine Golde/The Carnegie Foundation
Discussant: Ann Austin/Michigan State University

Melissa McDaniels/Michigan State University
 Carol Colbeck/The Pennsylvania State University
 Vicki Baker/The Pennsylvania State University

B5 • Symposium

Grand Ballroom F

The Future of the Community College as an Institutional Type

Discussant: Christopher Morpew/University of Georgia

Barbara Townsend/University of Missouri, Columbia
 Rick Wagoner/University of California, Los Angeles
 Susan Twombly/University of Kansas
 Debra Bragg/University of Illinois

B6 • Research/Scholarly Papers

Grand Ballroom G

Issues in Measuring Racial/Ethnic Diversity

Chair: Michelle Nilson/Simon Fraser University
Discussant: Consuella Lewis/University of Pittsburgh

Exploring the Black Racial Identity Scale through Factor Analysis
 Joe Lott II/University of Louisiana System

Diversity and Qualitative Research
 Denise O'Neil Green/University of Nebraska

Mixing Methods to Enable Critical and Dialectical Research of Continued Minority Underrepresentation in the STEM Fields
 Joyce Lee/University of Illinois at Urbana-Champaign

Methodological Strategies for Assessing Race in Survey Research: Accounting for Multiracial Students, Identity Politics, Context, & Change
 Casandra Harper/University of California, Los Angeles

B7 • Symposium

Garden 1

African American Women: Negotiating the Educational System and Learning From Success

Chair: Henrietta Williams Pichon/Rowan University
Discussant: V. Barbara Bush/University of North Texas

MaryBeth Walpole/Rowan University
 Crystal Gafford Muhammad/East Carolina University
 Rachelle Winkle Wagner/University of Pennsylvania
 Marybeth Gasman/University of Pennsylvania
 Benita J. Barnes/University of Massachusetts, Amherst

B8 • Research/Scholarly Papers

Garden 2

Faculty and Their Institutions

Chair: Tonya Saddler/Virginia Tech

Discussant: Luis Ponjuan/University of Florida

Spillover and Job Satisfaction of Married/Partnered Faculty Members

Catherine Amelink/University of Maryland University College

Elizabeth Creamer/Virginia Tech University

Work and Family Balance in Higher Education: Graduate and Professional Student Perspectives

Kate Quinn/University of Washington

Growing Inequality in Faculty Salaries

John Cheslock/The University of Arizona

Trina Callie/The University of Arizona

A Framework for Understanding Faculty Investment in Their Institutions

Marietta Del Favero/University of New Orleans

B9 • Research/Scholarly Papers

Garden 3

Science, Technology, and the Health Professions

Chair: Larry Rowley/University of Michigan

Discussant: Paul Umbach/University of Iowa

The Demographic, Personality Characteristics and Conflict Resolution Behaviors of Graduate Occupational Therapy Students: Educational Implications.

Belkis Landa-Gonzalez/Barry University

Janice R. Sandiford/Florida International University

African American Graduate College Choice: Differences between STEM and Education Majors

Melanie Hayden/Virginia Tech University

Terrell Stayhorn/The University of Tennessee

Crossing Educational Borderlands: Geo-educational Scanning of Pathways among Doctorates in Science and Engineering

Soko Starobin/Iowa State University

Frankie Santos Laanan/Iowa State University

Exploring the Impact of Community College Attendance on the Professional and Educational Outcomes of Scientists and Engineers

Lindsey Malcom/University of Southern California

B10 • Presidential Session

Garden 4

Behind the Borders of Access and Equity: Educational Disparities Among College Men of Color

Shaun R. Harper/The Pennsylvania State University

Bryan McKinley Brayboy/University of Utah

Octavio Villalpando/University of Utah

Marvin H. McKinney/W.K. Kellogg Foundation

B11 • Symposium

Salon 7/8

Historical Advocacy for Women in Higher Education: The Role of External Organizations

Moderator: Linda Eisenmann/John Carroll University

Nancy Diamond/Temple University

Lynn Gangone/George Washington University

Jacquelyn Elliott/Tusculum College

Presidential Address:

The Underestimated Significance of Practitioner Knowledge in the
Scholarship on Student Success

Estela Mara Bensimon

Professor, University of Southern California
Director, Center for Urban Education

Introduction: Alicia Dowd/University of Southern California

Special Event ▪ November 2

ASHE Welcome Reception

North Tower Garden Terrace and Pool
6:30pm - 7:30pm

This reception has been made possible with the generous support of:

The Institute for College Access & Success



Tomorrow's Solutions. Today.



California State University,
Long Beach

C1 ■ Research/Scholarly Papers

Grand Ballroom B

Defining and Cultivating Leadership

Chair: Leonard A. Williams/University of New Orleans

Discussant: Marcy Roe/University at Buffalo

Taking it to the Next Level: Characteristics of Alumni Donors who increase Levels of Giving to their Alma Mater
David Weerts/Florida Atlantic University
Justin Ronca/University of Wisconsin, Madison

An Examination of Position Attainment for Academic Leadership in Higher Education: Evidence from NSOPF: 99
Jerlando Jackson/University of Wisconsin-Madison

Defining Leadership from the Prospective of Senior-level Administrators in England
Sharon McDade/The George Washington University
Brian Sponsler/The George Washington University

How Administrators of Color View the Hiring Process: A Case Study of a Predominantly White Institution
Carlton R. McHargh/University of Alabama

C2 ■ Research/Scholarly Papers

Grand Ballroom C

Gender and Ethnic Identity Development Among College Men

Chair: Andrew H. Nichols/The Pennsylvania State University

Discussant: Shaun R. Harper/The Pennsylvania State University

The Role of Pre-College Socialization in the Meanings College Men Make of Masculinities
Frank Harris III/University of Southern California

Exploring Racial Consciousness among White Male Students at an HBCU
R. Darrell Peterson/Iowa State University
Florence Hamrick/Iowa State University

Negotiating Borders: Considering a Black-Gay Identity Formation Model
Brian Bourke/University of Alabama

Ethnic Identity Development of Latino Fraternity Members at a Hispanic Serving Institution
Juan Guardia/Iowa State University
Nancy Evans/Iowa State University

C3 ■ Symposium

Grand Ballroom D

Unfinished Business: New and Continuing Challenges for Women Faculty

Chair/Discussant: Judith Glazer-Raymo/Teachers College, Columbia University

Aimee Terosky/Columbia University
Anna Neumann/Teachers College, Columbia University
Becky Ropers-Huilman/Louisiana State University
Kathleen M. Shaw/Pennsylvania Department of Education
Reitmetse Obakeng Mabokela/Michigan State University
Ana Martínez Aléman/Boston College

C4 ■ Symposium

Grand Ballroom E

The State of Community-University Engagement in Higher Education

Chair: Angela Allen/Michigan State University

Discussant: Kelly Ward/Washington State University

Hiram Fitzgerald/Michigan State University
Tami Moore/Washington State University
KerryAnn O'Meara/University of Massachusetts, Amherst
Audrey Jaeger/North Carolina State University

C5 ■ Research/Scholarly Papers

Grand Ballroom F

Racial and Ethnic Identity Development

Chair: Daniel K. Park/University of Southern California

Discussant: Lori D. Patton/Iowa State University

The Influence of Ethnic Identity on Self-Authorship: A Longitudinal Study of Latino/a College Students
Vasti Torres/Indiana University
Ebelia Hernandez/Indiana University, Bloomington

The Ethnic Identity Development of Cuban American and Non-Hispanic White College Students at a Hispanic Serving Institution
Roger Geertz Gonzalez/Florida International University

Research and Racial Authority: White Researchers and Hmong American University Students
Christin DePouw/University of Illinois at Urbana-Champaign

A Qualitative Study on the Salient Characteristics of Resilient Cambodian American College Students
Geisce Ly/University of Michigan

C6 ■ Symposium

Grand Ballroom G
Free Speech on Campus

John Wilson/Illinois State University
 William Tierney/University of Southern California
 Carole Kennedy/San Diego State University

C7 ■ Symposium

Garden 1
Dangerous Borderlands: Racial Micro-Aggressions and the Continued Assault on the Souls of Black Students

Franklin Tuitt/University of Denver
 Kamilah Briscoe/The Steinhardt Institute, New York University
 Carol Wright/TERC

C8 ■ Symposium

Garden 2
Cross-Gender Mentoring: Another Pipeline for Latino Academics

Juan Carlos Gonzalez/University of Missouri, Kansas City
 Caroline Turner/The Arizona State University
 Luis Ponjuan/University of Florida
 Sylvia Hurtado/University of California, Los Angeles
 Mark Kamimura/University of Michigan
 Jeanett Castellanos/University of California, Irvine
 Kenneth Gonzalez/University of San Diego

C9 ■ Symposium

Pacific
Issues and Experiences in the Assessment of Self-Authorship

Chair: Patricia King/University of Michigan

Marcia Baxter Magolda/Miami University
 Elizabeth Creamer/Virginia Tech University
 Peggy Meszaros/Virginia Tech University
 Lisa Boes/Harvard University

C10 ■ Research/Scholarly Papers

Garden 3
Intersections of Multiple Identities

Chair: Michelle L. McClure/Marquette University
Discussant: Kristen Renn/Michigan State University

Boundaries and Peripherality: Student Identity and Imagined Communities in a Mexican Lengua Inglesa Program
 Blanca Torres-Olave/University of British Columbia

Sexual Identity Borderlands: Using Queer Theory to Explore "Lesbian" College Students' Multiple Identities
 Elisa Abes/Miami University
 David Kasch/Miami University

The Many Faces of Me: Identity Integration Across Multiple Contexts
 Dafina Stewart/Bowling Green State University

Homo Academicus at Play: An Ethnographic Study of the Academic Work of First Year Students
 Jane Jensen/University of Kentucky
 Karin Lewis/University of Kentucky

C11 ■ Presidential Session

Garden 4
Promises to Keep: Financial Aid, College Access, and Democratic Participation

Stephen DesJardins/University of Michigan
 Patricia McDonough/University of California, Los Angeles
 Michael A. Olivas/University of Houston
 Robert Shireman/Project on Student Debt
 Alicia Dowd/University of Southern California



D1 ■ Research/Scholarly Papers

Grand Ballroom B

Understanding Challenging Contexts for Leadership

Chair: Mary Darden/College of the Mainland
Discussant: James Bess/James L. Bess & Associates

War Room Decision Making in Higher Education: Balancing Collaboration and Centralization in Post Katrina Higher Educational Governance
 Andre Perry/University of New Orleans
 KiKi Baker/University of New Orleans

Crisis Management in the Community College
 John Murray/Texas Tech University
 Joseph Kishur/Texas Tech University

A Study of Grassroots Leadership in Higher Education: Encounters with Power and Oppression
 Tricia Bertram Gallant/University of California, San Diego
 Rozana Carducci/University of California, Los Angeles
 Melissa Contreras-McGavin/University of Southern California
 Adrianna Kezar/University of Southern California
 Jaime Lester/Old Dominion University

Redistribution of Faculty Career Opportunity: 1988-2004
 David Leslie/College of William and Mary

D2 ■ Symposium

Grand Ballroom C

Factors Affecting Intercollegiate Student Athletes and Athletics

Moderator: James Barott/Eastern Michigan University

James Satterfield/University of Texas at El Paso
 Robin Hughes/Indiana University, Indianapolis
 Mary Howard-Hamilton/Indiana State University
 Joy Gaston-Gayles/Florida State University
 Chris Croft/University of Texas at El Paso

D3 ■ Symposium

Grand Ballroom D

Chicana and Chicano Doctorate Production: The “Status” of Attainment and Experiences from the Margin

Rebeca Burciaga/University of California, Los Angeles
 Daniel Solorzano/University of California, Los Angeles
 Tara Watford/University of California, Los Angeles
 Martha Rivas/University of California, Los Angeles
 Veronica Vélez/University of California, Los Angeles
 Tara Yosso/University of California, Los Angeles

D4 ■ Research/Scholarly Papers

Grand Ballroom E

Reenvisioning Pedagogy: Studies of Faculty Work

Chair: Aaron Kuntz/University of Massachusetts, Amherst
Discussant: Lynette Land/The University of Utah

Just Point, Click, and Teach, Right? What Faculty & Administrators Say about Teaching Online
 Claudine Keenan/University of Massachusetts, Amherst
 KerryAnn O’Meara/University of Massachusetts, Amherst

The Impact of Centers and Institutes on Faculty Life: Findings from a Study of Life Science Faculty at Research-Intensive Universities’ Medical Schools
 Sarah Bunton/Association of American Medical Colleges
 William Mallon/Association of American Medical Colleges

How do Campus Context, Career Socialization and Perceptions of Work Environments influence Faculty Allocation of Time to Research and Teaching?
 Molly Ott/University of Michigan
 Janet Lawrence/University of Michigan

Self-Concept and Pedagogy: Examining the Linkages Between Faculty Spirituality and Student-Centered Approaches to Undergraduate Teaching
 Jennifer Lindholm/University of California, Los Angeles
 Helen Astin/University of California, Los Angeles

D5 ■ Research/Scholarly Papers

Grand Ballroom F

Historical Perspectives on Access and the Research Mission

Chair: Marc Van Overbeke/Northern Illinois University
Discussant: Marybeth Gasman/University of Pennsylvania

“Guess Who’s Paying for College?”: Historical Perspective on Student Financial Aid
 John Thelin/University of Kentucky
 Amy Wells/University of Mississippi

The Development of a Research Mission in Urban State Universities in Post World War II America: The Case of Fenn College
 Ralph Kidder/University of Massachusetts, Boston & Newbury College

The Influence of Idealism on Student Access During the Aristocratic Era of American Higher Education, 1636-1862
 T. Gregory Barrett/University of Arkansas at Little Rock

The Impact of the GI Bill beyond Students: Faculty Challenges and University-State-Federal Relations at the University of Wisconsin, Madison
 Elizabeth Stransky/University of Wisconsin, Madison

D6 ■ Symposium

Grand Ballroom G

The Role of Higher Education in Breaking the Cycle of Segregation

Facilitator: Sylvia Hurtado/University of California, Los Angeles

Chair: Walter Allen/University of California, Los Angeles

Discussant: Jomills Henry Braddock II/University of Miami

Uma Jayakumar/ University of California, Los Angeles

Kimberly Misa/University of California, Los Angeles

Victor Saenz/University of California, Los Angeles

D7 ■ Symposium

Garden 1

The Impact of Culture on Educational Investment: Setting a New Research Agenda for the Study of Financial Aid

Chair/Discussant: Edward St. John/University of Michigan

Patricia McDonough/University of California, Los Angeles

Alicia Dowd/University of Massachusetts, Boston

Kristan Venegas/University of Nevada, Reno

D8 ■ Symposium

Garden 2

Rethinking Faculty Work and Workplaces: The Faculty Appointments Revolution and Its Implications

Moderator: Roger Baldwin/Michigan State University

Ann Austin/Michigan State University

Judith Gappa/Purdue University

Jack Schuster/Claremont Graduate School

Martin Finkelstein/Seton Hall University

D9 ■ Presidential Session

Garden 4

Admissions & Omissions: How “The Numbers” are Used to Exclude Deserving Students

Introduction/Chair: Robert Teranishi/New York University

Darnell Hunt/Professor of Sociology and Director of Ralph J. Bunche Center of African American Studies at University of California, Los Angeles

D10 ■ Research/Scholarly Papers

Garden 3

Organizing for Student Success

Chair: Henrietta Williams Pichon/Rowan University

Discussant: Fran Stage/New York University

What Community College Policies and Practices are Effective in Promoting Student Success? A Comparison of High- and Low-Impact Institutions

Davis Jenkins/Community College Research Center, Teachers College Columbia University

Thomas Bailey/Teachers College

Delivering the College Promise: A Mixed Method Study of High Performing States and What We can Learn from Them

Joshua Powers/Indiana State University

Elonda Ervin/Indiana State University

Marc Malone/Indiana State University

Robert Pool/Indiana State University

A Conceptual Model Describing Influence of Campus

Environment on Early Adult Transition to Community College

Pam Schuetz/University of California, Los Angeles

Viewpoint Diversity in the Classroom: Sensemaking and Learning Outcomes

Staney DeGraff/University of Michigan

D11 ■ Research/Scholarly Papers

Pacific

College Effectiveness and Student Satisfaction

Chair: Troy Buer/University of Virginia

Discussant: Janet Holdsworth/University of Minnesota

The Terms of Engagement: Capturing Factors of African American College Student Engagement at a Predominantly White Institution

Susan Johnson/Indiana University, Bloomington

Committing to Keep Illinois Students In State: Understanding College Choice and Student Migration Patterns Among Illinois' High School Graduates

Diane Dean/Illinois State University

Erika Hunt/Illinois State University

Where are the Women? An Historical Look at Women Philanthropists in American Higher Education

Janine Welch/Florida State University

Exploring Good Practices in Outcomes-Based Assessment Program Review

Marilee Bresciani/Texas A&M University

Awards Luncheon

11:30am - 1:00pm

Grand Ballroom A

(Admission by ticket)

This Awards Luncheon has been made possible with the generous support of:

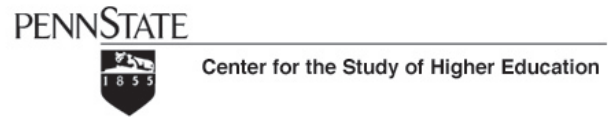

Concurrent Session E ■ November 3 ■ 1:00pm - 2:00pm

E1 ■ Poster Session

Grand Foyer and Grand Ballroom Hall

1. Region- and State-Level Variations in Public and Private Higher Education after World War II
Jennifer Ann Adams/The Pennsylvania State University
2. Minority Access to Higher Education and Labor Market Returns Across Three Generations
Noga Admon/New York University
3. Exploring the Role of Involvement in Civic Engagement in the Preparation of Future Scholars
Angela Allen/Michigan State University
4. The Development of the Faculty Senate in the American Research University
Christian Anderson/The Pennsylvania State University
5. Thriving in the First Year: A Case Study of a Business- Specific First-Year Seminar
Vicki Baker/The Pennsylvania State University
Kyle Sweitzer/The Pennsylvania State University
6. A Test Answer Recording Medium That Teaches While It Assesses: The Immediate Feedback Assessment Technique (IF AT)
Gary Brosvic/Rider University
Michael Epstein/Rider University
7. What matters to first-year students' interactions with faculty? A multi-institutional qualitative investigation
Jennifer Buckley/Indiana University
Jillian Kinzie/Indiana University
8. Gender, Tenure Status, and Institutional Type in Developmental Education: A Confluence of Border Issues
Bonita Butner/University of Missouri, Kansas City
Patricia Boyer/University of Missouri, St. Louis
Dwyane Smith/Indiana University, Bloomington
9. Environmental impact on Asian American self-concept: An institutional comparison
Debbie Chang/Michigan State University
10. Outcomes of Situational Ethnic Identity in Higher Education
Prema Chaudhari/University of Pittsburgh
Jane Pizzolato/University of Pittsburgh
11. Predicting Faculty Job Satisfaction among Foreign Born Asians: A Binary Logistic Regression Study
Bin Cheng/Seton Hall University
Martin Finkelstein/Seton Hall University
12. African American Female Doctoral Students' Perspectives on Mentoring
Nettavia Curry/Michigan State University
13. Splitting the Higher Education Budget: Are State Governments Representing their Constituents?
Luciana Dar/University of California, Los Angeles
14. Soulful Success: Spirituality and Church Participation in the College Life of African American Student
Saran Donahoo/Southern Illinois University, Carbondale
15. Critical Thinking and Campus Culture: Evidence from the National Survey of Student Engagement (NSSE) at St. X College
Kathryne Drezek/Virginia Polytechnic and State University
16. Women's Experience of Graduate Education: A Case Study of Women Faculty in the Field of Higher Education Administration
Karen Haley/North Carolina State University
17. Making it (or not) on a Dime in College
Anne Hornak/University of Toledo
Patricia Farrell/Western Michigan University
18. Identifying and Meeting the Needs of Doctoral Students: A Role for Student Affairs?
Melanie Guentzel/St. Cloud State University
Ann Gansemer-Topf/Grinnell College
Leah Ross/Iowa State University
Becki Elkins/University of Iowa

19. Living on the Border: First Year Student Experience and Drinking Behaviors
Angelia Green/University of Illinois at Urbana-Champaign
20. Professional Integrity in Higher Education: Development and Application of Staff Ethics in Student Affairs
Mark Halx/The University of Texas, San Antonio
Earle Reybold/George Mason University
21. An Investigation of the Role of Continuous Improvement in Student Learning
Betty Harper/The Pennsylvania State University
22. Perceptions of Racial Diversity among College Athletes in Michigan
Scott Hirko/Michigan State University
23. A Test of the Glass Ceiling Effect in Higher Education: An Examination of Race/Ethnicity and Senior-Level Position Attainment in the Academic Workforce
Jerlando Jackson/University of Wisconsin, Madison
Elizabeth O'Callaghan /University of Wisconsin, Madison
24. The Executive Leadership in Academic Medicine Program for Women: Program Innovation and Evolution
Ruth Johnston/The George Washington University
25. Tales From The Trenches: The Voices of Multicultural Administrators Operating Under Race-Neutrality
Sosanya Jones/Teacher's College, Columbia University
Nicole Lewis/The University of North Carolina, Chapel Hill
26. Learning Across Borders: Competition in US and Canadian Higher Education
Camille Kandiko/Indiana University
27. "This is Something I Can Do!": A Case Study of a University-Sponsored Program that Inspires High-Achieving, 1st Generation, Low SES Female Students to Doctoral Pursuits
Jolina Kwong/Portland State University
Michael Smith/Portland State University
28. Balancing the Demands of Multiple Principals: The Role of the ND Roundtable in Balancing Government, Business, and Academic Priorities
Jason Lane/University of North Dakota
29. The Mathematics Placement Test as a Border to College-Level Math Classes: Institutional Barriers and Interventions
Teresa Leyba Ruiz/The Arizona State University
30. The History of Student Rights in Wisconsin: From Baum to Southworth
Laurie Marks/University of Wisconsin, Milwaukee
31. Current Status of Gender-Related Scholarship in Higher Education: Where has the Research Gone?
Sarah Marshall/Central Michigan University
32. Adult Access to Professional Graduate Education in an Urban Context: A Case Study Research
Kenichi Maruyama/The Arizona State University
33. Exploring the Possibility of Selection Bias in a Study of Doctoral Student Outcomes
David Most/Colorado State University
34. Ethical Behavior: Student, Faculty, and Administrator Influences
Sandra Nadelson/University of Nevada, Las Vegas
35. The Legislative History and Legal Authority of the Nevada Committee to Evaluate Higher Education Programs
Kimberly Nehls/University of Nevada, Las Vegas
36. Unpacking Voice and Silence: A Phenomenological Study of Black and Latina Women in the College Classroom
Shelly Perdomo/University of Massachusetts
37. (Re)-conceptualizing the Ivory Towers: A LatCrit Model of Institutional Support for Undocumented Latina and Latino College Students
Lindsay Perez Huber/University of California, Los Angeles
Maria Malagon/University of California, Los Angeles
38. University Technology Licensing Effects on Innovation Diffusion: A National Study
Joshua Powers/Indiana State University
39. Which Way Did They Go? Tracking Student Outcomes in Both Credit and Non-credit Education
Kristie Rankin/Lawson State Community College & University of Alabama
David Hardy/University of Alabama
Stephen G. Katsinas/University of Alabama
40. The Higher Education Ph.D.: A Borderland of Transcendence
Lisa Rodrigue/Arizona State University
41. Collegiality and the Satisfaction of Science and Engineering Women and Minority Faculty by Rank
Tonya Saddler/Virginia Polytechnic Institute & State University
Elizabeth Creamer/Virginia Tech University
42. Moral Judgment and Student Judicial Systems: What Are Institutions Teaching?
Robert Schwartz/Florida State University
Merryl Cooper/Florida State University
43. Low Income Students and the Transition to Graduate School
Julia Spears/Southern Illinois University, Carbondale
44. Examining Faculty Motivation to Participate in Professional Development
Ellen Stevens/University of Colorado at Denver and Health Sciences Center
Michael Wray/Metropolitan State College
Teri Switzer/University of Colorado at Denver and Health Sciences Center
Barbara Bates/DeVry Institute of Technology
Patrick Lowenthal/Regis University
45. Measuring Up: Examining the Connections among State Structural Characteristics, Regulatory Practices, and Performance
David Tandberg/The Pennsylvania State University
James Fredericks Volkwein/The Pennsylvania State University
46. Survey of Employability for Online Degree Recipients
Leisa Thompson/University of Nevada, Las Vegas
47. Civic Responsibility and Research Universities: Ideology, Culture and Action
Courtney Thornton/North Carolina State University
48. Factors Explaining Faculty Technology Use
Yonghong Jade Xu/University of Memphis
Katrina Meyer/University of Memphis
49. Cultural Competency and Affirmative Action Attitudes of Graduate/ Professional Students
Ebony Zamani-Gallaher/Eastern Michigan University
Cheryl Price/Eastern Michigan University
50. Phenomenological Study of Chinese International Students' Academic and Social Integration on Campus
Yanmei Zhang/University of Florida

F1 ■ Research/Scholarly Papers

Grand Ballroom B

Defining and Cultivating Leadership for Women

Chair: Courtney Thornton/North Carolina State University
Discussant: Consuella Lewis/University of Pittsburgh

A Theoretical Model for the Professional Development of African American Women Administrators
 Kandace Hinton/Indiana State University

The President as a Transformational Leader: One Woman's Story
 Leah Ross/Iowa State University
 John Schuh/Iowa State University

Pathways to the Presidency: Women of Color Firsts
 Caroline Turner/Arizona State University

Critical Incidents as Indicators of Leadership Development in Women Faculty in Medicine and Dentistry: Case of the ELAM Program
 Sharon McDade/George Washington University
 Lorraine Sloma-Williams/George Washington University

F2 ■ Research/Scholarly Papers

Grand Ballroom C

College Choice and Access to Higher Education

Chair: Tricia Bertram Gallant/University of California, San Diego
Discussant: Liang-Hsuan Chen/University of Toronto, Scarborough

Formulating a New Model for College Choice and Persistence
 J. Nathaniel Southerland/University of Utah

No Child Left Unrecruited: When Military Recruiters Play High School Guidance Counselors
 Amy Fann/University of California, Los Angeles
 Shannon Calderone/University of California, Los Angeles
 Patricia McDonough/University of California, Los Angeles

Postmodernism or Diversity Diluted? Findings from the Millennial Student Project
 Melissa Ousley/The University of Arizona
 Lynette Cook Francis/The University of Arizona

Graduate College Choice: Understanding the Process
 Terrell Strayhorn/The University of Tennessee
 Norma Mertz/The University of Tennessee

F3 ■ Research/Scholarly Papers

Grand Ballroom D

Partnerships, Impacts, & Outcomes

Chair: Benita J. Barnes/University of Massachusetts, Amherst
Discussant: Kyle Joseph Scaife/The University of New Orleans

General Education Courses and the Promotion of Essential Learning Outcomes
 Thomas Nelson Laird/Indiana University
 Amanda Suniti Niskode/Indiana University, Bloomington
 George Kuh/Indiana University

The Impact of Tutoring on Academic Achievement in Post-Secondary Education
 Joel Hurwitz/University of California, Los Angeles
 Jennifer Keup/University of California, Los Angeles

Measuring Engaged Learning in College Students: Beyond the Borders of NSSE
 Laurie Schreiner/Azusa Pacific University
 Michelle Louis/Bethel University

Outcomes for Educators of Student Affairs-Academic Affairs Partnership Programs
 Melanie Guentzel/St. Cloud State University
 Cynthia Wells/The Boyer Center, Messiah College
 Elizabeth Whitt/University of Iowa
 William McDonald/Presbyterian College
 Becki Elkins/University of Iowa

F4 ■ Research/Scholarly Papers

Grand Ballroom E

State and Federal Aid Programs

Chair: DaVina Hoyt/Washington State University
Discussant: Greg Dubrow/University of California, Berkeley

The Adoption of State Matching Fund Programs: An Event History Analysis
 Ying Liu/Vanderbilt University

Replacing State Appropriations with Alternative Revenue Sources: The Case of Voluntary Support
 Matthew E. Gianneschi/Colorado Commission on Higher Education
 John Cheslock/The University of Arizona

The Influence of Public Funding Strategies on Enrollment of Low-Income, High-Achieving African American Students
 Krystal Williams/University of Michigan
 Shouping Hu/Florida State University
 Edward St. John/University of Michigan

State Merit Aid Policy and Student Academic Choice: Evidence from Kentucky
 Jennifer Delaney/Stanford University

F5 ■ Presidential Session

Garden 4

The Effects of Katrina on the Academic and Life Experiences of Students and Faculty

Barbara Johnson/Jackson State University
 Marietta Del Favero/University of New Orleans
 Andre Perry/University of New Orleans
 Becky Ropers-Huilman/Louisiana State University
 Kimberly Reese/Xavier University
 Annette Accomando/South Louisiana Community College
 Susan Gardner/Louisiana State University
 Jennifer Loftin/Louisiana State University

F6 ■ Symposium

Grand Ballroom F

Ethnic and Racial Identity in Higher Education: The State of the Research, New Discoveries and Future Challenges

Anna Ortiz/California State University, Long Beach
 Kristen Renn/Michigan State University
 Silvia J. Santos/California State University, Dominguez Hills
 Vasti Torres/Indiana University

F7 ■ Research/Scholarly Papers

Grand Ballroom G

Examining Diversity in PWIs and MSIs

Chair: Larry Rowley/University of Michigan
Discussant: Jeffrey Milem/University of Arizona

Framing the Effect of Multiculturalism on Diversity Outcomes Among Students at Historically Black Colleges and Universities
 Brigid Dwyer/University of Michigan

Students' Satisfaction at a Minority-Serving Institution: Dominant, Tilted and Token students
 Meechai Orsuwan/University of Hawaii at Manoa
 Barbara Ross/University of Hawaii at Manoa
 Darnell Cole/University of Southern California

A Look at Student Satisfaction with Ethnic Diversity for White, Black, Latino/a, and Asian American Students
 Julie Park/University of California, Los Angeles

Improving the Experiences and Retention of Black Students at Traditionally White Institutions: A Case Study of an African American Studies Department
 Cheryl Brown/The Carnegie Foundation

F8 ■ Symposium

Garden 1

United We Stand, Divided We Fall: The Need for Academic Mentoring in Higher Education

Moderator: Kelly Risbey/University of Minnesota

Carole J. Bland/University of Minnesota
 Janet Lawrence/University of Michigan
 Deborah Olsen/Virginia Tech
 Ann Austin/Michigan State University
 Christopher Lucas/University of Arkansas

F9 ■ Research/Scholarly Papers

Garden 2

The Construction and Deconstruction of Race and Ethnicity in Higher Education

Chair: Erica Yamamura/University of California, Los Angeles
Discussant: Benjamin Baez/Florida International University

Counterstories: Listening to the Native Voice in Higher Education

Johanna Masse/California State University, Long Beach
 Meredith Freijo/California State University, Long Beach
 Elaine Lipiz/California State University, Long Beach
 Lindsay San Miguel/California State University, Long Beach

Protecting White Privilege: The Many Ways that White Folks Use Color-Blindness and Political Correctness to Maintain the Advantage
 Kimberly King-Jupiter/Auburn University

The "Minority Model" and the Marginalization of Asian Americans in Higher Education
 Sharon S. Lee/University of Illinois at Urbana-Champaign

Issues of Access and Retention for Graduate and Professional Students of Color

Carla Morelon/Indiana University
 Susan Johnson/Indiana University, Bloomington
 Rachelle Winkle Wagner/University of Pennsylvania
 John Kuykendall/Marquette University
 Dwyane Smith/Indiana University, Bloomington
 Lilia Santiago/Indiana University
 Keon Gilbert/University of Pittsburgh
 Ghangis Carter/Indiana University, Bloomington

F10 ■ Symposium

Garden 3

Being the Difference: Black Faculty and Scholarship in Higher Education

Moderator: Dafina Stewart/Bowling Green State University
Moderator: Lori D. Patton/Iowa State University

Michelle McClure/Marquette University
 Fred Bonner, II/Texas A&M University
 Mary Howard-Hamilton/Indiana State University
 Robin Hughes/Indiana University, Indianapolis
 Sherry Watt/University of Iowa
 Shaun R. Harper/The Pennsylvania State University
 Bridget T. Kelly/Seattle University

F11 ■ Symposium

Pacific

Dual enrollment: New Research on Student Outcomes

Chair/Discussant: Brian Prescott/Western Interstate Commission for Higher Education

Melinda Karp/Community College Research Center, Teachers College
 Vanessa Morest/Teachers College, Columbia University
 Juan Carlos Calcagno/Community College Research Center, Teachers College
 Thomas Bailey/Teachers College



G1 ■ Research/Scholarly Papers

Grand Ballroom B

Faculty Entry and Socialization

Chair: Al Smith/Baylor University

Discussant: Sally Bomotti/University of Nevada, Las Vegas

Entering the Academy: Exploring the Socialization Experiences of African American Male Faculty

Dorian McCoy/The University of Vermont

New Faculty in the Academy: Overworked or Undertrained?

Leonard A. Williams/University of New Orleans

“Getting Started”: The Role of Institutional Orientations and Colleague Support in New Faculty Socialization

Barbara Johnson/Jackson State University

Finding Time: An Examination of How Much Time Faculty of Color Spend on Work and Other Activities by Rank

John Kuykendall/Marquette University

Susan Johnson/Indiana University Bloomington

Thomas Nelson Laird/Indiana University

Amanda Suniti Niskode/Indiana University, Bloomington

Ted Ingram/Indiana University

G2 ■ Symposium

Grand Ballroom C

Can Women Survive Academic Capitalism?

Chair: Sheila Slaughter/University of Georgia

Moderator: Kathleen M. Shaw/Pennsylvania Department of Education

Amy Metcalfe/University of British Columbia

Pilar Mendoza/Oklahoma State University

Theresa Wright/The University of Georgia

Allison McWilliams/University of Georgia

G3 ■ Research/Scholarly Papers

Grand Ballroom D

Diversity, Culture, and Higher Education: From Theory into Practice

Chair: Kimberly Griffin/University of California, Los Angeles

Discussant: Roger Geertz Gonzalez/Florida International University

The Interaction of Student Race and Experiences: Critical Influences on Learning Outcomes in Engineering

Betty Harper/The Pennsylvania State University

Amber D. Lambert/The Pennsylvania State University

Lisa R. Lattuca/The Pennsylvania State University

More than Meets the Eye: Critical Race Theory, Culturally Relevant Pedagogy, and Learning

Stephen John Quaye/The Pennsylvania State University

Lisa R. Lattuca/The Pennsylvania State University

The Diversity Portfolio: A Tool for Assessing Multicultural Online Learning Competencies

Doris Wright Carroll/Kansas State University

Diversity and Service-Learning: Extending the Discourse Towards Action

Jenny Lee/The University of Arizona

Michelle M. Espino/The University of Arizona

G4 ■ Research/Scholarly Papers

Grand Ballroom E

Knowledge of College and Influence of Aid

Chair: Paul E. Pitre/Washington State University

Discussant: Laura W. Perna/The University of Pennsylvania

Perspectives of College Costs, Benefits, and Financial Aid Among Latino Parents and Youth in the California and the U.S.

Maria Estela Zarate/The Tomas Rivera Policy Institute

Harry Pachon/The Tomas Rivera Policy Institute

College Knowledge and Financial Aid Information: School Differences and Their Impact on College Destination

Pedro Villarreal, III/The Pennsylvania State University

Regina Deil-Amen/The Pennsylvania State University

Financial Aid and Where Applicants to a Large Public University Eventually Attend

Bradley Curs/University of Missouri, Columbia

The Politics of State Higher Education Funding

David Tandberg/The Pennsylvania State University

G5 ■ Symposium

Grand Ballroom F

Borderlines Broken, Diversity Redefined: Implications for Higher Education on the Diversification of Student Characteristics and Perspectives

Moderator: Melissa Ousley/The University of Arizona

Ernest T. Pascarella/University of Iowa

Jeffrey Milem/The University of Arizona

Jennifer Hart/University of Missouri, Columbia

Lynette Land/University of Utah

G6 ■ Research/Scholarly Papers

Grand Ballroom G

Social Capital and Access to Higher Education

Chair: Ontario S. Wooden/Albany State University

Discussant: Donald E. Heller/The Pennsylvania State University

Social Capital and College Financing in Non-nuclear Families

Sandra Tarbox/University of Michigan

The Effects of High School Feeder Networks on College Enrollment

Gregory C. Wolniak/Human Capital Research Corporation

Mark Engberg/Human Capital Research Corporation

Networking and the College Choice Process: How Do Student-Initiated Organizations Affect the Choice of Underserved Students?

Jocelyn Surla Banaria/University of California, Berkeley

Greg Dubrow/University of California, Berkeley

Social Structural Factors Affecting African American, Latino, Asian American, and White Students' College Aspirations

Deborah Carter/University of Michigan

Sonia DeLuca Fernandez/University of Michigan

Angela Locks/University of Michigan

G7 ■ Research/Scholarly Papers

Garden 1

Understanding the Borders of Access and Opportunity

Chair: Tara Parker/University of Massachusetts, Boston
Discussant: Robert Teranishi/New York University

Who are Our Honors Students? Examining the Academic and Social Background Characteristics of Students Who Participate in Collegiate Honors Programs
 M. Kate Callahan/Temple University

Defining the Precollege Goals, Values, and Aspirations That Influence Degree Attainment Among Latina/o Students
 Oscar Cerna/University of California, Los Angeles
 Victor Saenz/University of California, Los Angeles
 Patricia Perez/University of California, Los Angeles

Gender and Academic Fields of Study: New Patterns and Trends
 Ann L. Mullen/University of Toronto
 Jayne Baker/University of Toronto

G8 ■ Symposium

Garden 2

The Status and Future Prospects of the Church-Related College: A Last Bastion for Institutional Diversity in American Higher Education?

Chair: Martin Finkelstein/Seton Hall University
Discussant: Mary Meehan/Alverno College

Andrew Tatusko/Mt. Aloysius College
 Nicholas Mazza/St. John Villa Academy of NY
 James Keane/St. John's University
 Paul Witek/Russian Orthodox Church of NJ

G9 ■ Dissertation of the Year

Garden 3

Chair: Jeanne Cooper/University of Hawaii

G10 ■ Graduate Student Session

Pacific

Getting Published as a Graduate Student

Chair: Ashley Mouberry Sieman/North Carolina State University

M. Christopher Brown II/The Pennsylvania State University/AACTE
 Bradley Curs/University of Missouri, Columbia
 Ryan J. Davis/University of Maryland
 Consuella Lewis/University of Pittsburgh

The session will examine the need for graduate students to get published and establish themselves as researchers first, prior to taking on too many responsibilities that may take them away from research.

G11 ■ Research/Scholarly Papers

Garden 4

Making Diversity Work

Chair: Shelly Perdomo/University of Massachusetts
Discussant: Ken Kempner/Southern Oregon University

The Process of Coming Up: How Asian American Studies Became an Academic Department
 Erin Kimura/University of California, Los Angeles

Critical Race Theory and Organizational Change : An Alternative Approach to Changing Colleges and Universities
 Melissa Contreras-McGavin/University of Southern California

The Impact of Interracial Interactions on Students' Intellectual Self-Concept: An Examination Across Racial/Ethnic Groups
 Darnell Cole/University of Southern California

A Phenomenological Study of Institutional Racism at a Predominantly White Institution of Higher Education
 Tatiana Suspitsyna/The Ohio State University
 D'Andra Mull/The Ohio State University

Keynote ■ November 3 ■ 5:00pm - 6:30pm ■ Grand Ballroom A

Migration and Education in the Global Era

Marcelo Suarez-Orozco

Courtney Sale Ross University Professor of Globalization and Education,
 New York University

Introduction: James T. Minor/Michigan State University

H1 ■ Symposium

Grand Ballroom B

The Role of Organizational and Social Capital in Educational Partnerships

Chair: C. Casey Ozaki/Michigan State University
Reactor: Marilyn Amey/Michigan State University

Pamela Eddy/Central Michigan University
 Patricia Farrell/Western Michigan University
 Jesse S. Watson/Michigan State University
 Carrie Kisker/University of California, Los Angeles
 Kim Seifert/Dona Ana Branch Community College

H2 ■ Research/Scholarly Papers

Grand Ballroom C

Tracking the Changes: Perspectives on Academic Life

Chair: Nettavia Curry/Michigan State University
Discussant: Kirsten Turner/University of Kentucky

Chosen to Lead: Generations of Rhodes Scholars in American Meritocracy

Ted I. K. Youn/Boston College
 Karen Arnold/Boston College

Journal Keeping Across Disciplinary Borders: Eight Case Studies of Classroom Use

Joanne Cooper/University of Hawaii
 Dannelle Stevens/Portland State University
 Mona Chock/University of Hawaii, Manoa

Life Off the Tenure Track: The Effect of Contingent Appointments on Faculty Job Satisfaction
 Paul Umbach/University of Iowa

The Discourse Around Women and Feminism: An Analysis of the Association for the Study of Higher Education Conferences from 1989-2005

Jennifer Hubbard/University Of Missouri, Columbia

H3 ■ Research/Scholarly Papers

Grand Ballroom D

Curriculum and Pedagogy in Higher Education

Chair: Kelly Brennan/The University of Alabama
Discussant: David Diramio/Auburn University

Identifying Factors that Influence Student-Centered Instruction in the Undergraduate Classroom: A Structural Equation Model Analysis

Steven Hubbard/New York University

The Influence of Curricular-based Interventions within First-year "Success" Courses on Student Alcohol Expectancies and Engagement in High-risk Drinking Behaviors

Matt Mayhew/New York University

Rebecca Caldwell/University of North Carolina at Wilmington

Aimee Hourigan/ University of North Carolina at Wilmington

International Comparative Curriculum in a Semester Abroad: Conversations with American Student Travelers

James Barber/University of Michigan

Intersections of Curricular and Organizational Change

Research and Theory: Where Do We Go from Here?

Lisa R. Lattuca/The Pennsylvania State University

Jennifer M. Domagal-Goldman/The Pennsylvania State University

H4 ■ Presidential Session

Grand Ballroom E

Higher Education Journals in the 21st Century

Leonard Baird/Journal of Higher Education

Ana Martínez Alemán/Educational Policy

Gary Rhoades/Higher Education

Amaury Nora/The Review of Higher Education

Florence Hamrick/The Journal of College Student Development

H5 ■ Research/Scholarly Papers

Grand Ballroom F

The View from the States

Chair: Jesse Mendez/Oklahoma State University

Discussant: Alma Maldonado-Maldonado/The University of Arizona

The Effect Of In-State Resident Tuition Eligibility On The College Enrollment Of Undocumented Latino Students In Texas

Stella Flores/Harvard University

Pricing the Flagships: The Political Economy of Tuition Setting at Public Research Universities

Michael McLendon/Vanderbilt University

James Hearn/Vanderbilt University

Robert Hammond/Vanderbilt University

State Higher Education Governance Restructuring: Massachusetts Case Study

David Tandberg/The Pennsylvania State University

Christian Anderson/The Pennsylvania State University

The Relationship Between the Selection of Public Trustees and State Higher Education Performance

James T. Minor/Michigan State University

H6 ■ Research/Scholarly Papers

Grand Ballroom G

The Borderlands of Asian Americans in Higher Education

*Chair: Deborah Floyd/Florida Atlantic University
Discussant: Robert Teranishi/New York University*

Korean American Women College Students on the Borderlands: Constructions of Success, Failure, and the Self
Jennifer Hong-Silwany/Teachers College, Columbia University

Asian American College Students in Education Studies: A Review of Three Journals, 1996 - 2006
Oiyen Poon/University of California, Los Angeles

Asian American and Pacific Islander Student Perspectives on Minority Serving Institutions
Julie Park/University of California, Los Angeles

Looking Beyond the Numbers: Assessing Campus Climate for Asian American Students
Sharon S. Lee/University of Illinois at Urbana-Champaign

H7 ■ Symposium

Garden 1

Student Development in the Academic Marketplace and Age of Technology

Moderator: Joan Hirt/Virginia Tech University

Nancy Evans/Iowa State University
Vasti Torres/Indiana University
Terrell Strayhorn/The University of Tennessee
David Kniola/Virginia Tech University

H8 ■ Research/Scholarly Papers

Garden 2

Student Engagement and Faculty Roles

*Chair: Jocelyn Banaria/University of California, Berkeley
Discussant: Christine Golde/The Carnegie Foundation*

Is Freshman Retention a Consequence of Faculty Employment Status?: How Part-Time Faculty Affect Student Outcomes.
Audrey Jaeger/North Carolina State University
Courtney Thornton/North Carolina State University
Kevin Eagan/University of California, Los Angeles

Shattering the Mold: Examining Critical Differences in Faculty Composition and Faculty Roles at For-Profit Degree-Granting Institutions
Vicente Lechuga/Texas A & M University

Faculty Growth and Development: The Importance of Autonomy, Competence, and Relatedness
Jay Dee/University of Massachusetts, Boston
Cheryl Daly/University of New Hampshire
Alan Henkin/University of Iowa

Mentoring and Being Mentored: Effective Mentoring Across Genders and Ethnicities
Sindie Shollenberger/University of Minnesota
Carole J. Bland/University of Minnesota
Anne Taylor/University of Minnesota
Patricia A. Mulcahy/University of Minnesota
Anne Marie Weber Main/University of Minnesota

H9 ■ Symposium

Garden 3

Methodological Borderlines: A Dialogue on the Intersection of Positionality and Quality in Critical Qualitative Inquiry

Moderator: Rozana Carducci/University of California, Los Angeles

Melissa Contreras-McGavin/University of Southern California
Aaron Kuntz/University of Massachusetts, Amherst
Penny Pasque/University of Michigan

H10 ■ Symposium

Garden 4

Increasing Access to College: Understanding the Role of High School Counselors

*Moderator: Ryan J. Davis/University of Maryland
Discussant: Kassie Freeman/Bowdoin College*

Laura W. Perna/University of Pennsylvania
Shaun R. Harper/The Pennsylvania State University
Patricia McDonough/University of California, Los Angeles
Ontario S. Wooden/Albany State University
Edward St. John/University of Michigan

Blurring the Borders

Juliet V. Garcia

President

University of Texas at Brownsville & Texas Southmost College

Introduction: Anna Neumann/Teachers College, Columbia University

Concurrent Session I ■ November 4 ■ 11:30am - 1:00pm

I1 ■ Research/Scholarly Papers

Grand Ballroom B

Student Persistence and Retention

Chair: Robert Palmer/Morgan State University

Discussant: Robert D. Reason/The Pennsylvania State University

Institutional Practices and Student Persistence: Extending the Empirical Record

Mary Ziskin/Indiana University

Jacob P.K. Gross/Indiana University

Donald Hossler/Indiana University

Serving Sophomores: A National Study of Initiatives for Second-Year College Students

Bradley Cox/The Pennsylvania State University

Stephanie K. Serven/Marymount University

Barbara Tobolowsky/University of South Carolina

Not New, But I Still Feel Lost: Examining the Experiences of Second-Year Students

Ann Gansemer-Topf/Grinnell College

Joyce Stern/Grinnell College

Mimi Benjamin/Iowa State University

Effects of Climate on Second-Year Persistence Decisions: An Examination of Racial/Ethnic Differences Using Structural Equation Modeling

Samuel D. Museus/The Pennsylvania State University

Andrew H. Nichols/The Pennsylvania State University

Amber Lambert/The Pennsylvania State University

Shaun R. Harper/The Pennsylvania State University

I2 ■ Research/Scholarly Papers

Grand Ballroom C

Perspectives on the Advancement of Female Experiences and Outcomes

Chair: Kimberly Griffin/University of California, Los Angeles

Discussant: Crystal Gafford Muhammad/East Carolina University

Beyond Equal Representation: Perspectives of Gender Equity from the New Majority in Doctoral Education

Tara Watford/University of California, Los Angeles

A Comparison of Undergraduate Women's Leadership Self-Confidence and Future Leadership Aspirations at Women's Colleges and Coeducational Institutions

Jennifer Curley/University of California/Los Angeles

Female Student Experiences in Information Technology Majors: Exploring the Intersections of Classroom Discourse and Gender

Julia Colyar/Southern Illinois University, Carbondale

Anita Kelly/Southern Illinois University, Carbondale

Belle Woodward/Southern Illinois University, Carbondale

Susanne Ashby/Southern Illinois University, Carbondale

Strength in the Spirit: African American College Women and Spiritual Coping Mechanisms

Lori D. Patton/Iowa State University

Michelle McClure/Marquette University

I3 ■ Symposium

Grand Ballroom D

Bridging Self and Scholar: Autobiography as Pedagogy for Learning about Race and Gender in Education

Chair: Becky Ropers-Huilman/Louisiana State University

Discussant: Anna Neumann/Teachers College, Columbia University

Marco Barker/Louisiana State University

Jennifer Loftin/Louisiana State University

Tam Le/Louisiana State University

Mark Dochterman/Louisiana State University

I4 ■ Symposium

Grand Ballroom E

State Performance Accountability in Higher Education: A Symposium Discussion of Its Origins, Impacts, and Futures

Moderator: Kevin Dougherty/Teachers College, Columbia University

Michael McLendon/Vanderbilt University
James Hearn/University of Georgia
Vanessa Morest/Teachers College, Columbia University
Monica Reid/Teachers College, Columbia University
Nancy Shulock/California State University, Sacramento

I5 ■ Research/Scholarly Papers

Grand Ballroom F

Administrative Perceptions and Organizational Cultures

Chair: Xinquan Jiang/University of Michigan
Discussant: Marilyn Amey/Michigan State University

Possibility, Identity, Action, and Meaning: An Integrated Model of Student Learning for Social Change
Melissa Peet/University of Michigan

Collapsing the Border between Research and Instruction: The Dilemmas of Critical Pedagogy in a Research University
Marie-France Orillion/University of California, Riverside

The Cultural Reproduction of Architectural Education
Jennifer Chamberlin/University of Michigan

Considering Race and Space: Mapping Developmental Approaches for Providing Culturally Responsive Service
Roland Mitchell/Louisiana State University
Gerald Wood/University of Northern Arizona

I6 ■ Research/Scholarly Papers

Grand Ballroom G

Student Involvement, Engagement, and Success

Chair: Miguel Ceja/California State University, Sacramento
Discussant: Brian Bridges/Center for Advancement of Racial and Ethnic Equity, ACE

Any Differences in Patterns of Involvement? A Comparative Study of Transfer Students and Native Students at a Four-Year Public Research University
Xueli Wang/The Ohio State University
Barbara I. Wharton/The Ohio State University

Examining the Influence of Involvement on Degree Completion among Black Students by Gender
Kevin Eagan/University of California, Los Angeles

Student-Faculty Interaction and Student Educational Outcomes in College: Examining Directions of Influence
Young Kyoung Kim/University of California, Los Angeles

The Influence of Student Expectations on First-Year Student Engagement and Success
Jillian Kinzie/Indiana University, Bloomington
Robert Gonyea/Indiana University, Bloomington
George Kuh/Indiana University, Bloomington

I7 ■ Symposium

Garden 1

Truth is Strangest in Fiction: A Conversation about the Evolution and Influence of Academic Novels

Moderator: Katherine Chaddock/University of South Carolina
Discussant: Philo Hutcheson/Georgia State University

Christian Anderson/The Pennsylvania State University
Marybeth Gasman/University of Pennsylvania
Jana Nidiffer/University of Michigan
L. Jackson Newell/Deep Springs College

I8 ■ Symposium

Garden 4

We Asked for Workers and They Sent Us People: College-ready Undocumented Immigrant Students and Their Teacher Allies in North Carolina

Moderator: Michael A. Olivas/University of Houston

Paz Oliverez/University of Southern California
Ruben Barato/New York University
Janet Kier Lopez/University of North Carolina, Chapel Hill

I9 ■ Research/Scholarly Papers

Garden 2

Contemporary Issues in Higher Education

Chair: Jennifer Delaney/Stanford University
Discussant: Linda Sax/University of California, Los Angeles

The Construct Validity of Student Engagement: A Confirmatory Factor Analysis
Steven LaNasa/University of Missouri, Kansas City
Alberto Cabrera/University of Maryland

Classifying Doctorate-granting Universities: An Alternative Approach
Alexander McCormick/The Carnegie Foundation
Chun-Mei Zhao/The Carnegie Foundation

The Squeaky Wheel: Quantitative and Qualitative Results of a Web Based Doctoral Climate Survey
Herbert Turner/University of Pennsylvania
Lois MacNamara/University of Pennsylvania

The Effect of Increased Academic Intensity on Transfer Rates: An Application of Matching Estimators to Student Unit Record Data
William Doyle/Vanderbilt University

I10 and I11

Continued on Next Page

110 ■ Graduate Student Session

Garden 3

Graduate Student Luncheon/Establishing Yourself as a Professional within the Field of Higher Education

Chair: Ashley Mouberry Sieman/North Carolina State University

Estela Bensimon/University of Southern California
Gary Rhoades/The University of Arizona
Shaun R. Harper/The Pennsylvania State University

Experts and advanced graduate students in the field will give advice on finding and developing mentoring relationships, the politics of higher education, ethics, steps to take in establishing a strong professional reputation, and common (avoidable) mistakes that graduate students make.

111 ■ Research/Scholarly Papers

Salon 6

Measuring Student Success

Chair: Eduardo Arellano/New Mexico State University
Discussant: Nathaniel Bray/University of Alabama

Access Reconsidered: The Effects of Social Background Characteristics, Academic Experiences, and Organizational Qualities on the Transfer Destinations of California Community College Students
Caroline Sheldon/Cerritos Community College

Articulating success: Community college transfer students graduate at the same rate as rising juniors in the four-year college

Tatiana Melguizo/University of Southern California
Alicia Dowd/University of Massachusetts, Boston

Level of Rigor: Considering Elements of a Constrained Curriculum and its Impact on Student Achievement, High School Graduation and College Continuation
Nathan Daun-Barnett/University of Michigan

Beyond the Borderlines of Measuring Student Success: A Case Study of UI Records among Community College Students
Frankie Santos Laanan/Iowa State University
Jonathan Compton/Iowa State University
Soko Starobin/Iowa State University
Janice Nahra Friedel/Iowa Department of Education

Concurrent Session J ■ November 4 ■ 1:15pm - 2:45pm

J1 ■ Symposium

Grand Ballroom B

Beyond Phoenix: Diversity and Distinctiveness in For-Profit Higher Education

Kevin Kinser/University of Albany, SUNY
Anna Chung/University of Michigan
Vincente Lechuga/Texas A & M University
Mary Kelly/Southwestern College

J2 ■ Research/Scholarly Papers

Grand Ballroom C

Towards a Seamless Transition: Modeling P-16

Chair: Miguel Ceja/California State University, Sacramento
Discussant: William Doyle/Vanderbilt University

The Beginnings of K-16 Initiatives: An Historical Analysis
Marc Van Overbeke/Northern Illinois University

State Policy and the P-16 Transition for Diverse Students
Glenda Musoba/Florida International University

How Two Leading Educational Reform States Align and Misalign P-16 Policy
Debra Bragg/University of Illinois
Eunyoung Kim/University of Illinois at Urbana-Champaign

Bridging the Divide Between High School and Higher Education for Students of Color: A Qualitative Study of School Reform Implementation
Kimberly White-Smith/Chapman University
Monica White/Teachers College, Columbia University

J3 ■ Research/Scholarly Papers

Grand Ballroom D

Pedagogical Borders: Classroom-based Research

Chair: Dorian McCoy/The University of Vermont
Discussant: Cynthia Macgregor/Missouri State University

Cultivating Critical Thinkers: Insights from an Elite Institution
Lisa Tsui/The Urban Institute

Trends in Student Learning Needs and Pedagogy in Community College Developmental Education from a National Case Study
Dolores Perin/Teachers College, Columbia University

Border Crossing and Difficult Dialogues: Uses of the Privileged Identity Exploration (PIE) Model in the Classroom
Sherry Watt/University of Iowa
Jerri Drummond/University of Iowa
Angela Kellogg/University of Iowa
Marisela Rosas/University of Iowa
Adele Lozano/University of Iowa
Gregg Curtiss/University of Iowa
Gina Nicoli/University of Iowa

Domain-Specific Epistemologies Described by Liberal Arts Students: Implications for the Classroom
Betsy Palmer/Montana State University
Rose M. Marra/University of Missouri

J4 ■ Research/Scholarly Papers

Grand Ballroom F
Community College Faculty

Chair: Marilyn Amey/Michigan State University
Discussant: Pamela Eddy/Central Michigan University

Faculty Life in a Rural Community College
 John Murray/Texas Tech University

Maneuvering the Role as a Community College Artist-Educator: Scholarship Assessed
 John Gibson/Tulsa Community College
 John Murray/Texas Tech University

Community College Faculty Turnover Intentions: Demographic, Work Environment, and External Environment Variables
 Jay Dee/University of Massachusetts, Boston
 Cheryl Daly/University of New Hampshire
 Alan Henkin/University of Iowa

Expanding Community Colleges' Traditional Borders: An Internationalization Journey
 Jenny Samaan/University of Hawaii
 Joanne Cooper/University of Hawaii

J5 ■ Research/Scholarly Papers

Garden 1
Navigating the Graduate School Experience

Chair: Miloni Gandhi/University of California, Los Angeles
Discussant: Brian Prescott/Western Interstate Commission for Higher Education

Graduate Student Involvement: Socialization for the Professional Role
 Susan Gardner/Louisiana State University
 Benita J. Barnes/University of Massachusetts, Amherst

Navigating Graduate Borderlands and Racial Boundaries: Critical Relationships between Black Students and White Faculty
 Franklin Tuitt/University of Denver

An Examination of the Influence of Self-Efficacy and Financial Factors on Graduate Student Professional and Scholarly Engagement
 Amaury Nora/University of Houston
 Blanca Plazas Synder/University of Houston

Flying Solo: The Stories of Latina/o Graduate Students at a Midwestern University
 Ebelia Hernandez/Indiana University, Bloomington

J6 ■ Research/Scholarly Papers

Garden 2
The Latino Educational Pipeline

Chair: Leticia Bustillos/University of Southern California
Discussant: Octavio Villalpando/University of Utah

Latino Students and the Educational Pipeline
 W. Scott Swail/Educational Policy Institute
 Alberto Cabrera/University of Maryland

Do Characteristics of the Millennial Generation Fit Latino College Students?
 Dorali Pichardo/California State University, Long Beach

When College Dreams are Disabled: The Case Study of a Low-Income Learning Disabled Latino High School Student
 Kristan Venegas/University of Nevada, Reno
 Kimberly R. Rogers/University at Buffalo

J7 ■ Research/Scholarly Papers

Garden 3
Identities, Bridges, and Boundaries

Chair: Patrick Dilley/Southern Illinois University
Discussant: James T. Minor/Michigan State University

A Comparative Analysis of the Effects of Resource Allocation on First-Year Writing Programs Across Four Sectors of Higher Education
 Kathleen M. Shaw/Pennsylvania Department of Education
 Erin McNamara Horvat/Temple University
 James Earl Davis/Temple University
 Kate Callahan/Temple University
 Kimberly LeChasseur/Temple University

The Role of Summer Bridge Programs in Access, College Adjustment, and Persistence among Black Male Undergraduates: Implications for Policy
 Shaun R. Harper/The Pennsylvania State University
 Ryan J. Davis/University of Maryland

Asian Americans and Higher Education Policy: A Critical Race Perspective
 Robert Teranishi/New York University

Considering Gender, Race, and Ethnicity in Boundary Crossers' Worldviews Toward Changing Higher Education
 Penny Pasque/University of Michigan

J8 ■ Presidential Session

Garden 4
Emerging Perspectives on Student Success

James Hearn/University of Georgia
 Jillian Kinzie/Indiana University
 Ana Martínez Alemán/Boston College
 Brian Pusser/University of Virginia
 Laura W. Perna/The University of Pennsylvania
 Susan Talburt/Georgia State University

JRT ■ Roundtables
 Pacific and Harbor

Complete Listing on Next Page

JRT ■ Roundtables

Pacific

1. Community Colleges and Baccalaureate Degree Attainment: Using Community Colleges to Finance the Freshman and Sophomore Years
Kevin Barron/The Pennsylvania State University
2. How Do You “Know It When You See It?”: Using Rubrics to Assess Students’ Learning at the Program Level
Jennifer Cochran/Central Michigan University
Denise Webster/Central Michigan University
3. The Use of Social Network Analysis in Higher Education Studies
Denise Collins/Indiana State University
Dawn Underwood/Indiana State University
Joshua Powers/Indiana State University
4. Rate My Professor: What Matters to Students in Evaluating Faculty Teaching and Engagement?
Diane Dean/Illinois State University
5. The Impact of Instructional Staffing Configurations and Ratios on Student Engagement and Graduation Rates: A National Study
Martin Finkelstein/Seton Hall University
Shouping Hu/Florida State University
Robert Gonyea/Indiana University, Bloomington
6. Preparing the Next Generation of Higher Education Leaders: The Influence of Graduate Program Curriculum
Tara Lynn Fulton/Lock Haven University
Adrianna Kezar/University of Southern California
Jerlando Jackson/University of Wisconsin, Madison
Pamela Eddy/Central Michigan University
7. Borderland Crossings: African American Women Faculty Paving Their Own Road to Academic Success
Sharon Holmes/Binghamton University
Lynette Land/University of Utah
Veronica D. Hinton-Hudson/University of Louisville
8. Conceptualizing Resentment: Toward Building a New Framework to Study the Impact of Racialized Policies
Sosanya Jones/Teachers College, Columbia University
9. General Education Assessment at Private Historically Black Colleges and Universities
Willis Jones/Vanderbilt University

Harbor

10. Considering Student Engagement in Canada: A Comparative Perspective
Camille Kandiko/Indiana University
Jillian Kinzie/Indiana University
Amy Garver/Indiana University
11. Understanding the Role of Alumni Involvement
Jerold Laguilles/University of Massachusetts, Amherst
12. Resistance and Consciousness-Raising: Social Justice Education Models as Experienced by Asian American Students
Dawn Lee/University of California, Davis
Nam Nguyen/San Jose State University
13. The Role and Use of Case Studies in Leadership Training and Academic Courses
Sarah Marshall/Central Michigan University
Anne Hornak/University of Toledo
14. African American Students at an Urban PWI
Henrietta Williams Pichon/Rowan University
15. Department Chair Leadership in the Life Sciences: Collegial Communicators and Change Agents
Todd Pourciau/Louisiana State University
16. The Problem with Tenure: Socialization Experiences of African American Female Faculty Members
Tonya Saddler/Virginia Polytechnic Institute & State University
17. Measuring Quality or “Gaming” the System: What Will the National Research Council’s Assessment of Doctoral Programs Produce, and Why Should We Care?
Ami Zusman/University of California



K1 ■ Research/Scholarly Papers

Grand Ballroom B

College Experiences and Outcomes among Low-Income and Working Class Students

Chair: Ryan J. Davis/University of Maryland
Discussant: MaryBeth Walpole/Rowan University

Is Social Class an Issue? The Peer Culture of Working Class Undergraduates
 Stephen Hess/Boston College

Policies and Practices that Improve Graduation Rates for Low-Income Students at Large, Public Four-Year Colleges and Universities

Jennifer Engle/The Pell Institute
 John Lee/JBL Associates
 Lana Muraskin/The Pell Institute

Understanding the Risk of Departure Among College Students from Low-Income Families: Evidence from a Discrete-Time Event History Analysis
 Rong Chen/University of Michigan

The Learned Laborer: Working-class Students in Post-Secondary Education
 Dawn Zeligman/Michigan State University

K2 ■ Symposium

Grand Ballroom C

Reframing Community College Teaching and Learning: Pushing the Boundaries of Tradition

Moderator: Romero Jalomo, Jr./San Jose/Evergreen Community College District

Frankie Santos Laanan/Iowa State University
 Soko Starobin/Iowa State University
 Barbara Townsend/University of Missouri, Columbia
 Nana Osei-Kofi/Iowa State University

K3 ■ Research/Scholarly Papers

Grand Ballroom D

Academic Capitalism and Hierarchies

Chair: Athena Perrakis/University of San Diego
Discussant: Amy Metcalfe/University of British Columbia

Labor Market Returns on For-Profit Postsecondary Degrees in the United States
 Anna Chung/University of Michigan

A Corollary to Academic Capitalism: Benkler's Peer-Production Model and Nonmarket Strategies
 Andrea Nixon/University of Minnesota

Academic Capitalism and Academic Culture: A Case Study
 Pilar Mendoza/Oklahoma State University
 Joseph Berger/University of Massachusetts, Amherst

Reputation Among Graduate Programs: Comparing Correlates of U.S. News Graduate Reputation Ratings between Five Academic Disciplines
 Kyle Sweitzer/The Pennsylvania State University

K4 ■ Symposium

Grand Ballroom E

If Not for the Rewards . . . Why? Theory-based Research about What Motivates Faculty to Engage in Public Scholarship

Moderator: Dwight Giles/University of Massachusetts, Boston

Carol Colbeck/The Pennsylvania State University
 KerryAnn O'Meara/University of Massachusetts, Amherst
 Lisa Weaver/The Pennsylvania State University
 Emily Janke/The Pennsylvania State University
 Scott Peters/Cornell University
 Theodore Alter/The Pennsylvania State University

K5 ■ Research/Scholarly Papers

Grand Ballroom F

Community College as a Gateway to a Four-Year Degree

Chair: Mary Ginter/Pima Community College
Discussant: Eboni Zamani/-Gallaher Eastern Michigan University

Rethinking A Traditional Model of College Dropout and How It Applies to Students at Two-Year Colleges
 Regina Deil-Amen/The Pennsylvania State University

Testing a "Commuter" Model of Persistence among Two-year College Students

Ann Person/Northwestern University
 Jennifer Stephan/Northwestern University
 James Rosenbaum/Northwestern University

Persistence Through Transfer: Educational Attainment of Four-year College Transfer Students

Po Yang/Teachers College, Columbia University

The Experience of Being a Transfer Student at a Four-Year University

Karen Kerr/California State University, Long Beach

K6 ■ Symposium

Grand Ballroom G

Historical Student Activism Reconsidered: A Symposium

Jana Nidiffer/University of Michigan
 Joy Ann Williamson/Stanford University
 John Thelin/University of Kentucky
 Marybeth Gasman/University of Pennsylvania

K7 ■ Symposium

Garden 2

Loss of Talent: Highly Gifted Undocumented Students in the U.S.

William Perez/Claremont Graduate University
 Heidi Coronado/Claremont Graduate University
 Richard Cortés/Claremont Graduate University
 Karina Ramos/Claremont Graduate University

K8 ■ Symposium

Garden 1

From the Margins to the Mainstream: Feminist Perspectives on Faculty Work Lives

Chair: Margaret Sallee/University of Southern California
Discussant: Becky Ropers-Huilman/Louisiana State University

Kelly Ward/Washington State University
 Lisa Wolf-Wendel/University of Kansas
 Marc Goulden/University of California, Berkeley
 Jaime Lester/Old Dominion University
 Margaret Sallee/University of Southern California

K10 ■ Research/Scholarly Papers

Garden 4

Rethinking Institutional Budgeting, Revenue, and Costs

Chair: Marcela Muniz/Stanford University
Discussant: John Levin/University of California, Riverside

The Impact of Undergraduate Loan Debt on Postbaccalaureate Program Attendance among Alumni of Central Appalachian Colleges and Universities
 Ty Cruce/Indiana University
 Gregory C. Wolniak/University of Iowa
 Ernest T. Pascarella/University of Iowa

Revenue Privatization in Public Higher Education: A Pooled Time-Series Analysis of Twenty Years of Variation in State Appropriation Patterns
 Michael McLendon/Vanderbilt University
 James Hearn/University of Georgia
 Christine Mokher/Vanderbilt University

A Multi-Institution Analysis of the Effects of Campus-Based Financial Aid On Student Persistence at Public Four-Year Institutions
 Don Hossler/Indiana University
 Paul Gross/Indiana University
 Mary Ziskin/Indiana University

Aspects of Fiscal Federalism in Cost Sharing: A Study on Student Financial Assistance Policy in Latvia
 Rita Kasa/University at Buffalo

K11 ■ Symposium

Salon 7/8

Making Good on Our Word: STEM Faculty and K-16 Partnerships

Chair: Patricia Maloney/Change & Sustainability in Higher Education Project

Penelope Earley/George Mason University
 Luz Mangurian/Towson University
 Richard Millman/University of Kentucky

K9 ■ Research/Scholarly Papers

Garden 3

Civic Engagement and Citizenship Among College Students

Chair: Steven Hubbard/New York University
Discussant: Leticia Oseguera/University of California, Irvine

Responsible Citizenship Among College Students: A Study of Predictive Experiences
 JoNes VanHecke/University of Michigan
 Patricia King/University of Michigan

The Contributions of Living-Learning Programs on Developing Civic Engagement in Undergraduate Students
 Heather Rowan-Kenyon/University of Virginia
 Matthew Soldner/University of Maryland, College Park
 Karen Kurotsuchi Inkelas/University of Maryland, College Park

College Student Involvement and Mobilization: An Ethnographic Study of a Christian Student Organization
 Peter Magolda/Miami University
 Kelsey Ebben/Miami University

L1 ■ Symposium

Grand Ballroom B

Bridges and Borders: The Intersections Between Critical Feminist Theories and Higher Education Praxis

Moderator/Discussant: Nana Osei-Kofi/Iowa State University

Tracy Buenavista/University of California, Los Angeles
 Anna Gonzalez/Claremont Graduate University
 Dimpal Jain/ University of California, Los Angeles
 Jaime Lester/University of Southern California

L2 ■ Symposium

Grand Ballroom C

Choosing the Research Mission: Strategic Institution-Building in the American Research University

Discussant: Adrianna Kezar/University of Southern California

Jane Robbins/Independent Scholar
 Nancy Diamond/Temple University
 Susan Richardson/Education by the Numbers, LLC

L3 ■ Research/Scholarly Papers

Grand Ballroom D

Perspectives on Student Learning in Higher Education

Chair: Lois Trautvetter/Northwestern University
Discussant: Nathaniel Bray/University of Alabama

The Effects of Internal Organizational Characteristics on Student Learning Experiences
 Patrick Terenzini/The Pennsylvania State University
 Lisa R. Lattuca/The Pennsylvania State University
 James Fredericks Volkwein/The Pennsylvania State University

A Mixed Methods Analysis of Integrated Learning among College Students
 Patricia King/University of Michigan
 Cassie Barnhardt/University of Michigan
 Nathan Lindsay/University of Michigan

Retaining Students in Science, Math, and Engineering Majors: Rediscovering Cooperative Education
 Audrey Jaeger/North Carolina State University
 Kevin Eagan/University of California, Los Angeles

Pedagogical Approaches Used by Faculty in Holland's Model Environments: The Role of Environmental Consistency
 John Smart/University of Memphis
 Corinna Ethington/University of Memphis
 Paul Umbach/University of Iowa

L4 ■ Research/Scholarly Papers

Grand Ballroom E

Race, Class, and Educational Success

Chair: T. Elon Dancy III/Louisiana State University
Discussant: Shederick McClendon/University of Massachusetts, Amherst

Social and Cultural Capital, Race and Ethnicity, and Persistence in Higher Education
 Ryan Wells/University of Iowa

A Change of Academic Major: Does This Affect the Differences in Degree Completion Rates Across Racial/Ethnic Groups?
 Dongbin Kim/University of Kansas
 Lisa Wolf-Wendel/University of Kansas

Understanding the Role of Campus Culture in the Engagement and Persistence of Racial/Ethnic Minority Students
 Samuel Museus/The Pennsylvania State University

How Do Race and Socioeconomic Background Influence Experiences of Good Practices in Undergraduate Education?
 Kathleen M. Goodman/University of Iowa
 Tricia A. Seifert/University of Iowa
 James D. Jorgensen/University of Iowa
 Gregory C. Wolniak/Human Capital Research Corporation
 Ernest T. Pascarella/University of Iowa
 Charles F. Blaich/Wabash College
 Carol Heary Schneider/Association of American College and Universities

L5 ■ Research/Scholarly Papers

Grand Ballroom F

Faculty on the Borders

Chair: Patrick Dilley/Southern Illinois University
Discussant: Terrell Strayhorn/The University of Tennessee

Potential Sources Of Failure In Doctoral Study: What Doctoral Advisors Expect From Their Advisees
 Benita J. Barnes/University of Massachusetts, Amherst

Opportunities and Challenges for Latino Faculty in Higher Education: A Multilevel Analysis of NSOPF99 Dataset
 Luis Ponjuan/University of Florida

Can Reaching Back Push You Forward?: A Qualitative Exploration of Black Professors' Perceptions of Their Relationships with Students
 Kimberly Griffin/University of California, Los Angeles

Organizational Climate and Status of Women at an Academic Health Center
 Sindie Shollenberger/University of Minnesota
 Carole J. Bland/University of Minnesota
 Anne Taylor/University of Minnesota
 Deborah Finstad/University of Minnesota

L6 ■ Research/Scholarly Papers

Grand Ballroom G

Higher Education and Civic Engagement: From Local to Global

Chair: Athena Perrakis/University of San Diego
Discussant: Christopher Rasmussen/Midwestern Higher Education Compact

Teaching Civic Engagement Leadership to International and American Students: Pedagogical Implications for the Global Classroom

Christine Cress/Portland State University
 Miki Yamashita/Portland State University

Fostering Civic Engagement through Community College Service Learning
 Mary Prentice/New Mexico State University

Advancing the Civic Purposes of Higher Education: Tracing the Trajectory of an Educational Reform Movement
 J. Matthew Hartley/University of Pennsylvania

Higher Education and African-American Civic Participation: An Empirical Examination of the "Talented Tenth" Concept
 Larry Rowley/University of Michigan
 Nathan Daun-Barnett/University of Michigan
 Venice Sule/University of Michigan

L7 ■ Symposium

Garden 1

The Challenge of Translational Research in Education: Writing across the Boundaries

Discussant: Susan Twombly/University of Kansas

Karri Holley/The University of Alabama
 William Tierney/University of Southern California
 Julia Colyar/Southern Illinois University
 Yvonna Lincoln/Texas A&M University

L8 ■ Symposium

Garden 2

Higher Education Desegregation Towards the End of an Era: Considerations of Justice, Law, and Policy

Moderator: M. Christopher Brown II/The Pennsylvania State University/AACTE

James T. Minor/Michigan State University
 Crystal Gafford Muhammad/East Carolina University
 Saran Donahoo/Southern Illinois University, Carbondale
 Marybeth Gasman/University of Pennsylvania

L9 ■ Symposium

Garden 3

States, Sectors and Students: The Impact of Merit Aid on Access and Enrollment

Chair/Discussant: Kenneth Redd/Council of Graduate Schools

Allison Ambrose/Illinois State University
 Kimberly R. Rogers/University at Buffalo
 Michelle Nilson/Simon Fraser University
 Patricia Farrell/Western Michigan University
 Greg Kienzl/American Institutes for Research

L10 ■ Symposium

Garden 4

Rethinking Border(lands) and Border Analysis: Higher Education's Return to Anzaldua

Facilitator: Richard T. Rodriguez/University of Illinois

Mirelsie Velazquez/University of Illinois at Urbana-Champaign
 Rufina Cortez/University of Illinois at Urbana-Champaign
 Judith Estrada/University of Illinois at Urbana-Champaign
 Berenice Vargas/University of Illinois at Urbana-Champaign



Special Event ■ November 4

ASHE Community Meeting

6:30pm - 7:30pm
 Terrace Plaza

Ruben A. Barato, New York University

Shadows in the Classroom: Undocumented Students in Community College

Director: Dr. Francis K. Stage

Mentor: Dr. Luis Miron, University of Illinois at Urbana-Champaign

Angela Bell, University of Georgia

College Opportunity in Context: An Analysis of Cultural, Organizational, and Policy Influences on the College Enrollment Behaviors of Students from Low-income Backgrounds

Director: Dr. Scott L. Thomas

Mentor: Dr. Anna Ortiz, California State University, Long Beach

Luciana Dar, University of California, Los Angeles

The Politics of Higher Education Spending in the American States, 1970-2004

Director: Dr. Susanne Lohmann

Mentor: Dr. Laura W. Perna, University of Pennsylvania

Jaime W. Deafenbaugh, The Ohio State University

The Land Grant Opportunity Scholars: An In-depth Examination of their College Transition and Persistence Experiences

Director: Dr. Ada Demb

Mentor: Dr. anthony antonio, Stanford University

Stella Flores, Harvard University

The Effect of In-State Resident Tuition Eligibility on the College Enrollment of Undocumented Latino Students in Texas

Director: Dr. Bridget Terry Long

Mentor: Dr. Ed St. John, University of Michigan

Su Jin Gatlin, Stanford University

Assets and Access: How Wealth Affects who Attends College and who Attends Selective Colleges

Director: Dr. anthony antonio

Mentor: Dr. Marybeth Walpole, Rowan University

Ryan Evely Gildersleeve, University of California, Los Angeles

Toward a College-Going Literacy: Voices of Migrant Students Coming to Know College Access

Director: Dr. Patricia McDonough

Mentor: Dr. Miguel Ceja, California State University, Sacramento

Rose M. Martinez, The University of Texas at Austin

The Road Less Traveled: Factors Affecting Community College Transfer Student Access to Elite Public Universities

Director: Dr. Patricia Somers

Mentor: Dr. Alicia Dowd, University of Southern California

Ebony McGee, University of Illinois at Chicago

Race, Identity, and Resilience: How Black College Students Negotiate Success in Mathematics and Engineering

Director: Dr. Danny Bernard Martin

Mentor: Dr. William Trent, University of Illinois at Urbana-Champaign

Named in memory of Irvin Lee (Bobby) Wright, this award recognizes one or more dissertations that serve as exemplary models of the methodology employed. Criteria also include the significance of the dissertation topic.

2005-2006: Aimee LaPointe Terosky
Taking Teaching Seriously: A Study of University Professors and Their Undergraduate Teaching

2004-2005: Liang Zhang
How College Affects Students: Toward the Reconciliation of Theory with Empirical Evidence

2003-2004: Toni E. Larson
Decentralization in U.S. Public Higher Education: A Comparative Study of New Jersey, Illinois, and Arkansas

2002-2003: Joni Mini Montez
Developing and Piloting the Higher Education Leadership Instrument (HELI)

2002-2003: Cited for Excellence: Christine Keller
Moving Forward or Standing Still: Progress in Achieving Wage Equality for women Faculty in the 1990s

2001-2002: Michael K. McLendon
Setting the Agenda for State Decentralization of Higher Education: Analyzing the Explanatory Boundaries of Alternative Agenda Models

2001-2002: Cited for Excellence: Joshua B. Powers
Academic Entrepreneurship: Institutional Effects on Performance of University Technology Transfer

2000-2001: David Weerts
Understanding Differences in State Support for Higher Education: A Comparative Study of State Appropriations for Research Universities

2000-2001: Cited for Excellence: William Mallon
Abolishing or Instituting Tenure: Four Case Studies of Change in Faculty Employment Policies

1999-2000: Marvin Dewey
An Exploratory Study of the Relationship Between Cognitive Complexity of Administrative Teams in Private Liberal Arts Colleges and Organizational Health as One Dimension of Organizational Effectiveness

1999-2000: Cited for Excellence: Elizabeth A. Palmer
An Analysis of a Diversity Requirement: The Effect of Course Characteristics on Students' Racial Attitudes, Gender Attitudes, and Self-Perceived Learning

1998-99: Deborah Faye Carter
A Dream Deferred? Examining the Degree Aspirations of African American and White College Students

1998-99: Cited for Excellence: R. Sam Larson
Organizational Change from the 'Inside': A Study of University Outreach

1997-98: Joseph Berger (Co-winner)
Organizational Behavior at Colleges and Student Outcomes: Generating a Quantitatively Grounded Theory

1997-98: Cynthia Sabik (Co-winner)
(Re) writing Metaphor and Form: Autoethnographic Enactments from the Postmodern Classroom

1996-97: Lisa Rose Lattuca
Envisioning Interdisciplinarity: Processes, Contexts, Outcomes

1996-97: Cited for Excellence: Rebecca Ropers-Huilman
Shaping an Island of Power and Change: Creating a Feminist Poststructural Teaching Discourse

1996-97: Cited for Excellence: Carol L. Colbeck
Organizational and Disciplinary Influences on Integration and Congruence of Faculty Work

1995-96: Teresa Isabelle Daza Campbell
Protecting the Public's Trust: A Search for Balance Among Benefits and Conflicts in University-Industry Relationships

1994-95: Robert A. Rhoads
Institutional Culture and Student Subculture: Student Identity and Socialization

1994-95: Cited for Excellence: Peter M. Magolda
A Quest for Community: An Ethnographic Study of a Residential College

1993-94: Rebecca R. Kline
The Social Practice of Literacy in a Program of Study Abroad

1993-94: Cited for Excellence: Dorothy Finnegan
Academic Career Lines: A Case Study of Faculty in Two Comprehensive Universities

1992-93: Martha Lillian Ann Stassen
White Faculty Members' Responses to Racial Diversity at Predominantly White Institutions

1991-92: Julie Neururer
Decency and Dollars Invested: Case Studies of South African Divestiture

1991-92: Cited for Excellence: Francoise Queval
The Evolution Toward Research Orientation and Capability in Comprehensive Universities: A Case Study: The California State University System

1990-91: Kenneth D. Crews, J.D.
Copyright Policies at American Research Universities: Balancing Information Needs and Legal Limits

- 1989-90: Roger L. Williams
George W. Atherton and the Beginnings of Federal Support for Higher Education
- 1988-89: Patricia Gumpert
The Social Construction of Knowledge: Individual and Institutional Commitment to Feminist Scholarship
- 1987-88: Dolores L. Burke
Change in the Academic Marketplace: A Study of Faculty Mobility in the 1980s
- 1986-87: Irvin Lee (Bobby) Wright
Piety, Politics and Profit: American Indian Missions in the Colonial Colleges
- 1986-87: Cited for Excellence: Lester F. Goodchild
The Mission of the Catholic University in the Midwest, 1842-1980
- 1985-86: Janet Kerr-Tener
From Truman to Johnson: Ad Hoc Policy Formulation in Higher Education
- 1985-86: Cited for Excellence: Amaury Nora
Determinants of Retention Among Chicano Students: A Structural Model
- 1985-86: Cited for Excellence: Charlotte Hanna
Modest Expectations: Qualitative and Quantitative Analysis of Faculty Affirmative Action
- 1984-85: Lois A. Fisher
State Legislatures and the Autonomy of Colleges and Universities: A Comparative Study of Legislation in Four States, 1900-79
- 1984-85: Runner-Up: Bernard Reams
Research Interactions Between Industry and Higher Education
- 1984-85: Cited for Excellence: Marta Wagner
The American Scholar in the Early National Period: The Changing Context of Colonial Education
- 1983-84: Jeffery Bartkovich
Designing an Empirically Derived Taxonomy of Organization Structures in Higher Education
- 1983-84: Cited for Excellence: Constance Collins
Loose Coupling as a Framework for Understanding Structural Change: Case Studies of Four American Colleges and Universities
- 1983-84: Cited for Excellence: Edward Ottensmeyer II
Strategic Organizational Adaptation and the Regulatory Environment: A Study of Universities During a Time of Regulatory Change
- 1982-83: Catherine Marienau
Bridging Theory and Practice in Adult Development and Planned Change
- 1982-83: Cited for Excellence: Jerry Wayne Askew
Toward a Theory on the Impact of Budget Retrenchment in Educational Organizations
- 1982-83: Cited for Excellence: Ellen Metzner Ironside
Career Paths of Women Administrators in Higher Education
- 1981-82: Ellen Chaffee
Decision Models in Budgeting
- 1981-82: Cited for Excellence: Ted I. K. Youn
The Career of Young Ph.D.s: Temporal Change and Institutional Effects
- 1981-82: Cited for Excellence: Joyce Mushaben
The State Versus the University: Juridicalization and the Politics of Higher Education at the Free University of Berlin, 1969-79
- 1980-81: Paul Duby
An Investigation of the Mediating Role of Causal Attitudes in School Learning
- 1980-81: Cited for Excellence: James Henson
Institutional Excellence and Student Achievement: A Study of College Quality and Its Impact on Education and Career Development
- 1979-80: Kenneth Bradley Orr
The Impact of the Depression Years 1929-39 on Faculty in American Colleges and Universities
- 1979-80: William Zumeta
The State and Doctoral Programs at the University of California: Academic Planning for an Uncertain Future
- 1979-80: Cited for Excellence: Daniel Carl Levy
University Autonomy Versus Government Control: The Mexican Case

HOWARD R. BOWEN DISTINGUISHED CAREER AWARD

Presented to an individual whose professional life has been devoted in substantial part to the study of higher education and whose career has significantly advanced the field through extraordinary scholarship, leadership and service. The award is usually presented at, or near, the time of the individual's retirement.

2005	Robert Birnbaum
2004	Yvonna Lincoln
2003	Ernest T. Pascarella
2002	Marvin W. Peterson
2001	Helen S. Astin
2000	Arthur Chickering
1999	Joan S. Stark
1998	Arthur Cohen
1997	Burton Clark
1996	Alexander W. Astin
1995	William Toombs
1994	Robert Silverman
1993	Robert O. Berdahl
1992	K. Patricia Cross
1991	Cameron Fincher
1989	Mary Corcoran
1989	Robert Pace
1987	Lewis Mayhew
1987	Joseph Kauffman
1986	David Riesman
1985	Howard R. Bowen

SPECIAL MERIT AWARD

Presented to a person, group or organization in recognition of distinctive support for the purposes and goals of the Association for the Study of Higher Education. This award may be presented to an influential academic leader or a scholar outside the field of higher education who has offered a valuable perspective for studying and understanding colleges and universities.

2005	Samuel E. Kellams
2004	Jerry Davis/Lumina
2003	University of Michigan Affirmative Action Defense Team
2002	Walter R. Allen
2001	Clifford Adelman
2001	Deborah Wilds
2000	Michael A. Olivas
1995	Lavina Fielding Anderson
1993	Walter Hobbs
1992	Jossey-Bass Inc. Publishers
1990	Peggy Heim
1990	Robert Silverman

ASHE DISTINGUISHED SERVICE AWARD

Presented in recognition of exceptional commitment to the Association for the Study of Higher Education and significant contribution to its success.

2005	Carol Everly Floyd
2004	Wynetta Lee
2003	Ann E. Austin
2002	Barbara K. Townsend
2001	Robert O. Berdahl
2000	Mildred Garcia
1999	Philip G. Altbach
1998	Joan S. Stark
1996	Stan Carpenter
1996	Patricia Hyer
1995	Daryl Smith
1993	John C. Smart
1990	L. Jackson Newell
1987	Jonathan Fife

RESEARCH ACHIEVEMENT AWARD

Presented for outstanding contribution to research for an individual whose published research (theoretical, empirical or applied) advances understanding of higher education in a significant way. The Research Achievement Award may acknowledge a body of research or a single piece of meritorious research.

2005	Arthur M. Cohen
2004	Judith Glazer-Raymo
2003	Michael T. Nettles
2002	David W. Leslie
2001	John C. Smart
2000	George Kuh
1999	Vincent Tinto
1998	Sheila Slaughter
1997	William G. Tierney
1996	Kenneth A. Feldman
1995	Larry L. Leslie
1994	Michael A. Olivas
1993	Yvonna S. Lincoln
1992	Joan Stark
1991	Ernest Pascarella
1991	Patrick Terenzini
1990	Robert Birnbaum
1989	Jack Schuster
1988	Robert Blackburn
1988	Howard Bowen
1987	Alexander W. Astin
1985	Burton Clark

EARLY CAREER AWARD

Given for a significant body of scholarship or a single extraordinary research achievement by a higher education scholar, and in recognition of potential for future research. This award may also call attention to significant work in progress that has won praise from senior colleagues and support from foundations or government agencies. The Early Career Award, called the Promising Scholar award in 1989 and 1990, is reserved for individuals who are no more than six years beyond the receipt of the doctoral degree.

2005	Brian Pusser
2004	anthony I. antonio
2003	Laura W. Perna
2002	Donald E. Heller
2001	M. Christopher Brown II
2000	Linda Serra Hagedorn
2000	Lisa Wolf-Wendel
1999	Linda J. Sax
1998	Jennifer Grant Haworth
1997	Rob Rhoads
1996	Eric Dey
1995	Sylvia Hurtado
1995	Elizabeth Whitt
1993	Alberto Cabrera
1993	Patricia Gumpert
1991	Amaury Nora
1990	Fran Stage
1989	Ann Austin

LEADERSHIP AWARD

Given for outstanding leadership in advancing the study of higher education. This award is intended to recognize individuals who bring visibility and support to the field of higher education by demonstrating the contributions of the study of higher education to policy formation, or in gaining substantial resources for research and training in higher education.

2005	Ann I. Morey
2004	Stan Ikeberry
2003	Kathryn M. Moore
2002	Edward St. John
2001	William Bowen
2000	Ted Marchese
1999	Zelda Gamson
1996	Peter Ewell
1995	Derek Bok
1992	Ernest Boyer
1990	Kenneth P. Mortimer

President

Estela Mara Bensimon
University of Southern
California
bensimon@usc.edu

At-Large Member

Michael McLendon
Vanderbilt University
michael.
k.mclendon@vanderbilt.edu

Graduate Student Member

Kimberly R. Rogers
University at Buffalo
krrogers@buffalo.edu

President Elect

Linda K. Johnsrud
University of Hawai'i
johnsrud@hawaii.edu

At-Large Member

Kelly Ward
Washington State
University
kaward@wsu.edu

Graduate Student Member

Ashley Mouberry Sieman
North Carolina State
University
mouberry@email.unc.edu

Immediate Past President

Sylvia Hurtado
University of California
at Los Angeles
sylvia.hurtado@gmail.edu

At-Large Member

Deborah Faye Carter
University of Michigan
dfcarter@umich.edu

Legal Counsel

J. Douglas Toma
University of Georgia
jdt@uga.edu

At-Large Member

Laura Perna
University of Pennsylvania
lperna@gse.upenn.edu

Executive Director

Dennis F. Brown
Michigan State University
browndf@msu.edu

ASHE Presidents

2005-2006	Estela Mara Bensimon	1990-1991	Judith Dozier Hackman
2004-2005	Sylvia Hurtado	1989-1990	Ernest T. Pascarella
2003-2004	Gary Rhoades	1988-1989	Ellen Earle Chaffee
2002-2003	John M. Braxton	1987-1988	Clifton Conrad
2001-2000	William G. Tierney	1986-1987	David W. Leslie
2000-2001	Ann E. Austin	1985-1986	Robert Birnbaum
1999-2000	John Thelin	1984-1985	Joan S. Stark
1998-1999	Laura Rendon	1983-1984	Kathryn M. Moore
1997-1998	Yvonna Lincoln	1982-1983	Marvin W. Peterson
1996-1997	George Kuh	1981-1982	Joseph F. Kauffman
1995-1996	Sheila Slaughter	1980-1981	Howard R. Bowen
1994-1995	Patrick Terenzini	1979-1980	Burton R. Clark
1993-1994	Elaine El-Khawas	1978-1979	Robert O. Berdahl
1992-1993	Michael T. Nettles	1977-1978	Kenneth P. Mortimer
1991-1992	Shirley M. Clark	1976-1977	C. Robert Pace

The 2006 ASHE Program Committee recognizes the following reviewers for their assistance in developing this year's program. Our work would not have been possible without theirs.

Abes, Elisa
 Ackerson, Betsy Virginia
 Ait Si Muhamed, Ali
 Alexander-Snow, Mia
 Allan, Elizabeth J.
 Allen, Angela D
 Alstete, Jeffrey
 Amelink, Catherine T.
 Amey, Marilyn J.
 Anderson, Christian K
 Anderson, Melissa S.
 Anderson-Thompkins, Sibby
 Antonaros, Mary Edna
 antonio, anthony
 Aper, Jeff
 Appiah, Elizabeth
 Arcahmbault-Crim, Karen
 Arif, Azza
 Arminio, Jan
 Asha Cooper, Michelle
 Austin, Ann E.
 Awe, Clara
 Ayers, David F.
 Bain, Olga
 Baker, Karen
 Baker, Vicki L.
 Baldwin, Candice
 Banaria, Jocelyn
 Barker, Marco J
 Barnes, Benita J.
 Barratt, Will
 Barrett, T. Gregory
 Baxter Magolda, Marcia B.
 Beach, Andrea L
 Bean, John P
 Beerkens, Eric
 Benjamin, Mimi
 Bensimon, Estela M
 Berger, Joseph
 Bergerson, Amy A.
 Bertram Gallant, Tricia
 Bess, James L
 Bieber, Jeffery P.
 Blankenship, John
 Bonner, II, Fred A.
 Borcoman, Gabriela
 Bornstein, Rita
 Bourke, Brian D
 Bowman, Nicholas A.
 Boyle, Kathleen M.
 Braxton, John M.
 Bray, Nathaniel J
 Bresciani, Dean L.
 Bridges, Brian K.
 Brint, Steven
 Briscoe, Kamilah

Brower, Aaron
 Brown Leonard, Jeannie
 Brown Wright, Dianne A.
 Brown, II, M. Christopher
 Bryant, Alyssa N.
 Buckley, Jennifer
 Buer, Troy Steven
 Bunnage, Joanne C.
 Burrell, Stephanie
 Bustillos, Leticia T.
 Butner, Bonita K.
 Cain, Timothy Reese
 Calderone, Shannon
 Calkins, Susanna
 Callahan, Kate
 Campbell, Dale
 Campbell, Susan E
 Card, Karen
 Cardona, Julio J.
 Carducci, Rozana
 Carpenter, Holly
 Carter, Deborah Faye
 Casillas Arellano, Eduardo
 Casteen, Laurie
 Cavote, Steve
 Cawthon, Tony
 Ceja, Miguel
 Cerna, Oscar
 Chaddock, Katherine E.
 Chapman, David W
 Chen, Rong
 Cheslock, John J
 Cintron, Rosa
 Clarke, Cynthia G.
 Coaxum, III, James
 Colbeck, Carol L.
 Collier, Mary Beth
 Collins, Denise
 Conley, Valerie
 Conrad, Clifton F.
 Cooper, Joanne E.
 Couturier, Lara K
 Creamer, Elizabeth G.
 Culpepper, Steve
 Curs, Bradley R
 Cutright, Marc
 Daniels, Brandon D.
 Dannells, Mike
 Dar, Luciana N
 Davis, Danielle
 Davis, Houston
 Davis, James Earl
 Davis, R. Deborah
 Davis, Ryan J
 Davis, Tracy M.
 Dean, Diane
 DeAngelo, Linda T
 Del Favero, Marietta
 Delaney, Jennifer Ann
 Delong, Allen
 DeSawal, Danielle M
 DesJardins, Stephen L.
 Dey, Eric
 Diamond, Nancy
 Dille, Patrick

DiRamio, David C
 Doane, Dudley J
 Domingo, Robert Jaymes
 Donahoo, Saran
 Dowd, Alicia C.
 Doyle, Jeff
 Doyle, Susan K
 Doyle, William
 Drezner, Noah D
 Dubrow, Greg
 Dykstra Boon, Rachel
 Eddy, Pamela
 Eggins, Heather
 Eggleston, Latrice E.
 Einarson, Marne
 Eisenmann, Linda
 Engberg, Mark
 England-Siegerdt, Christy
 Espino, Michelle M
 Evans, Nancy J.
 Evensen, Dorothy
 Fairweather, James S
 Fann, Amy
 Farrell, Patricia L
 Federico Cunningham, Alisa
 Fife, Jonathan
 Figueroa, Julie
 Finkelstein, Martin J
 Finnegan, Dorothy E.
 Flora, Bethany Hope
 Flowers, Lamont A.
 Floyd, Deborah L
 Forest, James J. F.
 Forward, G. L.
 Foubert, John
 Fries-Britt, Sharon
 Fuerstman, Daniel A
 Fulton, Tara
 Gafford Muhammad, Crystal R
 Gansemer-Topf, Ann
 Gardner, Susan K
 Gasman, Marybeth
 Gaston-Gayles, Joy
 Geertz Gonzalez, Roger
 Geiger, Roger L.
 Gerda, Janice J.
 Germain, Lauren
 Gibson Dixon, Karrie
 Gilbride-Brown, Jennifer
 Gildersleeve, R. Evelyn
 Gillett-Karam, Rosemary
 Gimmestad, Michael J
 Glazer-Raymo, Judith S.
 Golde, Christine M.
 Gomez, Gigi
 Gonyea, Robert
 González y González, Elsa
 Maria
 Gonzalez, Juan Carlos
 Gonzalez, Kenneth P.
 Goodman, Crystal
 Grimstead, Caryn Paige
 Griswold, Philip A
 Gross, P. Jacob
 Hallock, Hilton

Hamrick, Florence A.
 Hannah, K. Watson
 Hardy, David E
 Harris, Michael S.
 Hart, Jennifer Lynn
 Hartley, J
 Hearn, James C
 Heeter, Aimee
 Heiselt, April
 Helland, Pat
 Hernandez, Jeremy J.
 Hernquist, Angela I
 Herrera, Patricia
 Himelhoch, Carol R.
 Hinton, Kandace
 Hinton, Leone
 Hirschy, Amy
 Hirt, Joan B
 Hodges, Jennifer P
 Hoffman, Jennifer Lee
 Hoffman, Jess
 Holdsworth, Janet M
 Holland, Tina
 Holley, Karri
 Holloway-Friesen, Holly
 Hornak, Anne M
 Horton, Charles C.
 Howard-Hamilton, Mary
 Howell, Cameron
 Hoyt, DaVina
 Hu, Shouping
 Hudson, Ginny
 Hughes, Kevin M
 Hughes, Robin L.
 Hutcheson, Philo A.
 Hyle, Adrienne E
 Ignash, Jan M.
 Ingram, Ted N.
 Jackson, Jerlando F. L.
 Jacobs, Fred
 Jaeger, Audrey
 Janosik, Steven
 Jayakumar, Uma
 Jensen, Jane M.
 Johnson, Dawn R
 Johnson, Susan D
 Jones, Gwendolyn
 Jones, Sosanya
 Jun, Alexander
 Kaplan, Gabriel
 Kasa, Rita
 Kater, Sue
 Keenan, Kathleen
 Kempner, Ken
 Keup, Jennifer
 Kezar, Adrianna J
 Kile, Kimberly Sue
 Kim, Dongbin
 Kim, Eun Young
 King, Kathryn Claire
 Kinser, Kevin
 Kinzie, Jillian
 Kish, Kelly A
 Knight, MaryBeth
 Kolajo, Ebenezer

Kraly Morrison, Veronica
 Kraus, Janine M
 Kuntz, Aaron
 Kuykendall, John A.
 Lachica Buenavista, Tracy
 Lafer, Mark
 LaNasa, Steven
 Land, Lynette D
 Lane, Jason E
 LaPointe Terosky, Aimee J.
 Lattuca, Lisa R.
 Lazarus Stewart, Dafina L
 Lee, Jenny
 Lee-Thomas
 Lefebvre, Lauryl
 Leslie, David W.
 Lester, Jaime R
 Leverenz, Theo
 Levin, John S
 Lew, Jonathan Ward
 Lewis, Cassandra
 Lewis, Consuella
 Li, Dai
 Lindholm, Jennifer
 Lindsay, Nathan K.
 Livingston, Carolyn H
 Lloyd, Beth
 Lloyd, Scott
 Lloyd, Scott S.
 Loftin, Jennifer
 Longerbeam, Susan Diana
 Lott Jr., Joe
 Lovik, Eric G
 Ludwig, Nancy
 Lunceford, Christina
 Lundberg, Carol A
 Luukkonene, John
 Mabokela, Reitumetse O.
 Mahoney, Sandra
 Maldonado, Ceceilia
 Malik Gupta, Divya
 Maloney, Patricia A.
 Manning, Kathleen
 Marginson, Simon W
 Mars, Matthew M
 Martinez Aleman, Ana M
 Martinez, Mario C.
 Matveev, Alexei
 McBurnie, Grant
 McClure, Michelle
 McCormick, Alexander
 McCoy, Dorian L.
 McDade, Sharon A
 McDaniels, Melissa
 McDonald, Nicole L
 McEvoy, Suzanne
 McEwen, Marylu K.
 McKee-Culpepper, Malaika
 McLendon, Michael K
 McNally, Chris
 McNeal, Laura R
 McPhail, Christine
 Medwick, Allan Joseph
 Melguizo, Tatiana
 Merson, Dan
 Mettler, James R.
 Meyer, Heinz
 Milem, Jeffrey F.
 Miller, Elise S.
 Miller, Michael T.
 Millett, Catherine M.
 Mills, Michael R
 Minor, James T.
 Mitchell, Regina L.
 Modica, Shizuka
 Moore, Tami L
 morelon, carla
 Mophew, Christopher
 Mosi Locks, Angela
 Nelson Laird, Thomas
 Nettles, Michael T.
 Neumann, Anna
 Ngai, Hoi Ning
 Nidiffer, Jana
 Nilson, Michelle J
 Nix, Christina Marie
 Nooks, Kirk A
 Nur-Awaleh, Mohamed A
 O'Callaghan, Elizabeth
 Ogren, Christine A.
 Olsen, Deborah
 O'Meara, KerryAnn
 O'Neal, Chris
 Orsuwan, Meechai
 Ortiz, Anna M.
 Ouimet, Judith A.
 Ousley, Melissa Deanne
 Packard, Sandra
 Palmer, James C.
 Palmer, Megan M
 Park, Julie
 Parker, Tara L
 Parsons, Michael D.
 Pasque, Penny A
 Patton, Lori Denise
 Paulson, Karen
 Pereira, Kim
 Perna, Laura W.
 Petersen, Brent R.
 Pichon, Henrietta
 Pitre, Paul E.
 Pizzolato, Jane E
 Pope, Raechele L.
 Porter, Stephen R
 Pourciau, Todd A
 Powers, Joshua B
 Prentice, Mary
 Priest, Doug
 Quayle, Stephen John
 Quinn, Arthur
 Rade, Karin C.
 Rashid, Judy
 Rasmussen, Christopher James
 Ream, Todd C.
 Reason, Robert D.
 Redd, Kenneth
 Redic, Laura
 Rendon, Laura
 Renn, Kristen A
 Rhoads, Robert A.
 Rice, Charles
 Richardson, Richard C.
 Rion, Crystal L
 Rizvi, Fazal
 Robb Jones, Susan
 Robinson-Armstrong, Abbie
 Rogers, Kimberly R
 Ronning, Emily A.
 Ropers-Huilman, Becky
 Ross, Leah E
 Rosser, Vicki J.
 Rowan, Heather T
 Ryan, Edward
 Rybka, Kathryn M.
 Saddler, Tonya Nicole
 Sagaria, Mary Ann D.
 Saggio, Joseph John
 Saltiel, Iris
 Salvador, Jessica
 Sanders-McMurtry, Kijua
 Santiago, Lilia
 Santos, JoseLuis
 Sax, Linda
 Scafide, Kyle J
 Scales, Tara C.
 Schmertz, Barbara
 Schneider, Melba
 Schreiner, Laurie A
 Schuh, John H.
 Schuster, Jack
 Schwartz, Robert A
 Scott Metcalfe, Amy
 Sedgwick, Katherine V.
 Seggie, F. Nevra
 Seifert, Tricia A
 Serra Hagedorn, Linda
 Shapiro, Douglas
 Shaw, Kathleen M.
 Shuler, Caroletta A.
 Sidhu, Ravinder
 Sima, Celina M
 Simon, Merrill
 Smith, Tiffany L
 Somers, Patricia
 Spaulding, Randy S.
 Spreter, Andrea
 St. John, Edward P.
 Starobin, Soko S.
 Stetar, Joseph
 Stevens, Richie
 Strauss, Linda
 Strayhorn, Terrell L.
 Strom, SueAnn
 Strong, Philip
 Summers, Jeffrey
 Surla Banaria, Jocelyn M.
 Suspitsyna, Tatiana
 Sweitzer, Kyle V
 Szelenyi, Katalin
 Tandberg, David Allen
 Tarantelli, Tom
 Teranishi, Robert
 Terenzini, Patrick T.
 Thomas, Auden
 Thompson, Justin
 Thompson, Leisa
 Thompson, Pam
 Thornton, Courtney
 Titus, Marvin A
 Toma, J. Douglas
 Torres, Vasti
 Townsend, Barbara K.
 Travis, Jon E.
 Tuitt, Franklin
 Turner Kelly, Bridget
 Turner, Caroline S.
 Turner, Kirsten
 Turner, Sarah
 Twale, Darla
 Twombly, Susan B
 Umbach, Paul D.
 Valimaa, Jussi
 Vander Putten, Jim
 VanHecke, JoNes
 VanOverbeke, Marc
 Vogt, Kristen
 Volkwein, James Fredericks
 Wagner, Alan
 Walpole, MaryBeth
 Wang, Wei-ni
 Ward, Kelly
 Watson, Lemuel W.
 Wawrzynski, Matthew
 Weaver, Lisa D
 Wei, Na
 Wells, Amy E
 Wells, Cynthia A
 Whitt, Elizabeth J.
 Wilhelm, Simi
 Wilkinson, Robert
 Williams, Henrietta
 Wilson, Maureen
 Woda, Susan E
 Wolf-Wendel, Lisa
 Wolniak, Gregory C
 Wooden, Ontario S
 Wortman, Thomas I
 Yaeger, Patricia M
 Yamamura, Erica
 Yang, Po
 Yokoyama, Keiko
 Young, Llewellyn K
 Zamani-Gallaher, Eboni
 Zeligman, Dawn
 Zentner Bacig, Karen
 Zhai, Lijuan
 Zhang, Liang
 Ziskin, Mary
 Zuniga, Ximena
 Zusman, Ami

A

Abdulla, Fatma M. INT
 Abes, Elisa C10
 Accomando, Annette F05
 Adams, Jennifer Ann E01
 Adams, Stephanie INT
 Admon, Noga E01
 Ait Si Mhamed, Ali INT
 Allen, Angela C04, E01
 Allen, Walter D06
 Alter, Theodore K04
 Ambrose, Allison L09, PPF
 Amelink, Catherine B08
 Amey, Marilyn H01, I05, J04
 Anderson, Christian E01, H05, I07
 Anderson, Melissa S A08
 Andrei, Tudorel INT
 Arellano, Eduardo I11, PPF
 Arnold, Karen H02
 Ashby, Susanne I02
 Astin, Helen A03, D04
 Austin, Ann B03, D08, F08

B

Badders, William GPPS, PPF
 Baez, Benjamin F09
 Bailey, Thomas D10, F11
 Baird, Leonard H04
 Baker, Jayne G07
 Baker, KiKi D01
 Baker, Vicki B03, E01
 Balbachevsky, Elizabeth INT
 Baldwin, Roger D08
 Banaria, Jocelyn H08
 Barato, Ruben I08
 Barber, James A02, H03
 Barker, Marco I03
 Barnes, Benita J B07, F03, J05, L05
 Barnhardt, Cassie L03
 Barott, James D02
 Barrett, T Gregory D05
 Barron, Kevin JRT
 Bastedo, Michael INT
 Bates, Barbara E01
 Baum, Sandy PPF
 Baxter Magolda, Marcia C09
 Benjamin, Mimi I01
 Bensimon, Estela GPPS, I10
 Berdahl, Robert PPF
 Berger, Joseph K03
 Bertram Gallant, Tricia D01, F02
 Bess, James D01
 Birnbaum, Matt ART
 Birnbaum, Robert INT
 Blaich, Charles F L04
 Bland, Carole J F08, H08, L05
 Boes, Lisa C09
 Boilard, Steve PPF
 Bomotti, Sally G01

Bonner, II, Fred F10
 Bornstein, Rita A03
 Bourke, Brian C02
 Boyer, Patricia E01
 Bragg, Debra B05, J02
 Bray, Nathaniel I11, L03
 Breneman, David PPF
 Brennan, Kelly H03
 Bresciani, Marilee D11
 Bridges, Brian I06
 Briscoe, Kamilah C07
 Brosnic, Gary E01
 Brown II, M Christopher G10, GPPS, L08
 Brown, Cheryl F07
 Bryant, Alyssa N ART
 Buckley, Jennifer E01
 Buenavista, Tracy L01
 Buer, Troy D11
 Bunton, Sarah D04
 Burciaga, Rebeca D03
 Bush, V Barbara B07
 Bustillos, Leticia J06
 Butner, Bonita E01

C

Cabrera, Alberto I09, J06
 Calcagno, Juan Carlos F011
 Calderone, Shannon F02, INT
 Caldwell, Rebecca H03
 Callahan, Kate J07
 Callahan, M Kate G07
 Callie, Trina B08
 Campbell, Eric G A08
 Cantwell, Brendan INT
 Card, Karen INT
 Carducci, Rozana D01, H09
 Carter, Deborah G06
 Carter, Ghangis F09
 Castellanos, Jeanett C08
 Ceja, Miguel A07, I06, J02
 Cejda, Brent A07
 Cerna, Oscar G07
 Chaddock, Katherine I07
 Chamberlin, Jennifer I05
 Chance, William PPF
 Chang, Debbie E01
 Chapman, David ART
 Chaudhari, Prema E01
 Cheah, Sherene INT
 Chen, Liang-Hsuan F02, INT
 Chen, Rong K01
 Cheng, Bin E01, INT
 Cheslock, John B08, F04
 Cheung Chan, Tak INT
 Childress, Lisa INT
 Chock, Mona H02
 Choti, Truphena INT
 Chung, Anna J01, K03

Clancy, Patrick INT
 Cochran, Jennifer JRT
 Colatrella, Carol INT
 Colbeck, Carol B03, K04
 Cole, Darnell A07, F07, G11
 Collins, Denise JRT
 Colyar, Julia A09, I02, L07
 Compton, Jonathan I11
 Contreras, Frances A02, GPPS
 Contreras-McGavin, Melissa D01, G11, H09
 Cook Francis, Lynette F02
 Cooper, Joanne G09, H02, J04
 Cooper, Merryl E01
 Cordero-Arroyo, Graciela INT
 Coronado, Heidi K07
 Cortés, Richard K07
 Cortez, Rufina L10
 Couturier, Lara PPF
 Cox, Bradley I01
 Creamer, Elizabeth B08 C09, E01
 Cress, Christine L06
 Croft, Chris D02
 Cruce, Ty K10
 Curley, Jennifer I02
 Currie, Jan INT
 Curry, Nettavia E01, H02
 Curs, Bradley G04, G10
 Curtiss, Gregg J03

D

Daly, Cheryl H08, J04
 Dancy II, T Elon L04
 Daniel, Philip T.K. PPF
 Dar, Luciana E01
 Darden, Mary D01
 Daun-Barnett, Nathan I11, L06, PPF
 Dávila Casanovas, Gloria A06
 Davis, James Earl J07
 Davis, Ryan J G10, H10, J07, K01
 Dean, Diane A03, D11, JRT
 DeAngelo, Linda A07
 Dee, Jay H08, J04
 DeGraff, Stoney D10
 Deil-Amen, Regina G04, K05
 Del Favero, Marietta B08, F05
 Delaney, Jennifer F04, I09
 DeLuca Fernandez, Sonia G06
 DePouw, Christin C05
 DesJardins, Stephen C11
 Diamond, Nancy B11, L02
 Dilley, Patrick J07, L05
 Diramio, David H03
 Dochterman, Mark I03
 Dokter, Christina INT
 Domagal-Goldman, Jennifer M H03
 Donahoo, Saran E01, L08
 Dougherty, Kevin I04
 Douglas, Kate B01

Dowd, Alicia C11, D07, I11
 Doyle, William I09, J02
 Drezek, Kathryn E01
 Drezner, Noah INT
 Drummond, Jerri J03
 Dubrow, Greg F04, G06
 Dwyer, Brigid F07

E

Eagan, Kevin H08, I06, L03
 Earley, Penelope K11
 Ebben, Kelsey K09
 Eddy, Pamela H01, J04, JRT
 Eggins, Heather INT
 Einarson, Marne A07
 Eisenmann, Linda B11
 Elkins, Becki E01, F03
 Elliott, Jacquelyn B11
 Engberg, Mark G06
 Engle, Jennifer A10, K01
 Epstein, Michael E01
 Ervin, Elonda D10
 Espino, Michelle M ART, G03
 Espinosa, Lorelle INT
 Estrada, Judith L10
 Ethington, Corinna L03
 Evans, Nancy C02, H07

F

Fann, Amy A02, F02
 Farrell, Patricia E01, H01, L09
 Finkelstein, Martin D08, E01, G08, JRT
 Finnegan, Dorothy INT
 Finstad, Deborah L05
 Fischman, Gustavo A05
 Fisher, Don A04
 Fitzgerald, Hiram C04
 Flores, Stella H05
 Floyd, Deborah H06
 Fontes, Jesus A04
 Foster, Lenoar INT
 Frances, Carol INT
 Freeman, Kassie H10
 Freijo, Meredith F09
 Fry, Gerald INT
 Fuerstman, Daniel A08
 Fulton, Tara Lynn JRT

G

Gafford Muhammad, Crystal B07, I02, L08
 Galaz-Fontes, Jesus INT
 Gandhi, Miloni J05, INT
 Gangone, Lynn B11
 Gansemer-Topf, Ann E01, I01
 Gao, Lan INT
 Gappa, Judith D08
 Garcia, Mildred A03
 Gardner, Susan F05, J05

Garver, Amy JRT
 Gasman, Marybeth B07, D05, I07, K06, L08
 Gaston-Gayles, Joy D02
 Geertz Gonzalez, Roger C05, G03
 George, Casey E A05
 Gianneschi, Matthew GPPS, F04
 Gibson, John J05
 Gilbert, Keon F09
 Giles, Dwight K04
 Ginter, Mary K05
 Glazer-Raymo, Judith INT, A03, C03
 Goastellec, Gaelle INT
 Golde, Christine B03, H08
 Gonyea, Robert I06, JRT
 Gonzalez, Anna L01
 Gonzalez, Juan Carlos C08
 Gonzalez, Kenneth C08
 Goodman, Kathleen M L04
 Goulden, Marc K08
 Graca, Thomas ART
 Grant, Jessie A01
 Green, Angelia E01
 Griffin, Kimberly G03, I02, L05
 Gross, Jacob P. K. I01
 Gross, Paul K10
 Guardia, Juan C02
 Guentzel, Melanie E01, F03
 Guillen, Sandra INT
 Gumport, Patricia A03
 Gupton, Jarrett ART

H

Haas, Eric A05
 Haley, Karen E01
 Halx, Mark E01
 Hammond, Robert H05
 Hamos, James GPPS, PPF
 Hamrick, Florence C02, H04
 Hardy, David E01
 Harper, Betty E01, G03
 Harper, Casandra B06
 Harper, Shaun R B10, C02, F10, H10, I01, I10, J07
 Harris III, Frank C02
 Harris, Michael A06
 Hart, Jennifer G05
 Hartley, J. Matthew A01, L06
 Hayden, Melanie B09
 Hearn, James H05, I04, J08, K10
 Heary Schneider, Carol L04
 Heggins, Willie ART
 Heller, Donald GPPS, PPF, G06
 Hendel, Darwin INT
 Henkin, Alan H08, J04
 Herlinda Suárez Zozaya, María A06
 Hernandez, Ebelia C05, J05
 Hess, Stephen K01
 Heuvel, Lisa INT

Heyneman, Stephen INT
 Hinton, Kandace F01
 Hinton-Hudson, Veronica D JRT
 Hirko, Scott E01
 Hirt, Joan ART, H07
 Hodel, Ross PPF
 Hoffman, David INT
 Holdsworth, Janet D11
 Holdsworth, Janet M A08
 Holley, Karri L07
 Holmes, Sharon JRT
 Hong-Silwany, Jennifer H06
 Horn, Aaron INT
 Hornak, Anne E01, JRT
 Hossler, Don I01, K10
 Hourigan, Aimee H03
 Howard-Hamilton, Mary D02, F10
 Hoyt, DaVina F04
 Hu, Shouping F04, JRT
 Hubbard, Jennifer H02
 Hubbard, Steven H03, K09
 Hughes, Robin D02, F10
 Hunt, Darnell D09
 Hunt, Erika D11
 Hurtado, Sylvia C08, D06
 Hurwitz, Joel F3
 Hutcheson, Philo I07

I

Ingram, Ted ART, G01

J

Jackson, Jerlando C01, E01, JRT
 Jaeger, Audrey A01, A10, C04, H08, L03
 Jain, Dimpal L01
 Jalomo, Jr, Romero K02
 Jamison, Amy INT
 Janke, Emily K04
 Jayakumar, Uma D06
 Jenkins, Davis D10
 Jensen, Jane A02, C10
 Jiang, Xinquan I05
 Johnson, Barbara F05, G01
 Johnson, Susan D11, F09, G01
 Johnston, Ruth E01
 Johnstone, D. Bruce INT
 Jones, Sosanya E01, JRT
 Jones, Willis JRT
 Jorgensen, James A05, L04

K

Kamimura, Mark C08
 Kandiko, Camille E01, JRT
 Karkehabadi, Sharon INT
 Karp, Melinda F011
 Kasa, Rita K10
 Kasch, David C10
 Katsinas, Stephen G E01

- Keane, James G08
 Keenan, Claudine D04
 Keeney, Brianne A08
 Kellogg, Angela J03
 Kelly, Anita I02
 Kelly, Bridget T F010
 Kelly, Mary J01
 Kempner, Ken G11
 Kennedy, Brianna A09
 Kennedy, Carole C06
 Kerr, Karen K05
 Keup, Jennifer F3
 Kezar, Adrianna D01, JRT, L02
 Kidder, Ralph D05
 Kienzl, Greg L09
 Kier Lopez, Janet I08
 Kim, Dongbin L04
 Kim, Eun Young INT
 Kim, Eunyoung INT, J02
 Kim, Sunwoong INT
 Kimura, Erin G11
 King, Patricia C09, K09, L03
 King-Jupiter, Kimberly F09
 Kinsler, Kevin J01
 Kinzie, Jillian E01, I06, J08, JRT
 Kishur, Joseph D01
 Kisker, Carrie H01
 Kjeldgaard, Erik ART
 Klein, Michael INT
 Knight, MaryBeth A06
 Kniola, David H07
 Koshmanova, Tetyana S. INT
 Kraince, Richard INT
 Kuh, George F03, I06
 Kulati, Tembile INT
 Kuntz, Aaron A01, D04, H09
 Kurotsuchi Inkelas, Karen K09
 Kuykendall, John F09, G01
 Kwong, Jolina E01
 Kyoung Kim, Young I06
- L
 Laanan, Frankie Santos B09, I11, K02
 Laguilles, Jerold JRT
 Lambert, Amber D G03, I03
 LaNasa, Steven I09
 Land, Lynette D04, G05, JRT
 Landa-Gonzalez, Belkis B09
 Landoni, Pablo INT
 Lane, Jason E01, INT
 LaNear, John PPF
 Langenberg, Donald GPPS, PPF
 Lattuca, Lisa A10, G03, L03, H03
 Lawrence, Janet D04, F08
 Le, Tam I03
 LeChasseur, Kimberly J07
 Lechuga, Vincente H08, J01
 Lee, Dawn JRT
 Lee, Jenny A04, G03, INT
- Lee, John K01
 Lee, Joyce B06
 Lee, Sharon S F09, H06
 Lee-Thomas, Gwen INT
 Leišytė, Liudvika INT
 Lesko, Nancy INT
 Leslie, David D01, GPPS, PPF
 Lester, Jaime D01, K08, L01
 Levin, John K10
 Lew, Jonathan ART
 Lewis, Consuella B06, F01, G10
 Lewis, Karin C10
 Lewis, Nicole E01
 Leyba Ruiz, Teresa E01
 Lincoln, Yvonna L07
 Lindholm, Jennifer D04
 Lindsay, Nathan L03
 Lipiz, Elaine F09
 Liu, Ying F04
 Locks, Angela G06
 Loftin, Jennifer F05, I03
 Lott II, Joe B06
 Louis, Michelle F3
 Lowenthal, Patrick E01
 Lozano, Adele J03
 Lucas, Christopher F08
 Ly, Geisce C05
- M
 Mabokela, Reitumetse Obakeng C03, INT
 Macgregor, Cynthia J03
 MacNamara, Lois I09
 Magolda, Peter K09
 Malagon, Maria E01
 Malcom, Lindsey B09
 Maldonado-Maldonado, Alma A04, H05, INT
 Malee Bassett, Roberta INT
 Mallon, William D04
 Malone, Marc D10
 Maloney, Patricia GPPS, PPF, K11
 Mangurian, Luz K11
 Marcucci, Pamela N. INT
 Marginson, Simon B02, INT
 Marks, Laurie E01
 Marra, Rose M J03
 Mars, Matthew A06
 Marshall, Sarah E01, JRT
 Martínez Alemán, Ana C03, J08, H04
 Martinez, Mario PPF
 Maruyama, Kenichi E01
 Masse, Johanna F09
 Matveev, Alexie INT
 Mayhew, Matt H03
 Mazza, Nicholas G08
 Mbilizi, Margaret Asalele INT
 McClendon, Shederick B01, L04
 McClure, Michelle L C10, F10, I02
- McCormick, Alexander I09
 McCoy, Dorian G01, J03
 McDade, Sharon C01, F01
 McDaniels, Melissa ART, B03
 McDonald, William F3
 McDonough, Patricia C11, D07, F02, H10
 McHargh, Carlton R ART, C01
 McKinley Brayboy, Bryan B10
 McKinney, Marvin H B10
 McLaughlin, Jean INT
 McLendon, Michael H05, I04, K10, GPPS
 McNamara Horvat, Erin J07
 McWilliams, Allison G02
 Meehan, Mary G08
 Melear, Kerry Brian PPF
 Melguizo, Tatiana I11
 Mendez, Jesse H05
 Mendoza, Pilar A01, G02, K03
 Meng, Liping INT
 Mertz, Norma F02
 Meszaros, Peggy C09
 Metcalfe, Amy A04, G02, K03
 Miksch, Karen PPF
 Milem, Jeffrey F07, G05
 Millman, Richard K11
 Minor, James T H05, J07, L08
 Misa, Kimberly D06
 Mitchell, Roland I05
 Mokher, Christine K10
 Moore, Tami C04
 Morelon, Carla F09
 Morest, Vanessa F11, I04
 Morgan, DeWayne GPPS, PPF
 Mophew, Christopher A01, B05, GPPS
 Morris, Libby B01
 Moses, Yolanda A03
 Most, David E01
 Mouberry Sieman, Ashley G10, I10
 Mulcahy, Patricia A H08
 Mull, D'Andra G11
 Mullen, Ann L G07
 Muniz, Marcela K10
 Muñoz, Humberto B02
 Muraskin, Lana K01
 Murray, John D01, J04
 Museus, Samuel I01, L04
 Mushrush, Christopher PPF
 Musoba, Glenda J02
- N
 Nadelson, Sandra ART, E01
 Nagasawa, Makoto INT
 Nahra Friedel, Janice I11
 Nehls, Kimberly E01
 Neider, Xyanthe ART
 Nelson Laird, Thomas F03, G01
 Neumann, Anna C03, I03

Newell, L Jackson I07
 Ngalande, Cedrick INT
 Ngolovoi, Mary INT
 Nguyen, Nam JRT
 Nichols, Andrew H C02, I01
 Nicoli, Gina J03
 Nidiffer, Jana I07, K06
 Nilson, Michelle B06, L09
 Nixon, Andrea K03
 Nora, Amaury H04, J05
 Nur-Awaleh, Mohamed ART, INT

O

O'Neil Green, Denise B06
 O'Callaghan, Elizabeth E01
 Olivas, Michael A C11, I08
 Oliverez, Paz A09, I08
 Olsen, Deborah F08
 O'Meara, KerryAnn C04, D04, K04
 Ordorika, Imanol A04, B02, INT
 Orillion, Marie-France I05
 Orsuwan, Meechai F07
 Ortiz, Anna F06
 Oseguera, Leticia A02, K09
 Osei-Kofi, Nana K02, L01
 Ott, Molly D04
 Ousley, Melissa F02, G05
 Ozaki, C Casey H01

P

Pachon, Harry G04
 Padilla, Laura INT
 Palmer, Betsy J03
 Palmer, Robert I01
 Park, Daniel K C05
 Park, Julie F07, H06
 Parker, Tara G07
 Parry, Gareth INT
 Pascarella, Ernest T G05, K10, L04
 Pasque, Penny H09, J07
 Patton, Lori D C05, F10, I02
 Paulson, Karen GPPS
 Peet, Melissa I05
 Perdomo, Shelly E01, G11
 Perez Huber, Lindsay E01
 Perez, Patricia G07
 Perez, William K07
 Perin, Dolores J03
 Perna, Laura W G04, GPPS, H10, J08
 Perorazio, Thomas PPF
 Perrakis, Athena K03, L06
 Perry, Andre D01, F05
 Person, Ann K05
 Peters, Scott K04
 Peterson, R Darrell C02
 Pichardo, Dorali J06
 Pinto, Rosalba INT
 Pitre, Paul ART, G04
 Pizzolato, Jane E01

Plazas Synder, Blanca J05
 Ponjuan, Luis B08, C08, L05
 Pool, Robert D10
 Poon, Oiyen H06
 Porter, Stephen A08
 Portnoi, Laura INT
 Pourciau, Todd JRT
 Powers, Joshua D10, E01, JRT
 Prentice, Mary L06
 Prescott, Brian F011, J05
 Price, Cheryl E01
 Pusser, Brian A06, B02, J08

Q

Quaye, Stephen John ART, G03
 Quinn, Kate B08

R

Raible, Stephanie INT
 Ramirez, Anely INT
 Ramos, Karina K07
 Rankin, Kristie E01
 Rasmussen, Christopher L06
 Reason, Robert D I01
 Redd, Kenneth L09
 Reese, Kimberly F05
 Reid, Monica I04
 Renn, Kristen C10, F06
 Reybold, Earle E01
 Rhoades, Gary A04, H04, I10, INT
 Rhoads, Robert INT, B02
 Rice, Charles A06, INT
 Richardson, Richard INT
 Richardson, Susan L02
 Risbey, Kelly A08, F08
 Rivas, Martha D03
 Robbins, Jane L02
 Rodrigue, Lisa E01
 Rodriguez, Richard T L10
 Roe, Marcy C01
 Rogers, Kimberly R A10, J06, L09
 Ronca, Justin C01
 Ropers-Huilman, Becky C03, F05, I03, K08
 Rosas, Marisela J03
 Rosenbaum, James K05
 Ross, Barbara F07
 Ross, Leah E01, F01
 Rowan-Kenyon, Heather K09
 Rowley, Larry B09, F07, L06

S

Sabry, Manar INT
 Saddler, Tonya B08, E01, JRT
 Saenz, Victor D06, G07
 Sagaria, Mary Ann INT
 Sallee, Margaret A09, K08
 Samaan, Jenny J04
 San Miguel, Lindsay F09

Sandiford, Janice R B09
 Sandmann, Lorilee B01
 Sanford, Gretchen INT
 Santiago, Lilia F09
 Santos, Jose Luis INT
 Santos, Silvia J F06
 Satterfield, James D02
 Sax, Linda I09
 Scafide, Kyle Joseph F3
 Schreiner, Laurie F3
 Schuetz, Pam D10
 Schuh, John F01
 Schuster, Jack D08
 Schwartz, Robert E01
 Seashore Louis, Karen A08
 Seggie, Fatma Nevra INT
 Seifert, Kim H01
 Seifert, Tricia A L04
 Serven, Stephanie K I01
 Shakespeare, Christine INT
 Shapiro, Nancy GPPS, PPF
 Shaw, Kathleen M C03, G02, J07
 Sheldon, Caroline I11
 Shi, Wanbing INT
 Shireman, Robert C11
 Shollenberger, Sindie H08, L05
 Shulock, Nancy GPPS, PPF, I04
 Shults, Christopher A01
 Siegel, David B01
 Silas Casillas, Juan Carlos INT
 Simpson, Michael ART
 Sivestre, Gabriela A08
 Slaughter, Sheila A04, B02, G02
 Slocum, Jenee INT
 Sloma-Williams, Lorraine F01
 Smart, John L03
 Smith, Al G01
 Smith, Dwyane E01, F09
 Smith, Michael E01
 Smolentseva, Anna INT
 Soldner, Matthew K09
 Solorzano, Daniel A07, D03
 Some, Touorouzou INT
 Southerland, J Nathaniel F02
 Spears, Julia E01
 Sponsler, Brian C01
 St John, Edward D07, F04, H10
 Stage, Fran D10
 Starobin, Soko B09, I11, K02
 Stayhorn, Terrell B09, F02, H07, L05
 Stephan, Jennifer K05
 Stern, Joyce I01
 Stetar, Joseph INT
 Stevens, Dannelle H02
 Stevens, Ellen E01
 Stewart, Dafina C10, F10
 Stransky, Elizabeth A05, D05
 Streitwieser, Bernhard ART
 Stromquist, Nelly P. INT

Sule, Venice L06
 Sun, Jeffrey C. PPF
 Suniti Niskode, Amanda F3, G01
 Surla Banaria, Jocelyn G06
 Suspitsyna, Tatiana G11
 Swail, W Scott J06
 Sweitzer, Kyle E01, K03
 Switzer, Teri E01
 Szelenyi, Katalin INT

T

Talbert, Susan ART, J08
 Tandberg, David E01, G04, H05
 Tarbox, Sandra G06
 Tatusko, Andrew G08
 Taylor, Anne H08, L05
 Taylor, Barrett B01
 Teixeira, Pedro INT
 Teodorescu, Daniel INT
 Teranishi, Robert D09, G07, H06, J07
 Terenzini, Patrick L03
 Terosky, Aimee C03
 Thelin, John D05, K06
 Thompson, Leisa E01
 Thornton, Artist INT
 Thornton, Courtney A01, E01, F01, H08
 Tierney, William A09, C06, L07
 Tobolowsky, Barbara I01
 Torres, Carlos INT
 Torres, Vasti A02, C05, F06, H07
 Torres-Olave, Blanca C10
 Townsend, Barbara B05, K02
 Trautvetter, Lois A08, L03
 Tsui, Lisa J03
 Tuitt, Franklin C07, J05
 Turner, Caroline C08, F01
 Turner, Herbert I09
 Turner, Kirsten A05, H02
 Twombly, Susan B05, INT, L07

U

Umbach, Paul B09, H02, L03
 Underwood, Dawn JRT
 Unin, Norseha INT

V

Valimaa, Jussi INT
 Van Overbeke, Marc D05, J02
 VanHecke, JoNes K09
 Vargas, Berenice L10
 Velazquez, Mirelsie L10
 Vélez Cardona, Waldemiro A06
 Vélez, Veronica D03
 Venegas, Kristan A09, D07, J06
 Vidovich, Lesley INT
 Villalpando, Octavio B10, J06
 Villarreal, III, Pedro G04
 Volkwein, J. Fredericks E01, L03

W

Wagoner, Rick B05
 Walpole, MaryBeth B07, K01
 Wang, Wei-ni INT
 Wang, Xueli I06
 Wanger, Stephen P. A10
 Ward, Kelly C04, K08
 Watford, Tara D03, I02
 Watson, Jesse S. H01
 Watson, Lemuel INT
 Watt, Sherry F10, J03
 Weaver, Lisa K04
 Weber Main, Anne Marie H08
 Webster, Denise JRT
 Weerts, David B01, C01
 Wei, Na INT
 Welch, Janine D11
 Wells, Amy D05
 Wells, Cynthia F3
 Wells, Ryan L04
 Wharton, Barbara I I06
 Wheeler-Griffin, Kristi B01
 White, Monica J02
 White-Smith, Kimberly J02
 Whitt, Elizabeth F3
 Williams Pichon, Henrietta B07, D10, JRT
 Williams, Krystal F04
 Williams, Leonard A C01, G01
 Williamson, Joy Ann K06
 Wilson, John C06
 Winkle Wagner, Rachelle B07, F09
 Witek, Paul G08
 Wolf-Wendel, Lisa K08, L04
 Wolniak, Gregory C G06, K10, L04
 Wood, Gerald I05
 Wooden, Ontario S G06, H10
 Woodward, Belle I02
 Wray, Michael E01
 Wright Carroll, Doris G03
 Wright, Carol C07
 Wright, Theresa G02

X

Xu, Haixia B01
 Xu, Yonghong Jade E01

Y

Yamamura, Erica F09
 Yamashita, Miki L06
 Yang, Cheng-Cheng INT
 Yang, Po K05
 Yang, Rui INT
 Yao, Xiaohong INT
 Yokoyama, Keiko INT
 Yosso, Tara D03
 Youn, Ted I. K. H02

Z

Zamani-Gallaher, Eboni E01, K05
 Zarate, Maria Estela G04
 Zeligman, Dawn K01
 Zhang, Yanmei E01
 Zhao, Chun-Mei I09
 Zheng, Peijun A06
 Ziskin, Mary I01, K10
 Zusman, Ami JRT

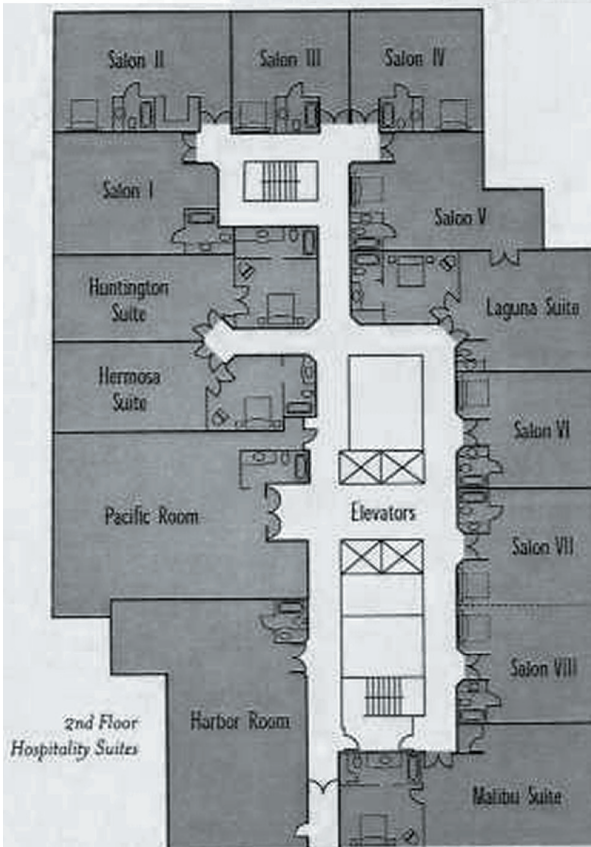
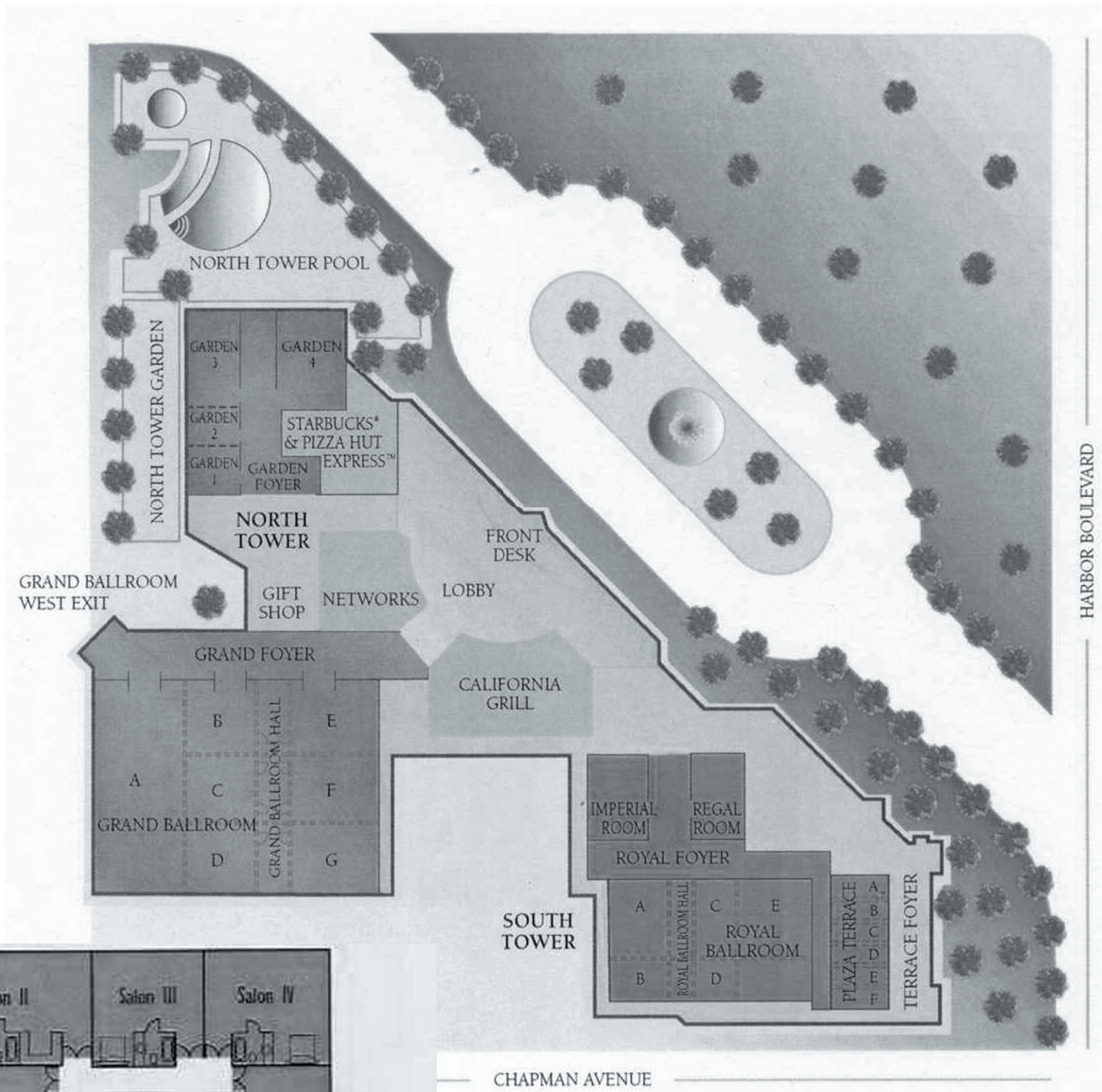

CHAPMAN AVENUE

