

Association for the Study of Higher Education

Sacramento, California | November 21-24, 2002

27th ANNUAL CONFERENCE

ACHIEVEMENT IN AMERICA

Claude M. Steele

Thursday, Nov. 21
4:30 PM - 6:00 PM

Regency DEF

REMEMBRANCE OF THINGS PAST

William G. Tierney

Friday, Nov. 22
5:30 PM - 6:45 PM
Regency AB

COMPETING CONCEPTIONS OF SHARED GOVERNANCE

Mary A. Burgan &
James J. Duderstadt

Saturday, Nov. 23
10:15 AM - 11:45 AM
Regency AB

TABLE OF CONTENTS

<u>Page</u>	
2	President’s Welcome
2	Welcome From the Program Committee
3	Major Addresses
4	Activities, Receptions & Meetings
6	International Forum
8	Forum on Public Policy in Higher Education
10	Graduate Student Policy Seminar
11	Concurrent A
12	Concurrent B
14	Concurrent C
15	ASHE President’s Commissioned Sessions
16	Poster Sessions
16	Program Chair’s Invited Conversations
17	Concurrent F
18	Concurrent G
20	Concurrent H
20	ASHE Community Business Meeting
21	Concurrent I
22	Concurrent J
24	Concurrent K
25	Concurrent L
26	Proposal Reviewers
27	Previous ASHE Award Recipients
28	Bobby Wright Dissertation of the Year Awards
30	ASHE Board of Directors
30	ASHE Presidents
31	Index of Conference Presenters
33	Hotel Map

PRESIDENT'S WELCOME

On behalf of the Board, I extend a welcome to everyone to the 27th Annual ASHE conference. I also wish to offer the Board's gratitude to Jim Antony and the members of the Program Committee for the work they have done. ASHE lives or dies by the voluntary efforts of its members. We are blessed to have the active involvement of many individuals who help the Association foster the study of higher education.

These are exciting times to be involved in academe, and I encourage you to dive into the conference and the association. The purpose of meetings such as ours has little to do with silently listening to one or another speaker, and everything to do with engaging with ideas and each other. My hope is that you enjoy the conference not because you are in agreement with everything that is said; rather, this conference will be successful if we have provided the intellectual space for you to discuss and debate the multitude of problems and challenges that face postsecondary education.

William G. Tierney
University of Southern California

WELCOME FROM THE PROGRAM COMMITTEE

The culmination of a year's planning, this meeting is an opportunity for us to share ideas and advance each other's thinking about topics of central interest in higher education. We hope you will find this year's meeting and the content we have organized to be useful and thought provoking.

Chair, 2002 Program Committee

James Soto Antony, University of Washington

Research & Scholarly Papers

Benjamin Bacz, Georgia State University
Philo Hutcheson, Georgia State University

Symposia

Deborah Faye Carter, Indiana University
Edward St. John, Indiana University

Focused Dialogues

Christine Cress, Portland State University
Ken Kempner, Southern Oregon University

Roundtables

Yvonna S. Lincoln, Texas A&M University
Fran Huckaby, Texas A&M University

Poster Presentations

James T. Minor, University of Southern California
Marvin Peterson, University of Michigan

International Forum

Jussi Välimaa, University of Jyväskylä

Forum on Public Policy in Higher Education

Ami Zusman, University of California

Graduate Student Policy Seminar

Cheryl Lovell, University of Denver

ASHE Graduate Student Representatives

Katherine Garlough, University of Oklahoma
Shedrick McClendon, Vanderbilt University

Graduate Student Assistants

Jennifer Lee Hoffman, University of Washington
Herbert Hoffman, University of Washington
Jeannette James, University of Washington
Danielle Orr-Bement, University of Washington
Michelle Trudeau, University of Washington

Local Arrangements

David Lang, California State University Sacramento

ASHE Executive Director

Barbara K. Townsend, University of Missouri-Columbia

ASHE Managing Director

Lauri D. Goma, University of Missouri-Columbia

MAJOR ADDRESSES



Claude M. Steele

Achievement in America: Intellectual Performance and the Problem of Stereotype Threat

Claude M. Steele

Lucie Stern Professor in the Social Sciences & Endowed Chair, Department of Psychology
Stanford University

Chair of Session: Mitchell J. Chang, University of California, Los Angeles

This session has been made possible with the generous support of the Irvine Foundation.

Thursday, November 21, 2002

4:30 p.m. to 6:00 p.m.

Location: Regency DEF



William G. Tierney

Remembrance of Things Past: The Obligations of the Intellectual

William G. Tierney

Wilbur-Kieffer Professor of Higher Education &
Director, Center for Higher Education Policy Analysis
University of Southern California

Chair of Session: Len Foster, San Diego State University

Friday, November 22, 2002

5:30 p.m. to 6:45 p.m.

Location: Regency AB



Mary A. Burgan

Competing Conceptions of Shared Governance

Mary A. Burgan

General Secretary
American Association of University Professors
Professor Emeritus of English
Indiana University

James J. Duderstadt

President Emeritus and
Professor of Science &
Engineering
University of Michigan

Chair of Session: Mildred Garcia, President, Berkeley College

This session has been made possible with the generous support of the Atlantic Philanthropies.

Saturday, November 23, 2002

10:15 a.m. to 11:45 a.m.

Location: Regency AB



James J. Duderstadt

ACTIVITIES, RECEPTIONS & MEETINGS

PRE-CONFERENCE ACTIVITIES

All events will be held at the Hyatt Regency Sacramento

Wednesday

International Forum

10:00 a.m. to 8:00 p.m.

Location: Golden State A & B, Carmel A

Graduate Student Policy Seminar Registration

12:00 Noon to 12:45 p.m.

Location: ASHE Registration Booth

Graduate Student Policy Seminar

1:00 p.m. to 9:00 p.m.

Location: Big Sur AB

Forum on Public Policy in Higher Education

1:00 p.m. to 8:00 p.m.

Location: Regency D

Council for the Advancement of Higher Education Programs

(Dinner: Pay at door)

7:00 p.m. to 8:00 p.m.

Location: Regency B

CAHEP Panel Discussion on New and Innovative Models For Delivering Higher Education Programs (Open to all)

8:00 p.m. to 9:30 p.m.

Location: Carmel AB

Thursday

Council for the Advancement of Higher Education Programs

(Open to all)

8:30 a.m. to 11:30 a.m.

Location: Tahoe

International Forum

8:00 a.m. to 12:00 Noon

Location: Golden State A & B

Forum on Public Policy in Higher Education

8:00 a.m. to 12:00 Noon

Location: Regency D

Graduate Student Policy Seminar

(Continental Breakfast Provided)

8:00 a.m. to 9:00 a.m.

Location: Big Sur AB

Graduate Student Policy Seminar

9:00 a.m. to 12:00 Noon

Location: Big Sur AB

RECEPTIONS

All events will be held at the Hyatt Regency Sacramento

Wednesday

Public Policy Forum Reception in collaboration with the Graduate Student Seminar on Higher Education Policy and the International Forum

6:00 p.m. to 8:00 p.m.

Location: Regency A

Thursday

Newcomers' Reception

6:00 p.m. to 6:30 p.m.

Location: Regency E

ASHE Welcome Reception

6:30 p.m. to 7:30 p.m.

Location: Regency AB

*This reception has been made possible with the generous
support of the Irvine Foundation.*

Council for the Study of Community Colleges Reception

7:30 p.m. to 8:30 p.m.

Location: Regency F

Pennsylvania State University Reception

7:30 a.m. to 9:00 p.m.

Location: Capitol View (15th Floor)

Committee on Ethnic Participation Reception

8:30 p.m. to 9:30 p.m.

Location: Regency E

Friday

Publications Committee Reception

7:00 p.m. to 8:00 p.m.

Location: Regency E

Michigan State University Reception

7:30 p.m. to 9:30 p.m.

Location: Regency F

Hosted by Michigan State University

The Executive Doctorate and Penn Center for Higher Education Management Reception

9:00 p.m. to 11:00 p.m.

Location: Capitol View (15th Floor)

Hosted by the University of Pennsylvania

Saturday

ASHE Saturday Night Event

5:30 p.m. to 7:00 p.m. & 7:00 p.m. to 8:30 p.m.

Location: Julia Morgan House & Gardens

*This event has been made possible with the generous support of California
State University, Sacramento and its President, Donald R. Gerth*

ACTIVITIES, RECEPTIONS & MEETINGS

MEETINGS

All events will be held at the Hyatt Regency Sacramento

Wednesday

ASHE Board Meeting

6:30 p.m. to 9:30 p.m.

Location: Sequoia Boardroom

National Survey of Student Engagement

4:30 p.m. to 9:00 p.m.

Location: Ventura

Council for the Advancement of Higher Education Programs

8:00 p.m. to 9:30 p.m.

Location: Curriel AB

Publications Committee Meeting

9:00 p.m. to 10:30 p.m.

Location: Santa Barbara

Thursday

National Survey of Student Engagement

7:30 a.m. to 12:00 Noon

Location: Ventura

ASHE Board Meeting

8:00 a.m. to 12:00 Noon

Location: Sequoia Boardroom

Council for the Advancement of Higher Education Programs

8:30 a.m. to 11:30 a.m.

Location: Tahoe

Newcomers' Orientation

11:45 a.m. to 12:45 p.m.

Location: Regency E

Committee on Ethnic Participation Business Meeting

7:30 p.m. to 8:30 p.m.

Location: Regency D

Friday

ASHE Reader Series Meeting

7:00 a.m. to 8:15 a.m.

Location: Trinity

ASHE/ERIC Advisory Board Meeting

7:00 a.m. to 8:15 a.m.

Location: Big Sur A

AERA-J Executive Committee Meeting

7:30 a.m. to 8:30 a.m.

Location: Big Sur B

Council for the Study of Community Colleges Business Meeting

7:00 a.m. to 8:15 a.m.

Location: Ventura

Saturday

ASHE Community Business Meeting (Open to all)

7:00 a.m. to 8:30 a.m.

Location: Regency AB

Consortium of Big XII Higher Education Programs

(Breakfast Provided: By Invitation Only)

7:00 a.m. to 8:30 a.m.

Location: Tahoe

Hosted by Baylor University

2003 Program Committee Meeting

7:00 a.m. to 8:30 a.m.

Location: Trinity

Review of Higher Education Editorial Board Meeting

11:30 a.m. to 12:30 p.m.

Location: Trinity

Journal of Higher Education Advisory Board Meeting

11:30 a.m. to 12:30 p.m.

Location: Ventura

Graduate Student Luncheon and Business Meeting

12:15 p.m. to 1:45 p.m.

Location: Regency F

This luncheon has been made possible with the support of the College of Education at the University of Oklahoma

Sunday

ASHE Board Meeting

8:00 p.m. to 11:00 a.m.

Location: Sequoia Boardroom

GRADUATE STUDENT MEETING & SESSIONS

All events will be held at the Hyatt Regency Sacramento

Thursday

Graduate Student Session - Session A9

ASHE from ABC to Ph.D - Making the Conference Work for You

1:00 p.m. to 2:30 p.m.

Location: Trinity

Saturday

Graduate Student Luncheon and Business Meeting

12:15 p.m. to 1:45 p.m.

Location: Regency F

This luncheon has been made possible with the support of the College of Education at the University of Oklahoma

Graduate Student Session - Session K5

The View from the Professional Side:

Job Search and First-Year Survival Tips from Recent Graduates/

New Professionals

3:45 p.m. to 5:15 p.m.

Location: Big Sur A

INTERNATIONAL FORUM

WEDNESDAY, NOVEMBER 20, 2002

*All events will be held at the Hyatt Regency Sacramento.***10:00 a.m. - 10:15 a.m. - Welcome/Introduction**

Location: Golden State AB

*Dorothy E. Finnegan, Chair, International Forum, College of William and Mary**Jussi Valimaa, Program Chair, International Forum, University of Jyväskylä***10:15 a.m. - 11:15 a.m. - Symposium**

Location: Golden State AB

The Production, Measurement, and Distribution of Public Goods From Higher Education: A Global Context

*Chair: Brian Puseer, University of Virginia**Simon Marginson, Monash University**Imanol Ordorika, National Autonomous University of Mexico**Humberto Muñoz, National Autonomous University of Mexico**Marcela Mollis, University of Buenos Aires**Kirsten Turner, University of Virginia**Ken Kempner, Southern Oregon University***11:30 a.m. - 12:30 p.m. - Research Paper Sessions****Track A: Russian Higher Education in Transition**

Location: Golden State A

Administrators' Espoused Views and Tacit Assumptions about University Democratization in Newly Independent States

*Janet Lawrence, University of Michigan**Tatiana Suspitsina, University of Michigan**Zina Karaeva, International University of Kyrgyzstan*

Higher Education Vouchers in Russia

Alexi G. Mateev, College of William and Mary

Development of Ukrainian Private Higher Education 1991 - 2001

*J. Stetar, Seton Hall University**Elena Berenzkina, Seton Hall University*

Russian Private Higher Education: The Quest for Legitimacy

*Dmitry Suspitsin, Pennsylvania State University***Track B: Focusing on Academics**

Location: Golden State B

The Roles of Higher Education

Tommas Englund, Örebro University

Feminist Theoretical Critiques of the International Discourse on Women in Science and Engineering Higher Education: The Case on UNESCO, UNICEF, and the World Bank

Christine Min Wotipka, Stanford University

Higher Education and Corruption

Stephen P. Heyneman, Vanderbilt University

Mexican Public Higher Education on the U.S.-Mexico Border Demands and Limitations on Access

*Carol Elliott, University of Arizona***Track C: Comparative Perspectives into Higher Education**

Location: Carmel A

Professional Development Models and Personnel in Austria and in the U.S.

*Gary Rhoades, University of Arizona**Barbara Sporn, Vienna University of Economics and Business Administration*

University Responses to Changing Governance: European and United States Case Studies

Jan Currie, Murdoch University

Neo-Liberalism and the Redefinition of University Autonomy in Relation to Changing Governance and Funding in England and Japan

Keiko Yokoyama, University of London

A Corn Field for Nurturing a Hidden Dragon: Doctoral Mentoring for East-West Cultural Understanding

*Larry K. Bright, University of South Dakota**Jack Fei Yang, University of South Dakota***2:00 p.m. - 3:00 p.m. - Research Paper Sessions****Track A: South African Higher Education in Transition**

Location: Golden State A

Change and Continuity: A Conceptual Framework for Understanding Higher Education Reform in South Africa

*Khalifa Bilty, Pennsylvania State University**Dmitry Suspitsin, Pennsylvania State University*

Higher Education and Public Politics in the Ring: Institutional Restructuring Debates in South Africa

Teresa Barnes, University of Western Cape

Privatization on Non-Core Services at Gweru Teacher College (GTC) in Zimbabwe: Leadership Making Change

Wonderful Dzimiri, Georgia State University

Factors Influencing the Choices of Grade 12 Learners in South African Schools with Regard to Higher Education

*Michael Cossor, Human Services Research Council (Pretoria)***Track B: Ranking, Testing, and Assessing Higher Education**

Location: Golden State B

Ranking of Higher Educational Institutions in Comparative Perspective

*Olga Bain, Independent Scholar**William Cummings, George Washington University*

International Forum: Wednesday Sessions continued

From Future to Past, ETS and the Game of Technopoly: International Test Center Reorganization from Addis Ababa to Zurich

Jeffery Thomas Johnson, Tulane School of Public Health and Tropical Medicine

Assessing the Assessment: the UK Research Assessment Exercise, Process, Outcomes and Responses

Ian McNay, University of Greenwich

The Nexus of International Relations Theory and Higher Education in the U.S.

James J.F. Forest, United States Military Academy

Track C: Social Aspects of Higher Education

Location: Carmel A

University Accreditation and the Social Role of Higher Education in Ecuador

Susan Twombly, University of Kansas

Addressing the Continued Socioeconomic Gap in Higher Education: Insights from Low-Income Students in Australian Universities

Christopher Rasmussen, University of Michigan

Accounting for the Internationalization of Australian Higher Education

Fazal Rizvi, University of Illinois

Simon Marginson, Monash University

The Price of Knowledge: Access and Student Finance in Canada

Sean Junior, Canada Millennium Scholarship Foundation

3:15 p.m. - 4:15 p.m. - Research Paper & Roundtables

Track A: Focusing on Academics (Research Paper Sessions)

Location: Golden State A

Journey Towards a Professional Identity

Berit Karseth, University of Oslo

Tone Dyrdal Solbrekke, University of Oslo

Why Do They Say? Voices of Black African Academics in the United States

Laura Portnoi, University of California at Los Angeles

Social Status of Women in Japanese Community Colleges

Soko S. Starobin, University of North Texas

Ken Kempner, Southern Oregon University

Shared Governance and Leadership in Africa South of Saharan Universities

Mohamed Nur-Awaleh, Illinois State University

Dorothy Mtegha, Illinois State University

Track B: Roundtable Papers

Location: Carmel A

Scenario Planning Perspective: Possible Futures for Russian Higher Education

Nadia V. Kulikov, University of Utah

Building Social Capital In a Turkish University Classroom: Impossible Dream Or Realistic Goal In a Transitional Society?

Dannelle D. Stevens, Bilkent University

4:30 p.m. - 5:30 p.m. - Symposium

Track A

Location: Golden State A

Gender Equity, National Policies, and Institutional Responses: A Comparative Analysis of the European Union and the United States

Chair: Mary Ann Dunowitz Sagaria, Ohio State University

Judith Gilazer-Raymo, Long Island University

Barbara Sporn, Vienna University of Economics and Business Administration

Track B

Location: Golden State B

The Effects of Changes in the State Regulatory Environment on Higher Education in Kazakhstan

Chair: Stephen P. Hevnen, Vanderbilt University

Michael K. McLendon, Vanderbilt University

Timothy C. Cahoon, Vanderbilt University

D. Bruce Johnstone, State University of New York at Buffalo

Serik S. Abilov, East Kazakhstan State University

6:00 p.m. - 8:00 p.m.

Reception

Location: Regency A

Joint ASHE International Reception with the Forum on Public Policy in Higher Education and the Graduate Student Policy Seminar

INTERNATIONAL FORUM

THURSDAY, NOVEMBER 21 2002*All events will be held at the Hyatt Regency Sacramento***8:00 a.m. - 9:00 a.m. - Focused Dialogues****Track A**

Location: Golden State A

Strengthening in Higher Education in Countries in Transition: An Analysis of the Issues

*David W. Chapman, University of Minnesota**Ann E. Austin, Michigan State University**Janet Lawrence, University of Michigan**Martha Merrill, School for International Training***Track B**

Location: Golden State B

Internationalization and Institutional Change

*Victor Udén, Iowa State University**Walter Gmelch, Iowa State University***9:15 a.m. - 10:15 a.m. - Focused Dialogue & Symposium****Track A: Focused Dialogue**

Location: Golden State A

The UPAL Leadership Institute: A Model for Facilitating Higher Education Reform in Developing Countries

*Willie J. Heggins, III, Washington State University***Track B: Symposium**

Location: Golden State B

Higher Education Evaluation Systems: The Good, The Bad, and The Ugly (The Mexican Experience)

*Chair: Humberto Muñoz, National Autonomous University of Mexico**Discussant: Imanol Ordorika, National Autonomous University of Mexico**Estela Mara Bensimon, University of Southern California**Roberto Rodriguez, National Autonomous University of Mexico**Armando Alcantara, National University of Mexico**Alejandro Canales, National University of Mexico***10:30 a.m. - 11:30 a.m. - Symposium**

Location: Golden State A

Comparative Perspectives for Internationalizing Universities: Toward Creating Policy Development for Students, Faculty, and Administrators

*Chair: Beverly Lindsay, Pennsylvania State University**Thomas Wortman, Pennsylvania State Erie-The Behrend College**Val Rust, University of California, Los Angeles**Lindsay Dalton-Schram, University of California, Los Angeles**Ki-Wan Sung, Woosong University**Nicelma King, University of California, Los Angeles***11:30 a.m. - 12:00 Noon - Business Meeting**

Location: Golden State AB

Witness, among other things, the seating of the new ASHE International Forum. All are welcome, and participation is needed.

FORUM ON PUBLIC POLICY IN HIGHER EDUCATION

WEDNESDAY, NOVEMBER 21 2002*All events will be held at the Hyatt Regency Sacramento***1:00 p.m.-1:15 p.m. - Welcome/Introduction**

Location: Regency D

*Patrick T. Terenzini, Chair, Public Policy Forum, Pennsylvania State University**Ami Zusman, Chair, Public Policy Forum, University of California***1:15 p.m.-2:45 p.m. - Symposium**

Location: Regency D

The Pipeline to the Baccalaureate: Rethinking the Leaks Along the Way

*Chair: Ami Zusman, University of California**Patrick T. Terenzini, Pennsylvania State University**Donald F. Heller, Pennsylvania State University**Michael B. Paulsen, University of New Orleans**Laura W. Perna, University of Maryland***2:55 p.m.-3:20 p.m. - Research/Scholarly Paper**

Location: Regency D

Understanding the Choice of College Attended by Low Income Students: The Role of State Context

*Chair: Scott Thomas, University of Georgia**Laura W. Perna, University of Maryland**Marvin Titus, University System of Maryland***3:25 p.m.-3:50 p.m. - Research/Scholarly Paper**

Location: Regency D

Modeling the Impact of Substantial Budget Reductions on Freshman Retention

*Chair: William Slinger, North Dakota State University**Deborah Olsen, Virginia Tech**Thomas Chenier, Virginia Tech*

Forum on Public Policy in Higher Education: Wednesday Sessions continued

3:55 p.m.-4:20 p.m. - Research/Scholarly Paper

Location: Regency D

Student and Transfer Coordinator Views of a Statewide Articulation Policy: A Qualitative Analysis

Chair: *Michael Mumper, Ohio University*
Celina Sima, University of Illinois at Chicago
Jill Stein, University of Illinois at Chicago
Patricia Inman, University of Illinois at Chicago

4:30 p.m.-6:15 p.m.

Invited Plenary Session: Joint Session with Graduate Student Policy Seminar

Location: Regency D

Financing Higher Education: Old Problems, New Alternatives

Chair: *Toni Larson, Executive Director, Independent Higher Education of Colorado*
Jonathan A. Brown, Association, President, Association of Independent California Colleges and Universities
Charles Lenth, Vice President for Research and Policy Development, Minnesota Private College Council, Fund, and Research Foundation
Robert Moore, Interim Executive Director, California Postsecondary Education Commission
Debora Obley, Assistant Vice President-Budget Development and External Relations, University of California
Senator Jack Scott, California State Senate

6:15 p.m.-6:20 p.m. - Announcements and Networking

Location: Regency D

6:00 p.m.-8:00 p.m. - Reception

Location: Regency A

Forum on Public Policy in Higher Education Reception in collaboration with the Graduate Student Policy Seminar and the International Forum

THURSDAY, NOVEMBER 21 2002

All events will be held at the Hyatt Regency Sacramento

8:00 a.m.-8:25 a.m. - Research/Scholarly Paper

Location: Regency D

The Impact of Research on Graduation Rates and Time-to-Degree at Four-Year Colleges and Universities on a State's Legislative Decision Making: A Case Study

Chair: *Marc Cutright, Ohio University*
Mark Lafer, American Education Services/Pennsylvania Higher Education Assistance Agency
Nancy Diamond, Pennsylvania State University

8:30 a.m.-8:55 a.m. - Research/Scholarly Paper

Location: Regency D

Quality Assurance in Complex Higher Education Systems: A Transatlantic Comparison

Chair: *Judith Gappa, Purdue University*
Don F. Westerheijden, Center for Higher Education Policy Studies, University of Twente

9:05 a.m.-10:35 a.m. - Symposium

Location: Regency D

Explaining Differences in the Performance of State Higher Education Systems

Chair: *Carol Everly Floyd, Educational Consultant*
Richard C. Richardson, Jr., New York University
Mario Martínez, New Mexico State University
Alicia Hurley, New York University

10:45 a.m.-11:45 a.m. - Business Meeting, Evaluation & Closing

Location: Regency D

12:00 Noon-1:00 p.m. - Informal Lunch & Group Roundtables (On Own)

GRADUATE STUDENT POLICY SEMINAR

WEDNESDAY, NOVEMBER 20, 2002

All events will be held at the Hyatt Regency Sacramento

12:30 p.m. – 1:00 p.m. - Registration

Location: ASHE Registration Area

1:00 p.m. – 1:30 p.m. - Welcome & Introductions

Location: Big Sur AB

*Cheryl Lovell, Seminar Director, University of Denver
Bill Tierney, ASHE President, University of Southern California
John Braxton, ASHE President Elect, Vanderbilt University*

1:30 p.m. – 2:15 p.m. - Session I

Location: Big Sur AB

“Overview of Postsecondary Policy Terms and Concepts”

Cheryl Lovell, Seminar Director, University of Denver

2:15 p.m. – 2:30 p.m. - Break

Location: Hall 2nd Floor

2:30 p.m. – 3:45 p.m. - Session II

Location: Big Sur AB

“Student Financial Aid as a Factor in Persistence”

Amaury Nora, University of Houston

3:45 p.m. – 4:15 p.m. - Session III

Location: Big Sur AB

“Discussion on Policy Research Projects”

4:15 p.m. - 4:30 p.m. - Break

Location: Hall 2nd Floor

4:30 p.m. – 6:20 p.m. - Session IV

Location: Big Sur AB

Joint Invited Presentation with Public Policy Forum

6:30 p.m. – 7:30 p.m.

Celebrating 25 Years of the ASHE Graduate Student Policy Seminar – Reception

Location: Regency A

7:30 p.m. – 9:00 p.m. - Dinner and Presentations, Session V

Location: Regency E

“Policy Research Does Matter: Conversations with Researchers in the Field”

Emerging Governance Structures P 16 thru 20: Implications for Policy, Planning, and Practice

Dianne Brown Wright, University of Akron

Raising Public University Presence in Today's Policy Arena

Mimi Wolberton, University of Nevada, Las Vegas

E-Learning Technologies: Implications for Policy

Karen Middleton, WCET

NOVEMBER 21 2002

All events will be held at the Hyatt Regency Sacramento

7:30 a.m. – 8:00 a.m. - Continental Breakfast and Discussions

Location: Big Sur AB

8:00 a.m. – 9:00 a.m. - Session VI

“Whither California Higher Education: An Examination of the Efficacy of the 2002 Revisions of the California Master Plan”

Charles Ratliff, Senior Consultant, Joint Committee to Develop the California Master Plan for Education

Donald Gerth, President, California State University, Sacramento (tentative)

Ann I. Moroy, Distinguished Research Professor & Director, Center for Educational Leadership, Innovation, & Policy

9:00 a.m. – 9:15 a.m. - Break

Location: Hall 2nd Floor

9:15 a.m. – 10:45 a.m. - Session VII

Location: Big Sur AB

“Federal Student Aid and College Choice: Research Methodologies and Policy Implications”

Alisa Cunningham, Director of Research, Institute for Higher Education

10:45 a.m. – 11:30 a.m. - Wrap Up and Evaluation

Location: Big Sur AB

2002 ANNUAL MEETING

THURSDAY, NOVEMBER 21, 2002

All events will be held at the Hyatt Regency Sacramento

1:00 p.m. to 2:30 p.m. - Concurrent Session A

Session A1—Research/Scholarly Papers

Location: Carmel A

“Diversity in Higher Education: Issues of Access”*Chair: Kijua McMurtry-Sanders, Georgia State University**Discussant: Sharon L. Holmes, University of Alabama*

Familism and the Educational Expectations of Latina/o Tenth Graders

*Guadalupe Anaya, University of California, Los Angeles**Yolanda Trevino, Indiana University*

College Opportunities for Southeast Asian American Students in California

*Robert Teranishi, New York University**Gigi Gomez, University of California, Los Angeles**Walter Allen, University of California, Los Angeles***Examining the Perpetuation Hypothesis: The Influence of Pre-College Factors on Students' Predispositions Regarding Diversity***Jeffrey Milem, University of Maryland**Paul D. Umbach, Indiana University***Session A2—Research/Scholarly Papers**

Location: Golden State A

“Student Financial Aid”*Chair: Sheila Pedigo, University of Kansas**Discussant: James C. Palmer, Illinois State University*

The Role of Institutional Financial Aid in Increasing Minority Student Enrollment in a Post-Hopwood Environment

*Brittany Affolter-Caine, University of Michigan**Magda Martinez, University of Michigan**Lucretia Murphy, University of Michigan**Donald Heller, Pennsylvania State University*

The Impact of Borrowing from Federal Student Loan Programs on Year-to-Year Persistence

*Kimberly Shaye Lachman-Brodsky, City University of New York**Richard C. Richardson Jr., New York University*

Multilevel Analysis of the Effects of Loans on Students' Degree Attainment: Differences by Race, Parental Income, and Colleges

*Dongbin Kim, University of California, Los Angeles***Session A3—Research/Scholarly Papers**

Location: Carmel B

“Graduate and Professional Education”*Chair: Jeffrey Bouman, Calvin College**Discussant: Lester Goodchild, University of Denver*

On Your Mark, Get Set, Publish: Doctoral Student Research Productivity

*Catherine Millett, University of Michigan**Michael Nettles, University of Michigan*

Conceptualizing the Academic Life: Graduate Students' Perspectives

*Jeffrey Bieber, University of Kentucky**Lisa Kraus Worley, University of Kentucky*

The Intersection of Doctoral Education, Family Formation, and Career

*Muresi Nerad, University of Washington***Session A4—Research/Scholarly Papers**

Location: Golden State B

“Legal Issues in Higher Education”*Chair: Benjamin Baez, Georgia State University**Discussant: J. Douglas Toma, University of Pennsylvania*

Beyond Bayh-Dole: Entrepreneurial Policy Making in the 1990s

*Veronica Diaz, University of Arizona**Amy Scott Metcalfe, University of Arizona**Lisa Tarsi, University of Arizona**Richard Wagoner, University of Arizona*

Gender Equity in Intercollegiate Athletics: Determinants of Title IX Compliance

*John J. Cheslock, University of Arizona**Deborah Anderson, University of Arizona**Ronald G. Ehrenberg, Cornell University*

Legal Scholarship in a Neo-Liberal Environment: Professionalism Revisited

*Theresa Shanahan, University of British Columbia***Session A5—Symposium**

Location: Big Sur AB

The Future of Tenure in a Changing Academic Workplace

*Philip G. Altbach, Boston College**Jack H. Schuster, Claremont Graduate University**Martin J. Finkelstein, Seton Hall University**William G. Tierney, University of Southern California**Cathy Trower, Harvard Graduate School of Education***Session A6—Symposium**

Location: Santa Barbara

Supporting New Forms of Collaborative Faculty Work

*Elizabeth G. Creamer, Virginia Tech University**Lisa Lattuca, Pennsylvania State University**Marilyn J. Amey, Michigan State University**Anna Neumann, Teachers College, Columbia University***Session A7—Focused Dialogue**

Location: Ventura

Applying Racial Identity Theory: The Case of Asian Americans

*Alvin N. Alvarez, San Francisco State University**Erin F. Kimura, Santa Clara University*

Thursday, November 21, 2002 continued

Session A8—Roundtables

Location: Tahoe

Community Colleges and Teacher Education: A Challenging, Controversial Issue in University and Community College Sectors
Deborah L. Floyd, Florida Atlantic University
Janice Fricidel, Iowa Department of Education, Community College Division

Research Using NCES Data: Methodological Issues and Solutions
Alicia C. Dowd, University of Massachusetts, Boston

Emerging Definitions of Leadership in Higher Education: New Visions of Leadership or Same Old "Hero" Leader?

Kim E. VanDerLinden, Michigan State University
Pamela L. Eddy, Central Michigan University

Session A9—Graduate Student Session

Location: Trinity

ASHE from ABC to Ph.D.: Making the Conference Work for You
Ann E. Austin, Michigan State University
James Soto Antony, University of Washington

2:45 p.m. to 4:15 p.m. - Concurrent Session B

Session B1—Research/Scholarly Papers

Location: Carmel A

"Finance in Higher Education"

Chair: Janet M. Holdsworth, University of Minnesota
Discussant: Michael A. Olivas, University of Houston

Investment in Higher Education and its Effects on Growth in State Workforce Productivity

Nasrin Fatima, University of New Orleans
Michael B. Paulsen, University of New Orleans

Playing the Board Game: An Empirical Analysis of University Trustee & Corporate Board Interlocks

Scott L. Thomas, University of Georgia
Brian Pusser, University of Virginia
Sheila Slaughter, University of Arizona

The New Depression in Higher Education Revisited

David Leslie, College of William and Mary
Michael Stump, College of William and Mary

Session B2—Research/Scholarly Papers

Location: Golden State A

"Women in Higher Education"

Chair: Ami Zusman, University of California
Discussant: Judith Glazer-Raymo, Long Island University

In Different Voices: Exploring Marginality Through Academic Women's Narrative

Anne-Marie Nuñez, University of California, Los Angeles

Women Higher Education Administrators with Children: Negotiating Personal and Professional Lives

Sarah Marshall, Oklahoma State University

Longitudinal Investigation of Emotional Health Among First-Year College Students: Comparisons of Women and Men

Linda J. Sax, University of California, Los Angeles
Alyssa Bryant, University of California, Los Angeles
Shannon Gilmartin, University of California, Los Angeles

Session B3—Research/Scholarly Papers

Location: Carmel B

"Faculty Work and Lives"

Chair: Mandy Lohfink, University of New Orleans
Discussant: Jon Travis, Texas A&M University Commerce

Doorways to the Academy: Visual Self-Expression Among Faculty in Academic Departments

Marybeth Gasman, Georgia State University
Edward Epstein, The Marlboro School

Outcomes of Long-Term Scholarly Collaboration

Elizabeth G. Creamer, Virginia Tech University

The Meaning and Value of Service

Thomas Schnaubelt, University of Southern Mississippi

Exploring the Camel's Hump: Institutional and Disciplinary Perspectives on Faculty at Mid-Career

Roger Baldwin, Michigan State University
Kim E. VanDerLinden, Michigan State University

Session B4—Research/Scholarly Papers

Location: Golden State B

"Community Colleges: Student and College Policies"

Chair: Philo Hutcheson, Georgia State University
Discussant: Wynetta Lee, Dillard University

A Community College Model of Student Immigration, Language, and Course Completion

Linda Serra Hagedorn, University of Southern California
William Maxwell, University of Southern California

Community College/University Collaboration Policy Barriers and Policy Incentives

Rebecca Stout, Georgia State University
Richard C. Richardson Jr., New York University

Assessing Community College Student Knowledge in the Liberal Arts

Arthur Cohen, University of California, Los Angeles
Pam Schuetz, University of California, Los Angeles
Jone Chang, University of California, Los Angeles

Thursday, November 21, 2002 continued

Session B5—Research/Scholarly Papers

Location: Big Sur A

“Impact of College”

Chair: *Marguerite Bonous-Hummarth, University of California, Los Angeles*

Discussant: *Jeffrey Milem, University of Maryland*

First-Generation College Students: Additional Evidence on College Experiences and Outcomes

Ernest T. Pascarella, University of Iowa

Gregory Wolniak, University of Iowa

Christopher T. Pierson, University of Iowa

Patrick Terenzini, Pennsylvania State University

Diverse Viewpoints on American College Campuses: Do Students Benefit?

Katalin Szelenyi, University of California, Los Angeles

The Impact of Students’ Expectations on Academic Adjustment During the First Year of College

Jennifer Rinella Keup, University of California, Los Angeles

Session B6—Symposium

Location: Big Sur B

Neo-Institutional Perspectives on Public Higher Education: Research, Theory, and Practice

Michael N. Bastedo, Stanford University

Patricia J. Gumpert, Stanford University

John S. Levin, North Carolina State University

Marvin W. Peterson, University of Michigan

Session B7—Focused Dialogue

Location: Santa Barbara

In Students’ Own Words: Facilitators and Barriers to Interaction across Race/Ethnicity

Sylvia Hurtado, University of Michigan

Shirley Greene, University of Michigan

Mary Ziskin, University of Michigan

Lisa Landreman, University of Michigan

Bryan Cook, University of Michigan

Session B8 Roundtables

Location: Tahoe

Faculty and Diverse Student Populations at Non-Elite Institutions: Looking through the Lens of Race and Class

Jeffery Bieber, University of Kentucky

Kathleen M. Shaw, Temple University

“Capitalizing” on the Curriculum

Peter Eckel, American Council on Education

Brittany Affolter-Caine, University of Michigan

Case Studies as a Pedagogical Device in the Higher Education Classroom

Joshua B. Powers, Indiana State University

J. Douglas Toma, University of Pennsylvania

Major Address

4:30 p.m. to 6:00 p.m.

Location: Regency DEF

Achievement in America: Intellectual Performance and the Problem of Stereotype Threat

Claude M. Steele

Lucie Stern Professor in the Social Sciences & Endowed Chair, Department of Psychology
Stanford University

Chair: Mitchell J. Chang, University of California, Los Angeles

This session has been made possible with the generous support of the Irvine Foundation.

ASHE Welcome Reception

6:30 p.m. to 7:30 p.m.

Location: Regency AB

This reception has been made possible with the generous support of the Irvine Foundation.

FRIDAY, NOVEMBER 22, 2002*All events will be held at the Hyatt Regency Sacramento***8:15 a.m. to 9:45 a.m. - Concurrent Session C****Session C1—Research/Scholarly Papers**

Location: Golden State A

“Faculty Productivity and Rewards”*Chair: Vicki Rosser, University of Missouri-Columbia
Discussant: David Leslie, College of William and Mary*

Creating an Environment for Meaningful Discussion of Faculty Productivity: Expanding the Scope of the Delaware Study
*Michael Middaugh, University of Delaware
Heather Isaacs, University of Delaware*

What Does it Take? Success as a Faculty Member in the Academic System
Melissa S. Anderson, University of Minnesota

Believing is Seeing: The Influence of Beliefs and Expectations on Post-Tenure Review Outcomes in One State System
Kerry Ann O'Meara, University of Massachusetts, Amherst

Plagiarism in Academia: Trends and Implications
*Margaret Gibelman, Yeshiva University
Sheldon Gelman, Yeshiva University*

Session C2—Research/Scholarly Papers

Location: Tahoe

“Teaching and Curricular Issues”*Chair: Mimi Wolverton, University of Nevada, Las Vegas
Discussant: James L. Bess, James L. Bess & Associates, Amherst, Massachusetts*

Levels of Influence on Active and Collaborative Undergraduate Teaching
Andrea L. Beach, Michigan State University

Beyond the Money: The Effects of College Major, Institutional Prestige, and Academic Performance on Job Satisfaction
*Scott L. Thomas, University of Georgia
Liang Zhang, University of Arizona*

Session C3—Research/Scholarly Papers

Location: Golden State B

“Administration in Higher Education”*Chair: Thomas I. Wortman, Pennsylvania State University Erie, The Behrend College
Discussant: Jonathan D. Fife, Virginia Polytechnic Institute and State University*

Does a Nexus Exist Between Administrative Work and Student Outcomes in Higher and Postsecondary Education?
*Jerlando Jackson, University of Wisconsin, Madison
Kimberly Kile, University of Wisconsin, Madison*

Exploring a Model of Administrative Job Satisfaction and Turnover
*J. Fredericks Volkwein, Pennsylvania State University
Ying Zhou, Pennsylvania State University*

The Socialization of New Professionals
Shella Padigo, University of Kansas

Session C4—Research/Scholarly Papers

Location: Carmel B

“Assessment and Testing: Policy Perspectives”*Chair: David Chapman, University of Minnesota
Discussant: James J.F. Forest, United States Military Academy*

Bridges and Barriers: The Impact of High Stakes Testing on College Enrollment
*Joseph Berger, University of Massachusetts, Amherst
Stephen Coelen, University of Massachusetts, Amherst*

Fleshing Out an Ecological Model of Assessment: Findings From State Case Studies
*Michael Nottles, University of Michigan
Thomas Perorazio, University of Michigan
John Cole, Deputy Secretary of Education & The Arts, State of West Virginia*

Linking Public Policy to State Higher Education Performance
*Mario C. Martinez, New Mexico State University
Richard C. Richardson Jr., New York University*

Session C5—Symposium

Location: Santa Barbara

(Re)presenting the University: The Theatre of Image Construction
*Dorothy E. Finnegan, College of William and Mary
Amy Greenough, College of William and Mary
Michael Faughnan, College of William and Mary
Kevin Hughes, College of William and Mary
Sam Lee, College of William and Mary
James Walke, College of William and Mary
Stacy Richardson, Trinity College*

Session C6—Symposium

Location: Regency D

Establishing a Research Agenda for Work and Family in Higher Education
*Lisa Wolf-Wendel, University of Kansas
Kelly Ward, Oklahoma State University
Mary Ann Mason, University of California, Berkeley
Sarah Marshall, Oklahoma State University
Cynthia B. Robertson, Southern University & University of Texas at Austin
Robert Drago, Pennsylvania State University
Carol Colbeck, Pennsylvania State University
Kurt Burkum, Pennsylvania State University
Laura Perna, University of Maryland*

Friday, November 22, 2002 continued

Session C7—Focused Dialogue

Location: Carmel A

Researching Black Colleges: Toward a Research Agenda
M. Christopher Brown II, Pennsylvania State University
Kassie Freeman, Dillard University
Len Foster, San Diego State University
James Earl Davis, Temple University
Wynetta Lee, Dillard University
Janet Guyden, Florida A&M University

Session C8—Roundtables

Location: Regency E

Institutional Effectiveness, Plumbing, and Budgeting: Uniting a House Divided
Gail Dantzker, South Texas Community College
Brenda Cole, South Texas Community College

Introduction to the Statistical Database on State Higher Education, 1890 - 1965
Susan R. Richardson, Pennsylvania State University

Session C9—Symposium

Location: Regency F

Governance in the 21st Century
James T. Minor, University of Southern California
Charlotte Briggs, Loyola University
Patricia J. Gumpert, Stanford University
Yvonna S. Lincoln, Texas A&M University
Marietta Del Favero, Louisiana State University

10:00 a.m. to 11:30 a.m. - Concurrent Session D

Session D1—ASHE President's Commissioned Session

Location: Regency D

From Research to Policy to Practice to Research
David Leslie, College of William and Mary
Susanne Lohmann, University of California, Los Angeles
Michelle Knight, Teachers College, Columbia University
Chair: *Janet T. Minor, University of Southern California*

Session D2—ASHE President's Commissioned Session

Location: Regency E

Rethinking the Ed.D.
Benjamin Baez, Georgia State University
J. Douglas Toma, University of Pennsylvania
Barbara K. Townsend, University of Missouri-Columbia
Chair: *Karen Symms Gallagher, University of Southern California*

Session D3—ASHE President's Commissioned Session

Location: Regency F

Verifying Data
Yvonna S. Lincoln, Texas A&M University
John Smart, University of Memphis
Susan Talburt, Georgia State University
Chair: *Linda Serra Hagedorn, University of Southern California*

These sessions have been made possible with support from the Center for Higher Education Policy Analysis, University of Southern California

Session D4—Focused Dialogue

Location: Regency C

Policy, Practice and Funding Proposals: What Foundations Find Interesting and Why
Bob Shireman, Irvine Foundation
Ellen Wert, Pew Charitable Trusts
Jerry Davis, Lumina Foundation
Ted Hullar, Atlantic Philanthropies
Jorge Balan, Ford Foundation
William G. Tierney, University of Southern California

Awards Luncheon

Friday 11:45 a.m. - 1:00 p.m.

Location: Regency AB

(Need ticket to attend)

Friday, November 22, 2002 continued

1:00 p.m. to 2:00 p.m. - Concurrent Session E

Session E1 - Poster Session

Location: Ballroom Foyer

Selecting Peer Institutions: An Integrated Approach

Alexi G. Mateev, College of William and Mary

Nuria M. Cuevas, Norfolk State University

Marie V. McDemmond, Norfolk State University

Thelma B. Thompson, Norfolk State University

Understanding the Other Half: Change and Continuity in the Part-Time Professoriate

Mandy Liu, Association of American Medical Colleges

Martin J. Finkelstein, Seton Hall University

Jack H. Schuster, Claremont Graduate University

An Investigation of the Relationship Between Beliefs About Teaching and Use of Instructional Methods in the College Classroom

Lori Houghton Wright, University of Missouri-Columbia

Gender Roles and Academic Engagement Among African-American Males in College

James Earl Davis, Temple University

Beyond the Delta P: Estimating Changes in Predicted Probability at the Median and the Mode

Alicia C. Dowd, University of Massachusetts, Boston

Using Theory to Explore the Economic Returns to Higher Education: Revisiting the NLS-72

Amy Scott Metcalfe, University of Arizona

Visualizing the Changing Spatial Patterns of American Higher Education, 1940-1999

Jennifer Ann Adams, Pennsylvania State University

Developing Student Understanding of HIV/AIDS in the Context of Service-Learning

Elisa Abes, Ohio State University

Chicana Community College Transfer Students: The Role of Gender in the Transfer Choice Process

Jennifer Jovel, Stanford University

Corruption or Congruity: The Governance of For-profit Subsidiaries of Non-profit Universities

Jared Bleak, Harvard Graduate School of Education

The Rhetoric of Leadership: The Role of Gender in Communications and Leadership Style

Pamela L. Fiddy, Central Michigan University

Understanding the Impact of Single Parent Status on African-American Male College Choice

Michael J. Smith, University of California, Los Angeles

The Community College Commandments

Linda Serra Hagedorn, University of Southern California

Preparedness of Campus Diversity: The Relationship between Pre-College Experiences and Collegiate Expectations

Therese S. Eyermann, University of California, Los Angeles

Mitchell Chang, University of California, Los Angeles

Michael Hendricks, University of California, Los Angeles

Katalin Szelmyi, University of California, Los Angeles

Instructional Technology in the Academy: Favorable Institutional Characteristics

Veronica M. Diaz, University of Arizona

The College Choice Phenomenon: Which Institutional Characteristics Really Matter?

Sandra J. Lord, University of Nevada, Las Vegas

The Equity Index: A New Way of Analyzing Institutional Data and Making the Invisible Gap Visible

Lun Huo, University of Southern California

Session E2 - Program Chair's Invited Conversation

Location: Big Sur A

A User's Workshop Introducing the New NELS-2000: It Will Change the Way You Talk About Higher Education

Clifford Adelman, United States Department of Education

Session E3 - Program Chair's Invited Conversation

Location: Big Sur B

A Conversation About Higher Education For the Public Good

Alexander Astin, University of California, Los Angeles

Lena Astin, University of California, Los Angeles

Sylvia Hurtado, University of Michigan

Eric Dey, University of Michigan

Sponsored by the Kellogg Foundation and the UCLA Higher Education Research Institute

Session E4 - Program Chair's Invited Conversation

Location: Santa Barbara

A Conversation With the Editors of the Review of Higher Education, Journal of Higher Education, and Research in Higher Education

Philip Altbach, Boston College

Leonard Baird, Ohio State University

John Smart, University of Memphis

2:00 p.m. to 3:30 p.m. - Concurrent Session F

Session F1 - Research/Scholarly Papers

Location: Carmel A

"Moral Development and Identity"

Chair: Robert D. Reason, Iowa State University

Discussant: Susan Talburt, Georgia State University

Moral Judgment Development in Higher Education

Patricia King, University of Michigan

Matt Mayhew, University of Michigan

Friday, November 22, 2002 continued

Women's Religious and Spiritual Identity: Integrating the Catholic Faith with Progressive Social Values During College

Alysa Bryant, University of California, Los Angeles

Reframing Identities for Justice: Honoring Multiple Identities

Rebecca Gutierrez Keeton, Cal Poly Pomona & Claremont Graduate University

Session F2—Research/Scholarly Papers

Location: Golden State A

"College Decision Making"

Chair: Kenneth Gonzalez, University of San Diego

Discussant: James Soto Antony, University of Washington

How Does School Matter in Student College Going Decisions

Shouping Hu, Seton Hall University

Exploring College Decision Making: A Disconnect in Student Ratings

Suzanne Espinoza, University of Utah

Native College Pathways in California: A Look at College Access for American Indian High School Students

Amy Fann, University of California, Los Angeles

Session F3—Research/Scholarly Papers

Location: Carmel B

"Technology and Higher Education"

Chair: Lee Johnson, Lawrence Technological University

Discussant: Kevin Kinser, State University of New York at Albany

Virtual Reality in the Classroom: Student Voices in the Learning Process

Elaine Kuo, University of California, Los Angeles

Marc Levis-Fitzgerald, University of California, Los Angeles

Going the Distance: Rural Institutions' Strategies for Using Distance Education

Karen Card, University of South Dakota

Michael Card, University of South Dakota

Technology Issues at Community Colleges: Administrator Perspectives on Challenges and Opportunities

Marilyn J. Amey, Michigan State University

Kim E. VanDerLinden, Michigan State University

Wei-ni Wang, Michigan State University

Session F4—Symposium

Location: Golden State B

Studying Community College Students:

Research Approaches, Methods, and Policy Implications

Frankie Santos Luanan, University of North Texas

Barbara K. Townsend, University of Missouri-Columbia

Linda Serra Hagedorn, University of Southern California

Keni Phillippe, American Association of Community Colleges

Session F5—Symposium

Location: Tahoe

Critical Methodological Issues: Refining Higher Education Research

Linda Elsenmann, University of Massachusetts, Boston

Yusti Torres, George Washington University

Sylvia Hurtado, University of Michigan

Estela Mara Bensimon, University of Southern California

Donald Polkinghorne, University of Southern California

Georgiu Bauman, University of Southern California

Adrianna Kezar, University of Maryland

Session F6—Symposium

Location: Big Sur A

It's Not Just a Woman's Problem: Studying Patriarchy in the Academy and the Preparation of Higher Education Graduates

Carolyn J. Thompson, University of Missouri-Kansas City

Guadalupe Anaya, University of California, Los Angeles

Mildred Garcia, Berkeley College

Bruce A. Jones, University of Missouri-Kansas City

Cheryl Presley, Boston College

Christy Moran, University of Missouri-Kansas City

Kassie Freeman, Dillard University

Daniel Solorzano, University of California, Los Angeles

Session F7—Symposium

Location: Big Sur B

Tackling the Methodological and Conceptual Puzzles in Assessing Doctoral Students

Papers may be found at: <http://www.carnegiefoundation.org/cid/ushe/>

Chris M. Golde, Carnegie Foundation for the Advancement of Teaching

Ann E. Austin, Michigan State University

Don Haviland, WestEd

Sharon Goldsmith, WestEd

Berta Vigil Loden, University of Toronto

Barbara Lovitts, University of Maryland

Mark Connolly, University of Wisconsin, Madison

Session F8—Focused Dialogue

Location: Santa Barbara

The Uses of Institutional Culture: Building Campus Community and Enhancing External Relations

J. Douglas Toma, University of Pennsylvania

Greg Dubrow, Florida International University

Matthew Hartley, University of Pennsylvania

Session F9—Symposium

Location: Ventura

The Politics of United States Higher Education: Toward a Contemporary Research Agenda

Michael K. McLendon, Vanderbilt University

James Hearn, Vanderbilt University

Friday, November 22, 2002 continued

Dulmer Dunn, University of Georgia
Michael Munper, Ohio University
Richard Novak, Association of Governing Boards of Universities & Colleges
Abigail Payne, University of Illinois
Brian Passer, University of Virginia
David W. Leslie, College of William and Mary

3:45 p.m. to 5:15 p.m. - Concurrent Session G

Session G1—Research/Scholarly Papers

Location: Golden State B

“Student, Faculty, and Presidents: A View Within the Community College”

Chair: Eboni M. Zamani, Eastern Michigan University
Discussant: Jan Ignash, University of South Florida

Pathways to College: What Affects Lower SES Students' Decisions to Transfer to a Four-Year Institutions?

Alberto Cabrera, University of Wisconsin, Madison
Steven LaNasa, George Mason University
Kurt Burkum, Pennsylvania State University

There's More than One Way to Skin a Cat: How Community College Presidents Frame Change

Pamela L. Eddy, Central Michigan University

Quality of Instruction in the Community College: Full-time versus Part-time Faculty

Lisa Allison-Jones, Virginia Western Community College
Joan Hirt, Virginia Tech University

Session G2—Research/Scholarly Papers

Location: Golden State A

“College Choice, Equity, and Opportunity”

Chair: Audrey J. Jaeger, North Carolina State University
Discussant: Michael B. Paulsen, University of New Orleans

Developing the Hadley Taste for College: Organizational Habitus and Aspirations for Elite College Attendance

Anthony Listing Antonio, Stanford University
Erin McNamara Horvat, Temple University

Meeting the Access Challenge: An Examination of Indiana's Policy for Low-Income Student Access to Higher Education via the 21st Century Scholars Program

Edward St. John, Indiana University
Gleda Dmognana Musoba, Indiana University
Aula Simmons, Indiana University
Choon-Guen Chung, Indiana University

Challenges to Equity and Opportunity in Higher Education: An Analysis of Recent Policy Shifts

Donald Heller, Pennsylvania State University
Deborah Schwartz, University of Michigan

Session G3—Research/Scholarly Papers

Location: Carmel B

“Democracy and Institutional Values”

Chair: Jenny Lee, University of California, Los Angeles
Discussant: Becky Kopers-Huilman, Louisiana State University

Student Engagement with Diversity and Community: Effects on Democratic Outcomes

Ximena Zuniga, University of Massachusetts, Amherst
Elizabeth Williams, University of Massachusetts, Amherst
Joseph Berger, University of Massachusetts, Amherst

(Mis)Understanding Mission: How New College Students Interpret Institutional Values

Amy Aldous Bergerson, University of Utah

The Effect of a Diversity Course on Students' Interactions with Diverse Peers and Preparation for a Diverse Democracy: A Path Model

Thomas Laird, University of Michigan
Mark Engberg, University of Michigan
Sylvia Hurtado, University of Michigan

Session G4—Research/Scholarly Papers

Location: Carmel A

“Faculty Salary and Retention”

Chair: Andrea L. Beach, Michigan State University
Discussant: Melissa S. Anderson, University of Minnesota

Alternative Ways to Measure the Average Unexplained Wage Gap between Groups of Academic Employees

Robert K. Touthoushian, University System of New Hampshire

Salary Dispersion in Academic Departments

Leonard Goldfine, University of Minnesota

Turnover Intent in an Urban Community College: Strategies for Faculty Retention

Jay Dee, University of Massachusetts, Boston

Session G5—Symposium

Location: Big Sur B

Exploring Queer Student Experiences through Multiple Disciplinary Perspectives

Kristen A. Renn, Michigan State University
Brent Bilodeau, Michigan State University
Patrick Dilley, Southern Illinois University, Carbondale
Nancy J. Evans, Iowa State University

Session G6 Symposium

Location: Big Sur A

More Academic Capitalism: It's Not Just Patents and Technology Transfer

Sheila Slaughter, University of Arizona
Gary Rhoades, University of Arizona
Samantha King, University of Arizona
John J. Cheslock, University of Arizona

Friday, November 22, 2002 continued

Session G7—Symposium

Location: Santa Barbara

Advancing the Scholarship of Assessment

Trudy W. Buntu, Indiana University-Purdue University, Indianapolis

T. Dary Ervin, James Madison University

George D. Kuh, Indiana University

Patrick Terenzini, Pennsylvania State University

Marvin W. Peterson, University of Michigan

Session G8 Focused Dialogue

Location: Ventura

Career Trajectories: Personal Accounts of Career Paths in Higher Education

Kelly Wurd, Oklahoma State University

James Fairweather, Michigan State University

Judith Glazer-Raymo, Long Island University

Mildred Garcia, Berkeley College

Ken Borland, East Stroudsburg University

Dorothy E. Finnegan, College of William and Mary

Session G9—Focused Dialogue

Location: Trinity

Re-Remembering: Rethinking Separation and Student Persistence

R. Deborah Davis, Syracuse University

Vincent Tinto, Syracuse University

ASHE Presidential Address

Friday 5:30 p.m. to 6:45 p.m.

Location: Regency AB

Remembrance of Things Past: The Obligations of the Intellectual

William G. Tierney

Wilbur-Kieffer, Professor of Higher Education &
Director, Center for Higher Education Policy Analysis
University of Southern California

Chair: Len Foster, San Diego State University

SATURDAY, NOVEMBER 22, 2002*All events will be held at the Hyatt Regency Sacramento***ASHE Community Business Meeting**

(Open to all)

7:00 a.m. to 8:30 a.m.

Location: Regency AB

8:30 a.m. to 10:00 a.m. - Concurrent Session II**Session H1—Research/Scholarly Papers**

Location: Golden State B

“Data and Assessment”*Chair: Rosa Cintron, University of Oklahoma**Discussant: Mildred Murray-Ward, California Lutheran University*

Multiple Race Data in Higher Education Research: Implications for the Racial Categorization of Biracial College Students

Katalin Szelenyi, University of California, Los Angeles

Implementing a Comprehensive Assessment System at West Point: Lessons Learned

James J. F. Forest, United States Military Academy

Because the Numbers Matter: Transforming Racial/Ethnic Data Reporting to Account for Mixed Race Students in Postsecondary Education

*Kristen A. Renn, Michigan State University**Christina J. Lunceford, Michigan State University***Session H2—Research/Scholarly Papers**

Location: Golden State A

“Studies of College Impact and Outcomes”*Chair: Shouping Hu, Seton Hall University**Discussant: Anthony Lising Antonio, Stanford University*

In the Shadow of the Mountains: Effects of Private Liberal Arts Colleges in Appalachia

*Ernest T. Pascarella, University of Iowa**Gregory Wolniak, University of Iowa**Christopher T. Pierson, University of Iowa**Patrick Terenzini, Pennsylvania State University*

An Examination of Pace's Model of Student Development and College Impress

*Corinna Ethington, University of Memphis**Robert Horn, University of Memphis*

Maintaining, Regenerating, and Navigating Ties: An Exploratory Study of First-Generation Students' Transition to College

Anne-Marie Nuñez, University of California, Los Angeles

Working and Learning: Campus Involvements as Predictors of Learning for Employed Students

*Carol Lundberg, Azusa Pacific University***Session H3—Symposium**

Location: Big Sur AB

“Multiple Influences on College Student Learning”

*James Hearn, Vanderbilt University**Janet M. Holdsworth, University of Minnesota**Joseph Berger, University of Massachusetts, Amherst**Marietta Del Favero, Louisiana State University**Claire Major, University of Alabama**Amy Hirschy, Vanderbilt University**John Braxton, Vanderbilt University**Alan E. Bayer, Virginia Tech**Maureen Wilson, Bowling Green State University**Timothy Caboni, Vanderbilt University**Mary Deusterhaus, Vanderbilt University**Meaghan Munday, Vanderbilt University**Betsy Palmer, Montana State University***Session H4—Focused Dialogue**

Location: Carmel A

Community Colleges in the Emerging Market for Postsecondary Education

*Brian Puzser, University of Virginia**David Breneman, University of Virginia**Kevin J. Dougherty, Teachers College, Columbia University**Alexander C. McCormick, Carnegie Foundation for the Advancement of Teaching**John S. Levin, North Carolina State University***Session H5—Focused Dialogue**

Location: Ventura

“Navigating Borders: Intentional Talk Between Higher Education and Educational Administration Faculty”

*Edith Rusch, Rowan University**Mimi Wolverson, University of Nevada, Las Vegas**Kevin Kinser, State University of New York, Albany**Adrienne Hyle, Oklahoma State University**James Coaxum, Rowan University***Session H6—Roundtables**

Location: Tahoe

Assessing the Educational Experiences of Doctoral Students From a Formative Perspective

*John H. Schuh, Iowa State University**Mary Huba, Iowa State University**Mark C. Shelley II, Iowa State University*

Saturday, November 23, 2002 continued

Discovering Method, Discovering Self: A Discussion of Research, Race, and Personal Challenges

Nia Woods Haydel, Georgia State University
Sibby Anderson-Thompkins, Georgia State University
Marybeth Gasman, Georgia State University

Session H7—Roundtables

Location: Santa Barbara

Administrative Culture: What Do We Know and What Do We Need to Learn?

Joan Hirt, Virginia Tech University

Research and Scholarship on First-Generation College Students: What the Past Has Told Us and Where the Future Can Lead

Christine A. Ohl, Syracuse University

Session H8—Symposium

Location: Carmel B

Engineering Education Reform: Multiple Perspectives on Improving Curricula

Ann McKenna, Northwestern University
H. David Smith, Northwestern University
Roy Cox, Northwestern University
Penny Hirsch, Northwestern University

Major Address

10:15 a.m. to 11:45 a.m.

Location: Regency AB

Competing Conceptions of Shared Governance

Mary A. Burgan
 General Secretary
 American Association of University Professors
 Professor Emeritus of English
 Indiana University

James J. Duderstadt
 President Emeritus & University
 Professor of Science & Engineering
 University of Michigan

Chair: Mildred Garcia, President, Berkely College

12:00 p.m. to 1:30 p.m. - Concurrent Session I

Session H1—Research/Scholarly Papers

Location: Golden State B

“Women and Science”

Chair: Christine Min Wotipka, Stanford University
Discussant: Susan Twombly, University of Kansas

Survival of the Fittest? Women Engineering Majors and Effective Educational Practices

Chun-Mei Zhao, Indiana University
Robert Carini, Indiana University
George D. Kuh, Indiana University

African American Women Scientists and Engineers: A Phenomenological Study of Early-Career Faculty Experiences

Cecilia Lucero, The National Consortium for Graduate Degrees for Minorities in Engineering and Science (GEM)

Baccalaureate Degree Completion Rates for Women in Science and Engineering Fields: A Predictive Analysis

Lana Snider, University of Toledo
Ron Opp, University of Toledo
Penny Puplin Gosetti, University of Toledo

Session H2—Research/Scholarly Papers

Location: Golden State A

“College Persistence”

Chair: Yolanda Robinson, Claremont Graduate University
Discussant: Lisa Wolf Wendel, University of Kansas

The Student-Initiated Retention Movement: Toward a Theory of Self-Empowerment and Institutional Transformation

David Maldonado, University of California, Los Angeles
Robert Rhoads, University of California, Los Angeles
Gordon Chang, University of California, Los Angeles

Assimilation and Integration: Using Segmented Assimilation Theory to Enhance Conceptualization of College Participation

Anne-Marie Nolez, University of California, Los Angeles

Deciding to Leave: Stopping Out or Transferring from Selective Colleges and Universities

Catherine Millett, University of Michigan
Michael Nettles, University of Michigan

Saturday, November 23, 2002 continued

Session 13—Research/Scholarly Papers

Location: Carmel B

“Community College Students”

Chair: James Palmer, Illinois State University

Discussant: Philo Hutcheson, Georgia State University

New Light on Transfer From Community Colleges to Four-Year Colleges

Kevin J. Dougherty, Teachers College, Columbia University

Gregory Kienzl, Teachers College, Columbia University

Influences on Community College Students' Educational Plans

Ernest T. Pascarella, University of Iowa

Gregory Wolniak, University of Iowa

Christopher T. Pierson, University of Iowa

The Influence of Welfare Reform and the Workforce Investment Act on Community College Training and Education for Low Income Workers

Kathleen M. Shaw, Temple University

Christopher Mazzeo, Baruch College

Sara Rab, University of Pennsylvania

Session 14—Research/Scholarly Papers

Location: Tahoe

“African-Americans in Predominantly White Institutions”

Chair: Joy L. Gaston, Florida State University

Discussant: Reitemetse Obakeng Mabokela, Michigan State University

Issues Affecting the Integration of Multiple Social and Cultural Identities Among Black Students at a Predominantly White Institution

Dafina Lazarus Stewart, Ohio University

The Roles of Senior-Level African-American Administrators at Majority Institutions and their Perceived Impact on Recruitment: Retention of Minority Faculty

Walter Brown, George Washington University

Mentoring Across Race: Critical Case Studies of African-American Students in a Predominantly White Institution of Higher Education

Robin Yann Lynch, Saint Joseph University

Session 15—Symposium

Location: Regency D

Three Decades of Research on Faculty Careers:

What Do We Know? What Do We Need to Investigate?

Roger Baldwin, Michigan State University

Ann E. Austin, Michigan State University

Joanne Cooper, University of Hawaii

Judith Gappa, Purdue University

Session 16—Symposium

Location: Santa Barbara

New Perspectives on Organizational Theory in Higher Education

Brian Passer, University of Virginia

Joseph Berger, University of Massachusetts, Amherst

Jeffrey Milem, University of Maryland

Estela Mura Bensimon, University of Southern California

Sarah Collie, University of Virginia

Georgia Bauman, University of Southern California

Session 17 Symposium

Location: Big Sur A

Actionable Knowledge and Social Justice: Rethinking the Pedagogy, Research, and Practice

Edward St. John, Indiana University

Joseph Cadray, Emory University

O. Cleveland Hill, Nicholas State University

Kimberly Kline, Indiana University

Eric Love, Indiana University

Nancy Chism, Indiana University-Purdue University Indianapolis

Leetta Allen-Haynes, Southern University of New Orleans

Session 18—Roundtables

Location: Big Sur B

African-American Women CEOs in Community Colleges: Equity or Barriers?

Thelecia Yvette Wilson, Florida A&M University/University of North Florida

Distinguishing Among Part-Time Faculty: Developing a Taxonomy for Research

Valerie Martin Conley, Ohio University

Steven M. Janosik, Virginia Tech

Session 19—Roundtables

Location: Carmel A

How Fiction Can Be Used to Enhance Higher Education Research, Teaching, and Practice

Kathryn M. Rybka, University of Illinois, Urbana-Champaign

1:45 p.m. to 3:15 p.m. - Concurrent Session J

Session J1—Research/Scholarly Papers

Location: Golden State B

“Use of Data in the Community College for Decision Making”

Chair: Pam Schuetz, University of California, Los Angeles

Discussant: John S. Levin, North Carolina State University

The Impact of Mentoring Experiences on Withdrawal Behavior Among First-Year College Students at a Two-Year Institution

Amatory Nora, University of Houston

Saturday, November 23, 2002 continued

Information Systems and Information Culture: A Study of Knowledge Management in a California Community College

Lisa Petrides, Teachers College, Columbia University
Sara McClelland, Teachers College, Columbia University

A Cross-National Perspective: How Community College Leaders Understand and Use Research in Decision-Making in U.S. and Canada
Berta Vigil Loden, OISE/University of Toronto

Session J2—Research/Scholarly Papers

Location: Golden State A

“Administrative Leadership in Higher Education”

Chair: Diane R. Dean, Teachers College, Columbia University
Discussant: Sharon A. McDade, George Washington University

Probing Presidential Polemics: The Politics and Symbols of Academic Leadership

John Thelin, University of Kentucky
Amy E. Wells, University of New Orleans

The Relationship of Academic Department Chair Communication Styles to Perceived Chair Task Effectiveness

George Petersen, University of Missouri-Columbia
Julie Caplow, University of Missouri-Columbia
Ethan Heinen, University of Missouri-Columbia

Faculty Members' Perceptions of Administrative Norms for Academic Deans

Nathaniel Bray, Virginia Tech University

Session J3—Research/Scholarly Papers

Location: Carmel B

“Cultural Capital and College Decision-Making”

Chair: JoAnne C. Bunnage, Indiana University
Discussant: Marta Soto, University of Southern California

Perspectives on Racial Diversity in Higher Education: Campus Racial Climate, Educational Achievement, and Student Persistence

Robert Teranishi, New York University
Giniesha Dinwiddie, University of Pennsylvania
Ann Tiao, University of Pennsylvania

Transformational Elite Interviews: The Missing Link in Breaking Down Oppressive Systems

Adrianna Kezar, University of Maryland

Higher Education Reform as a Social Movement: The Case of Affirmative Action

Robert Rhoads, University of California, Los Angeles

How Does Developmental Education Fit into Higher Education?

Carol A. Kozerucki, University of California, Los Angeles

Session J4—Research/Scholarly Papers

Location: Carmel A

“Institutional and Organizational Change”

Chair: Greg Dubron, Florida International University
Discussant: Jana Nidiffer, University of Michigan

Leadership Lessons for Women in Higher Education: Key Factors for Effectiveness

Martha Tack, Eastern Michigan University
April Planagan, Eastern Michigan University

Engaging Resistance: Approaches to Surmounting Impediments to Organizational Transformation

Aaron Anderson, University of Michigan & University of California, Berkeley

A Case Study of Successful Community-Campus Partnership: Change Through Collaboration

Julie Bell Elkins, Framingham State College

Session J5—Symposium

Location: Tahoe

Using Quantitative Data to Answer Critical Questions

Shello Slaughter, University of Arizona
Deborah F. Carter, Indiana University
Frances Stage, New York University
Edward St. John, Indiana University
Sylvia Hurtado, University of Michigan
Laura Perna, University of Maryland
Benjamin Baez, Georgia State University

Session J6—Symposium

Location: Santa Barbara

The Social Effects of Institutional Stratification within Higher Education

Joseph Soares, Yale University
Karen Arnold, Boston College
Ted Youn, Boston College
Ann Mullen, U.S. Department of Education
Roger Geiger, Pennsylvania State University

Session J7—Symposium

Location: Big Sur B

The Tale of One City: Exploring College Preparation, Enrollment, and Persistence of African American and Latino Students in Chicago

Nicole E. Holland, University of Chicago
George J. Wimberly, ACT
Raquel L. Farmer Hinton, University of Chicago

Session J8—Focused Dialogue

Location: Big Sur A

On Becoming Qualitative Researchers: A Focused Dialogue

V. Lynne Holland, Bowling Green State University
Jane Rosser, Bowling Green State University
Mauveen Wilson, Bowling Green State University
Ellen Broide, Bowling Green State University

Saturday, November 23, 2002 continued

Session J9—Focused Dialogue

Location: Ventura

Faculty Senates and Governance: Questions, Concerns, and Research

*James T. Minor, University of Southern California**Dean Campbell, University of Southern California**Marvin W. Peterson, University of Michigan***3:30 p.m. to 5:00 p.m. - Concurrent Session K****Session K1—Research/Scholarly Papers**

Location: Golden State B

“Technology: Policy and Implementation”**Chair:** *Jenny Lee, University of California, Los Angeles***Discussant:** *Jim Vander Putten, University of Arkansas-Little Rock*

State Conceptualization of the Role of Technology in the Future of Higher Education

*Christopher Rasmussen, University of Michigan**Brittany Affolter-Caine, University of Michigan**Thomas Perorazio, University of Michigan*

Shoulder to Shoulder and Wire to Wire: Applying a Collaboratory Model in a Professional School

*Cynthia Hudgins, University of Michigan**Paula Allen-Mearns, University of Michigan*

The Institutional Impact of Advanced Technological Education Program on Community Colleges

*Yakari Matsuzuka, Teachers College, Columbia University**Thomas Bailey, Teachers College, Columbia University***Session K2—Research/Scholarly Papers**

Location: Golden State A

“Career and Degree Aspirations”**Chair:** *Rosa Cintron, University of Oklahoma***Discussant:** *Darwin D. Hendel, University of Minnesota*

Pathways to the Professoriate: The Roles of Self, Others, and Environment in the Formation of Academic Career Aspirations

Jennifer Lindholm, University of California, Los Angeles

Changes in Degree Aspirations During College Years

Leticia Oseguera, University of California, Los Angeles

Who Wants to Be a College President? Forms of Capital and Career Aspirations of Senior College Administrators

*Paul D. Umbach, Indiana University***Session K3—Research/Scholarly Papers**

Location: Carmel B

“The College and University Presidency”**Chair:** *James J.F. Forest, United States Military Academy***Discussant:** *Adrianna Kezar, University of Maryland*

Relationship of Faculty Experiences of College Presidents to their Leadership Development

*Sharon McDaule, George Washington University**Diane Dean, Teachers College, Columbia University*

Legitimacy in the Academic Presidency

Rita Bornstein, Rollins College

The Seventh Daughters: African American Women Presidents of Four-Year Predominantly White Colleges and Universities

*V. Barbara Bush, University of North Texas***Session K4—Research/Scholarly Papers**

Location: Carmel A

“State Policy and Higher Education”**Chair:** *Janet M. Holdsworth, University of Minnesota***Discussant:** *James C. Hearn, Vanderbilt University*

State Restructuring of Higher Education: Evidence from the Most Recent National Survey: 1995-2000

*Michael K. McLendon, Vanderbilt University**Erik Ness, Vanderbilt University*

Blending Cultures in University-Industry Partnerships: A Study of California Institutes for Science and Innovation

*Karen Kim, University of California, Los Angeles**Tracy Davis, University of California, Los Angeles*

A Theoretical Perspective of the State Public Policy Process for Higher Education Policy Decisions: The Case of the State of Washington

*Danielle Orr-Bement, University of Washington***Session K5—Graduate Student Session**

Location: Big Sur A

The View from the Professional Side: Job Search and First Year Survival Tips From Recent Graduates/New Professionals

Co-Chairs: *Shederick A. McClendon, Vanderbilt University**Katherine Garlough, University of Oklahoma**James T. Minor, University of Southern California**Kristen Renn, Michigan State University**Myron Pope, University of Oklahoma**Ellen Broudo, Bowling Green State University**Eugene Anderson, American Council on Education**Brian E. Nolund, Tennessee Higher Education Commission*

Saturday, November 23, 2002 continued

ASHE Saturday Night Event

5:30 p.m. to 7:30 p.m. (first group)

7:30 p.m. to 8:30 p.m. (second group)

Location: Julia Morgan House & Gardens*(Need ticket to attend)**This event has been made possible with the generous support of California State University-Sacramento and its President, Donald R. Gerth***SUNDAY, NOVEMBER 24, 2002***All events will be held at the Hyatt Regency Sacramento.***8:15 a.m. to 9:45 a.m. - Concurrent Session 1.****Session L1—Research/Scholarly Papers**

Location: Golden State B

“Altruism and Activism in College”*Chair: Carolyn J. Thompson, University of Missouri Kansas**Discussant: Chris M. Golde, Carnegie Foundation for the Advancement of Teaching***Working the System: Communication Processes of Student Activists and Higher Education Administrators***Becky Ropers-Huilman, Louisiana State University**Laura Carwile, Louisiana State University**Kathy Barnett, Louisiana State University***From Admitting Impoverished Students to Studying Poverty: How Serving the Poor Changed at the University of Michigan, 1870-1910***Jana Nidlffer, University of Michigan**Jeffrey P. Bouman, Calvin College***Volunteering in College: Impacts on Cognitive Outcomes, Learning Orientations, and Educational Aspirations***Christopher T. Pierson, University of Iowa**Ernest T. Pascarella, University of Iowa***Session L2—Symposium**

Location: Tahoe

College Preparation Programs and College Access: Relationships Real and Imagined*Linda Serra Hugeslorn, University of Southern California**Scott Swail, Council for Opportunity in Education**Clifford Adelman, OERI**Amaury Nora, University of Houston**Laura Perna, University of Maryland**Michelle Knight, New York University**Heather Oesterreich, New York University**Julia Colyar, University of Southern California***Session L3—Symposium**

Location: Carmel B

Learning Communities, First-Year Seminars, and Service Learning: The Impact of Curricular Interventions on Student Outcomes of the First Year of College*Jennifer Rinella Keup, University of California, Los Angeles**Shannon Gilmartin, University of California, Los Angeles**Arienne Walker, University of California, Los Angeles**Kimberly Misa, University of California, Los Angeles**Linda J. Sax, University of California, Los Angeles***Session L4—Symposium**

Location: Carmel A

The Multi-Mission Community College: Origins, Benefits, and Costs*Kevin J. Dougherty, Teachers College, Columbia University**Debra Bragg, University of Illinois at Champaign-Urbana**Vanessa Smith Marest, Teachers College, Columbia University**Kathleen M. Shaw, Temple University**Carolyn Charvon, Teachers College, Columbia University***Session L5—Roundtables**

Location: Golden State A

Credentialing for the Student Affairs Profession: Is It Just Around the Corner or Is the Idea Just Academic?*Cody Arvidson, University of North Texas***Problem-Based Learning as an Instructional Method for Higher Education Administration Students***Betsy Palmer, Montana State University**Claire Major, University of Alabama*

2002 CONFERENCE PROPOSAL REVIEWERS

International Forum

Aittola, Helena
 Austin, Ann
 El-Khawas, Elaine
 Fairweather, Jim
 Farrand-Rogers, John
 Finnegan, Dorothy E.
 Forest, James
 Gilazer-Raymo, Judith
 Kempner, Ken
 Kinser, Kevin
 Marginson, Simon
 Morphew, Christopher C.
 Nur-Awaleh, Mohamed
 Passer, Brian
 Rhoades, Gary
 Twombly, Susan
 Vander Putten, Jim
 Weidman, John C.
 Westerheijden, D.F.

Public Policy Forum

Aper, Jeff
 Cutright, Marc
 Diamond, Nancy
 Dowd, Alicia
 Floyd, Carol Everly
 Gappa, Judith
 Heller, Donald E.
 Inman, Patricia
 Janosik, Steven M.
 King, Jacqueline
 Kuboyama, Emi
 Lafer, Mark
 Maloney, Patricia
 Manns, Derrick
 McElendon, Michael
 Oromaner, Mark
 Palmer, James C.
 Perna, Laura
 Slinger, Bill
 Thomas, Scott

Focused Dialogues

Antonio, Anthony
 Broido, Ellen
 Cooper, Joanne
 Cress, Christine
 Foster, Len
 Hart, Jeni
 Joyce, Sharon
 Kempner, Ken
 Kinnick, Mary
 Lindholm, Jennifer
 Outcalt, Charles
 Passer, Brian
 Safarik, Lynn
 Vogelgesang, Lori
 Walpole, Marybeth
 Wood, Diane
 Yee, Jennifer

Poster Sessions

Aney, Marilyn
 Burrell, T. Gregory
 Dee, Jay
 Hearn, James
 Morphew, Christopher C.
 Peterson, Marvin
 Zamani, Eboni

Research/Scholarly Papers

Alstete, Jeffrey
 Aney, Marilyn
 Aper, Jeff
 Awe, Clara
 Barr, Susan
 Beach, Andrea
 Bieber, Jeffrey
 Boyer, Pat
 Bray, Nathaniel
 Brayboy, Brian
 Brown-Wright, Dianne A.
 Caplow, Julie
 Cawthon, Tony
 Chapman, David
 Cintron, Rosa
 Colbeck, Carol
 Creamer, Elizabeth G.
 Danowitz Sagaria, Mary Ann
 Davis, James Earl
 Davis, Tracy M.
 Dean, Diane A.
 Dee, Jay R.
 DesJardins, Stephen L.
 Dowd, Alicia C.
 Eatman, Timothy K.
 Eddy, Pamela
 Estler, Suzanne
 Fajen, Ava
 Fatima, Nasrin
 Feldman, Kenneth
 Fife, Jonathan
 Finkelman, Martin
 Forest, James J.F.
 Foster, Len
 Garlough, Katherine
 Gasman, Marybeth
 Gimmetad, Michael J.
 Golde, Chris
 Gonzalez y Gonzalez, Elsa
 Green, Paul
 Hagedorn, Linda Serra
 Hamrick, Florence
 Hanna, Kathryn
 Hersdel, Darwin
 Hildyard, Andrea
 Hirt, Juan
 Holmes, Sharon
 Hubschman, Betty
 Ignash, Jan M.
 Janosik, Steve
 Jara, Brian
 Jones, Gwendolyn
 Kezar, Adrianna
 Kim, Dongbin
 Kinser, Kevin
 Kirshstein Rita
 Kohen, Andrew
 Krause, Kerri-Lee
 Laanan, Frankie Santos
 Lamb, Charles
 Lee, Wynetta
 Levin, John
 Longo, Nancy
 Mabokela, Rcitumetse
 Obakeng
 Mangione, Terri L.
 Mazza, Christopher
 McClafferty, Karen
 McCleendon, Shedrick
 Milem, Jeffrey
 Millet, Catherine
 Morphew, Christopher
 Murray, John
 Murray-Ward, Mildred
 Olivas, Michael
 Outcalt, Charles
 Palmer, James
 Paulsen, Michael
 Perna, Laura
 Popp, Ronald
 Powers, Joshua
 Raveling, Joyce
 Glazer Raymo, Judith
 Rendon, Laura
 Renn, Kristen
 Robinson, Yolanda
 Ropers-Huilman, Becky
 Safarik, Lynn
 Saporoni, Dana
 Schuster, Jack
 Serow, Robert
 Shaw, Kate
 Sjogren, Jane
 Smith, Iola
 Smith, Regina O.
 Stein, Jill
 Swenk, Jean
 albur, Susan
 Taylor, Alton
 Teranishi, Robert
 Thomas, Scott
 Tonn, Doug
 Townsend, Barbara K.
 Twombly, Susan
 Travis, Jon E.
 Underwood, Dan
 VanDerLinden, Kim
 Vander Putten, Jim
 Villalpando, Octavio
 Walpole, Marybeth
 Wolf-Wendel, Lisa
 Wotipka, Christine Min

Worthman, Thomas
 Zamani, Eboni

Roundtables

Anderson, Melissa
 Austin, Ann
 Brown, M. Christopher II
 Carter, Deborah
 Conrad, Clifton F.
 Gurnport, Patricia
 Hughes, Robin L.
 Hyle, Adrienne E.
 Jackson, Jerlando F.L.
 Neumann, Anna
 Renn, Kristen
 Ropers-Huilman, Becky
 Sorcinelli, Mary Deane
 Stanley, Christine
 Terenzini, Patrick T.
 Travis, Jon
 Twombly, Susan
 Ward, Kelly

Symposia

Anderson, Melissa
 Boyle, Kate
 Dey, Eric
 Gasman, Marybeth
 Holmes, Sharon
 Hossler, Don
 Howard-Hamilton, Mary
 Hu, Shouping
 Jackson, Jerlando
 Kinzie, Jillian
 Lattuca, Lisa
 Lee, Wynetta
 McCormick, Alex
 Oliva, Maricela
 Sax, Linda
 Thompson, Carolyn

ASHE AWARD WINNERS

Awards listed are those given since 1985, the year that the ASHE Awards Committee officially convened.

Howard R. Bowen Distinguished Career Award

Presented to an individual whose professional life has been devoted in substantial part to the study of higher education and whose career has significantly advanced the field through extraordinary scholarship, leadership and service. The award is usually presented at, or near, the time of the individual's retirement.

- 2001 Helen S. Astin
- 2000 Arthur Chickering
- 1999 Joan S. Stark
- 1998 Arthur Cohen
- 1997 Burton Clark
- 1996 Alexander W. Astin
- 1995 William Toombs
- 1994 Robert Silverman
- 1993 Robert O. Berdahl
- 1992 K. Patricia Cross
- 1991 Cameron Fincher
- 1989 Mary Corcoran & Robert Pace
- 1987 Lewis Mayhew & Joseph Kauffman
- 1986 David Riesman
- 1985 Howard R. Bowen

ASHE Distinguished Service Award

Presented in recognition of exceptional commitment to the Association for the Study of Higher Education and significant contribution to its success.

- 2001 Robert O. Berdahl
- 2000 Mildred Garcia
- 1999 Philip G. Altbach
- 1998 Joan S. Stark
- 1996 Stan Carpenter & Patricia Hyer
- 1995 Daryl Smith
- 1993 John C. Smart
- 1990 L. Jackson Newell
- 1987 Jonathan Fife

Special Merit Award

Presented to a person, group or organization in recognition of distinctive support for the purposes and goals of the Association for the Study of Higher Education. This award may be presented to an influential academic leader or a scholar outside the field of higher education who has offered a valuable perspective for studying and understanding colleges and universities.

- 2001 Clifford Adelman & Deborah Wilds
- 2000 Michael A. Olivas
- 1995 Lavina Fielding Anderson
- 1993 Walter Hobbs
- 1992 Jusscy-Bass Inc. Publishers
- 1990 Peggy Heim & Robert Silverman

Research Achievement Award

Presented for outstanding contribution to research for an individual whose published research (theoretical, empirical or applied) advances understanding of higher education in a significant way. The Research Achievement Award may acknowledge a body of research or a single piece of meritorious research.

- 2001 John C. Smart
- 2000 George Kuh
- 1999 Vincent Tinto
- 1998 Sheila Slaughter
- 1997 William G. Tierney
- 1996 Kenneth A. Feldman
- 1995 Larry L. Leslie
- 1994 Michael A. Olivas
- 1993 Yvonna S. Lincoln
- 1992 Joan Stark
- 1991 Ernest Pascarella & Patrick Terenzini
- 1990 Robert Birnbaum
- 1989 Jack Schuster
- 1988 Robert Blackburn & Howard Bowen
- 1987 Alexander W. Astin
- 1985 Burton Clark

Promising Scholar/Early Career Award

Given for a significant body of scholarship or a single extraordinary research achievement by a higher education scholar, and in recognition of potential for future research. This award may also call attention to significant work in progress that has won praise from senior colleagues and support from foundations or government agencies. The Early Career Award is reserved for individuals who are no more than six years beyond the receipt of the doctoral degree.

- 2001 M. Christopher Brown II
- 2000 Linda Hagodorn & Lisa Wolf-Wendall
- 1999 Linda J. Sax
- 1998 Jennifer Grant Haworth
- 1997 Rob Rhoads
- 1996 Eric Dey
- 1995 Sylvia Hurtado & Elizabeth Whitt
- 1993 Alberto Cabrera & Patricia Gumpert
- 1991 Amanry Nora
- 1990 Fran Stage
- 1989 Ann Austin

Leadership Award

Given for outstanding leadership in advancing the study of higher education. This award is intended to recognize individuals who bring visibility and support to the field of higher education by demonstrating the contributions of the study of higher education to policy formation, or in gaining substantial resources for research and training in higher education.

- | | |
|--------------------|--------------------------|
| 2001 William Bowen | 1992 Ernest Boyer |
| 2000 Ted Marchese | 1990 Kenneth P. Mortimer |
| 1999 Zelda Gamson | 1996 Peter Ewell |
| 1995 Derek Bok | |

BOBBY WRIGHT DISSERTATION OF THE YEAR AWARDS

Awards listed are those given since 1985, the year that the ASHE Awards Committee officially commenced.

Named in memory of Irvin Lee (Bobby) Wright, this award recognizes one or more dissertations that serve as exemplary models of the methodology employed. Criterion also include the significance of the dissertation topic.

2001-2002: Michael K. McLendon

Setting the Agenda for State Decentralization of Higher Education: Analyzing the Explanatory Boundaries of Alternative Agenda Models

2001-2002: Cited For Excellence: Joshua B. Powers

Academic Entrepreneurship in Higher Education: Institutional Effect of Performance of University Technology Transfer

2000-2001: David Weerts

Understanding Differences in State Support for Higher Education: A Comparative Study of State Appropriations for Research Universities

2000-2001: Cited for Excellence: William Mallon

Abolishing or Instituting Tenure: Four Case Studies of Change in Faculty Employment Policies

1999-2000: Marvin Dewey

An Exploratory Study of the Relationship Between Cognitive Complexity of Administrative Teams in Private Liberal Arts Colleges and Organizational Health as One Dimension of Organizational Effectiveness

1999-2000: Cited for Excellence: Elizabeth A. Palmer

An Analysis of a Diversity Requirement: The Effect of Course Characteristics on Students' Racial Attitudes, Gender Attitudes, and Self-Perceived Learning

1998-1999: Deborah Faye Carter

A Dream Deferred? Examining the Degree Aspirations of African American and White College Students

1998-1999: Cited for Excellence: R. Sam Larson

Organizational Change from the 'Inside': A Study of University Outreach

1997-1998: Joseph Berger (Co-winner)

Organizational Behavior at Colleges and Student Outcomes: Generating a Quantitatively Grounded Theory

1997-1998: Cynthia Sabik (Co-winner)

(Re) writing Metaphor and Form: Autoethnographic Enactments from the Postmodern Classroom

1996-1997: Lisa Rose Lattuca

Envisioning Interdisciplinarity: Processes, Contexts, Outcomes

1996-1997: Cited for Excellence: Rebecca Ropers-Hullman

Shaping an Island of Power and Change: Creating a Feminist Poststructural Teaching Discourse

1996-1997: Cited for Excellence: Carol L. Colbeck

Organizational and Disciplinary Influences on Integration and Congruence of Faculty Work

1995-1996: Teresa Isabelle Daza Campbell

Protecting the Public's Trust: A Search for Balance Among Benefits and Conflicts in University-Industry Relationships

1994-1995: Robert A. Rhoads

Institutional Culture and Student Subculture: Student Identity and Socialization

1994-1995: Cited for Excellence: Peter M. Magolda

A Quest for Community: An Ethnographic Study of a Residential College

1993-1994: Rebecca R. Kline

The Social Practice of Literacy in a Program of Study Abroad

1993-1994: Cited for Excellence: Dorothy Finnegan

Academic Career Lines: A Case Study of Faculty in Two Comprehensive Universities

1992-1993: Martha Lillian Ann Stassen

White Faculty Members' Responses to Racial Diversity at Predominantly White Institutions

1991-1992: Julie Neururer

Decency and Dollars Invested: Case Studies of South African Divestiture

1991-1992: Cited for Excellence: Françoise Queval

The Evolution Toward Research Orientation and Capability in Comprehensive Universities: A Case Study: The California State University System

1990-1991: Kenneth D. Crews, J.D.

Copyright Policies at American Research Universities: Balancing Information Needs and Legal Limits

1989-1990: Roger L. Williams

George W. Atherton and the Beginnings of Federal Support for Higher Education

1988-1989: Patricia Gumpert

The Social Construction of Knowledge: Individual and Institutional Commitment to Feminist Scholarship

Bobby Wright Dissertation of the Year Awards continued

1987-1988: Dolores L. Burke

Change in the Academic Marketplace: A Study of Faculty Mobility in the 1980s

1986-1987: Irvin Lee (Bobby) Wright

Piety, Politics and Profit: American Indian Missions in the Colonial Colleges

1986-1987: Cited for Excellence: Lester F. Goodchild

The Mission of the Catholic University in the Midwest, 1842-1980

1985-1986: Janet Kerr-Tener

From Truman to Johnson: Ad Hoc Policy Formulation in Higher Education

1985-1986: Cited for Excellence: Amaury Nora

Determinants of Retention Among Chicano Students: A Structural Model

1985-1986: Cited for Excellence: Charlotte Hanna

Modest Expectations: Qualitative and Quantitative Analysis of Faculty Affirmative Action

1984-1985: Lois A. Fisher

State Legislatures and the Autonomy of Colleges and Universities: A Comparative Study of Legislation in Four States, 1900-79

1984-1985: Runner-Up: Bernard Reams

Research Interactions Between Industry and Higher Education

1984-1985: Cited for Excellence: Marta Wagner

The American Scholar in the Early National Period: The Changing Context of Colonial Education

1983-1984: Jeffery Bartkovich

Designing an Empirically Derived Taxonomy of Organization Structures in Higher Education

1983-1984: Cited for Excellence: Constance Collins

Loose Coupling as a Framework for Understanding Structural Change: Case Studies of Four American Colleges and Universities

1983-1984: Cited for Excellence: Edward Ottensmeyer II

Strategic Organizational Adaptation and the Regulatory Environment: A Study of Universities During a Time of Regulatory Change

1982-1983: Catherine Marleau

Bridging Theory and Practice in Adult Development and Planned Change

1982-1983: Cited for Excellence: Jerry Wayne Askew

Toward a Theory on the Impact of Budget Retrenchment in Educational Organizations

1982-1983: Cited for Excellence: Ellen Metzner Ironside

Career Paths of Women Administrators in Higher Education

1981-1982: Ellen Chaffee

Decision Models in Budgeting

1981-1982: Cited for Excellence: Ted L. K. Youn

The Career of Young Ph.D.s: Temporal Change and Institutional Effects

1981-1982: Cited for Excellence: Joyce Mushaben

The State Versus the University: Juridicalization and the Politics of Higher Education at the Free University of Berlin, 1969-79

1980-1981: Paul Duby

An Investigation of the Mediating Role of Causal Attitudes in School Learning

1980-1981: Cited for Excellence: James Henson

Institutional Excellence and Student Achievement: A Study of College Quality and Its Impact on Education and Career Development

1979-1980: Kenneth Bradley Orr

The Impact of the Depression Years 1929-39 on Faculty in American Colleges and Universities

1979-1980: William Zumeta

The State and Doctoral Programs at the University of California: Academic Planning for an Uncertain Future

1979-1980: Cited for Excellence: Daniel Carl Levy

University Autonomy Versus Government Control: The Mexican Case

2002 BOARD OF DIRECTORS AND PAST PRESIDENTS OF ASHE**2002 BOARD OF DIRECTORS****President**

William G. Tierney
University of Southern California
wgtiern@usc.edu

President-Elect

John M. Braxton
Vanderbilt University
john.m.braxton@vanderbilt.edu

Immediate Past President

Ann E. Austin
Michigan State University
aaustin@msu.edu

At-Large Member

Caroline S. Turner
Arizona State University
csturner@asu.edu

At-Large Member

Linda Eisenmann
University of Massachusetts - Boston
linda.eisenmann@umb.edu

At-Large Member

Edward P. St. John
Indiana University
estjohn@indiana.edu

At-Large Member

Wynetta Y. Lee
Dillard University
wlee@dillard.edu

Graduate Student Member

Shederick A. McClendon
Vanderbilt University
sa.mcclendon@vanderbilt.edu

Graduate Student Member

Katherine Garlough
University of Oklahoma
garlo@ou.edu

Legal Counsel

J. Douglas Toma
University of Pennsylvania
toma@gse.upenn.edu

Executive Director

Barbara K. Townsend
University of Missouri-Columbia
TownsendB@missouri.edu

Managing Director

Lauri D. Goma
University of Missouri-Columbia
GomaL@missouri.edu

ASHE PRESIDENTS

2002-2001 William G. Tierney
2001-2000 Ann E. Austin
1999-2000 John Thelin
1998-1999 Laura Rendon
1997-1998 Yvonna Lincoln
1996-1997 George Kuh
1995-1996 Sheila Slaughter
1994-1995 Patrick Terenzini
1993-1994 Elaine El-Khawass
1992-1993 Michael T. Nettles
1991-1992 Shirley M. Clark
1990-1991 Judith Dozier Hackman
1989-1990 Ernest T. Pascarella
1988-1989 Ellen Earle Chaffee
1987-1988 Clifton Conrad
1986-1987 David W. Leslie
1985-1986 Robert Birnbaum
1984-1985 Joan S. Stark
1983-1984 Kathryn M. Moore
1982-1983 Marvin W. Peterson
1981-1982 Joseph F. Kauffman
1980-1981 Howard R. Bowen
1979-1980 Burton R. Clark
1978-1979 Robert O. Berdahl
1977-1978 Kenneth P. Mortimer
1977-1976 C. Robert Pace

INDEX OF PARTICIPANTS

-AB-

Abes, Elisa, E1
 Abilov, Serik S., Intl
 Adams, Jennifer Ann, E1
 Adelman, Clifford, E2, L2
 Affolter-Caine, Brittany, A2, H8, K1
 Alacantara, Armando, Intl
 Allen, Walter, A1
 Allen-Haynes, Leeta, I7
 Allen-Mears, Paula, K1
 Allison-Jones, Lisa, G1
 Altbuch, Philip G., A5, E4
 Alvarez, Alvin N., A7
 Amey, Marilyn J., A6, F3
 Anaya, Guadalupe, A1, F6
 Anderson, Aaron, J4
 Anderson, Deborah, A4
 Anderson, Eugene, K5
 Anderson, Melissa S., C1, G4
 Anderson-Thompkins, Sibby, H6
 Antonio, Anthony Lisang, G2, H2
 Antony, James Soto, A9, F2
 Arnold, Karen, J6
 Arvidson, Cody, L5
 Astin, Alexander, E3
 Astin, Lena, E3
 Austin, Ann E., A9, F7, I5, Intl
 Bacz, Benjamin, A4, U2, J5
 Bailey, Thomas, K1
 Bain, Olga, Intl
 Baird, Leonard, E4
 Balan, Jorge, D4
 Baldwin, Roger, B3, I5
 Banta, Trudy W., G7
 Barnes, Teresa, Intl
 Barnett, Kathy, L1
 Bastedo, Michael N., B6
 Bauman, Georgia, F5, I6
 Bayer, Alan H., I13
 Beach, Andrea L., C2, G4
 Bell-Elkins, Julie, J4
 Bensimon, Estela Maru, F5, I6, Intl
 Berczanska, Elena, Intl
 Berger, Joseph, C4, G3, H3, I6
 Bergerson, Amy Aldous, G3
 Bess, James L., C2
 Bieber, Jeffrey, A3, B8
 Bility, Khalipha, Intl
 Bilodeau, Brent, G5
 Bleak, Jared, E1
 Bonus-Hammarth, Marguerite, I15
 Borland, Ken, G8
 Bornstein, Rita, K3
 Bouman, Jeffrey P., A3, L1
 Bragg, Dobra, L4
 Braxton, John, H3, Grad
 Bry, Nathaniel, J2
 Breneman, David, H4
 Briggs, Charlotte, C9
 Bright, Larry K., Intl
 Broido, Ellen, J8, K5
 Brown, Jonathan A., Pub
 Brown, M. Christopher H., C7

Brown, Walter, I4
 Bryant, Alyssa, B2, F1
 Bunnage, JoAnne C., J3
 Burgan, Mary A., Address
 Burkum, Kurt, C6, G1
 Bush, V. Barbara, K3

-CD-

Caboni, Timothy, H3, Intl
 Cabrera, Alberto, G1
 Cadray, Joseph, I7
 Campbell, Dean, J9
 Canales, Alejandro, Intl
 Caplow, Julie, J2
 Card, Karen, I3
 Card, Michael, F3
 Carducci, Rozana, J3
 Carini, Robert, I1
 Carter, Deborah F., J5
 Carwile, Laura, L1
 Chang, Gordon, I2
 Chang, June, B4
 Chang, Mitchell, I1
 Chapman, David W., C4, Intl
 Charron, Carolyn, L4
 Chenier, Thomas, Pub
 Cheslock, John J., A4, G6
 Chism, Nancy, I7
 Chung, Choon-Guen, G2
 Cintron, Rosa, H1, K2
 Coaxum, James, H5
 Coelen, Stephen, C4
 Cohen, Arthur, B4
 Colbeck, Carol, C6
 Cole, Brenda, C8
 Cole, John, C4
 Collie, Sarah, I6
 Colyar, Julia, I2
 Conley, Valerie Martin, I8
 Connolly, Mark, F7
 Cook, Bryan, B7
 Cooper, Joanne, I5
 Cosser, Michael, Intl
 Cox, Roy, I18
 Creamer, Elizabeth G., A6, B3
 Cuevas, Nuria M., I1
 Cummings, William, Intl
 Cunningham, Ahsa, Grad
 Currie, Jan, Intl
 Cutright, Marc, Pub
 Daltro-Schram, Lindsey, Intl
 Danowitz Sagaria, Mary Ann, Intl
 Dantzer, Gail, C8
 Davis, James Earl, C7, E1
 Davis, Jerry, D4
 Davis, R. Deborah, G9
 Davis, Tracy, K4
 Dean, Diane, J2, K3
 Dee, Jay, G4
 Del Favero, Marietta, C9, H3
 Deusterhaus, Mary, H3
 Dey, Eric, E3
 Diamond, Nancy, Pub

Diaz, Veronica, A4, E1
 Dilley, Patrick, G5
 Diuviddie, Giniasha, J3
 Dougherty, Kevin J., I14, I3, I4
 Dowd, Alicia C., A8, E1
 Drago, Robert, C6
 Dubrow, Greg, F8, J4
 Duderstadt, James J., Address
 Dunn, Delmer, F9
 Dzimiri, Wonderful, Intl

-EF-

Eckel, Peter, B8
 Eddy, Pamela L., A8, E1, G1
 Ehrenberg, Ronald G., A4
 Eisenmann, Linda, F5
 Elliot, Carol, Intl
 Engberg, Mark, G3
 Englund, Tomas, Intl
 Epstein, Edward, B3
 Erwin, T. Dary, G7
 Espinoza, Suzanne, F2
 Ethington, Corinna, I12
 Evans, Nancy J., G5
 Eyermann, Therese S., B1
 Fairweather, James, G8
 Fann, Amy, F2
 Farmer Hinton, Raquel L., J7
 Fatima, Nasrin, B1
 Faughnan, Michael, C5
 Fife, Jonathan D., C3
 Finkelstein, Martin J., A5, E1
 Finnegan, Dorothy E., C5, G8, Intl
 Flanagan, April, J4
 Floyd, Carol Everly, Pub
 Floyd, Deborah L., A8
 Forest, James J.F., C4, H1, K3, Intl
 Foster, Len, C7
 Freeman, Kassie, C7, F6
 Friedel, Janice, A8,

-GH-

Gallagher, Karen Symms, D2
 Gappa, Judith, I5, Pub
 Garcia, Mildred, F6, G8
 Garlough, Katherine, K5
 Gasman, Marybeth, B3, I16
 Gaston, Joy L., I4
 Geiger, Roger, J6
 Gelman, Sheldon, C1
 Gerth, Donald, Grad
 Gihelman, Margie, C1
 Gilhmartin, Shannon, B2, L3
 Glazer-Raymo, Judith, H2, G8, Intl
 Gmelch, Walter, Intl
 Goldc, Chris M., F7, L1
 Goldfine, Leonard, G4
 Goldsmith, Sharon, F7
 Gomez, Gigi, A1
 Gonzalez, Kenneth, F2
 Goodchild, Lester, A3
 Greene, Shirley, B7

Greenough, Amy, C5
 Gumpert, Patricia J., H6, C9
 Guyden, Janet, C7
 Hagedorn, Linda Serra, B4, D3, E1, F4, L2
 Hao, Lan, E1
 Hartley, Matthew, F8
 Haviland, Don, F7
 Haydel, Nia Woods, H6
 Hearn, James, F9, H3, K4
 Heggins, Willie J. III, Intl
 Heinen, Ethan, J2
 Heller, Donald, A2, G2, Pub
 Hendel, Darwin, K2
 Hendricks, Michael, F1
 Heyneman, Stephen P., Intl
 Hill, O. Cleveland, I7
 Hirsch, Penny, H8
 Hirschy, Amy, I13
 Hirt, Joan, G1, H7
 Holdsworth, Janet M., B1, H3, K4
 Holland, Nicole E., J7
 Holland, V. Lynne, J8
 Holmes, Sharon L., A1
 Horn, Robert, H2
 Horvat, Erin McNamara, G2
 Houghton Wright, Lori, E1
 Hu, Shouping, F2, H2
 Huba, Mary, H6
 Hudgins, Cynthia, K1
 Hughes, Kevin, C5
 Hullar, Ted, D4
 Hurley, Alicia, Pub
 Hurtado, Sylvia, B7, E3, F5, G3, I5
 Hutcheson, Philo, B4, I3
 Hyle, Adrienne, I15

-IJK-

Ignash, Jan, G1
 Inman, Patricia, Pub
 Isaacs, Heather, C1
 Jackson, Jerlando, C3
 Jaeger, Audrey J., G2
 Janosik, Steven M., I8
 Johnson, Jeffrey Thomas, Intl
 Johnson, Lee, F3
 Johnstone, Bruce D., Intl
 Jones, Bruce A., F6
 Jovel, Jennifer, E1
 Junor, Sean, Intl
 Karaeva, Zina, Intl
 Karsoth, Berit, Intl
 Keeton, Rebecca Gutierrez, F1
 Kempner, Ken, Intl
 Keup, Jennifer Rineilla, B5, L3
 Kezar, Adrianna, F5, J3, K3
 Kienzl, Gregory, I3
 Kile, Kimberly, C3
 Kim, Dongbin, A2
 Kim, Karen, K4
 Kimura, Erin F., A7,

MAP OF HYATT REGENCY SACRAMENTO MEETING FLOORS

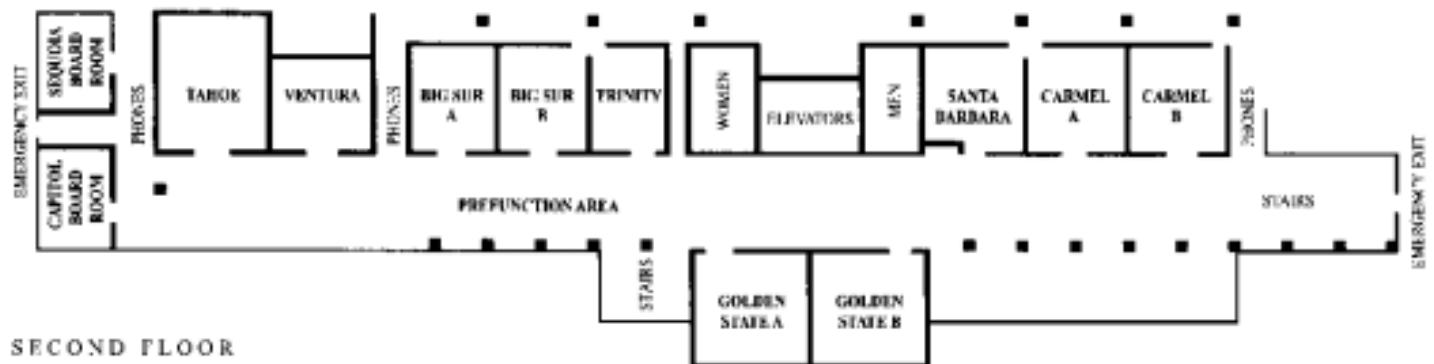
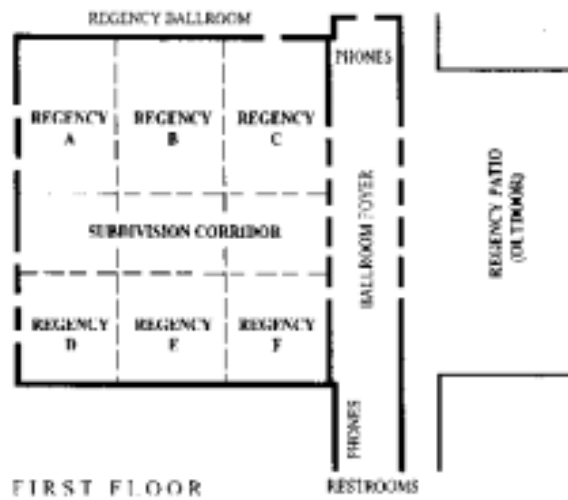

ASHE EXECUTIVE OFFICE MEMBERS

Barbara K. Townsend
Executive Director

Laarni D. Goma
Managing Director

Jeremy S. Bloss
Administrative Assistant

Daniel LeFever
Graduate Assistant

Program Designed by L. D. Goma 2002

Association for the Study of Higher Education
University of Missouri-Columbia
Department of Educational Leadership & Policy Analysis
202 Hill Hall
Columbia, MO 65211-2190
Ph. 573-882-9645
Fx. 573-884-2197
Email: ashe@eoc.missouri.edu
Web: www.ashe.missouri.edu

Hyatt Regency Sacramento
1709 L Street
Sacramento, CA 95814