

FIFTEENTH ANNUAL MEETING

# ASHE

Association For The Study Of Higher Education

---

November 1-4, 1990 ❖ Red Lion-Jantzen Beach ❖ Portland, Oregon

---

Dear Colleague,

On behalf of ASHE, I would like to welcome you to our fifteenth annual meeting in Portland. Judy Grace and the program committee have been especially creative and resourceful in putting together the program. This year's program offerings represent the very best things that ASHE has come to stand for: good research scholarship, analysis and debate of important issues, diversity of intellectual perspectives, interesting and informative keynote speakers (this year Kenneth Mortimer and Judith Ramaley), and a chance to interact with good friends and colleagues in an informal, friendly atmosphere. I hope you will exploit the program offerings and be stimulated and enriched by them.

In addition to our formal program, I invite you to join us for the sponsored Welcome Breakfast on Friday morning, the "ASHE Bash" on Friday evening, and especially Saturday evening's dinner at the World Forestry Center.

On a personal note, let me say that it has been an honor to serve as ASHE president this year, and I encourage you to attend the combined business meeting and awards session to learn more about the Association, welcome Judith Hackman as our new president, and honor deserving colleagues. Enjoy the conference.

Cordially,

Ernest T. Pascarella  
ASHE President

---

ASHE WISHES TO THANK THE 1990 SPONSORS:

**ASHE/ERIC Higher Education Report Series**  
**Center for the Study of Higher Education - Pennsylvania State**  
**University**  
**Council for Advancement and Support of Education**  
**Jossey-Bass, Publishers**  
**Journal of General Education**  
**Pacific Power and Light Company**  
**TIAA-CREF**

FIFTEENTH  
ANNUAL  
MEETING

# Association For The Study Of Higher Education

---

NOVEMBER 1-4, 1990 ♦ Red Lion-Jantzen Beach ♦ Portland, Oregon

---

---

**Program Chair:**

**Judy Diane Grace**

*Council For Advancement And Support Of Education*

---

**Co-Chairs:**

**Patrick T. Terenzini**

Research Papers

*Pennsylvania State University*

**Jonathan D. Fife**

Keynotes

*George Washington University*

**William G. Tierney**

Research Papers

*Pennsylvania State University*

**Ellen Brier**

Keynotes

*Syracuse University*

**Ann E. Austin**

Symposia

*Vanderbilt University*

**Michael Mills**

Evaluation

*University of Hartford*

**John Neal**

Symposia

*Webster University*

**Laura Rendon**

Newcomers

*North Carolina State University*

**Amaury Nora**

Focused Dialogues

*University of Illinois-Chicago*

**Christine Z. Somervill**

Local Arrangements

*Columbia College*



**WEDNESDAY, OCTOBER 31, 1990**

1:00 pm to 9:00 pm **GRADUATE STUDENT POLICY SEMINAR**  
**Coordinator:** Patricia B. Hyer, VPI & SU  
**ROOM:** CROWN ZELLERBACH

**THURSDAY, NOVEMBER 1, 1990**

8:00 am to 12:00 pm **GRADUATE STUDENT POLICY SEMINAR (CONTINUED FROM WEDNESDAY)**  
**ROOM:** WEYERHAEUSER

8:00 am to 12:00 pm **ASHE BOARD MEETING**  
**ROOM:** JANTZEN

9:00 am to 12:00 pm **HIGHER EDUCATION PROGRAM DIRECTORS MEETING**  
**ROOM:** RED LION - EAST

10:00 am to 7:00 pm **REGISTRATION**  
**ROOM:** LOBBY

**12:00 pm to 1:15 pm CONCURRENT SESSIONS I****IA. Paper Presentation: Institution Choice: Decision-Making and Tracking**

**Chair:** Amaury Nora, University of Illinois-Chicago  
**Presenters:** "Social Reproduction and College Participation: A Case Study," James F. Trainor, Pennsylvania State University ♦ "Mobility of Educational Aspirations: The Effect of Community Colleges," Alexander C. McCormick, Stanford University ♦ "Baccalaureate Transfers: An Exploration of Factors that Influence Second Institution Choice," Karen Twede, UCLA ♦ "Measuring Graduation Rates in the Two-Year College," Rodolfo Garcia Z., Michigan State University  
**Discussant:** Gary Rhoades, University of Arizona  
**ROOM:** MULTNOMAH

**IB. Paper Presentation: Administration and Leadership**

**Chair:** William Tierney, Pennsylvania State University  
**Presenters:** "Personal Qualities and Highly Visible Presidents," Carolyn Griswold and Ian Macfie, University of Georgia ♦ "Errand-boy, Commander, Builder, and ? : Images of Leadership in Community Colleges," Susan B. Twombly and Marilyn J. Amey, University of Kansas ♦ "Number One Staffer or Number Two Leader of the Institution: Clarifying Expectations and Realities of the Role of Chief Academic Officer," Marilyn J. Amey, University of Kansas  
**Discussant:** Estela Bensimon, Pennsylvania State University  
**ROOM:** CLACKAMAS

**IC. Paper Presentation: Pedagogy**

**Chair:** Malcolm Lowther, University of Michigan  
**Presenters:** "Academic Tasks as the Representation of Content in Postsecondary Teaching," Veronica M. Blake and Sarah M. Dinham, University of Arizona ♦ "Faculty Course Objectives: Substantive Disciplinary Differences or Semantics?" Patricia A. Wren, Joan S. Stark, and Malcolm A. Lowther, University of Michigan ♦ "A Comparison of the Teaching Goals, Assumptions, and Practices of Faculty in Eight Liberal Arts Disciplines," Janet H. Lawrence, University of Michigan ♦ "Teaching Theories of Community College Faculty," Julie A. Hughes, University of Missouri  
**Discussant:** John Centra, Syracuse University  
**ROOM:** CLARK

**ID. Paper Presentation: Student Goals and Values**

**Chair:** Daryl Smith, Claremont Graduate School  
**Presenters:** "Freshman Values Versus Student Experiences: Carleton Students in the 1980s," David L. Brodigan and John G. Ramsay, Carleton College ♦ "Differences in Perceived Goal Conflict Among First-generation and Non First-generation College Students," Kathleen Shaw, University of Michigan ♦ "Reliability and Concurrent Validity of Student Goals Exploration: A New Instrument for Assessing Student Course-level Goals," Richard J. Bentley, Joan S. Stark, Malcolm Lowther, Kathleen Shaw, University of Michigan  
**Discussant:** Kenneth Feldman, SUNY-Stony Brook  
**ROOM:** WASHINGTON

**THURSDAY, NOVEMBER 1 (CONTINUED)****IE. Paper Presentation: Evaluation of Student Learning and Reasoning**

**Chair:** Patrick Terenzini, Pennsylvania State University  
**Presenters:** "Validity of Faculty Judgments of Student Performance," Dwight Smith, Rutgers University ♦ "Influence of Collegiate Environments on Student Effort and Learning," George D. Kuh, Indiana University-Bloomington ♦ "Changes in Students' Reasoning Over Time: A Ten-year Longitudinal Study of the Development of Reflective Judgment," Patricia M. King, Bowling Green State University ♦ "The Impact of College on NTE Performance," Ronald D. Opp, UCLA Higher Education Research Institute  
**Discussant:** Leonard Baird, University of Kentucky  
**ROOM:** CROWN ZELLERBACH

**1:30 pm to 2:45 pm CONCURRENT SESSIONS II****IIA. Paper Presentation: Assessment**

**Chair:** Linda Gerber, Portland Community College  
**Presenters:** "Price-quality Relationships in Liberal Arts Colleges," Jeffrey L. Gilmore, US Department of Education ♦ "Assessing Undergraduate Program Quality from the Perspective of the Chief Academic Officer: A Classification by Institution Type and by Academic Discipline," Dennis F. Brown, University of Kansas ♦ "The Assessment Mandates: How Persuasive Are They?" Dennis E. Hinkle, Butler University and Jeff Aper, Southern Illinois University, and Michael Scott, Dabney S. Lancaster Community College  
**Discussant:** Michael Nettles, University of Tennessee  
**ROOM:** MULTNOMAH

**IIIB. Symposium: The Crisis of Facilities in American Higher Education**

**Presenters:** Stephen G. Katsinas, Oklahoma State University ♦ Vincent A. Lacey, Southern Illinois University ♦ Wayne Leroy, Association of Physical Plant Administrators of Universities and Colleges  
**Reactor:** Raymond J. Young, Washington State University  
**ROOM:** CLACKAMAS

**IIIC. Symposium: New Approaches to Program Review, Accreditation, and Assessment**

**Presenters:** Barbara E. Breier, Hardin-Simmons University ♦ Robert J. Barak, Iowa Board of Regents ♦ Mary Kinnick, Portland State University ♦ Dan Walleri, Mount Hood Community College  
**Reactor:** Michael Paulsen, University of Illinois-Urbana Campaign  
**ROOM:** CLARK

**IIID. Paper Presentation: The State and Higher Education**

**Chair:** Robert Hendrickson, Pennsylvania State University  
**Presenters:** "The State and Higher Education: A Model for Higher Education Policy Studies," Jeff Aper, Southern Illinois University ♦ "A Case Study of the Influence of Political Culture on Institutional Behavior and Outcomes," Tazella J. Gaither, Arizona State University ♦ "The Role of State Departments of Education in School/College Collaborations," Elizabeth M. Hawthorne, University of Toledo, and Ami Zusman, University of California ♦ "A Comparative Analysis of Arrangements for State Coordination of Higher Education in Canada and the United States," Michael L. Skolnick and Glen Jones, Ontario Institute for Studies in Education  
**Discussant:** Ellen Earle Chaffee, North Dakota University System  
**ROOM:** WASHINGTON

**IIIE. Distinguished Symposium: Students in American Higher Education - A Multicultural Population**

**Discussant:** Cheryl Presley, Colorado State University  
**Presenters:** Mildred Garcia, Montclair State University ♦ Richard Duran, University of California-Santa Barbara ♦ Marvin Peterson, University of Michigan ♦ Caroline Turner, University of Minnesota-Minneapolis ♦ Bobby Wright, Pennsylvania State University  
**ROOM:** CROWN ZELLERBACH

**THURSDAY, NOVEMBER 1 (CONTINUED)**3:00 pm to 4:15pm **CONCURRENT SESSIONS III****IIIA. DISSERTATION OF THE YEAR AWARD**

*"Copyright Policies at American Research Universities: Balancing Information Needs and Legal Limits,"* Kenneth D. Crews, San Jose State University (UCLA, 1990)  
**ROOM: MULTNOMAH**

**IIIB. Paper Presentation: Evaluating Presidents**

**Chair:** Kenneth Kempner, University of Oregon  
**Presenters:** "The Evaluation of College Presidents: Dimensions Used by Campus Leaders," Eleanor Fujita, Columbia University Teachers College ♦ "Will You Love Me in December as You do in May?: Why Experienced College Presidents Lose Faculty Support," Robert Birnbaum, University of Maryland-College Park ♦ "The Leadership of Hard Times and Good Times: What's the Difference?" Anna Neumann, Michigan State University  
**Discussant:** Kathryn Moore, Michigan State University  
**ROOM: CLACKAMAS**

**IIIC. Paper Presentation: Curriculum: General Learning, Assessment, and Perception**

**Chair:** Charles Ambrose, Western Carolina University  
**Presenters:** "General Learning at a Women's College," James L. Ratcliff and Elizabeth Jones, Pennsylvania State University ♦ "Effective Coursework Patterns and Faculty Perceptions of the Development of General Learned Abilities," Elizabeth Jones and James L. Ratcliff, Pennsylvania State University ♦ "Preparation for Trivial Pursuit or Life: The Meaning Students Give to General Education," Susan B. Twombly, University of Kansas  
**Discussant:** L. Jackson Newell, University of Utah  
**ROOM: CLARK**

**IIID. Paper Presentation: Persistence and Attrition**

**Chair:** J. Fredericks Volkwein, SUNY-Albany  
**Presenters:** "Freshman Experiences Influencing Academic Integration: An Elaboration of Tinto's Model," Nancy G. Christie and Sarah M. Dinham, University of Arizona ♦ "The Convergent and Discriminant Validity Between Two Theories of College Persistence," Maria B. Castaneda, Arizona State University-West Campus ♦ "Determinants of Persistence: The Inclusion and Testing of Agility to Pay in Tinto's Model of Student Attrition," Alberto I. Cabrera and Maria B. Castaneda, Arizona State University-West Campus; Amaury Nora, University of Illinois-Chicago; and Dennis Hengstler, University of Houston ♦ "The Dynamics of Student Departure: Event History Analysis as a Methodological Breakthrough," Jennifer O'Day, Stanford University ♦  
**Discussant:** Frances Stage, Indiana University  
**ROOM: WASHINGTON**

**IIIE. GRADUATE STUDENT SESSION: Career Paths in Higher Education**

**Chair:** Melissa Anderson, University of Minnesota  
**Participants:** Roger Baldwin, College of William and Mary ♦ Shirley Clark, Oregon State System of Higher Education ♦ Barbara Townsend, Loyola University of Chicago ♦ Joan Stark, University of Michigan  
**ROOM: CROWN ZELLERBACH**

4:30 pm to 5:45 pm **CONCURRENT SESSIONS IV****IVA. Distinguished Symposium: The Feminist Perspective and the Study of Higher Education**

**Presenters:** Barbara K. Townsend, Loyola University of Chicago ♦ Judith S. Glazer, Long Island University ♦ Frances Stage, Indiana University ♦ Estela Bensimon, Pennsylvania State University  
**ROOM: MULTNOMAH**

**THURSDAY, NOVEMBER 1 (CONTINUED)****IVB. Paper Presentation: Faculty Research and Publication**

**Chair:** Marilyn Arney, University of Kansas  
**Presenters:** "Relationship of Faculty Publication Performance with Age, Career Age, and Rank," Richard Bentley and Robert T. Blackburn, University of Michigan ♦ "Faculty Knowledge Production: Dimensions of Quality," Jeffrey Bieber, College of William and Mary; and Robert T. Blackburn and Diana DeVries, University of Michigan ♦ "How Department Chairpersons Enhance the Research Careers of Faculty," John W. Creswell, University of Nebraska-Lincoln, and Martha Brown, Creighton University  
**Discussant:** Robert Silverman, Ohio State University  
**ROOM: CLACKAMAS**

**IVC. Symposium: Universities and Industry: Evaluating the New Partnership**

**Presenters:** Roger L. Geiger, Pennsylvania State University ♦ Gary Matkin, University of California-Berkeley ♦ Gary Rhoades and Sheila Slaughter, University of Arizona ♦ David Dill, University of North Carolina, Chapel Hill  
**ROOM: CLARK**

**IVD. Symposium: The Academic Origins of Recent Doctorate Recipients: Current Research and Its Implications for Higher Education and the U.S. Economy**

**Presenters:** E. Stephen Hunt, U.S. Department of Education ♦ Carol H. Fuller, Independent Colleges Office ♦ Susan T. Hill, National Science Foundation ♦ David Davis-Van Atta, Howard Hughes Medical Institute  
**ROOM: WASHINGTON**

★ 5:45 pm to 6:30 pm **MULTI CULTURAL FORUM**  
**ROOM: CROWN ZELLERBACH**

★ 6:30 pm to 7:30 pm **OPENING RECEPTION:**  
 Hosted by Newcomers and Graduate Students  
**ROOM: RED LION BALLROOM - EAST**

7:00 pm to 8:00 pm **RHE Editorial Board**  
**ROOM: WHITE STAG**

**FRIDAY, NOVEMBER 2, 1990**

7:00 am to 6:00pm **REGISTRATION**  
**ROOM: PENDLETON**

★ 7:00 am to 8:15 am **WELCOME BREAKFAST** - *Dissertation Dinner*  
**ROOM: RED LION BALLROOM - EAST** - *Boston Program*

8:30 am to 9:45 am **KEYNOTE SPEAKER**  
**ROOM: RED LION BALLROOM - WEST**



**KENNETH P. MORTIMER**  
 President, Western Washington University  
**ADMINISTRATIVE REALITIES AND POLICY RESEARCH:  
 IS THERE A COMMON GROUND?**  
 James L. Ratcliff, presiding

**FRIDAY, NOVEMBER 2 (CONTINUED)**10:00 am to 11:15 am **CONCURRENT SESSIONS V****VA. GRADUATE STUDENT SESSION: Broadening the Scope and Usefulness of Research in Higher Education**

**Chair:** Georgia Coopersmith, Syracuse University  
**Presenters:** Michael T. Nettles, University of Tennessee ♦ George Keller, University of Pennsylvania ♦ James L. Ratcliff, Pennsylvania State University ♦ Daryl G. Smith, Claremont Graduate School ♦ Monique Claque, University of Maryland ♦ Burton Clark, UCLA ♦ Larry Ebbers, Iowa State University ♦ Sheila Slaughter, University of Arizona  
**ROOM: MULTNOMAH**

**VB. Symposium: Defining the Community College Transfer Student, Transfer Rates, Data Sets**

**Presenters:** Daniel J. Phelan, Johnson County Community College ♦ Clifford Adelman, U.S. Department of Education ♦ Judith S. Eaton, American Council on Education ♦ Debra L. Banks, Educational Consultant  
**Reactor:** Deborah M. DiCroce, Piedmont Virginia Community College  
**ROOM: CLACKAMAS**

**VC. Paper Presentation: Economic Partnership**

**Chair:** Patricia Crosson, University of Massachusetts  
**Presenters:** "Commercializing the University: The Practical Consequences of Overturning University Traditions," Gary W. Matkin, University of California-Berkeley ♦ "The Decline of Competition: Cooperative Approaches to University Research Management," Barbara A. Holland, University of Maryland-College Park ♦ "Economic Development Initiatives Among Land-grant Colleges and Universities: Policy Change and Institutional Motivation," Lawrence S. Cole and Mary Kay Cole, Pennsylvania State University  
**Discussant:** James Fairweather, Pennsylvania State University  
**ROOM: CLARK**

**VD. Distinguished Symposium: Tenure and Academic Freedom: New Threats and Challenges**

**Presenters:** Steven G. Olswang, University of Washington ♦ Barbara A. Lee, Rutgers University ♦ Robert M. Hendrickson, Pennsylvania State University  
**ROOM: WASHINGTON**

**VE. SPECIAL TOPIC: The Community College Promise of Access and Opportunity Represents More Fact than Fiction**

**Convenor:** Laura Rendon, North Carolina State University  
**ROOM: CROWN ZELLERBACH**

11:30 am to 12:45 pm **CONCURRENT SESSIONS VI****VIA. Paper Presentation: Analyzing Cultures and Anarchies**

**Chair:** Elizabeth Whitt, Iowa State University  
**Presenters:** "Negotiating in an Anarchy: Faculty Bargaining and Organizational Cognition," Robert Birnbaum, University of Maryland-College Park ♦ "The Influences of Faculty Versus Administrative Organizational Perceptions on Faculty Motivation and Involvement," Marvin W. Peterson and Theodore H. White, University of Michigan ♦ "The Implementation of State Mandated Program Review: A Case Study of Governance and Decision-making in Community Colleges," Kenneth B. White, Pima Community College  
**Discussant:** Yvonna Lincoln, Vanderbilt University  
**ROOM: MULTNOMAH**

**FRIDAY, NOVEMBER 2 (CONTINUED)****VIB. Paper Presentation: Fund Raising and Fiscal Policy**

**Chair:** Richard Chait, University of Maryland-College Park  
**Presenters:** "On the Transformation of an Administrative Occupation: Professional Process and University Fund Raising," Harland G. Bioland, University of Miami, and Rita Bornstein, Rollins College ♦ "Green Carrots: A Survey of State Use of Fiscal Incentives for Academic Quality," Barbara A. Holland and Robert O. Berdahl, University of Maryland-College Park ♦ "Testing Conventional Wisdom of Fund Raising Effectiveness in Higher Education Institutions," Margaret A. Duronio and Bruce A. Loessin, University of Pittsburgh  
**Discussant:** Larry L. Leslie, University of Arizona  
**ROOM: CLACKAMAS**

**VIC. Distinguished Symposium: Emerging Trends in University Research: Deconcentration and Privatization**

**Presenters:** Roger L. Geiger, Pennsylvania State University ♦ Hugh Davis Graham, University of Maryland-Baltimore County ♦ Jennifer Krohn, Grinnell College ♦ Nancy Diamond, University of Maryland Graduate School-Baltimore  
**ROOM: CLARK**

**VID. FOCUSED DIALOGUE: Tenure and Academic Freedom**

**Convenor:** Steven G. Olswang, University of Washington  
**Discussant:** Walter Hobbs, SUNY-Buffalo  
**ROOM: WASHINGTON**

12:45 pm to 1:30 pm **COMMITTEE MEETINGS**

**ROOM: MULTNOMAH** Curriculum Committee  
**ROOM: JANTZEN** Membership Committee  
**ROOM: CLACKAMAS** Multicultural Committee

**ASHE READERS ADVISORY BOARD****ROOM: WHITE STAG**1:30 pm to 2:45 pm **CONCURRENT SESSIONS VII****VIA. ERIC WORKSHOP FOR GRADUATE STUDENTS**

**Coordinator:** Jan Burt, ERIC Clearinghouse on Higher Education  
**(SIGN UP AT REGISTRATION DESK)**  
**ROOM: CLACKAMAS**

**VIB. Symposium: Research Administrators Can Use Effectively**

**Presenters:** Frederic Jacobs, American University ♦ Richard Chait, University of Maryland-College Park ♦ Arthur Levine, Institute for Educational Management  
**ROOM: CLARK**

**VIC. Symposium: Fund Raising in Higher Education - Some Ethical Issues**

**Presenters:** Thomas R. Pezzullo, University of Rhode Island ♦ Barbara E. Brittingham, University of Rhode Island ♦ Judy Diane Grace, Council for Advancement and Support of Education  
**ROOM: MULTNOMAH**

**VID. FOCUSED DIALOGUE: Emerging Trends in University Relations: Deconcentration and Privatization**

**Convenor:** Roger Geiger, Pennsylvania State University  
**Discussant:** Les Goodchild, University of Denver  
**ROOM: WASHINGTON**

**VIII. FOCUSED DIALOGUE: Statewide Education Issues: Toward More Effective Research**

**Facilitator:** Carol Floyd, Illinois State Board of Regents  
**ROOM: CROWN ZELLERBACH**

**FRIDAY, NOVEMBER 2 (CONTINUED)**3:00 pm to 4:15 pm **CONCURRENT SESSIONS VIII****VIIIA. Paper Presentation: Methodology and Theory**

**Chair:** Patricia Gumpert, Stanford University  
**Presenters:** "Paradigms of Theory in Higher Education," John H. Milam, Jr., West Virginia University ♦ "A Comparison of Qualitative and Quantitative Measures of Academic Culture: Do They Tell Us the Same Thing?" Marvin W. Peterson, Melinda G. Spencer, University of Michigan ♦ "Phenomenological Inquiry and Higher Education Research," Louis C. Attinasi, Jr., University of Houston  
**Discussant:** William Tierney, Pennsylvania State University  
**ROOM:** MULTNOMAH

**VIIIB. Paper Presentation: After the Party's Over: Post-Graduation Environments**

**Chair:** Mildred Garcia, Montclair State University  
**Presenters:** "An Assessment of the Perceived Utility of Various College Majors," Steven W. Graham, Irv Cockriel, University of Missouri ♦ "Structural Discontinuities in the Transition from College to Work," H. Bradley Sagen, Mary Peterson, University of Iowa, Gayle Lundak, Augustana College ♦ "THE NLS Women at Thirty-something: Paradoxes of Attainment," Clifford Adelman, Office of Research - U.S. Department of Education  
**Discussant:** Robert Pace, UCLA  
**ROOM:** CLACKAMAS

**VIIIC. Symposium: National Faculty Database: Opportunities, Issues, and Problems**

**Presenters:** Jay L. Chronister, University of Virginia ♦ Robert T. Blackburn, University of Michigan ♦ Martha Brown, Creighton University ♦ John W. Creswell, University of Nebraska-Lincoln ♦ Susan H. Russell, SRI International  
**ROOM:** CLARK

**VIIID. Symposium: Feldman and Newcomb's Impact of College on Students: A Retrospective Review**

**Presenters:** David S. Webster, Oklahoma State University ♦ Patrick Terenzini, Pennsylvania State University ♦ Emily Dial-Driver, Rogers State College ♦ Clifton Warren, Central State University ♦ Kenneth Feldman, SUNY-Stony Brook  
**Discussant:** Ernest Pascarella, University of Illinois-Chicago  
**ROOM:** WASHINGTON

**VIIIE. FOCUSED DIALOGUE: Fund Raising in Higher Education - Some Ethical Questions**

**Facilitator:** Marsha Krotzeng, University of Hartford  
**ROOM:** CROWN ZELLERBACH

4:30 pm to 5:30 pm **BUSINESS MEETING AND AWARDS**

5-6 **TASK FORCE**  
**ROOM:** RED LION BALLROOM - WEST

5:45 pm to 7:00 pm **ASHE BASH****ROOM:** CLARK & WASHINGTON**SATURDAY, NOVEMBER 3, 1990**7-8<sup>13</sup> **hangover**  
7:00 am to 8:00 pm **REGISTRATION****ROOM:** PENDLETON8-9<sup>13</sup> **Bl. Crown Zellerbach**  
8:30 am to 9:45 pm **KEYNOTE SPEAKER****ROOM:** MULTNOMAH & CLACKAMAS

**JUDITH A. RAMALEY**  
 President, Portland State University  
 Shirley Clark, Presiding

**SATURDAY, NOVEMBER 3 (CONTINUED)**10:00 am to 11:45 am **ANTICIPATING THE FUTURE OF HIGHER EDUCATION**

**Coordinator:** James Morrison, UNC-Chapel Hill  
**Presiding:** Jonathan D. Fife, George Washington University  
**ROOM:** MULTNOMAH & CLACKAMUS

12:30 pm to 1:45 pm **TOWN MEETING**

**Hosts:** Ernest Pascarella, University of Illinois-Chicago ♦ Judith Hackman, Yale University ♦ Ellen Earle Chaffee, North Dakota University System  
**Convenor:** Cameron Fincher, University of Georgia  
**ROOM:** CLARK & WASHINGTON

2:00 pm to 3:15 pm **CONCURRENT SESSIONS IX****IXA. Paper Presentation: Issues of Equity**

**Chair:** Bobby Wright, Pennsylvania State University  
**Presenters:** "Institutional Responses to African American Students: The Impact on Faculty at Predominantly White Colleges and Universities," Martha L.A. Stassen, Gerald Gurin, Cheryl L. Presley, University of Michigan ♦ "After the Money is Gone: Organizational Consequences of State Incentives to Improve Minority Student Recruitment and Retention," Susan M. Studds, George Mason University ♦ "Factors Related to Academic Outcomes of Minorities in Doctoral Programs," Madeline J. Williamson, Arizona State University  
**Discussant:** Michael Olivas, University of Houston Law School  
**ROOM:** MULTNOMAH

**IXB. Distinguished Symposium: Hidden Voices in Higher Education**

**Presenters:** William Tierney, Pennsylvania State University ♦ Patricia Gumpert, Stanford University ♦ Sheila Slaughter, Gary Rhoades, University of Arizona  
**ROOM:** CLACKAMUS

**IXC. Symposium: African-Americans and Native Americans in Higher Education: Academic Achievement Determinants**

**Presenters:** Carolyn J. Thompson, University of Oklahoma ♦ James E. Davis, University of Delaware ♦ Kofi Lomotey, SUNY-Buffalo ♦ Garry L. Rolison, University of Oklahoma ♦ Cornel D. Peweardy, University of Oklahoma  
**ROOM:** CROWN ZELLERBACH

**IXD. Symposium: Linking Social and Academic Integration to Persistence: A Longitudinal Study of Freshmen**

**Presenters:** Peter Gray, Barbara Baker, Robert Froh, Vincent Tinto, Peter Baigent, Barbara Yonai, Syracuse University  
**ROOM:** WEYERHAEUSER

3:30 pm to 4:45 pm **PRESIDENTIAL ADDRESS****ROOM:** MULTNOMAH & CLACKAMUS

Ernest Pascarella, University of Illinois-Chicago, *Impact of College on Students Revisited: Some Observations on the Nature of the Evidence*

5:00 pm to 6:15 pm **CONCURRENT SESSIONS X****IXA. Symposium: The Seamless Web: Fostering Minority Doctoral Success Through the Academic Pipeline**

**Presenters:** Madeline J. Williamson, Robert H. Fenske, Louis Olivas, Brian L. Foster, Arizona State University ♦ Michael T. Nettles, University of Tennessee ♦ John W. Tippeconic, U.S. Department of Education  
**ROOM:** WEYERHAEUSER



**SATURDAY, NOVEMBER 3 (CONTINUED)****XB. Symposium: Mentoring Between Academic Women**

**Convenor:** Linda K. Johnsrud, University of Hawaii  
**Presenters:** Kathryn Moore, Michigan State University ♦ Janet Lawrence, University of Michigan ♦ Ann E. Austin, Vanderbilt University ♦ Palisa Williams, Indiana University  
**ROOM:** CROWN ZELLERBACH

**XC. Symposium: Strategic Planning Councils: Their Evolution and Effectiveness**

**Presenters:** Jack H. Schuster, Claremont Graduate School ♦ Myrtle M. Yamada, University of Hawaii ♦ Kathleen A. Corak ♦ Daryl G. Smith, Claremont Graduate School  
**Reactor:** George Keller, University of Pennsylvania  
**ROOM:** MULTNOMAH

**XD. FOCUSED DIALOGUE: Hidden Voices in Higher Education**

**Convenor/Discussant:** Robert Silverman, Ohio State University  
**ROOM:** WHITE STAG

**XE. FOCUSED DIALOGUE: Canonical Concepts: Origin, Development, Dissemination, Use: Their Construction and Maintenance**

**Facilitators:** Robert Silverman, Ohio State University ♦ Patricia Gumpert, Stanford University ♦ Jeffrey Cinnamon, Indiana University of Pennsylvania  
**ROOM:** JANTZEN

6:30 pm to 9:00 pm **DINNER AT THE WORLD FORESTRY CENTER**

**BUSES BEGIN LEAVING HOTEL AT 6:30 FROM LOBBY**

**SUNDAY, NOVEMBER 4, 1990**

8:00 am to 10:00 am **ASHE BOARD MEETING**  
**ROOM:** JANTZEN

9:00 am to 10:15 am **CONCURRENT SESSIONS XI**

**XIA. Paper Presentation: Faculty Satisfaction and Stress**

**Chair:** Carolyn Thompson, University of Oklahoma  
**Presenters:** "An Examination of Disciplinary Difference in Factors Related to Job Satisfaction Among Liberal Arts College Faculty Members," John E. Neal, Webster University ♦ "Work Satisfaction and Stress in the First Three Years of Academic Appointment," Deborah Olsen, Frances Stage, Indiana University -Bloomington ♦ "Dimensions of Faculty Stress: Evidence from a Recent National Survey," Eric L. Dey, Higher Education Research Institute-UCLA  
**Discussant:** Roger Baldwin, College of William and Mary  
**ROOM:** MULTNOMAH

**XIB. Symposium: Reexamining the Balance Between Teaching and Research in American Universities**

**Presenters:** Ann E. Austin, Vanderbilt University ♦ William Jackson, Ron Simpson, University of Georgia ♦ Kathryn Moore, Michigan State University ♦ Jack H. Schuster, Claremont Graduate School  
**ROOM:** WASHINGTON

**XIC. SPECIAL TOPIC: Perspectives on Proprietary Education**

**Facilitators:** John Lee, JBL Associates ♦ Richard Chait, University of Maryland ♦ David Goodwin, U.S. Department of Education ♦ Jamie Mertsotis, Consultant  
**ROOM:** CLACKAMAS

**SUNDAY, NOVEMBER 4 (CONTINUED)**

10:30 am to 11:45 pm **CONCURRENT SESSIONS XII**

**XIIA. Paper Presentation: The Doctoral Process**

**Chair:** Samuel Kellams, University of Virginia  
**Presenters:** "Administrative Perceptions of the Value and Content of Higher Education Doctorates," Barbara Townsend, Michael Wiese, Loyola University of Chicago ♦ "The Process of Professional Socialization in Higher Education," John C. Weidman, Elizabeth L. Stein, University of Pittsburgh ♦ "Faculty Perception of the Doctoral Dissertation," Paul D. Isaac, Stephen V. Quinlan, Mindy Walker, Ohio State University  
**Discussant:** Maresi Nerad, University of California-Berkeley  
**ROOM:** MULTNOMAH

**XIIB. Paper Presentation: Organizations and Their Environments**

**Chair:** Bruce Jones, University of Pittsburgh  
**Presenters:** "Test of a Model of Institutional Adaptation," Dwayne Matthews, Arizona State University ♦ "Resource Dependencies and Organizational Demography: A Study of Academic Departments," Melissa S. Anderson, University of Minnesota ♦ "Alternative Theoretical Approaches to the College Environment," Leonard L. Batrel, University of Kentucky  
**Discussant:** James Bess, New York University  
**ROOM:** CLACKAMAS

**XIIC. Paper Presentation: Faculty Issues**

**Chair:** Carol Floyd, Illinois Board of Regents  
**Presenters:** "Supporting the Professor as Teacher: An Evaluation Study of the Lilly Teaching Fellows Program," Ann E. Austin, Vanderbilt University ♦ "Predicting Faculty Teaching Behaviors: Testing of a Theoretical Model of Motivation," Janet H. Lawrence, University of Michigan ♦ "Faculty Socialization: A Strategy Abating Faculty Shortages," Cynthia L. Orczyk, Purdue University ♦ "Faculty Inbreeding Among Contemporary American University Professors," D. Barry Lumsden, G. Bryan Stewart, Linda Linn, University of North Texas  
**Discussant:** John Creswell, University of Nebraska  
**ROOM:** CLARK

**XIID. Symposium: Captow and McGee's *The Academic Marketplace: A Retrospective Review a Generation After Publication***

**Chair:** John Gardner, Oklahoma State University  
**Presenters:** David S. Webster, Oklahoma State University ♦ Roger G. Baldwin, College of William and Mary ♦ Dolores Burke, Duke University ♦ Reece McGee, Purdue University ♦ Jack Schuster, Claremont Graduate School  
**ROOM:** WASHINGTON



# 1990 PROGRAM REVIEWERS/READERS

## Papers

Marilyn Arney  
Louis Attinasi  
Leonard Baird  
John Bean  
Estela Bensimon  
James Bess  
Robert Birnbaum  
Robert Blackburn  
Carol Boyer  
John Braxton  
Ellen Brier  
Paul Brinkman  
Alberto Cabrera  
John Centra  
Darrell Clowes  
Clifton Conrad  
Thomas Dyer  
Corinna Ethington  
Kenneth Feldman  
Dorothy Finnegan  
Joni Finney  
Carol Floyd  
Mildred Garcia  
Rodolfo Garcia Z.  
Roger Geiger  
Les Goodchild  
Carolyn Griswold  
Patricia Gumpert  
David Guthrie  
Craig Heller  
Bob Hendrickson  
Donald Hossler  
Bruce Jones

George Keller  
Ken Kempner  
Cynthia King  
Patricia King  
Marsha Krotseng  
George Kuh  
Yvonna Lincoln  
Michael Mills  
Kay Moore  
Ann Morey  
Maresi Nerad  
Michael Nettles  
Anna Neumann  
Amaury Nora  
Michael Olivas  
Marvin Peterson  
Jennifer Presley  
Laura Rendon  
Pedro Reyes  
Robert Rhoades  
Mary Ann Sagaria  
Sheila Slaughter  
John Smart  
Daryl Smith  
Betty Taylor  
Jim Trainer  
Caroline Turner  
Susan Twombly  
J. Fredericks Volkwein  
Valora Washington  
John Weidman  
Bobby Wright  
Ted Youn

## Symposia

Johnetta Brazzell  
Roger Baldwin  
Stan Carpenter  
May Chen  
Jay Chronister  
Shirley Clark  
John Creswell  
Richard Durand  
Carol Floyd  
John Gardiner  
Les Goodchild  
Adrienne Hyle  
Vernon Johnson  
Bruce Jones  
Steve Katsinas

Marsha Krotseng  
George Kuh  
David Leslie  
Cheryl Lovell  
Jan Lyddon  
Michael Mills  
Kay Moore  
William Moore  
Patricia Murrell  
Maresi Nerad  
Amaury Nora  
Steven Olswang  
Laura Rendon  
Gary Rhoades  
Daryl Smith

## **Dissertation of the Year Winners**

**1989-90**

**Recipient: Roger L. Williams**

**UMI Order No.: (not available)**

**Title: "George W. Atherton and the Beginnings of Federal Support for Higher Education"**

**1988-89**

**Recipient: Patricia Gumport**

**UMI Order No.: (not available)**

**Title: "The Social Construction of Knowledge: Individual and Institutional Commitments to Feminist Scholarship"**

**1987-88**

**Recipient: Dolores L. Burke**

**UMI Order No.: DA 871 1086**

**Title: "Change in the Academic Marketplace: A Study of Faculty Mobility in the 1980's"**

**1986-87**

**Recipient: Irvin Lee Wright**

**UMI Order No.: DA 860 7966**

**Title: "Piety, Politics and Profit: American Indian Missions in the Colonial Colleges"**

**Runner Up: Lester F. Goodchild**

**UMI Order No.: (not available)**

**Title: "The Mission of the Catholic University in the Midwest 1842-1980"**

**1985-86**

**Recipient: Janet Kerr-Tener**

**UMI Order No.: AAD85-26903**

**Title: "From Truman to Johnson: *Ad hoc* Policy Formulation in Higher Ed."**

**Runner Up: Amaury Nora**

**UMI Order No.: AAD85-27875**

**Title: "Determinants of Retention Among Chicano College Students: A Structural Model"**

**Runner Up: Charlotte Hanna**

**UMI Order No.: AAD86-002480**

**Title: "Modest Expectations: Qualitative and Quantitative Analysis of Faculty Affirmative Action"**

**1984-85**

**Recipient: Lois A. Fisher**

**UMI Order No.: DAI 45/08-A**

**Title: "State Universities and the Autonomy of Colleges and Universities: A Comparative Study of Legislation in Four States 1900-79"**

**Runner Up: Bernard Reams**

**UMI Order No.: AAD85-16700**

**Title: "Research Interactions Between Industry and Higher Education"**

**Runner Up: Marta Wagner**

**UMI Order No.: AAD84-16425**

**Title: "The American Scholar in the Early National Period: The Changing Context of Colonial Education"**

**1983-84**

**Recipient: Jeffery Bartkovich**

**UMI Order No.: AAD84-16425**

**Title: "Designing an Empirically Derived Taxonomy of Organization Structures in Higher Education"**

**Runner Up: Constance Collins**

**UMI Order NO.: AAD84-26621**

**Title: "Loose Coupling as a Framework for Understanding Structural Change: Case Studies of Four American Colleges and Universities"**

**Runner Up: Edward Ottensmeyer III**

**UMI Order No.: AAD83-08871**

**Title: "Strategic Organizational Adaptation and the Regulatory Environment: A Study of Universities During a Time of Regulatory Change"**

**1982-83**

**Recipient: Catherine Marienau**

**UMI Order No.: AAD82-21310**

**Title:** "Bridging Theory and Practice in Adult Development and Planned Change"

**Runner Up: Jerry Wayne Askew**

**UMI Order No.: AAD83-00202**

**Title:** "Toward a Theory on the Impact of Budget Retrenchment in Educational Organizations"

**Runner Up: Ellen Metzner Ironside**

**UMI Order No.: AAD82-22864**

**Title:** "Career Paths of Women Administrators in Higher Education"

**1981-82**

**Recipient: Ellen Chaffee**

**UMI Order No.: AAD81-08902**

**Title:** "Decision Models in Budgeting"

**Runner Up: Ted Youn**

**UMI Order No.: AAD81-25677**

**Title:** "The Careers of Young Ph.D's: Temporal Change and Institutional Effects"

**Runner Up: Joyce Mushaben**

**UMI Order No.: AAD81-1903**

**Title:** "The State vs. the University: Juridicalization and the Politics of Higher Education at the Free University of Berlin: 1969-79"

**1980-81**

**Recipient: Paul Duby**

**UMI Order No.: DAI 41/07A**

**Title:** "An Investigation of the Mediating Role of Causal Attitudes in School Learning"

**Runner Up: James Henson**

**UMI Order No.: AAD80-15983**

**Title:** "Institutional Excellence and Student Achievement: A Study of College Quality and Its Impact on Education and Career Development"

**1979-80**

**Recipient: Kenneth Bradley Orr**

**UMI Order No.: AAD78-13714**

**Title:** "The Impact of the Depression Years 1929-39 on Faculty in American Colleges and Universities"

**Runner Up: Daniel Carl Levy**

**UMI Order No.: AAD78-10475**

**Title:** "University Autonomy vs. Government Control: The Mexican Case"

**AWARD WINNERS**

The following is a list of award recipients since 1985, the year the committee was officially recognized:

**1985**

Distinguished Career: Howard Bowen

Research Achievement: Burton Clark

**1986**

Distinguished Career: David Riesman

**1987 (February)**

Distinguished Career: Lewis Mayhew and Joseph Kauffman

Research Achievement: Alexander Astin

**1987 (November)**

ASHE Service Award: Jonathan Fife

**1988**

Distinguished Career: Robert Blackburn

Research Achievement: Howard Bowan

**1989**

Distinguished Career: Mary Corcoran and Robert Pace

Research Achievement: Jack Schuster

Promising Scholar: Ann Austin

**Past Presidents of the Association:**

- C. Robert Pace** 1976-77
- Kenneth P. Mortimer** 1977-78
- Robert O. Berdahl** 1978-79
- Burton R. Clark** 1979-80
- Howard R. Bowen** 1980-81
- Joseph F. Kauffman** 1981-82
- Marvin W. Peterson** 1982-83
- Kathryn M. Moore** 1983-84
- Joan S. Stark** 1984-85
- Robert Birnbaum** 1985-86
- David W. Leslie** 1986-87
- Clifton Conrad** 1987-88
- Ellen Earle Chaffee** 1988-89
- Ernest T. Pascarella** 1989-1990

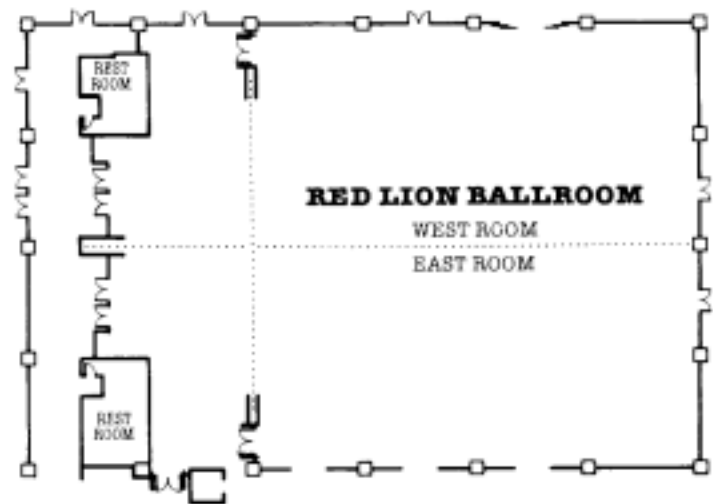
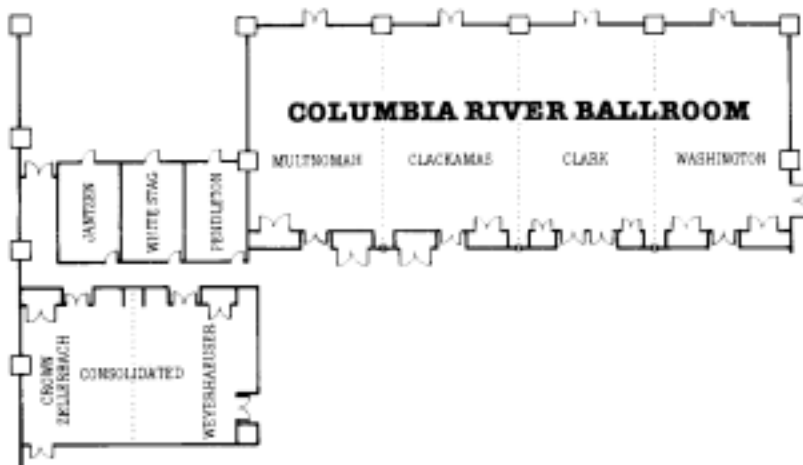

**CONFERENCE ROOMS**

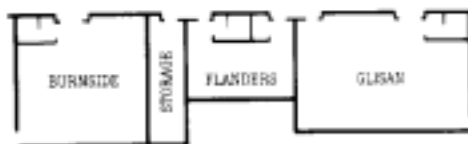

MT. BACHELOR WING



MT. ST. HELENS WING



**RED LION Inn.**  
JANTZEN BEACH