

# CIRCLE CITY CONVERGENCE

ARLIS/NA 37

ART LIBRARIES SOCIETY  
OF NORTH AMERICA



## CONFERENCE PROGRAM

Indianapolis Marriott Downtown > Indianapolis, Indiana > April 16 to April 21, 2009

# RICHARD MINSKY

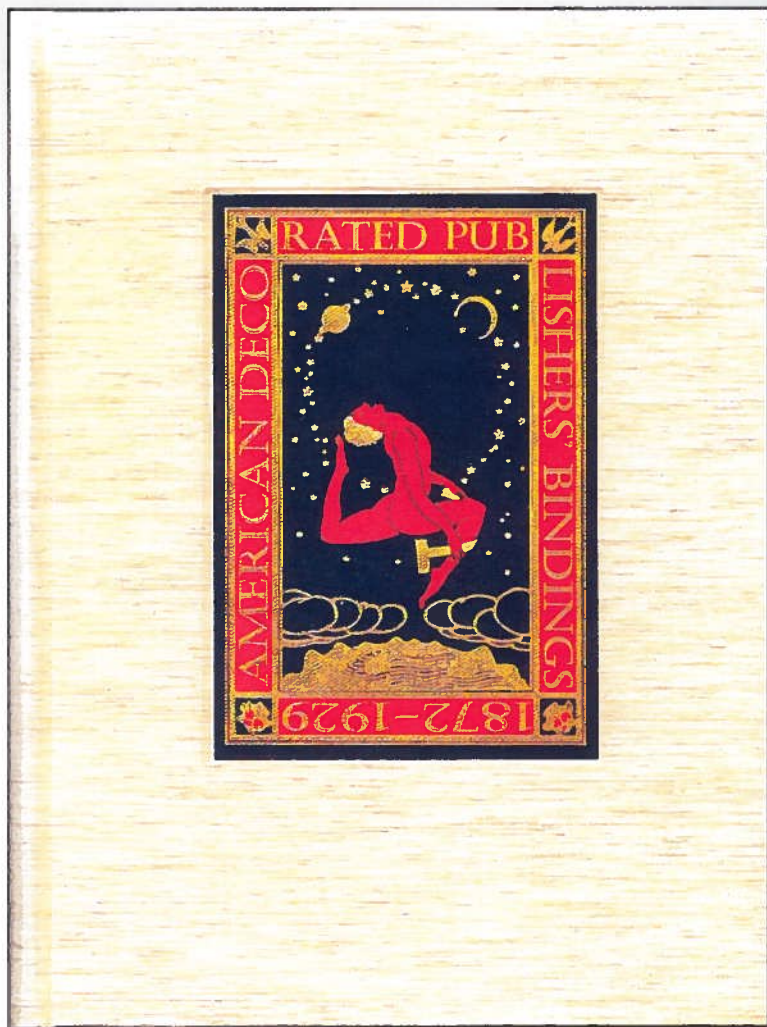

CATALOG OF THE SECOND EXHIBITION OF  
AMERICAN DECORATED PUBLISHERS' BINDINGS  
1872-1929

PUBLISHED MARCH 2009

AVAILABLE IN DELUXE (ABOVE), LIMITED AND CD-ROM EDITIONS

THIS EXHIBITION OF 300 DESIGNS HAS BEEN ACQUIRED IN ITS ENTIRETY BY  
THE LILLY LIBRARY OF INDIANA UNIVERSITY, BLOOMINGTON

**minsky.com**

VISIT OUR GALLERY IN HUDSON, NEW YORK, 30 MILES SOUTH OF ALBANY  
RICHARD IS AT THE ARLIS CONFERENCE. PHONE 516.729.9227 TO MEET.

## TABLE OF CONTENTS

**2**

WELCOME FROM  
THE PRESIDENT

**3**

WELCOME FROM  
THE CONFERENCE  
CO-CHAIRS

**4**

CONFERENCE  
PLANNING  
COMMITTEE

**5**

ARLIS/NA  
EXECUTIVE BOARD  
2008/09

**6**

SPONSORS/  
DONORS

**8**

EXHIBITORS

**10**

GENERAL  
INFORMATION

**12**

INDIANAPOLIS  
MAP

**15**

SPECIAL  
EVENTS

**20**

MEETING FINDER  
(LISTED ALPHABETICALLY)

**22**

MEETING FINDER  
(LISTED BY DATE  
AND BY TIME)

**24**

CONFERENCE EVENTS  
AT A GLANCE

**26**

PROGRAM  
SCHEDULE

**58**

INDIANAPOLIS MARRIOTT  
FLOOR PLANS

**59**

NOTES

## WELCOME FROM THE PRESIDENT

The Art Libraries Society of North America 37<sup>th</sup> Annual Conference will be held in Indianapolis, IN, Thursday, April 16 - Tuesday, April 21, 2009. Our venue will be the comfortable, and very convenient, Downtown Indianapolis Marriott.

In Indianapolis, we will continue and build on many of the innovative features of the Denver conference. In addition to a full slate of activities at our hotel, we will take advantage of the Indianapolis Cultural Trail to highlight community, technology, public art, and urban revitalization.

Our Convocation will be Friday, April 17<sup>th</sup> at the conference Hotel with speaker Max Anderson, Melvin & Bren Simon Director and CEO of the Indianapolis Museum of Art. Following that, we will all adjourn to the nearby Eiteljorg Museum for our Welcome Party. The Eiteljorg Museum of American Indians and Western Art is a showcase for Native American art and heritage located on Indy's beautiful White River Parkway. The Museum galleries and the shop will stay open for us until 10:00 p.m.

The stunning new incarnation of the Indianapolis Museum of Art will be the setting for our Circle City Celebration on Sunday, April 19<sup>th</sup>. The first floor galleries, special exhibition, and shop will be open for us to enjoy from 6:00 - 9:00pm

James Neal, Vice President for Information Services and University Librarian, Columbia University, will be our opening Plenary speaker on Saturday, April 18<sup>th</sup>. Central Indiana Community Foundation and Indianapolis Foundation President Brian Payne, the urban visionary who helped create the 7.5 mile Indianapolis Cultural Trail greenway, will be our closing plenary speaker on Monday, April 20<sup>th</sup>.

Sessions will be offered that are guaranteed to get your Web 2.0 engines humming, your resources streamlined, your social networking moving in the fast lane, and your services working like an Indy 500 pit crew.

Workshops will take advantage of the close proximity of so many cultural and academic venues, including a focus on Book Arts and Artists Books and new technology.

Tours will emphasize Indy's unique conjunction of art, sport, and history and culture, and will highlight some very special near-by attractions: Columbus, IN — a mecca for modern architecture with over 70 buildings by major 20<sup>th</sup> and 21<sup>st</sup> century architects; and Bloomington, IN — with the Kinsey Institute, the Lilly Library, the Benton Murals, and the I.M. Pei designed Indiana University Art Museum and Fine Arts Library.

Indianapolis will surprise and delight you. So join us as we Segway down the Parkway, circle the Monument, and rev up to **stART our Engines at IndyCon 2009**.

Sincerely,

Kenneth Soehner  
President, ARLIS/NA

## WELCOME FROM THE CONFERENCE CO-CHAIRS



On behalf of the ARLIS/Midstates Chapter, we would like to extend a heartfelt and enthusiastic welcome to our Circle City Convergence, the 37<sup>th</sup> Annual Conference of ARLIS/NA, in Indianapolis, Indiana. Despite tough economic circumstances, our Conference Planning Committee has worked very hard to provide a full slate of challenging, cutting-edge sessions and workshops, a variety of exciting tours and activities, and social events we hope will bring us all together and strengthen the bonds between us.

Come prepared to be enlightened, surprised, and entertained. Also come prepared for unpredictable weather. Indianapolis in Spring can be delightful, but you never know....

Alba Fernández-Keys and Sonja Staum  
*Local Arrangements Co-chairs*

Eileen Fry and Tony White  
*Program Co-chairs*

# CONFERENCE PLANNING COMMITTEE

## LOCAL ARRANGEMENTS CO-CHAIRS

**Alba Fernández-Keys**  
afernandez-keys@imamuseum.org

**Sonja Staum**  
sstaumku@iupui.edu

## PROGRAM CO-CHAIRS

**Eileen Fry**  
fryp@indiana.edu

**Tony White**  
antmwhit@indiana.edu

## WORKSHOP COORDINATOR

**Marc Gartler**  
mgartler@harringtoncollege.com

## REGISTRATION/HOSPITALITY DESK COORDINATORS

**Rijn Templeton**  
rijn-templeton@uiowa.edu

**Kathleen Lonbom**  
klonbom@ilstu.edu

## CONFERENCE MANAGER

**Susan Rawlyk**  
arlisna@mcphersonclarke.com

## BUDGET COORDINATOR

**Lyn Korenic**  
lkorenic@library.wisc.edu

## EXHIBITS COORDINATORS

**Kitty Jansen**  
kjansen@eiteljorg.com

**Shelley Quattrocchi**

## LOCAL DEVELOPMENT COORDINATOR

**Sonja Staum**  
sstaumku@iupui.edu

## RESTAURANT/ LOCAL GUIDE

**Alba Fernández-Keys**  
afernandez-keys@imamuseum.org

**Marsha Stevenson**  
stevenson.2@nd.edu

## PROCEEDINGS

**Terrie Wilson**  
wilso398@msu.edu

## PUBLICITY

**Annette Haines**  
ahaines@umich.edu

**Rebecca Price**  
rpw@umich.edu

## RAFFLE/SILENT AUCTION COORDINATORS

**Amy Trendler**  
aetrendler@bsu.edu

**Anna Proctor**  
annalysproctor@yahoo.com

## SPECIAL EVENTS COORDINATORS

**Sonja Staum**  
sstaumku@iupui.edu

**Leigh Gates**  
lgates@artic.edu

## TOURS

**Jennifer Hehman**  
jhehman@iupui.edu

**Marsha Stevenson**  
stevenson.2@nd.edu

## WEB, GRAPHICS, TECHNOLOGY

**Nicole Beatty (webmaster)**  
nabeatty@indiana.edu

**Erika Dowell (designer)**  
edowell@indiana.edu

**Laura Haxer (blog)**  
LHaxer@HarringtonCollege.com

**Jessica Bozeman (blog)**  
jbozeman@indiana.edu

**Eileen Fry (scheduler and technology)**  
fryp@indiana.edu

**Aaron Steele (technology)**  
asteel@imamuseum.org

# ARLIS/NA EXECUTIVE BOARD 2008/09

## PRESIDENT

**Ken Soehner, President**  
ken.soehner@metmuseum.org

## VICE-PRESIDENT/PRESIDENT ELECT

**Amy Lucker**  
amy.lucker@nyu.edu

## PAST PRESIDENT

**Deborah K. Ultan Boudewyns**  
ultan004@umn.edu

## SECRETARY

**Rebecca Price**  
rpw@umich.edu

## TREASURER

**Edward (Ted) Goodman**  
goodman@columbia.edu

## CANADIAN MEMBER-AT-LARGE

**Liv Valmestad**  
liv\_valmestad@umanitoba.ca

## CHAPTERS LIAISON

**Cate Cooney**  
catecooney@gmail.com

## COMMUNICATIONS & PUBLICATIONS LIAISON

**Barbara C. Rominski**  
brominski@sfrmona.edu

## DEVELOPMENT & MEMBERSHIP LIAISON

**Amy Trendler**  
aetrendler@bsu.edu

## EDUCATION LIAISON

**Elizabeth Schaub**  
eschaub@uts.cc.utexas.edu

# SPONSORS/DONORS

ARLIS/NA gratefully acknowledges the support and contributions of the following organizations and individuals:

## SOCIETY AFFILIATE GOLD SPONSORS

ARTstor

Eiteljorg Museum of American Indians and Western Art

Indianapolis Museum of Art

## SOCIETY AFFILIATE SILVER SPONSORS

AskART

F.A. Bennett Books

## SOCIETY AFFILIATE BRONZE SPONSORS

B.J. (Betty Jo) Irvine

ProQuest

Richard Minsky

Worldwide Books

## SOCIETY AFFILIATE SPONSORS

Erasmus

Herron School of Art and Design

J. Paul Getty Trust

## AWARD SPONSORS

AskART

Howard Karno Books, Inc.

H.W. Wilson Foundation

Puvill Libros

Worldwide Books



**Eiteljorg Museum**  
of American Indians and Western Art

Celebrating 20 Years

## OTHER SPONSORS AND DONORS

Anonymous Sponsor: Society Circle

ARLIS/Central Plains

ARLIS/DC-MD-VA Chapter

ARLIS/Delaware Valley

ARLIS/Midstates

ARLIS/Mountain West

ARLIS/New York Metropolitan

ARLIS/Northern California

ARLIS/Ohio Valley

ARLIS/Southeast

ARLIS/Southern California

ARLIS/Texas-Mexico

ARLIS/Twin Cities

Artprice

Casalini Libri

Duncan Systems Specialists, Inc

HARRASSOWITZ

Indiana University Library, Bloomington

IUPUI University Library

Indiana University Press

Michael Shamansky Bookseller Inc.

OCLC Online Computer Library Center, Inc.

OMI - Old Manuscripts & Incunabula

Pratt School of Information and Library Science

School of Library and Information Science, Indiana University

Swann Galleries

## The essential tool for art research



### AskART offers institutions:

- Your largest library for American art research PLUS evaluation tools for artists **WORLDWIDE**
- Provenance, literature, condition, and exhibition included where available for auction records
- Research tools such as bibliographical references, museum holdings, and exhibitions
- Pronunciation Guide, Audio guide to pronouncing difficult artist names
- Glossary of art terms, and essays on important art movements
- Signatures, artwork images and now larger and multiple images for select artworks
- Artists' biographies and more!

[www.askart.com](http://www.askart.com) • [academic@askart.com](mailto:academic@askart.com)



## SURVEYING THE FIRST DECADE



Video Art and Alternative Media in the U.S. 1968-1980

*Surveying the First Decade* includes more than 16 hours of historic video on one essential DVD anthology: 68 seminal titles by 60+ early video artists curated into programs ranging from conceptual, performance, feminist, and image processed works, to documentary and grassroots community-based genres. The 8-disc anthology is accompanied by *REWIND*, an in-depth guide featuring a curator's essay, title descriptions, bibliography, and artists' biographies.

For a complete list of artists and descriptions of programs and titles included in the anthology, please visit [www.vdb.org](http://www.vdb.org). To place an order, please contact us via email: [info@vdb.org](mailto:info@vdb.org), phone 312.345.3550, or fax: 312.541.8073.

**Price and Ordering Info:**  
Volumes 1 and 2 \$1500  
Volume 1 \$800  
Volume 2 \$800

**Shipping:**  
\$35 US; \$50 Canada  
Request a quote for overseas shipping.

Just released DVD Box Set and Monograph

Paul Chan's *Tin Drum Trilogy*, featuring 3 videos, contextualizing essays and artist commentary.

Mention discount code ARLIS2009 when placing your next VDB order to receive a 10% discount.



Video Data Bank

School of the Art Institute of Chicago  
112 S Michigan Ave  
Chicago, IL 60603

T 312.345.3550  
F 312.541.8073  
[info@vdb.org](mailto:info@vdb.org)  
[www.vdb.org](http://www.vdb.org)





# EXHIBITORS

We are pleased to welcome the following exhibitors to the 37<sup>th</sup> Annual ARLIS/NA Conference. This list represents exhibitors registered at the time of program printing. A complete list will be distributed to all conference attendees.

|  |                                    |
|--|------------------------------------|
| 21 <sup>ST</sup> Editions                                  | Howard Karno Books, Inc.           |
| ART CONSULTING: SCANDINAVIA<br>Books on Art & Architecture | H.W. Wilson                        |
| Archivision, Inc.  | Michael R. Weintraub, Inc.         |
| Ashgate Publishing Company                                 | Oxford University Press            |
| AskART   | ProQuest                           |
| Brill  | Puvill Libros                      |
| Casalini Libri   | R.A.M. Publications + Distribution |
| Davis Art Images   | Red Trillium Press                 |
| The Donohue Group, Inc.                                    | Scholar's Resource                 |
| Duncan Systems Specialists, Inc.                           | The Scholar's Choice               |
| Erasmus Boekhandel BV                                      | Vamp & Tramp Booksellers, LLC      |
| F.A. Bennett Books   | Video Data Bank                    |
| HARRASSOWITZ Booksellers &<br>Subscription Agents          | Worldwide Books                    |

YOU NEVER KNOW WHO'S GOING TO  
WALK THROUGH YOUR DOOR NEXT.



**DIVERSE USERS. DIVERSE NEEDS.**

From casual readers to serious researchers. From genealogists and entrepreneurs to scientists and medical professionals. From K-12 to Ph.D. and beyond. ProQuest has the breadth and depth of unique content blended with user-friendly technology to help you support lifelong paths of exploration and enlightenment. For more than 70 years, we have worked with you to anticipate and meet the needs of your users: a steady path of customer-centered innovation.

Because you never know who's going to walk through your door next, start here ... and continue moving forward with ProQuest.



[www.proquest.com/go/path](http://www.proquest.com/go/path)

New visual studies and fine art books  
from Ashgate and Lund Humphries...



**The Four Modes of Seeing**  
*Approaches to Medieval Imagery in Honor of Madeline Harrison Caviness*  
Edited by Evelyn Staudinger Lane, Elizabeth Carson Pastan and Ellen M. Shortell  
Includes 146 b&w illustrations  
Apr 2009. 610 pg. 978-0-7546-6010-1



**Re-framing Representations of Women**  
*Figuring, Fashioning, Portraiting and Telling in the 'Picturing' Women Project*  
Edited by Susan Shifrin  
Includes 109 color and 41 b&w illustrations and a CD  
Oct 2008. 354 pg. 978-0-7546-6077-4



**The Netherlandish Image after Iconoclasm, 1566-1672**  
*Material Religion in the Dutch Golden Age*  
Mia M. Mochizuki  
Includes 158 color and 61 b&w illustrations and 4 ground plans  
Nov 2008. 424 pg. 978-0-7546-6104-7



**The Idol in the Age of Art**  
*Objects, Devotions and the Early Modern World*  
Edited by Michael W. Cole and Rebecca Zorach  
*St. Andrews Studies in Reformation History*  
Includes 1 color and 96 b&w illustrations  
Feb 2009. 384 pg. 978-0-7546-5290-8



**Images of Children in Byzantium**  
Cecily Hennessy  
Includes 16 color and 57 b&w illustrations  
Dec 2008. 296 pg. 978-0-7546-5631-9



**American Prints from Hopper to Pollock**  
Stephen Coppel with the assistance of Jerzy Kierkuc-Bielinski  
Includes 25 color and 135 duotone illustrations  
Lund Humphries. Feb 2008. 272 pg. 978-0-85331-992-4



**The Avant-Garde Icon**  
*Russian Avant-Garde Art and the Icon Painting Tradition*  
Andrew Spira  
Includes 90 color and 40 b&w illustrations  
Lund Humphries. Oct 2008. 224 pg. 978-0-85331-975-7



**The Darker Side of Light**  
*Arts of Privacy, 1850-1900*  
Peter Parshall  
Includes 90 color illustrations  
Lund Humphries. Apr 2009. 192 pg. 978-1-84822-021-8

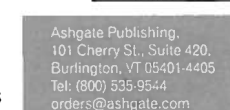

Ashgate Publishing,  
101 Cherry St., Suite 420,  
Burlington, VT 05401-4405  
Tel: (800) 535-9544  
orders@ashgate.com

**Re-Reading Leonardo**  
*The Treatise on Painting across Europe, 1550-1900*  
Edited by Claire Farago  
Includes 5 color and 170 b&w illustrations  
Mar 2009. 652 pg. 978-0-7546-6532-8

**George de Forest Brush**  
*The Indian Paintings*  
Nancy K. Anderson  
Includes 110 color and 25 b&w illustrations  
Lund Humphries. Sep 2008. 224 pg. 978-1-84822-006-5

**Art, Sex and Eugenics**  
*Corpus Delecti*  
Edited by Fae Brauer and Anthea Callen  
Includes 70 b&w illustrations  
Dec 2008. 316 pg. 978-0-7546-5827-6

**A Fine Regard**  
*Essays in Honor of Kirk Varnedoe*  
Edited by Patricia G. Berman and Gertje R. Utley  
Includes 65 color and 64 b&w illustrations  
Dec 2008. 356 pg. 978-0-7546-6217-4

**The Feminine Dynamic in English Art, 1485-1603**  
*Women as Consumers, Patrons and Painters*  
Susan E. James  
Includes 52 b&w illustrations  
Jan 2009. 376 pg. 978-0-7546-6381-2

**London Transport Posters**  
*A Century of Art and Design*  
Edited by David Bownes and Oliver Green  
Includes 240 color and 30 b&w illustrations  
Lund Humphries. Sep 2008. 240 pg. 978-0-85331-984-9

**Painted Enamels**  
*An Illustrated Survey 1500-1920*  
Erika Speel  
Includes 30 color and 50 b&w illustrations  
Lund Humphries. Mar 2008. 256 pg. 978-0-85331-935-1

**Crusader Art**  
*The Art of the Crusaders in the Holy Land, 1099-1291*  
Jaroslav Folda  
Includes 90 color, 30 b&w illustrations and 13 maps  
Lund Humphries. Oct 2008. 176 pg. 978-0-85331-995-5

**Come visit our display in the exhibit hall!**  
[www.ashgate.com/ARLIS2009](http://www.ashgate.com/ARLIS2009)

# GENERAL INFORMATION

## OPEN MEETING AND GUEST POLICY

Business meetings are open to all members. Guests are welcome to attend, provided they are registered. For information on registering a guest, please visit the Registration Desk located in the Exhibits Foyer.

## FIRST TIME ATTENDEES

Welcome to Indianapolis and the 37<sup>th</sup> annual meeting of ARLIS/NA! We hope you will find our sessions, workshops, and activities professionally stimulating and rewarding, that our tours will surprise and delight you, and that our social events will provide you with opportunities to meet many new colleagues and expand your ARLIS/NA network. If you are not already active in one of the many special interest groups, check out the "Meeting Finder" in the program, as these are a good way to participate in the activities of the Society. All business meetings are open, so please feel free to attend and get involved.

On Friday, April 17<sup>th</sup>, from 5:00 – 6:00pm, a meeting for First Time Attendees will take place in the Lincoln Room, where you will be introduced to the ARLIS/NA Executive Board members, and where you can learn more about the Society. ARLISnap, an organization for young professionals in ARLIS/NA, is also preparing a "Conference Survival Guide" for all our First-Timer's. Afterwards, we hope you will join us at the Convocation and then at the Welcome Party at the Eiteljorg Museum, a short walk from the Hotel. Taxis will be available for those needing transportation.

## TOURS AND WORKSHOPS

Tours and workshops require registration and most have associated fees. If you would like to check availability for a particular tour or workshop, stop by the Registration Desk.

## AskART INTERNET CAFÉ

The Internet Café, generously sponsored by AskART, will be located in the Exhibits Foyer, near the Registration and Information desks. Hours will be:

Saturday, April 18<sup>th</sup> 8:00am – 4:30pm

Sunday, April 19<sup>th</sup> 8:00am – 4:30pm

Monday, April 20<sup>th</sup> 8:00am – 12:00pm

## CONFERENCE BLOG AND VIRTUAL POSTER SESSIONS

Several Sessions and Poster Sessions will compliment their presentations with Virtual Poster Sessions. The Virtual Posters are provided via the Conference Blog (<http://arlisnaindy.wordpress.com/>), giving conference participants the ability to view content when it is convenient. The content is searchable, and will remain available beyond the time of the conference. Viewers will have the option to comment and send questions to the authors.

## HOTEL INFORMATION

All Conference meeting rooms, as well as the Registration and Information Desks, Internet Café, and Exhibits, are located on the Second Floor of the Indianapolis Marriott Downtown, which is a very easy hotel to navigate. Downstairs, in the Lobby, you'll find two restaurants (Champions and Circle City Bar & Grille), a Starbucks Kiosk, flavored water, a Business Center, a Gift/newsstand, and free wireless access in the lobby and a second floor seating area near the escalators.

The Downtown Indianapolis Marriott is connected by skywalk to the Indiana Convention Center and Circle Center Mall. It is conveniently located near White River State Park, the Eiteljorg Museum of American Indians and Western Art, Indiana Historical Society and over 200 restaurant and entertainment options.

## GETTING AROUND

### On Foot

The Downtown Marriott is located in the heart of downtown Indianapolis and within easy walking distance to museums, sports venues, and the IUPUI campus.

In addition to the many cultural organizations, Indianapolis offers great sports venues like the new Lucas Oil Stadium, home of the Indianapolis Colts, Victory Field, home to our Indianapolis Indians, and NCAA Headquarters. Just blocks from all these great sites you will find the

Herron School of Art and Design on the IUPUI campus. Many of these venues are located either on the Canal Walk or just a few short blocks from the canal. Be sure to bring your walking and/or running shoes with you to the conference – one loop of the canal is 3.2 miles! Or even better, book a segway or paddle boat for added enjoyment and stories to bring back from the conference!

### By Bus

The Red Line is the most convenient way to travel around downtown Indianapolis. The shuttle fee is \$1.75 and operates on a loop Monday – Saturday 7:00am – 10:00pm. The nearest stops are located two blocks north of our hotel on Ohio St. and the Canal (Westbound) and Ohio St. and Senate Ave (Eastbound). For more information including a map of the route and stops please visit [http://www.indygo.net/red\\_line.htm](http://www.indygo.net/red_line.htm) or stop by the ARLIS/NA Hospitality Desk.

### By Taxi

The Hotel staff will be happy to call a cab for you. Although most conference events outside the hotel are within easy walking distance, as are many of the attractions of the City, some areas of interest are most easily accessed via Taxi.

# INDIANAPOLIS MAP

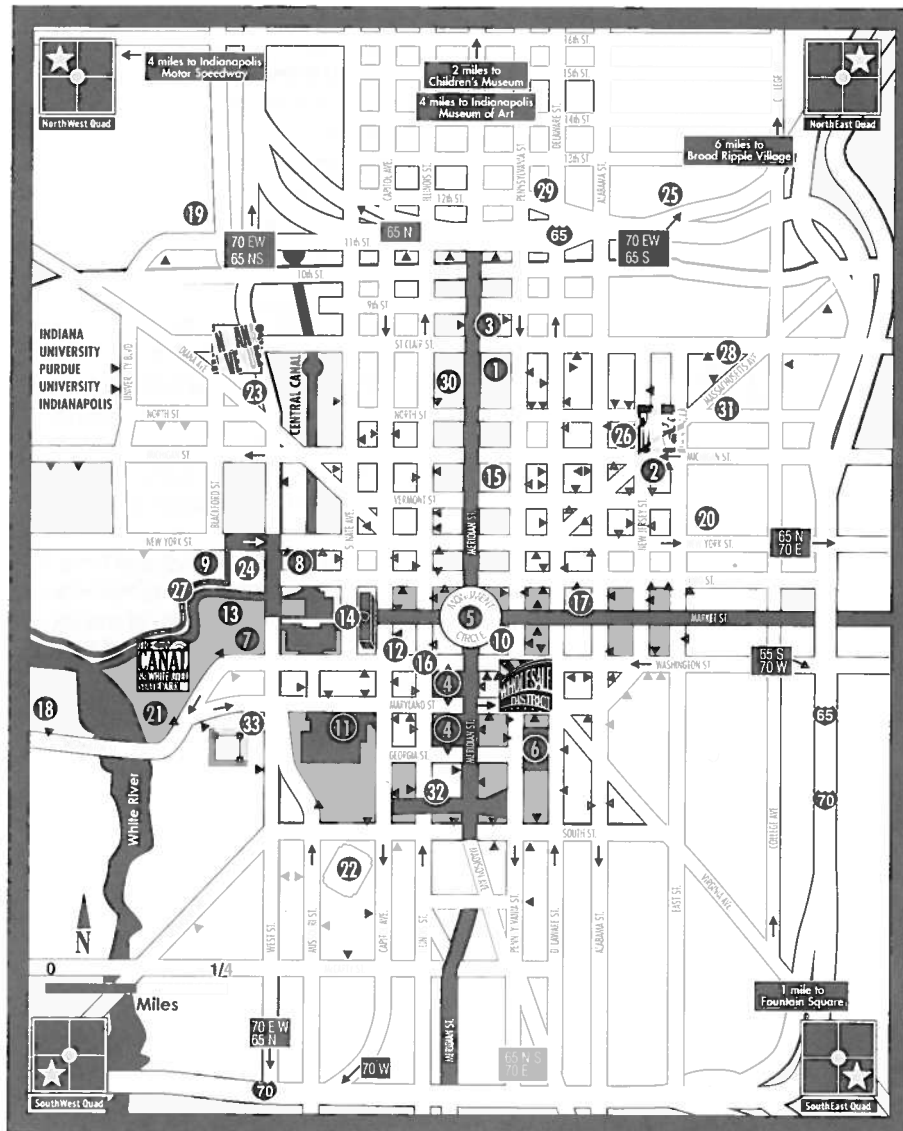

## Indianapolis Downtown

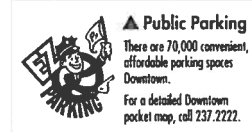

### Places of Interest

- 1 American Legion Mall/Veterans' Memorial Plaza
- 2 Athenaeum
- 3 Central Library
- 4 Circle Centre
- 5 Col. Eli Lilly Civil War Museum
- 6 Conseco Fieldhouse (Ice, Fever, Pacers)
- 7 Eiteljorg Museum of American Indians & Western Art
- 8 Eugene and Marilyn Glick Indiana History Center
- 9 Herron School of Art & Design and Galleries
- 10 Hilbert Circle Theatre/Indianapolis Symphony Orchestra
- 11 Indiana Convention Center
- 12 Indiana Repertory Theatre/Indiana Roof Ballroom
- 13 Indiana State Museum & IMAX Theater
- 14 Indiana State House/Government Center
- 15 Indiana War Memorial & Museum/USS Indianapolis Museum
- 16 Indianapolis Arts Garden
- 17 Indianapolis City Market
- 18 Indianapolis Zoo
- 19 IPS Crispus Attucks Museum (1st quarter 2009)
- 20 James Whitcomb Riley Home
- 21 Lawn at White River State Park
- 22 Lucas Oil Stadium (Colts)
- 23 Madame CJ Walker Building & Heritage Center/Freetown Village
- 24 Military Park
- 25 Morris-Butler House Museum
- 26 Murat Centre/Broadway in Indianapolis
- 27 NCAA Hall of Champions
- 28 Phoenix Theatre
- 29 President Benjamin Harrison Home
- 30 Scottish Rite Cathedral
- 5 Soldiers and Sailors Monument
- 31 Theatre on the Square
- 32 Union Station Grand Hall
- 33 Victory Field (Indians)



Indianapolis  
Downtown Inc.

[www.indydt.com](http://www.indydt.com)



## Some of our most spectacular works aren't signed by the artist.

(152 ACRES OF FLOWERS, TREES AND VISTAS)



### 2009 SPECIAL EXHIBITIONS

European Design Since 1985:  
Shaping the New Century  
THROUGH JUNE 21

Fashion in Bloom  
APRIL 4, 2009—JANUARY 31, 2010

Adaptation: Video Installations by  
Ben-Ner, Herrera, Sussman and  
Sullivan & The Rufus Corporation  
MAY 8—AUGUST 16

Sacred Spain: Art and Belief  
in the Spanish World  
OCTOBER 11, 2009—JANUARY 3, 2010

### Free General Admission Daily

#### HOURS

Tuesday, Wednesday, Saturday 11:00 am-5:00 pm  
Thursday and Friday, 11:00 am-9:00 pm  
Sunday, noon-5:00 pm  
Closed Mondays, Thanksgiving, Christmas  
and New Years days.  
Grounds open daily from dawn to dusk



INDIANAPOLIS MUSEUM OF ART

4000 Michigan Road  
317-923-1331 [imamuseum.org](http://imamuseum.org)

## SPECIAL EVENTS

### FIRST TIME ATTENDEES ORIENTATION

Friday, April 17, 5:00-6:00PM

HOTEL, LINCOLN

Is it your first time at an ARLIS/NA conference? Stop by for an introduction to the board members and a general welcome to ARLIS/NA. It's a great place to find out who the other newbies are and begin that networking right away! You'll also get an overview of what to expect and how to get the most out of the conference. We look forward to seeing you there!

### CONVOCATION AND AWARDS CEREMONY

Friday, April 17, 6:30-8:00PM

HOTEL, MARRIOTT 7/10

Our first evening will get off to an exciting start with our Convocation Ceremony, where we have an opportunity to recognize and honor book award winners, travel award winners, and our Distinguished Service Award winner. **Maxwell Anderson**, the Melvin and Bren Simon Director and CEO of the Indianapolis Museum of Art, will give the keynote address at the Convocation.

### WELCOME PARTY

Friday, April 17, 8:00-10:00PM

EITELJORG MUSEUM OF AMERICAN INDIANS AND WESTERN ART

Generously Sponsored by the Eiteljorg Museum of American Indians and Western Art, and by the following ARLIS/NA Chapters: Central Plains Chapter, DC-MD-VA, Delaware Valley, Midstates, Mountain West, New York Metropolitan, Northern California, Ohio Valley, Southeast, Southern California, Texas-Mexico, and Twin Cities

Immediately following the Convocation Ceremony, all attendees are invited to the welcome party at the Eiteljorg Museum of American Indians and Western Art. It's an easy walk from the hotel and the event gives everyone a chance to see who's at the conference and to begin catching up on everyone's news. The galleries and museum shop will be also be open for us that evening.

### LEADERSHIP BREAKFAST: *The Indy Carburetion* "StART Your Engines"

Saturday, 7:00-8:15AM

HOTEL, MARRIOTT 7/8

Generously Sponsored by F.A. Bennett

(By Invitation Only)

The leadership of ARLIS/NA will get their motors humming as they meet to exchange ideas, formulate goals, and discuss strategies for meeting the need of the organization and its members.

## OPENING PLENARY SESSION

---

**8:30-10:30AM**

**HOTEL MARRIOTT 2/4**

*Convergence and Managing Progressive Change*: with guest speaker James Neal and four respondents: Jane Carlin, Rebecca Moss, Ken Soehner, and Carol Terry

Generously Sponsored by ARTstor

**Moderator:**

Tony White

Convergence and Change are inevitable in today's library environment, but are they positive or negative forces? A view from the top with James Neal, Vice President for Information Services and University Librarian at Columbia University, and four ARLIS/NA Librarian Administrators representing Academic, Museum, Art/Design School and Visual Resources perspectives. The format of the session will include introductory remarks from the moderator, Jim Neal's opening presentation, responses from each of the representative librarians, and then opening the floor to the membership for questions and comments.

**Speaker:**

James Neal, Vice President for Information Services and University Librarian, Columbia University

**Respondents:**

Ken Soehner, Arthur K. Watson Chief Librarian, Watson Library, Metropolitan Museum of Art, New York

Carol Terry, Director of Library Services, The Fleet Library, Rhode Island School of Design, Providence, RI

Jane Carlin, Director of Collins Memorial Library, University of Puget Sound, Tacoma, WA

Rebecca Moss, Coordinator of Visual Resources, University of Minnesota, Minneapolis, MN

## EXHIBITS GRAND OPENING

---

**Saturday, April 18, 10:30AM-1:00PM**

**HOTEL, EXHIBITS HALL**

Generously Sponsored by Richard Minsky

A grand kickoff to our Exhibits Hall and our wonderful Vendors.

Exhibits Hall Hours for the Conference are: Saturday 10:30am-7:00pm (closed for Lunch, 1:00-2:00pm) and Sunday 9:30am-4:00pm (closed for Lunch, 12:30-2:00pm). Come and visit with our vendors, see what they've brought for us to enjoy and learn from, and check out this year's Silent Auction offerings.

## WEB 2.0 TECH KIOSK

---

**Saturday, April 18, 10:30AM-1:00PM and Sunday, April 19, 9:30AM-12:30PM**

**HOTEL, EXHIBITS HALL**

Generously sponsored by J. Paul Getty Trust

A crew of tech-savvy and dedicated volunteers will help you try your hand at using a Web 2.0 Technology. Find out what all the buzz is about and try your hand at blogging, flickr, RSS feeds, wikis, and even a tweet or two. Discover tricks and tools and walk away with hands-on experience and knowledge of how the world of art information is changing.

## PRATT – SILS REUNION

---

**Saturday, April 18, 5:15- 6:15PM**

**HOTEL, DENVER**

Generously sponsored by Pratt School of Information and Library Science

A reception for alumni and current students from Pratt School of Information and Library Science. It will be a great opportunity to see old and new colleagues and friends. Food and drink will be served. Many thanks to Dean Tula Giannini for encouraging and supporting this Pratt gathering

## INDIANA REUNION HONORING BETTY JO IRVINE

---

**Saturday, April 18, 8:00-10:00pm**

**HOTEL, SANTE FE**

Generously Sponsored by Betty Jo Irvine and the School of Library and Information Science, Indiana University

**Organizers**

Sarah Carter and Kristen Mastel

Betty Jo Irvine served as the Head of the Fine Arts Library at Indiana University for 41 years before her retirement in 2007. In addition to providing formal instruction in the Seminar in Art Librarianship and Research Sources in Art History courses, she also mentored dozens of students, employees, and co-workers throughout their professional careers.

The Indiana Reunion is open to "all Irvinites – former students, employees, associates, IU alums, etc." The reunion will feature refreshments, good fellowship, and a slide show of days gone by.

## SILENT AUCTION AND HAPPY HOUR/ NETWORKING IN THE EXHIBITS

---

**Saturday, April 18, 6:00-7:00PM**

**HOTEL, EXHIBITS HALL**

The Silent Auction is a fun-filled way to raise funds for the Society. Individuals, Chapters, and generous vendors donate a tempting assortment of gift baskets, artwork, books, and other valuable and desirable items to offer for auction. Take some time to view all the donations displayed in the Exhibit Hall and make a bid on your favorite items. Don't miss the finale on Sunday morning when the competition for items gets fast and furious!

## **SOCIETY CIRCLE RECEPTION**

(By invitation only)

**Saturday, April 18, 6:00-8:00PM**

**HERRON ART GALLERY, HERRON SCHOOL OF ART AND DESIGN, IUPUI**  
(Walking Distance from the Hotel)

Generously Sponsored by Herron School of Art and Design, and the IUPUI University Library, and an Anonymous Donation

The Society Circle Reception at this year's conference will be held at the newly constructed Herron School of Art and Design, <http://www.herron.iupui.edu> on the IUPUI campus. The Herron School of Art and Design is conveniently located approximately five blocks from the conference hotel. The Herron School of Art and Design has graciously and generously opened the Herron Grand Hall and Main Gallery, the Eleanor Prest Reese and Robert B. Berkshire Galleries, to our Society Circle members attending this special event. Artist, Marie Krane Bergman's work will be on view throughout the Main Gallery. Outside the galleries and located in the Herron Grand Hall, members will enjoy a light array of hors d'oeuvres, open bar, and jazz soloist to complete the event's festivities.

The Society Circle was formed in 2003 to serve as the fundraising arm of the organization. Each year an event is offered for Society Circle members. If you're not already a member, consider joining. For more information about the Society Circle and becoming a member, please visit, <http://www.artisna.org/about/supporting.html>.

## **SUNDAY MORNING COFFEE BREAK IN THE EXHIBITS**

**Sunday, April 19, 9:30-10:45AM**

**HOTEL, EXHIBITS HALL**

Generously Sponsored by Erasmus

Enjoy refreshments and spend some quality time with our vendors

## **SILENT AUCTION FINALE**

**Sunday, April 19, 9:30-10:45AM**

**HOTEL, EXHIBITS HALL**

The Silent Auction is a fun-filled way to raise funds for the Society. Individuals, Chapters, and generous vendors donate a tempting assortment of gift baskets, artwork, books, and other valuable and desirable items to offer for auction. Take some time to view all the donations displayed in the Exhibit Hall and make a bid on your favorite items. Join in the Finale Scramble as bidders scramble to make their last bid the winning one!

## **CIRCLE CITY CELEBRATION**

**Sunday, April 19, 6:00-9:00PM**

**INDIANAPOLIS MUSEUM OF ART**

(Buses will depart from the Hotel Lobby, Missouri Street exit, beginning at 5:45PM)

Generously Sponsored by the Indianapolis Museum of Art

One of the most beautiful venues in the Circle City, the newly redesigned Indianapolis Museum of Art will be the stunning setting for our big Conference Celebration.

Enjoy hors d'oeuvres and network with colleagues while you experience the view from the IMA's Pulliam Great Hall that includes Robert Irwin's *Light and Space III* and Sol Lewitt's *Wall Drawing 652, Continuous Forms With Color Acrylic Washes Superimposed*. Attendees will also be able to visit the special exhibition: *European Design Since 1985: Shaping the New Century* as well as the first floor galleries, museum shop, and the new Design Center.

## **MEMBERSHIP MEETING AND CONTINENTAL BREAKFAST**

**Monday, April 20, 8:00-10:00AM**

**HOTEL, MARRIOTT 2/4**

All members are invited to our annual meeting. You'll hear updates about the Society's activities from this year and hopes and plans for the coming year and our new officers will take the helm. A highlight of the meeting will be an introduction to Boston, site of our conference in 2010.

## **CLOSING PLENARY SESSION**

*Bigger, Bolder and More Beautiful: Cultural Development and Urban Design in Indianapolis*, with Guest Speaker Brian Payne

**Monday, April 20, 2:00-3:00pm**

**HOTEL, MARRIOTT 7/8**

How does a City re-invent itself culturally? Brian Payne, President of the Central Indiana Community Foundation will address current issues of Urban Planning, the Arts, and the development of the Indianapolis Cultural Trail. The Indianapolis Cultural Trail: A Legacy of Gene & Marilyn Glick is a world-class urban bike and pedestrian path that connects neighborhoods, Cultural Districts and entertainment amenities, and serves as the downtown hub for the entire central Indiana greenway system.

The five downtown cultural districts connected by the Indianapolis Cultural Trail include Fountain Square, Indiana Avenue, Mass Ave, The Canal & White River State Park, and the Wholesale District. The Cultural Trail will also connect with the Monon Trail, allowing visitors easy access to Broad Ripple Village from downtown. The Cultural Trail is made possible by a large public and private collaboration led by Central Indiana Community Foundation, the City of Indianapolis and several not-for-profit organizations devoted to building a better city. The Central Indiana Community Foundation (CICF) provides leadership on community issues like helping families overcome obstacles, creating great public spaces, and embracing our ethnic communities. <http://www.indyculturaltrail.org/about.html>

### **Guest Speaker:**

Brian Payne, President of the Central Indiana Community Foundation and The Indianapolis Foundation

# MEETING FINDER (ALPHABETICAL)

| TITLE   | DATE                              | TIME         | ROOM          |
|---|-----------------------------------|--------------|---------------|
| Academic Division Meeting                     | Sat. April 18                     | 12:30-2:00pm | Lincoln       |
| Architecture Section Meeting                  | Sun. April 19                     | 12:30-2:00pm | Austin/Boston |
| ARLIS Canada Chapter                          | Sun. April 19                     | 12:45-1:45pm | Marriott 9/10 |
| ARLIS DC-MD-VA Chapter                        | Time and Location to be Announced |              |               |
| ARLIS Midstates Chapter                       | Sat. April 18                     | 5:15-6:30pm  | Lincoln       |
| ARLIS Mountain West Chapter                   | Sat. April 18                     | 5:30-6:30pm  | Marriott 7/8  |
| ARLIS Ohio Valley Chapter                     | Sun. April 19                     | 3:30-4:30pm  | Location TBA  |
| ARLIS Southeast Chapter                       | Time and Location to be Announced |              |               |
| ArLISNAP Special Interest Group               | Sat. April 18                     | 7:00-8:00am  | Austin/Boston |
| Art & Design School Division Meeting          | Sat. April 18                     | 12:30-1:30pm | Marriott 7/8  |
| Artists Files Special Interest Group          | Sat. April 18                     | 5:30-6:30pm  | Sante Fe      |
| ARTstor User Group                            | Mon. April 20                     | 12:00-1:30pm | Marriott 2/4  |
| Avery/IBA/Getty User Group                    | Sun. April 19                     | 8:00-9:30am  | Marriott 7/8  |
| Book Arts Special Interest Group              | Sun. April 19                     | 5:15-6:15pm  | Austin/Boston |
| Catalog Section Meeting                       | Sun. April 19                     | 12:40-1:40pm | Marriott 7/8  |
| Cataloging Advisory Committee                 | Sat. April 18                     | 5:15-6:15pm  | Marriott 1    |
| Cataloging Problems Special Interest Group    | Sun. April 19                     | 8:00-9:30am  | Marriott 9/10 |
| Chapter Chairs Meeting                        | Mon. April 20                     | 5:00-6:00pm  | Marriott 9/10 |
| Collection Development Special Interest Group | Sun. April 19                     | 5:15-6:15pm  | Marriott 7/8  |
| Committee for Committee Chairs                | Time and Location to be Announced |              |               |
| Communications and Publications Committee     | Time and Location to be Announced |              |               |
| Content DM User Group                         | Sun. April 19                     | 8:00-9:30am  | Sante Fe      |
| CPAC meeting                                  | Mon. April 20                     | 5:00-6:00pm  | Austin/Boston |
| Decorative Arts Special Interest Group        | Time and Location to be Announced |              |               |
| Development Committee                         | Sat. April 18                     | 5:15-6:15pm  | Austin/Boston |

| TITLE                                      | DATE                              | TIME           | ROOM          |
|--|-----------------------------------|----------------|---------------|
| Diversity Committee                        | Time and Location to be Announced |                |               |
| Education Sub-Committee                    | Time and Location to be Announced |                |               |
| Executive Board Meeting                    | Fri. April 17                     | 8:30am-4:00 pm | Denver        |
| Finance Committee                          | Time and Location to be Announced |                |               |
| Gerd Muehsam Award Committee               | Sun. April 19                     | 8:00- 9:30am   | Lincoln       |
| Interlibrary Loan Special Interest Group   | Time and Location to be Announced |                |               |
| International Relations Committee          | Sun. April 19                     | 8:00-9:30am    | Denver        |
| Internship Award Sub Committee             | Time and Location to be Announced |                |               |
| Membership Committee                       | Sat. April 18                     | 5:30-6:30pm    | Marriott 9/10 |
| Museum Division Meeting                    | Sat. April 18                     | 12:30-1:30pm   | Marriott 9/10 |
| Nominating Committee                       | Time and Location to be Announced |                |               |
| Post Conference Executive Board Meeting    | Mon. April 20                     | 6:00-8:00pm    | Denver        |
| Professional Development Committee         | Sun. April 19                     | 12:30-2:00pm   | Denver        |
| Public Librarians Special Interest Group   | Time and Location to be Announced |                |               |
| Public Policy Committee                    | Time and Location to be Announced |                |               |
| Research Awards Committee                  | Time and Location to be Announced |                |               |
| RIS Section Meeting                        | Sun. April 19                     | 12:40-1:40pm   | Sante Fe      |
| FLG User Group                             | Mon. April 20                     | 12:00-1:30pm   | Denver        |
| Scipio User Group                          | Mon. April 20                     | 12:00-1:30pm   | Austin/Boston |
| Standards Committee                        | Sun. April 19                     | 12:30-1:30pm   | Lincoln       |
| Teaching Librarians Special Interest Group | Sun. April 19                     | 8:00-9:30am    | Austin/Boston |
| Travel Awards Committee                    | Time and Location to be Announced |                |               |
| Visual Resources Division Meeting          | Sat. April 18                     | 12:30-2:00pm   | Denver        |
| Witkenorn Award Committee                  | Time and Location to be Announced |                |               |

# MEETING FINDER

(LISTED BY DATE AND TIME)

| TITLE                                      | DATE          | TIME           | ROOM          |
|--|---------------|----------------|---------------|
| Executive Board Meeting                    | Fri. April 17 | 8:30am-4:00 pm | Denver        |
| ArLISNAP Special Interest Group            | Sat. April 18 | 7:00-8:00am    | Austin/Boston |
| Art & Design School Division Meeting       | Sat. April 18 | 12:30-1:30pm   | Marriott 7/8  |
| Museum Division Meeting                    | Sat. April 18 | 12:30-1:30pm   | Marriott 9/10 |
| Academic Division Meeting                  | Sat. April 18 | 12:30-2:00pm   | Lincoln       |
| Visual Resources Division Meeting          | Sat. April 18 | 12:30-2:00pm   | Denver        |
| Cataloging Advisory Committee              | Sat. April 18 | 5:15-6:15pm    | Marriott 1    |
| Development Committee                      | Sat. April 18 | 5:15-6:15pm    | Austin/Boston |
| ARLIS Midstates Chapter                    | Sat. April 18 | 5:15-6:30pm    | Lincoln       |
| ARLIS Mountain West Chapter                | Sat. April 18 | 5:30-6:30pm    | Marriott 7/8  |
| Artists Files Special Interest Group       | Sat. April 18 | 5:30-6:30pm    | Sante Fe      |
| Membership Committee                       | Sat. April 18 | 5:30-6:30pm    | Marriott 9/10 |
| Avery/IBA/Getty User Group                 | Sun. April 19 | 8:00-9:30am    | Marriott 7/8  |
| Cataloging Problems SIG                    | Sun. April 19 | 8:00-9:30am    | Marriott 9/10 |
| Content DM User Group                      | Sun. April 19 | 8:00-9:30am    | Sante Fe      |
| Gerd Muehsam Award Committee               | Sun. April 19 | 8:00-9:30am    | Lincoln       |
| Cataloging Problems Special Interest Group | Sun. April 19 | 8:00-9:30am    | Marriott 9/10 |

| TITLE   | DATE          | TIME         | ROOM          |
|---|---------------|--------------|---------------|
| International Relations Committee             | Sun. April 19 | 8:00-9:30am  | Denver        |
| Teaching Librarians Special Interest Group    | Sun. April 19 | 8:00-9:30am  | Austin/Boston |
| Architecture Section Meeting                  | Sun. April 19 | 12:30-2:00pm | Austin/Boston |
| Standards Committee                           | Sun. April 19 | 12:30-1:30pm | Lincoln       |
| Professional Development Committee            | Sun. April 19 | 12:30-2:00pm | Denver        |
| Catalog Section Meeting                       | Sun. April 19 | 12:40-1:40pm | Marriott 7/8  |
| RIS Section Meeting                           | Sun. April 19 | 12:40-1:40pm | Sante Fe      |
| ARLIS Canada Chapter                          | Sun. April 19 | 12:45-1:45pm | Marriott 9/10 |
| Book Arts Special Interest Group              | Sun. April 19 | 5:15-6:15pm  | Austin/Boston |
| Collection Development Special Interest Group | Sun. April 19 | 5:15-6:15pm  | Marriott 7/8  |
| ARTstor User Group                            | Mon. April 20 | 12:00-1:30pm | Marriott 2/4  |
| PLG User Group                                | Mon. April 20 | 12:00-1:30pm | Denver        |
| Scio User Group                               | Mon. April 20 | 12:00-1:30pm | Austin/Boston |
| Chapter Chairs Meeting                        | Mon. April 20 | 5:00-6:00pm  | Marriott 9/10 |
| CPAC meeting                                  | Mon. April 20 | 5:00-6:00pm  | Austin/Boston |
| Post Conference Executive Board Meeting       | Mon. April 20 | 6:00-8:00pm  | Denver        |



# CONFERENCE EVENTS AT-A-GLANCE

| EVENT   | DATE   |
|---|--|
| Circle City Celebration at the Indianapolis Museum of Art                           | Sunday, April 19   |
| Circle City Yoga  | Saturday, April 18<br>Sunday, April 19<br>Monday, April 20                       |
| Convocation and Awards Ceremony   | Friday, April 17   |
| Exhibits Grand Opening & Reception  | Saturday, April 18   |
| Exhibits Hall   | Saturday, April 18<br>Sunday, April 19   |
| First Time Attendees Orientation  | Friday, April 17   |
| Indiana University Reunion honoring Betty Jo Irvine                                 | Saturday, April 18   |
| Information Desk open (see Registration & info Desks)                               | Monday, April 20   |
| Internet Café Open  | Saturday, April 18<br>Sunday, April 19<br>Monday, April 20                       |
| Leadership Breakfast  | Saturday, April 18   |
| Membership Meeting with Breakfast   | Monday, April 20   |
| Museums and the Web Exhibits Open to ARLIS/NA attendees                             | Friday, April 17   |
| Plenary, Opening: Convergence and Managing Progressive Change                       | Saturday, April 18   |
| Plenary, Closing Cultural Development, Urban Planning, and the Arts in Indianapolis | Monday, April 20   |
| Pratt-SILS Reunion  | Saturday, April 18   |
| Registration and Information Desks  | Thursday, April 16<br>Friday, April 17<br>Saturday, April 18<br>Sunday, April 19 |
| Silent Auction and Happy Hour / Networking in the Exhibits                          | Saturday, April 18   |
| Silent Auction Finale   | Sunday, April 19   |
| Society Circle Reception at the Herron Art Gallery (Invitation Only)                | Saturday, April 18   |
| Sunday Morning Coffee Break   | Sunday, April 19   |
| White River Bird Watching   | Sunday, April 19   |
| Web 2.0 Kiosk   | Saturday, April 18<br>Saturday, April 18<br>Sunday, April 19                     |
| Welcome Party at the Eiteljorg Museum   | Friday, April 17   |

| TIME                        | LOCATION                                  |
|-----------------------------|---|
| 6:00-9:00pm                 | Indianapolis Museum of Art                |
| 7:00-7:45am                 | Marriott Downtown, Denver                 |
| 7:00-7:45am                 | Marriott Downtown, Denver                 |
| 7:00-7:45am                 | Marriott Downtown, Denver                 |
| 6:30-8:00pm                 | Marriott Downtown, Marriott 7/10          |
| 10:30am-1:00pm              | Marriott Downtown, Exhibits Hall          |
| 10:30am-1:00pm; 2:00-2:00pm | Marriott Downtown, Exhibits Hall          |
| 9:30am-12:30pm; 2:00-4:00pm | Marriott Downtown, Exhibits Hall          |
| 5:00-6:00pm                 | Marriott Downtown, Lincoln                |
| 9:00-10:00pm                | Marriott Downtown, Sante Fe               |
| 5:00am-5:00pm               | Marriott Downtown, Exhibits Foyer         |
| 8:00am-4:30pm               | Marriott Downtown, Exhibits Foyer         |
| 8:00am-4:30pm               | Marriott Downtown, Exhibits Foyer         |
| 8:00am-12:00pm              | Marriott Downtown, Exhibits Foyer         |
| 7:00-8:15am                 | Marriott Downtown, Marriott 7/8           |
| 8:00-10:00am                | Marriott Downtown, Marriott 2/4           |
| 9:00 am-5:00pm              | Hyatt Regency Indianapolis, Exhibits Hall |
| 8:30-10:00am                | Marriott Downtown, Marriott 2/4           |
| 2:00-3:00pm                 | Marriott Downtown, Marriott 7/8           |
| 5:15-6:15pm                 | Denver                                    |
| 11:00 am-5:00pm             | Marriott Downtown, Exhibits Foyer         |
| 7:00 am-5:00pm              | Marriott Downtown, Exhibits Foyer         |
| 7:00 am-5:00pm              | Marriott Downtown, Exhibits Foyer         |
| 8:00 am-5:30pm              | Marriott Downtown, Exhibits Foyer         |
| 6:00-7:00pm                 | Marriott Downtown, Exhibits Hall          |
| 9:30-10:45am                | Marriott Downtown, Exhibits Hall          |
| 6:00-8:00pm                 | IUPUI Campus, Herron Art Gallery          |
| 9:30-11:00am                | Marriott Downtown, Exhibits Foyer         |
| 7:00am-8:00pm               | White River Parkway, Meet in Hotel Lobby  |
| 10:30am-1:00pm              | Marriott Downtown, Exhibits Hall          |
| 2:00-6:00 pm                | Marriott Downtown, Exhibits Hall          |
| 9:30am-12:30pm              | Marriott Downtown, Exhibits Hall          |
| 8:00-10:00pm                | Eiteljorg Museum                          |

# PROGRAM SCHEDULE

## THURSDAY, APRIL 16<sup>TH</sup>

**11:00-5:00PM**

Registration and Information Desks

**EXHIBIT HALL FOYER**

### TOUR

Please meet in the Hotel Lobby WEST ENTRANCE (Missouri Street) at least 15 minutes before departure time

**3:00-5:00PM**

High and Hot Technology at IUPUI

### WORKSHOP

**3:00-5:00PM**

Mashups

**IUPUI UNIVERSITY LIBRARY, 755 WEST MICHIGAN STREET, ROOM UL-1130**  
(Walking Distance from the Hotel)

Creating a mashup is a great way to introduce information visually – all you need is a good idea. This hands-on workshop will introduce mash-ups and examine how they can be beneficial to art libraries. We'll also walk through the steps of making simple mash-ups of our very own. Participants are encouraged to think about materials from a local institution, environment, or collection they'd like to work with and to bring a few images with them to the session. Demonstrations will include creating mashups for Manhattan Hot Spots, local Indianapolis restaurants and amenities, African masquerade locations, and IU's Cushman image collection.

#### Workshop Leader:

Amanda Gluibizzi, Fine Arts Librarian, The Ohio State University

#### Workshop Contributor:

Nicole Beatty, Image Cataloger, Henry R. Hope School of Fine Arts Visual Resources Center, Indiana University Bloomington

**6:00PM**

Dinner (on your own)

**7:00-9:00PM**

Minor League Baseball Game (on your own).

**VICTORY FIELD**

## FRIDAY, APRIL 17<sup>TH</sup>

**7:00AM-5:00PM**

Registration and Information Desks Open

**EXHIBITS FOYER**

**8:30AM-4:00PM**

Executive Board Meeting

**DENVER**

### WORKSHOPS

**8:00AM-5:00PM** (includes transportation time between Indianapolis and Bloomington)

Type, Print, Bind – a Hands-on Letterpress Workshop  
with Paul Brown

*Meet in Hotel Lobby WEST ENTRANCE (Missouri Street) at least 15 minutes before departure time*

**FINE ARTS BUILDING ROOM 245, INDIANA UNIVERSITY, BLOOMINGTON, IN**

In this hands-on workshop, Paul Brown will lead participants as they set type, print, and bind a small book in a letterpress shop at Indiana University Bloomington. All supplies and smocks will be provided, and participants are encouraged to wear clothes they don't mind getting dirty. Lunch will be provided.

#### Workshop Leader:

Paul Brown, IU Professor of Graphic Design

Paul Brown received his M.F.A. from Indiana University and his B.A. from Concordia College, Moorhead, Minnesota. He joined the faculty at Indiana University, Bloomington in 2000 as a professor of Graphic Design after 16 years at the Herron School of Art as a professor of Visual Communication. While at Herron, he also served as coordinator of the Visual Communication area and as Associate Dean. His work has been included in Communication Arts and Print magazines and in Graphic Design USA, the Annual of the American Institute of Graphic Arts. In addition, Brown has received awards from the Chicago Book Clinic, the Council for the Advancement and Support of Education, the Miniature Book Society, the American Federation of Arts Design, and the Art Directors Club of Indiana. He has served as a design consultant for the Herron Gallery at the Herron School of Art, the Indiana Arts Commission, and the Indiana University Foundation and he was a founding member and has served on the board of the Indianapolis chapter of the American Institute of Graphic Arts. His work has been exhibited widely including IGA's Fifty Books, New York, Art of the Book 1998, Toronto, and Book Arts: Images and Words, Cambridge, Massachusetts. His most recent work involves limited edition, letterpress printed book works and broadsides.

**8:00AM-12:00PM**

## Creating Effective Resumes, Cover Letters and Job Searching Skills

**MARRIOTT 1**

This workshop is aimed at new and current professionals seeking jobs in the fields of art librarianship and visual resources. Speakers will talk about strategies related to resume and cover letter writing and job searching skills from the perspectives of the employer and the job seeker. Participants will be paired with professionals who will provide personalized advice about resumes and cover letters in one-on-one meetings. Speakers and resume reviewers will include professionals from academic universities, art and design colleges, visual resource collections, and public libraries. Participants please bring copies of your resumes and cover letters for the reviewing portion of the workshop.

**Workshop Moderators:**

Shilpa Rele, MLIS from UCLA, 2009. Metadata Librarian, University of Miami (May)

Sarah Sherman, Assistant Reference Librarian, Special Collections and Visual Resources Research Library Getty Research Institute

**Speakers:**

Marc Gartler, Director of Library Services, Harrington College of Design

Janine Henri, Architecture, Design, and Digital Services Librarian, Arts Library, UCLA

Rebecca Cooper, Architecture & Instruction Librarian, Fiske Kimball Fine Arts Library, University of Virginia

Martha González Palacios, Librarian, Architecture and Planning Library, The University of Texas at Austin

**8:00AM-12:00PM**

## Decision Trees: Seeking the Right Path for Visual Resource Users

**IUPUI UNIVERSITY LIBRARY, 755 WEST MICHIGAN STREET, ROOM UL-1130  
(Walking Distance from the Hotel)**

A Decision Tree helps users differentiate between the types of visual resources available to them, as well as helps the user isolate and differentiate the various types of tasks associated with using visual resources (i.e. teaching, publication, off-campus presentations, etc.) This workshop will provide an in-depth account of the creation of Cornell's innovative teaching tool for visual resource users, a discussion of the visual resources reference interview process, and the changing face of reference in an academic environment. Active participation will include a component in which audience members can navigate/modify the Cornell decision Tree and take this initial work with them. It will also include a discussion forum in which participants will be able to ask questions, share their own teaching experiences, and discuss potential applications of the Decision Tree beyond Cornell University.

**Workshop Leaders:**

Greta Bahnemann, Curator, Knight Visual Resources Facility, Cornell University; Margaret Webster, Director, Knight Visual Resources Facility, Cornell University; and Jeannine Keefer, Visual Resources Librarian, School of Arts and Sciences, University of Richmond

**12:30-4:30PM**

## ARLIS/NA Career Mentoring Program

**MARRIOTT 1**

This four-hour workshop will be modeled on the successful Banff workshop led by Margaret Law that kicked off the year-long ARLIS/NA Mentoring Program. The workshop, which will be facilitated by Sarah Carter and Rachel Resnik, will feature an introduction to mentoring, viewing of a DVD of the Banff workshop, discussion, role-playing, and breakout sessions with mentor/mentee pairs. Characteristics of mentors, mentees, and the mentoring relationship; methods of communication; and benefits and potential pitfalls of mentoring will be discussed. ARLIS members who want to participate in the year-long Career Mentoring Program will fill out an application to facilitate matching, and will be required to attend the workshop. For more information contact V. Heidi Hass, chair of the Mentoring Subcommittee.

**Workshop Moderator:**

V. Heidi Hass, Head of Research Services, The Morgan Library & Museum

**Workshop Facilitators:**

Sarah Carter, Instruction and Research Services Librarian, Verman Kimbrough Memorial Library, Ringling College of Art and Design

Rachel Resnik, Technical Services Librarian, Massachusetts College of Art & Design

**1:00-4:00PM**

## They Never Covered this in Library School: Cataloging Artists Books

**HERRON ART LIBRARY, HERRON SCHOOL OF ART AND DESIGN, 735 WEST NEW YORK STREET, ROOM 117 (Walking Distance from the Hotel)**

Generously Sponsored by Swann Galleries

This comprehensive session will cover all aspects of cataloging artists' books and a little bit more. Each registrant will receive a copy of Sylvia's handbook, which includes a comprehensive appendix on the structure and form terms applied to this genre. In the session we will cover defining the artist's book, housekeeping issues, administrative considerations, plus all of the elements of bibliographic description, subject analysis and classification. Of particular interest will be the opportunity to discuss several wonderful examples of artists' books from the extensive collection of the Herron Art Library. The presenter promises a fun afternoon, of value to the novice and the experienced librarian and cataloger. Sylvia Turchyn has oversight for the cataloging of artists' books at Indiana University, where she developed cataloging expertise with this genre. She has a long-standing relationship with the Women's Studio Workshop in Rosendale, New York, where she has visited as a librarian-in-residence for several years.

**Workshop Leader:**

Sylvia Turchyn, Section Head, Western European Cataloging Section, Herman B Wells Library, Indiana University Bloomington

**TOURS**

*Please meet in the Hotel Lobby WEST ENTRANCE (Missouri Street) at least 15 minutes before departure time*

**8:00AM-5:00PM**

Bloomington Treasures: Kinsey Institute, Lilly Library, Benton Murals, IU Art Museum, Wells Library Information Commons, Fine Arts Library

*(Includes transportation time between Indianapolis and Bloomington. Lunch is provided.)*

Generously Sponsored by Indiana University Library, Bloomington

**8:00AM-5:00PM**

Architecture of Columbus, Indiana

*(Includes transportation time between Indianapolis and Columbus. Lunch is provided.)*

**8:00AM-12:00PM**

Kokomo Opalescent Glass Company Studio & Shop

**1:00-5:00PM**

Auto Design and the Indianapolis Motor Speedway

**1:00-5:00PM**

Decorative Arts at the Indiana State Museum

**3:00-5:00PM**

Historic Theaters in Indianapolis.

Guided by Historic Landmarks Foundation

**5:00-6:00PM**

First Time Attendees Orientation

**LINCOLN**

Is it your first time at an ARLIS/NA conference? Stop by for an introduction to the board members and a general welcome to ARLIS/NA. It's a great place to find out who the other newbies are and begin that networking right away! You'll also get an overview of what to expect and how to get the most out of the conference. We look forward to seeing you there!

**6:30-8:00PM**

Convocation and Awards Ceremony

**MARRIOTT 7/10**

Our first evening will get off to an exciting start with our Convocation Ceremony, where we have an opportunity to recognize and honor book award winners, travel award winners, and our Distinguished Service Award winner. Maxwell Anderson, the Melvin and Bren Simon Director and CEO of the Indianapolis Museum of Art, will give the keynote address at the Convocation.

**8:00-10:00PM**

Welcome Party

**EITELJORG MUSEUM OF AMERICAN INDIANS AND WESTERN ART  
(Walking Distance from the Hotel)**

Generously Sponsored by the Eiteljorg Museum of American Indians and Western Art, and by the following ARLIS/NA Chapters: Central Plains, DC-MD-VA, Delaware Valley, Midstates, Mountain West, New York Metropolitan, Northern California, Ohio Valley, Southeast, Southern California, Texas-Mexico, and Twin Cities

Immediately following the Convocation Ceremony, all attendees are invited to the welcome party at the Eiteljorg Museum of American Indians and Western Art. It's an easy walk from the hotel and the event gives everyone a chance to see who's at the conference and to begin catching up on everyone's news. The galleries and museum shop will be also be open for us that evening.

**SATURDAY, APRIL 18<sup>TH</sup>****7:00AM-5:00PM**

Registration and Information Desks open

**EXHIBITS FOYER****7:00-7:45AM**

Circle City Yoga

**DENVER**

Wake up your body and mind with a series of gentle stretches based on Yoga and related systems of exercise (Qigong). Practice includes both deep breathing and positions of physical ease. These 45-minute morning sessions are planned for those with or without prior Yoga or Qigong experience.

Led by BJ Kish Irvine

**7:00-8:15AM**Leadership Breakfast: *The Indy Carburetion* "StART Your Engines"**MARRIOTT 7/8**

Generously Sponsored by F.A. Bennett

By Invitation Only

The leadership of ARLIS/NA will get their motors humming as they meet to exchange ideas, formulate goals, and discuss strategies for meeting the need of the organization and its members.

**8:00AM-4:30PM**

## Internet Café Open

**EXHIBITS FOYER**

Generously Sponsored by AskART

**8:30-10:30AM**

## Opening Plenary Session

**MARRIOTT 2/4**

Convergence and Managing Progressive Change: with guest speaker James Neal and four respondents: Jane Carlin, Rebecca Moss, Ken Soehner, and Carol Terry

Generously Sponsored by ARTstor

**Moderator:**

Tony White

Convergence and Change are inevitable in today's library environment, but are they positive or negative forces? A view from the top with James Neal, Vice President for Information Services and University Librarian at Columbia University, and four ARLIS/NA Librarian Administrators representing Academic, Museum, Art/Design School and Visual Resources perspectives. The format of the session will include introductory remarks from the moderator, Jim Neal's opening presentation, responses from each of the representative librarians, and then opening the floor to the membership for questions and comments.

**Speaker:**

James Neal, Vice President for Information Services and University Librarian, Columbia University

**Respondents:**

Ken Soehner, Arthur K. Watson Chief Librarian, Watson Library, Metropolitan Museum of Art, New York

Carol Terry, Director of Library Services, The Fleet Library, Rhode Island School of Design, Providence, RI

Jane Carlin, Director of Collins Memorial Library, University of Puget Sound, Tacoma, WA

Rebecca Moss, Coordinator of Visual Resources, University of Minnesota, Minneapolis, MN.

**10:30AM-1:00PM**

## Exhibits Grand Opening &amp; Reception (No Conflict till 12:30)

**EXHIBITS HALL**

Generously Sponsored by Richard Minsky

A grand kickoff to our Exhibits Hall and our wonderful Vendors. Come and visit with our exhibitors, see what they've brought for us to enjoy and learn from, and check out this year's Silent Auction offerings.

**10:30AM-1:00PM**

## Web 2.0 Kiosk Open

Generously Sponsored by J.Paul Getty Trust

A crew of tech-savvy and dedicated volunteers will help you try your hand at using a Web 2.0 Technology. Find out what all the buzz is about and try your hand at blogging, flickr, RSS feeds, wikis, and even a tweet or two. Discover tricks and tools and walk away with hands-on experience and knowledge of how the world of art information is changing.

**12:30-2:00PM**

## Academic Division Meeting

**LINCOLN****Moderators:**

Kathleen Lonborn (outgoing)

Greg Hatch (incoming)

**12:30-2:00PM**

## Museum Division Meeting

**MARRIOTT 9/10****Moderators:**

Amy Ballmer(outgoing)

Karyn Hinkle (incoming)

**12:30-2:00PM**

## Art and Design School Division Meeting

**MARRIOTT 7/8****Moderators:**

Claudia Covert & Laura Haxer(outgoing)

Jill Luedke & Holly Hatheway (incoming)



**12:30-2:00PM**

Visual Resources Division Meeting

**DENVER****Moderators:**

Spruill Harder (outgoing)

Eileen Fry (incoming)

**1:00-2:00PM**

Exhibits Closed for Lunch

**2:00-7:00 PM**

Exhibits Open

Silent Auction Open

**2:00-3:30PM POSTER SESSIONS**

Exhibits Hall

**ROUNDING UP IMAGES.****Presenter:**

Barbara Furbush, Senior Reference Librarian, Research Library at the Getty Villa, Getty Research Institute.

**COPYRIGHT AND FAIR USE: LANDMARKS AND GUIDELINES FOR THE ART INFORMATION PROVIDER.****Presenter:**

Carmen Orth-Alfie, Coordinator, Government Information Services, University of Kansas Libraries

**A COLLECTION IS RE-INVENTED: THE UNIVERSITY OF CALIFORNIA BERKELEY ARTIST FILES PROJECT.****Presenter:**

Linda Psomas, San Jose State University School of Library and Information Science, MLIS 2008

**FROM START TO FINISH: PLANNING AN INTERDISCIPLINARY INFORMATION LITERACY COURSE.****Presenters:**

Kaeley McMahan, Art, Theatre & Dance Librarian, Z. Smith Reynolds Library, Wake Forest University

Sharon Snow, Head of Special Collections and Religious Studies and Classical Studies Liaison, Z. Smith Reynolds Library, Wake Forest University.

**2:00-3:30PM SESSIONS**

The Evolving Art Librarian: Convergence of our Traditional Roles

**MARRIOTT 7/8**

In the past, an art librarian's job duties consisted of clearly defined tasks in the realms of collection development, reference, and instruction. Major trends have now changed this paradigm. Technology has made many job duties obsolete and allowed librarians to take on new tasks. A more democratic work environment with flattened hierarchies has given librarians more autonomy. The current emphasis on team support of strategic goals has provided opportunities for art librarians to expand their skill sets. Today's librarian is juggling a multitude of roles, and may engage in teaching for-credit courses, event planning, marketing, exhibitions, and public relations activities. Many librarians are taking on more technical responsibilities, as well, by managing digital collections, data sets, and the adoption of emerging technologies. While the work of art librarians is rapidly evolving, customer expectations of librarian job duties typically remain static or may have even increased due to the new technologies within libraries. Many librarians feel challenged by efforts to redefine and market their new roles.

This presentation will present the results from a survey of art librarians working in academic, public, and museum libraries, as well as new art librarians and how they are managing this identity transition. They will also present mechanisms for exploiting this time of change to the benefit of libraries and to the patrons they serve.

**Moderator:**

Alyssa Resnick, Senior Library Supervisor, Brand Library & Art Center, Glendale Public Library

**Speakers:**

Laurel Bliss, Fine Arts Librarian, San Diego State University. *The Perspective of the New Art Librarian*

Cathy Carpenter, Head, Architecture Library, Georgia Institute of Technology. *The Perspective of the Academic Art Librarian*

Catherine Essinger, Architecture & Art Library Coordinator, University of Houston. *The Perspective of the Museum Librarian*

Alyssa Resnick, Senior Library Supervisor, Brand Library & Art Center, Glendale Public Library. *The Perspective of the Public Art Librarian*

Architectural Patronage and the Corporation:  
The Legacy of Columbus, Indiana

**MARRIOTT 9/10**

Since J. Irwin Miller of the Cummins Engine Company implemented a program to underwrite architectural fees for any building designed by a firm from an approved list, Columbus's reputation as an architectural Mecca has grown steadily. In 2005, the town was named one of the country's "Dozen Distinctive Destinations" by the National Trust for Historic Preservation. With important public buildings, landscapes, and sculpture designed by noted American modernists, such as Eliel and Eero Saarinen, Dan Kiley, Harry Weese, I.M. Pei, Cesar Pelli, Richard Meier, and Robert Venturi, six of its buildings are National Historic Landmarks (<http://www.nps.gov/history/nhl/>). This

session will offer a tripartite approach to the town's historical importance: an analysis of its architectural culture and corporate support; an overview of its architectural heritage relating to modernism; and an exploration of preservation issues of mid-century modernism.

**Moderator:**

Joy Kestenbaum, Director, Adam & Sophie Gimbel Design Library, The New School, New York, NY

**Speakers:**

Susan Olson Allen, Assistant Professor, School of Public Health and Information Sciences, University of Louisville. *Coming Full Circle: The Evolution of Twentieth Century Architecture as Reflected in Columbus, Indiana.*

Anthony J. Costello, FAIA, Irving Distinguished Professor Emeritus of Architecture, College of Architecture and Planning, Ball State University, Muncie, Indiana. *Columbus, Indiana: The Persistence of Modernism in Architecture.*

Marsh Davis, President, Historic Landmarks Foundation of Indiana, Indianapolis. *Columbus, Indiana: The Preservationist's Perspective.*

Reaching Out and Bringing In: Understanding and Encouraging Diversity In the Library

**SANTE FE**

How can art and architecture librarians work to serve increasingly diverse user populations? This session will address how to identify such populations, understand their needs, and create effective programs and services. The session will begin with an overview of diverse populations one may encounter in the contemporary library, including minority, international, and nontraditional students. A presentation of recent research examines how perceived differences in gender and ethnicity affect the provision of electronic reference services. Finally, recent efforts to create outreach programming for underrepresented students in architecture and urban planning will be discussed. Attendees will leave this session with an understanding of recent research on serving diverse populations and valuable ideas for creating new programs and services at their own institutions.

**Moderator:**

Laura Haxer, Digital Resources Librarian, Harrington College of Design

**Speakers:**

Dorothy Tao, Associate Librarian, Architecture, Planning, and Visual Arts, State University of New York at Buffalo. *Who are the Diverse User Groups in the 21<sup>st</sup> Century Library? What Do We Know About Them? How Can We Better Serve Them?*

Pnina Shachaf, Ph.D., Assistant Professor of Library and Information Science, School of Library and Information Science, Indiana University Bloomington. *Are Virtual Reference Services Color Blind?*

Meredith Kahn, University Library Associate, Art, Architecture & Engineering Library, University of Michigan. *Intersecting Paths and Building Relationships: Outreach Programming for Underrepresented Students in Architecture & Urban Planning*

**2:00-6:00PM**

Web 2.0 Kiosk Open

Generously Sponsored by J. Paul Getty Trust

A crew of tech-savvy and dedicated volunteers will help you try your hand at using a Web 2.0 Technology. Find out with what all the buzz is about and try your hand at blogging, flickr, RSS feeds, wikis, and even a tweet or two. Discover tricks and tools and walk away with hands-on experience and knowledge of how the world of art information is changing.

**3:30-3:45PM**

Break

**EXHIBITS HALL**

**3:45-5:15PM SESSIONS**

Discovery on this Side of the Virtual Wall: Evolving Authority Control Resources and Techniques in the Digital Age

**MARRIOTT 7/8**

Generously Sponsored by Duncan System Specialists Inc.

The session intends to present how, in the process of creating and maintaining authority control, art information specialists working with both print and visual media discover new resources and research tools to employ and integrate, and even invent some; how they not only strive to provide access for users, but how they themselves are users of resources provided by the applications of new technologies; how the process of discovery is part of their research work as well as it is essential for library users; how new technologies can be best streamlined for facilitating serious research as opposed to Google's "Whole Universe"; how to reasonably incorporate the "unstructured" (social tagging) into structured standards (LC, ULAN, Getty Vocabularies, Thesauri, etc.)

**Moderator:**

Rodica Tanjala Krauss, Frick Art Reference Library, Head, Cataloging Projects

**Speakers:**

Sherman Clarke, Head of Original Cataloging (to December 2008), New York University Libraries. *How do you say 'new' in a useful way?*

Mark Bresnan, Frick Art Reference Library, Head, Bibliographic Records. *Name authorities: the widening gyre*

Patricia Harpring, PhD, Getty Vocabulary Program, Managing Editor. *Cultural Objects Name Authority (CONA): A new Getty vocabulary in development*

Susan Chun, Cultural Heritage Consultant; Founder and Project Lead, *steve Project. Social Tagging: Implications for Cultural Heritage Professionals*

If You Sit There, Will They Come?  
The Changing Reference Landscape

**MARRIOTT 9/10**

This "Ask ARLIS" session will focus on several aspects of how technology has impacted reference, and how reference service is evolving, and emerging as a result of available or adaptable technologies.

**Moderator:**

Linda Seckelson, Principal Reader Services Librarian, Thomas J. Watson Library, The Metropolitan Museum of Art.

**Speakers:**

Linda Seckelson, Principal Reader Services Librarian, Thomas J. Watson Library, The Metropolitan Museum of Art. *Challenges, Tensions and New Patterns of Service: an Overview*

Karen Bucky, Collections Access and Reference Librarian, Sterling and Francine Clark Art Institute. *Reference Service in Art Libraries: Who is Being Served, And How?*

Louis V. Adrean, Senior Librarian for Reader and Circulation Services, Ingalls Library, Cleveland Museum of Art. *Technology = Outreach: New Programming for Art Museum Library Patrons*

Trudy Buxton Jacoby, Director, Visual Resources Collection, Art and Architecture Department, Princeton University. *Collaborative Image Use in the New Visual Resources Environment: Blurring Traditional Lines*

Jennifer Laherty, Reference/Digital Services Librarian, Indiana University Bloomington Libraries. *Virtual and Chat Reference: Trends, Trials, Tributes*

Women Artists and Technology: Strategies for Capturing and Archiving the Cyber-Feminist Voice

**SANTE FE**

As Web 2.0 technologies such as blogs have empowered and given voice to the people, they have provided a means to build communities around modes of thought, express the opinions of the anonymous individual, and strip expression of sexuality. This panel will explore this level of content creation by women artists, who now have critical voices and collective power. It will also feature practitioners who use these tools to bring communities together around exhibitions, engaging their audiences beyond the gallery wall and closing date of the exhibition. As librarians are challenged to work with new forms of content and be more actively involved in the creation cycle, this panel will explore the implications of a gendered voice and the role sexuality has in content creation.

**Moderator:**

Sarah Falls, User Services Specialist, ARTstor

**Speakers:**

Arezoo Moseni, Senior Art Librarian, New York Public Library. *How does cyberspace as a "third place" influence the way we look at and interpret art?*

Sue Maberry, Director of the Library and Instructional Technology, Otis College of Art and Design. *Using technology to preserve the history of the Woman's Building*

Hana Iverson, Director, Neighborhood Narratives, Rutgers, the State University of New Jersey. *The tension between traditional notions of the archive and preservation customary to the analog context of library practice (and its digital counterpoint) versus the open, ephemeral information systems of web 2.0*

**5:15-6:15PM**

PRATT – SILS REUNION

**DENVER**

Generously Sponsored by Pratt School of Information and Library Science. Many thanks to Dean Tula Giannini for encouraging and supporting this Pratt gathering.

A reception for alumni and current students from Pratt School of Information and Library Science. It will be a great opportunity to see old and new colleagues and friends. Food and drink will be served.

**6:00-7:00PM**

Silent Auction and Happy Hour / Networking in the Exhibits

**EXHIBITS HALL**

The Silent Auction is a fun-filled way to raise funds for the Society. Individuals, Chapters, and generous vendors donate a tempting assortment of gift baskets, artwork, books, and other valuable and desirable items to offer for auction. Take some time to view all the donations displayed in the Exhibit Hall and make a bid on your favorite items.

**6:00-8:00PM**

Dinner (self-scheduled)

**6:00-8:00PM**

## Society Circle Reception at the Herron Art Gallery (Invitation Only)

**HERRON ART GALLERY, IUPUI (Walking Distance from the Hotel)**

Generously Sponsored by Herron School of Art and Design, and the IUPUI University Library

The Society Circle was formed in 2003 to serve as the fundraising arm of the organization. Each year an event is offered for Society Circle members. If you're not already a member, consider joining. For more information about the Society Circle and becoming a member, please visit, <http://www.arlisna.org/about/supporting.html>. Our special fundraising event at this year's conference will be held April 18<sup>th</sup>, 6:00-8:00pm at the newly constructed Herron School of Art and Design, <http://www.herron.iupui.edu> on the IUPUI campus. The Herron School of Art and Design is conveniently located approximately 5 blocks from the conference hotel.

The Herron School of Art and Design has graciously and generously opened the Herron Grand Hall and Main Gallery, the Eleanor Prest Reese and Robert B. Berkshire Galleries, to our Society Circle members attending this special event. Artist, Marie Krane Bergman's work will be on view throughout the Main Gallery. Outside the galleries and located in the Herron Grand Hall, members will enjoy a light array of hors d'oeuvres, cash bar, and jazz soloist to complete the event's festivities.

**8:00-10:00PM**

## Indiana University Reunion Honoring Betty Jo Irvine

**DENVER**

Generously Sponsored by the School of Library and Information Science, Indiana University

**Organizers:**

Sarah Carter and Kristen Mastel

Betty Jo Irvine served as the Head of the Fine Arts Library at Indiana University for 41 years before her retirement in 2007. In addition to providing formal instruction in the Seminar in Art Librarianship and Research Sources in Art History courses, she also mentored dozens of students, employees, and co-workers throughout their professional careers.

The Indiana Reunion is open to "all Irvinites - former students, employees, associates, IU alums, etc." The reunion will feature refreshments, good fellowship, and a slide show of days gone by.

**SUNDAY, APRIL 19<sup>TH</sup>****7:00-7:45AM**

## Circle City Yoga

**DENVER**

Wake up your body and mind with a series of gentle stretches based on Yoga and related systems of exercise (Qigong). Practice includes both deep breathing and positions of physical ease. These 45-minute morning sessions are planned for those with or without prior Yoga or Qigong experience.

Led by BJ Kish Irvine

**7:00-8:00AM**

## White River Bird Watching

*Meet in Hotel Lobby 15 minutes before departure time*

Join fellow birders for a brisk morning walk along the White River State park promenade to do some urban / spring migration bird watching along the river. April is a peak time in Indianapolis for sighting a variety of migrating birds of the Mississippi Flyway as they stop along their journey to the Great lakes and Canada. We may get to see the resident peregrine falcons in action- if not on their " falconcam"? web site as they will be nesting on one of our bank buildings.

Led by Jennifer Hehman, member of the local Amos Butler Audubon Society

**8:00AM-5:30PM**

## Registration and Information Desks open

**8:00AM-4:30PM**

## Internet Café Open

**EXHIBITS FOYER**

Generously Sponsored by AskART

**8:30-9:30AM**

## Avery/IBA/Getty User Group Breakfast Meeting

**MARRIOTT 7/8**

## ContentDM User Group Meeting

**SANTE FE****9:30-10:45AM**

## Sunday Morning Coffee with the Exhibitors

**EXHIBITS HALL**

Generously Sponsored by Erasmus

Enjoy refreshments and spend some quality time with our exhibitors.

**9:30-11:00AM**

Exhibits Open (No Conflict)

**9:30-12:30PM**

Web 2.0 Kiosk Open

**EXHIBITS HALL**

Generously Sponsored by J. Paul Getty Trust

A crew of tech-savvy and dedicated volunteers will help you try your hand at using a Web 2.0 Technology. Find out what all the buzz is about and try your hand at blogging, flickr, RSS feeds, wikis, and even a tweet or two. Discover tricks and tools and walk away with hands-on experience and knowledge of how the world of art information is changing.

**10:00-11:00AM**

Silent Auction Finale

**EXHIBITS HALL**

Don't miss the Silent Auction finale on Sunday morning when the competition for items gets fast and furious!

The Silent Auction is a fun-filled way to raise funds for the Society. Individuals, Chapters, and generous vendors donate a tempting assortment of gift baskets, artwork, books, and other valuable and desirable items to offer for auction. Take some time to view all the donations displayed in the Exhibit Hall, scout out the competition, and race to make the final bid on your favorite items.

**11:00-12:30PM SESSIONS**

Working Together, Working Better: Liaison Relationships for Art, Architecture, and Visual Resources

**MARRIOTT 7/8**

Liaison relationships—our collaborative and communicative associations with departments and teaching faculty—form an important part of academic librarians' job duties. Despite the need to work closely with your department's students and faculty, developing and maintaining effective liaison relationships can be challenging. This session will provide practical advice for librarians seeking to work in concert with their users to provide better services. Attendees will hear about liaison relationships in different contexts, learn methods for developing and maintaining such relationships, as well as common challenges faced by librarians with liaison duties. Participants include mid-career professionals and a new librarian from a range of disciplines, including art, architecture, and visual resources. Speakers will discuss the evolution of liaison roles, models such as the field librarian or college librarian, how to balance the needs of the library and the needs of the unit you serve, and the need to redefine professional roles in the wake of increased access to electronic resources (particularly for images).

**Moderator:**

Meredith Kahn, University Library Associate, Art, Architecture & Engineering Library, University of Michigan

**Speakers:**

Deborah K. Ultan Boudewyns, Art, Architecture, and Landscape Architecture Librarian, University of Minnesota. *Librarians and Their Evolving Identity*

Annette Haines, Art & Design Field Librarian, Art, Architecture & Engineering Library, University of Michigan. *The Home Turf Advantage: An Art & Design Field Librarian's Liaison Experiences*

Leanne Hindmarch, Architecture and Environmental Design Librarian, California Polytechnic State University (Cal Poly). *Liaison Relationships in Practice: Connecting with Architecture Faculty in a Polytechnic Environment*

Elaine Paul, Curator, Visual Resources Collection, Department of Art & Art History, University of Colorado, Boulder. *Transformational Change: Visual Resources Curators, Collections, and Users in a New Era*

The Future of Art Journals

**MARRIOTT 9/10**

This session will consider the future of art journals and whether this format still would be viable in a digital world. It's not that we don't have born-digital examples of art journals but the content and the intent for these seems quite different from the standard paper journals with which we are most familiar. Will these paper journals be able to transition into a digital format? What will be lost and what will be gained? Who will pay the costs? We know that newspapers are struggling to find subscribers and it seems to me that we may find that our journals may suffer the same fate. Who will support the publications when advertisers no longer find there is an identifiable readership? If the journals themselves are in jeopardy, what about periodical indexes and abstracting services? Can we forecast what these changes are and how they will affect library resources?

**Moderator:**

Tammy Ravas, Fine Arts Librarian and Media Coordinator, University of Montana

**Speakers:**

Adam Robinson, Graduate School of Library & Information Science, Simmons College. *The University of Kansas "Print versus E-Journal" Comparison Study*

Tammy Ravas, Fine Arts Librarian and Media Coordinator, University of Montana & Steve McCann, Digital Projects Librarian, University of Montana. *Hurting or Helping? Image Quality in Online Art History Journals*

Margaret Richter, Editor of Art Full Text and Humanities Full Text, H.W. Wilson Company. *Paper rules? Continuity and change in the 21st century art journal*



## Computerized Gaming in Libraries and the Academy: Collections Development, Service Provision and Future Directions

### SANTE FE

Computerized gaming as a field of academic pursuit as well as an object of library collections development and service provision is no longer in its infancy, with greater numbers of learners and scholars having been exposed in some way to various aspects of computerized gaming for several decades. In this panel, we will examine issues surrounding cataloging and organization of gaming collections in libraries, hearing about the development of one of the nation's first such archives at the University of Michigan's Art & Engineering Library from librarian David Carter. We will take a look at how gaming/3-D spaces provide not only education and entertainment; they can have functions extending far beyond this into the realm of art and library service provision, as discussed by Dr. Daniel Riha. Finally, we will hear how a veteran game developer and Assistant Professor of Telecommunications at Indiana University, Dr. Lee Sheldon, views the future of the field both in and beyond the Ivory Tower.

#### Moderator:

Stephanie Krueger, Associate Director for Library Relations, ARTstor

#### Speakers:

Dr. Daniel Riha, Charles University, Prague & Inter-net. *3-D Virtual Community in the Library Setting*

David Carter, University of Michigan. *Michigan's Gaming Archive*

Lee Sheldon, Department of Telecommunications, Indiana University Bloomington. *The Future of Gaming*

### 12:30-2:00PM

Exhibits Closed for Lunch

### 12:30-2:00PM

## Architecture Section Meeting

### AUSTIN/BOSTON

#### Moderators:

Alan Michelson (outgoing)

Patti Cossard (incoming)

## Cataloging Section Meeting

### MARRIOTT 7/8

#### Moderators:

James Phillip Ascher (outgoing)

Lori Van Deman (incoming)

## RISS Section Meeting

### SANTE FE

#### Moderators:

Rebecca Friedman (outgoing)

Incoming TBD

### 2:00-3:30PM SESSIONS

## From Courthouse to Modern House: Historic Preservation in Indiana

### SANTE FE

Historic preservation today means education, advocacy, and the conservation and restoration of everything from historic buildings and landscapes to works of modern architecture. A wide range of these efforts and issues play out in Indiana, the home of historic courthouses, the city of Columbus, one of the finest and best appreciated collections of modern architecture in the country—and a vibrant preservation network. In this session we will hear from educators and professionals in the field who will review the historic preservation movement in Indiana, describe the state's resources for historic preservation, and illustrate how they interact to provide historic preservation advocacy that is a model across the United States. Specific examples of education and advocacy will be addressed through discussion of the American Grand Tour Project for environmental design students and the work of the Landmarks of the Recent Past Committee of the Historic Landmarks Foundation of Indiana in raising public awareness about preserving modern architecture.

#### Moderator:

Amy Trendler, Architecture Librarian, Ball State University

#### Speakers:

Duncan Campbell, Director, Graduate Program in Historic Preservation, Associate Professor, Department of Architecture, Ball State University. *Preserving Indiana, A National Model*

Joseph C. Blalock Jr., ASLA, Associate Professor of Landscape Architecture, Ball State University. *The American Grand Tour Technologies: Wiki and Google Earth Integration for Investigating Place*

Mark Dollase, Vice President of Preservation Services and Director, Central Regional Office, Historic Landmarks Foundation of Indiana. *The New Mod Squad: Saving Indiana's Finest Modern Landmarks*

## Off the Wall: Photography Beyond Aesthetics

**MARRIOTT 9/10**

Art librarians with interest in photography deal with an expansive subject, extending far beyond the traditional boundaries of art and aesthetics. Since the invention of photography in 1839, the medium has served innumerable disciplines—from science to fashion, from forensics to the occult—categories not normally associated with art librarianship. Our speakers will address some of those endeavors today, presenting photography never intended for the gallery wall. Originally found in the newspaper or illustrated essay, the tabloids, the police files, the amateur's shoebox, or even in a plain brown paper wrapper—these photographs are now collected in our museums, hanging in our galleries, and researched in our institutions.

**Moderator:**

Laura T. Harris, Associate Museum Librarian, Joyce F. Menschel Library/Dept. of Photographs, Metropolitan Museum of Art.

**Speakers:**

Claude Cookman, Associate Professor, School of Journalism, Indiana University Bloomington. *A love letter and wish list from a photographic historian*

Martin Krause, Curator of Prints, Drawings and Photographs, Indianapolis Museum of Art. *An Enduring Present: Photography's Gift*

Jennifer Pearson Yamashiro, Assistant Professor, History of Art, Miami University Hamilton. *Menage à Trois: Science, Sex and Art*

## Image Copyright in a Digital World

**MARRIOTT 7/8**

How does current copyright law apply to visual works and works (such as most art publications) that contain both visual and textual material? How should copyright apply to digital images? For more than ten years, impassioned voices from stakeholders in the copyright arena have proposed major revisions to current copyright law that would significantly alter the landscape of image copyright - from "orphan works" legislation to changes of the section 108 of the U.S. Copyright Act that specifies exemptions allowing for libraries, museums and archives to make copies of protected works. As the U.S. Congress continues to examine the proposals, the needs and wishes of libraries, museums and archives must be weighed against the rights of creators and owners of protected works. At the same time, the movement to provide "open access" to scholarly materials has given rise to initiatives such as the Scholarly Publishing and Academic Resources Coalition (SPARC). How can the competing needs for control and dissemination—particularly with regard to visual materials—be reconciled in the current copyright environment?

As art information specialists, we must be aware of the ways these changes could affect our institutions' policies and services. This panel session continues the ARLIS/NA Public Policy Committee's examination of major aspects of copyright in the digital age by focusing on issues specific to copyright and use of visual materials. Representatives from the creative arts, museum, and academic research communities will have a chance to express their own views on image copyright and to suggest ways in which art information specialists can work with existing laws.

**Moderators:**

Marilyn Russell, Library Director, Haskell Indian Nations University

Lawrence, Kansas

Roger Lawson, Administrative Librarian, National Gallery of Art, Washington, D.C.

**Speakers:**

Todd Joyce, National President, American Society of Media Photographers. *Copyright Law and the Creator's Ability to Profit from Intellectual Property*

Ruth V. Roberts, Coordinator of Rights & Reproductions, Indianapolis Museum of Art, Indianapolis, Indiana. *Museums and New Technologies – Do the Old Copyright Rules Still Apply to the New Applications of Images?*

Madelyn F. Wessel, Special Advisor/Liaison to the General Counsel, University of Virginia, Charlottesville, Virginia. *The New Cases and Legal Standards for the Fair Use of Images in Teaching, Research and Scholarship*

**2:00-4:00PM**

Exhibits, with final closing at 4:00pm

**EXHIBIT HALL**

**3:30-3:45PM**

Break

**3:45-5:15PM SESSIONS**

Hot and Bothered: Erotica in the Library and Museum Context

**MARRIOTT 9/10**

This session will discuss the subject of erotica in both the museum and library setting from differing perspectives. Speakers will include representatives from The Kinsey Institute (University of Indiana), The Leather Archives and Museum (Chicago), and the Tom of Finland Foundation (Los Angeles). In addition, a librarian from the University of British Columbia who will discuss the role of the art librarian in the development of cultural understanding of sexuality and cultural development at large.

**Moderator:**

Ray Anne Lockard, Bibliographer and Public Services Librarian, Frick Fine Arts Library, University of Pittsburgh

**Speakers:**

Allison R. Schulte, Librarian, Tom of Finland Foundation. *Promoting "Information Cruising" at the Tom of Finland Foundation*

Rick Storer, Executive Director, Leather Archives & Museum. *Sexuality collections of The Leather Archives & Museum*

Liana Zhou, Director of Library and Archives, The Kinsey Institute, Indiana University. *The Scientific Pursuit of Erotica: Alfred C. Kinsey's vision and the Collections of the Kinsey Institute for Research in Sex, Gender and Reproduction*

Kevin Madill, Circulation Manager, Borrower Services, Walter C. Koerner Library, University of British Columbia. *Sticky Pages: Revving Up A Particular Engine In The Fine Arts Library*

## New Voices in the Profession, 2009

**SANTE FE**

For the fourth year, this session will showcase emerging professionals in Art and Visual Resources Librarianship. The topics reveal new ways of thinking about old problems, as well as up-and-coming ideas, and give the membership a glimpse of the academic interests and current discourse of the newest members of ARLIS/NA.

**Moderator:**

Sarah Falls, User Services Specialist, ARTstor

**Speakers:**

Maureen Whalen, 2008 Gerd Muesham Award Winner. Associate General Counsel, The J. Paul Getty Trust. MLIS, University of California, Los Angeles (2008). *What's Wrong with This Picture? An examination of art historian's attitudes about electronic publishing opportunities and the consequences of their continuing love affair with print*

Erin Wilkins, MLIS, University of Pittsburgh, 2008. *Mapping the Universe: Potential Applications for Information Visualization Systems in Libraries*

Kathleen C. Lonbom, Art Librarian, Milner Library, Illinois State University and Sheila Majumdar, student, School of Art, Illinois State University. *Discovering & Uncovering the Voice of a Silenced Collection: The Art of a Child, a Historic Perspective*

Megan Lotts, Assistant Professor- Fine Arts Librarian, Southern Illinois University at Carbondale. *i-pARTicipate: a green friendly Fine Arts Information Literacy program at Southern Illinois University Carbondale*

## Visual Literacy: What, Why, How?

**MARRIOTT 7/8**

This session will discuss visual literacy in the context of 21st century literacies. A visual literacy rubric will be discussed based upon the ACRL Information Literacy Standards and constructivist approaches to learning. Presenters will describe and demonstrate specific visual literacy tools, and discuss assessment of specific visual literacy implementations.

**Moderator:**

Barbara Rockenbach, Director of Undergraduate & Library Research Education, Yale University

**Speakers:**

Barbara Rockenbach, Director of Undergraduate & Library Research Education, Yale University. *Viewing the Visual Literacy Landscape*

Carole Ann Fabian, Planning, Outreach & Communications Officer, ARTstor. *Critical viewing: understanding the visual*

Ian McDermott, Assistant Librarian, Yale Center for British Art. *Ways of Seeing: Visual Literacy at Yale University Library*

**5:45PM**

## Transportation to Indianapolis Museum of Art

Shuttles to the IMA will depart from the West Entrance (Missouri Street) beginning at 5:40. Last bus for the IMA will depart the Hotel at 6:30pm.

**6:00-9:00PM**

## Circle City Celebration at the Indianapolis Museum of Art

**INDIANAPOLIS MUSEUM OF ART**

Generously Sponsored by the Indianapolis Museum of Art

Enjoy hors d'oeuvres and network with colleagues while you experience the view from the IMA's Pulliam Great Hall that includes Robert Irwin's *Light and Space III* and Sol Lewitt's *Wall Drawing 652, Continuous Forms With Color Acrylic Washes Superimposed*. Attendees will also be able to visit the special exhibition: *European Design Since 1985: Shaping the New Century* as well as the first floor galleries, museum shop, and the new Design Center.

**9:15PM**

Last return shuttles depart at 9:20pm

**MONDAY, APRIL 20<sup>TH</sup>, 2009****7:00-7:45AM**

## Circle City Yoga

**DENVER**

Wake up your body and mind with a series of gentle stretches based on Yoga and related systems of exercise (Qigong). Practice includes both deep breathing and positions of physical ease. These 45-minute morning sessions are planned for those with or without prior Yoga or Qigong experience.

Led by BJ Kish Irvine

**8:00-5:00PM**

## Information Desk open

**8:00-10:00AM**

## Membership Meeting with Breakfast

**MARRIOTT 2/4**

All members are invited to our annual meeting. You'll hear updates about the Society's activities from this year and hopes and plans for the coming year and our new officers will take the helm. A highlight of the meeting will be an introduction to Boston, site of our conference in 2010.

**8:00AM-12:00PM**

Internet Café Open

**EXHIBITS FOYER**

Generously Sponsored by AskArt

**10:00-10:15AM**

Break

**10:15-11:45AM SESSIONS**

Integrating Resources through Collaborative Convergence

**MARRIOTT 7/8**

The quantity, accessibility and deliverability of resources in the last decade have changed the way users interact with online catalogs containing images, audio, video and text. Faculty and departmental collections, library, museum and gallery materials, can now be merged together to facilitate cross collection searching. Integrating new content like GIS information and utilizing web 2.0 tools such as blogs, wikis, Flickr, iTunes and more, enable users to combine many types of information, create groups and network with one another. User annotation of items also increases access to the content in the classroom and beyond. Collaboration is a key part of bringing these materials (and the people involved) together and results in a wonderful convergence, from African films, to urban design to immigration research, all playing together in a union catalog and benefiting from each collection owner's expertise. Each speaker will discuss specific tools and case studies related to the convergence of technology and content, but will also talk about the broad concepts underlying these structures which can be brought back and utilized in your own institution.

**Moderators:**

Jodie Double, Director of Digital Collections and Archives / Curator, Digital Collections + Archives Unit, College of Design, University of Minnesota

Rebecca Moss, Coordinator of Visual Resources, Office of Information Technology, College of Liberal Arts, University of Minnesota

**Speakers:**

Jodie Double, Director of Digital Collections and Archives / Curator, Digital Collections + Archives Unit, College of Design, University of Minnesota. *Exploring ways to incorporate and explore GIS and related technologies into catalogs*

Rebecca Moss, Coordinator of Visual Resources, Office of Information Technology, College of Liberal Arts, University of Minnesota. *Exploring the use of new technologies such as Tineye, PicLens, IM and Twitter to help us find and identify images and then share the results*

Elizabeth Schaub, Director, Visual Resources Collection, School of Architecture, The University of Texas at Austin. *Outlining the process of identifying appropriate Web 2.0 technologies for a visual resources environment and providing examples of the successful implementation of a swiki, wiki, Flickr group, and blog*

Betha Whitlow, Curator of Visual Resources, Washington University in Saint Louis. *Exploring the impact of Web 2.0 on our faculty constituents, and present strategies for integrating them into a Web 2.0 age through the use of Flickr, Facebook, RSS, Zotero, Google Docs and other technologies*

Indiana Innovations: Traditional and Modern Decorative Arts

**AUSTIN/BOSTON**

This panel will discuss and illustrate style and innovations from Indiana to exemplify the circle of design from traditional to modern. Traditional techniques inform modern design; modern techniques contribute to the ongoing production of traditional craft and design. Four distinct components will be addressed in this session: quilts, ceramics, furniture and glass. This program will showcase historic and modern creativity and decorative arts and design innovations representative of Indiana and the region.

**Moderator:**

Kathy Woodrell, Reference Specialist, Decorative Arts, Humanities & Social Sciences Division, Library of Congress

**Speakers:**

Mary Jane Teeters-Eichacker, Curator of Social History, Indiana State Museum. *Indiana's Quilting Heritage: Amish and "English" Quilts in the Indiana State Museum*

Peter Blume, Director of the Ball State University Museum of Art, Muncie, Indiana. *The Creation and Nurture of Studio Potters in and sometimes of Indiana*

David Buchanan, Curator of Decorative Objects and Furniture, Indiana State Museum. *Adventurous Excess and Clear Design - William S. Wooton and Charles Hollis Jones*

Lisa Pelo-McNiece, Department Head, Glass Studio, The Indianapolis Art Center. *Temperature Rising: Hot Glass of Indiana and Contemporary Counterparts*

Where Libraries and Archives Converge: Artists Files

**MARRIOTT 9/10**

Generously Sponsored by Richard Minsky

Artist files, which contain unique combinations of materials and ephemera such as pamphlets, correspondence, and postcards, are collected and held in many art research libraries. These files contain resources that document well established artists as well as lesser known artists who are poorly documented elsewhere. When accessible, artist files have the potential to be among the most valued and heavily used resources in art research facilities. However, the uniqueness of the material, limited cataloging staff, and lack of technical or administrative support have traditionally limited the ability for libraries to make artist files readily accessible. This session will explore several questions regarding artist files at this juncture: Does the electronic age allow artist files to play a new role in libraries and if so why are they not more accessible than ever? How are researchers using artist files? In a time when libraries are focusing their budgets on online resources produced by vendors instead of on printed resources, this session discuss three examples of institutions providing improved access to artist files found in libraries.

**Moderator:**

Jon Evans, Reference Librarian, Hirsch Library, Museum of Fine Arts, Houston

**Speakers:**

Kraig Binkowski, Head Librarian, Reference Library and Photograph Archive, Yale Center for British Art. *Introduction to Artist Files: Definitions and Broad Context*

Francine Snyder, Manager of Library and Archives, Solomon R. Guggenheim Museum, NYC. *Artist Files in the institution: MARC21 and EAD cataloging, a convergence of Library and Archives standards*

Samantha Deutch, Research and Program Manager, Center for the History of Collecting in America, The Frick Art Collection & Frick Art Reference Library, NYC. *Artist Files in Research: the Center for the History of Collecting in America's Directory, a convergence of disciplines and institutions*

Sally McKay, Associate Reference Librarian, Research Library, Getty Research Institute, Los Angeles, CA and Barbara Rominski, Head Librarian, San Francisco Museum of Modern Art. *Artist Files aggregated: The Artist Files Online Directory*

**12:00-1:30PM**

ARTstor User Group Lunch Meeting

**MARRIOTT 2/4**

RLG User Group Meeting

**DENVER**

Scipio User Group Meeting

**AUSTIN/BOSTON****12:00-2:00PM**

Lunch

**2:00-3:00PM SESSION**

Closing Plenary Session

Bigger, Bolder and More Beautiful: Cultural Development and Urban Design in Indianapolis, with Guest Speaker Brian Payne

**MARRIOTT 7/8**

How does a City re-invent itself culturally? Brian Payne, President of the Central Indiana Community Foundation and the Indianapolis Foundation will address current issues of Urban Planning, the Arts, and the development of the Indianapolis Cultural Trail. The Indianapolis Cultural Trail: A Legacy of Gene & Marilyn Glick is a world-class urban bike and pedestrian path that connects neighborhoods, Cultural Districts and entertainment amenities, and serves as the downtown hub for the entire central Indiana greenway system.

The five downtown cultural districts connected by the Indianapolis Cultural Trail include Fountain Square, Indiana Avenue, Mass Ave, The Canal & White River State Park, and the Wholesale District. The Cultural Trail will also connect with the

Monon Trail, allowing visitors easy access to Broad Ripple Village from downtown. The Cultural Trail is made possible by a large public and private collaboration led by Central Indiana Community Foundation, the City of Indianapolis and several not-for-profit organizations devoted to building a better city. The Central Indiana Community Foundation (CICF) provides leadership on community issues like helping families overcome obstacles, creating great public spaces, and embracing our ethnic communities. <http://www.indyculturaltrail.org/about.html>

**Guest Speaker:**

Brian Payne, President of the Central Indiana Community Foundation and The Indianapolis Foundation

**3:00-3:30PM**

Coffee Break in the Exhibits

**EXHIBIT HALL****3:30-5:00PM SESSIONS**

When Worlds Collide: the Journey from Here to Where in VR

**MARRIOTT 7/8**

This session will explore the processes involved as visual resources (or other types of) collections are integrated into a larger institutional structure in response to changes in the focus and the delivery of the collection. How and why is change initiated? What happens when institutional change is mandated? Who are the stake holders and how do they negotiate and influence this process? How are productive collaborations formed and developed among staff who originated in diverse administrative units? How are new services implemented while critical aspects of the older paradigms are preserved? How do we think "outside the box" when crafting new solutions?

**Moderator:**

Margaret Webster, Director, Knight Visual Resources Facility, Cornell University

**Speakers:**

Margaret Webster: Director, Knight Visual Resources Facility, Cornell University. *When Change Comes Knocking*

Jolene de Verges, Images Librarian, Rotch Library of Architecture and Planning, MIT. *The Ying and the Yang: Stand Alone Versus Integrated Visual Resources Collections*

Katie Keller, Combined Reference Librarian and VRC Cataloger, Stanford University. *Changing Course: Navigating in New Terrain*

Gary Ginther, Head, Fine Arts Library, Ohio University. *VR Races Back to the Art Library and Makes a Speedy Recovery*



## Why is that Column in the Middle of the Room: Designing Functional, Flexible, and Forging Spaces for Library Instruction

### MARRIOTT 9/10

As hands-on instruction becomes essential in the information literacy curriculum, librarians and library administrators must plan spaces that support their instructional needs and nurture those needs through responsive design decisions. To be effective, libraries must move toward locating, designing, equipping, and furnishing functional, flexible, and comfortable electronic classrooms. Whether or not an architect is available for assistance, essential criteria must be considered. The process often begins with anxious questions: What is the right space for library instruction? How do we propose a project of that magnitude? What happens if the architect doesn't listen to us? Can we do this on our own, without an architect? Do we want fixed seating? What type of equipment is needed? What should the capacity be? These and other questions need to be addressed in creating dedicated instructional spaces within or near a library. With the increasing demand for electronic classrooms and the measurable benefit smart classrooms have in effective information literacy instruction; our first need is to define the components of the smart classroom. This session will illustrate prototypes for shaping learning spaces to respond to changing learning needs. Discover how to get started and what questions to ask for a plan that insures success. The panel, which will comprise an architect of spaces for higher education and experts in instructional technologies, will address the design process from multiple perspectives.

#### Moderator:

Tony White, Head, Fine Arts Library, Indiana University Bloomington.

#### Organizer:

Paul Glassman, Director of the Library, Felician College, Lodi, New Jersey

#### Speakers:

Paul Glassman, Director of the Library, Felician College, Lodi, New Jersey. (Paper will be read by Tony White). *Design for Learning: Success in Creating Library Instruction Classrooms*

Anastasia S. Morrone, Ph.D., Associate Dean, Learning Technologies, Indiana University-Purdue University, Indianapolis. *Innovation in the Classroom: How to Use Technology to Transform Learning*

Julianne M. Miranda, Senior Director of Instructional Technology and Media Services, Butler University, Indianapolis. *Integrating Information Technology into the Curriculum*

Winifrid Williams, AIA, K. R. Montgomery & Associates, Anderson, Indiana. *Fundamentals of Classroom Design: Notes from the Field*

## A Convergence of Disciplines: Mapping a path through Unfamiliar Territories in Urban Planning

### AUSTIN/BOSTON

Urban Planning librarians often find themselves embarking on journeys into unknown and seemingly uncharted territories with their students and faculty. The multi-disciplinarity of the field requires that we be familiar with or, at the very least, aware of resources in neighboring fields. Just a few of the areas our faculty and students need to investigate and understand include business, geographic information systems, maps, government documents, numeric and spatial data generation and manipulation, social work, public policy, and environmental studies. This session brings together librarians who specialize in some of these areas to tell us about the best resources and the strategies for getting the most from them. In addition, an urban planning professor will speak to us about how they and their students explore these divergent fields and how we can best help them map a path for their explorations.

#### Moderator:

Rebecca Price, Architecture, Urban Planning & Visual Resources Librarian, University of Michigan

#### Speakers:

Steven Sowell, Assoc. Librarian and Head, Business/SPEA Information Commons, Indiana University Bloomington. *Remaining Relevant: Lessons and Strategies for Providing Library Services in a Multi-disciplinary Environment*

Jennifer Green, Spatial and Numeric Data Librarian, University of Michigan. *Becoming a Step in the Process: Embedded Data Librarians*

Prof. Francis Parker, Professor of Urban Planning, Ball State University. *The Faculty Perspective: Urban Planning Research and Practice*

### 5:00-6:00PM

CPAC meeting

### AUSTIN/BOSTON

### 5:00-6:00PM

Chapter Chairs Meeting

### MARRIOTT 9/10

### 6:00-8:30PM

Post Conference Executive Board Meeting

### DENVER

### 6:00PM

Dinner (on your own)

**TUESDAY, APRIL 21, 2009****9:00-11:00AM****WORKSHOP****Mashups****IUPUI UNIVERSITY LIBRARY, 755 WEST MICHIGAN STREET, ROOM UL-1130****(Walking Distance from the Hotel)**

Creating a mashup is a great way to introduce information visually – all you need is a good idea. This hands-on workshop will introduce mash-ups and examine how they can be beneficial to art libraries. We'll also walk through the steps of making simple mash-ups of our very own. Participants are encouraged to think about materials from a local institution, environment, or collection they'd like to work with and to bring a few images with them to the session. Demonstrations will include creating mashups for Manhattan, local Indianapolis restaurants and amenities, African masquerade locations, and IU's Cushman image collection.

**Workshop Leader:**

Eileen Fry, Image Librarian, Indiana University Bloomington

**Workshop Contributor:**

Amy M. Griffin, Circulation Supervisor, Fine Arts Library and Instruction Assistant, Undergraduate Libraries, Indiana University Bloomington

**TOURS**

*Please meet in the Hotel Lobby WEST ENTRANCE (Missouri Street) at least 15 minutes before departure time*

**8:00-5:00PM**

Bloomington Treasures: Kinsey Institute, Lilly Library, Benton Murals, IU Art Museum, Wells Library Information Commons, Fine Arts Library

*(Includes transportation time between Indianapolis and Bloomington. Lunch is provided. Will stop at Indianapolis Airport on return trip)*

Generously Sponsored by Indiana University Library, Bloomington

**8:00-5:00PM**

Architecture of Columbus, Indiana

*(Includes transportation time between Indianapolis and Columbus. Lunch is provided. Will stop at Indianapolis Airport on return trip)*

**10:00-12:00PM**

Indiana History Center

**ART BOOKS & EXHIBITION CATALOGUES**  
**Art • Architecture • Photography • Design**

Recognized as a leading specialist in the distribution of exhibition catalogues and other art books, Worldwide Books offers libraries flexible, expertly administered approval plans and reliable firm order services.

Each month we select hundreds of new exhibition catalogues and currently stock nearly 30,000 titles published since the 1960s by museums and galleries throughout the world. We also offer comprehensive coverage of new art books from scores of U.S. trade and university presses.



Worldwide's acclaimed Web site enables users to quickly locate titles on specific artists, periods, regions or media.

**Worldwide Books** 1001 W. Seneca St., Ithaca, NY 14850

phone 607-272-9200 • fax 607-272-0239 • info@worldwide-artbooks.com • www.worldwide-artbooks.com



Unprecedented access to images from movies and TV for education, research, and enjoyment.

**Cinema Image Gallery**

**Cinema Image Gallery** is one of the world's finest and most comprehensive still image archives of movie, television, and entertainment history. Find directors working on-set with the stars; set, costume and production; design, hair and make-up shots, and rare behind-the-scenes material. **Cinema Image Gallery** also offers:

- An extensive TV stills archive featuring classic and modern TV: comedies, dramas, series, TV movies, game shows and thousands of pictures of the stars of this medium.
- Links to film reviews and other articles about titles.
- Links to biographies.
- Portrait photography and biographies of the stars of film and TV.
- All images are rights-cleared for educational use.

**Free 30-day trials available!**  
Visit [www.hwwilson.com/trial](http://www.hwwilson.com/trial)



**H.W. Wilson**  
[www.hwwilson.com](http://www.hwwilson.com)

Toll Free: 800-367-6770 • Tel: 718-588-8400  
Fax: 718-590-1617 or 800-590-1617  
E-mail: [custserv@hwwilson.com](mailto:custserv@hwwilson.com)



# INDIANAPOLIS MARRIOTT FLOOR PLANS

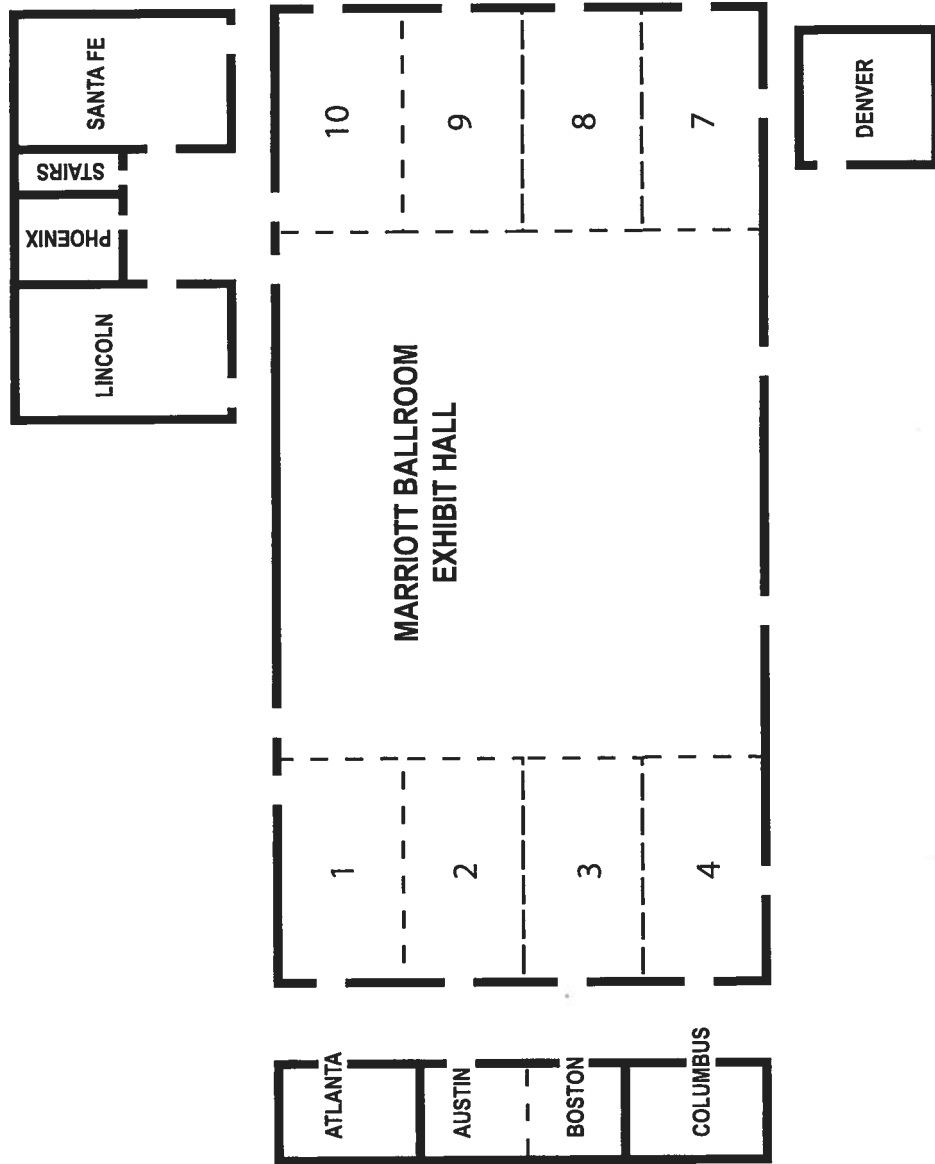



## REVOLUTION AND INNOVATION: AT THE HUB OF DISCOVERY



View of Boston Harbor from ICA Boston

**ARLIS/NA Conference**

**No. 38**

**Boston 2010**

**April 23-26**

# ARTSTOR



## A Digital Library of Images for Research & Study

The ARTstor Digital Library is a collection of nearly one million images — a valuable visual resource for scholars, teachers, and students across the arts, humanities, social sciences, and beyond. By working with individuals, organizations, and institutions across the globe, ARTstor provides a broad and deep range of rare and high-quality images of important sites and works from diverse collections such as the Metropolitan Museum of Art, Museum of Modern Art, Erich Lessing and Scala Archives representing major works in European museums, and architectural images from Esto and ART on FILE among others. New collections of contemporary art, non-Western art, and more international collections continue to grow and strengthen the Library. Our collaboration with Magnum Photos provides 80,000 of the world's most renowned photographs chronicling contemporary iconic events, people, and issues.

[ARTSTOR.ORG/COLLECTIONS](http://ARTSTOR.ORG/COLLECTIONS)

## Demonstrations & Trial Access

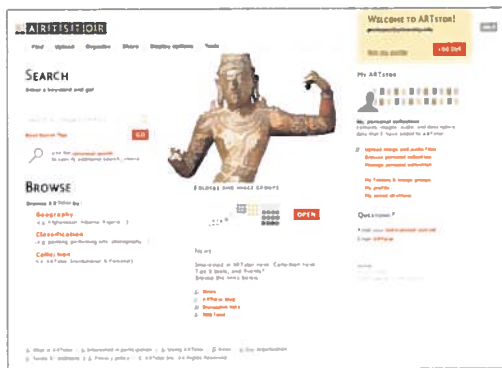

ARTstor Digital Library is presented in an easy-to-use software environment with tools that facilitate the integration of digital images into your teaching and scholarship. An online demonstration with an ARTstor representative is a good first step in learning more about the collections and tools available in the ARTstor Digital Library.

To explore a full version of the ARTstor Digital Library, including all its content and tools, ask your library to schedule a thirty-day trial. For more information or to request a trial, please contact ARTstor at [participation@artstor.org](mailto:participation@artstor.org).

[ARTSTOR.ORG/TRIAL](http://ARTSTOR.ORG/TRIAL)

**Image Credits** (From top left) Edo, Court of Benin | Pendant Mask; Iyoba, 16th century | The Metropolitan Museum of Art | Image © The Metropolitan Museum of Art • Brice Marden | Bear, 1996-97 | Image: Larry Qualls | © 2007 Brice Marden | Artists Rights Society (ARS), New York • Arched Dragon Pendant, Eastern Zhou dynasty (4th/3rd century BCE) | The Art Institute of Chicago | Photography © The Art Institute of Chicago, Chicago, Illinois, USA • Cartoons by Bernaert van Orley, woven in the workshop of Jan Moy and Willem Moy | Battle of Pavia: Imperial Attack on the French Cavalry Led by the Marquis of Pescara and on the French Artillery by the Lansquenets under Georg von Frundsberg (The Mutiny of the Swiss), 1525-1531 | Museo e gallerie nazionali di Capodimonte | © 2006, SCALA, Florence / ART RESOURCE, N.Y. Frank O. Gehry | Walt Disney Concert Hall; southeast corner entrance, completed 2003 | 111 South Grand Avenue, Los Angeles, California | ART on FILE.com • Constantin Brancusi (1876-1957) | Bird in Space, 1923 | The Metropolitan Museum of Art | Image © The Metropolitan Museum of Art | Artists Rights Society (ARS), New York / ADAGP, Paris • Mary Stevenson Cassatt | Woman Arranging Her Veil, c. 1890 | Philadelphia Museum of Art

CONTACT US AT [PARTICIPATION@ARTSTOR.ORG](mailto:PARTICIPATION@ARTSTOR.ORG) OR VISIT US AT [ARTSTOR.ORG](http://ARTSTOR.ORG)