

Art Libraries Society of North America



## 26th Annual Conference

Visions of the City:  
Philadelphia in Four Centuries

March 5 - 11, 1998 ▲ Doubletree Hotel ▲ Philadelphia, Pennsylvania

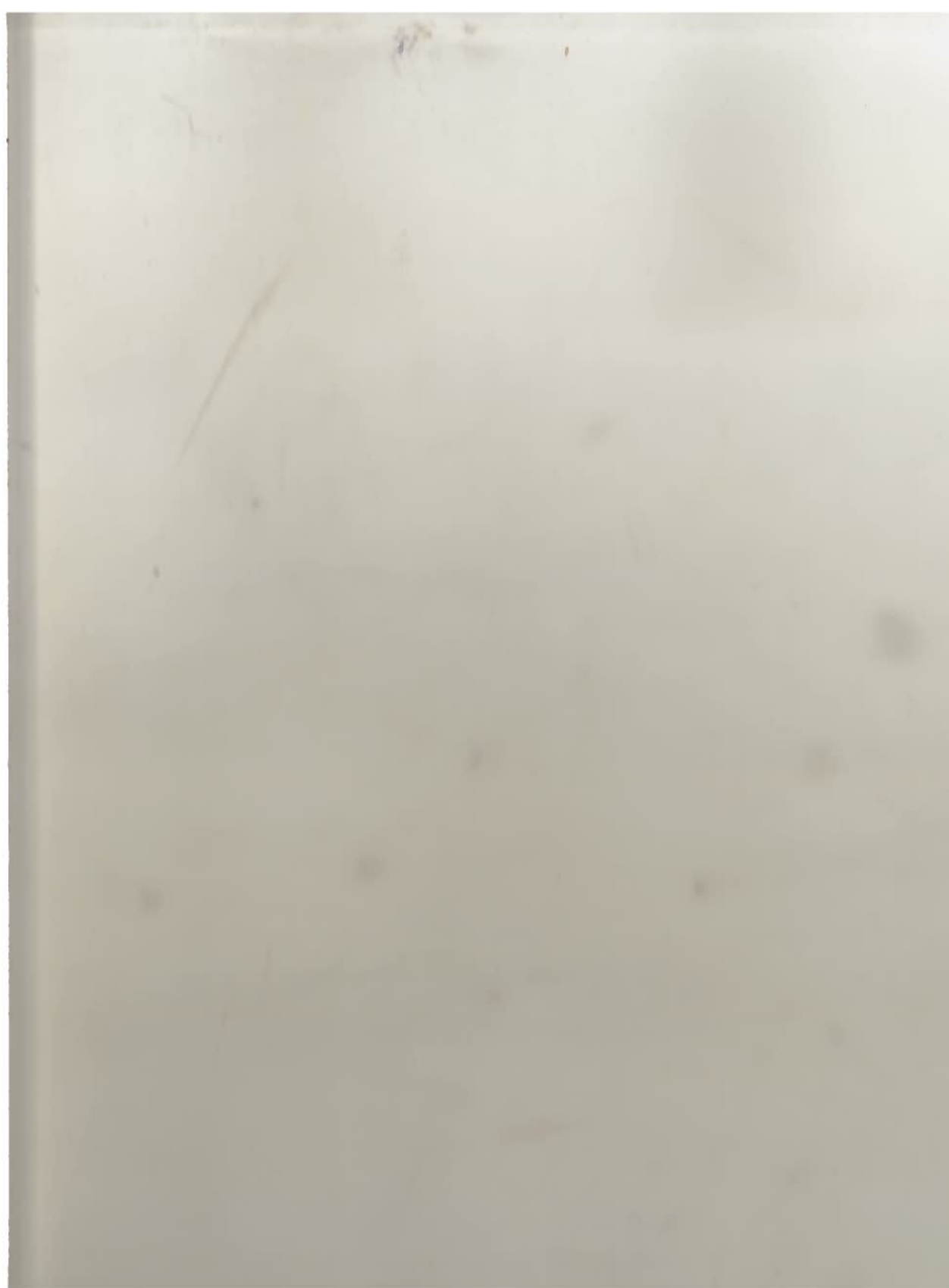

Art Libraries Society of North America

## **26th Annual Conference**

---

**Visions of the City: Philadelphia in Four Centuries**



March 5 - 11, 1998

Doubletree Hotel

Philadelphia, Pennsylvania

## Contents

---

Sponsors .....	4
ARLIS/NA Executive Board 1998 .....	5
Exhibitors.....	6
Welcome .....	7
ARLIS/NA 1998 Conference Committee.....	8
General Information .....	9
Program Information .....	11
Conference Program .....	13
Day-in-View Schedules .....	40
Hotel Floor Plans .....	46
Acronyms and Terms.....	52
Local Events and Activities .....	55
Local Information.....	58

## Sponsors

---

ARLIS/NA gratefully acknowledges the generous support  
of the following individuals, chapters, businesses, and institutions:

Andrew Cahan Bookseller	Philadelphia Museum of Art
Ars Libri, Ltd.	Puvill Libros
J. Benjamins Antiquariat B.V.	Luraine Tansey
Casallni Libri	University of Pennsylvania Museum of Archaeology and Anthropology
EBSCO	The University of the Arts
Emmett Publishing	Yankee Book Peddler
Erasmus B.V. Amsterdam	ARLIS/NA Chapters:
F.A. Bennett, Inc.	Central Plains
G.K. Hall/Macmillan	Delaware Valley
Getty Information Institute	Michigan
Innovative Interfaces Inc.	Midstates
Institute for Scientific Information	New England
Howard Karno Books	New Jersey
Mini-Aids	New York
David Mirvish Books	Ohio Valley
Museum of American Art of the Pennsylvania Academy of the Fine Arts	Southern California
	Western New York

## ARLIS/NA Executive Board 1998

---

### President

Roger Lawson  
National Gallery of Art Library

### Vice-President/ President-Elect

Mary Graham  
University of Arizona  
Arizona State Museum Library

### Secretary

Jeanne Brown  
University of Nevada-Las Vegas Library

### Treasurer

Ross Day  
Metropolitan Museum of Art  
Robert Goldwater Library

### Past President

Jack Robertson  
University of Virginia  
Fiske Kimball Fine Arts Library

### Canadian Representative

Cheryl Siegel  
Vancouver Art Gallery Library

### Regional Representatives

#### Midwest

Jane A. Carlin  
University of Cincinnati  
Design, Architecture, Art and Planning  
Library

#### Northeast

Margaret N. Webster  
Cornell University  
College of Architecture/ Art and Planning

#### South

Lee R. Sorensen  
Duke University  
Lilly Library

#### West

Deborah Barlow Smedstad  
Los Angeles County Museum of Art  
Art Research Library

---

### Executive Director

Penney De Pas, CAE

### Conference Manager

Sloane Ponder

## Exhibitors

---

ABC-CLIO  
Academic Press  
Andrew Cahan: Bookseller, Ltd.  
Antique Collectors' Club  
Ars Libri, Ltd.  
Art Sales Index, Ltd.  
Ashgate  
Aux Amateurs De Livres  
Baker & Taylor  
Blackwell's  
Califfa Books  
Canadian Heritage Information Network  
Casalini Libri  
Conservation Resources International  
The Craftsman on CD-ROM  
Cuadra Associates, Inc. (Cuadra Star)  
Delaware Art Museum  
The Dictionary of Art  
DoubleTake  
EBSCO Information Services  
Emmett Publishing  
Erasmus Boekhandel BV  
ESCALA  
F. A. Bennett Inc.  
G+B Arts International  
Gallery Systems  
Getty Trust Publications  
G.K. Hall Library Reference  
H.W.Wilson  
Han-Shan Tang Books  
Harrassowitz  
Howard Karno Books  
Hudson Hills Press  
Iberoamericana, Madrid  
IDC Publishers Philadelphia, PA  
ISI  
John Benjamins Publishing & Antiquariat  
Martinus Nijhoff International  
Michael Shamansky, Bookseller  
Moore College of Art and Design  
Norman Ross Publishing, Inc.  
OMI: Old Manuscripts Incunabula  
Parkstone Press  
Pennsylvania Academy of the Fine Arts  
Phaidon Press  
Philadelphia Museum of Art  
Purvill Libros Spain & Mexico  
Ram Publications & Distribution  
The Research Libraries Group  
Rosenthal Art Slides  
Sanderson Computers  
Saskia Ltd. Cultural Documentation  
The Scholar's Choice  
Thomas Heneage Art Books, London  
Warren Art Books  
Winterthur Museum and Gardens  
Worldwide Books  
Yale University Press

## Welcome

---

On behalf of the ARLIS/NA Executive Board and the 1998 Conference Committee, I would like to extend a warm welcome to those attending our 26th Annual Conference. The Society and the city of Philadelphia have changed dramatically since our last gathering here in 1983, and we invite you to take this opportunity to participate in the entire array of sessions, workshops, and tours, establish and renew friendships among colleagues, and investigate the many offerings of our host city — three centuries in the making, on the threshold of the fourth.

Our annual conferences have traditionally highlighted unique local resources within a broad range of topics in order to provide a distinctive viewpoint, and this year is no exception. The program sessions, workshops, and tours represent an unusually diverse array of interests relevant to every aspect of our profession. Philadelphia's treasures are featured prominently throughout the program, and it is our hope that you will come away from the conference with a better understanding of the city's contributions to the fields of art and art information.

Many of our members are also artists in their own right. This year we are delighted to present an exhibition of their work, which will be on view throughout the conference at the University of the Arts Great Hall. Our colleagues from the Visual Resources Association, with whom we have the good fortune to be meeting this year, are participating in the exhibition as well. A welcome party on Friday evening will celebrate the creativity of our members and this opportunity to meet with an organization that shares many of our interests.

The program and schedule on the following pages reflect our fervent hope that this will be the first of many such collaborative efforts as we strive to fulfill our mission "to foster excellence in art librarianship and visual resources curatorship for the advancement of the visual arts."

**Roger Lawson**  
President  
ARLIS/NA

## Conference Co-Chair (Local Arrangements)

Carol Graney  
The University of the Arts

## Conference Co-Chairs (Program)

Bill Lang  
The Free Library of Philadelphia

Iris Snyder  
University of Delaware

## Convocation

Jean Adelman  
University of Pennsylvania (retired)

Sara MacDonald  
The University of the Arts

## Exhibits

Susan Davi  
University of Delaware

Nancy Halli  
Bryn Mawr College

## Fund-raising

Judy Donovan  
Moore College of Art and Design

Allen Townsend  
Philadelphia Museum of Art

## Hospitality

Mary Wassermann  
Philadelphia Museum of Art

## Internet Room

Jean Adelman  
University of Pennsylvania (retired)

## Publicity

Peggy Ottens  
Dickinson College

## Receptions and Special Events

Martha Hall  
The University of the Arts

## Registration

Judy Donovan  
Moore College of Art and Design

Sophia Hewryk  
Moore College of Art and Design

## Tours and Transportation

Gina Kaiser  
University of the Sciences in Philadelphia

## Web Site

Andrea Goldstein  
Tyler School of Art

## Registration and Information Desk

The conference registration and information desk is located on the third floor of the hotel between the Aria B and Overture rooms, and adjacent to the staircase. Hours are listed in the program schedule.

## Receipts

If you preregistered, your receipt will be included in your conference registration packet. On-site registration receipts will be provided at the registration and information desk.

## Open Meeting and Guest Policy

ARLIS/NA committee meetings are open to all members unless a closed executive session is called. All guests are encouraged to register for the full conference. If not preregistered, guests will be permitted to join tours and special events on a space-available basis after all registered attendees have been accommodated.

## Non-Smoking Policy

Smoking is not permitted in conference meeting rooms or exhibit space.

## Internet Room

Located on the third floor of the hotel in the Aria B room, the Internet Room is equipped with computers and software for Internet access and word processing, and a networked printer. Hours are listed in the program schedule.

## Informal Gathering/ Meeting Room

The Aria A room on the third floor of the hotel is reserved as an open gathering/meeting room. If you would like to reserve the room for a small group meeting, see a conference registration and information desk attendant. A daily schedule of meetings will be posted on the door to Aria A. Hours are listed in the program schedule.

## Speaker Ready Room

The Speaker Ready Room is located in Sonata 2 (fifth floor) and is equipped with two Caramate Audioviewers. Please see a registration desk attendant for access to the room.

## Author's Rights Policy

To further the Society's objectives and contribute to its publishing program, ARLIS/NA reserves the right of first refusal for publication of papers presented at society conferences. Any conference speakers interested in publishing their papers elsewhere must first obtain release from the

chairman of the Publications Committee, who will consult with the Art Documentation editors. It is understood that the right of first refusal does not obligate ARLIS/NA to publish all conference papers. If, after a conference, the Publications Committee decides not to publish a particular paper or collection of papers, the author(s) should feel free to seek publication elsewhere.

## Program Information

---

### Exhibits

The exhibits will open on Sunday, March 8 in the Overture Room and Symphony Ballroom with a reception from 4:30 to 7:00 pm sponsored by J. Benjamins Antiquariat B.V. Exhibitors include publishers, book dealers, visual resources vendors, and suppliers of computer software and systems. Please be sure to spend time with each vendor as they are a vital source of income to the society and your attendance is important in making the exhibits a success.

Continental breakfast will be available in the exhibit rooms on Monday, March 9 from 7:30 am to 9:00 am and is sponsored by F.A. Bennett, Inc. Coffee service will be provided on Monday afternoon and Tuesday morning courtesy of Erasmus B.V. Amsterdam and Yankee Book Peddler.

### Workshops

Workshops require pre-registration. Space may be available, ask at the registration and information desk.

### Tours

Registration for tours that still have space available can be purchased at the conference registration and information desk. All tours will depart from the main entrance of the Doubletree Hotel (Broad Street entrance). The red and white Martz tour buses will be clearly marked with tour number and title.

### Hospitality

Jacks' Center City Tavern, adjoining the lobby of the conference hotel will serve as the informal social gathering place for all attendees. This location is in lieu of the hotel room "Hospitality Suite" of past conferences. Meet old friends or make new ones in a relaxed, convenient setting. Jack's is open Monday-Saturday, 11:00 am- 1:30 am, and Sunday until midnight.

### New Members and First-Time Attendees

We are pleased that you have elected to join us in Philadelphia for ARLIS/NA's 26th annual conference. We invite you to attend an orientation meeting on Saturday, March 7, from 5:30 pm to 6:15 pm. Participants will learn about ARLIS/NA and how to become more involved in the Society at the chapter and society level.

### Welcome Party

Join your ARLIS/NA and Visual Resources Association (VRA) colleagues at the joint-conference Welcome Party and opening for the exhibition "Insiders: Works by ARLIS/NA and VRA Members." Both events will be held at The University of the Arts, Hamilton Hall, Great Hall, 320 S. Broad Street (handicap entrance on Pine Street), from 8:00 pm to 10:30 pm. It will be an occasion to greet old friends and new and to celebrate the creative

work of our own members. Music will be provided by a jazz ensemble, and beverages and dessert will be served.

Warwick Hotel, or consult the VRA conference program (available at the ARLIS/NA registration desk) for additional information.

## ARLIS/NA and VRA Members' Art Exhibition

"Insiders: Works by ARLIS/NA and VRA Members" will be on display at the University of the Arts, Hamilton Hall, Great Hall, 320 S. Broad Street, March 6-10. Hours 8:00 pm-10:30 pm, Friday; 9:00 am-5:00 pm, Saturday-Monday; 9:00 am-4:00 pm, Tuesday. The Hamilton Hall Pine Street entrance must be used Saturday through Monday and for handicap access at all times.

## Visual Resources Association (VRA) Conference Admission Information

The Visual Resources Association conference is being held at the Warwick Hotel in Philadelphia, March 3-7, 1998. Your ARLIS/NA conference registration also permits you to attend VRA sessions and roundtables held on Friday, March 6, and the New Technology Roundup and presentations held on Saturday, March 7. You may also register for VRA workshops and tours on Friday and Saturday on a space-available basis. These VRA programs will be held at the Warwick Hotel, 17th & Locust Streets (three blocks from the Doubletree Hotel). Admission will be permitted with your ARLIS/NA conference badge. Workshops and tours require additional fees. See VRA representatives at the

# Conference Program

## Thursday, March 5

1:00 pm-6:00 pm Executive Board Pre-Conference Meeting  
*Maestro, Fourth Floor*  
Open to membership on a seating available basis.

## Friday, March 6

NOTE: The Visual Resources Association Annual Conference is being held at the Warwick Hotel in Philadelphia, March 3-7, 1998. Sessions on Friday, March 6, are open to ARLIS members, at no cost, with ARLIS conference badges. VRA sessions are listed here for your convenience. See page 12 for additional information.

7:30 am-5:00 pm Registration Desk Open  
*Overture and Aria Foyer, Third Floor*

8:00 am-2:30 pm Executive Board Pre-Conference Meeting  
*Maestro, Fourth Floor*  
Open to membership on a seating available basis.

8:30 am-10:30 am VRA Session: The Future of Comprehensive Reference Collections  
Organizer: Margaret Welch  
Moderator: Katharine Martinez

9:00 am-2:15 pm RLG Art and Architecture Group Meeting  
*Concerto, Third Floor*  
Open to AAG members only.  
Coordinator: Ed Teague

11:00 am-1:00 pm VRA Roundtable: Subject Indexing and the Visual Resources Collection  
Organizer and Moderator: Wendy Botting  
VRA Roundtable: Visual Resources Software Users Discussion Group  
Organizer and Moderator: Trudy Jacoby

12:00 pm-6:00 pm Internet Room and Informal Gathering/Meeting Room Open  
*Aria, Third Floor*



Tours: 12:45 pm-5:15 pm

Tours I.

**Tour 1. Barnes Foundation, 12:45 pm-4:45 pm**

Limit: 50

Price: \$30.00

Includes: Round trip transportation via motorcoach, ARLIS/DVC volunteer to assist, wheelchair accessible.

[NOTE: Repeated on Saturday, March 7, at 8:45 am and 12:45 pm]

The Barnes Foundation was established in 1922 by Dr. Albert C. Barnes to "promote the advancement of education and the appreciation of the fine arts." It houses one of the finest collections of Post-impressionist and early French modern paintings, with strong holdings of Renoir, Cezanne, and Matisse, as well as African sculptures, watercolors by Charles Demuth, and decorative arts. Although some of the collection toured from 1993-1995, this is an opportunity to see it in its entirety, installed in its original setting in newly refurbished galleries, hung according to Barnes's dictates.

**Tour 2. Old City Walking Tour, 2:30 pm-5:15 pm**

Limit: 25

Price: \$15.00

Includes: Round trip transportation via city bus, Foundation for Architecture professional guide, ARLIS/DVC volunteer to assist, wheelchair accessible

The Old City section of Philadelphia extends from the Delaware River west to 7th Street, and from Vine Street south to Chestnut Street. This area was a mixture of residential and commercial structures from its earliest days. The walking tour includes some of Philadelphia's most historic streets. One of these is Elfreth's Alley, the oldest continuously occupied street in the United States. Other highlights include the early 18th century Christ Church, Victorian commercial structures (many with cast iron facades), and Franklin Court, a contemporary site designed by Venturi, Rauch and Scott Brown.

2:30 pm-4:30 pm

**VRA Session: The Cultural Commune:  
Recent Collaborative Data Sharing Ventures**  
Organizer: Elisa Lanzi  
Moderator: Ben Kessler

4:15 pm-5:15 pm

**SCIPIO Users Group Meeting**  
*Maestro A, Fourth Floor*  
Coordinator: Debbie Kempe

5:00 pm-9:00 pm

**First Friday In Old City**

Located within the most historic square mile of Philadelphia County- from the Delaware River west to 7th Street, and from Vine Street south to Chestnut Street-Old City was once a busy commercial waterfront district. What was once an industrial, warehouse area is now a thriving arts and residential community much of which is housed in restored and converted industrial structures. Today, Old City is an active cultural, dining and shopping district every day of the month.

First Friday of each month, however, is a unique cultural event in Philadelphia and one of the city's most popular evening escapes. On this night the arts community of Old City has "open house." The receptions and openings in more than three dozen galleries and other cultural centers are always festive and welcoming. Enjoy an evening meal in one of the many sponsoring area restaurants. Old City is easy to reach by bus or taxi. No invitations or reservations are needed. The evening will be informal and fun.

5:15 pm-6:45 pm

**Committee Business Meetings I**

Finance - Ann Abid

*Chamber Board Room, Fourth Floor*

Nominating - Jeffrey Horrell

*Rhapsody, Fourth Floor*

North American Relations - Claire Eike and Marianne Cavanaugh

*Minuet, Fourth Floor*

Publications - Judy Dyki

*Concerto A, Third Floor*

Research - Amanda Bowen

*Concerto B, Third Floor*

Technology Education - Henry Pisciotta

*Maestro A, Fourth Floor*

Wittenborn Award - Marilyn Berger

*Maestro B, Fourth Floor*

8:00 pm-10:30 pm

**ARLIS/NA and VRA Welcome Party and**

**"Insiders: Works by ARLIS/NA and VRA Members" Art Exhibition at the University of the Arts, Hamilton Hall, Great Hall, 320 S. Broad Street**

Exhibition sponsored by the ARLIS/Delaware Valley Chapter

Join your ARLIS and VRA colleagues at the joint-conference Welcome Party and opening for the ARLIS/NA and VRA members' art exhibition. It will be an occasion to greet old friends and new and to celebrate the creative work of our own members. Music will be provided by a jazz ensemble and refreshments will be served.

## Saturday, March 7

- 7:30 am-6:00 pm Registration Desk Open  
*Overture and Aria Foyer, Third Floor*
- 8:00 am-6:00 pm Internet Room and Informal Gathering/Meeting Room Open  
*Aria, Third Floor*
- 8:30 am-10:00 am Committee Business Meetings II  
Awards - Mary Williamson  
*Concerto A, Third Floor*  
Cataloging Advisory - Daniel Starr  
*Maestro A, Fourth Floor*  
International Relations - Leslie Abrams  
*Chamber Board Room, Fourth Floor*  
Membership - Suzanne Freeman  
*Minuet, Fourth Floor*  
Professional Development - Ann Lally  
*Rhapsody, Fourth Floor*  
Public Policy - Katy Poole and Hinda Sklar  
*Concerto B, Third Floor*  
Standards - Eileen Fry  
*Maestro B, Fourth Floor*

Tours: 8:30 am-12:45 pm

### Tours II Tour 3. Fairmount Park Houses, 8:30 am-12:00 pm

Limit: 40

Price: \$25.00

Includes: Round trip transportation via motorcoach, professional guide, ARLIS/DVC volunteer to assist.

NOTE: This tour is not wheelchair accessible.

Philadelphia's Fairmount Park is the largest municipal park in the world, with over 8,000 acres of wooded hills encompassing some of the city's greatest treasures. The 18th- and 19th-century houses, once the country homes of eminent Philadelphians, rank among the best groups of authentic early American houses in the nation. Trained guides will give us a tour of the three following houses, all with period furnishings: Mount Pleasant, a grand country estate, celebrated as one of America's finest surviving mid-18th century architectural complexes; Lemon Hill, an Adam-inspired Federal house, noted for its oval salons and as the home of past Philadelphia Museum of Art director Fiske Kimball; and Cedar Grove, a Quaker summer cottage, moved to its present location in the park from its original site on Frankford Road near the Delaware River in a section called Harrowgate.

## Saturday, March 7

### Tour 4. Barnes Foundation, 8:45 am-12:45 pm

Limit: 50

Price: \$30.00

Includes: Round trip transportation via motorcoach, ARLIS/DVC volunteer to assist, wheelchair accessible.

[NOTE: Repeat of Tour 1.]

### Tour 5. Three Centuries of Philadelphia Architecture Bus Tour, 8:45 am-12:00 pm

Limit: 46

Price: \$25.00

Includes: Bus tour on a motorcoach, Foundation for Architecture professional guide, ARLIS/DVC volunteer to assist, wheelchair accessible.

Experience Philadelphia's rich architectural heritage on this tour of William Penn's original city, which was bounded east and west by the Delaware and Schuylkill Rivers, north and south by Vine and South Streets. The tour traces the development of the city from its elegant colonial buildings to the Post-modern era. You will see hallmarks of the city's early styles, including Georgian, Federal and Greek Revival, as well as the multiplicity of eclectic styles that characterized the Victorian period. There will be opportunities to leave the bus and examine a few sites more closely.

Workshop: 9:00 am-12:00 pm

### Workshop I They Never Covered This in Library School: Research Tools for Art and Architecture

Limit: 25

Price: \$25.00 (Transportation and lunch are not included.)

Location: Free Library of Philadelphia, Rare Book Department, Manuscript Room, 19th Street and the Benjamin Franklin Parkway (The SEPTA 32 bus stops in front of the hotel and Free Library.)

Have you every wished you could have taken art and architecture courses in library school? Have you ever wondered if there are basic art and architecture sources you are unaware of, or have never used to their full potential? Then this workshop is for you. It will cover basic reference sources in art and architecture for those who never received instruction in their use in library school, or for those new to art, museum, and VR libraries.

Organizers: Barbara Prior, Reference Librarian, Cornell University;

and Anne Haas Shankland, Art Librarian, Bowdoin College.  
 Leaders: Art Resources: B.J. Irvine, Fine Arts Librarian, Indiana University

Architecture Resources: Elizabeth Byrne, Head Librarian, Environmental Design, University of California-Berkeley

10:30 am-12:00 pm

**Committee Business Meetings III**  
 Collection Development - Ann Whiteside  
*Chamber Board Room, Fourth Floor*  
 Diversity - Pedro Figueredo and Tom Riedel  
*Minuet, Fourth Floor*  
 Development - Barbara Polowy  
*Rhapsody, Fourth Floor*  
 Gerd Muehsam Award - Jennifer Moldwin  
*Maestro B, Fourth Floor*  
 Technology Relations - Susan Jurist  
*Maestro A, Fourth Floor*  
 Travel Awards - Kathryn Wayne  
*Concerto B, Third Floor*  
 Visual Resources Advisory - Trudy Jacoby  
*Concerto A, Third Floor*

Tour: 12:45 pm-4:45 pm

Tours III

**Tour 6. Barnes Foundation, 12:45 pm-4:45 pm**  
 Limit: 50  
 Price: \$30.00  
 Includes: Round trip transportation via motorcoach, ARLIS/DVC volunteer to assist, wheelchair accessible.  
 [NOTE: Repeat of Tour 1.]

Panel Sessions I: 1:00 pm-3:00 pm

Session 1

**The Architectural Vision:  
 Non-Print Reference Sources on Architects**  
*Ormandy East, Lobby Level*  
 Co-Moderators: Anita Carrico, Head, Architecture Library, University of Maryland; and Thomas Jacoby, Art and Design Librarian, University of Connecticut, Storrs  
 Co-Sponsors: Academic Library Division, Architecture Section, and Reference and Information Services Section

**Abstract:** This session will provide information on electronic and other non-print reference sources for art and architecture librarians, visual resources curators, and archivists who are called upon to answer queries for information on local and nationally recognized architects and buildings that are inadequately covered in print publications. Speakers will examine general and national resources, as well as regional and local sources. Lists of Web sites and names of contact persons for general sources will be provided.

**Panelists :** Bruce Laverty, Architectural Archivist, Athenaeum of Philadelphia

Hyman Myers, AIA, Historic Preservation Architect, Vitetta Group  
 C. Ford Peatross, Curator of the Architecture, Engineering, and Design Collection, Prints and Photographs Division, Library of Congress

Tony Wrenn, Archivist, American Institute of Architects Headquarters

[Related event: Session 5, "Documenting Gardens"]

Session 2

**Collection Level Records: Archivists and Librarians Share Solutions**

*Ormandy West, Lobby Level*

**Moderator:** Willy Cromwell-Kessler, Library and Bibliographic Services Officer, Research Libraries Group

**Co-Sponsors:** Cataloging Section and Visual Resources Division

**Abstract:** Librarians are challenged to provide access to non-traditional library materials in their collections, otherwise called "the inaccessible domain." These materials have considerable research value, but in times of reduced staffing are either too numerous or too complex for standard library cataloging, and therefore remain undocumented in local or national bibliographic databases. Bibliographic and visual resources catalogers, seeking new and more efficient ways of providing access, are casting an eye toward solutions found in other cataloging communities. One such idea is the collection level record, an established practice in the archival community. This session will introduce the concept of the collection level record with speakers focusing on specific applications for various types of material, and continues to explore issues raised during the ARLIS 1996 session "A Wilder Kingdom: Stalking Ephemeral Material."

**Panelists:** Deborah Kempe, Chief, Collections Management and Access, Frick Art Reference Library

Cyndie Campbell, Head, Documentation and Visual Resources, National Gallery of Canada, Library and Archives

Kris Kiesling, Head of Manuscripts and Archives, Harry Ransom Humanities Research Center

Karen Weiss, Cataloger, Archives of American Art, Smithsonian Institution

**Session 3 Serving Diverse Communities/Building Diverse Collections**

*Concerto, Third Floor*

Co-Moderators: Ross Day, Associate Museum Librarian, Robert Goldwater Library, Metropolitan Museum of Art; and András J. Riedlmayer, Bibliographer / Islamic Art, Fine Arts Library, Harvard University

Co-Sponsors: Diversity Committee and Academic Library Division

Abstract: In past ARLIS/NA meetings, the issue of diversity has most often been addressed in terms of staffing. However, as art documentation professionals we also need to think about ways to respect and serve diversity in the way we build our collections, in the kinds of intellectual access we create, and in the ways we serve our users-whose interests have grown to embrace a culturally diverse world of art and artists. Marginalizing certain kinds of materials, certain forms of access, or certain groups of users by the way we operate on a day-to-day basis militates against this kind of diversity. Our panel will explore how that cultural and linguistic diversity is being (under)served, and discuss recent trends and suggestions for future improvement.

Panelists: Ray Anne Lockard, Head Librarian, Frick Fine Arts Library, University of Pittsburgh

András Riedlmayer, Bibliographer / Islamic Art, Fine Arts Library, Harvard University

Claudia Hill, Original and Special Materials Cataloger for Avery Library's Art and Architecture Collections, Columbia University

Rita Scherrei, Associate University Librarian for Personnel and Administrative Services, University of California, Los Angeles; and Alfred E. Willis, Head, Arts Library, University of California, Los Angeles

**Panel Sessions II: 3:15 pm-5:15 pm**

**Session 4 Learners' Permits, Licenses, and the Electronic Highway: Finding Your Way**

*Ormandy East, Lobby Level*

Co-Moderators: Hinda Sklar and Katy Poole, Co-Chairs, Public Policy Committee

Co-Sponsors: Public Policy Committee and Visual Resources Division

Abstract: For the past several years, librarians and visual resource curators have been learning the basics and details of acquiring and providing access to electronic resources. As more electronic resources are available commercially as well as locally through in-house projects, new and complex issues arise that must be addressed. These issues include, but are not limited to: copyright policy and procedures, site licensing, Web access, and network security.

This session will offer an opportunity to explore some of these issues and provide a forum to exchange experiences on making reasonable decisions which balance the needs of patrons against the realities of limited staff and resources in the context of legal compliance. The panel will consist of representatives from a cross-section of environments: academia, museums, public libraries, and special libraries.

Panelists: Maryly Snow, Librarian, Architecture Slide Library, University of California-Berkeley

Nancy Allen, Director of Information Resources, Museum of Fine Arts, Boston

Hinda Sklar, Librarian, The Architectural Association, Bedford Square, London

H.E. "Chuck" Broadbent, Director of Information Technology, Free Library of Philadelphia

**Session 5 Documenting Gardens: Researching and Preserving Landscape Designs**

*Ormandy West, Lobby Level*

Co-Moderators: Shiela Klos, Head of Library, Architecture and Allied Arts Library, University of Oregon; and Joan Stahl, Coordinator, Image Collections, National Museum of American Art

Sponsor: Decorative Arts Roundtable

Abstract: Gardens are complex creations. They are changing environments achieved through the collaboration of landscape designers and architects, planners, horticulturists and gardeners, artists and craftspeople; they may consist of plants, buildings, ornaments, sculpture, paths, and walls. Preservation is complicated since they are not fixed in time-as are the original plans and designs-but subject to change and decay. The documentation of historically noteworthy designs is also diversified. Architectural plans, photographs and prints, papers and manuscripts, and electronic databases may be housed in library collections whose

focus ranges from art and architecture, to horticulture, to planning. This session will provide attendees with information on landscape research, significant documentation projects, and the intersection of gardens with art and architecture.

Panelists: Charles Birnbaum, FASLA, Coordinator, Historic Landscape Initiative, National Park Service: "Establishing Context for Historic Designed Landscapes: The National Park Service's *Pioneers of American Landscape Design Database*"

Lauranne Nash, Chief, Collections Management and Education Branch, Horticultural Services Division, Smithsonian Institution: "Archives of American Gardens: Documenting Historic and Contemporary American Landscapes"

Catha Grace Rambusch, Director, CATALOG of Landscape Records in the United States, Wave Hill; and Chris M. Panos, Assistant Director, CATALOG: "Creating Awareness and Collecting Information About our Nation's Landscape History: The CATALOG, a Decade of Service"

Anne Whiston Spirn, Professor of Landscape Architecture and Regional Planning, University of Pennsylvania: "Landscape as Literature: Frank Lloyd Wright's Taliesins"

[Related event: Tour 13. Winterthur Museum and Gardens, and Longwood Gardens]

Session 6 Accessing Cultural Heritage Information Through CHIN

*Concerto, Third Floor*

Moderator: Cheryl Siegel, Librarian, Vancouver Art Gallery

Sponsor: ARLIS Canada

Abstract: The Canadian Heritage Information Network (CHIN) has been offering databases and other electronic information tools related to cultural heritage since 1972. From national inventory databases for Canadian museums, they have expanded to the Artists in Canada database, international databases related to conservation of cultural property known as the Conservation Information Network (BCIN, ACIN, and MCIN), an international museology bibliographic database (BMUSE), a Heritage Law Bibliography (HERB), an electronic version of the Art and Architecture Thesaurus (AAT), and a collections management software review, among others. The session will discuss specific research tools of use to art and architecture libraries and their clients. It will demonstrate how moving from online access to Web access has changed the databases and will discuss the new directions that CHIN will be taking in the future.

Panelists: Wendy Thomas, Project Leader, CHIN

Cyndie Campbell, Head, Documentation and Visual Resources, National Gallery of Canada Library and Archives.

Leslie Munro, Museum Consultant, Munro-Butler Associates, Inc.

Vicki Davis, Reference Librarian, Canadian Conservation Institute Library

Gail Eagen, Director, Systems and Access, CHIN

5:30 pm-6:15 pm

New Member and First Time Attendees Orientation Meeting  
Beverage service sponsored by ARLIS/NY Chapter

*Maestro, Fourth Floor*

Roger Lawson, President; and Mary Graham, Vice-President/  
President-Elect

5:45 pm-10:30 pm

Continuous transportation by bus to Convocation and back to the Doubletree Hotel

6:45 pm-8:00 pm

Convocation at the University of Pennsylvania Museum of Archaeology and Anthropology, Harrison Auditorium

8:00 pm-10:30 pm

Reception at the University of Pennsylvania Museum of Archaeology and Anthropology, Chinese Rotunda and Upper Egyptian Gallery

Sunday, March 8

7:00 am-7:45 am

Yoga in Philadelphia

*Health Club, Racquetball Court, Fifth Floor*

Presented by B.J. Irvine. Wake up your mind and body with a series of gentle stretches based on Yoga and related systems of exercise. Practice includes both deep breathing and positions of physical ease (Yoga asanas or postures). These morning sessions can be enjoyed by those who have not had prior Yoga classes, as well as by more experienced practitioners.

7:30 am-5:00 pm

Registration Desk Open

*Overture and Aria Foyer, Third Floor*

8:00 am-6:00 pm

Internet Room and Informal Gathering/Meeting Room Open  
*Aria, Third Floor*

Panel Sessions III: 8:30 am-10:30 am

- Session 7** Auction Catalogs: Collection Development, Organization, Reference, and the Appraiser  
*Concerto, Third Floor*  
Moderator: Stephen H. Van Dyk, Chief Librarian, Cooper-Hewitt Museum Library, National Design Museum  
Sponsor: Decorative Arts Roundtable and Public Library Division  
Abstract: Auction catalogs provide useful information for collectors, museum curators, appraisers, auction houses, gallery owners, antique dealers, and art and design historians. At the same time, these catalogs create a challenge for reference librarians in their use and access, and to librarians who need to purchase, organize, and store them. The panelists will discuss auction catalogs in terms of reference, collection development, and cataloging, as well as their usefulness to the art market professional.  
Panelists: Stephen H. Van Dyk, Chief Librarian, Cooper-Hewitt Museum Library, National Design Museum  
Ann Leslie Jones, Serials Librarian, Art Institute of Chicago  
Rod Thompson, Independent appraiser and teacher of research methods in the New York University Appraisal Studies Program  
Lee Robinson, Reference Librarian, Art Division, New York Public Library
- Session 8** Philadelphia Collects: The Evolution of Some of the Great Collections of the City  
*Ormandy East, Lobby Level*  
Moderator: Allen Townsend, Librarian, Philadelphia Museum of Art  
Sponsor: ARLIS/Delaware Valley Chapter  
Abstract: Representative curators from the Rosenbach Museum and Library, and the Philadelphia Museum of Art will discuss the history of several of Philadelphia's public collections and the collectors who were responsible for their creation.  
Panelists: Derek Dreher, Curator, The Rosenbach Museum and Library: "The Rosenbach Brothers and their Collections"  
Innis Shoemaker, Curator of Prints, Drawings, and Photographs, The Philadelphia Museum of Art: "The Collections of Earl Horter, Philadelphia Artist"  
Joseph Rishel, Curator of European Painting and Sculpture before 1900, The Philadelphia Museum of Art: "The Collections of Henry P. McIlhenny and John G. Johnson"



**Session 9** Intellectual Access to Information: Using Expert Systems as Filters in User Interfaces

*Ormandy West, Lobby Level*  
Moderator: Patricia Young, Head, Vocabulary Program, Getty Information Institute  
Sponsor: Cataloging Section  
Abstract: We are now seeing the potential of using vocabularies such as the Art and Architecture Thesaurus (AAT), Union List of Artists names (ULAN), and geographic and chronological knowledge base as a means of assisting a search of heterogeneous material in geographically diverse locations. Vocabulary resources enable researchers to search on concepts, not just terms; concepts of time, place, subject, and object can act as powerful filters in assisting a researcher to gain meaningful access to information in various forms and created by various disciplines.  
Panelists: Karen Neimansis, Manager of Development, Canadian Heritage Information Network  
Joseph Busch, Program Manager, Getty Art History Information Program  
Howard Smith, Manager, Architecture and Fine Arts Library and Image Collections, University of Southern California

Panel Sessions IV: 10:45 am-12:45 pm

- Session 10** Diamonds or Dinosaurs? New Technologies in Landmark Libraries  
*Concerto, Third Floor*  
Co-Moderators: Paul Glassman, Art & Architecture Librarian, Pratt Institute; and Clare Hills-Nova, Reference/Collection Development Librarian, Institute of Fine Arts Libraries, New York University  
Co-Sponsors: Architecture Section, Space Planners Roundtable, and ARLIS/New York Metro Chapter  
Abstract: How do you modernize a library facility without sacrificing its architectural integrity? How do you reconcile the sometimes problematic confluence of historic preservation practices and ordinances with principles of collections conservation? In this session practitioners who have created successful adaptations of architecturally significant structures will discuss the goals of their projects and what they learned in the process. Among the participants will be an environmental consultant, a preservationist, an architect, and a librarian. Presentations will address conditions and challenges that may present conflicts, such

as: the introduction of potentially intrusive mechanical equipment and ductwork and the establishment of proper environmental controls for the conservation of collections; the installation of significant amounts of additional and complex cabling systems and computer equipment for the introduction and expansion of electronic resources; the persistence of doubts as to the essential functionality of the building in addressing the need for additional storage, collections expansion, and research space; the implications of specific and substantial architectural accretions in order to comply with the Americans with Disabilities Act guidelines.

Panelists: Samuel Y. Harris, AIA, PE, Kieran Timberlake Harris  
 "Infrastructure as Furniture"

Dr. Roger Moss, Executive Director, The Philadelphia Athenaeum:  
 "The Librarian as Preservationist"

William Lull, Garrison/Lull Inc.: "Challenges in Providing Environmental Control in Historic Library Buildings"

David Marohn, AIA, Senior Associate, Venturi, Scott Brown and Associates; and Julia Moore Converse, Curator and Director, Architectural Archives, University of Pennsylvania: "The Client Architect Partnership at the Furness Building for the Architectural Archives of the University of Pennsylvania"

[Related event: Tour 7. Fisher Fine Arts Library at the University of Pennsylvania.]

Session II The Art Librarian as Curator

*Ormandy East, Lobby Level*

Co-Moderators: Deirdre Lawrence, Principal Librarian/Coordinator of Research Services, Brooklyn Museum of Art; and Rosemary Haddad, Associate Librarian, Canadian Centre for Architecture

Sponsor: Museum Library Division

Abstract: The session will focus on the advantages and disadvantages of mounting exhibitions as part of a library program. The opportunities for art librarians as curators will be discussed by representatives of various types of libraries. Their talks will cover such topics as: balancing exhibition activity with other responsibilities, collection research and development, professional recognition, and public outreach.

Panelists: Rochelle Elstein, Bibliographer, Collection Management, Northwestern University Library

James A. Findlay, Librarian, Broward County Library's Bienes Center for the Literary Arts, The Dianne and Michael Bienes Special Collections and Rare Book Library

Karen Lightner, Reference Librarian, Rare Book Department, Free Library of Philadelphia

Barbara Mathé, Librarian, Robert Goldwater Library, Metropolitan Museum of Art

Session 12 Education of Women in the Arts: An Historic Overview

*Ormandy West, Lobby Level*

Co-Moderators: Susan Nurse, Visual Resources Curator, Memorial Art Gallery; and Bonnie Reed, Fine Arts Librarian, Texas Tech University

Co-Sponsors: Women and Arts Roundtable and Academic Libraries Division

Abstract: An exploration of art education for women is an important step to an understanding of where the field of "Women in the Arts" is now and where it has come from. Philadelphia has a very rich history of arts education, including the Pennsylvania Academy of the Fine Arts and Moore College of Art and Design, both pioneers in women's art education. In this session, we will explore some traditional and non-traditional approaches to the education of women in the arts.

Panelists: Page Talbott, Project Director and Curator, 150th Anniversary Programs at Moore College of Art and Design: "When 30 Makes 10: The Philadelphia 10, Women Artist Group 1917-1945"

Tara Tappert, author, *Cecilia Beaux and the Art of Portraiture*: "Painting is a great deal of trouble: Cecilia Beaux as an Educator"

Virginia Fitzpatrick, Director of the Art Education Certification Program, Moore College of Art and Design: "Research on Curriculum Changes at an All Women's Art College"

Audrey Flack, artist: "My Experiences as a Woman Artist"

12:00 pm-4:00 pm

Exhibits Set-up  
*Overture and Symphony, Third Floor*

Ask ARLIS: 2:00 pm-3:30 pm

Ask ARLIS I Cataloging and Indexing in an Ideal World

*Ormandy East, Lobby Level*

Moderator: Daniel Starr, Chief Librarian, Technical Services and Planning, Museum of Modern Art

Sponsor: Cataloging Section

Abstract: In an era of core and minimal cataloging, cutbacks, and outsourcing, the Cataloging Section would like to remind the

library community what we are losing by not providing the best possible cataloging and indexing. Time and money saved in technical services may result in extra hidden expenses in acquisitions, interlibrary loan, and reference. Speakers from various cataloging and indexing communities will describe what they would like to provide and how it differs from what is currently done.

Contributors: Anne Britton, Assistant Librarian, Museum of Modern Art

Alison Dickey, Editor, Art Index, H.W. Wilson & Co.

Linda McRae, Associate Librarian, University of South Florida

Daniel Starr, Chief Librarian, Technical Services and Planning, Museum of Modern Art

Kay Teel, Chief Cataloger, Cleveland Museum of Art

**Ask ARLIS 2 Shaping Future Art Librarians: Mentorship, Management, and Professional Development**

*Ormandy West, Lobby Level*

Co-Moderators: Anne Lally, Architecture Librarian, College of Architecture Library, University of Arizona; and Tom Riedel, Fine Arts Librarian, University of Wyoming

Co-Sponsors: Diversity Committee and Professional Development Committee

Abstract: The establishment of the ARLIS/NA 25th Anniversary Scholarship Fund to support art library internships or study recognizes the importance of practical experience and professional mentorship to better prepare future art librarians and visual resource curators. In addition to providing training, mentorship can be an effective means for recruiting new professionals, for expanding the diversity of Society membership, and as a management tool for art libraries and visual resource collections. This AskARLIS will address both successes and challenges of mentoring and mentorship programs.

Contributors: B.J. Irvine, Fine Arts Librarian, Indiana University: "Mentoring Students and Colleagues"

Jeffrey Horrell, Librarian, Fine Arts Library, Harvard University: "Mentorship and Professional Development"

Meg Cunningham, Reference Librarian, Mt. Holyoke College: "The Importance of Mentoring-a Personal Perspective"

3:45 pm-5:15 pm

Discussion Groups I

Art NACO - Sherman Clarke

*Rhapsody, Fourth Floor*

Canadian Members - Cheryl Siegel

*Maestro A, Fourth Floor*

VRA/ARLIS Cataloging Problems - Kay Teel

*Minuet, Fourth Floor*

Museum Library Directors - Jeannette Dixon

*Ormandy East, Lobby Level*

4:30 pm-7:00 pm

*S. P. S. ...*

7:00 pm-9:00 pm

Exhibits Opening Party

Sponsored by J. Benjamins Antiquariat B.V.

*Overture and Symphony, Third Floor*

Serials Swap I

*Chamber Board Room, Fourth Floor*

Coordinator: Gisèle Guay, Head of Serials, Canadian Centre for Architecture

Tour: 7:15 pm-10:00 pm

**Tours IV Tour 7. Fisher Fine Arts Library, University of Pennsylvania, 7:15 pm-10:00 pm**

Limit: 40

Price: \$30.00

Includes: Round trip transportation via motorcoach, professional guide, ARLIS/DVC volunteer to assist, refreshments, wheelchair accessible.

The Fisher Fine Arts Library was designed in 1888 by Frank Furness in consultation with Melvil Dewey. It was renovated, adhering to the original plans, by Pritzker Prize winning architects Venturi, Scott Brown & Associates, in time to celebrate its centennial. Architectural historian George Thomas, an expert on Furness who was the lead restoration consultant, will give an informal tour of the library. The tour will be followed by light refreshments served in the lobby.

**Monday, March 9**

7:00 am-7:45 am

Yoga in Philadelphia

*Health Club, Racquetball Court, Fifth Floor*

Presented by B.J. Irvine.

7:30 am-5:00 pm

Registration Desk Open

*Overture and Arla Foyer, Third Floor*



# Monday, March 9

7:30 am-9:00 am

Chapter Officers' Breakfast  
*Orchestra Room, Second Floor*

Coordinators: Debbie Barlow Smedstad, Cheryl Siegel, and Jane Carlin

Breakfast and discussion about management issues and strategic planning initiatives; for chapter officers and Executive Board members.

Serials Swap II  
*Chamber Board Room, Fourth Floor*

Coordinator: Gisèle Guay, Head of Serials, Canadian Centre for Architecture

7:30 am-9:00 am

Exhibits Continental Breakfast  
Sponsored by F.A. Bennett, Inc.  
*Overture and Symphony, Third Floor*

8:30  
Richard

7:30 am-11:00 am

Exhibits Open  
*Overture and Symphony, Third Floor*

8:00 am-6:00 pm

Internet Room and Informal Gathering/Meeting Room Open  
*Aria, Third Floor*

9:15 am-10:45 am

Division Business Meetings  
Academic Library - Ray Anne Lockard  
*Concerto, Third Floor*  
Art and Design School Library - Melissa McDonald  
*Maestro, Fourth Floor*  
Museum Library - Barbara Mathé  
*Ormandy East, Lobby Level*  
Public Library - Suzy Frechette  
*Sonata 3, Fifth Floor*

Visual Resources - Martha Mahard  
*Ormandy West, Lobby Level*

11:00 am-12:30 pm

Membership Meeting  
*Ormandy, Lobby Level*

1:00 pm-2:30 pm

Round Table Business Meetings  
Decorative Arts - Jean Hines  
*Rhapsody, Fourth Floor*  
Film and Video - Alison Pinsler  
*Sonata 3, Fifth Floor*

# Monday, March 9

Gay and Lesbian Interests - Mary D. Galvin  
*Ormandy East, Lobby Level*

Indigenous Art and Culture - Meg Cunningham  
*Ormandy West, Lobby Level*

New Art - Susan Nurse and Bonnie Reed  
*Concerto A, Third Floor*

Serials - Stephanie Moye  
*Concerto B, Third Floor*

Space Planners - Sonja Staum-Kuniej  
*Maestro A, Fourth Floor*

Women and Art - Bonnie Reed  
*Maestro B, Fourth Floor*

2:00 pm-6:00 pm

Exhibits Open  
Coffee service sponsored by Erasmus B.V. Amsterdam  
*Overture and Symphony, Third Floor*

entire DAA

2:45 pm-4:15 pm

Section Business Meetings

Architecture - Ann Lally  
*Ormandy East, Lobby Level*

Cataloging - Kay Teel  
*Ormandy West, Lobby Level*

Computer - Marilyn Healey  
*Concerto, Third Floor*

Reference and Information Services - Kaia Stavig Esau  
*Maestro, Fourth Floor*

5:00 pm-6:30 pm

Cataloging Problems Discussion Group  
*Ormandy East, Lobby Level*

Coordinator: Sherman Clarke

6:00 pm-10:00 pm

Continuous transportation by bus to the Ars Libri Reception and back to the Doubletree Hotel

6:00 pm-10:00 pm

Ars Libri Reception at the Museum of American Art of the Pennsylvania Academy of the Fine Arts

# Tuesday, March 10

7:00 am-7:45 am

Yoga in Philadelphia  
*Health Club, Racquetball Court, Fifth Floor*  
Presented by B.J. Irvine.

- 7:30 am-12:00 pm Registration Desk Open  
*Overture and Aria Foyer, Third Floor*
- 7:30 am-9:30 am Leadership Breakfast  
*Orchestra Room, Second Floor*  
Coordinator: Mary Graham,  
ARLIS/NA Vice-President / President-Elect  
Breakfast and discussion about management issues and strategic planning initiatives; for group leaders including committee chairs, Division and Section moderators, Round Table coordinators, publications editors, Web Site Manager, Executive Board, and management staff.
- 8:00 am-5:00 pm Internet Room and Informal Gathering / Meeting Room Open  
*Aria, Third Floor*
- 8:30 am-12:00 pm Exhibits Open  
Coffee service sponsored by Yankee Book Peddler  
*Overture and Symphony, Third Floor*

Panel Sessions V: 9:30 am-11:30 am

- Session 13 Outside the Lines: Some Non-Traditional Art Education Programs in Philadelphia  
*Ormandy West, Lobby Level*  
Moderator: Karen Lightner, Reference Librarian, Rare Book Department, Free Library of Philadelphia  
Sponsor: ARLIS/Delaware Valley Chapter  
Abstract: Philadelphia has a long history of fine arts education beginning with the founding of The Pennsylvania Academy of the Fine Arts in 1805. The Academy, along with the programs at numerous area colleges, universities, and art schools, has trained vast numbers of artists whose work has enriched our city and society. Philadelphia also has a rich history of non-traditional art education programs designed to reach disadvantaged, poor, and working-class individuals.  
This session will introduce the audience to four programs which have, in exciting ways worked hard and successfully to fulfill their missions. The speakers will present examples of how the arts have enriched and transformed the lives of individuals and the environment.  
Panelists: Thora Jacobson, Executive Director, Fleisher Art Memorial  
Michele Grant, Executive/Artistic Director, Prints in Progress  
Jane Golden, Director, Mural Arts Program, Philadelphia Department of Recreation  
Lily Yeh, Executive Director, Village of the Arts and Humanities

- Session 14 Pink Papers and Lavender Files: Preserving Gay and Lesbian Art History in Archival Collections  
*Ormandy East, Lobby Level*  
Co-Moderators: Ted Goodman, General Editor, Avery Architectural Library, Columbia University; and Ray Anne Lockard, Head Librarian, Frick Fine Arts Library, University of Pittsburgh  
Co-Sponsors: Gay and Lesbian Interests Round Table, Diversity Committee, and Academic Library Division  
Abstract: During the session sponsored by GLIRT and the Diversity Committee at the 1997 conference in San Antonio, ARLIS members learned how challenging it is to be lesbian/gay inclusive in collection development. This session continues the discussion of accessibility by focusing on what can be done in archival collections. While lesbian and gay archives exist in all of the major cities of the country, many do not include information on the lesbian/gay artists in their communities. Furthermore, few people, including those in the lesbian/gay community, know of archival collections. (Philadelphia hosts two excellent resources: The Lesbian and Gay Library of Philadelphia, and the AIDS Information Network.) This panel will address from a variety of perspectives, how selected archives across the country collect, and make accessible, materials on the lesbian and gay artists in their communities.  
Panelists: Patrick Moore, Director of the Estate Project for Artists with Aids: "The Estate Project for Artists with Aids: A Description and Update"  
Janet Parks, Drawings Curator, Avery Architectural and Fine Arts Library, Columbia University: "Architectural Archives and AIDS"  
Stephen Nonack, Boston Athenaeum: "Visual Image Research for *Public Faces/Private Lives: Boston's Lesbian and Gay History*"  
John Smith, Archivist, The Andy Warhol Museum: "Queer Contents: Looking for Sex at the Andy Warhol Museum"
- Session 15 Money Matters: Multiple Perspectives in Grant Funding for Libraries and Museums  
*Concerto, Third Floor*  
Co-Moderators: Marianne L. Cavanaugh, Associate Librarian, St. Louis Art Museum; and Pat Lynagh, Assistant Librarian, National Portrait Gallery.  
Co-Sponsors: Museum Library Division, North American Relations Committee  
Abstract: The challenge of obtaining library grant funding has grown

in recent years. Trends such as an emphasis on cooperative applications and multiple funding sources, with private and public funds working in partnership are supplanting the traditional method of an individual institution applying to a single source of funding.

The multiple perspectives to be examined in this session will include those from a librarian who has negotiated several successful grant-funded projects, and representatives of government funding agencies and private corporate foundations.

Panelists: Deirdre Lawrence, Principal Librarian/Coordinator of Research Services, Brooklyn Museum of Art

George Farr, Director, Division of Preservation and Access, National Endowment for the Humanities

Diane B. Frankel, Director, Institute of Museum and Library Services  
Mary L. Kuhn, Executive Director, Stockton Rush Bartol Foundation

9:45 am-11:15 am

Getty Vocabularies Users Group Meeting (AAT, ULAN, TGN)  
*Maestro, Fourth Floor*

Coordinator: Robin Johnson

11:15 am-12:45 pm

BHA Users Group Meeting  
*Maestro, Fourth Floor*

Coordinators: Michael Rinehart and Katie Keller

Tours: 12:45 pm-4:30 pm

Tours V

Tour 8. Wharton Esherick Studio, 12:45 pm-4:30 pm

Limit: 24

Price: \$30.00

Includes: Round trip transportation via motorcoach, professional guide, ARLIS/DVC volunteer to assist, wheelchair accessible.

Wharton Esherick (1887-1970) was among the vanguard of artists who created an American sculpture style early in the 20th century. Working primarily in wood, he extended his sculptural forms to furniture, furnishings, and interiors. The Studio, which took Esherick 40 years to build, reflects the artist's changing styles, from organic to expressionist to the lyrical free forms for which he is best known. The building, its contents, and grounds have been preserved much as they were when Esherick lived and worked there. On exhibition are more than 200 of his works, including paintings, woodcuts, sculpture, and furniture.

Tour 9. Architecture of Frank Furness Bus Tour, 12:45 pm-4:00 pm

Limit: 46

Price: \$25.00

Includes: Bus tour on a motorcoach, professional guide, ARLIS/DVC volunteer to assist, wheelchair accessible.

Recognized as one of America's greatest architects, Frank Furness is responsible for the design of nearly 800 banks, residences, railroad stations, and churches. Two of his best known works are the Fisher Fine Arts Library at the University of Pennsylvania and the Pennsylvania Academy of the Fine Arts. George Thomas, architectural historian and Furness scholar, will lead this bus tour highlighting the architect's works. There will be opportunities to leave the bus and examine a few sites more closely.

Tour 10. Conservation Center for Art and Historic Artifacts, 1:15 pm-3:45 pm

Limit: 20

Price: \$30.00

Includes: Round trip transportation via motorcoach, professional guide, ARLIS/DVC volunteer to assist.

NOTE: This tour is not wheelchair accessible.

The Conservation Center for Art and Historic Artifacts, established in 1977, is a nonprofit regional conservation laboratory specializing in the treatment of art and historic artifacts on paper, rare books, photographs, and library and archival material. A conservator will give a one-half hour slide lecture on book and paper conservation and then there will be a one-hour tour of the Center's laboratory to see firsthand the treatments on which they are working.

Tour 11. Society Hill Walking Tour, 1:30 pm-4:00 pm

Limit: 25

Price: \$15.00

Includes: Round trip transportation via city bus, Foundation for Architecture guide, ARLIS/DVC volunteer to assist, wheelchair accessible.

The Society Hill section of Philadelphia, extending from the Delaware River west to 7th Street, and from Market Street south to South Street, is home to the largest intact collection of original Colonial architecture within the United States. The tour will explore this neighborhood, named after the Free Society of Traders, and then follow the city's architectural development as it expanded

## Tuesday, March 10

westward, evolving through Georgian, Federal, and Greek Revival styles.

1:00 pm-2:30 pm

### Discussion Groups II

Art Documentation Contributors -  
Stephanie Sigala and Betsy Peck Learned  
*Rhapsody, Fourth Floor*

CHIN Users Group - Vicki Davis  
*Minuet, Fourth Floor*

Interlibrary Loan - Jacqui Allen  
*Chamber Board Room, Fourth Floor*

## Wednesday, March 11

Tours: 7:30 am-6:30 pm

### Tours VI Tour 12. Bucks County/Doylestown, 7:30 am-6:30 pm

Limit: 40

Price: \$85.00

Includes: Round trip transportation via motorcoach, box breakfast, catered lunch, professional guides, ARLIS/NA volunteer to assist.

NOTE: This tour is not wheelchair accessible.

Bucks County, PA is one of those few American counties famous outside its own locality. It is known for its Revolutionary War sites, its distinctive Colonial fieldstone architecture and covered wooden bridges, its artists' colonies, industrial archaeology of the 18th and 19th centuries, and its beautiful landscapes of canals and towpaths, rivers, and protected countryside. This day-long tour offers the perfect combination of features; a way for ARLIS members to complete their conference with a truly memorable experience.

The first stop on our tour is a visit to the David Library of the American Revolution, a unique resource for researchers of the Revolutionary War, just a few minutes away from the site of George Washington's famous crossing of the Delaware River on Christmas Day, 1776. Traveling along the river on one side and the Delaware Canal (a National Historic Landmark) on the other, we will pass by (or through, if the bus will fit) covered bridges on our way to Fonthill and the Moravian Pottery and Tile Works. We will tour these two sites, both built of concrete in the second decade of the 20th century by archaeologist and antiquarian Henry Chapman Mercer. Fonthill was Mercer's own home, which he called a

## Wednesday, March 11

"concrete castle for the New World." The Tile Works produced tiles and mosaics for floors, walls and ceilings, and continues to this day to make hand-crafted tiles. Our next stop will be the James A. Michener Art Museum. After a catered lunch there, we will tour the Museum's galleries, which house the best collection of landscapes of the New Hope school of artists. Included are works by Daniel Garber (whose bucolic farm Cuttaloosa, we will have passed on the way), Edward Redfield, and John Folinsbee. The Michener also displays the woodwork of George Nakashima. We will cross the street to the Mercer Museum which houses a fascinating collection of pre-industrial tools. The Mercer is home to the Bucks County Historical Society and the recently restored Spruance Library, which we will have a chance to tour before heading back to the hotel.

Tour 13. Winterthur Museum and Gardens, and Longwood Gardens, 8:00 am-6:00 pm

Limit: 40

Price: \$60

Includes: Round trip transportation via motorcoach, professional guide, ARLIS/DVC volunteer to assist, wheelchair accessible.

This day long tour combines two outstanding attractions of the Brandywine Valley. Our first stop will be at Winterthur, the former country estate of Henry Francis du Pont, which houses his unrivalled collection of early American decorative arts. After a short introductory slide presentation, we will divide into small groups for a highlights tour of the collection, viewing eleven period rooms. We will reassemble for a tour of "Deceit, Deception, and Discovery," the special exhibition in the galleries, led by the curator of the show, Linda Eaton. Then there will be time for both lunch on one's own, either in the Cappuccino Cafe or in the Pavilion Cafeteria, and for visiting Winterthur's gift shops. After lunch, we will reassemble for the short bus ride to Longwood Gardens.

Founded by Pierre du Pont, Longwood Gardens is a spectacular horticultural display including 1,050 outdoor acres and 20 indoor gardens. Because of the time of year, we will most likely spend our time indoors viewing the wonderful orchid collection, displays arranged by temperate zones, and other greenhouse displays. Our two-hour stay will also allow time to visit Longwood's lovely gift shop before heading back to the hotel in Philadelphia.

Tour 14. Beaux-Arts Philadelphia Walking Tour, 8:45 am-11:00 am

Limit: 25

Price: \$12.00

Includes: Foundation for Architecture guide, ARLIS/DVC volunteer to assist, wheelchair accessible.

Starting at the Doubletree Hotel, this tour will explore the late 19th- and early 20th- century architecture that was influenced by the Ecole des Beaux-Arts in Paris. The Beaux-Arts style, with its references to classical architecture, was used extensively in Philadelphia's contribution to the City Beautiful Movement. The tour will include some of the grand, yet intimate, residential buildings in Rittenhouse Square, as well as some of the monumental public structures on the Benjamin Franklin Parkway.

**Tour 15. Philadelphia Museum of Art, 9:30 am-1:30 pm**

Limit: 20

Price: \$25.00

Includes: Round trip transportation via motorcoach, professional guide, ARLIS/DVC volunteer to assist, wheelchair accessible.

The Philadelphia Museum of Art, founded in 1876, is unique among American museums in its integrated presentation of a full range of both fine and applied arts from Asia, Europe, and the United States. The collections include masterpieces of painting, sculpture, prints, and drawings, as well as a wide range of furniture, silver, glasswork, architectural elements, and entire furnished rooms from historic houses. ARLIS member Barbara Sevy (retired Philadelphia Museum of Art librarian) will guide us through a one-hour Collection Highlights tour. In the remaining two and one-quarter hours you may view the galleries on your own, have lunch in the cafeteria or restaurant, and visit the gift shops before returning to the hotel.

NOTE: Tour 15 and 16 may be taken separately or together. If you choose to register for both, check off the appropriate spaces on the registration form and include payment for both tours.

**Tour 16. Museum of American Art of the Pennsylvania Academy of the Fine Arts, 1:30 pm-4:30 pm**

Limit: 20

Price: \$25.00

Includes: Round trip transportation via motorcoach, professional guide, ARLIS/DVC volunteer to assist, wheelchair accessible.

The Museum of American Art of the Pennsylvania Academy of the Fine Arts is the nation's first art museum and school of fine arts. We will begin with a Museum Highlights tour exploring three centuries of American art from the permanent collections. An overview of the

Academy and its spectacular building (designed by Frank Furness) will be included, as will a tour of the special exhibition Pop/ Abstraction. During the remaining time you may view the galleries on your own and visit the gift shop before returning to the hotel.

NOTE: Tour 15 and 16 may be taken separately or together. If you choose to register for both, check off the appropriate spaces on the registration form and include payment for both tours.

8:00 am-5:00 pm

**Executive Board Post-Conference Meeting  
Concerto, Third Floor**

Open to the membership on a seating available basis.

Workshop: 9:00 am-4:00 pm

**Workshop 2 Keeping It Safe: Preservation of Library Materials**

Limit: 15

Price: \$50.00, materials included. (Lunch is not included.)

Location: University of the Arts, Anderson Hall, 333 S. Broad Street, Printmaking Department, 5th Floor, Room 522 (Two blocks south of the hotel.)

All libraries have concerns and problems with preserving special materials in their collections whether those materials are rare books and manuscripts, difficult-to-handle ephemera, photographs, or some other prized or hard-to-replace item. While much of this work should be given to conservation professionals, there is a great deal librarians can do in their own libraries to protect and preserve special items. This workshop will emphasize what librarians can do with their own collections.

A significant portion of the workshop will be hands-on work time. Enclosures suitable for the preservation of various types of materials will be made by each attendee. This is a skill which librarians in any type of library can use and teach to their staff.

Conservation concerns, preventions, and cures will be addressed and discussed. Attendees are encouraged to bring items from their libraries for discussion and advice. The workshop is given under the auspices of the American Philosophical Society, Philadelphia, PA.

Sponsor: ARLIS/Delaware Valley Chapter

Organizer: Martha Hall, Access Services and Visual Resources Librarian, University of the Arts

Leaders: Hedi Kyle, Head Conservator, American Philosophical Society  
Denise Carbone, Conservation Technician, American Philosophical Society

# Friday, March 6, 1998

7 a.m.														
8 a.m.	Registration Desk Open	Executive Board Pre-Conference Meeting	VRA Session	RLG Art & Architecture Group Meeting										
9 a.m.														
10 a.m.														
11 a.m.					VRA Roundtable									
Noon														
1 p.m.			Internet Room Open					Tours I & 2						
2 p.m.														
3 p.m.						VRA Session								
4 p.m.														
5 p.m.														
6 p.m.		Committee Business Meetings I									First Friday in Old City			
7 p.m.														
8 p.m.				ARLIS/NA & VRA Welcome Party										
9 p.m.														
10 p.m.														
11 p.m.														
12 a.m.														

# Saturday, March 7, 1998

7 a.m.																
8 a.m.	Registration Desk Open	Internet Room Open	Committee Business Meetings II	Workshop I	Tours II 3, 4, & 5	Members' Art Exhibition										
9 a.m.																
10 a.m.							Committee Business Meetings III									
11 a.m.																
Noon																
1 p.m.								Panel Sessions I Session 1, 2, & 3		Tours III Tour 6						
2 p.m.																
3 p.m.								Panel Sessions II Session 4, 5, & 6								
4 p.m.																
5 p.m.																
6 p.m.			New Member & First-Timer Meeting						Transportation to Convocation							
7 p.m.									Convocation							
8 p.m.									Reception							
9 p.m.																
10 p.m.																
11 p.m.																
12 a.m.																

# Sunday, March 8, 1998

7 a.m.	Yoga			
8 a.m.	Registration Desk Open	Internet Room Open		
9 a.m.			Panel Sessions III Session 7, 8, & 9	Members' Art Exhibition
10 a.m.				
11 a.m.			Panel Sessions IV Session 10, 11, & 12	Exhibits Set-Up
Noon				
1 p.m.				
2 p.m.			Ask ARLIS 1 & 2	
3 p.m.			Discussion Group I	
4 p.m.				Exhibits Opening Party
5 p.m.				
6 p.m.				
7 p.m.		Serials Swap I	Tours IV Tour 7	
8 p.m.				
9 p.m.				
10 p.m.				
11 p.m.				
12 a.m.				

# Monday, March 9, 1998

7 a.m.	Yoga				
8 a.m.	Registration Desk Open	Internet Room Open	Chapter Officers' Breakfast	Serials Swap II	
9 a.m.				Exhibits Continental Breakfast and Exhibits Open	Members' Art Exhibition
10 a.m.			Division Business Meetings		
11 a.m.			Membership Meeting		
Noon					
1 p.m.			Round Table Business Meetings		
2 p.m.				Exhibits Open	
3 p.m.			Section Business Meetings		
4 p.m.					
5 p.m.			Cataloging Problems Discussion Group		
6 p.m.					
7 p.m.	Ars Libri Reception				
8 p.m.					
9 p.m.					
10 p.m.					
11 p.m.					
12 a.m.					

# Tuesday March 10, 1998

7 a.m.	Yoga				
8 a.m.		Registration Desk Open	Leadership Breakfast	Exhibits Open	Members' Art Exhibition
9 a.m.					
10 a.m.		Internet Room Open	Panel Sessions V Session 13, 14, & 15	Getty Vocab. Users Group Meeting	
11 a.m.				BHA Users Group Meeting	
Noon					
1 p.m.	Tours V Tour 8, 9, 10, 11		Discussion Groups II		
2 p.m.					
3 p.m.					
4 p.m.					
5 p.m.					
6 p.m.					
7 p.m.					
8 p.m.					
9 p.m.					
10 p.m.					
11 p.m.					
12 a.m.					

# Wednesday, March 11, 1998

7 a.m.			
8 a.m.	Tours VI Tour 12, 13, 14, 15 & 16	Executive Board Post Conference Meeting	
9 a.m.			Workshop 2
10 a.m.			
11 a.m.			
Noon			
1 p.m.			
2 p.m.			
3 p.m.			
4 p.m.			
5 p.m.			
6 p.m.			
7 p.m.			
8 p.m.			
9 p.m.			
10 p.m.			
11 p.m.			
12 a.m.			



## Doubletree Hotel Lobby Level, First Floor

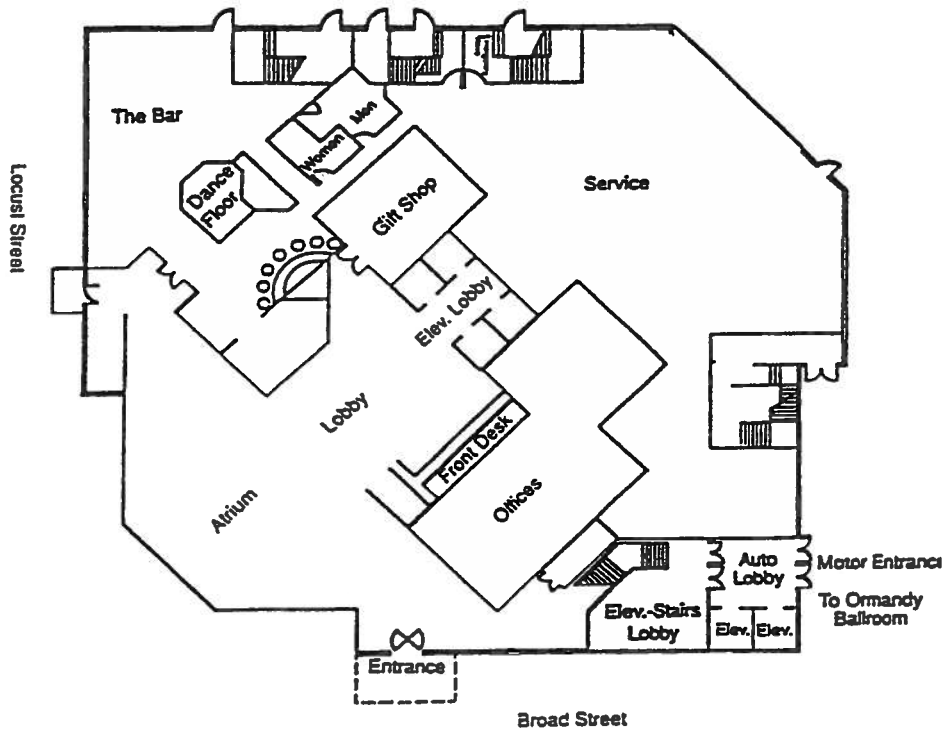

Hotel Views

## Doubletree Hotel Ormandy Ballroom, Lobby Level

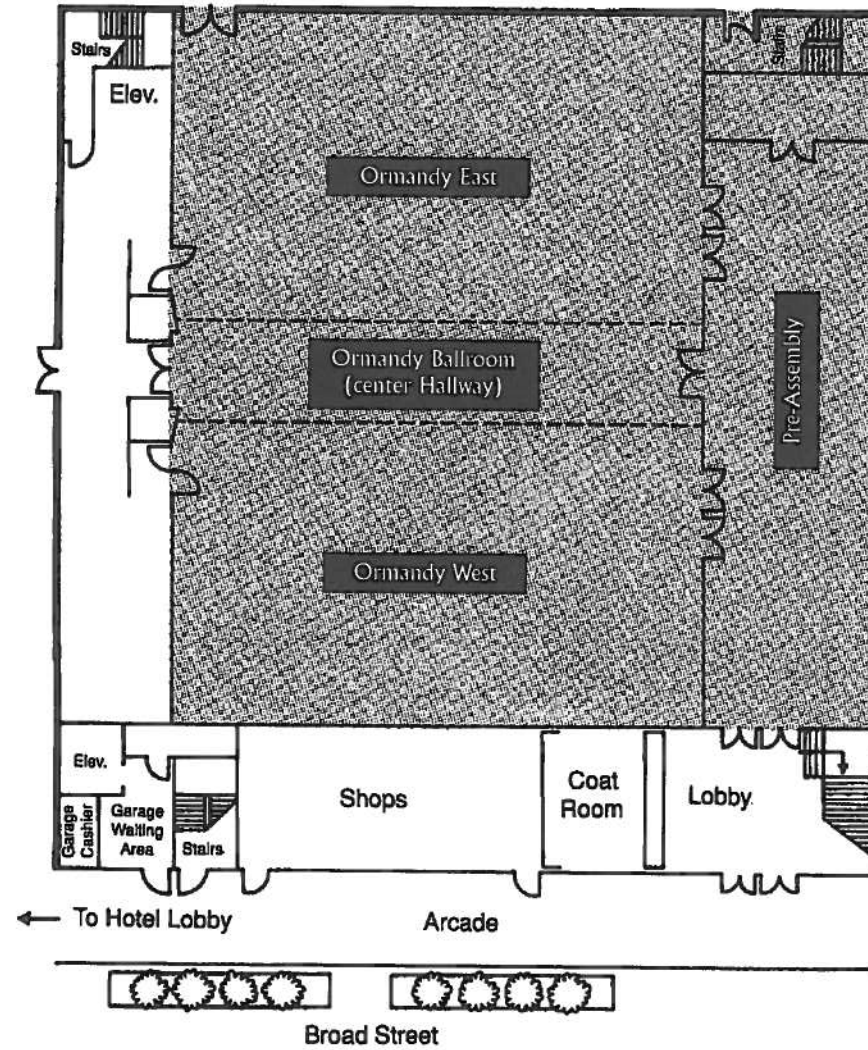

Hotel Views

## Doubletree Hotel Restaurant Level, Second Floor

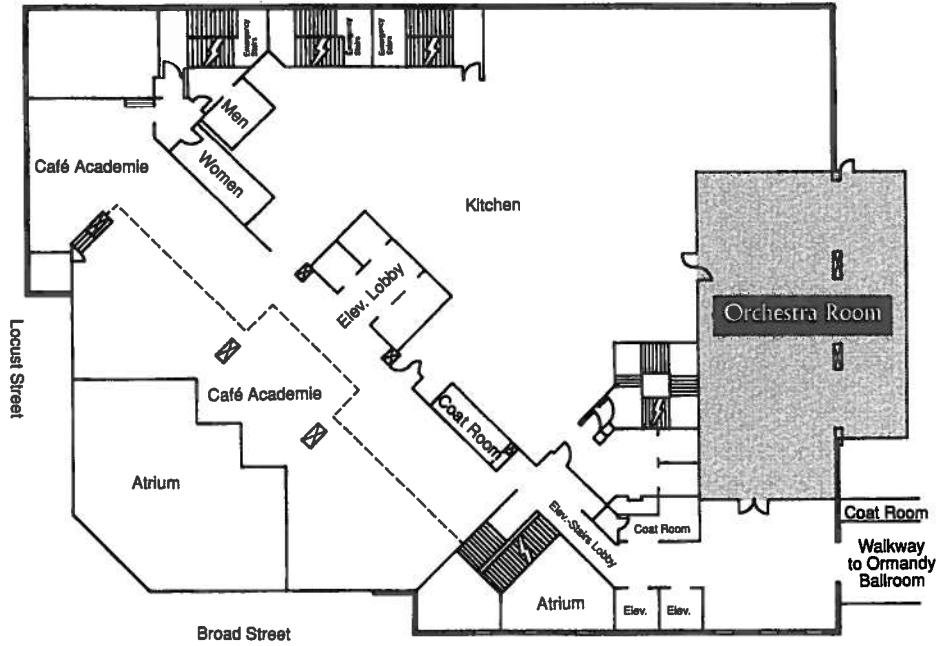

Hotel Views

## Doubletree Hotel Meeting Level, Third Floor

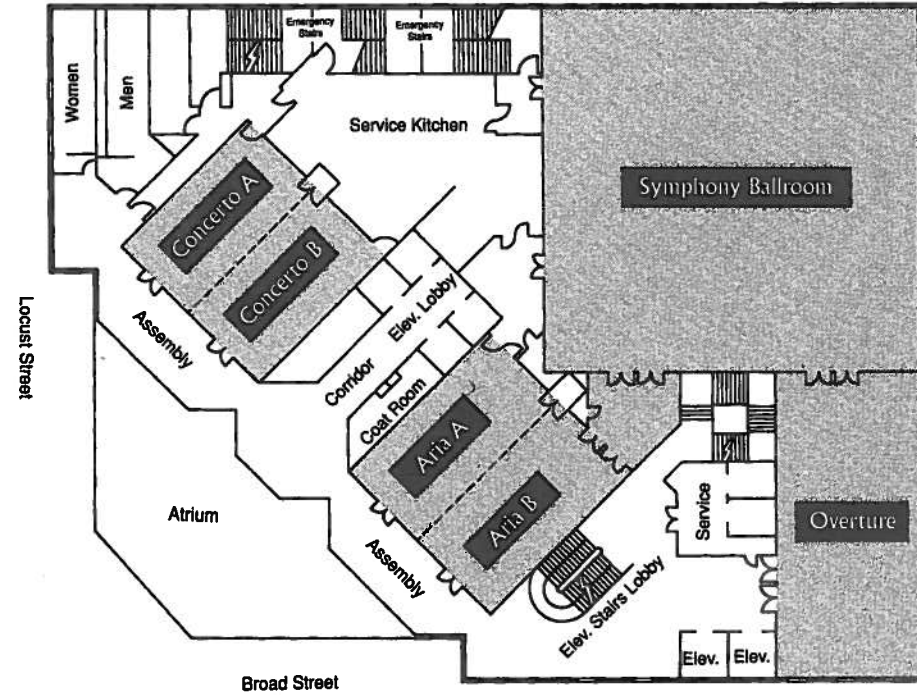

Hotel Views

## Doubletree Hotel Meeting Level, Fourth Floor

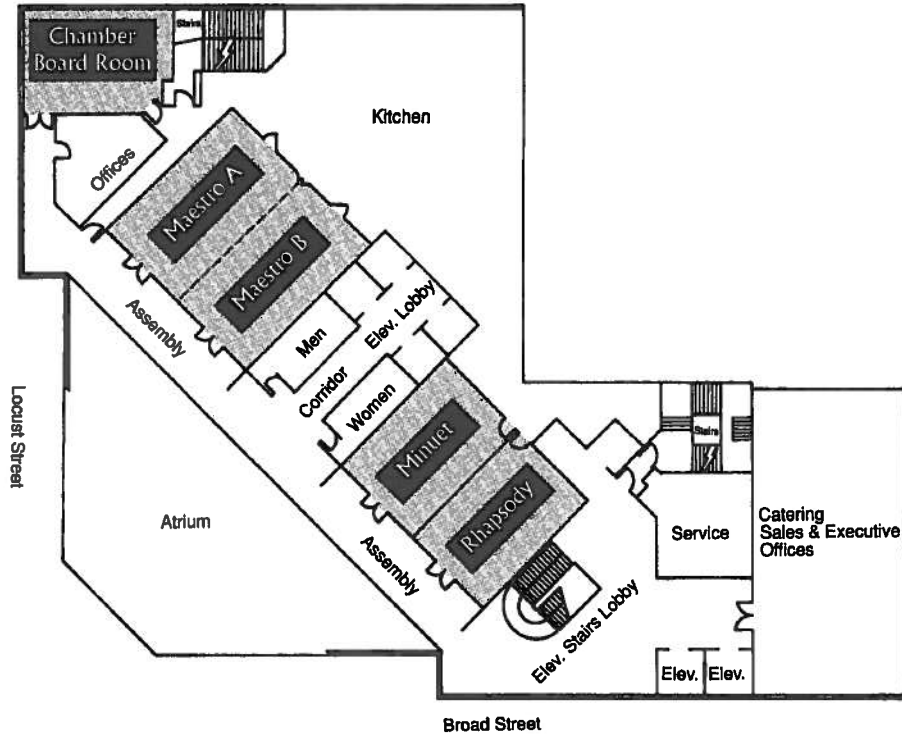

Hotel Views

## Doubletree Hotel Meeting/Recreational Level, Fifth Floor

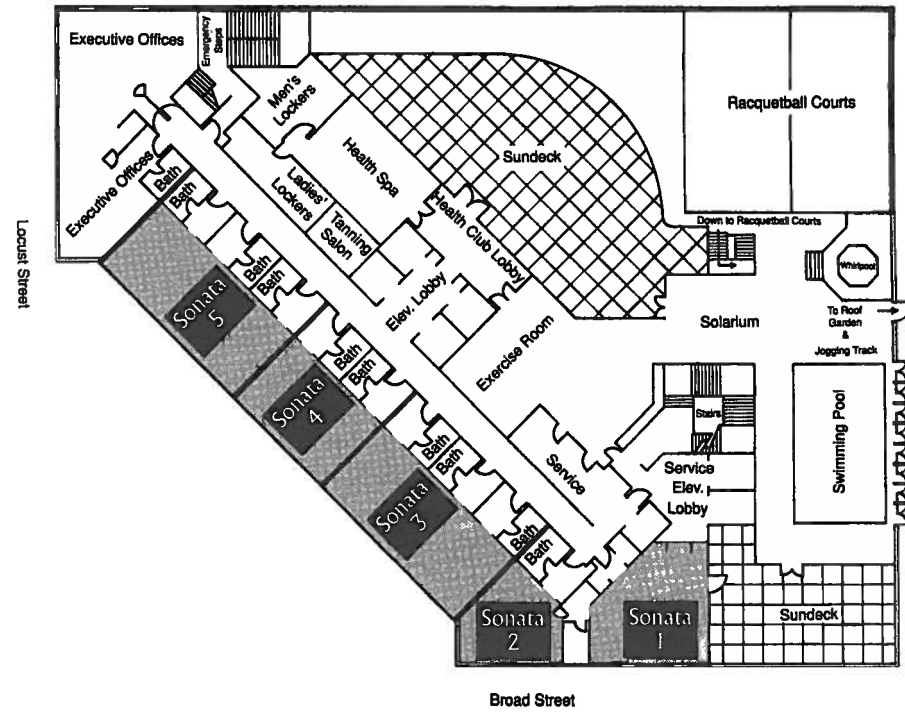

Hotel Views

# Acronyms and Terms

AACR2	Anglo-American Cataloging Rules, Second Edition
AAG	Art and Architecture Group (RLG)
AAM	American Association of Museums
AAT	Art and Architecture Thesaurus (Getty)
ACRL	Association of College and Research Libraries
ADAG	Architecture Drawings Advisory Group
AHIP	Art History Information Program (Getty)
AIA	American Institute of Architects
AITF	Art Information Task Force
ALA	American Library Association
ARLIS-L	ARLIS/NA Electronic Discussion List
ASIS	American Society for Information Science
AVIADOR	Avery Videodisc Index of Architectural Drawings on RLIN
CAA	College Art Association
CAC	Cataloging Advisory Committee (ARLIS/NA)
CARLIS-L	Canadian Members' ARLIS/NA Electronic Discussion List
CC:DA	Committee on Cataloging: Description and Access (ALA)
CD-ROM	Compact Disc Read-Only Memory
CD-I	Interactive Compact Disc
CIC	Committee on Institutional Cooperation
CHIN	Canadian Heritage Information Network
CIHA	International Committee of the History of Art
CIMI	Computer Exchange of Museum Information
CLA	Canadian Library Association
CNI	Coalition for Networked Information
CRL	Council on Library Resources
DART	Decorative Arts Round Table (ARLIS/NA)
DBMS	Database Management System
DCTV	Digital Color Television
DIALOG	An online database system
DVI	Digital Video Interfaces
EAD	Encoded Archival Description
EmbARK	Digital Collections' Collection Management Application Software
EPIC	OCLC's online reference system

ERIC	Educational Resources Information Center
GLIRT	Gay and Lesbian Interests Round Table (ARLIS/NA)
HDTV	High Definition Television
HTML	Hypertext Mark-up Language
HTTP	Hypertext Transport Protocol
ICONCLASS	An iconographic classification system
IFLA	International Federation of Library Associations and Institutions
ILL	Interlibrary Loan
INNOPAC	An online integrated library system
IRC	International Relations Committee (ARLIS/NA)
LAN	Local Area Network
LCSH	Library of Congress Subject Headings
MARBI	Machine Readable Bibliographic Information Committee (ALA)
MARC	Machine Readable Cataloging
NAAB	National Architecture Accreditation Board
NACO	Name Authorities Cooperative Project (LC)
NARC	North American Relations Committee (ARLIS/NA)
NART	New Art Round Table (ARLIS/NA)
NEA	National Endowment for the Arts
NEH	National Endowment for the Humanities
NFB	National Film Board of Canada
NINCH	National Initiative for a Networked Cultural Heritage
NISO	National Information Standards Organization
NOTIS	An online integrated library system
NTSC	National Television Standard Code
OCLC	Online Catalog Library Center, Inc.
OCUC	OCLC Online Union Catalog
OPAC	Online Public Access Catalog
PCC	Program for Cooperative Cataloging
PLA	Public Library Association
PRISM	An access service to OCLC
PURL	Persistent Universal Resource Locator
RAM	Random Access Memory
RAMA	Remote Access to Museum Archives

## LOCAL EVENTS AND ACTIVITIES

RISS	Reference and Information Services Section (ARLIS/NA)
RLG	Research Libraries Group
RLIN	Research Libraries Information Network (RLG)
SAA	Society of American Archivists
SCIPIO	Sales Catalog Index Project Input On-Line (RLIN)
SGML	Standard Generalized Mark-up Language
SLA	Special Libraries Association
TAU	Thesaurus Artis Universalis
URL	Universal Resource Locator
VRA	Visual Resources Association
VRAC	Visual Resources Advisory Committee (ARLIS/NA)
WAN	Wide Area Network
VRD	Visual Resources Division (ARLIS/NA)
VRMS	Visual Resources Management System
WAART	Women and Art Round Table (ARLIS/NA)
WAIS	Wide Area Information System
WWW	World Wide Web

Philadelphia offers an abundance of cultural, entertainment, and sporting opportunities. Following are those easily accessible from the Doubletree Hotel. Some of these events require ticket purchase.

Additional information on Philadelphia and area attractions is available at the Philadelphia Convention and Visitors Centers at 16th Street and JFK Boulevard, and at 3rd Street and Chestnut Street, from 9:00 am-5:00 pm, seven days a week. They can also be reached at 636-1666 (recorded message); press 5 to speak with a person. There will also be brochures, restaurant menus, maps, and local guides available at the conference registration desk.

**Goldie Paley and Levy Galleries, Moore College of Art and Design** (20th Street and the Benjamin Franklin Parkway, 215-568-4515, ext. 1119. 10:00 am-5:00 pm, Tuesday-Friday; 12:00 pm-4:00 pm, Saturday, Sunday). "The Philadelphia Ten," painting and sculpture created by a group of women artists working together from 1917 to 1945. January 23-March 13.

**Institute of Contemporary Art** (118 S. 36th Street at Sansom Street, 215-898-7108. 10:00 am-5:00 pm, Wednesday-Sunday; 10:00 am-7:00 pm, Thursday). "Glenn Ligon: Unbecoming," drawings, paintings, prints, installations, and archival materials connected by Ligon's autobiographical search for his identity as an African American and as a gay man. January 17-March 8.

**Museum of American Art of the Pennsylvania Academy of the Fine Arts** (118 North Broad Street, 215-972-7600. 10:00 am-5:00 pm, Monday-Saturday; 11:00 am-5:00 pm, Sunday). "Pop/ Abstraction" investigates abstract qualities of 1960s Pop Art and its shared aesthetics with Minimalism and contemporary production. Mid-February-April 19.

"April Gornik: Graphic Works," an exhibit of drawings and prints coinciding with the exhibition of this noted contemporary landscape artist at the University of the Arts. January 10-April 26.

"Kate Moran," the work of Academy graduate and multi-media artist. January 10-April 12.

**Philadelphia Museum of Art** (26th Street and Benjamin Franklin Parkway, 215-763-8100, 215-684-7500-recorded information. 10:00 am-5:00 pm, Tuesday, Thursday-Sunday; 10:00 am-8:45 pm, Wednesday). "Paris in the 1890's: Painters' Prints in the Age of Bonnard, Vuillard, and Toulouse-Lautrec." January 24-April 5. "American Self-Taught Artists of the 20th Century: An Anthology." March 10-May 17.

**Rodin Museum** (22nd Street and Benjamin Franklin Parkway, 215-763-8100. 10:00 am-5:00 pm, Tuesday-Sunday). The museum houses the largest collection of Rodin sculpture and drawings outside of Paris, including "The Thinker," "The Burghers of Calais," and the "Gates of Hell."

Rosenwald-Wolf Gallery, University of the Arts (333 S. Broad Street, 215-875-1116. 10:00 am-5:00 pm, Monday, Tuesday, Thursday, Friday; 10:00 am-9:00 pm, Wednesday; 12:00 pm-5:00 pm, Saturday, Sunday). "April Gornik: Embodied Landscapes," an exhibit of selected paintings by one of the most prominent landscape painters in contemporary art. January 9-March 6.

University of Pennsylvania Museum of Archaeology and Anthropology (33rd and Spruce Streets, 215-898-4000. 10:00 am-4:30 pm, Tuesday-Saturday; 1:00 pm-5:00 pm, Sunday). "Roman Glass: Reflections on Cultural Change" features over 200 examples of Roman glass and related materials from the first century B.C. through the 6th century A.D. September 27, 1997 through October 1998.

Athenaeum (219 S. 6th Street, 215-925-2688. 9:00 am-5:00 pm, Monday-Friday). "Philadelphia Victorian: The Building of the Athenaeum" celebrates the 150th anniversary of the opening of the Italianate palazzo Athenaeum building designed by John Notman. October 30-March 13.

Free Library of Philadelphia (19th and Vine Streets, 215-686-5322. Hours listed under Libraries and Archives on p. 64). "Music in Philadelphia," exhibited in the Main Lobby, includes images and artifacts from the long history of musical life in the city. October 15-March 15.

"The Illuminated Saint: Images and Iconography from Medieval Manuscripts," exhibited in the Rare Book Department. February 23-May 29.

Library Company of Philadelphia (1314 Locust Street, 215-546-3181. 9:00 am-4:45 pm, Monday-Friday). A special exhibit will be set-up for ARLIS conference attendees.

Rosenbach Museum & Library (2010 Delancy Place, 215-732-1600. 11:00am-4:00 pm, Tuesday-Sunday). "Words & Deeds: Natives, Europeans and Writing in Eastern North America, 1500-1850" runs through March 8th. Also showing, a small exhibition commemorating the ARLIS/NA conference.

Philadelphia Orchestra (Academy of Music, Broad and Locust Streets, 215-893-1999). David Zinman, conductor. Program to include: Harbison, Remembering Gatsby; Mozart, Violin Concerto No.3, K.216; Janacek, Violin Concerto, "Pilgrimage of the Soul;" and Kodaly, Dances of Galanta. March 6, 7, & 10.

Peter Nero and The Philly Pops (Academy of Music, Broad and Locust Streets, 215-893-1999). March 8, 9, & 11.

Zellerbach Theatre, Annenberg Center (3680 Walnut St., 215-247-BACH). Bach Festival of Philadelphia. Paul Winter Consort and Convergence Dancers. The Grammy award-winning ensemble with a 20th-century celebration of Bach's music interpreted by dance; choreography by Janaea Rose Lyn; guest artists Leslie Carothers, Christine Cox and Meredith Rainey of the Pennsylvania Ballet. March 7, 8 p.m.

Merriam Theater (250 South Broad Street, 215-732-5446). "Unforgettable," the music of Nat King Cole opens March 10th.

Walnut Street Theatre (825 Walnut Street, 215-574-3550). "To Kill a Mockingbird" opens March 10th.

Wilma Theater (265 South Broad Street, 215-546-STAGE). "On the Razzle," a comedy by Tom Stoppard. February 18-March 15.

Franklin Institute (20th St. and Benjamin Franklin Parkway, 215-448-1200, www.fi.edu). "Powers of Nature" explores weather and other natural phenomena.

Philadelphia Flower Show (Pennsylvania Convention Center, 12th and Arch Streets, 215-988-8899, www.libertynet.org/~phs. 8:00 am-6:00 pm, Sunday; 10:00 am-9:30 pm, Monday-Friday; 8:00 am-9:30 pm, Saturday). The Philadelphia Flower Show, founded in 1829, is the largest indoor flower show in the world. The theme of this year's show is "La Passion du Jardin" and will portray France and aspects of French life. March 1-8.

First Friday (for information, see under Friday, March 6, 5:00 pm)

# LOCAL INFORMATION

## RESTAURANTS

Restaurants of all types abound in Philadelphia, particularly around and near the Doubletree Hotel. The restaurants listed below are within easy walking distance of the hotel. Please refer to the restaurant guide in the registration packet for a more complete listing of establishments, and the Restaurant Notebook at the conference registration desk for a selection of restaurant menus.

Price ranges [per person, excluding alcoholic beverages, sales tax, and tips]. When two price ranges are given the lower price is for lunch and the higher for dinner.

\$ = under \$10.00

\$\$ = \$10.00-\$20.00

\$\$\$ = \$20.00-\$30.00

\$\$\$\$ = over \$30.00

NWA = Not Wheelchair Accessible

MCC = Major Credit Cards

### LOCUST STREET

(the hotel is on Broad Street (14th) at Locust)—between 12th and 16th Streets

#### Bassetts' Original Turkey \$

15th and Locust Streets. 546-1812  
7:00 am-8:00 pm, Monday-Friday;  
11:00 am-8:00 pm, Saturday.

#### Bertucci's \$\$

1515 Locust Street. 731-1400  
11:00 am-11:00 pm, Monday-Thursday; 11:00 am-12:00 am, Friday, Saturday; 12:00 pm-11:00

pm, Sunday. Brick over pizza plus other Italian entrees. MCC

#### Deux Cheminees \$\$\$\$

1221 Locust Street. 790-0200  
5:30 pm-9:00 pm, Monday-Friday; 5:30 pm-9:30 pm, Saturday, Sunday. French. Frank Furness townhouse. Reservations. NWA, MCC

#### DiLullo Centro \$\$\$\$

1407 Locust Street. 546-2000  
5:00 pm-9:00 pm, Monday-Thursday; 5:00 pm-10:00 pm, Friday, Saturday. Northern Italian. Reservations. MCC

#### Girasole Ristorante \$\$\$

1305 Locust Street. 985-4659  
12:00 pm-2:30 pm, Monday-Friday; 5:00 pm-10:30 pm, Monday-Thursday; 5:00 pm-11:00 pm, Friday, Saturday; 5:00 pm-10:30 pm, Sunday. Italian. Reservations. NWA, MCC

#### Ilana's \$-\$\$

1420 Locust Street. 545-1845  
11:30 am-12:00 am, Monday-Sunday; 10:30 am-3:30 pm, Sunday brunch. Classic American. NWA, MCC

#### Locust Rendezvous \$-\$\$

1415 Locust Street. 985-1163  
11:00 am-1:00 am, everyday. Breakfast menu anytime Saturday or Sunday. American. MCC

#### Mama Angelina's Pizza \$

1337 Locust Street. 735-4987  
7:00 am-12:30 am, Monday-Thursday; 7:00 am-2:00 am, Friday; 12:00 pm-2:00 am, Saturday; 12:30 pm-12:30 am, Sunday.

#### Napoleon \$\$\$-\$\$\$\$

1500 Locust Street. 893-9100  
11:00 am-10:00 pm, Monday-Friday;  
5:00 pm-12:00 am, Saturday; 5:00 pm-9:00 pm, Sunday. American with European influence. Reservations. MCC

#### Tequila's \$\$-\$\$\$

1511 Locust Street. 546-0181  
11:30 am-2:00 pm, Monday-Friday;  
5:00 pm-10:00 pm, Monday-Thursday;  
5:00 pm-11:00 pm, Friday, Saturday. Mexican. Large selection of premium tequilas and Mexican beers. NWA, MCC

#### Upstairs at Varalli \$\$-\$\$\$

1343 Locust Street. 546-4200  
11:30 am-10:00 pm, Monday-Saturday; 11:30 am-9:00 pm, Sunday. Italian trattoria overlooking the Avenue of the Arts. Reservations. NWA, MCC

### SPRUCE STREET

(one block South of the hotel) — between 12th and 16th Streets:

#### 1521 Cafe Gallery \$\$

1521 Spruce Street. 546-1521  
11:00 am-12:00 am, Tuesday-Saturday;  
11:00 am-3:00 pm, Sunday brunch. Family owned. Freshly prepared dishes using organic produce, desserts. NWA, BYOB

#### Chanterelles \$\$\$\$

1312 Spruce Street. 735-7551  
5:30 pm-9:30 pm, Monday-Saturday.  
French. Reservations. NWA, MCC

#### Grand Canal Szechuan Restaurant \$-\$\$

1506 Spruce Street. 546-3888  
11:30 am-10:30 pm, Monday-Thursday; 11:30 am-11:00 pm, Friday, Saturday; 4:00 pm-10:30 pm, Sunday. MCC

#### Original Pizza Academy \$

1508 Spruce Street. 732-6607  
11:00 am-11:30 pm, Monday-Thursday;  
11:00 am-12:30 am, Friday, Saturday;  
12:00 pm-11:30 pm, Sunday

#### Thinny Delights \$

1511 Spruce Street. 545-0716  
10:00 am-10:00 pm, Monday-Sunday.  
Light foods.

### BROAD STREET

(the hotel is located on Broad Street)—between Chestnut and Spruce Streets

#### The Green Village Food Market \$

231 S. Broad Street (corner of Broad and Locust Streets). 735-7792  
6:30 am-9:00 pm, Monday-Friday;  
8:00 am-8:00 pm, Saturday; 9:00 am-7:00 pm, Sunday. Breakfast and lunch every day. Take out only. Soups, salads, generous sandwiches and hoagies, fruits, bagels and pastries.

#### Italian Bistro \$-\$\$

211 S. Broad Street. 731-0700  
11:00 am-11:30 pm, Monday-Friday;  
12:00 pm-11:30 pm, Saturday, Sunday. MCC

#### Joseph's on the Avenue \$\$\$-\$\$\$\$

260 S. Broad Street. 735-2800  
11:30 am-2:30 pm, Monday-Friday;  
4:00 pm-11:00 pm, Monday-Thursday; 4:00 pm-11:30 pm, Friday, Saturday; 3:00 pm-10:00 pm, Sunday. Late menu 10:30 pm-1:00 am, Friday, Saturday. Italian. Reservations. MCC

#### Noodle Heaven \$-\$\$

220-224 S. Broad Street. 735-6191  
11:30 am-10:30 pm, Monday-Thursday;  
11:30 am-11:00 pm, Friday; 12:00 pm-11:00 pm,

Saturday; 12:00 pm-10:00 pm, Sunday.  
Chinese. No bar. MCC

### **PARK HYATT PHILADELPHIA, BELLEVUE RESTAURANTS**

200 S. Broad Street at Walnut Street  
[Handicap entrance on Chancellor Court.]

#### **Ciboulette \$\$\$\$**

200 S. Broad Street, Ballroom Level,  
Park Hyatt. 790-1210  
12:00 pm-2:00 pm, Tuesday-Friday;  
5:30 pm-10:00 pm, Monday-Saturday.  
Provençal French. MCC

#### **Downstairs at the Bellevue \$**

200 S. Broad Street, Lower level.  
7:00 am-6:00 pm, Monday-Friday; 9:00  
am-3:00 pm, Saturday. Convenient food  
court with two dozen food establishments.  
ATM inside.

#### **Founders \$\$\$-\$\$\$\$**

1415 Chancellor Court, 19th floor, Park  
Hyatt. 893-1776  
6:30 am-2:00 pm, Monday-Sunday; 5:30  
pm-10:00 pm, Monday-Thursday; 5:30  
pm-11:00 pm, Friday, Saturday; 5:30 pm-  
9:00 pm, Sunday; 11:30 am-2:00 pm,  
Sunday brunch. The Ethel Barrymore  
Room features three-course English  
afternoon tea Wednesday-Saturday. Light  
menu evenings. Philadelphia Library  
Lounge features bar menu. MCC

#### **Palm Restaurant \$\$\$\$**

200 S. Broad Street, 1st Floor. 546-7256  
11:30 am-11:00 pm, Monday-Friday; 5:00 pm-  
11:00 pm, Saturday; 4:30 pm-9:00 pm,  
Sunday. Classic American. Reservations. MCC

#### **Zanzibar Blue \$\$\$**

200 S. Broad Street, Lower level. 735-5200  
Restaurant: 5:30 pm-10:30 pm,  
Monday-Sunday. Bar only: 10:30-12:00 am.  
International classic. Jazz every night.  
MCC

#### **Ruth's Chris Steak House \$\$\$\$**

260 S. Broad Street. 790-1515  
5:00 pm-11:30 pm, Monday-Saturday;  
4:30 pm-10:30 pm, Sunday. Prime steak, live  
lobsters, fresh seafood. Reservations. MCC

#### **Tony Clark's \$\$\$**

121 S. Broad Street. 772-9238  
Restaurant: 11:30 am-10:30 pm, Monday-  
Saturday; 4:30 pm-9:30 pm, Sunday. American  
classics. Reservations. Bar only: 10:30 pm-1:00  
am, Monday-Saturday; 9:30 pm-1:00 am,  
Sunday. Music and dancing. MCC

### **RESTAURANTS NEARBY SERVING BREAKFAST ON WEEKENDS**

#### **Ala' Mode - Two Sisters \$**

1141-43 Pine Street. 574-4277  
11:00 am-12:00 am, Monday-Saturday; 10 am-  
12:00 am, Sunday. Sunday brunch, 10:00 am-  
2:00 pm. Light meals. Freshly baked desserts.  
NWA

#### **Fairmount Bagel Institute \$**

225 S. 15th Street. 732-4573  
7:00 am-4:00 pm, Monday-Friday; 8:00 am-  
3:00 pm, Saturday, Sunday.

#### **Little Pete's Restaurant and**

**Cocktail Lounge \$**  
17th and Chancellor Streets. 545-5508  
Open 24 hours, 7 days.  
Diner food.

## **COFFEE HOUSES**

#### **The Last Drop Coffeehouse**

13th and Pine Streets. 893-9262. 7:30 am-11:00  
pm, Sunday-Thursday; 8:30 am-12:00 am,  
Friday, Saturday. Very smoky.

#### **Millennium Coffee**

212 S. 12th Street (between Walnut and Locust).  
731-9798. 7:30 am-12:00 am, Monday-Thursday;  
7:30 am-12:00 am, Friday; 10:00 am-12:00 am,  
Sunday. Good light fare.

#### **Passero's Gourmet Coffee Co.**

1401 Locust Street. 546-2515.  
6:45 am-5:00 pm. Monday-Friday.  
Pastries, bagels, muffins.

#### **Starbuck's**

1528 Walnut Street. 732-0708.  
6:00 am-9:00 pm, Monday-Friday;  
7:00 am-9:00 pm, Saturday; 7:30 am-8:00  
pm, Sunday. Pastries, bagels, muffins.

#### **Xando**

12th and Walnut Streets. 413-1608  
15th and Locust Streets. 893-9696.  
6:30 am-2:00 am, Monday-Friday; 7:00 am-  
2:00 am, Saturday; 7:30 am-2:00 am, Sunday.  
Bar service after 4:00 pm. Pastries, bagels,  
soups, sandwiches, salads, desserts. MCC

## **PUBS AND BARS**

#### **Copa Tool \$\$**

263 S. 15th Street. 735-0848.  
11:30 am-12:00 am, 7 days.  
Bar open until 2:00 am  
Eclectic menu. NWA, MCC

#### **Dr. Watson's Pub \$\$**

216 S. 11th Street. 922-3427. 11:00 am-2:00 am,  
Monday-Friday; 12:00 pm-2:00 am, Saturday,  
Sunday. Restaurant and bar. MCC

#### **Frank Clements Tavern \$-\$\$**

224 S. 15th Street. 985-9600. Kitchen open:  
11:30 am-10:00 pm, Monday-Thursday,  
Saturday; 11:30 am-11:00 pm, Friday. The bar is  
generally open until 12:00 pm depending on  
how crowded it is. NWA, MCC

#### **Irish Pub \$\$**

1123 Walnut Street. 925-3311.  
2007 Walnut Street. 568-5603.  
11:00 am-2:00 am daily. Restaurant and bar.  
NWA, MCC

#### **Locust Rendezvous**

See entry under Restaurants.

#### **Monk's Cafe \$\$**

264 S. 16th Street. 545-7005  
11:30 am-1:00 am, Monday-Friday; 11:00 am-  
1:00 am, Saturday, Sunday. Sunday brunch  
until 5:00 pm. Neighborhood cafe. Belgian  
ales. Good mussels. NWA, MCC

#### **Moriarty's Restaurant and Bar \$\$**

1116 Walnut Street. 627-7676. 11:00 am-2:00  
am daily. NWA, MCC

#### **Tony Clark's**

See entry under Restaurants.

#### **Xando**

See entry under Coffee Houses.

#### **Zanzibar Blue**

See entry under Restaurants.



## GAY, LESBIAN, AND GAY-FRIENDLY PHILADELPHIA

While Center City Philadelphia is gay-friendly just about everywhere, the "gay corridor" is primarily east of Broad Street, between Walnut and Pine Streets (running east and west) and 12th Street and Broad Street (running north and south). Unless noted, all of the addresses listed here are within easy walking distance of the Doubletree Hotel. Additional information will be available at the Registration Desk.

### COMMUNITY INFORMATION

**William Way Lesbian, Gay, Bisexual and Transgender Community Center**  
1315 Spruce Street (between Broad Street and 13th Street). 732-2220. Web site: <http://www.iamproud.com/waygaycenter>  
12:00 pm-10:00 pm, Monday-Friday; 10:00 am-4:00 pm, Saturday. Housed in the former Engineers Club of Philadelphia building, the Community Center is home to a library of over 8,000 books and magazines (Steve Capsuto, librarian), and an archive, and provides meeting and office space for many community organizations. Stop by this lovely old building and look around.

**Philadelphia Gay & Lesbian Task Force**  
772-2000; Violence Hotline: 772-2005

**Gay & Lesbian AI-Anon**  
732-1918

**AIDS Information Network Library**  
1211 Chestnut Street, 7th floor. 215-575-1110  
10:00 am-5:00 pm, Monday and Friday; 12:00 pm-7:00 pm, Wednesday; 12:00 pm-5:00 pm,

Tuesday, Thursday, and Saturday. The world's first public lending library devoted solely to HIV/AIDS information, this institution also provides technical assistance to other service organizations that wish to establish their own information resource centers. Over 100,000 items (books, magazines, audio and video-tapes, pamphlets, brochures).

### NEWSPAPERS

The following weeklies are available for free in bars, bookstores, etc. Philadelphia Gay News is also available in newsboxes for \$ .75.

**Philadelphia Gay News**  
<http://www.epgn.com/>

**Au Courant**  
<http://www.au-courant.com/>

### BOOKSTORES

**Giovanni's Room**  
345 S. 12th Street (corner of 12th & Pine). 923-2960. [giophilp@netaxs.com](mailto:giophilp@netaxs.com)  
11:30 am-9:00 pm, Monday, Tuesday, and Thursday; 11:30 am-7:00 pm, Wednesday; 11:30 am-10:00 pm, Friday; 10:00 am-10:00 pm, Saturday; 1:00 pm-7:00 pm, Sunday.  
Store and mail-order. Books, CDs and tapes, magazines, videos, jewelry.

**Afterwords**  
218 S. 12th Street (12th between Walnut and Locust). 735-2393  
10:00 am-12:00 am daily. Magazines, newspapers, books, cards, gifts.

### BARS AND RESTAURANTS

**Woody's**  
202 S. 13th Street  
(between Walnut and Locust). 545-1893

11:00 am-2:00 am, Monday-Saturday; 12:00 pm-2:00 am, Sunday.

One of the most popular gay bars in Philadelphia, Woody's is a must for anyone who wants to see the local gay scene (Millennium Coffee and Shampoo are other very popular spots). Casual atmosphere, young professional crowd. Bring your boot-scootin' shoes for country-western dancing (lessons at 7:00 pm on Friday, 8:00 pm on Tuesday) on Tuesday, Friday, and Sunday nights. Disco on Saturday (\$5.00 cover on Saturday) and Thursday nights. ATM inside.

**Astral Plane**  
1708 Lombard Street. 546-6230  
5:00 pm-11:00 pm, Monday-Saturday. Sunday brunch, 11:30-2:30 pm.  
One of Philadelphia's original "restaurant renaissance" eateries. Good, reliable continental fare. Quiet setting. Seven blocks from hotel. MCC

**Cheap Art Cafe**  
260 S. 12th Street  
(between Locust and Spruce). 735-6650  
Open 24 hours, 7 days. Casual cafe; no alcohol.

**Franny's Place**  
203 S. 13th Street  
(between Walnut and Locust). 985-2344  
Opens 6:30 am Monday-Friday; 8:30 am Saturday; Closing hours vary from 12:00 am to 3:00 am.  
Leather and lox, bondage and bagels- this store is one of the area's stranger combinations. We're afraid to go in, but you might enjoy it. MCC

### Key West

207 S. Juniper Street (between Walnut and Locust, 13th and Broad). 545-1578  
4:00 pm-2:00 am Monday-Saturday; 12:00 pm-2:00 am Sunday.  
Combination piano bar and dance club. Catch Ramona Peterson on Friday evenings and sing along to your favorite Broadway numbers.

### Millennium Coffee

212 S. 12th Street (between Walnut and Locust). 731-9798  
7:30 am-12:00 am, Monday-Thursday; 7:30 am-12:00 am, Friday; 10:00 am-12:00 am, Sunday. Very popular coffee house/cafe. Elegant yet casual interior. Good light fare.

### Shampoo

417 N. 8th Street (between 7th and 8th Streets on Willow Street, north of Market Street - take a cab). 922-7500  
9:00 pm-2:00 am, daily.  
Hip mix of gay and straight for dancing. Fridays are gay "Shaft Fridays." If Woody's is empty, everyone's at Shampoo. MCC

### Sisters

1320 Chancellor Street (Chancellor is between Walnut and Locust). 735-0735  
4:00 pm-2:00 am, Monday-Saturday; 12:00 pm-2:00 am, Sunday. Sunday brunch, 12:00 pm-4:00 pm.  
The only primarily female gay spot. Dining, dancing, pool room, and live entertainment.

### Venture Inn

255 S. Camac Street (between 12th and 13th Streets and Locust and Spruce Streets). 545-8731  
12:00 pm-2:00 am, daily.

Popular bar and restaurant; English pub setting. Sunday brunch 12:00 pm-4:00 pm. For the more "mature" crowd, locals sometimes unkindly refer to it as the "denture inn". MCC

#### **Westbury Bar**

13th and Spruce Streets. 546-5170  
10:00 am-2:00 am, daily.

Sports bar, restaurant. Popular neighborhood spot. MCC accepted for dinner.

## **MUSEUMS, GALLERIES, AND LIBRARIES**

[Museums, galleries, and libraries located in Center City are listed below. A more complete listing is available at the registration and information desk.]

### **MUSEUMS AND GALLERIES**

[check at the conference registration desk for information about free admission]

**Art in City Hall, Philadelphia City Hall**  
Broad and Market Streets, NE entrance,  
2nd and 4th floors. 686-2803. 7:00 am-6:00 pm, Monday-Friday.

**Cigna Museum and Art Collection**  
1601 Chestnut Street, Two Liberty Place.  
761-4907. By appointment.

**Curtis Center Museum of  
Norman Rockwell Art**  
601 Walnut Street. 922-4345  
10:00 am-4:00 pm, Monday-Saturday; 11:00 am-4:00 pm, Sunday.

**David David Gallery**  
260 S. 18th Street. 735-2922. 9:30 am-5:00 pm, Monday-Friday; by appointment, Saturday.

**Fabric Workshop and Museum**  
1315 Cherry Street, 5th Floor. 568-1111. 9:00 am-6:00 pm, Monday-Friday; 12:00 pm-4:00 pm, Saturday; and by appointment.

**Fleisher/Oilman Gallery**  
211 S. 17th Street. 545-7562. 10:30 am-5:30 pm, Monday-Friday; 11:00 am-5:00 pm, Saturday.

**Goldie Paley and Levy Galleries, Moore College of Art and Design**  
20th Street and the Benjamin Franklin Parkway. 568-4515. See listing under Local Events and Activities.

**Gross McCleaf**  
127 S. 16th Street. 665-8138.  
10:00 am-5:00 pm, Monday-Saturday.

**Institute of Contemporary Art**  
118 S. 36th Street at Samsom. 898-9108. See listing under Local Events and Activities.

**Locks Gallery**  
600 Washington Square South. 629-1000.  
10:00 am-6:00 pm, Tuesday-Saturday.

**Mangel**  
1714 Rittenhouse Square. 545-4343.  
11:00 am-6:00 pm, Tuesday-Friday;  
1:00 am-5:00 pm, Saturday.

**More Gallery**  
1630 Walnut Street. 735-1827.  
10:00 am-5:30 pm, Tuesday-Saturday.

**Museum of American Art of the  
Pennsylvania Academy of the Fine Arts**  
118 N. Broad Street. 972-7600. See listing under Local Events and Activities.

**Newman Galleries**  
1625 Walnut Street. 563-1779.  
9:00 am-5:30 pm, Monday-Friday;  
10:00 am-4:30 pm, Saturday.

**Claire Oliver Fine Art**  
The McIlhenny Manion, 1912 Rittenhouse Square. 546-9936. 10:00 am-6:00 pm, Tuesday-Thursday; 10:00 am-8:00 pm, Friday and Saturday; 12:00 pm-5:00 pm, Sunday.

**Philadelphia Art Alliance**  
251 S. 18th Street. 545-4302.  
11:00-5:00 Tuesday-Sunday.

**Philadelphia Museum of Art**  
26th Street and the Benjamin Franklin Parkway. 763-8100. See listing under Local Events and Activities.

**The Print Center and Gallery Store**  
1614 Latimer Street. 735-6090.  
11:00 am-5:30 pm, Tuesday-Saturday.

**Rodin Museum**  
22nd Street and the Benjamin Franklin Parkway. 763-8100. See listing under Local Events and Activities.

**Rosenwald-Wolf Gallery,  
University of the Arts**  
333 S. Broad Street. 875-1116. See listing under Local Events and Activities.

**Schmidt/Dean Gallery/Walnut**  
1636 Walnut Street. 546-7212.  
10:30 am-6:00 pm, Tuesday-Saturday.

**Schmidt/Dean Gallery/Spruce**  
1721 Spruce Street. 546-9577.  
10:30 am-6:00 pm, Wednesday-Saturday.

**Sande Webster**  
2018 Locust Street. 732-8850.  
10:00 am-6:00 pm, Monday-Friday;  
11:00 am-4:00 pm, Saturday.

### **LIBRARIES AND ARCHIVES**

**Athenaeum of Philadelphia**  
219 S. 6th Street. 925-2688. 9:00 am-5:00 pm, Monday, Tuesday, Thursday, Friday;  
12:00 pm-8:00 pm, Wednesday.

**Free Library of Philadelphia**  
19th Street and the Benjamin Franklin Parkway. 686-5322. 9:00 am-9:00 pm, Monday, Wednesday; 9:00 am-6:00 pm, Thursday, Friday; 9:00 am-5:00 pm, Saturday; 1:00 pm-5:00 pm, Sunday.

**Historical Society of Pennsylvania**  
1300 Locust Street. 732-6200.  
Closed for renovations.

**Library Company of Philadelphia**  
1314 Locust Street. 546-3181. 9:00 am-4:45 pm, Monday-Friday.

**Masonic Library and  
Museum of Pennsylvania**  
1 North Broad Street. 988-1934.  
9:00 am-5:00 pm, Monday-Friday;  
9:00 am-12:00 pm, Saturday, museum only.

**National Archives, Mid-Atlantic Region**  
9th and Market Streets, Room 1350.  
597-3000. 8:00 am-5:00 pm, Monday-Friday.

Philadelphia City Archives  
401 N. Broad Street, Suite 942. 686-1580.  
8:30 am-5:00 pm, Monday-Friday.

Rosenbach Museum and Library  
2010 Delancey Place. 732-1600. 11:00 am-4:00  
pm, Tuesday-Sunday.

## TELEPHONE DIRECTORY

[All area codes are local (215)  
unless otherwise noted.]

### EMERGENCY INFORMATION

Emergency  
(police, fire, ambulance) 911

Telecommunications Relay Service  
for individuals with speech or hearing  
disabilities.

TTY/TDD only 1-800-654-5984  
Voice only 1-800-654-5988

Poison Control Center  
386-2100

### COUNSELING/HOTLINES

Alcoholics Anonymous  
574-6900

Lesbian & Gay Counseling Service  
732-8255

Narcotics Anonymous  
440-8400

National HIV/AIDS Hotline  
1-800-342-2437

Philadelphia AIDS Hotline  
985-2437

Tel-Med, Health Information Service  
829-5500  
24 hours, 7 days

Suicide Prevention Center  
686-4420

Women Organized Against Rape  
985-3333

### VISITOR INFORMATION

Philadelphia Convention and Visitors Bureau  
636-1666  
<http://www.libertynet.org/phila-visitor>

TIME  
846-1212

WEATHER  
936-1212

### SPORTS AND ENTERTAINMENT

[Performance listings and schedules are  
available at the registration and information  
desk, and in the City Paper also available at  
the registration desk.]

### TICKET OFFICES

Central City Ticket Office  
1312 Sansom Street. 735-1350

Glassman's  
231 S. 13th Street  
(at Locust Street). 735-9673

Upstages Box Office  
16th and Chestnut Streets. 569-9700.  
10:00 am-5:00 pm, Monday-Saturday;  
12:00 pm-5:00 pm, Sunday. Discount,  
half- and full-price tickets.

### SPORTS

Philadelphia 76ers Basketball 339-7600

Philadelphia Flyers Ice Hockey 465-4500

Philadelphia Phantoms Ice Hockey 465-4522

Philadelphia Wings Lacrosse 389-9464

### TRANSPORTATION

Amtrak  
(general information and reservations)  
1-800-872-7245

PATCO  
922-4600  
Hi-Speedline to South Jersey

Greyhound Bus Lines  
931-4097

Peter Pan Trailways  
413-3420

New Jersey Transit  
1-800-582-3752  
Bus and rail service to New Jersey (including  
Atlantic City, New York). Rates vary according  
to distance.

SEPTA (local bus and rail service)  
592-1800  
\$1.60 per trip, no round trip; \$2.00 with  
transfer. Tokens: 5 for \$5.75, 10 for \$11.50. Day  
passes available at Visitors Center, 16th Street  
and JFK Blvd. Please refer to the SEPTA  
brochure in your registration packet for more  
information.  
Bus route 76 travels from Society Hill/South  
Street along Market Street and the Ben Franklin  
Parkway to the Philadelphia Museum of Art  
and the Philadelphia Zoo in Fairmount Park.

Bus routes 21 and 42 connect Center City  
with University City (West Philadelphia).

Bus route C and the Broad Street subway line  
connect Center City with North Broad Street  
and South Broad Street to the sports  
complex in South Philadelphia.

### PHLASH-Downtown Loop

Stops at Broad and Walnut Streets, one block  
north of the hotel and makes continuous  
loops, 10 am-6 pm, from Logan Circle  
through Center City to the Delaware River  
Waterfront and South Street. Ride all day for  
\$3.00 or one way for \$1.50.

### Airlines

For specific flight information, contact  
airline directly or call 1-800-PHL-GATE for  
up-to-the-minute information on arrivals,  
departures, and gate assignments.

Philadelphia International Airport 937-6680

## MAIL

US Postal Service  
Broad and Sansom Streets. 567-5186.  
7:30 am-5:30 pm, Monday-Friday.

2970 Market Street. 895-8978. Open 24  
hours, Monday through Saturday.

Zip Code Information 895-8000.

Federal Express  
1-800-463-3339  
Office: 121 S. Broad Street

Drop-off locations: 1624 Locust Street and  
1700 Walnut Street

UPS/United Parcel Service  
1-800-742-5877 (1-800-PICK-UPS)

## BANKS AND ATMS

**CoreStates Bank**  
973-3512  
Broad and Chestnut Streets.  
Foreign currency exchange. ATM

**First Union**  
985-7068  
Broad and Walnut Streets.  
Foreign currency exchange. ATM

**Mellon / PSFS**  
553-3000  
Broad and Chestnut Streets; Broad and Locust  
Streets; 12th and Market Streets. Foreign  
currency exchange. ATM

**Outdoor ATM Machines**  
1300 block of Walnut Street near Broad  
Street (outside of Royal Bank)

1300 block of Chestnut Street near Broad  
Street (outside of CoreStates Bank)

## FOREIGN CURRENCY EXCHANGE

(See also listings under banks and ATMs.)

**Airport Foreign Currency Exchange**  
Terminal A, between Terminal B & C, Terminal  
D and Customs, 492-8880

**Thomas Cook Currency Services, Inc.**  
1800 JFK Boulevard. 1-800-287-7362

## MONEY TRANSFER SERVICES

**Western Union**  
For the Nearest Location 1-800-325-6000  
Credit Card Money Transfers 1-800-225-5227

## COPYING SERVICE

**Kinko's**  
20th and Market Streets,  
215-561-5170. Open 24 hours.

**The Printer's Places**  
(located 2 blocks from the Doubletree Hotel)  
1310 Walnut Street. 215-546-6562. 8:30 am-  
5:30 pm, Monday-Friday; 9:30 am-4:00 pm,  
Saturday.

## FILM/PHOTO FINISHING

**Mid-City Camera**  
1316 Walnut Street. 735-2522.  
8:30 am-7:00 pm, Monday-Friday;  
10:00 am-5:00 pm, Saturday.

**Ritz Camera Centers**  
1300 Walnut Street. 545-7761. 8:00 am-6:00  
pm, Monday-Friday; 10:00 am-4:00 pm,  
Saturday. Same day service.

## SHOE REPAIR

**Avila's Shoe Repair**  
275 S. 15th Street. 732-8606  
8:00 am-6:30 pm, Monday-Friday;  
9:00 am-5:00 pm, Saturday.

## CLEANERS AND LAUNDRY

**Academy Cleaners**  
1417 Locust Street. 732-2627  
7:30 am - 6:30 pm, Monday-Thursday;  
7:30 am-6:00 pm, Friday; 9:00 am-5:00 pm  
Saturday; closed, Sunday.

**U-Do-It Laundry (and cleaners)**  
1513 Spruce Street. 735-1255  
7:00 am-11:00 pm, daily.

## DRUG STORES

**Rite Aid Pharmacy**  
215 S. Broad Street. 735-1117, 735-3593. 7:00  
am-7:00 pm, Monday-Friday; 6:00 am-7:00  
pm, Saturday; 2:00 pm-7:00 pm, Sunday.

**CVS**  
1424 Chestnut Street. 963-9316. 8:00-7:00  
pm, Monday-Friday; 9:00 am-6:00 pm,  
Saturday; 12:00 am-5:00 pm, Sunday.  
1826-30 Chestnut Street. 972-1401.  
Open 24 hours.

**Eckerd**  
1426 Walnut Street. 545-8050.  
8:00 am-7:00 pm, Monday-Friday;  
9:00 am-6:00 pm, Saturday.

## LIQUOR STORES

(Wine & liquor only—beer available at select  
small markets, delicatessens, and bars.)

**Pennsylvania State Stores,  
Wine & Spirits Shops**  
1318 Walnut Street. 560-4295. 8:00 am-7:00  
pm, Monday-Friday; 9:00 am-6:00 pm,

Saturday; 10:00 am-2:00 pm, Sunday.  
819 Chestnut Street. 560-6190.  
9:00 am-9:00 pm, Monday-Saturday.  
1913 Chestnut Street. 560-4215.  
9:00 am-9:30 pm, Monday-Saturday.  
2109 Walnut Street. 563-8994.  
11:00 am-6:00 pm, Monday-Saturday.

## BOOKSTORES

(A more complete listing of bookstores is  
available at the registration and information desk)

**AIA Bookstore**  
17th and Sansom Streets. 569-3188.  
10:00 am-6:00 pm, Monday, Tuesday,  
Thursday-Saturday; 10:00 am-8:00 pm,  
Wednesday; 12:00-5:00 pm, Sunday.

**Barnes and Noble**  
1805 Walnut Street. 665-0716.  
8:00 am-11:00 pm, Monday-Friday;  
9:00 am-11:00 pm, Saturday, Sunday.

**Borders**  
1727 Walnut Street. 568-7400  
9:00 am-10:00 pm, Monday-Saturday;  
10:00 am-7:00 pm, Sunday.

**Rizzoli Bookstore**  
200 S. Broad Street, Park Hyatt Belevue  
Building. 546-9200. 10:00 am-7:00 pm,  
Monday-Tuesday, Thursday-Friday; 10:00 am-  
8:00 pm, Wednesday; 10:00 am-6:00 pm,  
Saturday; 11:00 am-5:00 pm, Sunday.

**Robins Bookstore**  
108 S. 13th Street. 735-9600  
9:00 am- 6:00 pm, Monday-Friday; 10:00  
am-6:00 pm, Saturday.

John Warren Art Books  
116 S. 20th Street. 413-0203  
10:00 am-5:30 pm, Monday-Friday; 10:00  
am-4:00 pm, Saturday.

## SHOPPING

### DEPARTMENT STORES

JC Penney Co., Inc.  
1035 Market Street. 238-9100. 10:00 am-7:00  
pm, Monday, Tuesday, Thursday, Saturday;  
10:00 am-8:00 pm, Wednesday, Friday;  
12:00 noon-5:00 pm, Sunday.

Lord and Taylor  
13th and Market Streets. 241-9000.  
10:00 am-7:00 pm, Monday, Tuesday,  
Thursday-Saturday; 10:00 am-8:00 pm,  
Wednesday; 12:00 pm-5:00 pm, Sunday.

Strawbridge's  
801 Market Street. 629-6000.  
10:00 am-6:00 pm, Monday, Tuesday,  
Thursday-Saturday; 10:00 am-9:00 pm,  
Wednesday; 11:00 am-6:00 pm, Sunday.

### SHOPPING CENTERS

The Shops at Liberty Place  
16th and Chestnut Streets. 851-0955. 9:30 am-  
7:00 pm, Monday-Saturday; 9:30 am-8:00  
pm, Wednesday; 12:00 pm-6:00 pm, Sunday.  
Specialty merchandise in 60 unique shops.

The Gallery at Market East  
9th and Market Streets. 10:00 am-7:00 pm,  
Monday-Saturday; 10:00 am-8:00 pm,  
Wednesday; 2:00 pm-6:00 pm, Sunday. 170  
shops, 40 eateries plus 50 eclectic pushcarts.  
Anchored by Strawbridge's and J.C. Penney.

## SHOPPING AREAS

Rittenhouse Row  
Broad Street to 20th Street and Market to  
Spruce Streets. Galleries, restaurants, haute  
couture boutiques, and other fine stores.

Antique Row  
Pine Street between 9th and 17th Streets.  
Period furnishings, antiques, collectibles, estate  
jewelry, vintage clothing and artifacts from  
around the world.

Jewelers' Row  
Sansom Street between 7th and 9th Streets.  
More than 300 jewelers and designers.  
America's oldest and one of the largest  
diamond districts established in 1851.

Italian Market  
9th Street between Wharton and Christian  
Streets. World's largest outdoor market  
dating back 125 years. Many shops run  
by members of the original families. Fresh  
pastas, cheeses, spices, meats, dry goods,  
fruits and vegetables.

South Street  
South Street between Front and 10th Streets.  
Originally an artists' center. Now a fun place  
with 150 shops, boutiques, galleries and  
eateries.

Reading Terminal Market  
12th and Arch Streets. 8:00 am-6:00 pm,  
Monday-Saturday. More than 80 merchants  
selling fresh farm produce and prepared  
foods. Pennsylvania Dutch stalls are open  
Thursdays-Saturdays only.

## RELIGIOUS SERVICES

First Baptist Church (Baptist)  
17th & Sansom Streets. 563-3853.  
11:00 am, Sunday.

St. John the Evangelist (Catholic)  
13th Street, between Chestnut & Market  
Streets. 563-4145. 5:15 pm, Saturday Vigil;  
7:00 am, 8:30 am, 10:00 am, 11:30 am,  
1:00 pm, Sunday.

St. Lukes in the Epiphany (Episcopal)  
330 S. 13th (between Spruce & Pine Streets).  
732-1918. 12:10 pm Eucharist, 6:15 pm Evening  
Prayer, Wednesday; 9:00 am small service,  
11:00 am main service, Sunday; 6:15 pm  
Prayer around the Cross service, first Friday  
of month (call to confirm).

Beth Zion-Beth Israel Synagogue (Jewish)  
18th & Spruce Streets. 735-5148. 7:45 am,  
5:30 pm, Daily; 9:00 am & Sundown,  
Saturday; 9:00 am and 5:30 pm, Sunday &  
Holidays.

Holy Communion of Lutheran Church  
(Lutheran)  
2110 Chestnut Street. 567-3668.  
10:30 am, Sunday.

Arch St. United Methodist Church  
(Methodist)  
N. Broad & Arch Streets. 568-6250. 8:30 am,  
nontraditional, 11:00 am, traditional; Sunday.

The Church of Jesus Christ of  
Latter Day Saints (Mormon)  
3913 Chestnut Street. 387-5958.  
1:20 pm, Sunday.

Old Pine Street Church (Presbyterian)  
412 Pine Street. 925-8051. 10:30 am, Sunday.

Visit

# image DIRECTORY

[www.imagedir.com](http://www.imagedir.com)

The **Image Directory** is the first online resource of information on art images from museums and collections around the world. An accurate and authoritative database on an extraordinary range of work, the **Image Directory** is an indispensable reference for anyone who holds or uses art images.

The ever-expanding **Image Directory** covers the full spectrum of the arts, including paintings, sculpture, architecture, textiles, photography, ethnographic objects, engravings, decorative pieces, tools, musical scores, toys, religious artifacts, lithographs, posters, furniture, portfolios, jewelry, maps, and more.



**Academic Press**

525 B Street, Suite 1900  
San Diego, California 92101  
For more information, contact:  
[jelliot@acad.com](mailto:jelliot@acad.com)

JE/IR/GEM—25038 1/98

#### YOU GET:

- ◆ Immediate access to data on each artwork, including artist, title, date, dimensions, and materials
- ◆ Rights and reproduction information
- ◆ A link to the image provider's Web site
- ◆ Two valuable tools that make searching easy—the Getty Information Institute's Union List of Artist Names<sup>®</sup> and its Art and Architecture Thesaurus<sup>™</sup>

Among the institutions to become providers for the database are: The Museum of Modern Art, The Asia Society, The Brooklyn Museum, the Smithsonian Institution, the Newberry Library, the Rijksmuseum, the Vancouver Art Gallery, the UCLA/Hammer Museum, the Natural History Museum, London, the San Francisco Museum of Modern Art, the American Craft Museum, the Berkeley Art Museum, the Jewish Museum, the George Eastman House, the Chicago Architecture Foundation, the Toronto Historical Board, the Shelburne Museum, the Sterling and Francine Clark Art Institute, and the Portland Art Museum, and many more.

Image providers retain complete control of their images and information. The **Directory** now holds approximately 100,000 records and its collection is growing daily.

This one-of-a-kind reference enables image owners to bring information about their holdings to the attention of a vast audience, and organizes all data into a single, accessible source. Access to the **Directory** will be sold through site licenses, by time, and by search, beginning March 16, 1998.

# AMERICAN ART AND ARTISTS

## RARE AND OUT-OF-PRINT PUBLICATIONS RELATED TO AMERICAN ART AND ARTISTS

\*Monographs \*Exhibition Catalogues \*Auction Catalogues \*  
\*Gallery Catalogues \*Annual Exhibitions \*Periodicals \*Ephemera \*

**Kevin Mullen, Bookseller** maintains a select stock of 6000+ titles relating to **American Art and Artists**, each indexed and cross-referenced in a meticulously maintained and ever-growing database. Visit me on the **WEB** or **EMAIL** me with specific needs or concerns. **Want lists encouraged. Collection Development Services available.**

**WORLD-WIDE search for ALL art and non-art titles.**

**I am ALWAYS interested in purchasing libraries or individual volumes and will travel to make you a generous offer.**

I presently have a 5000+ item art research library available for bulk purchase. In addition to many significant and uncommon titles on American Art and artists, there is also a significant representation of reference works on European Artists, especially French painters. The collection occupies appx. 200 feet of shelf space. Delivery is available. Please inquire for additional details.

EMAIL: [kmullenb@mullenbooks.com](mailto:kmullenb@mullenbooks.com) **Kevin Mullen, Bookseller**  
<http://www.mullenbooks.com> P.O. Box 472  
717-426-4800 Marietta, Pennsylvania  
717-426-4002 (FAX) 17547

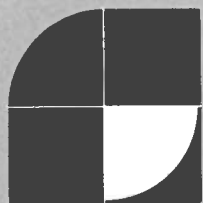

*ars libri, ltd.*

560 Harrison Avenue  
Boston, MA 02118  
tel: 617.357.5212  
fax: 617.338.5763  
e-mail: arslibri@xensei.com

**Forthcoming:**

American Art of the 20th Century.  
Books from the libraries of Victor and  
Sally Ganz, Paul Cummings, and others

Monographs on Renaissance and  
Baroque Artists

**Currently Available:**

Catalogue 109  
Rare Books

Catalogue 108  
Arts of Asia

Catalogue 107  
Art Architecture, Archaeology:  
Periodicals and Sets

# design and applied arts index

"A must for any serious design library"

AIGA Journal of Graphic Design 15/2 1997

**designandappliedartsindex on CD-ROM**

Start Menu Run the Tutorial Search for Articles View as Card Print Save to disk Exit daai

Click in box:  to choose those articles you wish to Print or Save to disk

*This Journal is Held in the Library*

[Article]  
Author: Beverly Russell.  
Title: Starck raving genius of design.  
Reference: Graphis vol.51 no.301 (Jan/Feb.1996) pp.30-41 illus. por.  
Language(s): English, German and French

For further information about periodical click:

A profile of French designer Philippe Starck, with an analysis of the "secrets" of his success. The article includes a discussion of his latest project - the Delano Hotel in Miami, Florida, and illustrations of his recent work - the roof structure for the Nani Nani building in Tokyo, glassware for Daum, the 'Dr Oola' adjustable footrest for Vitra, the 'Partoo' TV and 'Alo' telephone for Thomson, the 'Ego' TV for Telefunken, the 'Rosy Angelis' floor lamp and 'Light Lite' lamp for Flos, the 'Hot Bertaa' tea kettle for Alessi, a toothbrush and container for Fluocaril, and beds for Cassina.

Starck, Philippe [1949-. France. Furniture\Interior\Industrial Designer\Architect]  
Hotels: Architecture and Interior Design: USA: Miami, Florida

To return to previous search screen click: \* Field Search \*

Click on arrows to view references: 8 of: 10

## Features of daai on CD-ROM

- Over 100,000 annotated references from more than 400 design and craft journals published between 1973-1997, making it the largest database of its kind in the world
- Includes data on over 40,000 designers, craftspeople, studios, workshops, firms, etc.
- 10,000-12,000 new references are added annually
- Contains four supplementary databases: international directories of design/craft schools, organisations, journals and archives
- Over 1,000 Internet links

## DESIGN DOCUMENTATION

Woodlands • Stone Cross • Mayfield • East Sussex • TN20 6EJ • England

Tel: +44 1435 873 763 • Fax: +44 1435 873 759

WWW: <http://surf.to/daai> • E-mail: [design\\_documentation@compuserve.com](mailto:design_documentation@compuserve.com)

See us at Stand 29 for a **FREE** copy of the CD-ROM

# THE ART BOOK FAIR

METROPOLITAN PAVILION

110 WEST 19TH STREET AT 6TH AVENUE

NEW YORK ♦ MAY 25-26 1998

Antiques ♦ Architecture ♦ Art ♦ Decorative Arts  
Design ♦ Fashion ♦ Gardens ♦ Interiors  
Photography ♦ Reference

The International Art Publishers Association is organizing the first Art Book Fair to be held in downtown Manhattan in May 1998. Leading publishers from around the world will exhibit, including Abrams, Antique Collectors' Club, Rizzoli International, Getty Museum Publications, te Neues, Prestel, Stewart Tabori and Chang, the British Library, Lund Humphries, Riverside Book Company, Idea Books, George Braziller, and Philip Wilson Publishers.

The Art Book Fair will offer a focused event for books on the Arts. These leading specialist publishers will be displaying both new and backlist titles - as well as titles to come - to a diverse group of art and publishing professionals.

For further information please contact the  
Antique Collectors' Club or access our web site at  
<http://www.antiquecc.com/artbookfair>.

Dan Farrell  
Antique Collectors' Club  
91 Market Street Industrial Park  
Wappingers Falls, NY 12590  
Tel: 914-297-0003  
Fax: 914-297-0068  
Email: [info@antiquecc.com](mailto:info@antiquecc.com)

Brian Cotton  
Antique Collectors' Club  
5 Church Street  
Woodbridge, Suffolk  
England IP12 1DS  
Tel: 01394 385501  
Fax: 01394 388994



Ansel Adams, *Taos Pueblo, San Francisco, 1930*,  
sold on December 11, 1997 for \$32,200, an auction record.

## SWANN GALLERIES

Auctioneers & Appraisers Specializing in

Rare Books · Autographs & Manuscripts · Maps & Atlases  
Photographs · Prints & Drawings · Posters

April 6: 19TH & 20TH CENTURY PHOTOGRAPHS  
*Illustrated Catalogue \$25 US/\$35 Overseas*

April 16: RARE BOOKS  
*Illustrated Catalogue \$25*

April 23: AMERICAN HISTORICAL PRINTS  
*Illustrated Catalogue \$25*

May 14: WORKS OF ART ON PAPER  
*Illustrated Catalogue \$25/\$35 Overseas*

June 11: PHOTOGRAPHIC LITERATURE  
& PHOTOGRAPHS  
*Illustrated Catalogue \$15*

For further information on buying and selling at Swann, please contact  
Christine von der Linn, Art & Architecture Books · Tobias Abeloff, Rare Books  
Daile Kaplan, Photographs and Photographic Literature  
Todd Weyman, Prints & Drawings · Nicholas Lowry, Posters  
tel (212) 254-4710 • fax (212) 979-1017 • e-mail: [Swannsales@aol.com](mailto:Swannsales@aol.com)

**IAO** Member International Association of Auctioneers

## SWANN GALLERIES

104 East 25th Street, New York, NY 10010 • (212) 254-4710



F·A·BERNETT·INC



Rare & Scholarly Books  
on the

FINE & DECORATIVE ARTS  
ARCHITECTURE  
ARCHAEOLOGY



144 Lincoln Street  
Boston, M.A. 02111

Tel 617-350-7778

Fax 617-350-7722

CATALOGUES ON REQUEST

## BOOKS OF APPLIED VISUAL DESIGN & ART



OVER

**400**

Titles Available



- Art
- Architecture
- Graphic Design
- Illustration
- Japanese Books
- Fashion Design
- Photography
- Textile Design
- Japanimation
- Fashion

**1-800-562-1410**

Call for FREE COLOR CATALOG

**NIPPAN**

1123 Dominguez St. #K Carson, CA 90746  
Tel : (310) 604-9701 Fax : (310) 604-1134

**Casalini  
libri**

*General book dealers  
for Italian publications  
to libraries throughout  
the world*

*Our services include:*

- Highly selective approval plans to meet every library's special requirements
- Standing orders for series and multi-volume monographs
- Subscriptions to periodicals with direct, centralized mailing
- Library binding
- Management reports and statistics
- Bibliographic information for new publications:

*in printed form*

bibliographic cards (free of charge) sent weekly or monthly;  
catalogues produced at regular intervals in different subject areas;

*in electronic form*

USMARC and UNIMARC records on floppy disk, machine readable tape or via FTP

- Specialized bibliographies compiled on specific subjects
- Web site giving full details of our services, special offers and access to our database which contains over 130,000 entries and is updated each week
- EDI services (offers, orders, reports, claims, invoices, etc.)

Via Benedetto da Maiano, 3  
50014 Fiesole (FI) - Italy

Tel. ++39-55-5018.1  
Fax ++39-55-5018.201

<http://www.casalini.com>  
[gen@casalini.com](mailto:gen@casalini.com)



THE ULTIMATE AUTHORITY

on all the visual arts

# The Dictionary of Art

Volumes: 34 • Articles: 41,000 • Contributors: 6,700 from 120 countries  
Illustrations: 15,000 throughout the text  
Bibliographies: 300,000 citations • Index: 720,000 entries • Pages: 32,600

## Winner

1997 Dartmouth Medal (ALA/RUSA)

1996 Wittenborn Award for Excellence in Art Publishing (ARLIS)

1997 Wilson Award for Excellence in Indexing (ASI)

1997 Outstanding Academic Book (CHOICE)

“No more  
complete  
guide to the  
world's art  
exists....

There's no art publication  
in existence that  
gives the reader such  
richness of detail  
and coherence of organization.”

Robert Hughes  
TIME  
November 4, 1996

“Grove's new 34-volume  
*Dictionary of Art* reflects big  
changes in the politics,  
the history and  
the biases of our age.”

“The most ambitious  
art-publishing venture of  
the late 20th century,  
it is an

## awesome

single source on world art...  
It is an invaluable acquisition  
for any serious art lover,  
indispensable for libraries  
or schools.”

Michael Kimmelman  
THE NEW YORK TIMES BOOK REVIEW  
August 24, 1997



Grove's Dictionaries Inc.

For more information call 1.800.221.2123 (in New York call 212.689.9200)

fax: 212.689.9106; e-mail: [dictart@pipeline.com](mailto:dictart@pipeline.com); or clip the form below and mail to:  
The Dictionary of Art, 345 Park Avenue South, 10th Floor, New York, NY 10010

Yes, I'd like more information on the 34-volume *Dictionary of Art*.

Name \_\_\_\_\_

Institution \_\_\_\_\_

Address \_\_\_\_\_

City \_\_\_\_\_ State \_\_\_\_\_ Zip \_\_\_\_\_

Phone \_\_\_\_\_ Fax \_\_\_\_\_ E-mail \_\_\_\_\_

ARLIS'98

# NEW FROM GARLAND

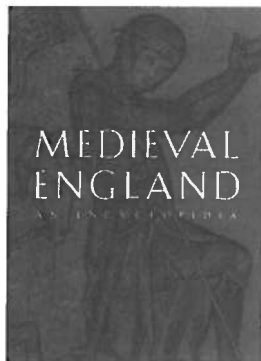

## MEDIEVAL ENGLAND

### An Encyclopedia

Edited by Paul E. Szarmach, M. Teresa Tavormina, & Joel T. Rosenthal

This valuable reference work devotes substantial coverage to medieval art and architecture. It explains how English arts, history, literature, and culture developed during the Middle Ages. More than 300 expert contributors provide a stimulating diversity of interpretations and opinions. Includes over 150 illustrations.

936 pages, Index, Illustrated, 05786-4, \$135, 5/98  
Volume 3, Garland Encyclopedias of the Middle Ages

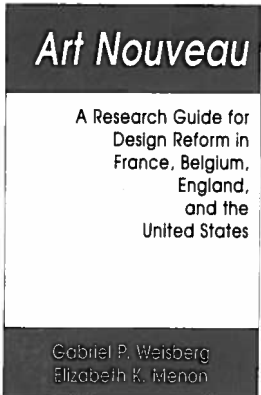

## ART NOUVEAU

### A Research Guide for Design Reform in France, Belgium, England, and the United States

Gabriel P. Weisberg & Elizabeth K. Menon

Through the first thoroughly annotated examination of books, articles, exhibition catalogs, and unpublished dissertations, the Art Nouveau period (1890-1905) is revealed as an era dedicated to design reform in all areas of the visual arts. Architecture, interior decoration, furniture, jewelry, bookbinding, posters, ceramics, glass, wallpaper, and textiles are the subjects of critical documentation.

408 pages, Index, Illustrated, \$75, 06628-6, 2/98

### Also of Interest

## HENRI MATISSE

### A Guide to Research

Catherine C. Bock-Weiss

"Highly recommended."

—Choice

"An excellent reference work....valuable for scholars and graduate art history students and faculty."

—American Reference Books Annual

792 pages, Index, \$95, 30086-7, 9/96  
Volume 1, Artist Resource Manual

## HANS HOLBEIN THE YOUNGER

### A Guide to Research

Erika Michael

"The finest in comprehensive information and scholarly research.... Highly recommended for the scholarly researcher."

—Art Times

776 pages, Index, 30389-0, \$95, 7/97  
Volume 2, Artist Resource Manuals

Call/write/fax for a free Art & Architecture catalog.



## GARLAND PUBLISHING

1000A Sherman Avenue, Hamden CT 06514-1337

Toll-free (800) 627-6273

Tel (203) 281-4487 • Fax (203) 230-1186

e-mail: [info@garland.com](mailto:info@garland.com) • <http://www.garlandpub.com>

Discover Our  
New Titles  
on Display

at Booth #1

### Craftsman House

### CONTEMPORARY PRINTMAKING IN THE NORTHWEST

Lois Allan  
Cloth  
ISBN 90-5703-13-10  
US\$55 / £40 / ECU52



### CONTEMPORARY GRAPHIC ART IN POLAND

Richard Noyce  
Cloth ISBN 90-5703-48-16  
US\$55 / £35 / ECU42

### A SPIRIT OF PROGRESS Art Deco Architecture in Australia

Patrick VanDaele and Roy Lumby  
Cloth ISBN 90-5703-67-11  
US\$75 / £48 / ECU60

### G+B Arts International

### SPEAK ART! The Best of BOMB Magazine's Interviews with Artists

Edited by Betsy Sussler

Cloth ISBN 90-5701-261-8  
US\$49.95 / £33 / ECU42  
Paperback ISBN 90-5701-341-X  
US\$24.95 / £16 / ECU21



NEW from the Critical Voices series ..... a series of books forming a library of primary texts and critical responses that address the cultural issues of our times.

### ENGLAND AND ITS AESTHETES: BIOGRAPHY AND TASTE

Essays by John Ruskin, Walter Pater, and Adrian Stokes  
Commentary by David Carrier

Cloth ISBN 90-5701-211-1 • US\$35 / £21 / ECU27  
Paperback ISBN 90-5701-291-X • US\$18.95 / £12 / ECU15

### MEDIA RESEARCH: TECHNOLOGY, ART, COMMUNICATION

Essays by Marshall McLuhan

Edited by Michel A. Moos

Cloth ISBN 90-5701-091-7 • US\$35 / £21 / ECU27  
Paperback ISBN 90-5701-081-X • US\$18.95 / £12 / ECU15

NEW from the Documenting the Image Series .....

### LANDMARKS OF RUSSIAN ARCHITECTURE: A PHOTOGRAPHIC SURVEY

William Craft Brumfield

Cloth ISBN 90-5699-356-7 • US\$75 / £49 / ECU63  
Paperback ISBN 90-5699-537-5 • US\$35 / £23 / ECU29

### Harvey Miller Publishers

### THE PAPER MUSEUM OF CASSIANO DAL POZZO Citrus Fruit

David Freedberg and Enrico Baldini  
Cloth ISBN 1872-501-885  
US\$225 / £150 / ECU180

### THE WORLD UPSIDE DOWN English Misericords

Christa Grossinger  
Cloth ISBN 1872-501-982  
US\$60 / £38 / ECU48

### To order:

International Publishers Distributor  
P.O. Box 32160, Newark, NJ 07102  
1 800 545-8398  
fax 215-750-6343  
Visit our Home Page  
<http://www.gbhap.com>



## AFRICAN ETHNONYMS

### INDEX TO ART PRODUCING PEOPLES OF AFRICA

*Daniel Biebuyck, Susan Kelliher, and  
Linda McRae*

"Outstanding Academic Book of 1997."  
— CHOICE Magazine

African Ethnonyms is a comprehensive index of more than 2,500 names of ethnic groups taken from numerous sources, including linguistic and ethnographic surveys of Africa, as well as from more than one hundred major books and catalogs of African art. Its emphasis is on the art of sub-Saharan Africa, with the term "art" interpreted broadly to include ornamental design, architecture, textiles, and body adornment, in addition to the more traditional arts of masks and sculpture.

6 x 9 • 0-7838-1532-8 • \$100.00

## TWENTIETH-CENTURY ARTISTS ON ART

### AN INDEX TO WRITINGS, STATEMENTS, AND INTERVIEWS BY ARTISTS, DESIGNERS, AND ARCHITECTS

*Jack S. Robertson*

SECOND EDITION, REVISED AND ENLARGED

"... Recommended to anyone undertaking serious study of 20th-century artists, this book belongs in all collections serving studio art and art history programs."

— M. Nilsen, *University of Pennsylvania*

This Revised and Enlarged edition indexes more than 9,300 monographs, exhibition catalogs, and periodicals. 27,500 citations are included for writings in all formats: essays, manifestoes, poems, short stories, transcriptions of speeches, and scripts for performances, etc. The contents of these publications are not cataloged or indexed anywhere else.

6 x 9 • 0-8161-9059-3 • \$100.00

**To place an order call toll-free: 1-800-257-5157**

## CRISIS AND THE ARTS

### THE HISTORY OF DADA

*Edited Stephen C. Foster, Director of the  
Dada Archive and Research Center,  
University of Iowa*

8 volumes published between 1996 and 2000

Approaching the millennium, G.K. Hall & Co. is proud to announce the publication of *Crisis and the Arts*, the largest and most comprehensive treatment of any 20th-century artistic movement...

#### Now Available!

Volume I — DADA: THE COORDINATES  
OF CULTURAL POLITICS

6 x 9 • 0-8161-7354-0 • \$95.00

Volume II — DADA ZURICH:  
A CLOWN'S GAME FROM NOTHING

6 x 9 • 0-8161-7328-1 • \$95.00

Volume III — DADA COLOGNE.  
HANOVER

6 x 9 • 0-8161-7326-5 • \$95.00

## Art on microfiche

Visit  
booth nr.  
10

*New from IDC Publishers*

### Gerrit Rietveld Archive

The Dutch architect/designer Gerrit Rietveld (1888-1964) is probably best known for his affiliation with *De Stijl* in the early 1920ies. He did however explore other directions after that period, concentrating on public housing and design for mass production. The Gerrit Rietveld Archive, containing drawings, photographs, letters and texts, gives a clear and impressive account of Rietveld's ideas and work. A CD-ROM makes quick searches possible through the entire archive.

- 1,900 drawings, 2,000 photographs, 1,800 letters and 330 texts on 280 microfiche
- Including detailed inventory (in printed form and on CD-ROM)

### The Sir Lawrence Alma-Tadema Collection

The painter Lawrence Alma-Tadema (1836-1912) was born in Holland but moved to England in 1870 where he enjoyed great fame and fortune.

Alma-Tadema used many elements of classical art in his historical paintings. He strove to historical authenticity and for that purpose collected an extensive archive of archeological photographs. In addition to these photographs the archive contains prints, drawings, and tracings and the master's correspondence.

- c. 5,300 photographs, 1,050 sheets with drawings and c. 300 letters on 213 microfiche
- Including printed guide

### The Villani Photo Archives

The Villani Photo Archives, covering the years 1920-1980, constitutes one of the most comprehensible, well articulated and compact collections of art photographs dealing with Italy and more particular with Bologna and Emilia-Romagna. The collection is made accessible by a digital inventory which includes a full description of each negative and allows specific searches.

- 8,970 glass negatives and 512 positive prints on 191 microfiche
- Including guide (in print and on diskette)

  
PUBLISHERS

<i>The Netherlands</i>	Phone +31 (0)71 514 27 00	<i>North America</i>	Phone 718 432 1400
IDC Publishers	Fax +31 (0)71 513 17 21	IDC Publishers Inc.	Toll free 800 757 7441
P.O. Box 11205	E-mail info@idc.nl	3265 Johnson Avenue	Fax 718 432 0020
2301 EE Leiden	Internet http://www.idc.nl	Riverdale, NY 10463	E-mail idc-us@mindspring.com

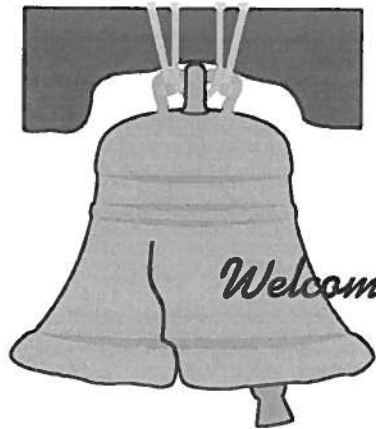

ARLIS/NA Members

**PALINET**

*Welcomes You to Philadelphia*

**Join us and see how much we can do for you!**

**PALINET Member Services:**

- OCLC & Information Services • Preservation & Conservation Services
- Publication Services • Automation Services • Educational Program •
- Computer & Network Services • Reference Database Services • Consulting Services
- Internet Access • CD-Access Services • Database Processing •
- Cooperative Purchasing • Media Conversion/Database Publishing

*Visit us on the Web: [www.palinet.org](http://www.palinet.org)*

**With Offices to Serve You:**

Philadelphia, PA: 800/233-3401  
 Pittsburgh, PA: 800/242-3790  
 Silver Spring, MD: 800/871-1662



**ART SALES INDEX LTD** has over 30 years of experience  
in recording auction catalogues **BENEFIT** from our expertise

*Please Visit our Stand for Special Offers*

**Art Sales Index CD-ROMs**

Essential reference source to 1.5 million auction sale results. You may search across 27 fields, save searches, print, export, use notepads and bookmarks to store your comments. Simple to use. Each CD comes with a comprehensive user guide.

1990/97 - 765,000 entries, 107,000 artists

ISBN: 0 903872 60 9

1980/89 - 763,000 entries, 93,000 artists

ISBN: 0 903872 61 7



**Price: \$595 each**

1997 subscription update for 1990-96 edition - \$195

**Demo Disk Available**

**ArtQuest**

On-line service since 1983 - 24 hours a day, 7 days a week. Now approaching 2 million entries, updated daily. Only a modem and PC/Mac required for rapid reference to the prices of 160,000 artists & sculptors. A typical search can be completed within two minutes. Download entries and view off-line. **Free trial upon request.**

**The Great Art Boom 1970-1997 Price: \$75**

A survey by Christopher Wood of the world's most important artists whose 190,000 international auction sales have generated £9 billion/\$15 billion. The introduction covers the principal selling groups with graphs and tables. This is followed by a commentary on each artist, highlighting their achievements. Illustrated, hard bound. ISBN: 0 903872 58 7

**1996/97 Art Sales Index Price: \$195**

This renowned publication helps you to source information quickly and easily on individual artists and paintings. Most up-to-date comprehensive listing of international art auction catalogues. Sales up to August 1997, listing a massive 118,000 works of fine art by 37,000 artists & sculptors at 2,100 international auctions. ISBN: 0 903872 59 5

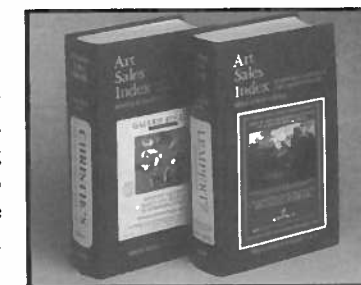

**Immediate despatch upon receipt of payment. All prices include postage and handling. CHEQUE, VISA, AMEX & ACCESS**

For orders & further information on other titles contact:  
**Art Sales Index Ltd.**, 1 Thames Street, Weybridge, Surrey KT13 8JG UK  
 Tel: 011 44 1932 856426 Fax: 011 44 1932 842482  
 email: [info@art-sales-index.com](mailto:info@art-sales-index.com) <http://www.art-sales-index.com>

Search more than 50 years of art journalism in a single stroke!

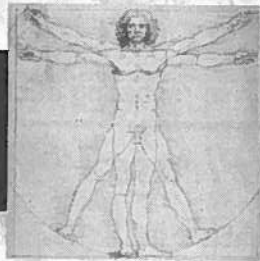

## New! Art Index Retrospective File

Seeking the most expansive research coverage of art and artists available? Add **Art Index Retrospective File** to your sources! As a stand-alone database, **Art Index Retrospective File** provides indexing of leading art publications from 1929 through 1984 — more than a half century of coverage! Combined with the **Wilson Art Index** or **Art Abstracts** database, **Art Index Retrospective File** allows searching of seven decades of art coverage in one stroke!

- ◆ **Speeds access to articles from some 400 international publications**
- ◆ **Eliminates searching through print volumes**
- ◆ **Searchable by keywords, subject headings, personal names, article title words, organizations, publication, and year**
- ◆ **Essential reference for academic libraries, museums, galleries, auction houses, and special collections!**

Visit our booth for more information! Or phone 800-367-6770 or (718-588-8400 outside U.S. and Canada) to reserve your **FREE 30-day trial!**



**H.W. Wilson** Information for tomorrow, today

New York • Dublin

950 University Avenue • Bronx, NY 10452-4224

800-367-6770 • 718-588-8400 • www.hwwilson.com

New from Ashgate... *The only comprehensive reference on enamelling!*

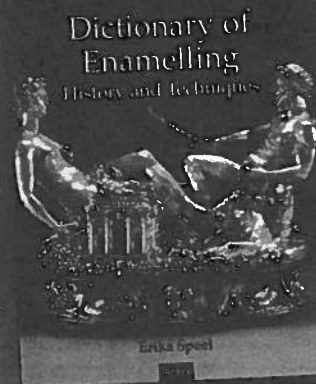

## Dictionary of Enamelling

History and Techniques  
Compiled by Erika Speel

Advance praise:

"This is the book that everybody who handles precious metalwork...will have to have for reference and for sheer pleasure." —*Geoffrey C. Munn, Managing Director, Wartski, UK*

"[Speel] has done the trade a great service bringing all this information together." —*Alan Mudd, FIGP, Alan Mudd Ltd., UK*

**Dictionary of Enamelling** is just one of the many fine books we publish in art and art history. For more information, stop by our booth or visit our Web site at [www.ashgate.com](http://www.ashgate.com).

ISBN: 1-85828-272-5  
January 1998 288 pages  
8.5" x 10.25"  
100 color, 100 b/w illustrations  
~~\$99.95~~  
**\$79.95 at conference discount**

**Ashgate**

Old Post Road • Brookfield, VT 05036-9704  
Toll-Free (US & Canada): (800) 535-9544 • Fax: (802) 276-3651  
E-mail: [info@ashgate.com](mailto:info@ashgate.com) • Web site: [www.ashgate.com](http://www.ashgate.com)

JOHN BENJAMINS ANTIQUARIAT

&

JOHN BENJAMINS PUBLISHING CO

welcome you to their book-exhibit  
during the 1998 Annual  
Conference of the Arlis,  
Philadelphia, March 5-11, 1998

ERASMUS

## Your Supplier for Art Books

Please send your orders and inquiries to:

ERASMUS BV  
P.O. Box 19140  
1000 GC AMSTERDAM  
The Netherlands  
Tel.: +31-20-627 69 52  
Fax: +31-20-620 67 99  
E-mail: [erasmus@erasmusbooks.nl](mailto:erasmus@erasmusbooks.nl)  
Internet: <http://www.erasmusbooks.nl>

*For books from France:*  
Librairie Erasmus  
28, rue Basfroi  
75011 Paris, France  
Tel.: +33-1-43 48 03 20  
Fax: +33-1-43 48 14 24  
E-mail: [erasmus@erasmus.fr](mailto:erasmus@erasmus.fr)

Erasmus

- Professional
- Traditional
- Academic



## Surveying the First Decade: Video Art and Alternative Media in the United States

**"At only \$67 per hour of  
programming, this is an  
unbeatable bargain!"**

—Debra Kruse, Librarian,  
Rhode Island School of Design

This comprehensive package on the history of experimental and independent video is an essential tool for teachers, libraries, and researchers. *Surveying the First Decade* includes:

- \* 17 hours of historic video on 9 VHS tapes;
- \* 68 seminal titles by over 50 artists, works from 1968 to 1980;
- \* *Rewind*, a 200+ page study guide.

**Call Video Data Bank for more  
information at 312-345-3550.**



photo. Ant Farm



Emily Carr, *Untitled*, charcoal drawing

# 1999 Conference in Vancouver

March 25-31, 1999

Hotel Vancouver

Vancouver, Canada







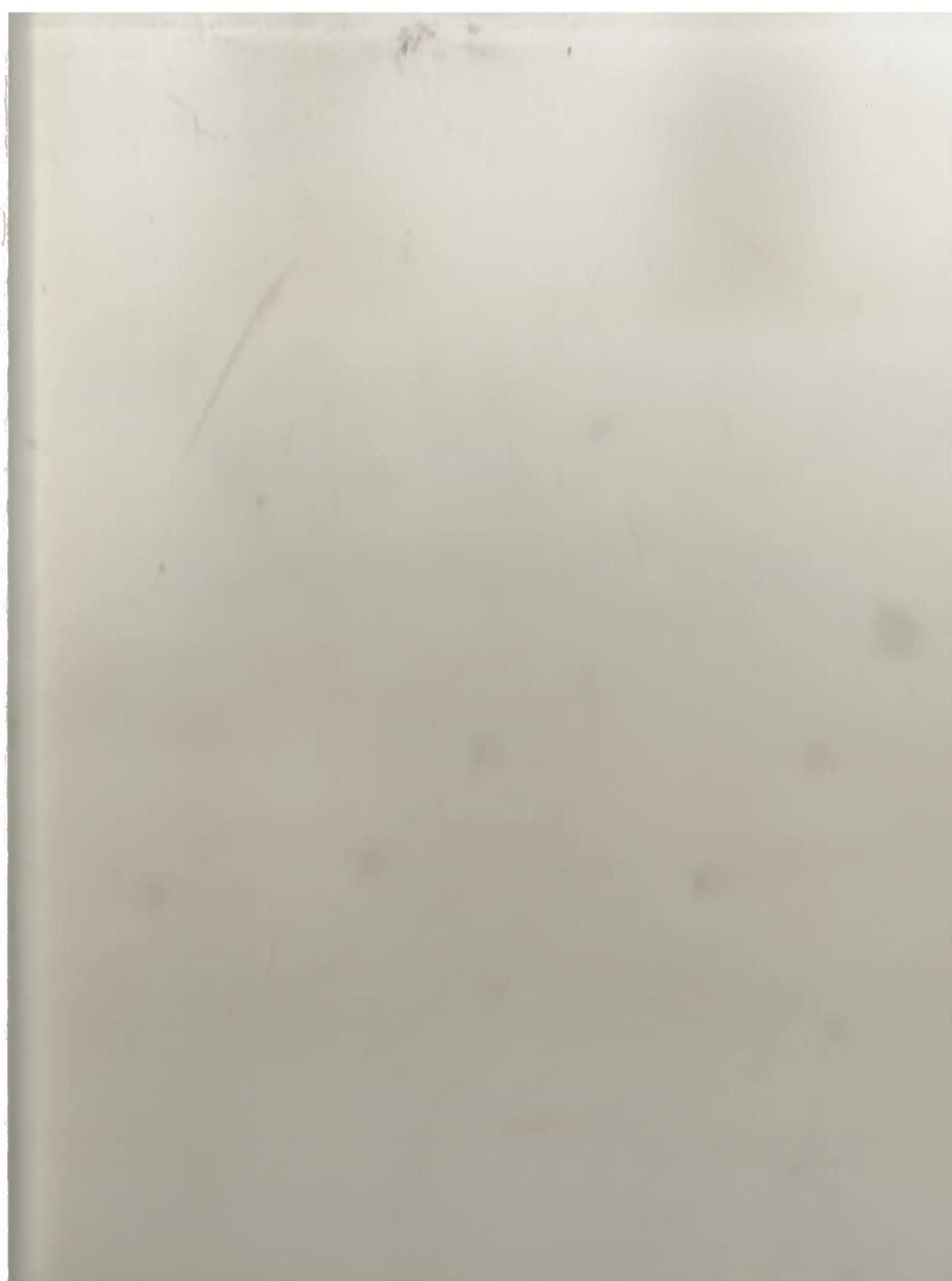
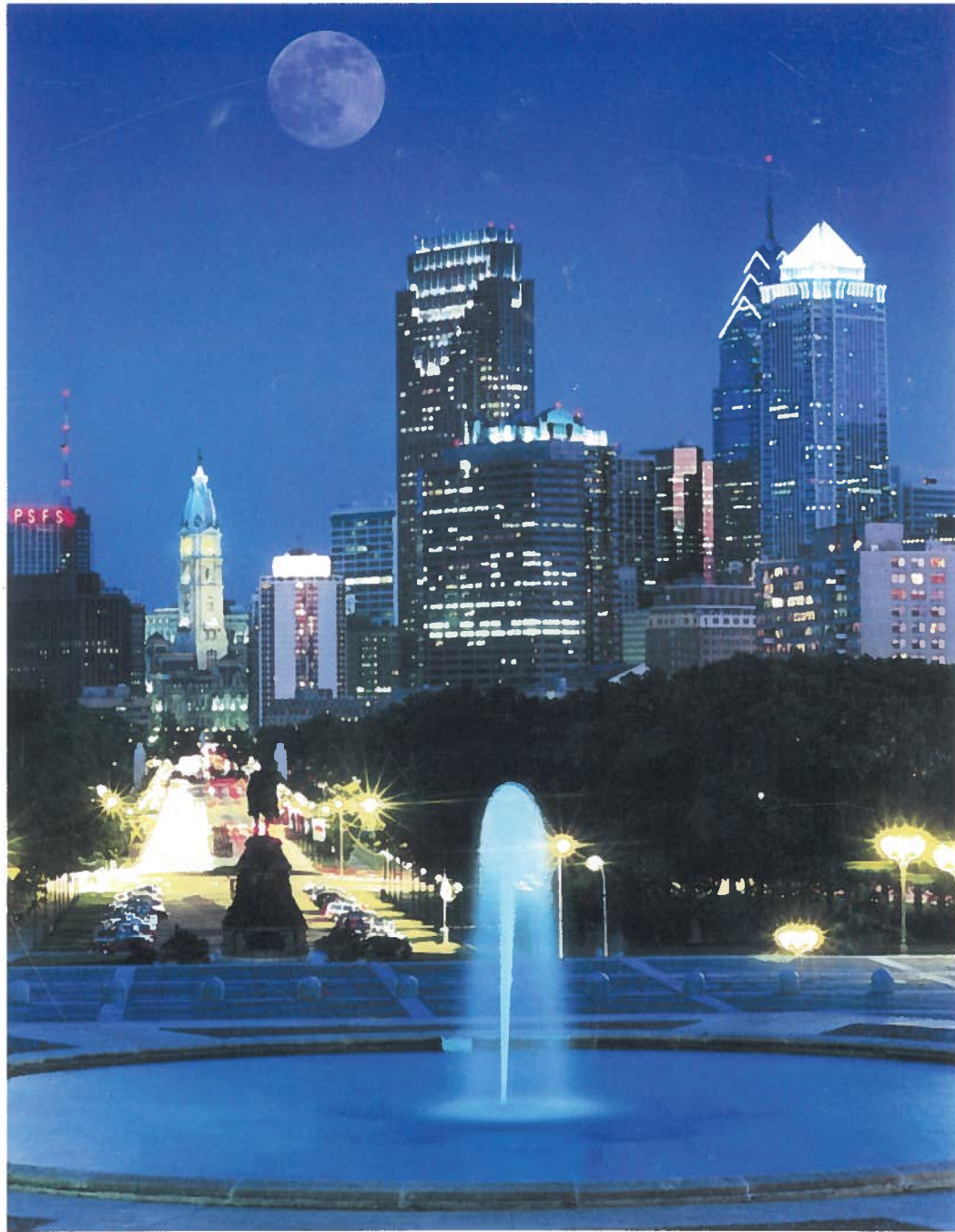

*Front Cover: City Hall, Philadelphia, PA*

*Back Cover: Skyline, Philadelphia, PA*

*Photos by Jim McWilliams*