

# ART LIBRARIES SOCIETY OF NORTH AMERICA

19TH ANNUAL CONFERENCE

THE RITZ-CARLTON  
KANSAS CITY, MO  
MARCH 7 - 14, 1991

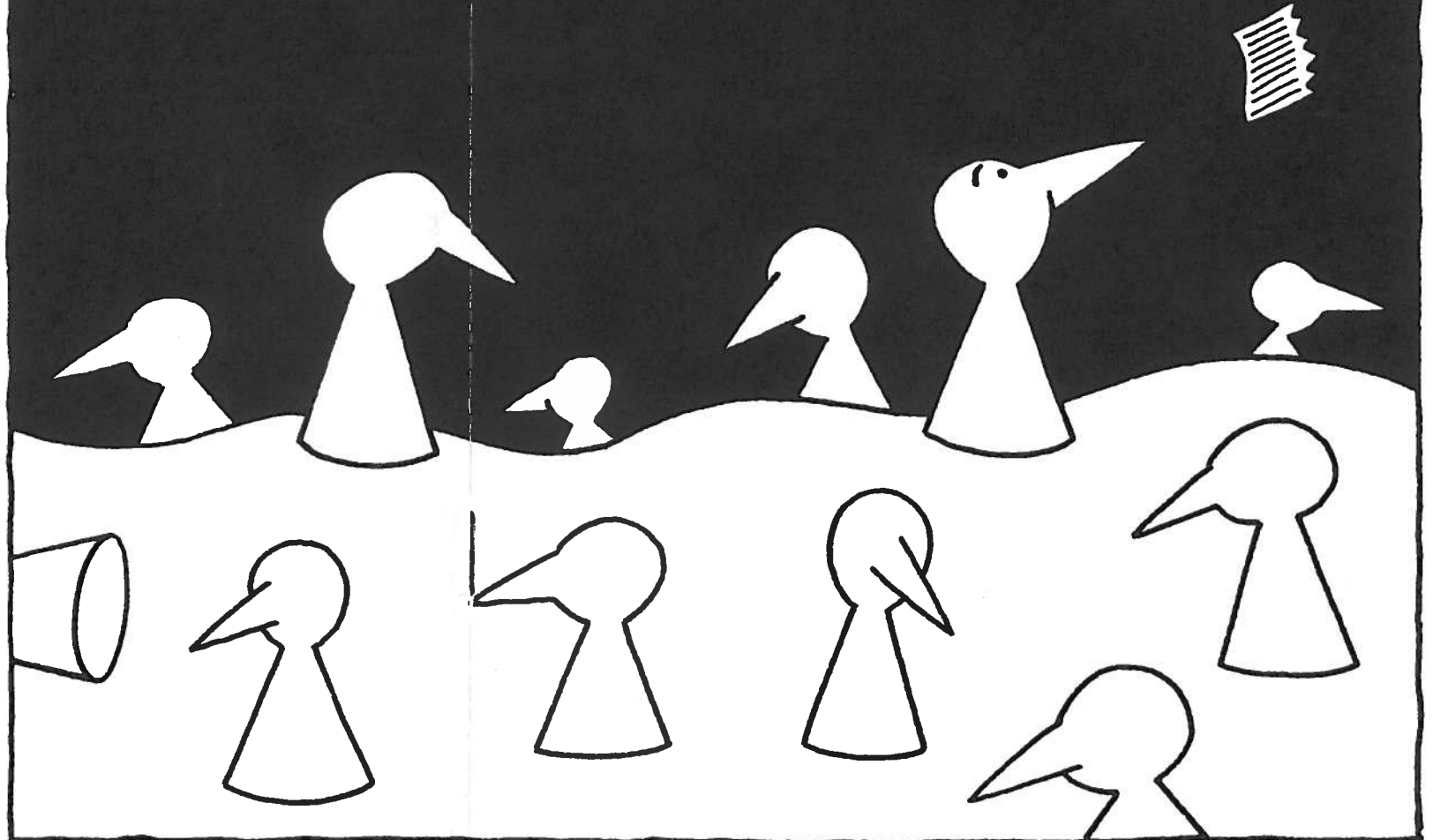

©C. P. G. W. R. O. L. L. I.

# ART LIBRARIES SOCIETY OF NORTH AMERICA

**19TH ANNUAL CONFERENCE**

**THE RITZ-CARLTON**

**KANSAS CITY, MO**

**MARCH 7 - 14, 1991**

---

# CONTENTS

Sponsors . . . . .	.5
Acknowledgements . . . . .	.6
Exhibitors . . . . .	.7
General Information . . . . .	.8
Conference Program . . . . .	11
Thursday, March 7 . . . . .	12
Friday, March 8 . . . . .	13
Saturday, March 9 . . . . .	15
Sunday, March 10 . . . . .	19
Monday, March 11 . . . . .	24
Tuesday, March 12 . . . . .	28
Wednesday, March 13 . . . . .	34
Thursday, March 14 . . . . .	36
Hotel Floor Plan . . . . .	Centerfold
Guide to Kansas City . . . . .	37

---

## SPONSORS

ARLIS/NA and the 19th Annual Conference Chairs would like to acknowledge the generous support of the following businesses and institutions:

- Alecto Historical Editions
- Ars Libri
- Dictionary of Art
- Jewell, Baker and Zander, Inc.
- K.G. Saur
- Nelson-Atkins Museum of Art
- Philbrook Museum of Art
- University of Kansas
- University of Missouri—Kansas City  
and especially the  
ARLIS/CP chapter

---

*Cover design: Charles Barsotti*  
*Interior Graphics: Kevin Osborn*

---

**ARLIS/NA EXECUTIVE BOARD,  
1990**

President: Lynette Korenic, University of California, Santa Barbara, Arts Library  
Vice-President/President-Elect: Merrill Smith, Massachusetts Institute of Technology, Rotch Library  
Secretary: Anita Gilden, Philadelphia Museum of Art, Library  
Treasurer: Eugenie Candau, San Francisco Museum of Modern Art, Ackerman Library  
Past President: Clive Phillpot, Museum of Modern Art, Library  
Regional Representatives:  
East: Edward Teague, University of Florida, Architecture and Fine Arts Library  
Midwest: Eileen Fry, Indiana University, Fine Arts Slide Library  
West: Kathryn Wayne, University of California, Berkeley, Environmental Design Library  
Canada: Irena Murray, McGill University, Blackader-Lauterman Library  
Executive Director: Pamela J. Parry

---

**ARLIS/NA 1991 CONFERENCE  
COMMITTEE**

Conference co-chair (Program):  
Thomas Young, Philbrook Museum of Art  
Conference co-chair (Local arrangements):  
Karen Meizner, Nelson-Atkins Museum of Art  
Registration:  
Stephanie Sigala, St. Louis Art Museum  
Marianne Cavanaugh, St. Louis Art Museum  
Suzy Frechette, St. Louis Public Library  
Exhibitions:  
Susan Craig, University of Kansas, Lawrence  
Dana Beth, Washington University  
Transportation:  
Stanley Hess, Nelson-Atkins Museum of Art  
Audio-Visual:  
Bonnie MacEwan, University of Missouri, Columbia  
Guidebook:  
Marilyn Carbonell, University of Missouri, Kansas City  
Special Events:  
Jane Zander, Nelson-Atkins Museum of Art  
Hospitality:  
Marie Sedlacek, Joslyn Art Museum

---

**SPECIAL THANKS TO:**

Joe MacReynolds, Kansas City Art Institute, and Mary Rosenblum University of Kansas, Lawrence, for their invaluable assistance with tours. Also to Jane Cheng and Mary Farrow, Nelson-Atkins Museum of Art, for their assistance with conference registration packets, and Welcome Party door prizes. Thanks to Giselle Simon for designing the map, and for her help with exhibition signage. Warm thanks and appreciation to Lois Crane and the members of the ARLIS/CP chapter who have contributed so much to the planning and organizing of this conference.

---

Abbeville Press  
Alecto Historical Editions  
Ars Libri, Ltd.  
Art Trak  
Association of American University Presses  
BHA, Bibliography of the History of Art/  
Bibliographie d'Histoire de l'Art  
Books Nippan  
Cactus Software  
Casalini Libri  
Chadwyck-Healey  
Conference Book Service  
The Dictionary of Art  
Emmett Publishing  
Erasmus  
F.A. Bernett  
Fred & Elizabeth Pajerski  
G.K. Hall & Co./Sandak, a Division of G.K. Hall  
Garland Publishing  
Gerard Hamon, Inc.  
Getty Art History Information Program  
H.W. Wilson Company  
Howard Karno Books  
K.G. Saur/R.R. Bowker  
Kraus International Publications  
LBS/Archival Products  
Librairie Léonce Laget  
Mindata Ltd.  
Music Library Association  
Norman Ross Publishing, Inc.  
Publishers Book Exhibit  
Puvill Libros  
Research Libraries Group  
Research Publications, Inc.  
St. James Press  
Thomas Heneage Art Books  
University of Michigan Slide Distribution  
University of New Mexico Press  
University of Washington Press  
University Products, Inc.  
Visual Resources Association  
Worldwide Books

---

## GENERAL INFORMATION

---

### ON-SITE REGISTRATION

For those unable to register early, on-site registration will begin at 3:00 p.m. on Thursday, March 7. An additional charge will be made for registrations postmarked after February 5, 1991, or those made on-site. Pre-registration and payment of a fee is required for all tours and workshops.

---

### REFUNDS

Requests for refund of registration fees must be received in writing at ARLIS/NA, 3900 E. Timrod Street, Tucson, Arizona 85711 no later than February 25, 1991. A \$5.00 processing fee will be assessed. No on-site refunds will be made. If events for which you have paid are filled when your registration form is received and no substitutes are available, you will be notified and a refund will be sent to you by mail.

---

### REGISTRATION AND INFORMATION DESK

The Registration/Information Desk will be located on the Ballroom Level of the Ritz-Carlton. This is two floors below the lobby level and is accessible by elevator or by the grand staircase to the right of the main entrance. The hours for the Registration Desk are included here in the Schedule. As in the past, Bulletin Boards will be provided for professional and personal messages. Registration desk volunteers will answer questions regarding the conference as well as dispense general information. Maps of the Kansas City area will be available in your registration packets, and volunteers at the desk will know the area well enough to give directions.

---

### SMOKING POLICY

Smoking is not permitted in conference meeting rooms or the exhibits.

---

### GUEST POLICY

If you plan to bring a guest, please observe the following ARLIS/NA policy: Guests of conferees are encouraged to register for the full conference. Unregistered guests will be permitted to join tours and special events on a space-available basis after all registered conferees have been accommodated.

---

### TRANSPORTATION

As mentioned below, the best way to explore the Kansas City area is still by private car. However, there is excellent bus service from the Plaza area to downtown via the Main Street corridor (the bus costs \$.75, plus \$.10 for each zone change), and there is also a Trolley service, providing a convenient link between the Plaza area, the shops at Crown Center, downtown Kansas City, and the Nelson-Atkins Museum. The Trolley costs \$3.00 for an all-day pass.

**Rental Cars** The easiest transportation around the city is by car; if you want to do some exploring, renting a car is recommended.

---

## THE HOTEL & PROGRAM INFORMATION

---

The Ritz-Carlton Hotel is conveniently located within walking distance of the Kansas City Art Institute, the Nelson-Atkins Museum of Art, the Linda Hall Library, and the University of Missouri—Kansas City.

High tea is served in the lobby every afternoon at 4:30. The Cafe offers fine food for breakfast, lunch and dinner, and the rooftop Grill, a favorite in Kansas City for fine dining, serves lunch and dinner daily and Sunday brunch.

A Fitness Center is open to hotel guests, with steam room and sauna. Tennis courts are within walking distance, and walking and jogging trails are in abundance nearby: at Loose Park, up the hill behind the hotel, and at Nichols Park, just a few blocks north.

The conference registration/information desk, meeting rooms and exhibit space are all located on the two levels below the main lobby. Some committee and business meetings will be held in conference suites on the upper floors of the hotel. Check-in time is 3:00 p.m.; check-out time is 12:00 noon.

---

### EXHIBITS

The exhibits will open on Monday, March 11, at 8:00 a.m., with a complimentary breakfast from 8:00 a.m. until 10:00 a.m. Hours of the exhibits, which will be located on the Ballroom Level, two floors below the main lobby, are included in this schedule. New this year will be a schedule of demonstrations, posted near the entrance to the exhibits: please stop by and take note of these demonstrations. Exhibitors will include publishers, book dealers, visual resources suppliers, and a number of vendors of computer software and systems. Please visit the exhibits often as the exhibitors rely upon our interest as much as we rely on their services. The exhibits are a vital source of income to the society, so your attendance is critical in making this a success.

---

### HOSPITALITY SUITE

An ARLIS/NA hospitality suite will be open during the conference. Hours are listed in your program and will also be available from the Registration/Information Desk. Wine, beer, and soft drinks will be available at a cash bar.

---

### NEW MEMBERS AND FIRST-TIME ATTENDEES

Registrants attending their first ARLIS/NA conference will be so designated on their name badges, and all conference attendees are encouraged to look out for these newcomers and make them feel welcome. Lyn Korenic, president of ARLIS/NA, invites all new members and first-time attendees to an ARLIS/NA and Conference Orientation on Saturday afternoon, March 9, from 4:45 to 6:15 p.m., followed by dinner (Dutch treat) with a member of the ARLIS/NA Executive Board. Participants will be able to meet one another, learn about ARLIS/NA as an organization and also how to become more involved in the society at the chapter and society level. All conferees are welcome to attend.

On Monday, March 11, from 8:00 to 10:00 p.m., Ars Libri, Ltd., Boston, is hosting a special reception, open to all conferees, honoring new members and first-timers, at the Federal Reserve Bank. Pre-registration is required for this ARLIS/NA annual event, which is sure to be another lavish and joyful occasion.

---

## THE HOTEL & PROGRAM INFORMATION

---

### WELCOME PARTY

A Welcome Party will be held on Saturday, March 9, at the Boulevard Brewery, featuring Kansas City's local brew, Boulevard Beer, Kansas City barbecue from Arthur Bryant's, and Kansas City jazz.

### CONVOCATION

All conference attendees are invited to attend the conference opening Convocation on Sunday, March 10, from 6:30 p.m. to 9:30 p.m. This year's festivities will be held in the Atkins Auditorium of the Nelson-Atkins Museum of Art. The program will include a welcome from officers of the society as well as the presentation of the winners of this year's annual awards. The evening will feature a lively and provocative talk by Marc Wilson, Director of the Nelson-Atkins Museum. Following the program, attendees will enjoy a reception in Kirkwood Hall, through the courtesy of Alecto Historical Editions and the Dictionary of Art.

---

## PRELIMINARY SCHEDULE OF ONGOING ACTIVITIES AND SERVICES

---

### REGISTRATION/INFORMATION DESK

Thursday, March 7	3:00 p.m. - 8:00 p.m.
Friday, March 8	12:00 Noon - 8:00 p.m.
Saturday, March 9	7:30 a.m. - 8:00 p.m.
Sunday, March 10	9:00 a.m. - 6:00 p.m.
Monday, March 11	9:00 am. - 6:00 p.m.
Tuesday, March 12	9:00 a.m. - 6:00 p.m.
Wednesday, March 13	7:30 a.m. - 9:00 a.m.

### HOSPITALITY SUITE

Friday, March 8	9:00 p.m. - 12:00 Midnight
Saturday, March 9	9:00 p.m. - 12:00 Midnight
Sunday, March 10	9:30 p.m. - 12:00 Midnight
Monday, March 11	10:00 p.m. - 12:00 Midnight
Tuesday, March 12	9:00 p.m. - Midnight

### EXHIBIT HOURS

Monday, March 11	8:00 a.m. - 10:00 a.m. ( <i>Opening Breakfast</i> ) 10:00 a.m. - 12:30 p.m. 4:00 p.m. - 6:00 p.m.
Tuesday, March 12	8:00 a.m. - 6:00 p.m.

**THURSDAY,  
MARCH 7**

**ARLIS/NA CONFERENCE PROGRAM**

**3:00-8:00 p.m.**  
BALLROOM LEVEL LOBBY

**REGISTRATION/INFORMATION DESK**

**7:00-10:00 p.m.**  
PLAZA B

**ARLIS/NA EXECUTIVE BOARD MEETING**

*(Open to membership on a seating-available basis)*

**FRIDAY, MARCH 8, 1991  
DAY-AT-A-GLANCE**

7:00 a.m.		
8:00 a.m.	ARLIS/NA Executive Board Meeting	AAPC/RLG Business Meeting Linda Hall Library
9:00 a.m.		
10:00 a.m.		
11:00 a.m.		
12:00 Noon		
1:00 p.m.	Registration & Information	
2:00 p.m.		
3:00 p.m.		
4:00 p.m.		
5:00 p.m.		
6:00 p.m.		
7:00 p.m.	RLG SESSION: Searching RLIN for Art-Related Questions	
8:00 p.m.		
9:00 p.m.	Hospitality Suite	
10:00 p.m.		
11:00 p.m.		
12 Midnight		

FRIDAY,  
MARCH 8

ARLIS/NA CONFERENCE PROGRAM

8:00 a.m.-5:00 p.m.

PLAZA B

ARLIS/NA EXECUTIVE BOARD MEETING

(Open to membership on a seating-available basis)

9:00 a.m.-4:00 p.m.

LINDA HALL LIBRARY  
5109 CHERRY STREET

ART & ARCHITECTURE PROGRAM COMMITTEE, RESEARCH LIBRARIES GROUP (RLG) MEETING

COORDINATOR

Jeannette Dixon, Librarian, Museum of Fine Arts, Houston  
(For AAPC/RLG members only)

12:00 Noon-8:00 p.m.

BALLROOM LEVEL LOBBY

REGISTRATION/INFORMATION DESK

7:00 p.m.-8:30 p.m.

SALON II

SEARCHING RLIN FOR ART-RELATED QUESTIONS

SPONSOR

Art & Architecture Program Committee, RLG

COORDINATOR

Jeannette Dixon, Librarian, Museum of Fine Arts, Houston

SPEAKER

LaVonne Gallo, Supervisor, Training, Research Libraries Group  
(Open to all ARLIS/NA conference registrants)

9:00 p.m.-12:00 Midnight

CONF. SUITE 541

HOSPITALITY SUITE

SATURDAY, MARCH 9, 1991  
DAY-AT-A-GLANCE

7:00 a.m.

8:00 a.m.

9:00 a.m.

10:00 a.m.

11:00 a.m.

12:00 Noon

1:00 p.m.

2:00 p.m.

3:00 p.m.

4:00 p.m.

5:00 p.m.

6:00 p.m.

7:00 p.m.

8:00 p.m.

9:00 p.m.

10:00 p.m.

11:00 p.m.

12 Midnight

Registration & Information	ARLIS/NA Executive Board Meeting	Workshop I* Space Planning	Workshop II-A* Searching RLIN	Tour A* General tour of Kansas City	Tour B* Liberty Memorial & Benton Home	Standards II Committee  Staffing
	New Committee Chairs		Workshop II-B* Searching RLIN	Tours* C-Art Deco E-Linda Hall & UMKC Archives		
		COMMITTEE BUSINESS MEETINGS AAT / ART DOC & UPDATE / Development / Nominating North American Library Resources / Professional Development #1				
		COMMITTEE BUSINESS MEETINGS International Relations / Membership / Muehsam Publications / Travel / Wittenborn				
Hospitality Suite	ARLIS/NA CENTRAL PLAINS CHAPTER WELCOME PARTY* Boulevard Brewery					

\* PRE-REGISTRATION REQUIRED



---

**SATURDAY,  
MARCH 9**

---

**ARLIS/NA CONFERENCE PROGRAM**

---

**7:30 a.m.-8:00 p.m.**

BALLROOM LEVEL LOBBY

---

**REGISTRATION/INFORMATION DESK**

*(Moves to Pavilion VI, 6:30 - 8:00 p.m.)*

---

**8:00 a.m.-2:00 p.m.**

PLAZA B

---

**ARLIS/NA EXECUTIVE BOARD MEETING**

*(Open to membership on a seating-available basis)*

---

**8:00 a.m.-3:00 p.m.**

PAVILION I

---

**WORKSHOP I  
SPACE PLANNING FOR ART AND  
ARCHITECTURE LIBRARIES**

*SPONSOR  
COORDINATORS*

Space Planners Round Table  
Sheila Klos, Head, Architecture & Allied Arts Library, University  
of Oregon  
Sonja Staum, Librarian/Archivist, Museum of Contemporary Art,  
Chicago

*PRESENTER*

Celine Alvey, Manager of Systems Planning, Getty Trust  
*(Pre-registration required)*

---

**8:00 a.m.-11:00 a.m.**

SALON II

---

**WORKSHOP II-A  
EXPANDING YOUR HORIZONS: SEARCHING  
RLIN FOR ART INFORMATION**

*SPONSOR  
COORDINATOR  
PRESENTERS*

Art & Architecture Program Committee, RLG  
Jeannette Dixon, Librarian, Museum of Fine Arts, Houston  
LaVonne Gallo, Supervisor, Training, RLG  
Marcia Reed, Associate Librarian, Getty Center Library, and other  
AAPC members  
*(Repeats Saturday, March 9, 12:00 Noon - 3:00 p.m.; pre-registration re-  
quired)*

---

**TOUR A  
KANSAS CITY ARCHITECTURE:  
GENERAL TOUR OF THE CITY,  
FROM THE RIVER TO THE PLAZA**

*(Meet in Ballroom level lobby at 7:45 a.m.)*

---

**9:00 a.m. - 12:00 Noon**

---

**TOUR B  
LIBERTY MEMORIAL AND THOMAS HART  
BENTON HOME**

*(Meet in Ballroom level lobby at 8:45 a.m.)*

---

**SATURDAY,  
MARCH 9**

---

**ARLIS/NA CONFERENCE PROGRAM**

---

**9:30 a.m.-4:00 p.m.**

PAVILION V

---

**STANDARDS COMMITTEE II:  
STAFFING — MEETING**

*(Open to Standards Committee members only)*

---

**12:00 Noon-3:00 p.m.**

SALON II

---

**WORKSHOP II-B  
EXPANDING YOUR HORIZONS: SEARCHING  
RLIN FOR ART INFORMATION**

*(Repeat of WORKSHOP II-A, 8:00 a.m. - 11:00 a.m.; pre-registration re-  
quired)*

---

**TOUR C  
KANSAS CITY ARCHITECTURE: ART DECO**

*(Meet in Ballroom level lobby at 11:45 a.m.)*

---

**TOUR E  
LINDA HALL LIBRARY AND THE WESTERN  
HISTORICAL MANUSCRIPTS COLLECTION AT  
THE UNIVERSITY OF MISSOURI—KANSAS  
CITY**

*(Meet in Ballroom level lobby at 11:45 a.m.)*

---

**1:00 p.m.-3:00 p.m.**

---

**TOUR D  
KANSAS CITY ARCHITECTURE:  
HISTORIC KANSAS CITY**

*(Meet in Ballroom level lobby at 12:45 p.m.)*

---

**2:00 p.m.-3:00 p.m.**

PAVILION II

---

**NEW COMMITTEE CHAIRS ORIENTATION**

---

**3:00 p.m.-4:30 p.m.**

CONF. SUITE 241

PAVILION III

PAVILION IV

CONF. SUITE 341

CONF. SUITE 441

PAVILION VII

---

**COMMITTEE BUSINESS MEETINGS**

Art & Architecture Thesaurus Advisory  
*Art Documentation / ARLIS/NA Update* Advisory Board  
Development  
North American Art Library Resources  
Nominating  
Professional Development (Meeting #1)

**SATURDAY,  
MARCH 9**

**ARLIS/NA CONFERENCE PROGRAM**

**4:45 p.m.-6:15 p.m.**

CONF. SUITE 241  
CONF. SUITE 341  
CONF. SUITE 441  
PAVILION III  
PAVILION IV  
PAVILION VII

**COMMITTEE BUSINESS MEETINGS**

Travel Awards  
Publications  
Gerd Muehsam Award  
Membership  
International Relations  
George Wittenborn Award

**4:45 p.m.-6:15 p.m.**

SALON II

SPONSOR  
COORDINATOR

**ORIENTATION TO ARLIS/NA FOR NEW MEMBERS & FIRST-TIMERS**

ARLIS/NA Executive Board  
Lyn Korenic, President, ARLIS/NA

**6:15 p.m.-8:00 p.m.**

**NEW MEMBERS AND FIRST-TIMERS ARE INVITED TO JOIN INDIVIDUAL BOARD MEMBERS FOR DINNER (DUTCH TREAT)**

**8:30 p.m.-11:30 p.m.**

BOULEVARD BREWERY  
2501 S.W. BOULEVARD

SPONSOR  
COORDINATOR

**ARLIS/NA CENTRAL PLAINS WELCOME PARTY**

ARLIS/NA Central Plains Chapter  
Jane Zander, Nelson-Atkins Museum of Art  
*(Pre-registration required; meet in Ballroom level lobby. Bus shuttle service to party begins at 8:15 p.m. Return shuttle service to hotel begins at 10:00 p.m.; meet at front entrance of Brewery. The LAST bus will depart at 11:45 p.m.)*

**9:00 p.m.-12:00 Midnight**

CONF. SUITE 541

**HOSPITALITY SUITE**

**SUNDAY, MARCH 10, 1991  
DAY-AT-A-GLANCE**

7:00 a.m.  
8:00 a.m.  
9:00 a.m.  
10:00 a.m.  
11:00 a.m.  
12:00 Noon  
1:00 p.m.  
2:00 p.m.  
3:00 p.m.  
4:00 p.m.  
5:00 p.m.  
6:00 p.m.  
7:00 p.m.  
8:00 p.m.  
9:00 p.m.  
10:00 p.m.  
11:00 p.m.  
12 Midnight

7:00 a.m.				
8:00 a.m.				
Registration & Information	SESSION 1 Professional Issues for Visual Resources Curators	SESSION 2 Collection Management	RLIN-ILL USERS	Strategic Planning Task Force
	SECTION BUSINESS MEETINGS		SESSION 3 Open Forum	
	12:00 Noon			
1:00 p.m.				
2:00 p.m.				
SESSION 4 Future of Subject Analysis and Access	SESSION 5 Current Databases for Architecture Information	SESSION 6 Funding for Art Museum Libraries		
4:00 p.m.				
5:00 p.m.				
6:00 p.m.				
7:00 p.m.				
8:00 p.m.				
9:00 p.m.				
Hospitality Suite	Serials Swap I	Slide Exchange		
11:00 p.m.				
12 Midnight				

\* PRE-REGISTRATION REQUIRED

**SUNDAY,  
MARCH 10**

**ARLIS/NA CONFERENCE PROGRAM**

**8:00 a.m. - 9:00 a.m.**

PAVILION V

**RLIN - ILL USERS GROUP**

**8:30 a.m.-10:00 a.m.**

PAVILION II

**STRATEGIC PLANNING TASK FORCE  
BUSINESS MEETING**

**9:00 a.m.-6:00 p.m.**

BALLROOM LEVEL LOBBY

**REGISTRATION/INFORMATION DESK**

**9:00 a.m.-11:00 a.m.**

SALON II

**SESSION 1  
PROFESSIONAL ISSUES FOR VISUAL  
RESOURCES CURATORS**

- SPONSOR** Visual Resources Division  
**MODERATOR** Jo Schaffer, Curator, Art Dept. Slide Collection, SUNY College at Cortland
- SPEAKERS** Linda McRae, Learning Resource Specialist, University of South Florida  
*An Analysis of Our Status as Professionals: Recommendations for Change*
- Benjamin Kessler, Director of Slide & Photographic Collections, Princeton University  
*Professional Qualifications: Establishing a Bottom Line*
- Rebecca Miller Hoort, Senior Assoc. Curator, Dept. of the History of Art, University of Michigan  
*Pay Equity: A Primer for Visual Resources Professionals*
- Margaret N. Webster, Slide Librarian, College of Architecture/Art/Planning, Cornell University  
*How to be a Professional in a Professional School*
- Jo Schaffer  
*A Summing Up: With All Rights Preserved*

SALON III

**SESSION 2  
COLLECTION MANAGEMENT: A DELICATE  
BALANCE**

- SPONSOR** Public Library Division  
**CO-MODERATORS** Susan Craig, Head, Art & Architecture Library, University of Kansas
- Valerie Pinkney, Art Librarian, Dallas Public Library
- SPEAKERS** Jeffrey L. Horrell, Asst. University Librarian, Syracuse University  
*Resource Sharing: Priorities, Conflicts, and Rising Expectations*

**SUNDAY,  
MARCH 10**

**ARLIS/NA CONFERENCE PROGRAM**

William J. Dane, Supervising Librarian & Keeper of Prints, Art & Music Division, Newark Public Library  
*A Major Challenge to Security: The Theft/Mutilation of Art Materials, or The Triumph of Art over Betrayed Trust, Rampant Mendacity and Vanished Guilt*

Ann Abid, Head Librarian, Cleveland Museum of Art  
*Loss Liability: Risk, Responsibility, Recovery*

**10:00 a.m.-11:00 a.m.**

PAVILION I

**SESSION 3  
OPEN FORUM ON CENSORSHIP ISSUES**

- SPONSOR** ARLIS/NA Executive Board  
**MODERATOR** Lyn Korenic, Head, Arts Library, University of California, Santa Barbara
- SPEAKERS** ARLIS/NA conference registrants
- This session will follow the format of a true open forum, focusing on a single issue of concern to the profession. Each speaker will be allowed 10 minutes at the open mike.*

**11:15 a.m.-12:45 p.m.**

PAVILION III

PAVILION V

PAVILION II

PAVILION IV

**SECTION BUSINESS MEETINGS**

- Architecture  
Cataloging  
Computers  
Reference and Information Services

**2:00 p.m.-4:00 p.m.**

SALON II

**SESSION 4  
THE FUTURE OF SUBJECT ANALYSIS AND  
ACCESS IN AN ONLINE ENVIRONMENT**

- SPONSOR** Cataloging Section  
**MODERATOR** Janette Rozene, Head Cataloger, Fashion Institute of Technology Library
- SPEAKERS** Anna Smithslova, Subject Cataloger-Fine Arts, Library of Congress  
*Art Subject Headings at L.C.: From Manual to Online Mode*
- Daniel Starr, Associate Librarian-Cataloging, Museum of Modern Art, New York  
*Subject Analysis: Process or Product? Alternate Thesauri and other Considerations in Online Subject Access*

SUNDAY,  
MARCH 10

ARLIS/NA CONFERENCE PROGRAM

Karen Markey Drabenstott, Associate Professor, University of Michigan  
*A New Systems Design for Subject Searching in Online Catalogs*  
Roger Lawson, Head, Cataloging Section, National Gallery of Art  
*Past Perfect: Subject Authorities in a Local System*

2:00 p.m.-4:00 p.m.

SALON III

SPONSOR  
CO-MODERATORS

SESSION 5  
CURRENT DATABASES FOR ARCHITECTURE  
INFORMATION: A-Z

Architecture Section  
Jennifer Hehman, Slide Librarian, Herron Art Library, Indiana University  
Dohery Dorszynski, Art & Architecture Librarian, Pratt Institute Library  
SPEAKERS  
Anthony Alofsin, Ph.D., University of Texas  
*The Frank Lloyd Wright Database*  
Patricia Gebhard, University of California  
*Searching Databases for Architectural History*  
Ruth Kamen, Royal Institute of British Architects Library  
*A is for Architecture Databases*  
Barbara Sykes-Austin, Indexer/Reference Librarian, Avery Library, Columbia University

PAVILION I

SPONSOR  
CO-MODERATORS

PANELISTS

SESSION 6  
FUNDING FOR ART MUSEUM LIBRARIES

Museum Library Division  
Katharine Martinez, Director, Winterthur Museum Library  
Jeannette Dixon, Librarian, Museum of Fine Arts, Houston  
Iris Snyder, Head Librarian, Delaware Art Museum  
Deirdre Lawrence, Principal Librarian, Brooklyn Museum  
Ann Morris, Head Librarian, Toledo Museum of Art

4:15 p.m.-5:45 p.m.

PAVILION II  
PAVILION IV  
PAVILION III  
PAVILION V  
PAVILION I

DIVISION BUSINESS MEETINGS

Academic Library  
Art & Design School Library  
Museum Library  
Public Library  
Visual Resources

SUNDAY,  
MARCH 10

ARLIS/NA CONFERENCE PROGRAM

6:30 p.m.-9:30 p.m.

CONVOCATION AND RECEPTION

Nelson-Atkins Museum of Art  
SPEAKER  
Marc F. Wilson, Director, The Nelson-Atkins Museum of Art  
*The Nelson-Atkins Museum of Art is located at 45th and Oak Streets. Entrance is on the 45th Street (North) side. For those who wish to walk, allow 20-25 minutes. Bus shuttle service from hotel will begin at 6:15 p.m. from Ballroom level lobby. Return shuttle service to hotel begins at 8:30 p.m., from the North (main) entrance of the Museum. The LAST bus to return to the hotel will depart at 9:45 p.m. (Pre-registration required)*

9:30 p.m.-11:30 p.m.

PAVILION V

SPONSOR

SERIALS SWAP

Serials Round Table

PAVILION VII

SPONSOR

SLIDE SWAP

Visual Resources Division

9:30 p.m.-12:00 Midnight

CONF. SUITE 541

HOSPITALITY SUITE

MONDAY, MARCH 11, 1991  
DAY-AT-A-GLANCE

7:00 a.m.					
8:00 a.m.	Registration & Information	EXHIBITS OPENER *			COMMITTEE MEETING: Professional Development #2
9:00 a.m.		Continental Breakfast			
10:00 a.m.	Exhibits	SESSION 7: PLENARY SESSION The Future of ARLIS/NA and the Profession			
11:00 a.m.					
12:00 Noon	MEMBERSHIP LUNCHEON *				
1:00 p.m.	MEMBERSHIP MEETING				
2:00 p.m.					
3:00 p.m.					
4:00 p.m.	Exhibits				Tour F* Hallmark
5:00 p.m.		ROUND TABLES New Art, Serials Indigeneous Art	Cataloging Problems	VR Automation	
6:00 p.m.	ROUND TABLES Film & Video, Space Planners, Women & Art		Arch't'l Drawings	Serials Swap II	Ask ARLIS II
7:00 p.m.					
8:00 p.m.	ARS LIBRI RECEPTION* IN HONOR OF NEW MEMBERS & FIRST TIMERS				
9:00 p.m.					
10:00 p.m.	Hospitality Suite				
11:00 p.m.					
12 Midnight					

\* PRE-REGISTRATION REQUIRED

MONDAY,  
MARCH 11

8:00 a.m.-10:00 a.m.

SALON I  
PAVILION V

8:00 a.m.-12:30 p.m.

SALON I

9:00 a.m.-6:00 p.m.

BALLROOM LEVEL LOBBY

10:00 a.m.-12:00 Noon

SALON III

SPONSOR  
MODERATOR

PANELISTS

12:30 p.m.-2:00 p.m.

SALON II

SPEAKER

2:00 p.m.-4:00 p.m.

SALON II & III

4:00 p.m.-6:00 p.m.

SALON I

4:30 p.m.-6:00 p.m.

PAVILION III  
PAVILION V  
PAVILION IV

ARLIS/NA CONFERENCE PROGRAM

EXHIBITS OPENING BREAKFAST

PROFESSIONAL DEVELOPMENT BUSINESS MEETING #2

EXHIBITS OPEN

REGISTRATION/INFORMATION DESK

SESSION 7: PLENARY SESSION  
THE FUTURE OF ARLIS/NA & THE  
PROFESSION (DISCUSSION OF THE  
STRATEGIC PLAN)

Strategic Planning Task Force  
Lyn Korenic, Head, Arts Library, University of California,  
Santa Barbara  
Strategic Planning Task Force & George Soete (Consultant),  
Assistant University Librarian, Collections, University of  
California, San Diego

MEMBERSHIP LUNCHEON

Ree Schonlau, Executive Director, Alterative Work Site/Bemis  
Foundation, Omaha, Nebraska  
(Pre-registration required)

MEMBERSHIP MEETING

EXHIBITS OPEN

TOUR F  
HALLMARK CARDS, INC.

(Meet at Ballroom level lobby. Bus leaves at 4:10 p.m.)

ROUND TABLE BUSINESS MEETINGS

Indigenous Art & Culture  
New Art  
Serials

---

MONDAY,  
MARCH 11

---

ARLIS/NA CONFERENCE PROGRAM

---

4:30 p.m.-6:00 p.m.

SALON II

SPONSOR  
MODERATOR

---

**CATALOGING PROBLEMS DISCUSSION  
GROUP**

Cataloging Section  
Sherman Clarke, Asst. Librarian/Cataloger, Amon Carter  
Museum

PAVILION II

SPONSOR  
MODERATOR

---

**VISUAL RESOURCES AUTOMATION ISSUES  
DISCUSSION GROUP**

Visual Resources Division  
Linda Narver, Director, Visual Resources, University of Illinois  
at Chicago

SALON III

SPONSOR  
MODERATOR

---

**ASK ARLIS I:  
"COURTING AND MANAGING CHANGES"**

Professional Development Committee  
Kathryn J. Deiss, Head of Interlibrary Loan, Northwestern  
University  
Jeffrey L. Horrell, Asst. University Librarian, Syracuse University  
Katharine Martinez, Director, Winterthur Museum Library

DISCUSSION LEADERS

---

6:00 p.m.-7:30 p.m.

PAVILION III

PAVILION IV

PAVILION V

PAVILION I

---

**ROUND TABLE BUSINESS MEETINGS**

Film and Video  
Space Planners  
Women and Art

---

**CATALOGING OF ARCHITECTURAL  
DRAWINGS DISCUSSION GROUP**

SPONSOR  
MODERATOR

Architecture Section  
Alfred Willis, Architecture Librarian, Kent State University

---

MONDAY,  
MARCH 11

---

ARLIS/NA CONFERENCE PROGRAM

---

6:00 p.m.-7:30 p.m.

SALON III

CO-SPONSORS

MODERATOR

SPEAKERS

---

**ASK ARLIS II:  
"PRODUCTION OF THE DURABLE ART BOOK"**

Professional Development Committee  
George Wittenborn Award Committee  
Jeffrey Weidman, Art Librarian, Oberlin College  
Carolyn Clark Morrow, Malloy Rabinowitz Preservation  
Librarian, Harvard University Library  
Marcia Reed, Assoc. Librarian, Getty Center Library  
James Carmin, Reference Librarian, Architecture & Allied Arts  
Library, University of Oregon

PAVILION VII

SPONSOR

---

**SERIALS SWAP II**

Serials Round Table

---

8:00 p.m.-10:00 p.m.

FEDERAL RESERVE  
BANK BUILDING  
925 GRAND

---

**ARS LIBRI RECEPTION IN HONOR OF NEW  
MEMBERS AND FIRST-TIME ATTENDEES**

The exhibition "México Nuevo" will be open in the Fine Arts  
Gallery.

*Meet in the Ballroom level lobby at 7:30 p.m. Bus shuttle service begins at  
7:40 p.m. The LAST bus to return to the hotel will depart at 10:15 p.m.  
(Pre-registration required)*

---

10:00 p.m.-12:00 Mid-  
night

CONF. SUITE 541

---

**HOSPITALITY SUITE**

TUESDAY, MARCH 12, 1991  
DAY-AT-A-GLANCE

7:00 a.m.  
8:00 a.m.  
9:00 a.m.  
10:00 a.m.  
11:00 a.m.  
12:00 Noon  
1:00 p.m.  
2:00 p.m.  
3:00 p.m.  
4:00 p.m.  
5:00 p.m.  
6:00 p.m.  
7:00 p.m.  
8:00 p.m.  
9:00 p.m.  
10:00 p.m.  
11:00 p.m.  
12 Midnight

	Exhibits	CHAPTER OFFICERS BREAKFAST *		AAT Users Group	
Registration & Information		SESSION 8 Preservation of the Avant Garde		SESSION 9 Spreading the Net for Integrated Reference Service	
		Computer Demos	Newsletter Editors	VRMS Users Group	Canadian Members
					Cataloging Advisory Committee
		SESSION 10 Access & Privacy	SESSION 11 New Trends in Decorative Arts		KCAI Tour and Meeting
	Exhibits Closing Reception *	Computer Demos			Tour G * Hallmark
		Museum Collections Management	MEETINGS:1991-1992 Sect. & Div. Mod./ Art Doc & Update Contr./ Art Doc Column Eds.	Ask ARLIS III	
	"The Henry Moore Sculpture Garden"				
Hospitality Suite				Tour H * K.C. Jazz	

\* PRE-REGISTRATION REQUIRED

*Nominations*  
4:30 Lounge Committee  
7:00 Dinner with Pat Barrett

TUESDAY,  
MARCH 12

ARLIS/NA CONFERENCE PROGRAM

8:00 a.m.-6:00 p.m.

SALON I

8:00 a.m.-10:00 a.m.

PAVILION I

PAVILION V

COORDINATOR

9:00 a.m. - 6:00 p.m.

BALLROOM LEVEL LOBBY

10:00 a.m.-12:00 Noon

SALON II

SPONSOR  
CO-MODERATORS

SPEAKERS

SALON III

CO-SPONSORS

CO-MODERATORS

EXHIBITS

CHAPTER OFFICERS BREAKFAST

Executive Board and Chapter Officers  
(Pre-registration required)

ART & ARCHITECTURE THESAURUS USERS GROUP MEETING

Toni Petersen, Director, AAT  
(Open to all registered conference attendees)

REGISTRATION/INFORMATION DESK

SESSION 8  
PRESERVATION OF THE AVANT GARDE:  
CONTEMPORARY ART ARCHIVES

New Art Round Table  
Darlene Tong, Art Librarian, San Francisco State University  
Hikmet Dogu, Assoc. Librarian, Museum of Modern Art, New York  
Stephen Foster, Chair, History of Art, University of Iowa  
*The Publication and the Archive: A Marriage Made in Heaven*  
Ester Milman, Head of Alternative Traditions Archives, University of Iowa  
*The Artifact and the System: the Problematic of Democratization*  
Jon Held, Jr., Librarian, Fine Arts Division, Dallas Public Library  
*Mail Art Archives*  
Fred Truck, Electrical Bank of Performance Art Material, Des Moines, Iowa  
*Electronic Bank Archives*

SESSION 9  
SPREADING THE NET FOR INTEGRATED  
REFERENCE SERVICE

Reference and Information Services Section  
Academic Library Division  
Beryl Smith, Assistant Art Librarian, Rutgers University

TUESDAY,  
MARCH 12

ARLIS/NA CONFERENCE PROGRAM

Laurie Whitehill, Readers Services Librarian, Rhode Island School of Design

PANELISTS  
Françoise Puriello, Director of the Mabel Smith Dodge Library, Rutgers University

Lois Bogia, Asst. Librarian, Professional Library of the Menninger Clinic, Topeka, Kansas

Judith Schaeffer Young, Manager of Bibliographic Research, Institute for Scientific Information

Marilyn Carbonnell, Asst. Director for Collection Development, University of Missouri-Kansas City

12:00 Noon-2:00 p.m.

COMPUTER DEMONSTRATIONS

PAVILION V

CONF. SUITE 341

COORDINATOR

NEWSLETTER EDITORS LUNCH MEETING

Marjorie Chenoweth, Cataloger, Maryland Institute, College of Art Library

PLAZA A

COORDINATOR

VRMS USERS LUNCH MEETING

Trudy Jacoby, Slide & Record Curator, Trinity College

PLAZA B

COORDINATOR

CANADIAN MEMBERS MEETING

Irena Murray, Head Librarian, Blackader-Lauterman Library, McGill University

PLAZA C

CATALOGING ADVISORY COMMITTEE

2:00 p.m.-4:00 p.m.

SESSION 10  
ACCESS & PRIVACY: ETHICS IN LIBRARY,  
ARCHIVAL AND VISUAL RESOURCE  
COLLECTIONS

SALON II

SPONSOR  
CO-MODERATORS

Indigenous Art & Culture Round Table

Mary Graham, Librarian, Arizona State Museum, University of Arizona

SPEAKERS

Ross Day, Asst. Museum Librarian, Robert Goldwater Library, Metropolitan Museum of Art

Jean Adelman, Librarian, University Museum, University of Pennsylvania

Fraiser McConnell, San Francisco, California

Sigrid Docken Mount, Humanities Bibliographer, Vanderbilt University

TUESDAY,  
MARCH 12

ARLIS/NA CONFERENCE PROGRAM

RESPONDENT  
Paula Fleming, National Anthropological Archives, Smithsonian Institution

Rennard Strickland, Director, American Indian Law & Policy Center, University of Oklahoma

2:00 p.m.-4:00 p.m.

SALON III

SPONSOR

MODERATOR

SPEAKERS

SESSION 11  
NEW TRENDS IN DECORATIVE ARTS

Academic Library Division

Neville Thompson, Librarian, Printed Book and Periodical Collection, Winterthur Museum Library

Scott Erbes, Curatorial Assistant, Department of Decorative Arts Nelson-Atkins Museum of Art  
*Organizing Pandora's Box: A Curatorial Perspective on Decorative Arts Bibliography*

Kimberly A. Rich, Curator, Historical Collection, Hallmark Card Inc.  
*Lots of Books, Many Nooks: the Libraries and Collections of Hallmark Cards, Inc.*

Courtney Shaw, Librarian, Art Library, University of Maryland  
*Tapestry Weaving Today*

KANSAS CITY ART INSTITUTE  
4415 WARWICK

TOUR OF KANSAS CITY ART INSTITUTE &  
MEETING

SPONSOR  
COORDINATOR  
HOST

Art & Design School Library Division

Cristine Rom, Library Director, Cleveland Institute of Art

Allen Morrill, Librarian, Kansas City Art Institute  
*(Meet at the KCAI Library at 2:00 p.m. The Art Institute is a 15-20 minute walk from the hotel)*

4:00 p.m.-5:30 p.m.

PAVILION V

COMPUTER DEMONSTRATION

4:00 p.m.-6:00 p.m.

SALON I

EXHIBITS CLOSER

(Cash bar)

TOUR G  
HALLMARK CARDS, INC.

*(Meet in Ballroom level lobby. Bus leaves at 4:10 p.m.)*



---

TUESDAY,  
MARCH 12

---

ARLIS/NA CONFERENCE PROGRAM

---

5:30 p.m.-7:00 p.m.

---

MEETINGS

PAVILION III

1991-1992 Section and Division Moderators

PAVILION II

*Art Documentation* Book Reviewers and Potential Contributors

PAVILION VII

*Art Documentation* Column Editors

SALON II

---

**ASK ARLIS III:  
"RESEARCH IN PROGRESS"**

SPONSOR

Professional Development Committee

MODERATOR

Jack Robertson, Fine Arts Librarian, University of Virginia

SPEAKERS

Jane Van Nimmen, Fine Arts Bibliographer, Library of Congress  
*Editing the Final Volume of Elizabeth Holt's Source Documents*

Alfred Willis, Architecture Librarian, Kent State University

*The State of American Architectural Libraries: an Analysis of ACSA  
Statistics*

James Bower, Project Manager, Vocabulary Coordination Group,  
Getty Art History Information Project, and

Ray Reece, Public Services Librarian, UCLA Art Library  
*Index of Artists and Exhibitions in Southern California,  
1960-1990*

PAVILION I

---

**MUSEUMS COLLECTIONS MANAGEMENT  
SYSTEMS & THEIR IMPACT ON MUSEUM  
LIBRARIES**

SPONSOR

Museum Library Division

MODERATOR

Milan R. Hughston, Librarian, Amon Carter Museum

PANELISTS

Deirdre Lawrence, Principal Librarian, Brooklyn Museum

Ellen Goheen, Administrator of Special Exhibitions & Collections  
Management, Nelson-Atkins Museum of Art

Pat Barnett, Museum Librarian for Systems, Metropolitan  
Museum of Art

Jim Coleman, Program Director, Research Libraries Group

---

8:00 p.m.-9:00 p.m.

---

**LECTURE: The Henry Moore Sculpture Garden**

PAVILION I

SPONSOR

ARLIS/NA Central Plains Chapter

SPEAKER

Deborah Emont Scott, Samuel Sosland Curator of Contemporary  
Art, Nelson-Atkins Museum of Art

---

9:00 p.m.-12:00 Midnight

---

**TOUR H: JAZZ TOUR**

*(Meet in Ballroom level lobby at 8:45 p.m.)*

---

TUESDAY,  
MARCH 12

---

ARLIS/NA CONFERENCE PROGRAM

---

9:00 p.m.-12:00 Midnight

---

HOSPITALITY SUITE

CONF. SUITE 541

**WEDNESDAY, MARCH 13, 1991  
DAY-AT-A-GLANCE**

7:00 a.m.	All - Day Tours		
8:00 a.m.	Registration & Information	TOUR I* Independence, MO	TOUR J* Lawrence, KS
9:00 a.m.			
10:00 a.m.			TOUR E-2* Linda Hall & UMKC Archives
11:00 a.m.			TOUR K* K.C. Residential Architecture
12:00 Noon			
1:00 p.m.			
2:00 p.m.			
3:00 p.m.			(J-2)
4:00 p.m.			
5:00 p.m.			
6:00 p.m.			
7:00 p.m.			(J-1)
8:00 p.m.	ARLIS/NA Executive Board Meeting		
9:00 p.m.			
10:00 p.m.			
11:00 p.m.			
12 Midnight			

\* PRE-REGISTRATION REQUIRED

**WEDNESDAY,  
MARCH 13**

**7:30 a.m.-9:00 a.m.**

BALLROOM LEVEL LOBBY

**8:00 a.m.-3:00 p.m.**

**8:00 a.m.-5:00 p.m.**

**8:00 a.m.-7:00 p.m.**

**9:00 a.m.-12:00 Noon**

**7:00 p.m.-10:00 p.m.**

PLAZA B

**ARLIS/NA CONFERENCE PROGRAM**

**REGISTRATION/INFORMATION DESK**

**TOUR J-2  
DAY TRIP TO LAWRENCE, KANSAS**

*(Meet in Ballroom level lobby at 7:30 a.m. Returns directly to airport; do NOT return to hotel; BRING LUGGAGE)*

**TOUR I  
DAY TRIP TO INDEPENDENCE, MISSOURI**

*(Meet in Ballroom level lobby at 7:45 a.m.)*

**TOUR J-1  
DAY TRIP TO LAWRENCE, KANSAS**

*(Meet in Ballroom level lobby at 7:45 a.m.)*

**TOUR K  
KANSAS CITY ARCHITECTURE: RESIDENTIAL ARCHITECTURE**

*(Meet in Ballroom level lobby at 8:45 a.m.)*

**TOUR E-2  
LINDA HALL LIBRARY AND THE WESTERN HISTORICAL MANUSCRIPTS COLLECTION, UNIVERSITY OF MISSOURI—KANSAS CITY**

*(Meet in Ballroom level lobby at 8:45 a.m.)*

**ARLIS/NA EXECUTIVE BOARD MEETING**

*(Open to membership on a seating-available basis)*

---

**THURSDAY,  
MARCH 14**

---

**ARLIS/NA CONFERENCE PROGRAM**

---

**8:00 a.m.-5:00 p.m.**

CONF. SUITE 141

---

**ARLIS/NA EXECUTIVE BOARD MEETING**

*(Open to membership on a seating-available basis)*

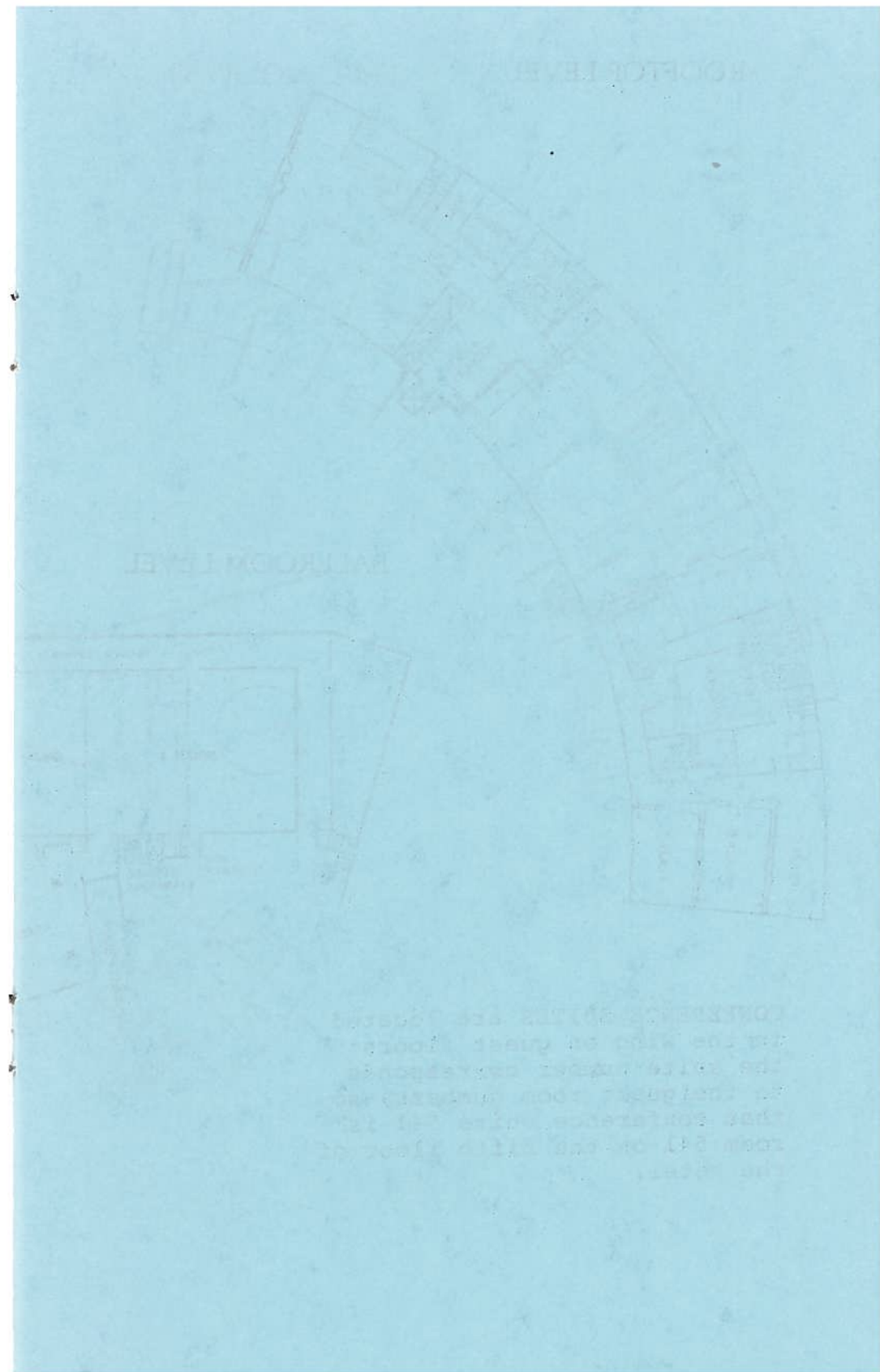

# ROOFTOP LEVEL

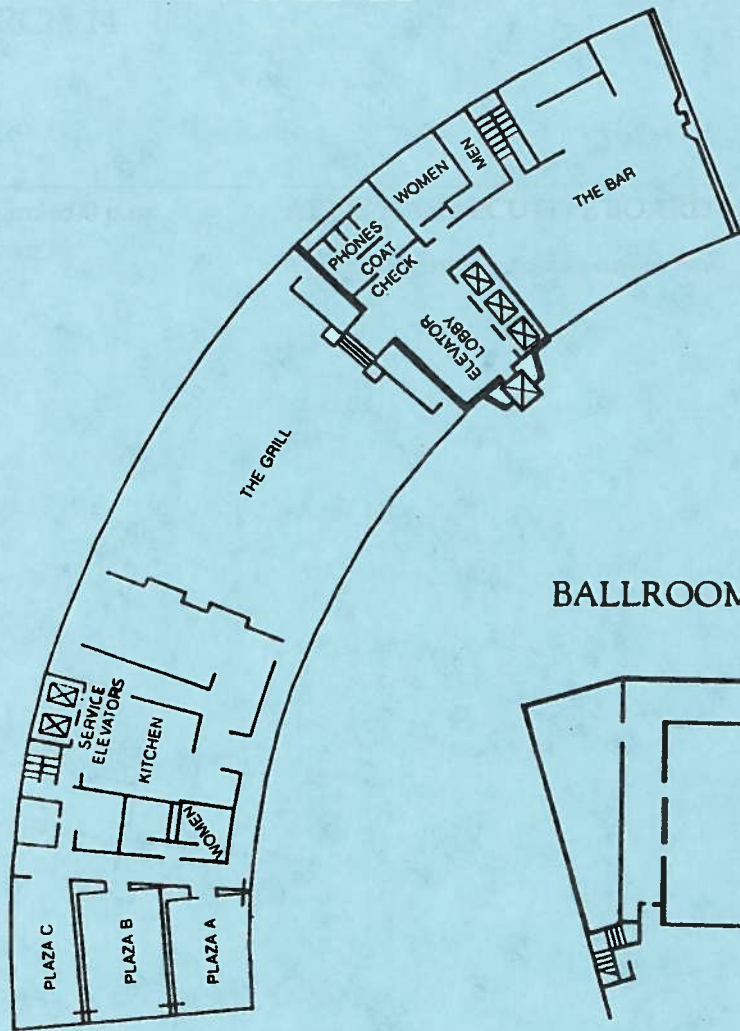

# PAVILION LEVEL

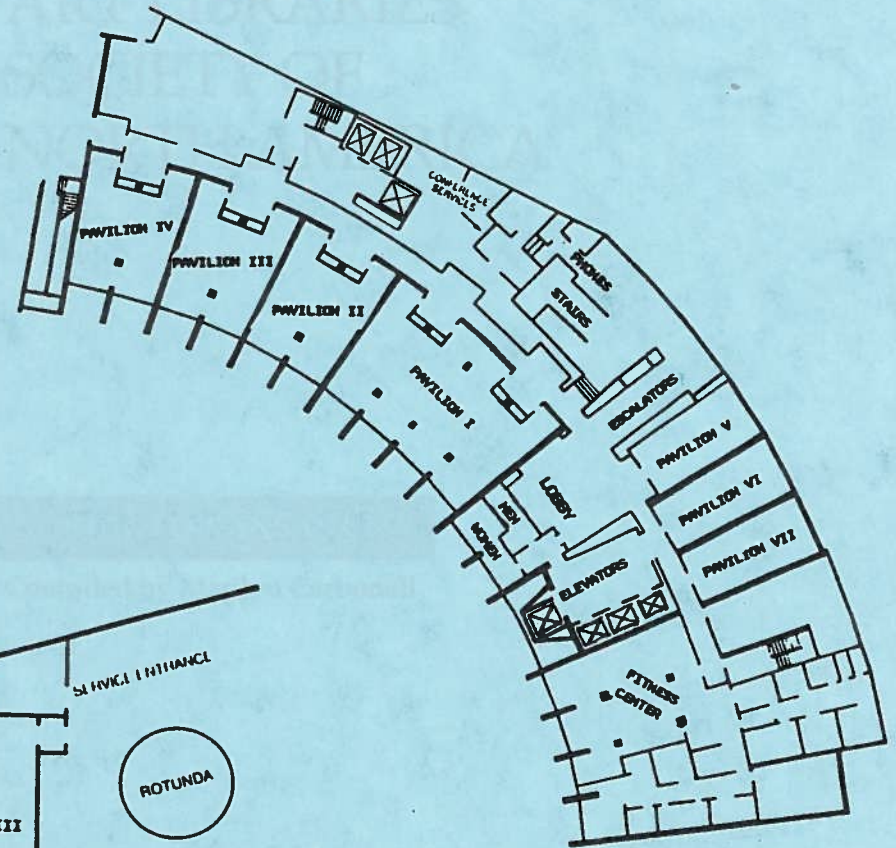

# BALLROOM LEVEL

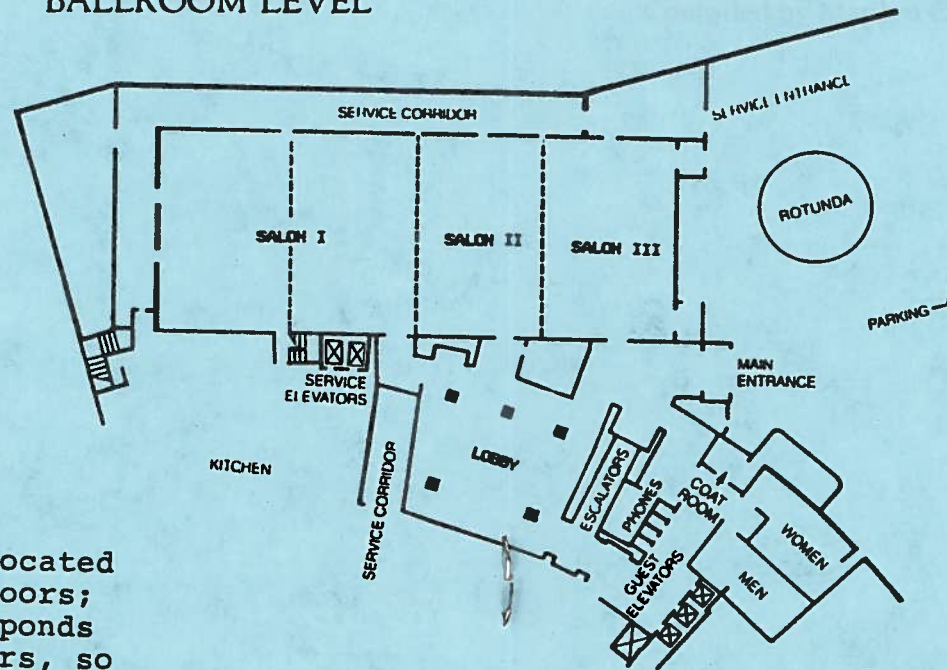

CONFERENCE SUITES are located in the wing on guest floors; the suite number corresponds to the guest room numbers, so that conference suite 541 is room 541 on the fifth floor of the hotel.

---

# ART LIBRARIES SOCIETY OF NORTH AMERICA

A GUIDE TO KANSAS CITY

Compiled by Marilyn Carbonell

PREPARED FOR THE  
ART LIBRARIES SOCIETY OF NORTH AMERICA  
19th ANNUAL CONFERENCE  
KANSAS CITY, MISSOURI  
March 7 - 14 1991

---

## CONTENTS

---

Introduction . . . . .	39
Restaurants . . . . .	40
Barbecue . . . . .	40
American . . . . .	40
New American . . . . .	41
Burgers and Sandwiches . . . . .	41
Cafes . . . . .	42
Cajun/Creole . . . . .	42
Chinese . . . . .	43
Continental/Fine Dining . . . . .	43
Italian . . . . .	43
Japanese . . . . .	44
Mexican . . . . .	44
Mediterranean and Greek . . . . .	45
Pizza . . . . .	45
Seafood . . . . .	45
Steak Houses . . . . .	45
Chocolates . . . . .	46
Bookstores . . . . .	46
Record Stores . . . . .	47
Nearby Libraries . . . . .	48
Museums . . . . .	48
Art Galleries . . . . .	49
Entertainment . . . . .	50
Radio and Television . . . . .	50
Classical Music . . . . .	50
Theater . . . . .	50
Clubs: Blues, Jazz, Rock . . . . .	51
Points of Interest . . . . .	51

---

## INTRODUCTION: GOING TO KANSAS CITY

---

Welcome to Kansas City and the 1991 ARLIS/NA Annual Conference. This guide gives only a sample of the many resources in the Kansas City community. This selective list of things to see, do, and try highlights the areas around and near the conference hotel on the Country Club Plaza.

A few hints about orienting yourself in Kansas City, Missouri: the Missouri River is the north-south line, where numbering begins for streets successively north and south. Main Street is the east-west dividing line for cross streets, usually named. The Ritz-Carlton on Wornall Road is a short three blocks east of Main Street. The area just north of the Plaza is called Westport. Kansas City's "cultural corridor" with the Nelson-Atkins Museum, the Kansas City Art Institute (45th, from Warwick to Rockhill) just east of the Plaza, extends southward to the University of Missouri-Kansas City and the Linda Hall Library (51st & Rockhill). "Downtown" in Kansas City means the large area comprising the central business district (Town Pavilion, 11th & Main), the River Market area (5th & Walnut), and Crown Center (24th & Grand). There is another Kansas City, just across the state line in Kansas, site of the Huron Indian Cemetery and the KU Medical Center campus.

Among the historic areas worth visiting outside Kansas City proper are Independence (10 miles east), site of the Truman home and Presidential Library, the Reorganized Church of Latter Day Saints, and the jumping off point of the westward trails; and Lawrence, Kansas (30 miles west), site of the University of Kansas, with its Spencer Museum of Art and the Spencer Research Library, and the Haskell Indian Community College. In between these points are many fascinating neighborhoods and communities, such as Mission Hills and Shawnee Mission in Kansas, and back on the Missouri side, the old Northeast area of Kansas City, with the Kansas City Museum and Cliff Drive on the bluffs overlooking the rail and river areas.

For detailed information on cultural events, sightseeing, and shopping, consult the local newspapers and the many guides to Kansas City and environs, ranging from the *Kansas City Visitors Guide* (in your conference packet), and the *Downtown Kansas City Guide*, to the guides listed in bibliography published in *ARLIS/NA Update* (1990, no.4). If you have time for longer explorations, try one of the "Day Trip" guides in the same bibliography.

It is impossible to list all of the resources in the Kansas City area, so we have tried to cite some of our favorites. If you have questions visit the Registration Desk; members of the local chapter will be glad to help you. We hope you enjoy the conference and your stay in the "Heart of America!"

---

## ACKNOWLEDGEMENTS

Special thanks to: Chuck Haddix and Brenda Dingley for restaurant and club information; to Louise Sherby & other staff of the University of Missouri-Kansas City Libraries who generously lent annotated copies of guides and advice; to David Weinglass for editorial advice; and again to Chuck for the "audio" portion of this guide and the bibliography. Any errors or omissions are those of the editor. Inclusion of any businesses or services in this guide does not represent endorsement by ARLIS/NA.

---

## RESTAURANTS

Kansas City is justly proud of its barbecue, but many guides attest to the variety of cuisine and eateries in the city, many of them located in the areas around the conference site. In addition to the restaurants listed in this section, you should consult the "Restaurant Guide" in the monthly magazine *Kansas City Live!* Reviews in the *Kansas City Star*, the "Restaurants" and "Past Repasts" columns in the Preview section (every Friday) are helpful.

Since the restaurant scene in Kansas City changes rapidly, and many good restaurants have closed recently, we suggest calling to check hours, reservations, and price ranges. Category listings are not exclusive. Comments about menus and prices should be considered only as suggestions. Most serve lunch and dinner. Among the hotels on the Plaza having good, reliable restaurants are: the Ritz-Carlton, the Raphael (across the street), and on Main Street (at 45th), the Hilton Plaza and the Marriott. Bon appetit!

---

### BARBECUE

#### ARTHUR BRYANT'S BARBEQUE

1727 Brooklyn, 231-1123 (Car trip)

Immortalized by Calvin Trillin, perhaps the most famous, but not the only BBQ in town. Sandwiches are piled high with enough beef or ham to feed two. The fries are on the greasy side and the sauce is peppery. A KC classic.

#### GATES AND SONS BAR-B-Q

4707 The Paseo, 921-0409 (East of UMKC)

Originally the Ol'Kentuck' Bar B Q, Gates is the most popular in KC. Don't be surprised when you are greeted by a counter person enthusiastically yelling, "Hi, may I help you." Fast food marketing and service are combined with adherence to the KC BBQ tradition. The meat is liberally smoked and served lean. The original sauce is rich and spicy, but the adventurous may want to sample from the other sauces. The beef on a bun (which comes with hot, thick fries) is a

real deal. Chicken, ribs, and beef sandwiches are recommended.

#### JAKE EDWARDS

5107 Main, 531-8878 (Nearby, South of Plaza)

Jake Edwards doesn't serve KC style BBQ. The sauce is a molasses-based brown sauce. The meat is cut thicker and fattier than served at Gates or Bryants. The sweet potato fries are a nice twist on the traditional BBQ side dishes of cole slaw & baked beans. Great chicken. Inexpensive.

#### THE GRAND EMPORIUM

3832 Main, 531-1504 (Westport)

In addition to serving lunches, the Grand Emporium is a popular night spot in the Westport area. Food is as adventuresome as the entertainment. The BBQ is a Texas derivative, prepared by Grace Harris. Her sauce is hot and spicy. The menu also includes Creole and Jamaican cuisine. Unconventional dining atmosphere, featuring the best live blues, reggae, and rock'n'roll six nights a week.

---

### AMERICAN

#### THE AMERICAN RESTAURANT

2450 Grand, 471-8050 (Halls, Crown Center)

Contemporary formal dining, served in spectacular setting in one of KC's culinary landmarks. Serves only dinners. The restaurant features imaginative approaches to American food; good wine list features American offerings. Elegant and expensive.

#### CALIFORNOS

4124 Pennsylvania, 531-7878 (Westport)

California cuisine comes to the Midwest in a pleasant setting. Good place for cocktails. Not as expensive as it looks.

---

## RESTAURANTS

#### HOUSTON'S

4640 Wornall Road, 561-8542 (Plaza)

Sandwiches, soup, and salads are served in very generous portions. Good value. Also serves barbecued baby back ribs. No reservations. Be prepared for long lines.

#### PARKWAY 600 GRILL

600 Ward Parkway, 931-6600 (Plaza)

Upscale, casual club-like atmosphere featuring a wide range of entrees from sandwiches, pasta dishes to lobster. Sunday Brunch.

#### PEPPERCORN DUCK CLUB

Hyatt Regency Hotel, 2345 McGee, 421-1234

(Crown Center)

Duck is specialty here in a restaurant that serves traditional American and continental cuisine in a formal atmosphere. The dessert bar is a chocolate lover's delight. Brunch on Sundays.

#### RUBY'S SOUL FOOD

1506 Brooklyn (at 15th St.), 421-8514 (Car trip)

If you crave great fried chicken, cornbread, and homemade ice cream, Ruby's is the place. Prices are very reasonable. The food is served buffet style.

#### STARKER'S

200 Nichols Rd., 753-3565 (Plaza)

Contemporary dishes featuring fresh fish, beef, and veal. The Bookbinder soup is a KC tradition. Good wine list. Reservations recommended.

#### STROUD'S

1015 E. 85th, 333-2132 (South KC, car trip)

Rustic, roadhouse style KC institution that serves wonderful pan-fried chicken, with fries or mashed potatoes, and cinnamon rolls. Stroud's tee-shirts proclaim, "we choke our own chickens." Large portions, reasonably priced. Calvin Trillin loves this place.

---

### NEW AMERICAN

#### CAFE ALLEGRO

1815 W. 39th, 561-3663 (Westport at stateline)

Fine dining featuring an inventive menu of seasonal and specialty entrees.

#### CAFE LULU

1706 W. 39th, 931-5858 (Westport near stateline)

Great appetizers like the duck burritos.

#### METROPOLIS

303 Westport Road, 753-1550 (Westport)

Eclectic, contemporary cuisine, with grilled and smoked seafood, meat, and poultry dishes. Decor is high-tech. Moderately priced.

#### VENUE

4532 Main, 561-3311 (Plaza)

Features adventuresome New American menu, with beautifully presented food. Usually expensive, but from 5-7 p.m., they offer a sandwich and Boulevard beer special at very reasonable prices.

---

### BURGERS AND SANDWICHES

#### EMILE'S EUROPEAN DELI

302 Nichols Rd., 753-2771 (Plaza)

Sandwiches and soup with a German accent at this popular informal deli. Weather permitting, enjoy your "wurst" outside in their sidewalk cafe.

#### FRED P. OTT'S BAR & GRILL

4770 J.C. Nichols Parkway, 753-2878 (Plaza)

Oversized burgers and more served in an informal atmosphere favored by young singles.

#### HOULIHAN'S

4743 Pennsylvania, 561-3141 (Plaza)

Burgers and onion soup are a staple at this national chain. Sunday Brunch.

---

## RESTAURANTS

### MCDONALD'S

500 Nichols Rd, in Seville Square, 931-1010 (Plaza)

Whether in KC or Moscow, the golden arches are reliable.

### SUBWAY SANDWICHES

4216 Main, 531-6566 (Plaza)

Meatball and other deli sandwiches.

### WINSTEADS

101 Brush Creek (47th & Main), 753-2244 (Plaza)

A local favorite in KC, the quintessential drive-in cited by Calvin Trillin serves single, double or triple hamburgers. Late hours make it possible to enjoy the good malts and old-fashioned sodas.

---

## CAFES

### ANDRE'S CONFISERIE SUISSE

5018 Main, 561-3440 (Nearby, South of Plaza)

Fine pastries and chocolates with Swiss flair are sold in the front of the shop or available to enjoy in the tearoom in the morning or afternoon. Excellent coffee, including espresso and capuccino. Tasty continental lunches (prix fixe) served. No reservations; beat the queue and come early or late.

### LA BONNE BOUCHEE

618 Ward Parkway, 931-5230 (Plaza)

Great place to have a light lunch in an airy atmosphere. This French bakery features, soup, croissant sandwiches, salads, and, of course, excellent pastries and breads. Brunch on Sundays.

### ANDE-LEI'S CAFE

1611 Westport Road, 756-2188 (Westport near stateline)

South American-influenced cuisine served in a casual atmosphere.

### CLASSIC CUP

4130 Pennsylvania, 756-0771 (Westport) and 301 W. 47th, 753-1009 (Plaza)

The original Westport cafe is housed with a specialty grocery and classical music store. The Plaza location is a sidewalk cafe. Features fresh, innovative entrees and a coffee-of-the-day. Sunday brunch at Westport.

### GOURMET GROCER

614 West 48th, 561-5888 (Plaza)

Specialty grocery featuring fabulous salads, deserts, breads, and muffins as take-outs, but you can have a quick nosh at one of the tables.

### LE PICNIQUE

301 East 55th, 333-3887 (South, UMKC)

Lunch at the cafe located in the Sebree Galleries and browse the antiques before and after. Interesting menu. The soup and sandwich combinations are a good buy. Reservations accepted.

### ROZZELLE COURT

in the Nelson-Atkins Museum of Art, 4525 Oak, 751-1279 (Plaza)

Serves lunches in an airy 16th-century Italian courtyard. Great soups, salads, and two hot entrees served cafeteria style. Museum entrance fee is required for patrons lunching, but will be waived for ARLIS/NA attendees who display conference badges!

---

## CAJUN / CREOLE

### KIKI'S BON TON MAISON

1515 Westport Rd., 931-9417 (Westport)

Rich Cajun and Creole delights such as gumbos and jambalayas are complemented by the funky decor featuring alligators. Live music from the Bon Ton Soul Accordion Band on Wednesday and Friday nights. Reservations accepted. Reasonably priced too.

---

## RESTAURANTS

### CHINESE

**BO LING'S CHINESE RESTAURANT,**  
4800 Main, 753-1718 (Plaza)

Known for its Dim Sum on weekends, Bo Ling regulars also like the orange beef. Reservations suggested for groups of more than six. Located in the Board of Trade building. Moderately priced.

### HOUSE OF TOY

602 West 48th, 561-9585 (Plaza)

Long-established Chinese restaurant serving reliable Cantonese style cuisine in an informal setting. Limited American menu. Value for money.

### NEW PEKING

540 Westport Rd., 531-6969 (Westport)

Szechuan and Mandarin style menu featured here. Decor is more formal than other KC Chinese restaurants, but dress code is informal. For parties of five or more, reservations are recommended. Moderately priced.

### NORTH CHINA

3805 Broadway, 931-7742 (Westport)

Family-run restaurant features Peking and Szechuan style dishes. Cantonese mainstays are also available. Try the steamed dumplings as an appetizer. Interesting vegetable dishes. Very reasonable.

### PRINCESS GARDEN

8906 Wornall Rd., 444-3709 (South KC)

Mandarin and Szechuan style dishes served with flair in this restaurant that was the first to introduce this cuisine to KC. Try the walnut chicken or the Peking duck. Informal to formal attire. Some waiting during peak times. Reservations suggested.

---

## CONTINENTAL AND FINE DINING

### FEDORA CAFE AND BAR

210 W. 47th., 561-6565 (Plaza)

Contemporary, elegant decor provides backdrop for French-Italian menu. Reservations suggested. Brunch on Sunday.

### LA MEDITERRANEE

4742 Pennsylvania, 561-2916 (Plaza)

Modern French cuisine served in a light but formal atmosphere. Luncheon specials are quite reasonable. Good wine list.

### JASPER'S

405 W. 75th, 363-3003 (South KC)

Northern Italian cuisine served in an ornately decorated setting. This award-winning restaurant is open for dinner. The Mirabile family also operates the informal Trattoria Marco Polo around the corner.

### NABIL'S

3605 Broadway, 531-0700 (Westport)

Continental cuisine with a Middle Eastern flair at affordable prices. Restaurant is smallish; reservations are recommended.

---

## ITALIAN

### FIGLIO RESTAURANT

209 W. 46th Terr., 561-0505 (Plaza)

Homemade pasta and California style pizza favored here.

### MAMA STUFFEATI'S RISTORANTE

3947 Main, 931-0522 (Westport)

Italian restaurant that places emphasis on freshness. Daily specials are available for lunch and dinner. Atmosphere is casual, similar to a New York bistro. No reservations for parties of less than six.



---

## RESTAURANTS

### MARIO'S

4747 Wyandotte, 931-4500 (Plaza)

Comfortable dining to please with traditional favorites. Meatball grinders are a luncheon specialty. Reservations for dinner recommended.

### TRATTORIA MARCO POLO

7514 Wornall Road, 361-0900 (South KC)

Casual Italian eatery run by the Mirabile family (see Jasper's, Continental). Good appetizers like cold, grilled eggplant.

---

## JAPANESE

### GOJO JAPANESE STEAK HOUSE

4163 Broadway, 561-2501 (Westport)

Teppan yaki style dining at large rectangular tables where the chef displays his flair for juggling, while expertly stir frying your selections. Moderately priced.

### HIBACHI JAPANESE STEAK HOUSE

4745 Wyandotte, 753-0707 (Plaza)

Grandmother probably didn't prepare and serve food in this manner, but the teppan yaki style allows guests to enjoy the chef's performance at table along with the steak and seafood.

### KABUKI JAPANESE RESTAURANT

2450 Grand, in Crown Center, 472-1717 (Crown Center)

Traditional style Japanese favorites including sushi, tempura, and teriyaki. Broiled eel (unagi) is tasty. Try the green tea ice cream for dessert. Teahouse seating available for groups. Reservations accepted.

---

## MEDITERRANEAN AND GREEK

### BOULEVARD CAFE

703 Southwest Blvd., 842-6984 (Westside)

Offers appetizers of the Mediterranean world, including Spanish tapas and Greek mezze selections for a meal or a snack. Boulevard beer is on tap. Reservations for parties of six or more.

### WESTSIDE CAFE

723 Southwest Blvd., 472-0010 (Westside)

Mediterranean, Caribbean, Indian, and Persian dishes served here. The menu varies; something delightful for even the most adventuresome palate. No reservations for this restaurant located in a former gas station. Lunch, Monday-Friday; dinner, Thursday-Saturday.

### ATHENA ON BROADWAY

3535 Broadway, 756-3227 (Midtown, North of Westport)

Greek and Mediterranean cuisine. Emphasizes fresh produce. Try the pita sandwich and soup for lunch. Good taramasalata dip.

### DIMITRI'S GREEK ISLANDS

4114 Broadway, 753-7567 (Westport)

Gyros and other Greek dishes. A vegetarian plate is available. Very reasonable. Watch out for the belly dancer!

### VETTA'S GRECIAN CUISINE

4536 Main, 531-0444 (Plaza)

Have dinner here accompanied by live entertainment featuring bouzouki music and belly dancing.

### CAFE CASABLANCA

5101 Main, 753-1700 (Nearby, South of Plaza)

New Middle Eastern restaurant elegantly decorated in the Moorish style. Moroccan menu includes lamb couscous with Baharat sauce (tasting of cayenne and cinnamon). Recent review cited side dishes of rice with nuts, rosewater carrots and saffron potatoes.

---

## RESTAURANTS

---

## MEXICAN

### ANNIE'S SANTA FE

100 Ward Parkway, 753-1621 (Plaza)

Americanized Mexican dishes served Santa Fe style. Large servings. Reasonably priced. Reservations recommended.

### PONAK'S MEXICAN KITCHEN

2856 Southwest Blvd., 753-0775 (Westside)

Traditional Mexican food served seven days in an informal atmosphere. Try the chicken mole. Great margaritas. Families find the generous servings good value. Reservations recommended. Reasonable.

### MANNY'S OF KANSAS CITY

297 Southwest Blvd., 474-7696 (Westside)

Authentic Mexican dishes. Fast service. Reasonably priced.

---

## PIZZA

### GODFATHER'S

4936 Main, 753-2225 (Nearby, South of Plaza)

National chain features luncheon buffet. Open Sundays.

### MINSKY'S PIZZA

5101 Main, 561-5100 (Nearby, South of Plaza)

Thick crust pizza, including vegetarian style.

### TORRE'S pizzeria

4112 Pennsylvania, 931-3663 (Westport)

Crispy crust pizza is a favorite. Casual atmosphere.

---

## SEAFOOD

### BRISTOL BAR AND GRILL

4740 Jefferson, 756-0606 (Plaza)

Consistent high-quality fresh seafood and steak. Casual elegance. Sunday brunch. Pricey. Reservations recommended, especially weekends.

### THE SAVOY GRILL

Savoy Hotel, 9th & Central, 842-3890

(Downtown, Central Business District)

A Kansas City institution since 1903, the Savoy features a traditional American menu of fresh seafood and prime rib, served in an old-fashioned elegant atmosphere.

---

## STEAK HOUSES

### GOLDEN OX RESTAURANT AND LOUNGE

1600 Genesee, 842-2866 (Stockyards by Kemper Arena)

Known for the best beef in town. Western-style decor preserves KC's stockyard.

### HEREFORD HOUSE

2 East 20th, 842-1080 (Downtown)

Classic steak house; generous servings. Come for the food, not the decor. Reservations recommended on weekends.

### PLAZA III—THE STEAKHOUSE

4749 Pennsylvania, 753-0000 (Plaza)

Steak soup is a favorite at this Plaza cornerstone. Waiters will display the beef before it is cooked. Reservations are a good idea. The ground floor features live entertainment by the City Light Orchestra.

### THE SAVOY (see above, Seafood)

### WALT BODINE'S STEAKHOUSE

106 W. 12th, 221-7000 (Downtown)

Located in the Raddison Suites Hotel, this steakhouse is named for a longtime KC radio broadcaster. Huge portions served in a comfortable atmosphere, where Walt occasionally dines. Also serves old-fashioned malts.

## CHOCOLATES

Have a sweet tooth for just a wee bit of chocolate? Nearby are several shops to satisfy that craving.

**ANNEDORE'S FINE CHOCOLATES**  
106 East 43rd, 753-5012

**ANDRE'S CONFISERIE SUISSE**  
5108 Main, 561-3440

**PANACHE CHOCOLATIER**  
418 Nichols Rd., 931-3191

**HALLS, Plaza Store**  
211 Nichols Rd., 274-3470 (Candy Dept.)

**KANSAS CITY FUDGE** in Crown Center  
2450 Grand, 421-0012

**PRICE'S FINE CHOCOLATES**  
500 Nichols Rd., 561-8141

**CLASSIC CUP**  
4130 Pennsylvania, 756-0771

For the best chocolate (and glazed) doughnuts in KC, there's

**LAMAR'S DO-NUTS**  
240 Linwood, 931-5166

## BOOKSTORES

The usual chain bookstores can be found in shopping centers, like Crown Center; the list below highlights booklovers' favorites.

**BENNETT SCHNEIDER**  
300 Ward Parkway, 531-8484 (Plaza)  
Large general stock of new books, stationery, magazines, and music—LPs and CDs. Current out-of-town newspapers.

**WHISTLERS BOOKS**  
427 Westport Rd., 531-5959 (Westport)  
Located in the heart of Westport. Lively range of new books: literature, best-sellers, strong in art, graphic design and photography, children's books. Stop upstairs for coffee at Whistler's Mother. Monday-Sunday.

**READING REPTILE**  
4120 Pennsylvania, 753-0441 (Westport)  
Specializes in children's books.

**WESTPORT BOOKSTORE**  
14 Westport Rd., just off Main St., 931-9822 (Westport)  
General stock of out-of-print books; good range of used paperbacks, including science fiction and mysteries; also magazine issues.

**PHOENIX BOOKS**  
6 West 39th, just off Main St., 931-5794 (Westport)  
Mainly paperbacks: women's and new age books, psychology, and recordings of women's music—LPs and tapes.

**DAVID SPIVEY, BOOKS**  
1915 West 45th, 531-6088 (West of Plaza)  
Located in the State Line Road antiques district at 45th street. Moderate-size antiquarian and out-of-print books; good stock of old maps, fine prints, and art books.

## BOOKSTORES

**GLENN BOOKS, INC.**  
323 East 55th, 444-4447 (South of UMKC)  
Located only a few blocks south of the campus on the same block as Le Picnique, Glenn Books is a long-established antiquarian bookshop emphasizing Americana, first editions, private press, science/medicine, and fine binding. Take Main Street bus (Route 56) to 55th Street. Tuesday - Saturday.

**THE BOOK SHOP**  
116 W. 63rd St., 444-8187 (Brookside)  
Small personable shop, carefully selected stock.

**KLAUS GRUNEWALD, BOOKDEALER**  
807 West 87th Terrace, 333-7799 (South KC)  
Located in his home. Large, interesting general stock of scholarly, antiquarian, and out-of-print books in all subject areas, especially Americana, bibliography, Limited Editions Club, travel, art and architecture, illustrated books, trains and aviation, and music. (By appointment only)

**RED BRIDGE BOOKS**  
230 West 75th, in Waldo district, 523-1449 (South KC)  
Located in the Waldo Flea Market. Large out-of-print stock in all subject areas: Americana, biography, the Civil War, the World Wars, literature, facsimile reprints, and coffee-table art books. Wednesday to Sunday, 11 a.m.-5 p.m.

**BORDERS**  
9108 Metcalf, (913) 642-3642 (Overland Park, KS, car trip)  
This chain bookstore is unlike any other in the KC area. Very large and varied current stock. Definitely worth the trip out to an area lined with shopping centers.

## RECORD STORES

Missing that one old album by Alan Price? You may find it here in KC.

**AUTOGRAPH'S RECORDS AND TAPES**  
2450 Grand, in Crown Center, 472-7827  
New records, prerecorded tapes, CDs. Musical accessories and gifts.

**MUSIC EXCHANGE**  
207 Westport Rd., 931-7560 (Westport)  
The Exchange has both new and used records. Ask at the counter for access to the large collection of 45s & 78s in the basement. Well-organized. Auditioning equipment available.

**PENNYLANE RECORDS**  
4128 Broadway, 561-1580 (Westport)  
Large selection of new CDs, LPs, and prerecorded tapes. Good selection of jazz and popular music. Prices below list with weekly specials.

**CLASSICAL WESTPORT**  
4130 Pennsylvania, 753-0433 (Westport)  
Their specialty is classical, jazz, soundtracks, new age, and Celtic music. New CDs and prerecorded tapes. List price. Located next to the Classic Cup.

## NEARBY LIBRARIES

### KC PUBLIC LIBRARY, PLAZA BRANCH

4801 Main, 753-6114, M-Sun (Plaza)  
Large modern, branch library that bustles with activity every day. Good fiction. Some out-of-town newspapers. Photocopier available. Children's Room on the ground floor. A postal substation on the ground floor is open Monday-Friday, during post office business hours.

### CLENDENING LIBRARY, Univ. of Kansas

Medical Center, KC, KS  
39th & Rainbow, 588-7040  
Interesting History of Medicine collection is housed in recently renovated portion of the red brick university building.

### ARCHIE DYKES LIBRARY, Univ. of Kansas

Medical Center, KC, KS  
39th & Rainbow, 588-7166  
The library of the health sciences campus of the University of Kansas.

### LINDA HALL LIBRARY

5109 Cherry, 363-4600 (UMKC)  
A privately supported research library of science and technology located in the center of the UMKC campus on beautifully maintained grounds. Distinguished from its state-funded neighbor by its elegant buildings and vast holdings in the natural, physical sciences, and technology. The Rare Book Room houses the History of Science collection.

### MILLER NICHOLS LIBRARY, UMKC

51st & Rockhill, 235-1534 (Reference)  
The main library of UMKC, a modern five-story building that is being renovated, but is open for service. Materials in Special Collections, including the Snyder Collection of Americana, may be paged through Reference. The Marr Sound Archives houses over 100,000 sound recordings in all media. Historic playback machines are part of the Archives. The Law Library is housed in the Law School (52nd & Oak).

## MUSEUMS

There are many guides which describe the museums in the regional Kansas City area; listed here are just a few of our favorites.

### NELSON-ATKINS MUSEUM OF ART

4525 Oak, 561-4000  
Comprehensive art museum, famed for its Oriental collections. The Henry Moore Sculpture Garden on the grounds features 12 works in a specially landscaped setting. Admission fee to museum waived for ARLIS/NA members wearing conference badges. Tuesday-Sunday.

### TOY AND MINIATURE MUSEUM

5235 Oak, 333-2055 (UMKC)  
Located in a restored 1911 mansion on the UMKC campus, this museum has two exhibitions: antique toy soldiers from the collection of Benjamin Crissey and a collection of modern plastic miniature models of vehicles, aircraft, and automobiles by the International Plastic Modelers. Admission fee. Wednesday-Sunday.

### KANSAS CITY MUSEUM

3218 Gladstone Blvd., 483-8300 (Northeast of Downtown)  
Located in the former mansion and estate of R.A. Long, lumber millionaire, the museum features local history exhibits and a planetarium. A complete drugstore c.1910 has been recreated, where cream specialties are served. A satellite museum is located downtown at the Town Pavilion, 1111 Main, 3rd Floor, 471-5262.

## MUSEUMS

### LIBERTY MEMORIAL

100 W. 26th, 221-1918 (Crown Center, across Union Station)  
Towering over KC, the Liberty memorial commemorates the declaration of peace after World War I. Museum exhibits include military uniforms and memorabilia and a full-scale battle trench. The world's largest mural by Gorget, restored by Daniel MacMorris, includes vignettes of international leaders and local KC residents. Tower ride offers panoramic view. Admission. Tuesday-Sunday.

### NATIONAL OFFICE EQUIPMENT HISTORICAL MUSEUM

12411 Wornall Rd., 941-7692 (South KC)  
New museum of office equipment, including period offices vintage 1890, 1920, and 1950. Free admission during business hours, Monday-Friday, 9 a.m.-5 p.m. Car trip required.

### BLACK ARCHIVES OF MID-AMERICA

2033 Vine, 483-1300 (Southeast of Downtown)  
Houses collection of art and research materials on KC area and local leaders. Restored slave cabin. Admission fee. Monday-Friday.

## ART GALLERIES

A calendar of current gallery shows appears in the "Arts" section of the Sunday *Kansas City Star*. Some of the art galleries in Kansas City are listed below. Call to check hours.

### ALTERNATIVE SPACE GALLERY

2016 Baltimore Ave., 474-1919 (Downtown)

### AMERICAN LEGACY GALLERY

5911 Main, 444-7944 (South of UMKC)

### CENTRAL PARK GALLERY

1644 Wyandotte, 471-7711 (Downtown)

### GARTH CLARK GALLERY

855 Rockwell Lane, 753-5299 (By appointment)

### FEDERAL RESERVE BANK FINE ARTS GALLERY

925 Grand, 881-2998 (Downtown)

### GALLERY V

5 Gregory Blvd., 523-4488 (South Kansas City)

### DORRY GATES GALLERY

523-4403 (By appointment only)

### SYBIL KAHN / PRIVATE STOCK GALLERY

236-4182 (By appointment only)

### KANSAS CITY ARTISTS COALITION GALLERY

1919 Wyandotte, 421-5222 (Downtown)

### CHARLOTTE CROSBY KEMPER GALLERY

Kansas City Art Institute  
4415 Warwick, 561-4852

### LEEDY-VOULKOS GALLERY

1919 Wyandotte, 474-1919 (Downtown)

### MORGAN GALLERY

Scarrit Arcade Building, 819 Walnut, 556-9446 (Downtown)

### SOCIETY FOR CONTEMPORARY PHOTOGRAPHY

218 Delaware, 471-2115 (Downtown)

### UMKC GALLERY OF ART

Fine Arts Building, 51st & Holmes, 235-1502 (UMKC)

### JAN WEINER GALLERY

931-8755 (By appointment only)

---

## ENTERTAINMENT

---

**General Information:** Visitor Information Hotline, service of Convention & Visitors Bureau, 474-9600. To charge tickets by phone, 931-3330, for TICKETMASTER. (See 1st section in Yellow Pages for seating area diagrams of theaters.)

---

### RADIO AND TELEVISION

Radio stations include: KCUR-FM (89.3), National Public Radio from the University of Missouri-Kansas City, broadcasts current affairs, jazz, and American Public Radio programs. KANU-FM (91.5), NPR from the University of Kansas (Lawrence), jazz programming; and KCPT-19, Kansas City's PBS public television station.

---

### CLASSICAL MUSIC

#### *March 8 (Friday)*

Kansas City Symphony, "Exploring the World of Sergei Prokofiev," 7 p.m., Scottish Rite Temple. (471-0400)

Malcom Bilson, Mozart, Fortepiano, Friends of Chamber Music series, 8 p.m., Folly Theater. (444-4429)

Kansas City Jazz Band Festival; 7:30 p.m., White Recital Hall, UMKC. (235-2700)

#### *March 9 (Saturday)*

Carla Edwards, organ recital; 8 p.m., RLDS auditorium, Independence. (833-1000 x434)

Kansas City Jazz Band Festival; 7:30 p.m., White Recital Hall, UMKC. (235-2700)

#### *March 10 (Sunday)*

Kansas City Civic Orchestra, Jack Ergo conducting; 7:30 p.m., White Recital Hall, 50th & Cherry, UMKC. (363-6212)

Malcom Bilson, Mozart, Fortepiano, Friends of Chamber Music series, 8 p.m., Folly Theater. (444-4429)

#### *March 11 (Monday)*

Misericord with Paul Turner, organ; 8 p.m., Cathedral of Immaculate Conception, 11st St. & Broadway. (931-1030)

---

### THEATER

**AMERICAN HEARTLAND THEATRE,**  
in Crown Center

2450 Grand, 842-9999 (Crown Center)

**Death Trap,** Ira Levin's classic mystery thriller opens March 12.

**MISSOURI REPERTORY THEATRE,**  
Helen Spencer Theatre

50th & Cherry, 235-7000 (UMKC)

Shakespeare's **Richard III** opens March 12.

**STAGE TWO,** in Westin Crown Center  
Hotel lobby

842-9999 (Crown Center)

**Shear Madness** continues its long run in KC.

**TIFFANY'S ATTIC** (dinner playhouse)  
5128 Main, 561-7529 (Plaza)

**Beau Geste,** which opened February 14,  
continues its run.

---

## ENTERTAINMENT

---

### CLUBS: BLUES, JAZZ, ROCK

Good places to check for listings are *The View & the PITCH*. Call the Jazz Hotline, 931-2888, for the latest information. For live music, we recommend:

#### **THE GRAND EMPORIUM**

3832 Main, 531-1504 (Westport)

**Best KC Blues club (plus BBQ!).**

#### **MILTON'S**

805 West 39th, 753-9476 (Westport)

**Classic Jazz club.**

#### **BLAYNEY'S**

415 Westport Rd., 561-3747 (Westport)

**Rock and roll.**

#### **ENGLISH'S**

1101 Walnut, Courtyard Level, 221-8870  
(Downtown)

**Home of The Downtown Blues.**

#### **GUITARS AND CADILLACS**

3954 Central, 756-2221 (Westport)

**Country and Western.**

#### **KIKI'S BON TON MAISON**

1515 Westport Rd., 931-9417 (Westport)

**BonTon Soul Accordion Band** performs  
Wednesdays and Fridays.

#### **THE LEVEE**

16 West 43rd, 753-2821 (Between Plaza &  
Westport)

**Jazz and Blues.**

---

## PLACES OF INTEREST

---

For your own exploring on the Plaza, visit the Plaza Merchants Association office, 4625 Wornall Rd, 753-0100, for a copy of brochures.

### **BOARD OF TRADE**

4800 Main, 3rd Flr., 753-7500 (Plaza)

Interested in winter wheat futures? This is where they are traded. Visitors' gallery. Public art piece of realistic western sculpture out front presents an interesting view.

### **THOMAS HART BENTON HOME & STUDIO**

3616 Belleview, 931-5722 (Valentine)

**Restored home and studio of the late artist is a state historical site. Admission. Monday-Saturday.**

### **HALLMARK VISITORS CENTER**

in Crown Center complex, entrance at Gillham & 25th, 274-5672

**Exhibits present the story of Hallmark Cards. Fun for kids of all ages.**

### **BLOCH CANCER SURVIVORS PARK**

corner of 47th & Madison (Plaza)

**Newest Plaza public art complex, donated by Richard and Annette Bloch to commemorate the struggles of cancer survivors, caused artistic controversy when it opened.**

### **BRUCE R. WATKINS CULTURAL HERITAGE CENTER**

3600 Blue Parkway (at 47th), 923-6226

**Located east of the Plaza, the center bears the name of a well-respected long-time city councilman. Changing exhibits (Josephine Baker, March 3-7) and cultural meeting center honor the contributions of Afro-Americans in Kansas City.**

Located outside of Kansas City proper, these sites are worth noting.

**SHAWNEE INDIAN METHODIST MISSION**

3403 W. 53rd (53rd & Mission Rd), Fairway, KS, (913) 262-0867

Car needed to visit this site, which includes early Mission school established in 1839 by Rev. Thomas Johnson and was a stopping off point on the Santa Fe Trail. Free. Tuesday-Sunday.

**MORMON VISITORS' CENTER**

937 West Walnut, Independence, MO, 836-3466 (Independence)

Historic displays about Mormons in early Missouri. Open daily. Free. Guided tours available.

**NATIONAL FRONTIER TRAILS CENTER**

318 West Pacific, Independence, MO, 836-7111 (Independence)

Permanent and hanging exhibits focus on the settlement of the American West, with special emphasis on the Santa Fe, California, and Oregon trails during the first half of the 19th century.

**JOHNSON COUNTY COMMUNITY COLLEGE, CULTURAL EDUCATIONAL CENTER**

12345 College Blvd. at Quivira Rd., KS, (913) 469-8500

The newest cultural center in the KC area, featuring several performing and fine arts facilities, including an art gallery. Bill Cosby opened the center in January 1991.

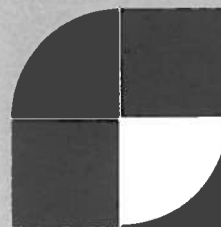

560 Harrison Avenue, Boston, MA 02118  
tel: (617) 357-5212 / telex: 95 1075  
telefax: (617) 338-5763 / cable: Ars Libri, BSN

*ars libri, ltd.*

**RARE AND OUT-OF-PRINT  
SCHOLARLY BOOKS IN  
THE FINE ARTS**

Ars Libri maintains the largest and most comprehensive stock in the United States of rare and scholarly art-reference books and periodicals. We issue catalogues regularly and provide quotations upon request. We welcome want lists.

We are always interested in purchasing libraries and important individual books in the fine arts.

Currently available:

- |                             |                                     |
|-----------------------------|-------------------------------------|
| <i>Catalogue 81:</i>        | Ancient and Classical Art           |
| <i>Catalogue 80:</i>        | American Art                        |
| <i>Special Bulletin 70:</i> | Art History in Festschriften        |
| <i>Special Bulletin 69:</i> | Russian and Eastern<br>European Art |
| <i>Special Bulletin 68:</i> | Castles, Villas, Cottages           |
| <i>Special Bulletin 67:</i> | Modern Art                          |

# BODMER'S AMERICA



KARL BODMER'S ILLUSTRATIONS  
TO PRINCE MAXIMILIAN  
OF WIED-NEUWIED'S TRAVELS  
IN THE INTERIOR OF  
NORTH AMERICA 1832-1834



A new edition from the original plates  
published by  
Alecto Historical Editions, London,  
in association with the  
Joslyn Art Museum, Omaha, Nebraska.

CONTACT GREG FOX (402) 341 1162  
Joslyn Art Museum, 2200 Dodge Street, Omaha, Nebraska 68102

## *Interactive Videodisc Collections*



Visit over 200 museums and art collections – without leaving your chair. This is what our interactive information systems offer – and more. In addition to providing access to thousands of paintings (and details of these paintings) on videodisc, a knowledge base of iconographic information and commentary is at your fingertips.

The power of our system lies in the DOCENT™ developed for working with the images we provide. DOCENT offers the ability to search for particular images; to browse (if you don't exactly know what you look for). It is also an authoring system. With the *Notebook*, you can annotate images, prepare lectures and classes, and write articles. In some

cases you can dictate your comments and hear them as loudly and clearly as you spoke them.

If you already use videodiscs, or intend to create one, and are interested in having a DOCENT to maximize your effort, Belser's MetaDOCENT™ is for you. It will generate a DOCENT for your particular needs. DOCENT and MetaDOCENT work on almost every computer operating system: Macintosh (with or without Hypercard), MS-DOS (with or without Windows 3.0), and UNIX.

Currently available videodiscs include: *German Renaissance Painters*, *Paintings of the 19th Century*; *Dutch Baroque Painting*, and *Codex Vat. lat. 39-New Testament* (from the 13th century).



BELSER  
KNOWLEDGE  
SERVICES

SPRING RIZZOLI 1991  
NEW YORK

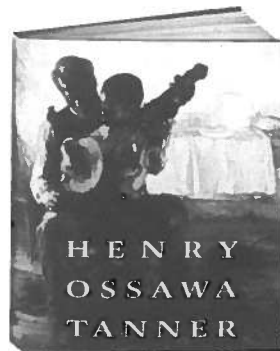
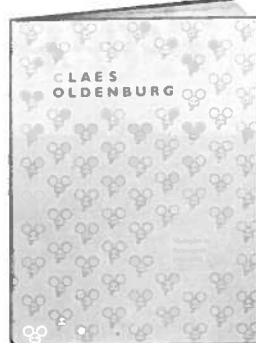
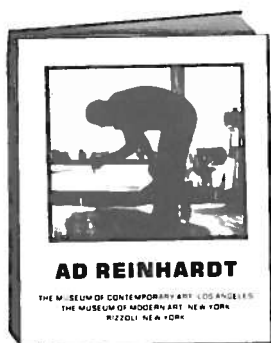

**AD REINHARDT**

Yve-Alain Bois. Published in conjunction with a comprehensive exhibition at MOMA in New York, this volume is the first major monograph on this pioneering American abstract painter (1913-1967) since the 1960's. Includes previously unpublished writings by the artist. 192 pages. 9" x 12". 120 illus., 95 in color. 1336-3. \$45

**CLAES OLDENBURG: MULTIPLES IN RETROSPECT 1964-1990**

Thomas Lawson. Catalogue raisonné of Oldenburg's multiple editions of small sculptures, presented here for the first time, with production histories written by the artist for each multiple. An invaluable sourcebook for collectors and students. 160 pages. 9" x 12". 142 illus., 94 in color. 1335-5. \$60

**THE LANDSCAPE IN TWENTIETH-CENTURY AMERICAN ART**

Introduction by Robert Rosenblum. Presents sixty landscapes by modern and contemporary American masters from the permanent collection of the Metropolitan Museum, including works by Benton, Homer, O'Keeffe, and Fairfield Porter. Published in conjunction with a traveling exhibition organized by the American Federation of the Arts. 176 pages. 9" x 10". 85 illus., 70 in color. 1303-7. \$45

**HENRY OSSAWA TANNER**

Darel Sewell, et al. The first monograph on this late nineteenth-century expatriate African-American artist, who studied with Eakins in Pennsylvania before moving permanently to France in 1891. Accompanies the first major retrospective of Tanner's work, organized by the Philadelphia Museum of Art and to travel nationally. 308 pages. 9" x 12". 150 illus., 97 in color. 1346-0. \$50

**TYPOLOGIES:**

**NINE CONTEMPORARY PHOTOGRAPHERS**

Marc Friedus, et al. Featured is the work of nine photographers who create suites of images on single motifs or types with an almost scientific eye. Includes the work of Bernd and Becher, Ed Ruscha, and Thomas Ruff, among others. 128 pages. 9" x 12". 80 illustrations. 1362-2. \$35

**BREAKTHROUGHS**

Essays by Dore Ashton, Lucy Lippard, Carter Ratcliff, et al. An extraordinary survey of avant-garde art—from music and dance, to painting, performance, film and video—in Europe and America from the 1950's to the present. Includes essays by major writers and artists of the time, as well as interviews with today's leading artists and film and video makers. 352 pages. 10" x 13". 274 illus., 124 in color. pb: 1365-7. \$45

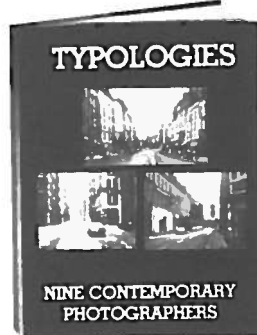
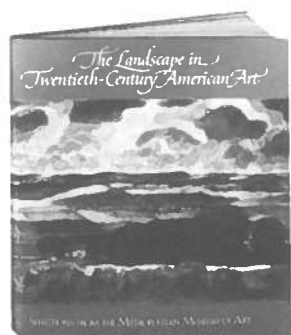

**Rizzoli International Publications**

300 Park Avenue South/New York, NY 10010/ISBN Prefix: 0-8478  
Toll free 1-800-433-1238 or in NY: 212-387-3400

**THE KNOEDLER LIBRARY  
ON  
MICROFICHE**

American and International Auctions, Exhibitions, Salons.  
Brochure available upon request

*"I find this material indispensable in the search for lost works or the tracking of provenances. It should be part of every major research or reference collection in the arts."*

Lorenz Eitner

**THE KNOEDLER LIBRARY**

19 East 70th Street, New York, N. Y. 10021

Tel. 212-794-0567

Fax 212-570-6616

*Art Resource Will Produce Slide Booklets of Your  
Collections for Sale in Museum Shops, Bookstores and  
Gift Catalogues*

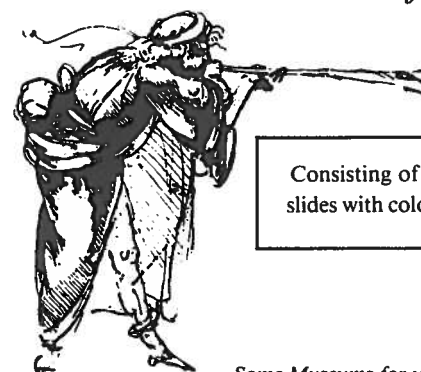

Consisting of 6, 12, 18, 36 or more  
slides with color cover and text pages



65 Bleecker St.  
New York, N.Y. 10012  
212-505-8700

*Some Museums for which slide booklets have been made:*

Detroit Institute of Arts, Isabella Stewart Gardner Museum, Jewish Museum of New York, Museum of Fine Arts, Houston, Metropolitan Museum of Art, Louvre, Prado, Uffizi, Vatican Museums

F·A·BERNETT·INC



Rare & Scholarly Books  
on the

◆  
FINE & DECORATIVE ARTS  
ARCHITECTURE  
ARCHAEOLOGY  
◆



2001 Palmer Avenue  
Larchmont N.Y. 10538

Tel. 914 834-3026

CATALOGUES ON REQUEST



THE ART SERVICES COMPUTER NETWORK

— introduces —

**AUCTION TRAK**

**WHAT:** *AUCTION TRAK*, a division of artTRAK, Inc., is a database compiler and search program that is designed to provide easy access to catalogs produced by the auction houses. This system is not meant to either take the place of the auction catalog or meant to judge academically the information provided by the auction houses. *AUCTION TRAK* is a system that will permit you to utilize auction information more efficiently. Whether the user is looking for pricing information, qualitative comparisons, or how many objects a particular collector has sold at auction, the system always leads you back to the auction catalog for in-depth analysis. For the cursory search *AUCTION TRAK can not be surpassed for speed.*

**HOW:** *AUCTION TRAK*, will provide information in 13 key fields all of which can be searched in a sub-string search for key words. The tribal art database includes the important sales and objects in the major auction houses in London, Paris, New York, Boston, and San Francisco. Several minor houses have been included from other cities. The database encompasses sales from 1980 to 1990 with selected important sales prior to this also included. This period will feature over 40,000 objects with approximately 4000 objects added annually.

**WHO:** The database system will be sold to non-profit organizations **only**. The sale will conform to the restrictions of the licensing agreement and the annual update agreement. The system may **not** be sold, transferred, or given away to any third party.

**PRICE:** The price for the first ninety days from the date of completion will be \$2000. After the ninety day period the price will be \$3000. Annual updates of the catalog information will be \$500 and will start with the calendar year 1991. Contracts will be renewed on a five-year basis with the renewal fee due June 30th of each year. The prices quoted above also include the transfer of information, the operation manual, and system support.

MORE DETAILED INFORMATION WILL BE PROVIDED ON REQUEST.

artTRAK

John Buxton

2916 McKinney Ave. • Dallas, Texas 75204  
FAX 214-969-1851

214-871-3100



## NEW FROM GARLAND

### LOUIS SULLIVAN

An Illustrated Catalogue from the Collection in the Art Institute of Chicago  
Edited by Sarah G. Mollman with a Preface by John Zukowsky

"An important contribution to scholarship on Sullivan and its more than 300 drawings and photographs provide the best visual documentation available on Sullivan's archival collections."  
—Choice

300 pages 300 illustrations and photographs 9x12 07032-1 \$180

### THE WALTER GROPIUS ARCHIVE

Volumes 1, 2, 3: The Collection of the Busch-Reisinger Museum  
Edited by Winfried Nerdinger

Volume 4: The Work of the Architects Collaborative  
Introduction by James Marston Fitch

"The masterly editing, introduction and commentaries by Winfried Nerdinger make this edition indispensable for studies of the buildings and projects by Gropius and his 'team'."  
—Richard Pommer, Institute of Fine Arts, New York University

4-volume set: \$1,235. The 9 x 12 volumes are also available separately.

### GOthic SCULPTURE IN AMERICAN COLLECTIONS

Volume I: The New England Museums  
Edited by Dorothy Gillerman, The Census of Gothic Sculpture in America

"A remarkable survey." —American Reference Books Annual

"Essential for research libraries." —Choice

434 pages 8 1/2 x 11 illustrated 08462-4 \$99

### THE ARTHURIAN REVIVAL IN VICTORIAN ART

Debra N. Mancoff

"Most appropriate for research libraries." —Choice

482 pages 8 1/2 x 11 101 plates, 8 in full color 07040-2 \$81

### HONORÉ DAUMIER

A Thematic Guide to the Oeuvre  
Louis Provost, Edited with an Introduction by Elizabeth C. Childs

"The book that for the first time makes it possible to study systematically all the subjects treated in Daumier's art."  
—Theodore Reff, Columbia University

300 pages 8 1/2 x 11 09302-X \$125

Visit the Garland Booth for your free Art & Architecture catalog.

## GARLAND PUBLISHING

136 Madison Avenue, New York, NY 10016 Call: 1-800-627-6273

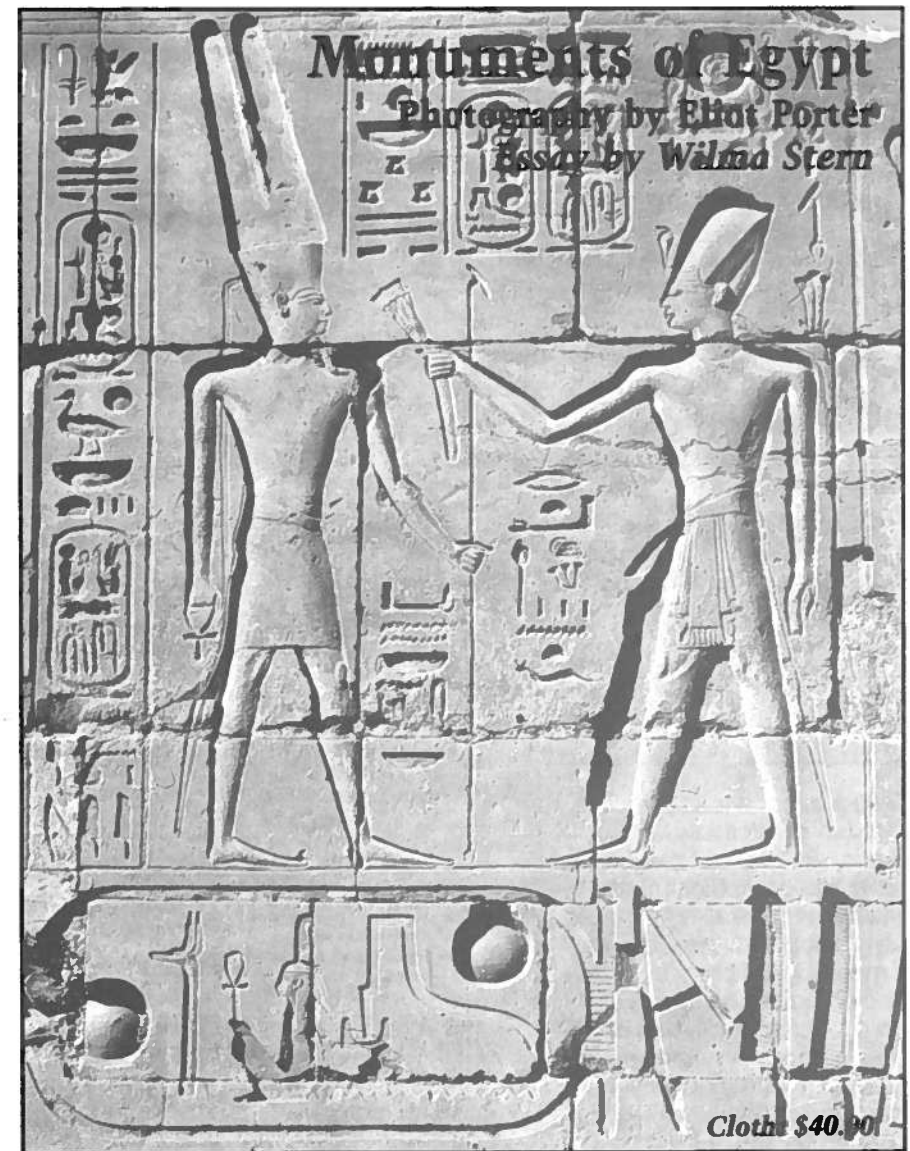

Eliot Porter

See our Eliot Porter books and other related titles at our booth.

At bookstores, or call (505) 277-4810  
FAX 1-800-622-8667

UNIVERSITY OF NEW MEXICO PRESS  
ALBUQUERQUE, NM 87131-1591



PERIODICALS  
PERIODICALS  
PERIODICALS

ALL SUBJECTS  
U.S. & FOREIGN  
BOUGHT & SOLD

RICK BARANDES  
41 N. MOORE STREET  
NEW YORK, N.Y. 10013  
(212) 941-0826

The most experienced supplier  
of Italian publications to  
libraries throughout the world.  
Monthly bibliographical cards  
for all new books.  
Highly selective blanket orders  
to meet every library's  
special requirements.  
Standing orders for series and  
multi-volume monographs.  
Subscription to periodicals with  
direct, centralized mailing.  
Searching for out-of-print  
material.  
Library binding.

**Casalini**  
**libri**

50014 Fiesole (FI), Italy  
Tel. (39-55) 599.941  
Fax (39-55) 598.895

**If you  
missed  
the  
exhibit**

Bauhaus  
Constructivism  
De Kooning  
Dine  
Duchamp  
Hockney  
Johns  
Matisse  
Monet  
Pop Art  
Rauschenberg  
Rothko  
Stella  
Warhol  
& others

Exhibition Catalogues  
of Painting, Sculpture  
& Graphics on  
20th Century Artists.  
Current & Out-of-print.

Send for our inventory catalogue. Mail \$1.00 to:

**ART CATALOGUES**

625 North Almont Drive  
Los Angeles, California 90069  
213 274 0160, Toll Free 1 800 955 2787  
FAX 213 274 5823

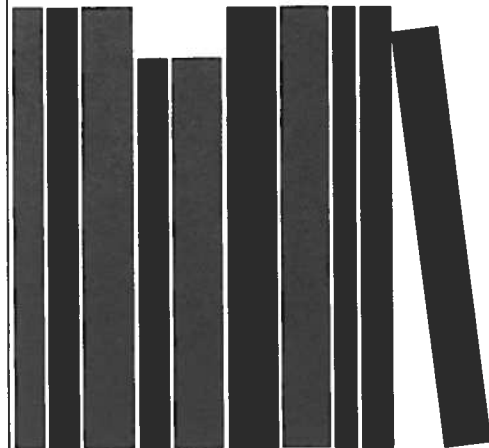

---

FROM THE GETTY ART HISTORY  
INFORMATION PROGRAM

---

For courses in methodology or  
historiography...

OBJECT·IMAGE·INQUIRY THE ART HISTORIAN AT WORK

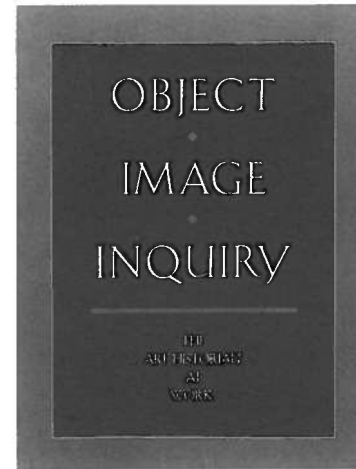

a collaborative study by THE GETTY ART  
HISTORY INFORMATION PROGRAM and THE  
INSTITUTE FOR RESEARCH IN INFORMATION  
AND SCHOLARSHIP, Brown University

"This analysis will rank with Turpin  
Bannister's *The Architect at Mid-Century* as  
a permanent contribution to historiography."  
Dora P. Crouch, *Journal of the Society of  
Architectural Historians*

U.S. \$12.95; \$16.95 postpaid  
California residents \$17.82 postpaid,  
sales tax included

The J. Paul Getty Book Distribution Center  
P.O. Box 2112  
Santa Monica, CA 90407-2112  
Telephone (213) 453-5352  
Fax (213) 453-7966

8½ x 11 inches, 200 pages,  
31 black-and-white illustrations  
Third printing  
ISBN 0-80236-135-2, paper

*An international survey of  
automated projects in the history  
of art and related fields.*

The Scuola Normale Superiore, Pisa, Italy, and The Getty Art History  
Information Program, Santa Monica, California.

**SN/G:**

REPORT ON DATA  
PROCESSING  
PROJECTS IN ART

Two volumes  
(*Projects and Indexes*)

To order, send 60,000  
Italian lire postpaid to:

SN/G Report  
SCUOLA NORMALE SUPERIORE  
Piazza dei Cavalieri, 7  
56100 Pisa, Italy  
Telephone: 39-50-597111  
Fax: 39-50-563513

# artibus et historiae

an art anthology

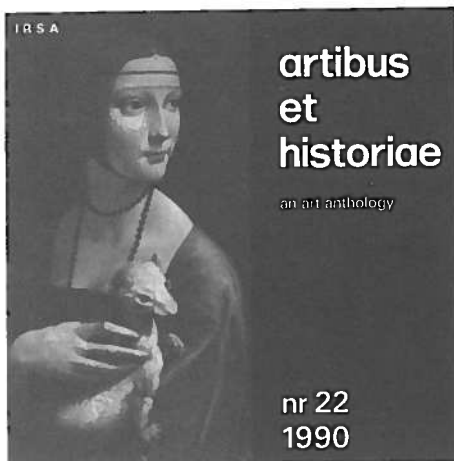

Founded 1980 and appearing every six months, this journal publishes articles on art history research which, by encompassing classical as well as modern, sometimes unconventional approaches on different subjects, provide an overall survey of contemporary art history and its current trends.

Laminated hardback, 200 pages, b/w and color ills., 260 x 240 mm  
Articles in English, French, Italian or German. Each article summarized in English, French, and German.

Annual subscription US\$ 120.—  
(2 issues)  
Single copy US\$ 65.—

## BIBLIOTHECA ARTIBUS ET HISTORIAE

Currently available

**JAN BIALOSTOCKI**  
**The Message of Images**  
Studies in the History of Art  
ISBN 3-900731-08-X  
US\$ 120.—

**CREIGHTON E. GILBERT**  
**L'arte del Quattrocento**  
Nelle testimonianze coeve  
ISBN 3-900731-09-8  
US\$ 50.—

**RACHEL WISCHNITZER**  
**From Dura to Rembrandt**  
Studies in the History of Art  
ISBN 3-900731-16-0  
US\$ 45.—

**SEYMOUR HOWARD** **Antiquity Restored** Essays on the Afterlife of the Antique  
Preface by *Ernst H. Gombrich* ISBN 3-900731-11-X US\$ 120.—

Forthcoming 1991

**MOSHE BARASCH**  
**Imago Hominis**  
Studies in the Language of Art  
ISBN 3-900731-17-9

**PHILIPP P. FEHL**  
**Decorum and Wit: The Poetry of Venetian Painting**  
Essays in the History of the Classical Tradition  
ISBN 3-900731-10-1

**PATRIK REUTERSWÄRD**  
**The Visible and Invisible in Art**  
Studies in the History of Art  
ISBN 3-900731-18-7

## ART EXHIBITION CATALOGUES

### OPUS SACRUM

Richly illustrated scholarly catalogue of the exhibition, at the Royal Castle in Warsaw (April to September 1990), of religious works of art from the Barbara Piasecka Johnson Collection. Introduction by *Sir John Pope-Hennessy*. 330 pp., 100 color and 78 b/w ills., cloth  
ISBN 3-900731-29-2 US\$ 50.—

## IRSA Verlag



Rüdengasse 6, A-1030 Vienna, AUSTRIA. Phone: 0222/7130136 Fax: 0222/7130130

## When you have:

Art objects  
Slides/photos/films/tapes  
Rare books/manuscripts  
Library materials  
Membership information



## you must:

Catalog/describe  
Lend/exhibit  
Query/search/find  
Display images  
Generate reports

## You need **STAR**

That's because STAR was designed expressly to handle text databases and related management processes. . . adapting to *your* collection and *your* way of working.

Wordprocessing systems and general-purpose DBMS's can't do it. Neither can inflexible, "do-it-our-way" systems. With STAR, you'll be up and running fast. . . confident that it will adapt easily to any new requirements.

You'll also be in good company, with the Program for Art on Film, Museum of American Folk Art, Museum of Modern Art, the Royal Armouries (Tower of London). . . and many other STAR users that are enjoying the benefits of successful automation.

Call us at 1-800-366-1390 for information or a demonstration. You'll find that STAR is the right way for you, too.

**Cuadra**  
**STAR**

*The right tool for text management*

Cuadra Associates, Inc., 11835 W. Olympic Blvd., Suite 855, Los Angeles, CA 90064

Tel: (213) 478-0066 & (800) 366-1390 • Fax: (213) 477-1078

New York Sales Office: (212) 984-0743 • Washington, D.C. Sales Office: (202) 463-2107

BOOKS FROM SPAIN AND MEXICO

**puvill**  
LIBROS S. A.

EXPERIENCED BOOK DEALER  
AND SUBSCRIPTION AGENT

SUPPLIER OF:

ART BOOKS, ART JOURNALS  
AND EXHIBITION CATALOGUES,  
FROM SPAIN AND MEXICO

FOR ORDER AND INFORMATION, CONTACT OFFICES IN:

**SPAIN:** 10 BOTERS ST., 08002 BARCELONA, SPAIN  
TEL. (01134-3) 318 29 86 FAX (01134-3) 412 31 40

**MEXICO:** PUVILL MEXICO DIVISION  
EMPRESA 109, COL. MIXCOAC  
MEXICO CITY 03910 MEXICO  
TEL (011525) 6111513

**USA:** PUVILL LIBROS, c/o D. FAUST  
264 DERROM AVE., PATERSON, N.J. 07504  
TEL: (201) 279-9054 FAX: (201) 278-1448

# AUCTIONS AT SWANN

*Monday, April 15*

Morning Session

## THE CIVIL WAR

IMPORTANT PHOTOGRAPHS  
MANUSCRIPTS • DIARIES • BROADSIDES



Half-plate daguerreotype of David Dixon Porter, circa 1845  
With six cartes-de-visite of Admiral Porter  
taken during the Civil War

Afternoon Session

*19th & 20th Century*

## PHOTOGRAPHS

ALBUMS • BOOKS  
DAGUERREOTYPES  
VINTAGE MASTER PRINTS

*Illustrated Catalogue \$30*

For information, please call Daile Kaplan,  
Director of Photographs at (212) 254-4710.



Irving Penn, *Portrait of Picasso*, silver print, 1960.



Salvador Dali, one of six aquatints from *Conquest of Cosmos II*, 1974,  
which sold at Swann on December 6, 1990 for a record \$26,400.

*Thursday, June 6*

## WORKS OF ART ON PAPER

*16th to 20th Century*  
PRINTS • DRAWINGS • WATERCOLORS

*Illustrated Catalogue \$20*

For information, please call  
Martin Barooshian at (212) 254-4710.

Swann Galleries is the oldest and largest US auctioneer of Rare Books, Autographs & Manuscripts,  
Photographs, and Works of Art on Paper. We conduct 35 sales each year.  
To receive our newsletter and catalogues, and to discuss consignments to future auctions,  
please call Swann at (212) 254-4710.

**SWANN GALLERIES**  
104 East 25 Street, New York, N.Y. 10010 ■ (212) 254-4710

# NOTES