

ART LIBRARIES SOCIETY OF NORTH AMERICA

CONFERENCE PROGRAM

15TH ANNUAL CONFERENCE
HERATON DALLAS HOTEL & TOWERS
DALLAS, TEXAS
FEBRUARY 4 - 11, 1988

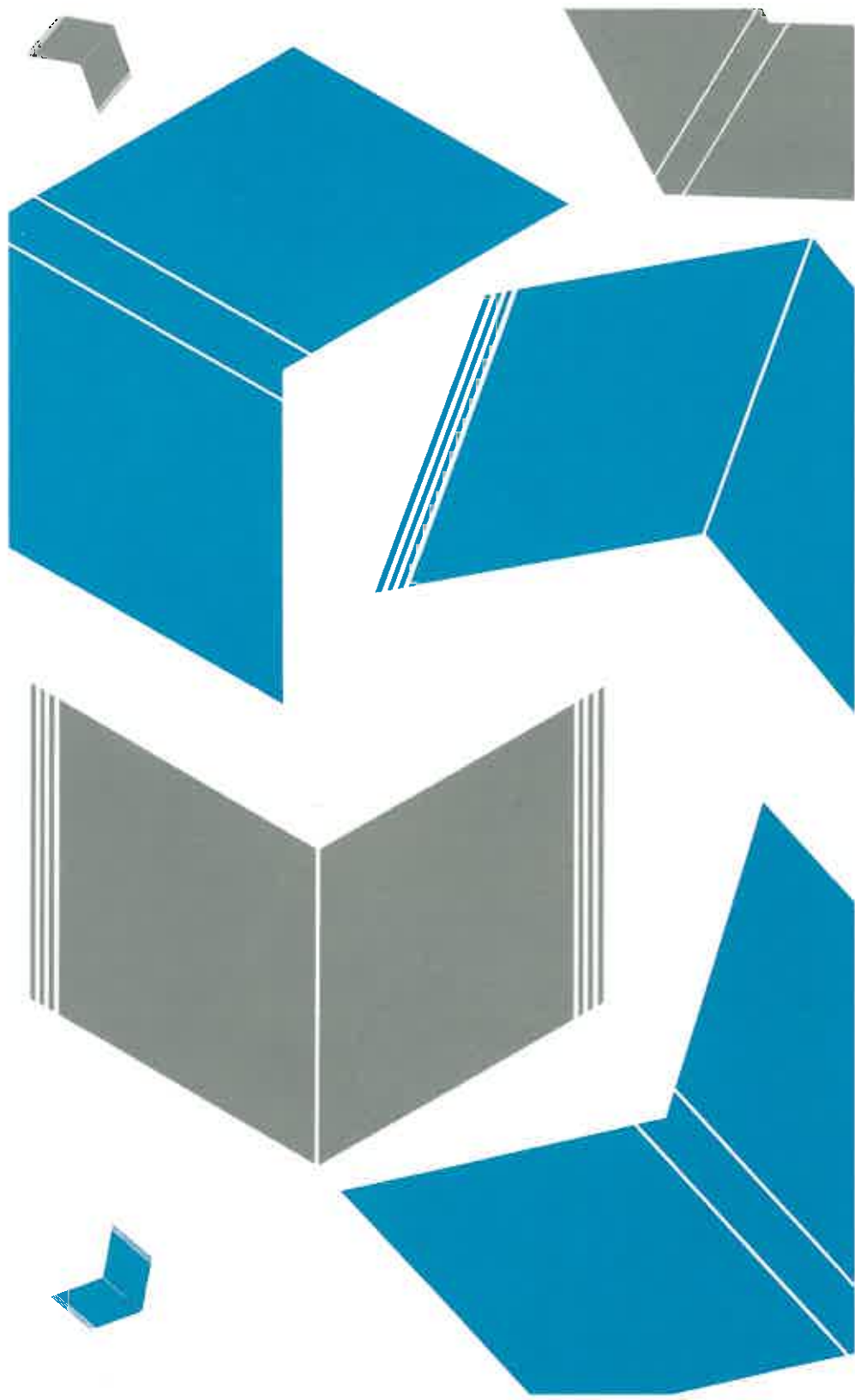



ART LIBRARIES SOCIETY OF NORTH AMERICA

CONFERENCE PROGRAM

16TH ANNUAL CONFERENCE
SHERATON DALLAS HOTEL & TOWERS
DALLAS, TEXAS
FEBRUARY 4 - 11, 1988

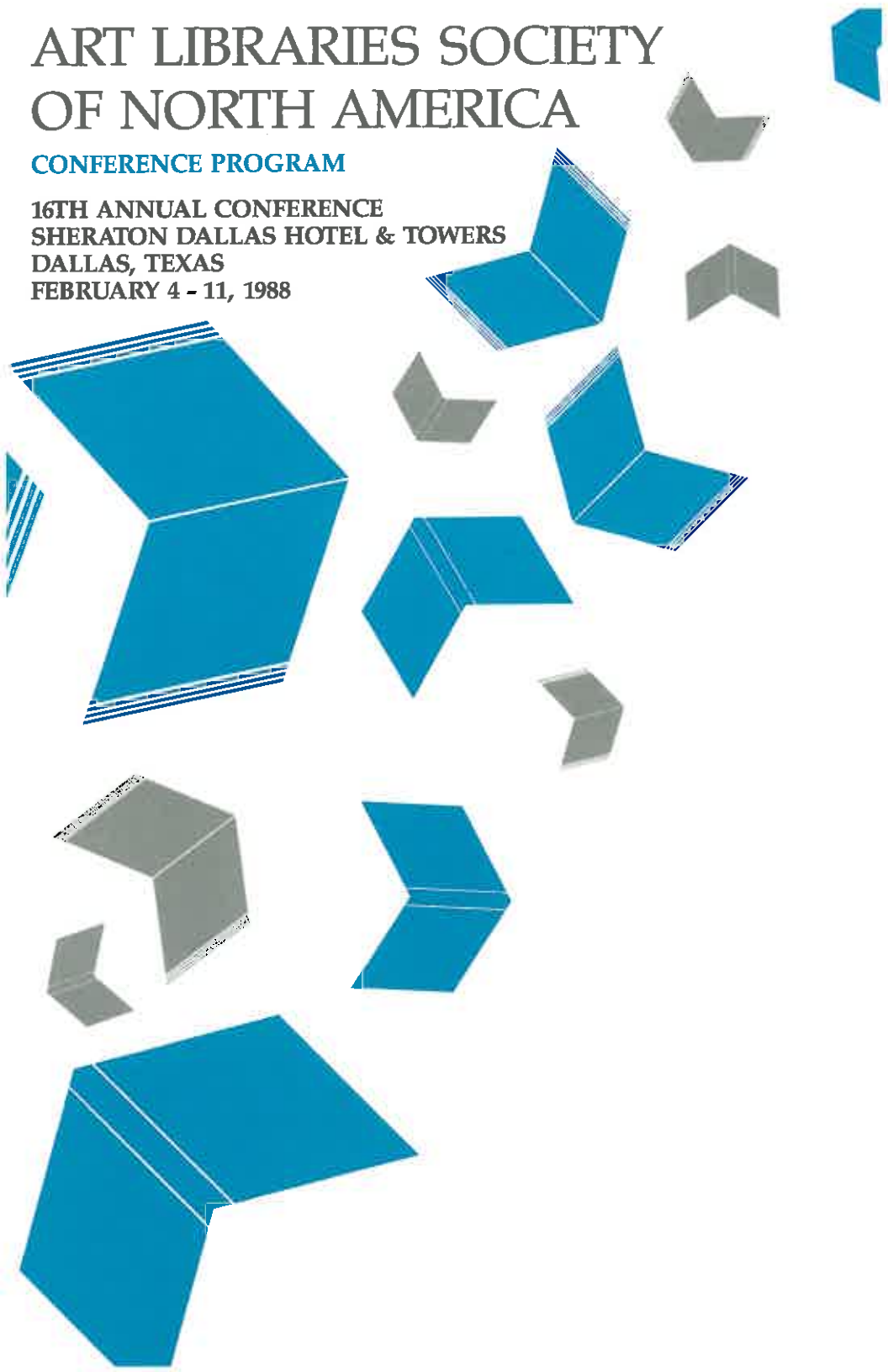

SPONSORS



ARLIS/NA and the Conference Chairs would gratefully like to acknowledge the support of the following firms and institutions who have contributed to the realization of the 16th Annual Conference in Dallas/Fort Worth.

Amon Carter Museum
Ars Libri
The Dictionary of Art

In-Kind Contributions:

American Airlines
American Institute of Architects, Dallas
Chapter
American Wine and Distribution
Dallas Museum of Art
Dallas Public Library
Tom Dawson, Kimbell Art Museum
Frito-Lay
INFOMART
Kimbell Art Museum
Museum of Fine Arts, Houston
Neiman-Marcus
K.G. Saur
Trammell Crow Company

Copyright 1988, ARLIS/NA
Art Libraries Society of North America
3900 E. Timrod St.
Tucson, AZ 85711
(602) 881-8479

Graphic Design by Kevin Osborn,
Research & Design Associates,
with assistance from Tom Dawson, Kimbell
Art Museum, Fort Worth



Sponsors2

Acknowledgments4

Exhibitors5

Welcome6

General Information7

Sheraton Dallas Hotel & Towers10

Ongoing Activities and Services12

Conference Program13

 Thursday, February 413

 Friday, February 514

 Saturday, February 615

 Sunday, February 718

 Monday, February 821

 Tuesday, February 924

 Wednesday, February 1031

 Thursday, February 1133

ARLIS/NA EXECUTIVE BOARD, 1987

- President: Jeffrey Horrell, Syracuse University
- Vice-President/President-Elect: Ann Abid, Cleveland Museum of Art
- Secretary: Helene Roberts, Fogg Art Museum, Harvard University
- Treasurer: William Dane, Newark Public Library
- Past President: Susan Craig, University of Kansas
- Regional Representatives:
- East: Paula Baxter, New York Public Library
- Midwest: Nadene Byrne, School of the Art Institute of Chicago
- West: Sheila Klos, University of Oregon
- Canada: Daphne Dufresne, Université du Québec à Montreal
- Executive Director: Pamela J. Parry



**1988 ARLIS/NA CONFERENCE
COMMITTEE**

Milan R. Hughston, Amon Carter Museum
Conference Co-Chair,

Local Arrangements & Publications

Lois S. Jones, North Texas State University
Conference Co-Chair, Program

Jeannette Downing, Kimbell Art Museum
Exhibits & Tours

Jane Holahan, Dallas Public Library
Guide to Dallas

Mary Lampe, Amon Carter Museum
Audio-Visual Equipment

Amy Schaffner, Dallas Museum of Art
Transportation & Convocation

Chia-Chun Shih, Kimbell Art Museum
Registration

OTHER PLANNING COORDINATORS

Robert Beebe, Houston Public Library
Hospitality Suite

Johnnye Cope, North Texas State University
Abstracts

Margaret Culbertson, University of Houston
Computer Demonstrations

Jon Held, Dallas Public Library
Tours

Marcia Lowry
15th Anniversary Reception

Kay Krochman Marks, Southern Methodist
University
Architectural Tours

Gregory P.J. Most, Museum of Fine Arts,
Houston

ARLIS/CAA Joint Session

Pat Oestricher, Kimbell Art Museum
Tours

Valeria Pinkney, North Texas State University
Publicity

Linda Shearouse, Museum of Fine Arts,
Houston

Assistant to the Co-Chairs

Tom Sime, Dallas Public Library
Guide to Dallas

Nancy Wynne, Amon Carter Museum
Publications and Registration

EXHIBITORS

ABC-CLIO
A·B·I Books
Amon Carter Museum
Archival Facsimiles
Ars Libri
Art Resource, Inc./Scala Fine Arts
Arthur H. Minters, Inc. Booksellers
Association of American University Presses
Califia
Casalini Libri
Centro Di
Chadwyck-Healey, Inc.
Conference Book Service, Inc.
Cuadra Associates, Inc.
The Dictionary of Art/Macmillan Publishers
Emmett Publishing Ltd.
F. A. Bennett, Inc.
Garland Publishing, Inc.
G. K. Hall & Company
Granary Books, Inc.
Gregg Publishing Company, Ltd.
Heaton-Sessions
Howard Karno Books
Hudson Hills Press
The H. W. Wilson Company
J. M. Cohen, Rare Books
John Benjamins North American, Inc.
K. G. Saur, Inc.
Kimbell Art Museum
Librairie Lecointre D.-Ozanne D.
Librairie Leonce Laget
Licosa, Libreria Commissionaria Sansoni, SPA
M. Knoedler & Company, Inc.
Norman Ross Publishing, Inc.
The Oryx Press
Otto Harrassowitz
Puvill Libros S. A.
Rizzoli International Publications
Santa Fe Bookseller
Saskia Ltd.
Speedimpex USA, Inc.

University of Michigan Slide Distribution
Project
Visual Resources Association
Vloemans Antiquarian Books
Worldwide Books



Everything in Texas is supposedly bigger and better than in the rest of the United States. The members of ARLIS/Texas may not be able to substantiate this claim, but we do know that our welcome is Texas-size.

We have rolled out the red carpet to provide continuing educational opportunities as well as entertainment. For the former, there are numerous tours: a half-day visit to the fabulous INFOMART where the latest computer technology will be discussed for both beginning and advanced-level ARLIS members, a number of architectural tours, and visits to the Print and Textile Study Room at the Dallas Museum of Art. The membership luncheon is scheduled for Monday, since all area museums are closed on the first day of the week. The convocation will be held at the Dallas Museum of Art, during which all the galleries will be open for viewing. Sunday is the last day for *Power and Gold: Jewelry from Indonesia, Malaysia, and the Philippines* as well as *Woven to Honor: the Steven G. Alpert Collection of Indonesian Textiles*. Other exhibitions include *Concentrations 17: Vernon Fisher and Frank Lloyd Wright: In the Realm of Ideas*.

At 12:30 p.m. on Wednesday, we are moving the conference to Fort Worth to enjoy Philip Johnson's Water Gardens and the three outstanding museums: Amon Carter Museum, Kimbell Art Museum, and Modern Art Museum of Fort Worth. Exhibitions include *Francis W. Edmonds: American Master in the Dutch Tradition*, *Berthe Morisot—Impressionist*, and *Donald Sultan*. Also on view are some recent acquisitions you have been reading about: the Kimbell's Caravaggio, *Cardsharps*, and the Amon Carter's Harnett, *After the Hunt*.

Highlights of the Texas-style entertainment include the opportunity to experience a classic western rodeo, dinner at the world-famous Mexican restaurant Joe T. Garcia's, and Billy Bob's Texas, billed as the "World's Largest Honky-Tonk." ARLIS/NA members are also encouraged to celebrate the 15th anniversary of ARLIS at a fund-raising cocktail party on Saturday night.

The Texas chapter carefully read the comments which were penned on last year's conference evaluation forms. We have tried to have only two programs per session, with only one night session. In order to provide space for the numerous meetings and small sessions, Tuesday morning was chosen as a time when six special interest roundtables and discussion groups could be scheduled. Although the ARLIS/NA membership provided the stimulating and provocative programs, the Texas chapter has initiated and sponsored "Hidden Treasures: Prints in the Art Library," a program which it is hoped will draw attention to these important art works.

The local members have worked for more than a year to make this conference a success. Hopefully, the weather will show you how delightful Dallas and Fort Worth can be in February. But regardless of the meteorologist's predictions, just come to the hospitality suite and talk to the area members, and you will learn what a truly Texas Welcome can be. We're sure glad y'all could come down!

Lois Swan Jones

Milan R. Hughston

Co-Chairs, 1988 ARLIS/NA Conference

Jeannette Downing,

President, ARLIS/Texas

GENERAL INFORMATION



ON-SITE REGISTRATION

For those unable to pre-register, on-site registration will begin Friday, February 5th at 6:30 p.m. A charge will be added for late registration (received by mail after December 18th or on-site).

GUEST POLICY

If you plan to bring a guest, please observe the following ARLIS/NA policy:

Guests of conferees are encouraged to register for the full conference. Unregistered guests will be permitted to join tours and special events on a space-available basis after all registered conferees have been accommodated.

REFUNDS

Requests for refund of registration fees must be received in writing at ARLIS/NA, 3900 E. Timrod Street, Tucson, Arizona 85711, no later than January 22, 1988. A \$5.00 processing fee will be deducted. No on-site refunds will be made. If events for which you have paid are filled by the time your registration form is received and no substitutes are available, you will be notified and refunds will be sent to you by mail.

TRANSPORTATION

Local transportation information can be found in *A Guide to Dallas*, part of this booklet.

TOURS AND WORKSHOPS

Registration and/or payment of a fee is required for all tours and workshops. Waiting lists and remaining tickets are administered at the Registration Desk. Chartered buses will leave from the Olive Street entrance of the Sheraton Dallas Hotel. *Times indicated are departure times--please plan to arrive at least fifteen minutes early for boarding buses.*

GUIDEBOOKS

This conference program also contains *A Guide to Dallas*, edited by Jane Holahan and Tom Sime. ARLIS/NA members are encouraged to use it as a guide to the multifaceted aspects of Dallas and the fine eating opportunities which await--if you have time!

SMOKING POLICY

Smoking is not permitted in sessions unless voted otherwise by the majority of the participants of each session just prior to the beginning of that meeting.

REGISTRATION/ INFORMATION DESK

The hours for the Registration Desk (located on the hotel's mezzanine level) are listed in the Ongoing Activities Schedule. You should pick up your registration packet as soon as possible after your arrival at the hotel. Bulletin boards will be provided for personal and professional messages. Members of the Registration Desk staff will answer conference questions and supply information about Dallas/Fort Worth in general. The desk will also serve as a center for the purchase of conference abstracts. Cash or checks will be accepted but not credit cards.



THE HOTEL

The Sheraton Dallas Hotel & Towers is a recently renovated hotel which has been a part of downtown Dallas for almost years. Located in the east end of downtown at 400 N. Olive Street, the hotel is a part of the Southland Center office complex. The hotel is just two blocks south of the downtown cultural district, which includes the Dallas Museum of Art and the new I.M. Pei-designed symphony hall (under construction). In addition to the Sheraton's outstanding conference facilities and guest rooms, there are two restaurants: Cafe Verde, which serves breakfast, lunch, and dinner, plus Olive Street, which offers lunch and a happy hour. The Gallery Bar, located on the mezzanine level, will offer conferees a spacious area to relax. Since much of downtown Dallas is linked by a network of glass-enclosed walkways above street level, conferees also have the 35 shops and restaurants of the nearby Plaza of the Americas hotel/office complex at their disposal. Checkout time is 1 p.m. The Sheraton Dallas' telephone number is (214) 922-8000. The hotel can be addressed at 400 N. Olive Street, Dallas, TX 75201-4007.

EXHIBITS

The exhibits will open on Monday morning, February 8, with a complimentary continental breakfast from 8:30 a.m.-9:30 a.m. Hours for the exhibit hall are listed in the Ongoing Activities Schedule. Exhibitors include publishers, book dealers, and visual resource suppliers. Please visit the exhibits often, since exhibitors rely on your input and patronage. The exhibits provide an excellent opportunity to view a wide range of new products and services. The exhibits are also a vital source of income to the Society, so your attendance is important in making the exhibits a success.

HOSPITALITY SUITE

An ARLIS/NA hospitality suite will be operating during the conference. Hours are listed in the Ongoing Activities Schedule and will be posted at the Registration Desk. Wine, beer, and soft drinks will be available at the cash bar staffed by ARLIS/NA volunteers.



NEW MEMBERS AND FIRST-TIME ATTENDEES

Registrants attending their first ARLIS/NA conference will wear special identifying badges. In order for these members to learn more about the Society, there will be an Orientation Get Together on Saturday afternoon, February 6, from 4:30 p.m. - 5:30 p.m. Its purpose is not only for new members to get acquainted but also to learn about ARLIS/NA and how they can participate in its different activities. Other conferees are also welcome to attend. On Monday, February 8, from 7:00 p.m. to 10:00 p.m., new members and first-time attendees will be honored at a special reception for all conferees at the LTV Center, a striking post-modern office tower near the conference hotel. The reception is made possible by Ars Libri Ltd., whose generosity to ARLIS/NA has provided many special occasions. The exhibition pavilion at the LTV Center will house a major exhibition of drawings from the Frank Lloyd Wright archives in Arizona. Conferees will be able to view the exhibition during the reception.

ART EXHIBITIONS

The winter 1987 issue of *Art Documentation* will include descriptions of museum collections in Texas. In addition to the permanent collections described, conferees can look forward to the following exhibitions during their visit to Dallas/Fort Worth:

Dallas Museum of Art

Power and Gold: Jewelry from Indonesia, Malaysia, and the Philippines (ends Sunday, February 7); *Woven to Honor: the Steven G. Alpert Collection of Indonesian Textiles*; *Concentrations 17: Vernon Fisher*; and *Frank Lloyd Wright: In the Realm of Ideas*

Amon Carter Museum, Fort Worth

Francis W. Edmonds: American Master in the Dutch Tradition

Modern Art Museum of Fort Worth

Donald Sultan

Kimbell Art Museum, Fort Worth

Berthe Morisot--Impressionist

SHERATON DALLAS HOTEL & TOWERS

MEETING ROOM FLOORPLANS

The Hospitality Suite is the Texas Suite, 4th floor

MEZZANINE LEVEL

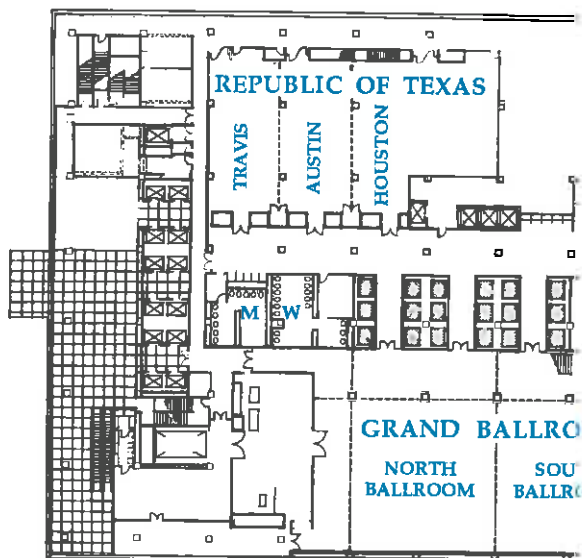

3rd FLOOR

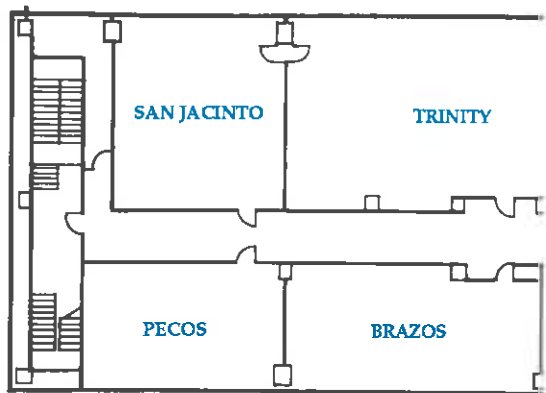

4th & 5th FLOOR

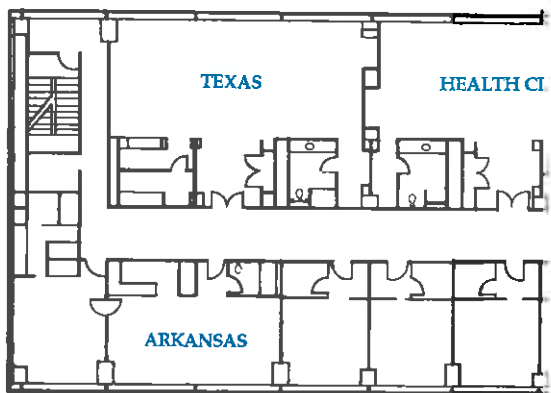

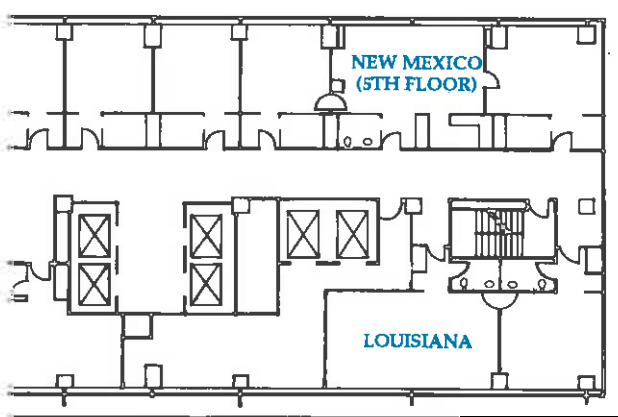
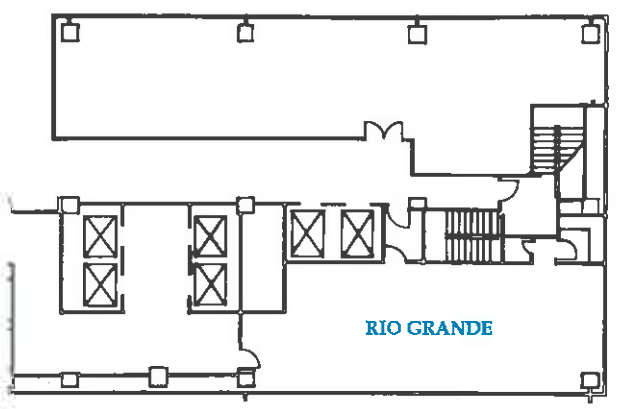
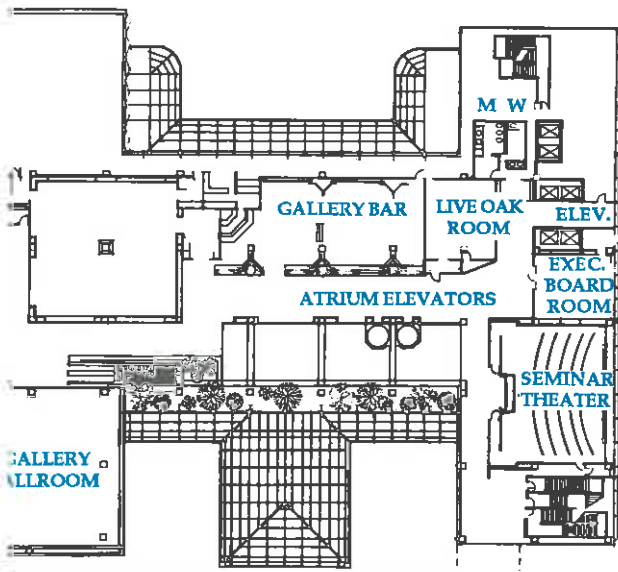

ONGOING ACTIVITIES AND SERVICES



MEZZANINE



REGISTRATION/INFORMATION DESK

Friday, February 5	6:30 p.m.-8:30 p.m.
Saturday, February 6	8:00 a.m.-12 Noon 3:00 p.m.-8:00 p.m.
Sunday, February 7	8:00 a.m.-5:30 p.m.
Monday, February 8	8:00 a.m.-12:30 p.m. 4:00 p.m.-6:00 p.m.
Tuesday, February 9	8:00 a.m.-12:30 p.m. 4:00 p.m.-6:00 p.m.
Wednesday, February 10	8:00 a.m.-12:30 p.m.

TEXAS

HOSPITALITY SUITE

Friday, February 5	8:00 p.m.-11:00 p.m.
Saturday, February 6	8:00 p.m.-11:00 p.m.
Sunday, February 7	9:30 p.m.-11:30 p.m.
Monday, February 8	10:00 p.m.-11:30 p.m.
Tuesday, February 9	9:30 p.m.-11:30 p.m.

REPUBLIC OF TEXAS

EXHIBIT HOURS

Monday, February 8	8:30 a.m.-12:30 p.m. 4:00 p.m.-6:00 p.m.
Tuesday, February 9	8:30 a.m.-12:30 p.m. 5:00 p.m.-7:00 p.m.

THURSDAY
FEBRUARY 4



ARLIS/NA CONFERENCE PROGRAM



7:00 p.m.-10:00 p.m.

ARLIS/NA EXECUTIVE BOARD MEETING

(open to membership on a seating-available basis)

BOARD ROOM



9:00 a.m.-5:00 p.m.

BOARD ROOM

ARLIS/NA EXECUTIVE BOARD MEETING

(open to membership on a seating-available basis)

9:00 a.m.-5:00 p.m.

**DIALOG INFORMATION SERVICES
SYSTEM SEMINAR**

(Held at INFOMART)

9:30 a.m.-4:00 p.m.

HOUSTON

COORDINATOR

**ART & ARCHITECTURE PROGRAM
COMMITTEE MEETING, RESEARCH
LIBRARIES GROUP (RLG)**

Nancy S. Allen, Head Librarian, Museum of Fine Arts, Boston
(for AAPC/RLG members only)

8:00 p.m.-10:00 p.m.

TRINITY

SPONSORS

SPEAKERS

**ONE-STOP SHOPPING: ACCESS TO VISUAL
AND ARCHIVAL MATERIALS— USE OF VIM
AND AMC MARC FORMATS**

Art & Architecture Program Committee/Research Libraries
Group

Nancy Sahli, Acting Director, Records Program, National
Historical Publications and Records Commission,
Washington;

Jim Bower, Technical Information Specialist, Vocabulary Co-
ordination Group, Getty Art History Information Program

Barbara C. Orbach, Cataloger, Prints and Photographs
Division, Library of Congress Center

(open to all conferees)

8:00 p.m.-11:00 p.m.

TEXAS

HOSPITALITY SUITE



TOURS AND WORKSHOPS

Registration and/or payment of a fee is required for all tours and workshops. Waiting lists and remaining tickets are administered at the Registration Desk. Chartered buses will leave from the Olive Street entrance of the Sheraton Dallas Hotel. *Times indicated are departure times--please plan to arrive at least fifteen minutes early for boarding buses.*

**8:30 a.m.-Noon;
1:30 p.m.-3:15 p.m.**

SEMINAR THEATER

COORDINATOR

**WORKSHOP I
SELF-STUDY PROCESS FOR ART LIBRARY
AND VISUAL RESOURCES COLLECTIONS II :
USE OF PERFORMANCE MEASURES**

Betty Jo Irvine, Head, Fine Arts Library, Indiana University

**8:30 a.m.-Noon;
1:30 p.m.-3:15 p.m.**

GALLERY BALLROOM

SPONSOR

COORDINATOR

**WORKSHOP II
PRESERVATION OPTIONS FOR ART
LIBRARIANS**

Amon Carter Museum and the Serials SIG
Carol S. Terry, Director of Library Services, Rhode Island
School of Design

**8:30 a.m.-Noon;
1:30 p.m.-3:15 p.m.**

TRINITY

SPONSOR

COORDINATOR

**WORKSHOP III
PLANNING THE SPACE NEEDS OF THE ART
LIBRARY**

Academic TOL
Beryl K. Smith, Art Librarian, Rutgers-The State University of
New Jersey

9:00 a.m.-3:30 p.m.

BOARD ROOM

ARLIS/NA EXECUTIVE BOARD MEETING
(open to membership on a seating-available basis)



9:00 a.m.-3:00 p.m.

**TOUR A
DEEP ELLUM**

Meet at Olive Street entrance at 8:45 a.m.

10:00 a.m.-3:00 p.m.

**TOUR C
ARCHITECTURE OF DALLAS: A BUS TOUR**

Meet at Olive Street entrance at 9:45 a.m.

1:00 p.m.-3:00 p.m.

**TOUR B-1
DOWNTOWN DALLAS WALKING TOUR**

Meet in Lobby at 12:45 p.m.

3:15 p.m.-4:30 p.m.

AD HOC GROUP MEETINGS

(open to all ARLIS/NA members)

Film and Video

Indigenous Arts and Cultures

Women and Art Documentation

Information Services

AUSTIN
HOUSTON
SOUTH BALLROOM
NORTH BALLROOM

3:15 p.m.-4:30 p.m.

COMMITTEE MEETINGS

Art Documentation/Update Advisory Board

Cataloging Advisory

International Relations

Membership

Nominating

Professional Development

Standards I (Space Needs) *(begins at 3:45 p.m.)*

Standards II (Staffing)

Wittenborn

TRAVIS
NEW MEXICO
SAN JACINTO
RIO GRANDE
LIVE OAK
PECOS
SEMINAR THEATER
BRAZOS
LOUISIANA

4:30 p.m.-5:30 p.m.

ORIENTATION GET - TOGETHER

For New Members and First-Time Attendees

TEXAS

5:30 p.m.-7:00 p.m.

FIFTEENTH ANNIVERSARY FUND RAISER

(Co-sponsored by The Dictionary of Art & ARLIS/NA)

GALLERY BAR

7:00 p.m.-Midnight

**TOUR D
RODEO IN FORT WORTH**

**SATURDAY
FEBRUARY 6**

ARLIS/NA CONFERENCE PROGRAM



8:00 p.m.-11:00 p.m.

HOSPITALITY SUITE

TEXAS



9:00 a.m.-9:50 a.m.

RIO GRANDE
PECOS
SEMINAR THEATER
BRAZOS

TOL (TYPE OF LIBRARY) MEETINGS

Academic
Art and Design School
Museum
Public

10:00 a.m.-12 Noon

GALLERY BALLROOM

SESSION 1

MEETING THE CHALLENGE OF PATRONS' NEEDS IN ART LIBRARIES AND VISUAL RESOURCES COLLECTIONS

SPONSOR Information Services Ad Hoc Group
MODERATOR Caroline Backlund, Head of Reader Services, National Gallery of Art
SPEAKERS Helene Roberts, Curator of Visual Collections, Fine Arts Library, Harvard University,
"Do You Have Any Pictures of...?": Subject Access to Visual Collections and Book Reproductions
Jack Robertson, Fine Arts Librarian, University of Virginia,
New Reference Sources in American Art: Do They Meet the Standards and Current Reference Needs?
Marshall Lapidus, Associate Editor, RILA,
The Challenging Merger of a French and English Language Abstracting Service: RILA and Répertoire d'Art et Archéologie
Maurice G. Fortin, Head of General Reference, North Texas State University Libraries,
Non-Art Bibliographic Databases: Are They Under-Utilized Resources in the Art Library?
Susan Godlewski, Associate Director, Ryerson & Burnham Libraries, Art Institute of Chicago,
Is the Art Library Meeting the Growing Information Needs of its Patrons and, If So, How?

10:00 a.m.-12 Noon

TRINITY

SPONSOR
MODERATOR
SPEAKERS

SESSION 2

CATALOGING ARTISTS' BOOKS

CISSIG
Nancy Norris, Assistant Librarian, University Research Library, University of California at Los Angeles
Fred A. Hillbruner, Assistant Director, Head of Technical Services, School of the Art Institute of Chicago,
Multi-faceted Access to the SAIC Artists' Book Collection
Matthew Hogan, Curator, Franklin Furnace Archive,
Artists' Books in the Franklin Furnace Archive

SUNDAY FEBRUARY 7



ARLIS/NA CONFERENCE PROGRAM



Daniel Starr, Associate Librarian, Cataloging, Museum of Modern Art,
Cataloging Artists' Books--So What's the Problem?

12 Noon-1:30 p.m.

PECOS
RIO GRANDE
ARKANSAS

MEETINGS

Canadian Members of ARLIS/NA
VRSIG Task Force
Development Committee

2:00 p.m.-4:00 p.m.

GALLERY BALLROOM

SPONSORS
MODERATOR
SPEAKERS

SESSION 3

HIDDEN TREASURES: PRINTS IN THE ART LIBRARY

Amon Carter Museum and the ARLIS/NA Texas Chapter
Katharine Martinez, Head of the Library, Winterthur Museum and Gardens
Georgia Barnhill, Curator of Graphic Arts, American Antiquarian Society,
Unappreciated Images in Books
Deirdre Lawrence, Chief Librarian, Brooklyn Museum,
Prints in Museum Libraries
William J. Dane, Supervisor, Art & Music Department, Newark Public Library,
Prints in Public Libraries

2:00 p.m.-4:00 p.m.

TRINITY

SPONSOR
MODERATOR
SPEAKERS ON OPTIONS

SESSION 4

INDEXING AND SEARCH STRATEGY USING AAT: THREE OPTIONS

RESPONDENTS FOR
RETRIEVAL IMPLICATIONS

AAT Advisory Committee
Nancy S. Allen, Head Librarian, Museum of Fine Arts, Boston
Amy Lucker, AVIADOR Project, Avery Architectural and Fine Arts Library, Columbia University;
Bethany Mendenhall, Head of Technical Services, Getty Center Library;
Murray Waddington, Associate Librarian, Canadian Centre for Architecture
James Anderson, Associate Dean, School of Communication, Library & Information Services, Rutgers University;
Pat Molholt, Associate Director of Libraries, Rensselaer Polytechnic Institute

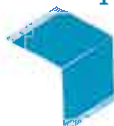

4:15 p.m.-5:30 p.m.

SEMINAR THEATER
GALLERY BALLROOM
TRINITY
NEW MEXICO
SOUTH BALLROOM

SIG (SPECIAL INTEREST GROUP) MEETINGS

Architecture
CISSIG (Cataloging and Indexing Systems)
Computer
Serials
VRSIG (Visual Resources)

4:15 p.m.-5:30 p.m.

TEXAS
LOUISIANA

**SERIALS SWAP I
SLIDE EXCHANGE I**

6:00 p.m.-9:00 p.m.

SPEAKER

CONVOCATION AND RECEPTION

Dallas Museum of Art

Decherd Turner, Director, Harry Ransom Humanities Research Center, The University of Texas at Austin

Note: Allow fifteen minutes to walk from the Sheraton Dallas Hotel to the Dallas Museum of Art. When the guards close the Museum at 5:00 p.m., ARLIS/NA members will be allowed to stay in the DMA Library until the galleries are re-opened -- a process which takes about 15 minutes. ARLIS/NA members will then be allowed to return to the galleries, which will remain open throughout the convocation and reception. In addition to the permanent collection, conferees may view these exhibitions: *Power and Gold: Jewelry from Indonesia, Malaysia, and the Philippines*; *Woven to Honor: the Steven G. Alpert Collection of Indonesian Textiles*; *Concentration 17: Vernon Fisher*; and *Frank Lloyd Wright: In the Realm of Ideas*.

9:30 p.m.-11:30 p.m.

TEXAS

HOSPITALITY SUITE

MONDAY
FEBRUARY 8

ARLIS/NA CONFERENCE PROGRAM



8:30 a.m.-9:30 a.m.

REPUBLIC OF TEXAS

8:30 a.m.-12:30 p.m.

REPUBLIC OF TEXAS

10:00 a.m.-12 Noon

SOUTH BALLROOM

**EXHIBITS OPENING:
CONTINENTAL BREAKFAST**

EXHIBITS

SESSION 5

**THE EXHIBITION CATALOG: HISTORY,
CURATORSHIP, PUBLISHING, DISTRIBUTION,
AND CATALOGING**

- SPONSOR** Professional Development Committee
- MODERATOR** Ray Anne Lockard, Frick Fine Arts Library, University of Pittsburgh
- SPEAKERS** Katherine W. Haskins, Bibliographer of Art & Architecture, University of Chicago,
Idiom and Ideology: Aspects of the Art Exhibition Catalog in the 20th Century
- Linda Ayres, Curator of Painting and Sculpture, Amon Carter Museum,
The Exhibition Catalog from the Curatorial Point of View
- Ron Tyler, Director, Texas State Historical Association,
Museum Publishing: The Production Side
- Brian Gold, Director, Worldwide Books,
Distribution, Acquisition, and Cataloging (COBRA)

10:00 a.m.-12 Noon

SEMINAR THEATER

SESSION 6

**VISUAL RESOURCES COLLECTION MANAGE-
MENT: CATALOGING PROCEDURES AND
OTHER ISSUES FOR AUTOMATED SYSTEMS**

- SPONSOR** VRSIG
- MODERATOR** Mary Lampe, Audiovisual Coordinator, Amon Carter Museum
- SPEAKERS** Toni Petersen, Director, Art & Architecture Thesaurus,
Subject Control in Visual Collections
- Jeanne M. Keefe-Watkinson, Graphics Curator, School of Architecture, Rensselaer Polytechnic Institute,
The Rensselaer On-Line Cataloging System for Slides
- Joy Alexander, Curator of Slides & Photographs, History of Art Department, University of Michigan,
Automating Visual Resources Collections: Some Considerations
- Jo Schaffer, Curator, Art Department Slide Library, SUNY-Cortland,

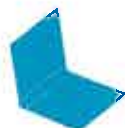

10:00 a.m.-12 Noon

RIO GRANDE

SPONSOR
MODERATOR
SPEAKERS

SESSION 7

COPING WITH COLLECTIBLES: FROM BASEBALL CARDS TO DEPRESSION GLASS

Public Library TOL

Linda Swieszkowski, Director, The Information Exchange of the Municipal Art Society, New York City

Dorothy Harris, Editorial Director, The House of Collectibles, *Development & Editorial Philosophy at the House of Collectibles*
Kathy Parker, Slide Librarian, Art Department, SUNY-Brockport, *Antique Valentines*

Andrea Segall, Librarian, Art & Music Department, San Francisco Public Library, *How I Learned to Stop Worrying and Start Loving Collectible Questions*

Elizabeth Blagbrough, American Society of Appraisers, *Appraising Collectibles*

12:30 p.m.-2:00 p.m.

NORTH BALLROOM

SPEAKER

MEMBERSHIP LUNCHEON

David Dillon, Architecture Critic, *The Dallas Morning News*, *Architecture Criticism: Does It Really Matter?*

2:00 p.m.-4:00 p.m.

NORTH BALLROOM

MEMBERSHIP MEETING

4:00 p.m.-5:30 p.m.

PECOS
RIO GRANDE
LOUISIANA
NEW MEXICO

COMMITTEE MEETINGS

Art & Architecture Thesaurus Advisory Publications
Muehsam Award
Travel Awards

4:00 p.m. - 6:30 p.m.

SAN JACINTO
BRAZOS

COMMITTEE MEETINGS

Standards I (Space Needs)
Standards II (Staffing)

**MONDAY
FEBRUARY 8**

ARLIS/NA CONFERENCE PROGRAM



5:30 p.m. - 6:30 p.m.

RIO GRANDE
BOARD ROOM
PECOS

COMMITTEE MEETINGS

Art Doc Book Reviewers and Potential Contributors
New SIG and TOL Moderators
Art & Architecture Thesaurus User Group

5:30 p.m.-6:30 p.m.

TEXAS
LOUISIANA

**SERIALS SWAP II
SLIDE EXCHANGE II**

7:00 p.m.-10:00 p.m.

BUFFET RECEPTION

In Honor of New Members and First Time Attendees, at the LTV Center, about a fifteen-minute walk from the Sheraton Dallas Hotel. Attendees will have a chance to view the exhibition of Frank Lloyd Wright drawings and models in the adjacent pavilion.

(Sponsored by Ars Libri)

10:00 p.m.-11:30 p.m.

TEXAS

HOSPITALITY SUITE

8:00 a.m. - 9:30 a.m.

NORTH BALLROOM

BREAKFAST MEETING

Executive Board and Chapter Officers

8:30 a.m.-12:30 p.m.

REPUBLIC OF TEXAS

EXHIBITS

9:30 a.m.-12:30 p.m.

SAN JACINTO

COMMITTEE MEETING

Standards I (Space Needs)

10:00 a.m.-12 Noon

RIO GRANDE

**SESSION 8
CATALOGING PROBLEMS
DISCUSSION GROUP**

CISSIG

D. Sherman Clarke, Associate Catalog Librarian, Cornell University

This usually lively discussion, which will cover all aspects of the subject, begins with a report by Anna Smislova, Art Subject Cataloger, Library of Congress. Ms. Smislova is the ARLIS/NA representative to ALA's Committee on Cataloging: Description and Access. Beginning and expert catalogers are welcome, as well as non-catalogers.

*SPONSOR
MODERATOR*

10:00 a.m.-12 Noon

DALLAS PUBLIC LIBRARY,
4TH FLOOR

**SESSION 9
ROUNDTABLE DISCUSSION AT DALLAS
PUBLIC LIBRARY**

Public Library TOL

Linda Swieszkowski, Director, The Information Exchange of the Municipal Art Society, New York.

Among the topics to be discussed are advancement at the public library, professional development, and library security

Meet in Lobby at 9:30 a.m. to walk to Dallas Public Library

*SPONSOR
MODERATOR*

10:00 a.m.-12 Noon

TRINITY

**SESSION 10
BIBLIOGRAPHIC INSTRUCTION FOR THE
VISUALLY LITERATE STUDENT**

Art & Design School TOL

Martha H. Hall, Head of Public Services, University of the Arts, Philadelphia

Barbara Polowy, Art and Photography Librarian, Rochester Institute of Technology,

Untraditional Sources for Design Students

*SPONSOR
MODERATOR*

SPEAKERS



Cristine C. Rom, Library Director, Cleveland Institute of Art,
and Elizabeth Lantz, Cataloger, Cleveland Museum of Art,
Embedding Library Instruction into the Studio Curriculum
Henry Pisciotta, Fine Arts Librarian, Carnegie Mellon
University,
The Degree Paper

10:00 a.m.-12 Noon

BRAZOS

SPONSOR
MODERATOR
SPEAKERS

SESSION 11

**CATALOGING FILM & VIDEO: FROM THE
SOPHISTICATED TO THE SIMPLE**

Film & Video Ad Hoc Group
Alison Pinsler, Academy of Motion Picture Arts & Sciences
Travis Jordan, Director, Media Services, Southern Methodist
University
Peggy Rudd, Film/Cable Librarian, North East Texas Library
System, Garland, Texas
Lee Atwell, Archivist, Southwest Film/Video Archives, Dallas

10:00 a.m.-12 Noon

DALLAS MUSEUM OF ART

SPONSOR
MODERATOR
SPEAKER

SESSION 12

**INDIGENOUS ART AT THE DALLAS MUSEUM
OF ART**

Indigenous Arts and Cultures Ad Hoc Group
Ross Day, Librarian, Robert Goldwater Library, Metropolitan
Museum of Art
Carol Robbins, Textile Curator, Dallas Museum of Art,
The Indigenous Textile Collection of the DMA
Meet in Lobby at 9:45 a.m. to walk to Dallas Museum of Art.

10:00 a.m.-12 Noon

GALLERY BALLROOM

SPONSOR
MODERATOR
SPEAKERS

SESSION 13

**RESOURCES ON WOMEN ARTISTS: SOME
PROBLEMS OF RESEARCH**

Women and Art Documentation Ad Hoc Group
Janis Ekdahl, Assistant Director of the Library, Museum of
Modern Art
Edith L. Crowe, Associate Librarian, San Jose State University,
Problems of Art Research Outside the Mainstream
Jennifer Hehman, Slide Librarian, Herron School of Art &
Design,
Locating Slides of Works by Women Artists & Architects
Ferris Olin, Executive Officer, Institute for Research on
Women, Douglass College,
*On the Trail of Women Artists: Researching the Coming
Exhibition, "Making Their Mark, A Documentary Survey of
Women Artists, 1970-1985"*



NOTE: Registration sign-up sheets for the individual sessions will be posted near the Registration Desk Sunday afternoon. Please make a note of which sessions you register for. Check the abstracts and sign-up sheets to confirm room numbers and capacities.

Buses between the Sheraton Dallas Hotel and INFOMART will run continuously from 11:30 a.m. to 5:00 p.m.

1:00 p.m. - 1:50 p.m.

Capturing the Collection: GRAPHICpro
(Corporate Information Group, Suite 4039)

Introduction to Electronic Publishing
(CPT Corp., Suite 3027)

PC and Printer Solutions
(Epson America, Suite 2029)

DataTimes: A World of Information
(DataTimes, Suite 3043)

Linking Personal Computers to Share Information
(Novell, Suite 3018)

Digitized Video Applications for the Personal
Computer
(AT&T & Image Sets, Suite 2058)

ARLIS/NA Members Computer
Demonstrations (Room 7012)
(Fadell, Pisciotta)

Showroom and INFOMART Presentations
(Kodak & Building Tour: Meet at Resource Center)

Desktop Publishing
(IBM, Suite 3034)

2:00 p.m. - 2:50 p.m.

Capturing the Collection: GRAPHICpro
(Corporate Information Group, Suite 4039)

Total Text Search
(CPT Corp., Suite 3027)

Going Online: Picking the Right System for You
(The Library at INFOMART, Suite 3008)

DataTimes: A World of Information
(DataTimes, Suite 3043)

Linking Personal Computers to Share Information
(Novell, Suite 3018)

Digitized Video Applications for the Personal
Computer
(AT&T & Image Sets, Suite 2058)

ARLIS/NA Members Computer
Demonstrations (Room 7012)
(Fadell, Pisciotta)

Showroom and INFOMART Presentations
(Xerox & Building Tour: Meet at Resource Center)

The IBM Infowindow System
(IBM, Suite 3034)

3:00 p.m. - 3:50 p.m.

The Ins & Outs of Pictorial Databases
(Corporate Information Group, Suite 4039)

Introduction to Electronic Publishing
(CPT Corp., Suite 3027)

PC and Printer Solutions
(Epson America, Suite 2029)

DataTimes: A World of Information
(DataTimes, Suite 3043)

Digitized Video Applications for the Personal
Computer
(AT&T & Image Sets, Suite 2058)

ARLIS/NA Members Computer
Demonstrations (Room 7012)
(Dinoff, Hillbruner)

Showroom and INFOMART Presentations
*(Minolta & Building Tour: Meet at Resource
Center)*

Desktop Publishing
(IBM, Suite 3034)

CD-ROM Now!
*(Digital Data Publishing Corp.,
EpoCenter, 5th floor)*

4:00 p.m. - 4:50 p.m.

The Ins & Outs of Pictorial Database
(Corporate Information Group, Suite 4039)

Going Online: Picking the Right System for You
(The Library at INFOMART, Suite 3008)

DataTimes: A World of Information
(DataTimes, Suite 3043)

Digitized Video Applications for the Personal
Computer
(AT&T & Image Sets, Suite 2058)

ARLIS/NA Members Computer
Demonstrations (Room 7012)
(Dinoff, Hillbruner)

Showroom and INFOMART Presentations
(Kodak & Building Tour: Meet at Resource Cen

The IBM Infowindow System
(IBM, Suite 3034)

CD-ROM Now!
*(Digital Data Publishing Corp., EpoCenter,
5th floor)*

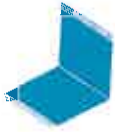

SESSION TITLE: Digitized Video Applications for the Personal Computer
SPONSOR: AT&T and Image Sets, Suite 2058
TIME: 1:00 p.m. ; 2:00 p.m.; 3:00 p.m.; 4:00 p.m.

ABSTRACT: An introduction to the AT&T Electronic Photography and Imaging Center (EPIC) and how its innovative imaging technology is opening new doors in computer graphics. We will present Truevision single slot expansion boards for the PC 6300 and compatibles that allow you to digitize, store and manipulate photographic quality images. The session will also include a demonstration of Truevision Image Processing Software video including database management, business presentations and video production.

SESSION TITLE: Introduction to Electronic Publishing

SPONSOR: CPT Corporation, Suite 3027

TIME: 1:00 p.m.; 3:00 p.m.

ABSTRACT: An overview of electronic publishing on CPT's full-page, easy to use DOS-based system. The seminar will be informational for someone who is not necessarily a graphics art professional, but is interested in the 'art' of doing their own publishing to produce books, newsletters, proposals, simple manuals and other documents. Scanners and laser printers will also be demonstrated.

SESSION TITLE: Total Text Search - Finding that Needle in Your Information Haystack

SPONSOR: CPT Corporation, Suite 3027

TIME: 2:00 p.m.

ABSTRACT: Do you ever find yourself searching through 'volumes' of information to find something? Does it take forever to pull all the pieces together? CPT will demonstrate a system that assists organizations with efficiently organizing and retrieving unstructured (papers, periodical indexes, memos, reports, notes) information. TTS is a tool that automates information gathering and compiling activities.

SESSION TITLE: Capturing the Collection--GRAPHICpro

SPONSOR: Corporate Information Group, Inc., Suite 4039

TIME: 1:00 p.m.; 2:00 p.m.

ABSTRACT: See a complete explanation and demonstration of a networked computer installation which allows for image capture, storage, retrieval and output. This system will allow the librarian to make the entire collection available to scholars for presentation and for output to publishing software and equipment.

SESSION TITLE: The Ins & Outs of Pictorial Databases--Merging the Image and Data for Optimum Usage

SPONSOR: Corporate Information Group, Inc., Suite 4039

TIME: 3:00 p.m.; 4:00 p.m.

ABSTRACT: This educational session will focus on the uses of high performance PC-based relational databases which allow for data plus pictures in each record. Downloading from larger systems, use for research and museum data/pictures and types of output all will be discussed.

SESSION TITLE: DataTimes: A World of Information

SPONSOR: DataTimes, Suite 3043

TIME: 1:00 p.m.; 2:00 p.m.; 3:00 p.m.; 4:00 p.m.

ABSTRACT: DataTimes provides full text computer access to regional, national, and international news sources -- including newspaper, newswire, magazine and financial databases. With DataTimes, research takes on a whole new perspective...and it takes the guesswork out of decision-making. This DataTimes session will include hands-on searching of the many databases available.

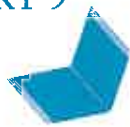

SESSION TITLE: CD-ROM Now!
SPONSOR: Digital Data Publishing Corporation, Epcenter, 5th floor
TIME: 3:00 p.m.; 4:00 p.m.

ABSTRACT: Learn from this experienced executive how his skeptical attitude was turned around when he realized the economic impact of CD-ROM. Listen to his cost and function comparison of CD-ROM with paper publishing, microforms, and online information subscriptions. Discover why he is convinced that now is the time to adopt this technology.

SESSION TITLE: PC and Printer Solutions
SPONSOR: Epson America, Suite 2029
TIME: 1:00 p.m.; 3:00 p.m.

ABSTRACT: A discussion of various printer technologies. Discover how recent developments in Epson products can help solve your system needs. Image scanning will also be discussed.

SESSION TITLE: Desktop Publishing
SPONSOR: IBM, Suite 3034
TIME: 1:00 p.m.; 3:00 p.m.

ABSTRACT: The IBM Personal Publishing System is a collection of hardware and software products that enables the user to produce near-typeset quality documents without recourse to outside typesetting, layout, or paste-up services. The demonstration will consist of the integration of text, graphics, and scanned images into a newsletter.

SESSION TITLE: The IBM Infowindow System

SPONSOR: IBM, Suite 3034
TIME: 2:00 p.m.; 4:00 p.m.

ABSTRACT: The IBM Infowindow System combines audio, video, computer graphics and text in a coordinated and interactive manner. Users may interact with the display and control the presentation sequence via a touch-sensitive screen or computer keyboard. The system is designed for use in applications addressing education and training, merchandising, and public access to information.

SESSION TITLE: Going Online: Picking the Right System for You

SPONSOR: The Library at INFOMART, Suite 3008

TIME: 2:00 p.m.; 4:00 p.m.

ABSTRACT: A session designed for the person who does not conduct his own online searches, but is planning to do so in the future. There will be a discussion on database selection, system selection, the option of choosing a gateway, and budgetary considerations.

SESSION TITLE: Linking Personal Computers to Share Information

SPONSOR: Novell, Inc., Suite 3018

TIME: 1:00 p.m.; 2:00 p.m.

ABSTRACT: Local area networks can link your computers together within one facility across towns or cities. Learn how Novell can provide a complete shared environment for your facility.

ARLIS/NA Members' Computer Demonstrations, Room 7012:

Beth Dinoff

Dallas Museum of Art Library

Database program for an auction catalog collection

John E. Fadell

University of Houston Libraries

The Information Machine, a menu-driven library and information and reference source

Fred Hillbruner

Library of the School of the Art Institute of Chicago

Database system for managing a collection of artists' books

Henry Pisciotta

Carnegie Mellon University Libraries

ARCHPICS, an online index to illustrations of twentieth century architecture

**TUESDAY
FEBRUARY 9**



ARLIS/NA CONFERENCE PROGRAM



2:45 p.m.-3:15 p.m.

**TOUR E-1
PRINT AND TEXTILE STUDY ROOM,
DALLAS MUSEUM OF ART**

Meet in Print and Textile Study Room at the Museum.

3:45 p.m.-4:15 p.m.

**TOUR E-2
PRINT AND TEXTILE STUDY ROOM,
DALLAS MUSEUM OF ART**

Meet in Print and Textile Study Room at the Museum.

5:00 p.m.-7:00 p.m.

REPUBLIC OF TEXAS

EXHIBITS CLOSING RECEPTION

(Sponsored by K. G. Saur)

7:00 p.m.-8:00 p.m.

NEW MEXICO

COMMITTEE MEETING

Cataloging Advisory Group

8:00 p.m.-10:00 p.m.

SAN JACINTO

COMMITTEE MEETING

Standards I (Space Needs)



8:00 p.m.-10:00 p.m.

GALLERY BALLROOM

- SPONSOR** Architecture SIG
- MODERATOR** Deborah A. Kempe, Indexer/Reference Librarian, Avery Library, Columbia University
- SPEAKERS** Mildred L. Schmertz, Editor, *Architectural Record*,
Editing an Architectural Periodical
Lawrence Speck, Professor of Architecture, The University of Texas at Austin,
Landmarks of Texas Architecture
Bruce Brooks Pfeiffer, Archivist, Frank Lloyd Wright Memorial Foundation, Taliesin West,
Exhibition Catalogue for Frank Lloyd Wright Exhibit
Scott A. Sullivan, Chairman, Art Department, North Texas State University,
The Notable and the Notorious: A Look at Dallas-Fort Worth Architecture in the 20th Century

SESSION 15

ARCHITECTURAL PUBLICATIONS: THE INSIDE STORY

8:00 p.m.-10:00 p.m.

TRINITY

- SPONSOR** VRSIG
- MODERATOR** Micheline Nilsen, Slide Librarian, University of Pennsylvania
- SPEAKERS** Carl Miller, Audio-Visual Librarian, The University of Texas, at Austin, *Technology of Electronic Imaging*
Micheline Nilsen, Slide Librarian, University of Pennsylvania,
Analog and Digital Projects
Maryly A. Snow, Librarian, Department of Architecture, Slide Library, University of California at Berkeley,
Building an Image Database Prototype on the UC-Berkeley Network
Mark Rorvig, Graduate School of Library & Information Science, The University of Texas at Austin,
Wordless Retrieval of Images from Large Collections

SESSION 16

VISUAL TECHNOLOGY AND SPECIAL PROJECTS

9:30 p.m.-11:30 p.m.

TEXAS

HOSPITALITY SUITE

WEDNESDAY
FEBRUARY 10



ARLIS/NA CONFERENCE PROGRAM

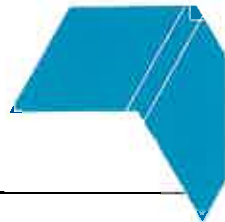

8:30 a.m.-1:30 p.m.

**TOUR F
FRITO-LAY COLLECTION/GALLERIA TOUR**

Meet at Olive St. entrance at 8:15 a.m.
Transportation underwritten by Frito-Lay.

9:00 a.m.-11:00 a.m.

**TOUR B-2
DOWNTOWN DALLAS WALKING TOUR**

9:00 a.m.-12 Noon

BOARD ROOM

ARLIS/NA EXECUTIVE BOARD MEETING

(open to membership on a seating-available basis)

9:30 a.m.-11:30 a.m.

GALLERY BALLROOM

**SESSION 17
ART & ILLUSION: PHOTOGRAPHIC ISSUES IN
PUBLISHING VISUAL ART**

CO-SPONSORS

MODERATOR

SPEAKERS

Visual Resources Association and ARLIS/NA
Eleanor Fink, Project Manager, Vocabulary Coordination
Group, Getty Art History Information Program
Harry Rand, Curator, Department of Painting and Sculpture,
National Museum of American Art, Smithsonian Institution,
Users Used and Abused
Eric Van Tassel, Fine Arts Editor, Princeton University Press,
Some Reactions from an Ex-Officio Philistine
Bert L. Long, Jr., Mixed-Media Artist, *The Role of the Artist
in Reproducing Works of Art*
Thomas Moon, Photographer, *The Original in Reproduction*

9:30 a.m.-11:30 a.m.

TRINITY

SPONSOR

MODERATORS

SPEAKERS

**SESSION 18
SPACE PLANNING FOR THE ART LIBRARIAN**

Museum TOL
Laurie Reese, Los Angeles Public Library, and Hollee Haswell,
Curator, Columbiana, Columbia University
Anne O. Morris, Head Librarian, Toledo Museum of Art,
*Can We Live Here 5 More Years?: What to Do When You Think
You've Done Everything Else*
Annette Masling, Librarian, Albright-Knox Art Gallery,
Spaced Out
Eleanor Hartman, Librarian, Los Angeles County Museum,
Living in Outer Space: Renovation in Progress



10:10 a.m.-10:40 a.m.

**TOUR E-3
PRINT AND TEXTILE STUDY ROOM,
DALLAS MUSEUM OF ART**
Meet in Print and Textile Study Room at the Museum.

11:10 a.m. - 11:40 a.m.

**TOUR E-4
PRINT AND TEXTILE STUDY ROOM,
DALLAS MUSEUM OF ART**
Meet in Print and Textile Study Room at the Museum.

12:30 p.m.-11:00 p.m.

**TOUR G-1 (FULL DAY) AND
TOUR G-2 (HALF DAY)
A VISIT TO FORT WORTH**

THURSDAY
FEBRUARY 11



9:00 a.m.-5:00 p.m.

BOARD ROOM

9:00 a.m.-12:30 p.m.

SEMINAR THEATER

4:45 p.m. - 7:00 p.m.

CO-SPONSORS

MODERATOR

SPEAKERS

ARLIS/NA CONFERENCE PROGRAM



ARLIS/NA EXECUTIVE BOARD MEETING

(open to membership on a seating-available basis)

**DIALOG INFORMATION SERVICES:
SEARCHING HUMANITIES AND SOCIAL
SCIENCES DATABASES**

**ARLIS/CAA JOINT SESSION, HOUSTON
ARTISTS' RIGHTS**

ARLIS/NA and CAA

Gregory P.J. Most, Slide Librarian, Museum of Fine Arts,
Houston

Richard Martin, Editor, *Arts Magazine*, and Executive Director
of Goodman Resource Center, Fashion Institute of
Technology,

*Re-Vision: Implications of Appropriation for Artists' Rights in the
1980s*

Marilyn L. Russell, Kansas City, Kansas, Public Library,
Censorship in the Arts

Monroe E. Price, Benjamin N. Cardozo School of Law, Yeshiva
University, New York,

Understanding Artists' Rights Laws

Nan Morris, Lawyer, Texas Accountants and Lawyers for the
Arts, Houston,

*The Kennedy Amendment and the Copyright Notice: 'Who Needs
It?' ... 'Who Cares?'*

560 Harrison Avenue, Boston, MA 02118
tel: (617) 357-5212 / telex: 95 1075
telefax: (617) 338-5763 / cable: Ars Libri, BSN



ars libri, ltd.

**RARE AND OUT-OF-PRINT
SCHOLARLY BOOKS IN
THE FINE ARTS**

Ars Libri maintains the largest and most comprehensive stock in the United States of rare and scholarly art-reference books and periodicals. We issue catalogues regularly and provide quotations upon request. We welcome want lists.

We are always interested in purchasing libraries and important individual books in the fine arts.

Currently available:

Catalogue 63: American Art

Catalogue 62: The Art of Germany, Austria
and Switzerland

Catalogue 61: Dutch and Flemish Art

Catalogue 60: British Art

Special Bulletin 56: The Art of Islam, Central
and Southern Asia

Special Bulletin 55: Ancient and Classical Art



Who would do such a thing?*

Consult **ABM**
(ARTbibliographies MODERN).

Coverage in **ARTbibliographies MODERN** has doubled to 12,000 citations per volume! Why would **ABC-CLIO** do such a thing? That's simple. **ARTbibliographies MODERN** is the only bibliography devoted exclusively to the coverage of modern and contemporary art. It provides detailed references to literature on all aspects of 20th-

Century art, including latest developments in the avant-garde, research on major figures and movements from the earlier years, and all types of decorative and applied art, with particular reference to photography, graphic-art, and three-dimensional design. Let us help you expand the horizon . . . or ascend a staircase.

Write for a free ARTbibliographies MODERN Prospectus:



ABC-CLIO

2040 A.P.S., Box 4397 • Santa Barbara, CA 93140-4397
In California call: 800-824-2103, outside CA: 800-422-2546

*Marcel Duchamp. (detail) L.H.O.O.Q. 1919.

Genuine Masterpieces



KATALOG DER GRAPHISCHEN PORTRÄTS IN DER HERZOG AUGUST BIBLIOTHEK WOLFENBÜTTEL 1500-1850

Reihe A: Porträtsammlung
PETER MORTZFELD and
the HERZOG AUGUST
BIBLIOTHEK
WOLFENBÜTTEL, Editors

The portrait collection of the Herzog August Library is one of the world's most important collections covering the seventeenth through the nineteenth centuries. The library's vast holdings feature European personalities of this period, with an emphasis on individuals from the German-speaking realm. The collection has been divided into two segments for publication — *Reihe (Series) A*: portrait engravings and *Reihe (Series) B*: portraits in books. *Series A* will ultimately include nearly 25,000 portrait engravings, indexed both by title and by "related subject" such as name and occupation of subject and artist's name.

1986-1987/3-598-31480-9
25 volumes; approx. 420
pages per volume; 9 index
volumes

4 volumes available.

Series A \$6,500*

INDEX OF ANCIENT ART AND ARCHITECTURE

Monuments of Greco-Roman Antiquity in the Photo Collection of the Deutschen Archäologischen Institut

The German Archaeological Institute in Rome possesses a collection of more than 300,000 photographs on the art of the ancient world, one of the largest such collections in the world. This unique collection to be reproduced on microfiche will be accompanied by a special series of catalogs that provide access by geographical place, iconography and more general cultural and historical subjects.

The major categories of photographs are: Architecture; Figurative and Non-figurative sculpture; Idealized sculpture; Portrait sculpture; Sarcophagi; Reliefs; Vases; Terra Cotta; Painting; Mosaics; Small art; Inscriptions and Miscellaneous.

1988-1991

First installment March 1988.

Photographic Inventory —
10 installments; approx. 3200
silver positive fiche (24X)

Catalogs — 2 installments;
approx. 650 fiche

Complete set, *special pre-publication price* \$9,000*

CATALOG OF THE RÜBEL ASIATIC RESEARCH COLLECTION, HARVARD UNIVERSITY FINE ARTS LIBRARY

The Rübel Asiatic Research Collection — one of the world's most useful specialized Oriental art libraries — is a collection of books and serial publications dealing with the arts of the Far East, Southeast Asia, and the Indian subcontinent. Its particular strengths include Buddhist arts, Chinese bronzes and painting, Japanese painting and prints, and Chinese and Japanese ceramics.

This dictionary catalog, now published in a facsimile book edition, contains entries for author, title, series and subject for works in both Western and Oriental languages acquired by the Rübel Collection through December 1985. Entries for Oriental languages have been romanized, and include the original characters and an English translation.

1988/0-89664-308-5/8 volumes;
approx. 3900 pages/\$950

*Price requires payment in full on receipt of first shipment.

200 Full-color Slides of Outstanding Interiors
published in INTERIOR DESIGN Magazine in 1987...as
selected by the Editors

The Best of INTERIOR DESIGN

in Full-Color Slides

Now you can own a collection of the very best contract and residential interiors created in 1987...and compile a comprehensive slide library chronicling the finest professional installations with *The Best of Interior Design*.

The first in a series of annual slide surveys, *The Best of Interior Design 1987* is an invaluable resource for designers and librarians. Each of the 200 slides is shot from the original color transparency and reproduced on high quality Kodak film for superior clarity. And each represents the work of outstanding interior designers and architects appearing in the industry's most authoritative design publication.

Each installation is identified on the slide mount with the designer's name, firm, date, location, and name of installation as well as the issue and page of *Interior Design Magazine* in which it appeared. A separate identification sheet is also included.

The complete set of 200 beautiful, full-color slides is just \$350.00 -- about \$1.75 each. A limited number of the premier series will be available in February, 1988 so order your set today to avoid disappointment.

For additional information, please contact: Richard Coyne
(212) 481-3733.

INTERIOR DESIGN Magazines's 1987 Best of Interior Design Slide Survey
126 Madison Avenue, New York, NY 10016 Attn: Richard Coyne

Please send us the 1987 Full-color Best of Interior Design Slide Survey
200 sides for just \$350.00

Send Invoice

Purchase Order enclosed

Payment enclosed

Name _____

Company/Institution _____

Address _____

City/State/Zip _____

NOTE: None Institutional orders must be prepaid.

THE KNOEDLER LIBRARY

*Auction Catalogues on Microfiche
from the British Auction House*

Christie's 1792-1970

& & & & & & & & & &

Auction Catalogues on Microfiche

Titles Available:

• **AMERICAN AUCTIONS**

*American Art Association, 1884-1939
American Art Galleries, 1886-1929
Anderson Art Galleries, 1911-1939
Philadelphia Auctions, 1873-1970
Selected American Auctions, 1835-1970*

• **BRITISH AUCTIONS**

*Christie's, 1792-1970
Selected English Auctions, 1748-1966
(excluding Christie's and Sotheby's)*

• **FRENCH AUCTIONS**

*Hotel Drouot, 1854-1970
George Petit, 1881-1932
Charpentier, 1933-1960
Palais Galleria, 1960-1970
Selected French Auctions, 1774-1970*

• **INTERNATIONAL AUCTIONS**

*Belgium Auctions, 1819-1968
Dutch Auctions, 1816-1970
German Auctions, 1876-1970
Selected International Auctions, 1845-1970*

& & & & & & & & & &

Published and distributed exclusively by

M. Knoedler

19 East 70th Street
New York, NY 10021, USA
Telephone: (212) 794-0550

Contact:
Cam Newell

THE COMPLETE TITLE INDEX OF 26,000 VOLUMES
OF SALES, EXHIBITIONS AND SALONS IN THE KNOEDLER
LIBRARY ON MICROFICHE 55 FICHE \$75.00

OCULI

Studies in the Arts of the Low Countries

The OCULI series provides a forum for historical research in the arts of the Low Countries. While the series focuses on the art of this particular region, corresponding to what are now the Netherlands and Belgium, it is not limited to a specific period but ranges from the beginnings of the Netherlandish arts in the 14/15th century to the present. Contributions may favor different approaches, but the emphasis is on historical analysis rather than esthetics and the philosophy of art. The series includes monographs as well as catalogues and critical studies on all aspects of the arts in the Low Countries. Volumes are written in English. The second volume in the series will be published in 1988 and further volumes are in preparation.

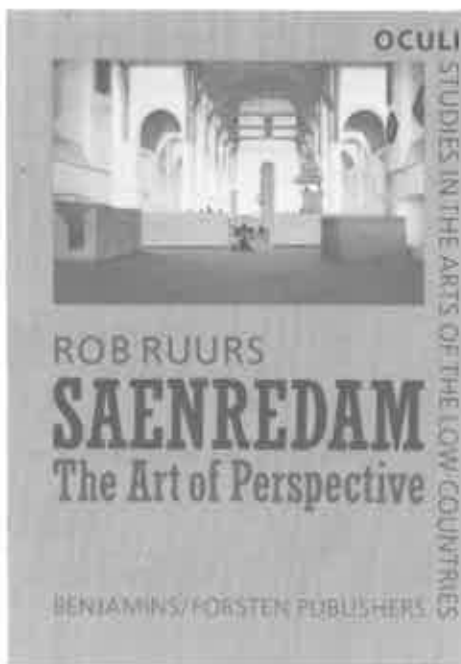

Saenredam

The Art of Perspective

ROB RUURS

Amsterdam 1987. 228 pp., 37 ills., with
bibliogr., glossary and index.

ISBN 1-55619-015-8 (US) 24.5 x 17.5 cm.

ISBN 90 272 5331 5 (Eur.) \$ 50.00

Oculi 1

Joachim Patinir

The Landscape as an Image
of the Pilgrimage of Life

R.L. FALKENBURG

Amsterdam 1988. n.y.p.

ca. 260 pp. + 49 ills., with bibliogr.
and index. 24.5 x 17.5 cm.

Oculi 2

db JOHN BENJAMINS PUBLISHING COMPANY db

P.O.Box 52519 · Amsteldijk 44 · 1007 HA AMSTERDAM · Holland · Tel (020) 738156 · Telex 15798
One Buttonwood Square · PHILADELPHIA, Pa. 19130 · USA · Tel. (215) 564-6379 · Telex 497 2813

Michael Shamansky, Bookseller

importer of italian publications on the fine arts



48 MAIN STREET, P.O. BOX 3904
KINGSTON, NEW YORK 12401

PHONE TOLL-FREE 1-800-527-6775
(IN NEW YORK, OUTSIDE U.S.A. 1-914-331-8519)
telex 5101008918 booksell

MICHAEL SHAMANSKY, BOOKSELLER is North America's largest importer of Italian publications, dealing exclusively with the fine arts.

We offer the most comprehensive service for the acquisition of new Italian monographs and exhibition catalogues.

Our catalogues, newsletters and individual title-slips describe new publications in full bibliographic detail.

We ship directly from our Kingston office, from a stock of more than 10,000 books supplemented by daily shipments from Italy.

Our toll-free phone service offers you a convenient source of information for new, backlist and out-of-print Italian imprints. Our computerized data-base is updated daily. We can answer most of your queries immediately or within a matter of days. Why wait three months or more before receiving a reply from your current vendor?

The value of your current vendor diminishes each time you issue a claim-notice. Only an active vendor will benefit your collection. We can establish an approval plan to your exact specifications, supplying titles faster than your current vendor in Italy. Our efficient and reliable service promises an orderly and painless method of acquiring new Italian imprints on the fine arts.

If you are not on our permanent mailing list, or would like to receive our new title-slips regularly, please call us, toll-free, at 1-800-527-6775.

Cambridge University Press

Announcing a new series...

Cambridge New Art History and Criticism

The first book...

Calligram

Essays in New Art History

Norman Bryson, Editor

Announcing a new series...

The Collections of the National Gallery of Art Systematic Catalogue

The first volume...

Early Netherlandish Painting

John Oliver Hand and Martha Wolff

The Beginnings of Netherlandish Canvas Painting

1400-1530

Diane Wolfthal

Visual Facts Over Verbal Fiction

A Study of the Carracci and the Criticism, Theory and Practice of Art in Renaissance and Baroque Italy

Carl Goldstein

Artists' Techniques in Golden Age Spain

Six Treatises in Translation

Zahra Veltz, Editor and Translator

Lives of the Eminent Spanish Painters and Sculptors

Antonio Palomino

Nina Ayala Mallory, Translator

Giotto and the Language of Gesture

Moshe Barasch

The Oriental Obsession

Islamic Inspiration in British and American Art 1500-1920

John Sweetman

Exhibition Catalogues...

Hans Arp 1886-1966

The Age of Correggio and the Carracci

The Age of Bruegel

Drawing in England from Hilliard to Hogarth

Hogarth

Sidney Nolan: Landscapes and Legends

Artists' Pigments

A Handbook of Their History and Characteristics

Robert Feller, Editor

A History of Photography

Social and Cultural Perspectives

Jean-Claude Lemagny and Andre Rouille, Editors

Now in paperback...

The Past is a Foreign Country

David Lowenthal

The Anatomy of Architecture

Ontology and Metaphor in Batammaliba

Architectural Expression

Suzanne Preston Blier

How We Understand Art

A Cognitive Developmental Account of Aesthetic Experience

Michael J. Parsons

Museums of Influence

Kenneth Hudson

Pharaohs and Mortals

Egyptian Art in the Middle Kingdom

Janine Bourriau

Oxford and Cambridge

Christopher Brooke and Roger Highfield with photographs by Wim Swaan

Reissued in its entirety...

The Architectural History of the University of Cambridge and the Colleges of Cambridge and Eton

Robert Willis and John Willis Clark

with an introduction by David Watkin

The Drawings of Guercino in the Collection of Her Majesty The Queen at Windsor Castle

Sir Denis Mahon and Nicholas Turner

Three by Raymond Lister...

Samuel Palmer

His Life and Art

A Catalogue Raisonné of the Works of Samuel Palmer

Now in paperback...

The Paintings of William Blake

See these and other titles at the Conference Book Service booth.

Cambridge University Press

32 East 57th Street

New York, NY 10022

F·A·BERNETT·INC



Rare & Scholarly Books
on the



FINE & DECORATIVE ARTS
ARCHITECTURE
ARCHAEOLOGY



2001 Palmer Avenue
Larchmont N.Y. 10538

Tel. 914 834-3026

CATALOGUES ON REQUEST

If you missed the exhibit

Exhibition Catalogues
of Painting, Sculpture
& Graphics on
20th Century Artists.
Current & Out-of-print.

Send for our inventory catalogue. Mail \$1.00 to:

ART CATALOGUES

625 North Almont Drive
Los Angeles, California 90069
213 274 0160

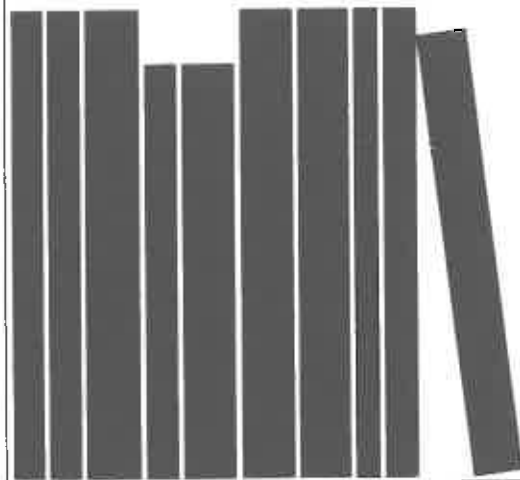

Bauhaus
Constructivism
De Kooning
Dine
Duchamp
Hockney
Johns
Matisse
Monet
Pop Art
Rauschenberg
Rothko
Stella
Warhol
& others

Casalini libri

Via B. da Maiano, 3
50014 FIESOLE (Firenze) Italy
Tel. 599941

The most experienced supplier
of Italian publications
to libraries
throughout the world

Standing orders
for series
and multi-volume monographs

Highly selective blanket orders
to meet
every library's special requirements

Subscription to periodicals
with direct, centralized mailing

Monthly bibliographical cards
for all new books

Searching for out-of-print material

Library binding

OVER 8,000 BOOKS &
EXHIBITION CATALOGUES
EXCLUSIVELY ON
AMERICAN ART & ARTISTS.
WANT LIST INVITED.

.....

OLANA GALLERY

Drawer #9
Brewster, New York 10509
914-279-8077

THE GETTY ART HISTORY INFORMATION PROGRAM
AND THE
INSTITUTE FOR RESEARCH IN INFORMATION AND
SCHOLARSHIP, BROWN UNIVERSITY



ANNOUNCE A
COLLABORATIVE STUDY
BASED ON INTERVIEWS WITH

*Enrico Castelnuovo, T. J. Clark,
Jennifer Fletcher, Kurt W. Forster,
Thomas Gaehtgens, Ernst H. Gombrich,
Fritz Koreny, Rosalind Krauss,
James Marrow, Jennifer Montagu,
Stephen Murray, Françoise Perrot,
Donald Preziosi, William Rubin,
Juergen Schulz, Gary Schwartz,
Nancy Troy, John Walsh, and
Rolf Winkes*

ORDER FORMS IN THE GROUP EXHIBIT AREA

*Art Resource Will Produce Slide Booklets of Your
Collections for Sale in Museum Shops, Bookstores and
Gift Catalogues*

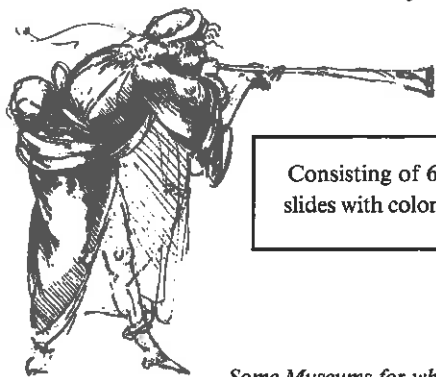

Consisting of 6, 12, 18, 36 or more
slides with color cover and text pages



**ART
RESOURCE**

65 Bleecker St.
New York, N.Y. 10012
212-505-8700

Some Museums for which slide booklets have been made:

Detroit Institute of Arts, Isabella Stewart Gardner Museum, Jewish Museum of New York, Museum of Fine Arts,
Houston, Metropolitan Museum of Art, Louvre, Prado, Uffizi, Vatican Museums

ART HISTORY

on microfiche

IDC is one of the largest microform publishers with a 'library' of 600,000 volumes selected by leading experts. All titles and single volumes are available separately and at low costs.

Please ask for the following IDC catalogues:

Art History, general
Art Sales Catalogues, 1600-1825
Alinari Photo Archive
Emblem Books
Malevich Archive
Architectural History
Armenian Architecture
South Asia, Art and Archaeology
South Asian Art Photograph Collection
Indonesian Archaeological Photographs
Royal Commonwealth Society Photograph
Collection
Historical Photographs of the Middle East
Sultan 'Abdulhamid II Photograph Collection
Early Photographs from Egypt
RIDIM, Musical Iconographic Collections

All catalogues are available free on request.

Visit Booth No. 27
Norman Ross Publishing Company, Inc.
1995 Broadway, New York, NY 10023



IDC Microform Publishers