

UNITED

2025 AMC
UNITED AIRLINES
CABIN DOOR ESCAPE SLIDE
PACK RENDER SAFE



THIS EVENT WILL SIMULATE THE REMOVAL/INSTALLATION PROCEDURES FOR THE BOEING 767-322 L1/R1 DOOR ESCAPE SLIDE PACK. THE EVENT WILL FOCUS ON SAFETY AND FOLLOWING THE PROCEDURE. THE TECHNICIANS WILL BE JUDGED ON THEIR ABILITY TO FOLLOW THE RENDER SAFE CHECKLIST AND AMM PROCEDURE TO SAFELY REMOVE AND REINSTALL THE SLIDE.

- THE SLIDE INFLATION CYLINDER WILL NOT BE PRESSURIZED DURING THIS EVENT.
- TWO TECHNICIANS AND ONE SAFETY OBSERVER WILL BE REQUIRED (3 PERSON EVENT).
- PRIMARY DOCUMENTS UTILIZED:
 - RENDER SAFE CHECKLIST FORM 46-0035 MUST BE UTILIZED AND FOLLOWED IN CORRECT SEQUENCE. THE EVENT WILL ASSUME DISTRACTIONS ARE IN THE WORK AREA AND ONE SAFETY BARRIER MUST BE INSTALLED ON THE EXTERIOR OF THE DOOR. THE SAFETY OBSERVER MUST REMAIN INDEPENDENT OF TECHNICIAN(S) PERFORMING MAINTENANCE AND ENSURE THAT THE TECHNICIAN(S) PERFORMING MAINTENANCE RENDER THE ESCAPE SLIDE SAFE. THE OBSERVER MUST VERBALLY READ THE RENDER SAFE CHECKLIST QUESTIONS TO THE TECHNICIANS IN QUESTION/ANSWER FORMAT AND ENSURE TECHNICIAN(S) RESPOND. FOR THE PURPOSE OF THIS EVENT, THE OBSERVER WILL BE THE INSPECTOR WHEN THE TASK REQUIRES.
 - AMM 25-66-01 FOR THE ESCAPE SLIDE PACK REMOVAL/INSTALLATION. EACH STEP MUST BE READ OUT LOUD. A 30 SECOND PENALTY WILL BE APPLIED FOR EACH MISSED STEP IN THE AMM OR RENDER SAFE CHECKLIST PROCEDURES. **GRABBING/PULLING ON THE DEPLOYMENT/RELEASE CABLES WILL RESULT IN IMMEDIATE DISQUALIFICATION.**
- THE AIRCRAFT NOSE NUMBER, DOOR LOCATION, DATE, STATION INFORMATION AND RELATED TASK INFORMATION WILL BE PROVIDED FOR THE SAFETY OBSERVER AND TECHNICIANS TO VERIFY VERBALLY.
- 3 SETS OF REMOVAL/INSTALLATION INSTRUCTIONS WILL BE PROVIDED AND MUST BE UTILIZED DURING THE EVENT. ONE RENDER SAFE CHECKLIST WILL BE PROVIDED FOR THE SAFETY OBSERVER.
- SHADOW BOXED TOOLING WILL BE PROVIDED.
- THE FOLLOWING SLIDES PROVIDE DETAILS ON THE RENDER SAFE CHECKLIST AND SHOW THE HIGHLIGHTS OF THE REMOVAL AND INSTALLATION TASK.



Escape Slide Render Safe Checklist

Read all notes before proceeding with Page 2

- To prevent inadvertent escape slide deployments, GMM 02-30-25 requires a Safety Observer (SO) be used when maintenance on a door/hatch slide system is performed. The SO will remain independent of technician(s) performing maintenance and ensure that the technician(s) performing maintenance render the escape slide safe. This checklist, to be controlled and completed by the SO, provides guidance in a challenge/response type format.
- This checklist will be used whenever maintenance on a door/hatch slide system is performed (troubleshooting, operational checks, slide removal/installation/replacement, etc.) Each door/hatch slide system requires a separate checklist.
- Overwing hatches must not be opened unless routine or non-routine work is being performed. If opening of these systems is required for access to other components, then the use of the Escape Slide Render Safe Checklist Form 46-0035, along with the SO is required. This policy is not applicable to the B737 overwing hatch.
- Form 46-0035 utilizes a question/answer type format. The SO will read questions (out-loud) and ensure technician(s) respond.
- This checklist is generic in nature and supplemental to the primary paperwork being used to perform the maintenance task. It should be worked simultaneous with primary paperwork. Sign-offs on this checklist does not preclude the sign-offs on the primary maintenance paperwork.
- For Heavy Check (Base Maint) that have a docking and de-docking card for disarming and re-arming the slide or off-wing escape system, it is acceptable to use one render safe checklist for each position during the visit. If there is a maintenance task during the visit that requires complete re-arming of the affected position, additional render safe checklist is required.

S L I D E



Stop

everything you are doing and drop your arms to your sides. Eliminate all distractions.



Look

at the door.



Identify

warning placards on the door and potential hazards, and review disarming procedures.



Disarm

the door, per approved procedure(s), if required. Reference the AMM, door placarding, the *Door Operations Guide*, located in eDocs, and the *Slide Render Safe Checklist** located in GMM 02-30-25.



Ensure

door is disarmed by double checking your work before proceeding!

Read all notes before proceeding with Page 2

Send completed form(s) to Aircraft Records

Escape Slide Render Safe Checklist

- * Slides contain stored explosive energy and can cause injury or damage when detonated. Failure to follow WARNINGS and Cautions in the AMM/Task Card will result in slide deployment.
- * Install Safety Barriers if your work area needs to be quarantined to avoid distractions.
- * Mental readiness and focus is essential to a successful mission. Excessive stress, loss of coordination, drowsiness, hurrying and fatigue will jeopardize this mission. Latent threats such as electrical, mechanical, explosive must be neutralized to avoid inadvertent events.

Section 1. Safety Observer: List all team members performing task as required. List Inspector if utilized.
Ref GMM 09-25-05. (All blocks must be entered)

Safety Observer: _____ Tech 1: _____ Tech 2: (as reqd): _____
Tech 3: (as reqd) _____ Inspector: (as reqd) _____

Contact Supervisor/advise slide maintenance in progress

All team members verbally confirm: (One per checklist)
Aft Nose Number: _____ Door/Hatch Location: _____ Station: _____

Is the work area free and clear of all obstructions and trip hazards?
 NO -- STOP! Clear area of obstructions and trip hazards. YES -- Continue

WARNING: Ensure Technicians DO NOT pull on the lacing cover cable - the slide will unpack.

What is the escape slide related task? (select one)
 Remove/Reinstall Slide or LRU replacement (Proceed to Section 3) Evaluate/Troubleshoot Discrepancy (Proceed to Section 2) Routine Task Card (Proceed to Section 3)

Section 2. Render Safe for fault diagnosis/isolation and other non-routine maintenance or operational test.

Is the door escape slide mode selector in the armed position?
Stop Look Identify Disarm Ensure
 YES - DO NOT OPEN - Position mode selector to DISARM
 No - Verify the girt bar is out of the pawls/floor fittings
 N/A This slide system does not have a mode selector

NOTE: B737 verify girt bar is removed from floor fittings and stow.

Was the mode selector hard or unable to move?
 YES - GET applicable FIM/TSM/AMM and troubleshoot
 No - Verify the girt bar is out of the pawls/floor fittings
 N/A This slide system does not have a mode selector

Is the effective FIM/TSM/AMM in-hand and reviewed?
 STOP! Get the AMM, TSM or FIM and review
 Yes - Continue

Does the fault found require escape slide deactivation?
 YES - Ensure Technician follows applicable AMM in sequence to remove electrical and mechanical energy threats.
 No - Record document being accomplished (FIM/TSM or AMM)

Are LOTO safety pins documented? (check any that apply)
 ELB (Electronic Log Book) Non-Routine
 Routine Task Card No LOTO pins required for this task

When completed troubleshooting/non-routine maintenance, proceed to Section 4.

Task Notes:

Submitted Date: _____

Section 3. Render safe for Routine Tasks

Is the correct effectivity AMM or Task Card in-hand and reviewed before working the door or hatch?
 NO - STOP! Get the AMM or Task Card
 Yes - Continue

Is the door or hatch escape slide armed?
Stop Look Identify Disarm Ensure
 Yes - STOP! Review the AMM/Task and disarm the slide
 No - Continue
 This task requires slide system to be ARMED.

NOTE: Off-wing slides are normally in the armed state.

Does the task require slide system deactivation?
 Yes - Accomplish AMM/Task Card and deactivate the slide
 No - Continue

Are LOTO safety pins documented? (check any that apply)
 ELB (Electronic Log Book) Non-Routine
 Routine Task Card No LOTO pins required for this task

When routine task is complete, proceed to Section 4.

Section 4. AMM/Task Card Installation and/or reactivation.

Slide system reactivation/restoration

- Ensure all steps are executed in sequence per AMM/Task Card
- Place mode lever to DISARM position. B737, stow girt bar in retainer clips
- Off-wing slide: Leave ARMED per AMM or Task Card (if applicable)
- Review completed work for RII items. Ref GMM 09-25-05
- Ensure all tools and materials are accounted for.

NOTE: If there is a need to turnover an incomplete task to the next shift, then generate the non-routine items in ELB as necessary. Safety Observer: Ensure written and verbal turnover of work accomplished. Turnover requires new checklist to be accomplished.

When tasks are complete for the shift, this form must be submitted to Aircraft Records via AirVault, please email: UAL-ACRecords@airvault.net

THE SAFETY OBSERVER WILL BE THE INSPECTOR FOR THIS EVENT. THE OBSERVER, TECH 1, TECH 2 AND INSPECTOR NAMES MUST BE VERBALIZED AND ACKNOWLEDGED. THE ACFT NOSE NUMBER, DOOR LOCATION, STATION AND ESCAPE SLIDE RELATED TASK INFORMATION WILL BE PROVIDED AT THE EVENT.

Section 1. Safety Observer: List all team members performing task as required. List Inspector if utilized.

Ref GMM 09-25-05.

Safety Observer: Tech 1: Tech 2: (as reqd)

Tech 3: (as reqd) Inspector: (as reqd)

Contact Supervisor/advise slide maintenance in progress

JUDGE WILL BE THE SUPERVISOR AND ACKNOWLEDGE WHEN NOTIFIED.

All team members verbally confirm:

Acft Nose Number: Door/Hatch Location: Date: Station:

Is the work area free and clear of all obstructions and trip hazards?

NO -- STOP! Clear area of obstructions and trip hazards.

YES -- Continue

WARNING: Ensure Technicians DO NOT pull on the lacing cover cable - the slide will unpack.

What is the escape slide related task? (select one)

Evaluate/Troubleshoot Discrepancy (Proceed to Section 2)

Remove/Reinstall Slide or LRU replacement (Proceed to Section 3)

Routine Task Card (Proceed to Section 3)

THE SAFETY OBSERVER MUST READ EACH QUESTION OUT-LOUD AND ENSURE THE TECHNICIANS RESPOND. THE OBSERVER WILL CHECK EACH BOX AS THEY ARE COMPLETED WITH THE GREASE PENCIL PROVIDED. THE OBSERVER, TECH 1, 2, INSPECTOR, ACFT NOSE NUMBER, DOOR LOCATION, DATE AND STATION BLOCKS ARE VERBAL ONLY AND NOT REQUIRED TO BE WRITTEN ON THIS FORM. A 30 SECOND PENALTY WILL BE ADDED TO THE TOTAL TIME FOR EACH VIOLATION ON THE RENDER SAFE CHECKLIST.



THE SLIDE RELATED TASK PROVIDED AT THE EVENT AND ANSWERED IN SECTION 1 OF THE CHECKLIST DETERMINES THE NEXT STEP. EXAMPLE: FOR A REMOVE/REINSTALL SLIDE TASK, FOLLOW SECTION 3 TO RENDER SAFE. A NON-ROUTINE WILL BE PROVIDED AT THE EVENT TO DOCUMENT LOTO SAFETY PIN INSTALLATIONS. EVERY BLOCK MUST BE READ OUT-LOUD BY THE OBSERVER AND RESPONSE CONFIRMED BY THE TECHNICIANS.

Section 2. Render Safe for fault diagnosis/isolation and other non-routine maintenance or operational test.

Is the door escape slide mode selector in the armed position?

Stop Look Identify Disarm Ensure

- YES - DO NOT OPEN - Position mode selector to DISARM**
- No - Verify the girt bar is out of the pawls/floor fittings
- N/A This slide system does not have a mode selector

NOTE: B737 verify girt bar is removed from floor fittings and stow.

Was the mode selector hard or unable to move?

- YES - GET applicable FIM/TSM/AMM and troubleshoot**
- No - Verify the girt bar is out of the pawls/floor fittings
- N/A This slide system does not have a mode selector

Is the effective FIM/TSM/AMM in-hand and reviewed?

- STOP! Get the AMM, TSM or FIM and review**
- Yes - Continue

Does the fault found require escape slide deactivation?

- YES - Ensure Technician follows applicable AMM in sequence to remove electrical and mechanical energy threats.**
- No - Record document being accomplished (FIM/TSM or AMM)

Are LOTO safety pins documented? (check any that apply)

- ELB (Electronic Log Book) Non-Routine
- Routine Task Card No LOTO pins required for this task

When completed troubleshooting/non-routine maintenance, proceed to Section 4.

Task Notes:

**SECTION 4
DO NOT CHECK THE OFF-WING SLIDE BOX SINCE EACH EVENT WILL ONLY APPLY TO ENTRY/SERVICE DOORS. CHECKING THIS BOX WILL RESULT IN A 30 SECOND PENALTY.**

Section 3. Render safe for Routine Tasks

Is the correct effectivity AMM or Task Card in-hand and reviewed before working the door or hatch?

- NO - STOP! Get the AMM or Task Card**
- Yes - Continue

Is the door or hatch escape slide armed?

Stop Look Identify Disarm Ensure

- Yes - STOP! Review the AMM/Task and disarm the slide**
- No - Continue
- This task requires slide system to be ARMED.

NOTE: Off-wing slides are normally in the armed state.

Does the task require slide system deactivation?

- Yes - Accomplish AMM/Task Card and deactivate the slide
- No - Continue

Are LOTO safety pins documented? (check any that apply)

- ELB (Electronic Log Book) Non-Routine
- Routine Task Card No LOTO pins required for this task

When routine task is complete, proceed to Section 4.

Section 4. AMM/Task Card Installation and/or reactivation.

Slide system reactivation/restoration

- Ensure all steps are executed in sequence per AMM/Task Card
- Place mode lever to DISARM position. B737, stow girt bar in retainer clips
- Off-wing slide: Leave ARMED per AMM or Task Card (if applicable)
- Review completed work for RII items. Ref GMM 09-25-05
- Ensure all tools and materials are accounted for.



767 Aircraft Maintenance Manual
TASK 25-66-01-004-001

2. Escape Slide Pack Removal (Figure 400, Figure 401, Figure 402, Figure 403 or Figure 404)

NOTE: This procedure is a scheduled maintenance task.

A. Procedure

WARNING: AN INADVERTENT SLIDE DEPLOYMENT CAN RESULT IN INJURY OR DEATH TO PERSONS AND DAMAGE TO EQUIPMENT. GMM 02-30-25 REQUIRES YOU RENDER THE ESCAPE SLIDE SAFE PER THE AMM AND UTILIZE THE ESCAPE SLIDE RENDER SAFE CHECKLIST FORM 46-0035.

- (1) Obtain and review the Escape Slide Render Safe Checklist Form 46-0035.
- (2) Place one safety barrier in front of the exterior of the door and install the DO NOT ENTER sign on the barrier to ensure a safe and sterile work environment.
- (3) Place DO NOT OPERATE tag number 1 over the exterior door handle.
- (4) Verify the entry/service door is closed.
- (5) Attach DO-NOT-OPERATE tag number 2 above or adjacent to the interior handle for the entry/service doors.
- (6) On the upper door liner, squeeze the buttons together to release the hinge pins. With caution, lower the door liner.

WARNING: MAKE SURE THAT YOU INSTALL THE GROUND LOCK FOR THE ENTRY DOOR. WITHOUT THE GROUND LOCK INSTALLED, ACCIDENTAL OPERATION OF THE DOOR CAN CAUSE INJURY OR DAMAGE.
- (7) Install the entry/service door ground lock pin P/N A52008-14 in the upper roller guide (Figure 400).
- (8) Verify the arm/disarm handle is in the DISARMED position.
- (9) Make sure that the yellow flag indicators (Figure 401) for the girt bar are not shown in the windows at the bottom of the door.
- (10) Remove the bustle (Figure 401) and place the bustle away from the immediate work area.
- (11) Remove the safety pin from the stowage pocket on the escape slide pack.

WARNING: INSTALL THE SAFETY PIN IN THE INFLATION CYLINDER REGULATOR. WITHOUT THE SAFETY PIN INSTALLED, THE ESCAPE SLIDE OR SLIDE-RAFT CAN INFLATE ACCIDENTALLY AND CAUSE INJURY OR DAMAGE.
- (12) Install safety pin into the inflation cylinder regulator (Figure 401).

CAUTION: DO NOT PULL ON THE RELEASE CABLES. A FORCE ON THE CABLES CAN CAUSE THE ESCAPE SLIDE PACK TO RELEASE FROM THE DOOR.

CAUTION: EXERCISE CARE WHEN HANDLING THE SLIDE PACK TO ENSURE THE RELEASE CABLES ARE NOT PULLED OUT OR DETACHED FROM THE PACKBOARD SIDE CHANNELS.
- (13) Remove the girt bar [3] from the girt bar carrier (Figure 403).

WARNING: OBEY THE PROCEDURE TO TWIST THE GIRT STRAPS WHEN YOU INSTALL THE GIRT FITTING IN THE DOOR OPENING. IF THE GIRT STRAP IS NOT IN THE CORRECT POSITION, THE ESCAPE SLIDE CAN OPERATE INCORRECTLY. IF THE ESCAPE SLIDE OPERATES INCORRECTLY, INJURY TO PERSONNEL CAN OCCUR.
- (14) Attach the girt bar [3] to the escape slide pack [1] with the retainer straps (View B-B Figure 402).
- (15) Turn the deployment bar down to touch the floor (View A-A Figure 402).
- (16) Release the reusable safety strap for the latch handle (View A, Figure 404).
- (17) Hold the top of the escape slide pack [1] and turn the latch handle to the unlocked position (Figure 402).
- (18) With two persons, carefully lower the escape slide pack down and inboard until it is on the floor.

NOTE: It is not necessary to lift the escape slide pack.
- (19) On the non-routine provided, sign block 9 stating the applicable entry/service door slide pack has been removed.

767 Aircraft Maintenance Manual
TASK 25-66-01-404-072

3. **Escape Slide Pack Installation** ([Figure 401](#), [Figure 402](#), [Figure 403](#), [Figure 404](#) or [Figure 405](#))

NOTE: This procedure is a scheduled maintenance task.

A. Procedure

WARNING: AN INADVERTENT SLIDE DEPLOYMENT CAN RESULT IN INJURY OR DEATH TO PERSONS AND DAMAGE TO EQUIPMENT. GMM 02-30-25 REQUIRES YOU RENDER THE ESCAPE SLIDE SAFE PER THE AMM AND UTILIZE THE ESCAPE SLIDE RENDER SAFE CHECKLIST FORM 46-0035.

- (1) Make sure the ground lock pin P/N A52008-14 for the entry/service door is installed in the upper roller guide.
- (2) Turn the deployment bar down to touch the floor (View A-A, [Figure 402](#)).
- (3) View the inflation cylinder regulator gauge pressure (it is acceptable for the gauge to be in the red band/0 PSI range for this event, [Figure 401](#)).

CAUTION: MAKE SURE THAT YOU CORRECTLY ENGAGED DEPLOYMENT CABLES INTO THE DEPLOYMENT CABLE RETRACTORS. MAKE SURE THAT THE DEPLOYMENT CABLES ARE IN THE CORRECT POSITION. IF YOU DO NOT OBEY, DAMAGE TO EQUIPMENT CAN OCCUR.

- (4) Set the escape slide pack [1] inboard face down (with the cover on the floor and the pack board on top).
- (5) Move the escape slide pack [1] in front of the entry/service door with the lower fittings adjacent to the door.
- (6) Move the escape slide pack [1] outboard and align the lower fittings with the mounting brackets on the door.
- (7) Continue to move the escape slide pack [1] outboard until the two lower fittings are engaged with the brackets on the door.

NOTE: You can move the escape slide pack [1] from side to side on its face to get the lower fitting height necessary to engage the door brackets. It is not necessary to lift the escape slide pack [1].

- (8) Lift the top of the escape slide pack [1] up and outboard.
- (9) Make sure the guide pin on the escape slide pack [1] aligns with the track on the door.
- (10) Hold the top of the escape slide pack [1] tightly against the latch. Turn the latch handle to the locked position ([Figure 402](#)).
- (11) Secure the reusable safety strap for the latch handle by attaching the snap (View A, [Figure 404](#)).

NOTE: The safety strap holds the latch handle in the locked position.

- (12) Turn the deployment bar up to the loaded position (View A-A, [Figure 402](#)).
- (13) Make sure the deployment cables are in the correct position as shown in View A-A, [Figure 402](#). Ensure the white rubber dust covers (2EA) are mated against deployment cable retractors. **Observer/Inspector verify step.**

CAUTION: DO NOT PULL ON THE RELEASE CABLES. A FORCE ON THE CABLES CAN CAUSE THE ESCAPE SLIDE PACK TO RELEASE FROM THE DOOR.

- (14) Release the retainer straps and disconnect the girt bar from the escape slide pack [1]. Resecure both snaps for the retainer straps.

WARNING: MAKE SURE THAT YOU INSTALL THE GIRT BAR IN THE GIRT BAR RETAINER. IF YOU DO NOT INSTALL THE GIRT BAR IN THE GIRT BAR RETAINERS, ACCIDENTAL INFLATION OF THE ESCAPE SLIDE CAN OCCUR. THIS CAN CAUSE INJURIES TO PERSONS OR DAMAGE TO EQUIPMENT.

(15) Install the girt bar in the girt bar carrier. **Observer/Inspector verify step.**

(16) Turn the girt bar locks to align the arrows as shown (View B, [Figure 403](#)). **Observer/Inspector verify step.**

(a) When you turn the girt bar lock, make sure you can feel the ball plunger in the lock operate correctly with positive detent action between the unlocked and locked positions.

(b) If the girt bar lock does not operate correctly, adjust the ball plunger in the lock.

(17) Do a check on the round, white, silicone bumper ([Figure 405](#)) on the forward side of the pack board as follows:

(a) Make sure the clearance between the bumper and the forward surface of the pack board channel is 0.15 to 0.21 inch (3.8 to 5.3 mm). **Observer/Inspector verify step.**

(b) If the clearance is not correct, adjust the bumper by loosening the jam nut and rotating the bumper to achieve the correct clearance. Resecure the jam nut and safety the bumper to the hole in the attaching bracket.

WARNING: REMOVE THE SAFETY PIN FROM THE INFLATION CYLINDER REGULATOR. MAKE SURE THAT THE SAFETY PIN IS NOT DAMAGED OR BROKEN. THE ESCAPE SLIDE OR SLIDE-RAFT WILL NOT INFLATE IN AN EMERGENCY IF THE SAFETY PIN OR PART OF THE SAFETY PIN IS IN THE REGULATOR.

(18) Remove the safety pin from the inflation cylinder regulator. **Observer/Inspector verify step.**

(19) Put the safety pin into the pocket on the escape slide pack [1]. **Observer/Inspector verify step.**

(20) Make sure a DYMO (or equivalent) tape label indicating date of last overhaul (mm/yy) is installed in proximity to the pressure gauge face. **Observer/Inspector verify step.**

CAUTION: DO NOT PULL ON THE RELEASE CABLES. A FORCE ON THE CABLES CAN CAUSE THE ESCAPE SLIDE PACK TO RELEASE FROM THE DOOR.

(21) Visually check and verify the girt bar is locked into the girt bar carrier. **Observer/Inspector verify step.**

(22) Install the bustle [2].

(23) Push the round green arm/disarm handle release button in and move the arm/disarm handle to the ARMED position.

(24) Make sure the yellow indicator flags ([Figure 401](#)) for the girt bar completely fill the windows at the bottom of the bustle [2]. **Observer/Inspector verify step.**

(25) Move the arm/disarm handle to the DISARMED position.

(26) Make sure the yellow indicator flags for the girt bar are not shown in the windows at the bottom of the bustle [2]. **Observer/Inspector verify step.**

(27) Remove the ground lock pin for the entry/service door. **Observer/Inspector verify step.**

Place the ground lock pin in the toolbox.

(28) Carefully raise the upper door liner and secure the hinge pins into the door frame basket.

(29) Remove the DO NOT OPERATE tag #2 from the interior handle for the entry/service door.

(30) Remove the DO NOT OPERATE tag #1 from the exterior handle for the entry/service door.

(31) Remove the DO NOT ENTER sign and safety barrier from the door exterior area.

(32) Return all tooling and DO NOT OPERATE tags to their appropriate shadow box locations.

(33) On the non-routine provided, complete block 17 with a signature for the slide installation (inspector signature required for installation).

NOTE: The safety observer must ensure all applicable sections of the render safe checklist have been completed in sequence through the last applicable block in section 4.



Figure 400: Entry/Service Door Ground Lock Pin.

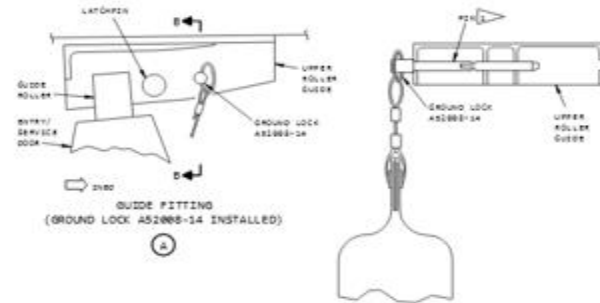

Figure 401: Entry/Service Door Escape System.

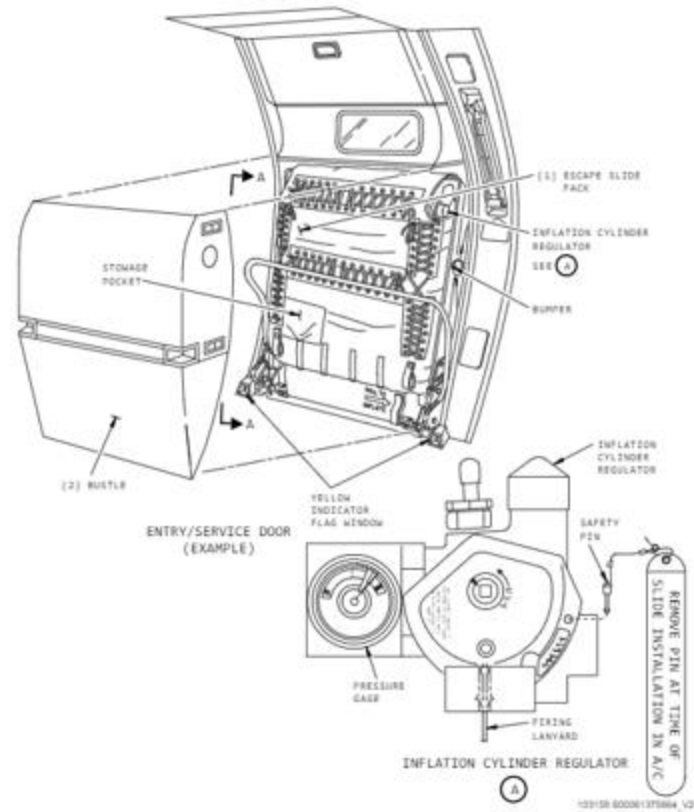

Figure 402: Entry/Service Door Escape System.

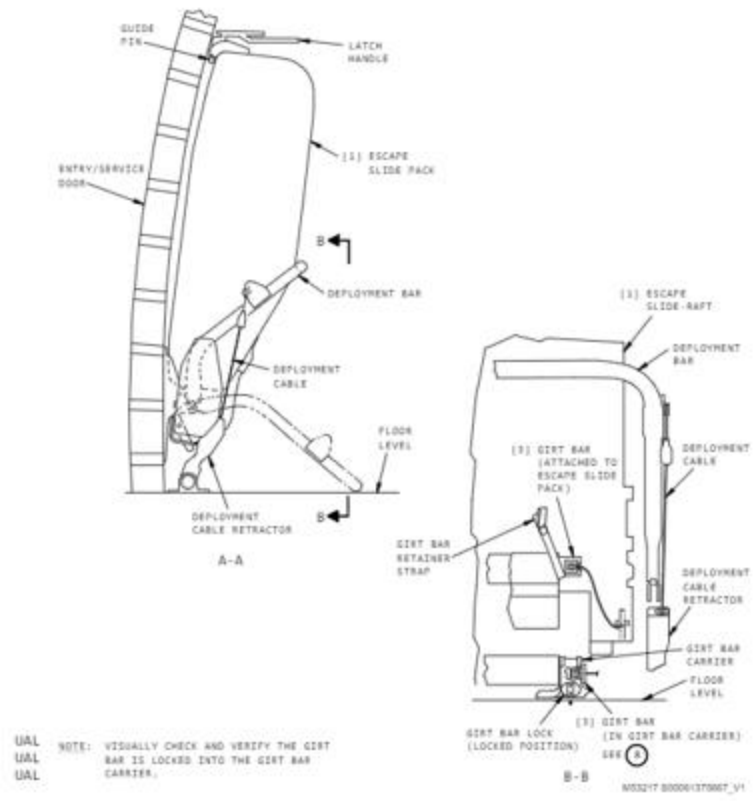
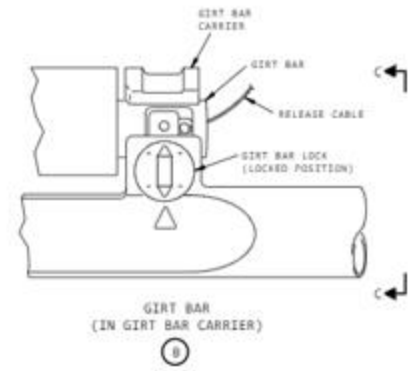
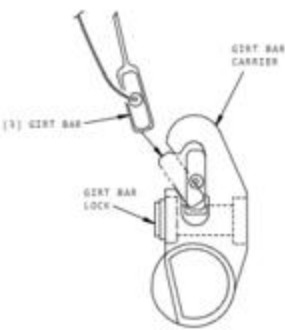

Figure 403: Entry/Service Door Escape System.



GIRT BAR
(IN GIRT BAR CARRIER)



C-C
MS2275 820001-375000_V1

UAL NOTE: VISUALLY CHECK AND VERIFY THE GIRT BAR
UAL IS LOCKED INTO THE GIRT BAR CARRIER.
UAL



Figure 404: Latch Handle Strap Installation

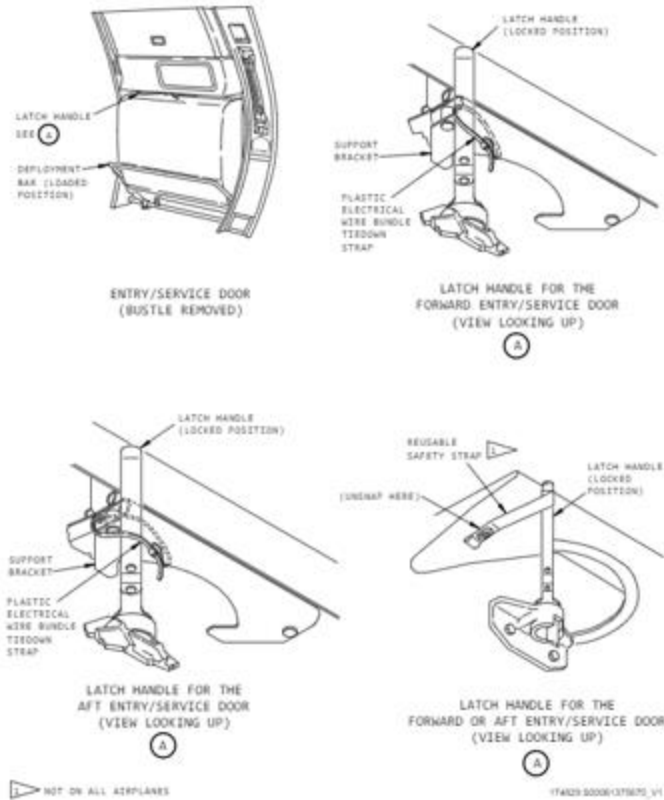

FIGURE 405:

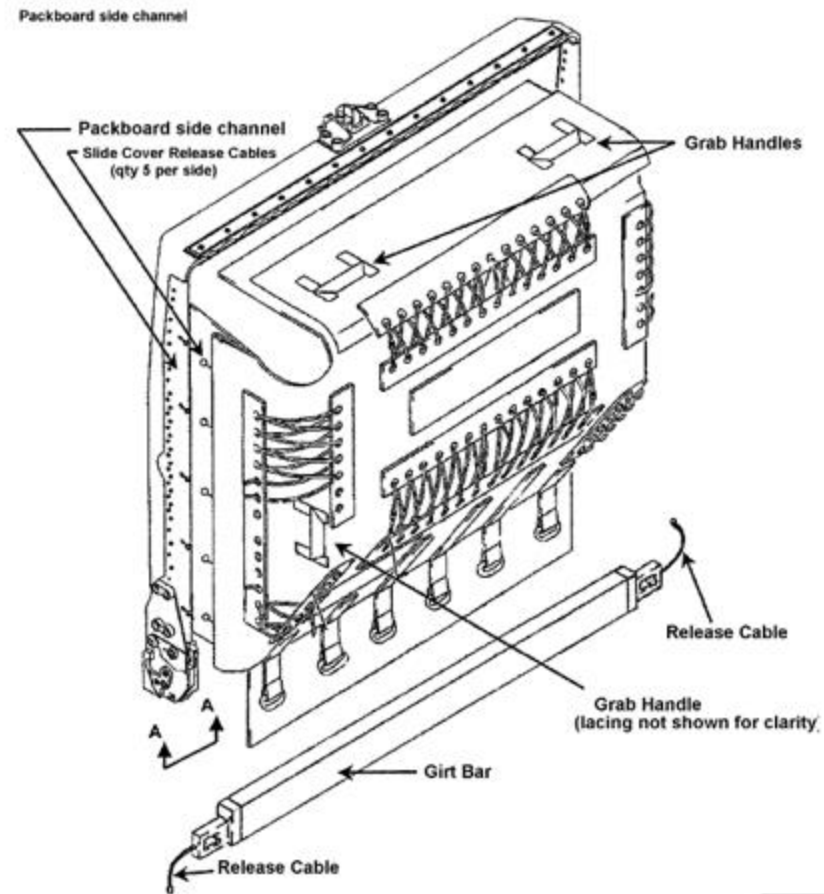

FIGURE 406:

View A-A Cables Detached

slide cover release cables
(qty 5 per side) secured into
the packboard side channels
(shown here detached)

packboard side channel

packboard extension & release
mechanism

release cable (shown here
detached from packboard
extension & release
mechanism)

View A-A Cables Attached

slide cover release cables
(qty 5 per side) secured into
the packboard side channels
(shown here attached)

**NOTE: ONCE THESE SLIDE
COVER RELEASE CABLES ARE
RELEASED FROM THE
PACKBOARD SIDE CHANNELS
THEY CANNOT BE RE-INSTALLED
(I.E. THE SLIDE IS UNUSABLE)**

release cable (shown here
attached to packboard
extension & release
mechanism)

**NOTE: DO NOT PULL OUT ON
THESE CABLES ONCE THEY
ARE INSTALLED. DOING SO
WILL UNLATCH THE SLIDE
COVER RELEASE CABLES AND
THE SLIDE WILL BE UNUSABLE!**



UNITED

VERIFY THE DOOR SLIDE IS IN THE DISARMED POSITION.



UNITED

UPPER ROLLER GUIDE MUST BE PINNED TO PREVENT THE DOOR FROM RISING WHEN THE WEIGHT OF THE SLIDE IS REMOVED. INSERT THE SAFETY PIN WITH THE RED STREAMER EXPOSED.



UNITED

REMOVE THE DOOR BUSTLE.



UNITED

REMOVE THE SAFETY PIN FROM THE SLIDE POUCH AND INSTALL THE PIN THE REGULATOR.



UNITED

ROTATE THE TWO LOCKS ON THE GIRT BAR CARRIER TO THE UNLOCKED POSITION

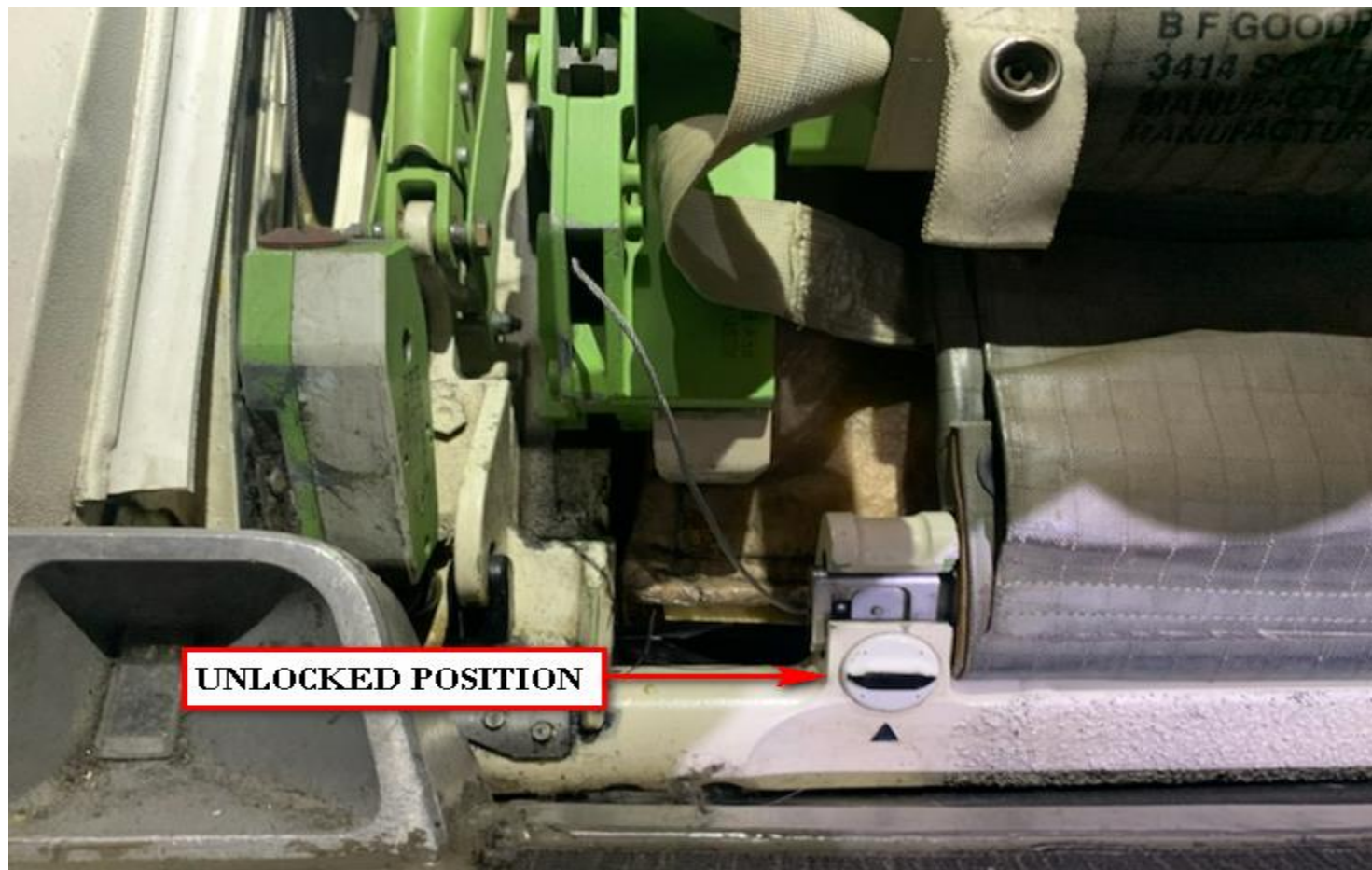

UNITED

UNDO THE SNAPS ON THE 2 STRAPS. REMOVE THE GIRT BAR AND SECURE IT WITH THE STRAPS.

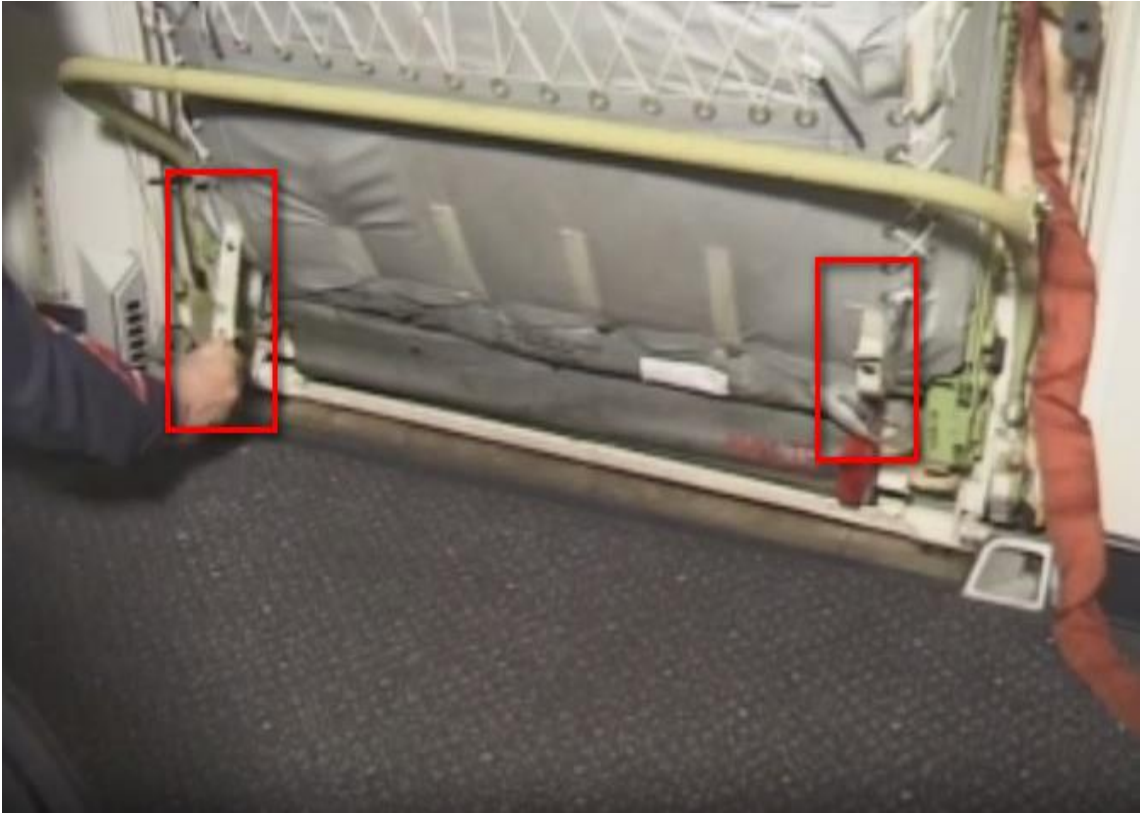

UNITED

LOWER THE DEPLOYMENT BAR.

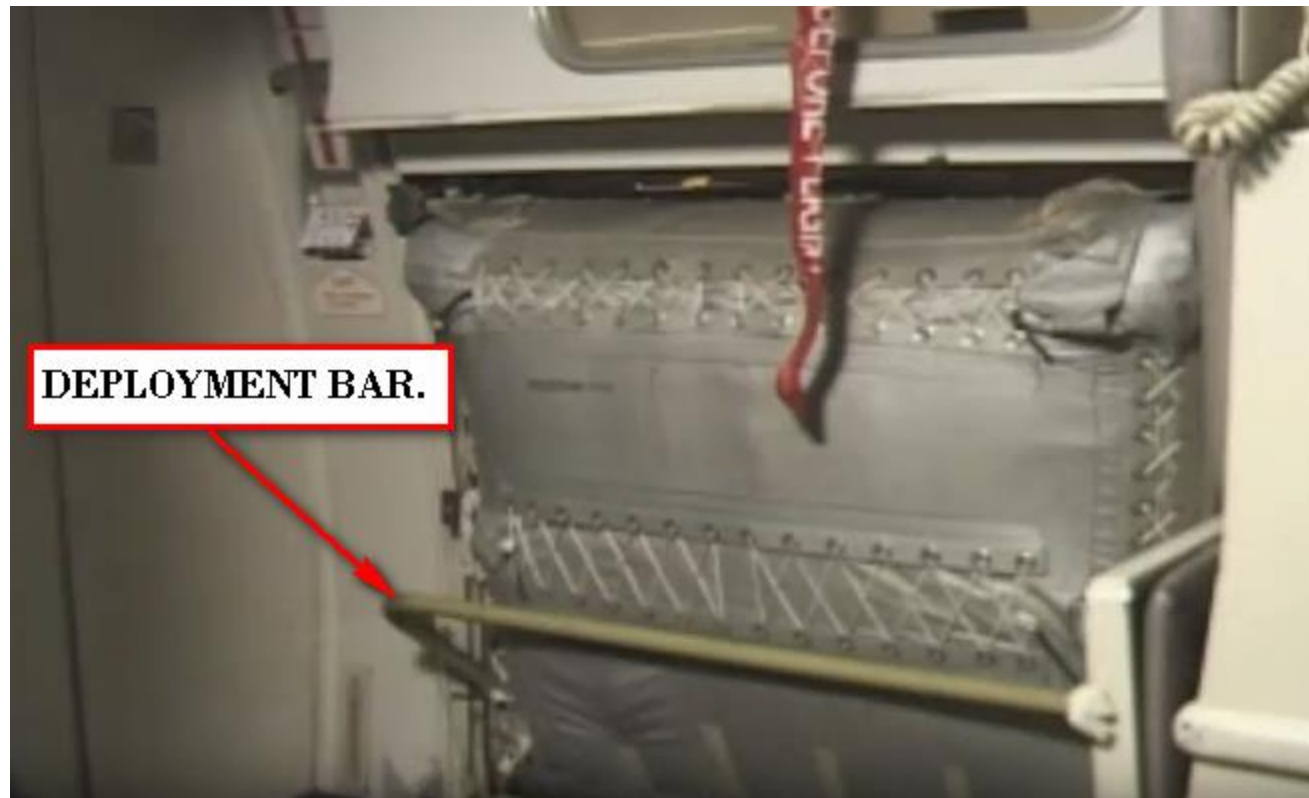

UNITED

TWO PERSONS ARE NECESSARY TO REMOVE/REINSTALL THE ESCAPE SLIDE PACK. THE WEIGHT OF THE SLIDE PACK IS APPROXIMATELY 146 LBS (66KGS).



UNITED

WHILE SUPPORTING THE SLIDE, UNDO THE SAFETY HANDLE YELLOW SAFETY STRAP AND ROTATE THE HANDLE TO REMOVE THE SLIDE. CAREFULLY LOWER THE SLIDE.



UNITED

SLIDE REINSTALLATION:
RAISE THE SLIDE AND SECURE IT IN PLACE. ROTATE THE SAFETY HANDLE AND SECURE THE
YELLOW STRAP.



UNITED

REMOVE THE GIRT BAR FROM THE RETAINING STRAPS AND INSTALL THE GIRT BAR INTO THE GIRT BAR CARRIER. ROTATE THE LOCKS TO THE LOCKED POSITION, ARROW UP.

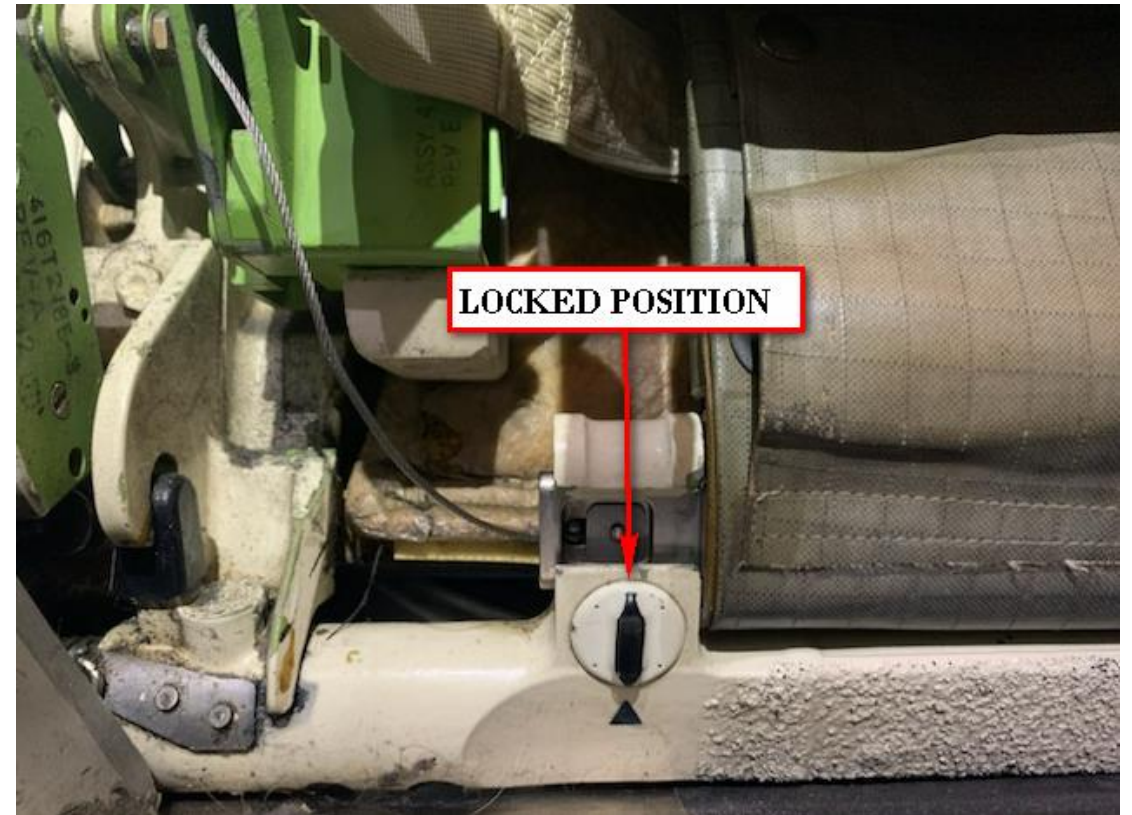

UNITED

CHECK THE CLEARANCE BETWEEN THE BUMPER AND PACKBOARD CHANNEL ARE WITHIN AMM LIMITS.



UNITED

REMOVE THE SAFETY LOCK PIN FROM THE REGULATOR VALVE. ROLL IT UP AND INSTALL IT IN THE SLIDE POUCH, LEAVING A SMALL PART OF THE STREAMER EXPOSED.



UNITED

PERFORM AN OPERATIONAL CHECK OF THE ARMED/DISARM MECHANISM PER THE AMM AND
VERIFY THE YELLOW GIRT BAR INDICATOR IS VISIBLE.



UNITED

REMOVE THE LOCKPIN FROM THE UPPER ROLLER GUIDE.

