

Program Summary:

Adaptive reuse of an existing structure at a summer camp for children with special needs into an arts and crafts “maker” space.

Program Statement:

The design task was to create immersive experiences, foster creative expression and amplify the joy of making within the timeless traditions of summer camp.

Drawing inspiration from the camp’s 25 year master plan, the project transformed an abandoned cabin, purposefully reintegrating its presence within existing camp roads and walkways. The nature of the users and creative program led the team to an accessible, inclusive, and direct “mosaic” concept. Directly associated with the creative work, mosaics begin with humble and sometimes unrelated pieces that, when assembled, celebrate their diversity and collaboration. Individuality becomes an asset, reminding us that the whole is indeed greater than the sum of its parts.

The floor plan, furniture, and storage solutions prioritize flexibility and utility, while a continuous mosaic spectrum of color links the string of interior and exterior spaces. A breezeway and detached bathroom provide privacy, while substantial fenestration allows for beautiful north light, clear circulation and functional program.

The custom trusses and playful columns are fabricated from reclaimed steel from the oil and gas industry. Nearly 1,000 sf of reclaimed lumber, including formwork used in the project, create a complimentary mosaic of natural texture and color on the ceiling and in the restroom.

At night the color spectrum radiates into camp, reminding campers of their time there, and creating a unique beacon in the wooded landscape, adding to the magic and memory of this special place and community.

SP-435.01

Building Area: (sf)
2300

Cost per Square Foot:
\$22/sf

Construction Cost
\$50,000

Date of Completion:
5/20/22

SP-435.02

Drawing inspiration from the camp's 25 year master plan, the project transformed an abandoned cabin, purposefully reintegrating its presence within existing camp roads and walkways.

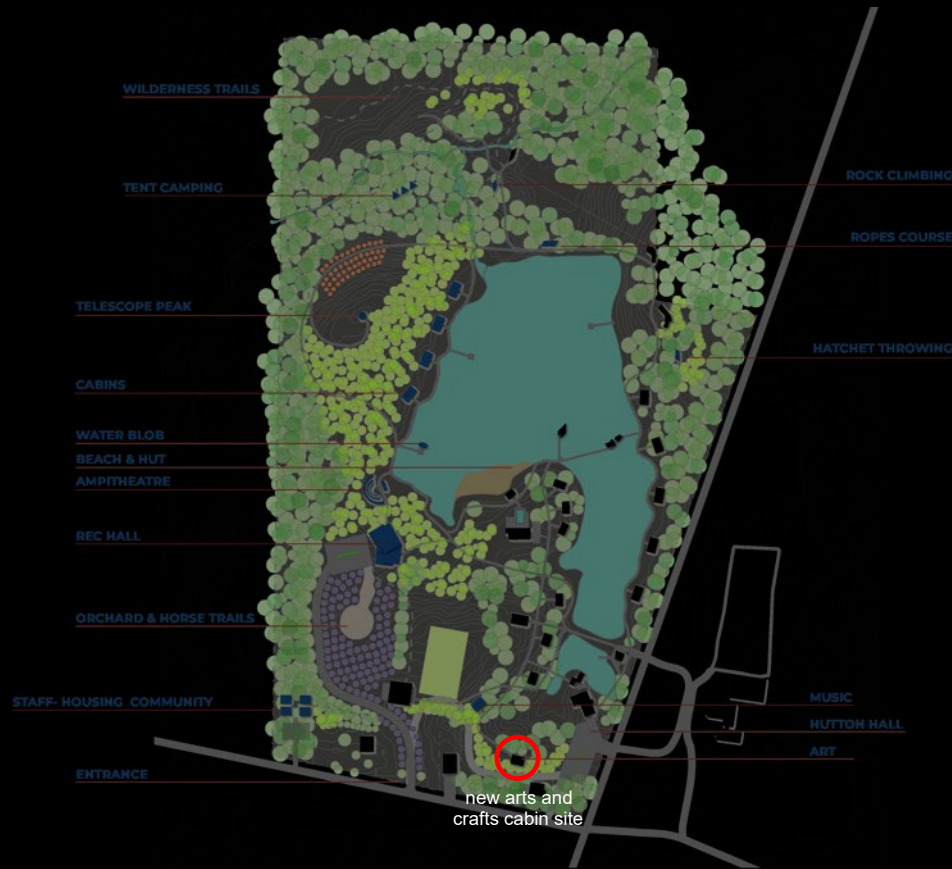

property map



existing structure

SP-435.03

The floor plan, furniture, and storage solutions prioritize flexibility and utility, while a continuous mosaic spectrum of color ties the interior and exterior spaces together.



SP-435.04

A breezeway and detached bathroom provide privacy, while substantial fenestration allows for beautiful north light that organizes logical circulation and program.





SP-435.05

The floor plan, furniture, and storage solutions prioritize flexibility and utility, while a continuous mosaic spectrum of color links the string of interior and exterior spaces.





SP-435.06

The nature of the users and creative program led the team to an accessible, inclusive, and direct "mosaic" concept.





SP-435.07

Directly associated with the creative work, mosaic work begins as humble and sometimes unrelated pieces, but when assembled, it celebrates their diversity. Individuality becomes an asset, reminding us that the whole is indeed greater than the sum of its parts

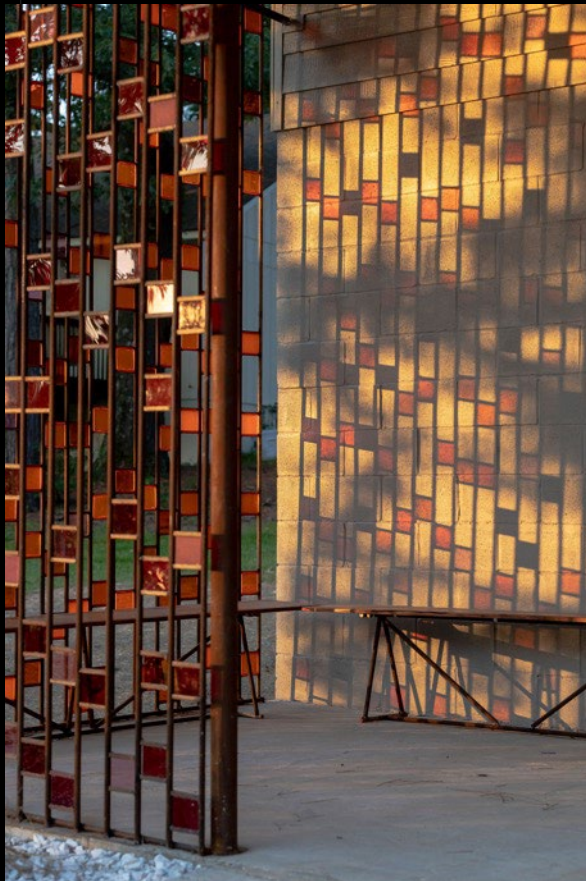

SP-435.08

The custom trusses, playful columns, and soffit screen are fabricated from reclaimed steel from the oil and gas industry.



SP-435.09

The custom trusses, playful columns, and soffit screen are fabricated from reclaimed steel from the oil and gas industry.



SP-435.10

Nearly 1,000 sf of reclaimed lumber, including formwork used in the project, create a complimentary mosaic of natural texture and color on the ceiling and in the bathroom.





SP-435.11

Nearly 1,000 sf of reclaimed lumber, including formwork used in the project, create a complimentary mosaic of natural texture and color on the ceiling and in the bathroom.



SP-435.12

At night the color spectrum radiates into camp, reminding campers of their time there, and creating a unique beacon in the wooded landscape, adding to the magic and memory of this special place and community.

SP-435.13

At night the color spectrum radiates into camp, reminding campers of their time there, and creating a unique beacon in the wooded landscape, adding to the magic and memory of this special place and community.



Project Name:
Mosaic Art Cabin

Project Location:
Choudrant Louisiana

Owner/Client:
MedCamps of Louisiana

Architect(s) of Record:
Brad Deal & Robert Brooks, AIA
And
Louisiana Tech University School of Design
P.O. Box 3147
Ruston, Louisiana 71272

Project Team:
Robert Brooks, Brad Deal and the 2022 ARCH 335 class at
Louisiana Tech University :

Seth Bartholomew
Devin Boyd
Alex Bradke
Emily Brinkerhoff
Cole Chivers
Riley Felicetty
Stacey Garner
Christ Jacob Goure
Foster Gunter
Haley Hamel
Bailey Hayes
Gavin Jones
Gracie Kimbrell
Cody Marino
Jordan Merritt
Josh Mwatibo
Jack North
Ty O'Neal
Whitley Procell
Morgan Provost
Preston Remy
Olivia Roger
Brandon Shows
Laila Stewart
Katelyn Watts
Will Whatley
Katie Young

Landscape Architect:
N/A

Consultants:
N/A

General Contractor:
Robert Brooks, Brad Deal and the 2022 ARCH 335
class from Louisiana Tech University

Photographer(s):
Henry McCoy Photography, Ruston Louisiana
Brad Deal, Louisiana Tech University

SP-435.x

Credit Slide

This slide will not be seen by the judges. It replaces what in past years has been in the sealed envelope.

Please fill out the information requested to the left. As with other slides please set the correct Entry Number above; OK to leave slide# as "x"

Some of this information will be added to the slides when used for the Awards Presentation at the AIA Louisiana Convention.

Note: on this slide if you run out of space please adjust font size as necessary or move more information to the second column.

Please submit 2 Power Point Submissions on CD as indicated on the instructions sent to you with your entry number (one w/credit slide and one without).