

Program Summary:

A prototype for the future of banking, this new branch represents a transformative shift in financial architecture—one that prioritizes resilience, sustainability, and energy independence.

Program Statement:

Located in a commercial district dominated by surface parking, the project serves as an oasis of innovation. Going beyond net-zero energy, the building will produce more energy than it consumes, setting a new benchmark for off-grid-capable banking facilities in the Gulf South. The design integrates state-of-the-art sustainability measures, including an extensive solar panel array with battery storage, a geothermal HVAC system, and an airtight, high-performance building envelope. These systems allow the branch to operate independently of the power grid for extended periods, ensuring functionality in the wake of extreme weather events. The building employs a predominantly wood construction system to minimize embodied carbon and maximize carbon sequestration, using wood structural elements and cellulose insulation. Expansive overhangs reduce cooling loads while maintaining a contemporary elliptical form—a reinterpretation mid-century commercial architecture, popular at Elmwood's inception. The massing is sculptural and functional, maximizing daylighting and offering an omnidirectional urban presence. Inside, warm wood ceilings extend from interior to exterior, connecting common areas to the landscape. Clean white walls and polished concrete floors balance refinement with durability and reduce additional material usage. The open layout eliminates traditional banking barriers, creating an approachable experience, while the brand's signature teal and orange add subtle vibrancy. This branch establishes a replicable model for disaster-resilient, energy-efficient banking—redefining the financial institution as resilient, responsible, and rooted in the future.

A215.01

Building Area: (sf)
4,900 SF

Cost per Square Foot:
\$1,036/SF

Construction Cost
\$5,080,000

Date of Completion:
2025



A215.02

Elliptical Massing

The massing is sculptural and functional, maximizing daylighting and offering an omnidirectional urban presence.

Expansive overhangs reduce cooling loads while maintaining a contemporary elliptical form—a reinterpretation of mid-century commercial architecture.



A215.03

Oasis in a Sea of Concrete

Located in a commercial district dominated by surface parking, the project serves as an oasis of innovation.



A215.04

Landscape Design

The project replaced a sea of impermeable surface parking with a landscape filled with a variety of native plants and bioswales that serve double duty: visual delight and stormwater management



A215.05

Wood

The building employs a predominantly wood construction system to minimize embodied carbon and maximize carbon sequestration, using wood structural elements and cellulose insulation.





A215.06

Interior Environments

Inside, warm wood ceilings extend from interior to exterior, connecting common areas to the landscape.





A215.07

Approachability

The open layout eliminates traditional banking barriers, creating an approachable experience, while the brand's signature teal and orange add subtle vibrancy.



A215.08

Simplicity & Functionality

Clean white walls and polished concrete floors balance refinement with durability and reduce additional material usage.





A215.09

Energetic Banking

Going beyond net-zero energy, the building will produce more energy than it consumes, setting a new benchmark for off-grid-capable banking facilities in the Gulf South.

This is made possible through a 40kW solar array on the roof that connects to a 40 kWh battery array that connects to smart electrical panels, providing a smart microgrid that powers the building during outages—an all-too common occurrence in southern Louisiana, especially after hurricanes.





A215.10

Designed for Replicability

This branch establishes a replicable model for disaster-resilient, energy-efficient banking—redefining the financial institution as resilient, responsible, and rooted in the future.

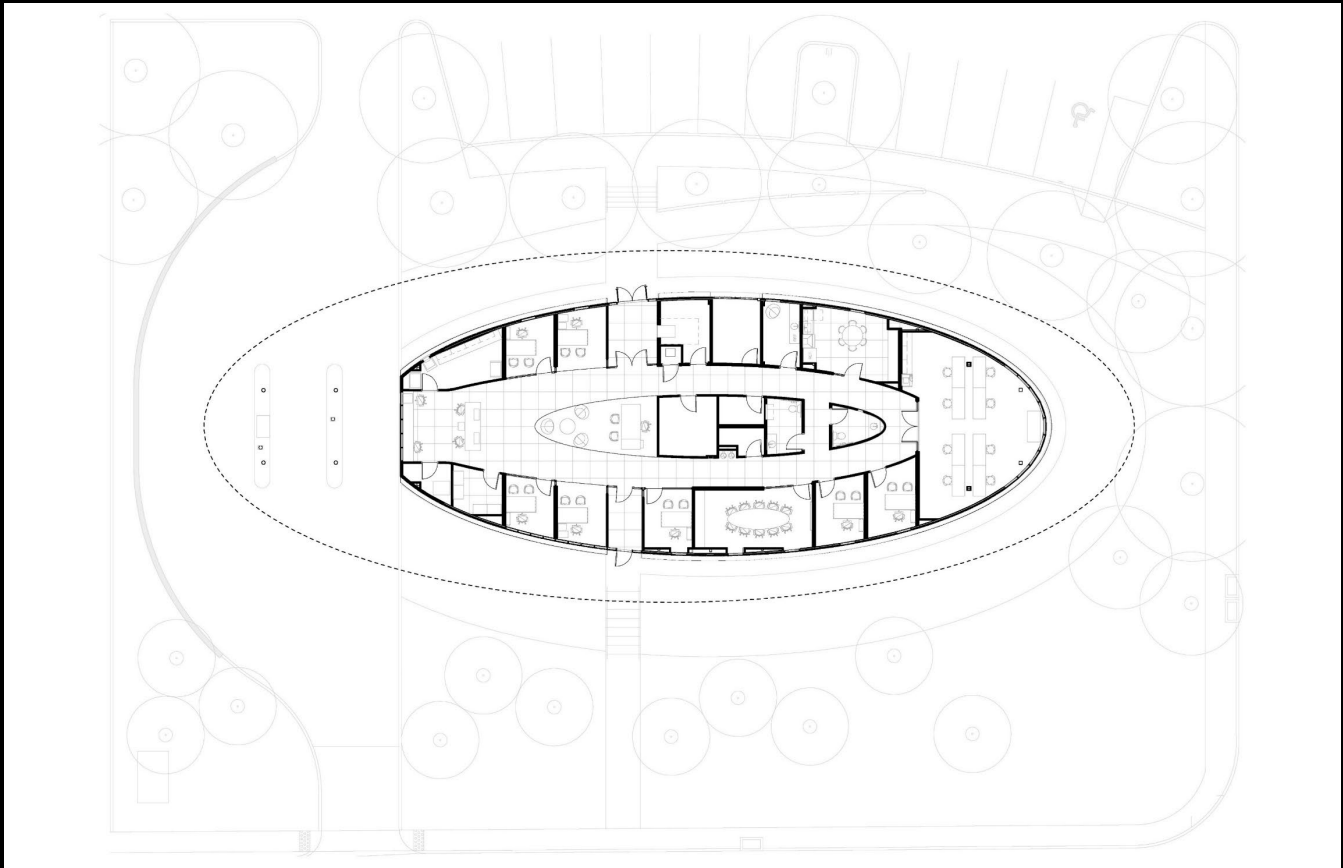

A215.11

Floor Plan