

### **Program Summary:**

The school features a STEAM-inspired, student-centered K-8 environment with dual buildings, enrichment spaces, and nature-themed interiors for discovery and growth.

### **Program Statement:**

Inspired by the school's long-standing record of academic excellence, our firm worked closely with teachers and staff to develop a student-centered learning environment to serve kindergarten through eighth grade students, and celebrate the school's French Immersion program. Diagrammatically, the school is divided into two buildings: the south building houses administrative offices, classrooms, special education, and media center spaces, while the north building contains enrichment classrooms and commons areas. The two structures form the start of a campus environment that facilitates learning activities and smooth movement between buildings. The interiors were inspired by a focus on STEAM and were designed through a play on words, "STEM from Nature," creating engaging settings for discovery and development. Key themes are translated in French to highlight the infusion of the Immersion program. The new campus creates the optimal setting for its anticipated 900+ students to thrive and grow throughout their pivotal developmental years.

# A-145.01

Building Area: (sf)  
**68,082 SF**

Cost per Square Foot:  
**\$343**

Construction Cost  
**\$23,412,707**

Date of Completion:  
**06/24/2024**

# A-145.02

## Site Plan

- Situated on the edge of a prominent university and across from a rigorously academic high school, this school is in the ideal location for students, staff, and community connection. The school is intentionally located with the students' futures in mind and designed from seamless transition through all stages of educational development.



# A-145.03

## Entry

- The entry to the school features large windows that offer clear views into the main lobby. Inside, the open layout and use of a vibrant color palette creates a warm, welcoming atmosphere for students and staff as they enter the building.
- The entry showcases as a focal point from the main roadway, enhancing visibility and streamlining wayfinding.
- Its transparency offers a glimpse of the dynamic atmosphere inside, creating a sense of creativity and engagement.





# 3 AIR

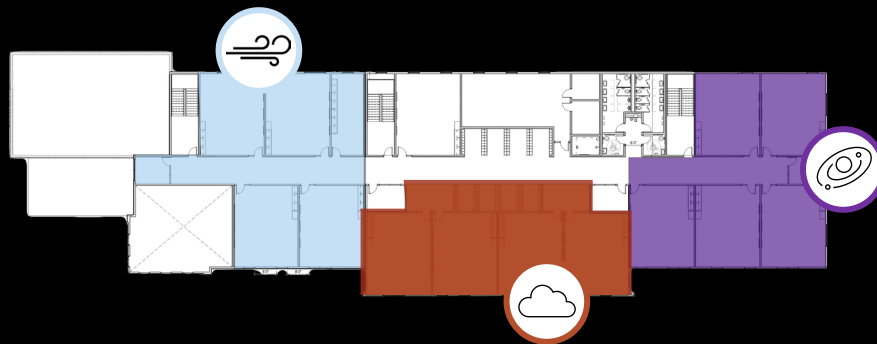

# 2 LAND

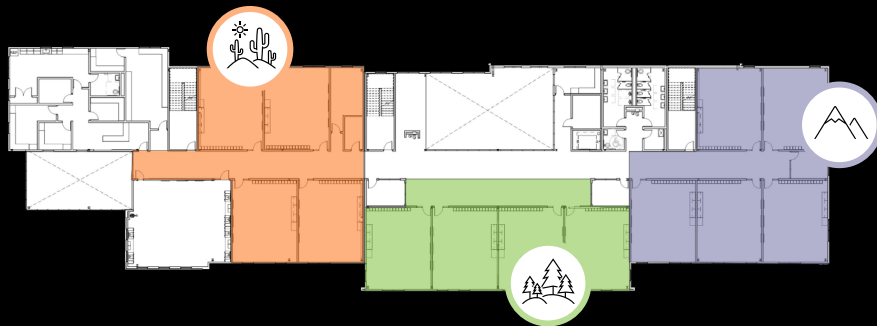

# 1 WATER

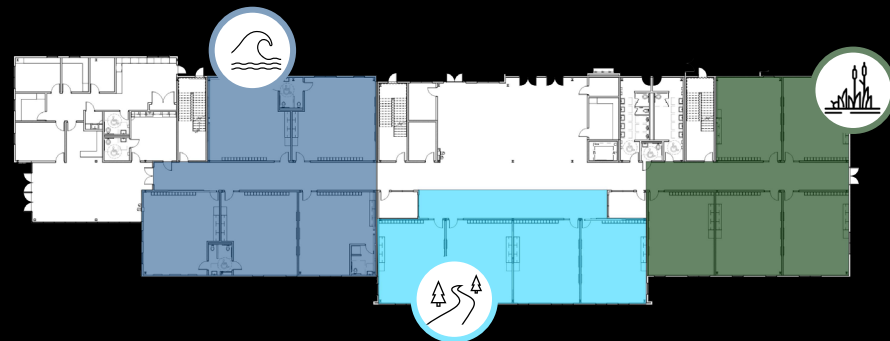

## A-145.04

Floor Plans / Interior Concept

- Each level of the school features a distinct thematic design carried throughout its floor plan—water on the first floor, land on the second, and air on the third—creating a cohesive and immersive experience as students move through the building.



ocean

river

swamp

desert

forest

mountain

sky

climate

space



# A-145.05

## Media Center

- The Media Center serves as the hub for expression and exploratory learning. Centrally located in the Academic building, this two-story space offers opportunities for learning, catered to the needs of students at all levels.
- At one end of the space, a custom graphic showcases unique facts about Louisiana, while the other end invites students into a serene, forest-inspired setting—ideal for individual or small group learning.
- High above the “river” sits a treehouse that provides another setting for one-on-one development and learning.







# A-145.06

## River Portal to Media Center

- The 'river' portal serves two key functions: guiding students to first-floor classrooms and drawing them into the exploratory learning environment of the Media Center. Additionally, the Media Center offers access to the covered walkway connecting the Academic and Commons buildings.
- A sense of movement is inherent in the rippling ceiling clouds, the stair portal, and the flowing flooring pattern.
- The "river" continues beneath the stairs to create semi-private space for cozy reflection.







## A-145.07

### Commons

- The Commons building is bordered by play areas and connected to the Academic building via a walkway flanked by a playground, basketball courts, restricted carpool access, and a direct path to the soccer field
- The building accommodates communal dining and food preparation areas, along with enrichment spaces that are acoustically separated from the Academic building to minimize noise.
- The dining area is open and spacious, with large windows that flood the space with natural light.





# A-145.08

## Treehouse

- The Treehouse is located on the second floor of the Media Center, offering a small respite from the group activity below. Nestled in the trees, this semi-private space changes the scale of the surrounding open area for more focused learning and engagement.
- As students move from the “desert”, to the “forest”, and into the “mountains”, they can watch the learning process in action from the Treehouse above.





# A-145.09

## 3rd Floor Corridor

- The 3<sup>rd</sup> floor brings students up into air elements as they transition from “sky” to “climate” to “space”. While its focus is on rigorous academics, this floor still maintains a sense of play and adventure, reinforcing the mantra that learning never stops and the sky’s the limit!
- While classroom corridors can be long, windowless spaces, this floor highlights how simple design elements can bring any space to life and foster a sense of creativity and learning.
- French translations of themed areas and signage are displayed throughout the campus, reinforcing the school's commitment to its French Immersion program and supporting language development in daily routines.

